

Mail City
 WOODBINE
Phone
 410-984-5813
E-mail

Mail State MD 21797
Primary Yes

Cell Number **Fax Number**

Professionals (This section is not required.)

License # *
 08010091659
License Type *
 MHIC Ind
Primary
 Yes

Business Name
 MCWHORTER CONSTRUCTION LLC
First Name RYAN **Middle Name** **Last Name** MCWHORTER
Address Line 1
 6851 REDBERRY ROAD
Address Line 2

City CLARKSVILLE **State** MD **ZIP Code** 21029-0000
Phone 1 4109845813 **Phone 2** **Fax** 3018543449
E-mail
 MCWHORTEROUTDOOR@GMAIL.COM

Applicant (This section is not required.)

Search **As Owner** **As Lic. Prof** **As Contact**

Type *
 Applicant RYAN **MI** **Last Name** MCWHORTER
Relationship
 Applicant
Primary
 Yes

Organization Name
 MCWHORTER CONSTRUCTION LLC
Street Address
 6851 REDBERRY ROAD
Address Line 2

City CLARKSVILLE **State** MD **Zip Code** 21029-0000
Phone 4109845813 **Cell** **Fax** 3018543449
E-mail *
 MCWHORTEROUTDOOR@GMAIL.COM

Addtl Info

Est Construction Cost * 20000 **Housing Units *** 0 **Number of Buildings *** 0 **Public Owned** No

Construction Type
 434 - Additions, Alterations and Conversions - Residential

MISC PERMIT INFO

MISCELLANEOUS PERMIT INFORMATION

Capital Project-No Fee * Yes No **Capital Project Number** **Fee Exempt *** Yes No **Roadside Tree Project Permit *** Yes No **Roadside Tree Project Permit #**

Existing Use * SFD **Water** Private **Sewage** Private **Expiration Date** 2/18/2024

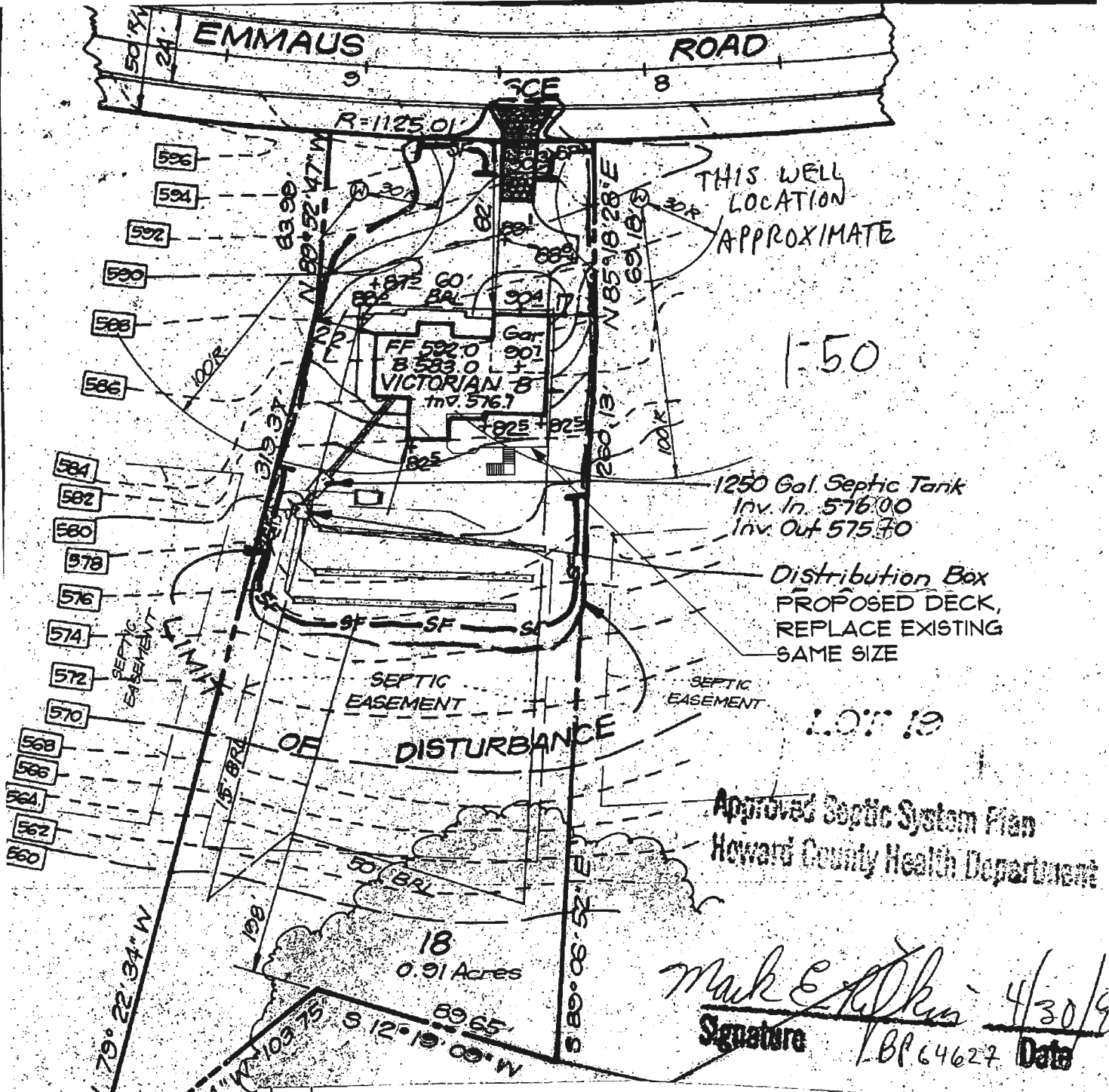

No.	REVISIONS	DATE
1.	Proposed Silt Fence, Septic Tank, Dist. Box and Septic Trenches relocated per Ho. Co. Health Dept. Comm.	4-29-99



CLARK • FINEFROCK & SACKETT, INC.
ENGINEERS • PLANNERS • SURVEYORS

135 MINSTREL WAY • COLUMBIA, MD. 21045 • (410) 381-7500 - BALTO • (301) 621-8100 - WASH.

SIGNED ME TWM WN BAL	SITE DEVELOPMENT SEDIMENT AND EROSION CONTROL PLAN LOT 18	SCALE As Shown
	WALNUT SPRINGS	DRAWING 1 OF 1

*** SEE DECK CODE COMPLIANCE GUIDELINES FOR MINIMUM SPECIFICATIONS

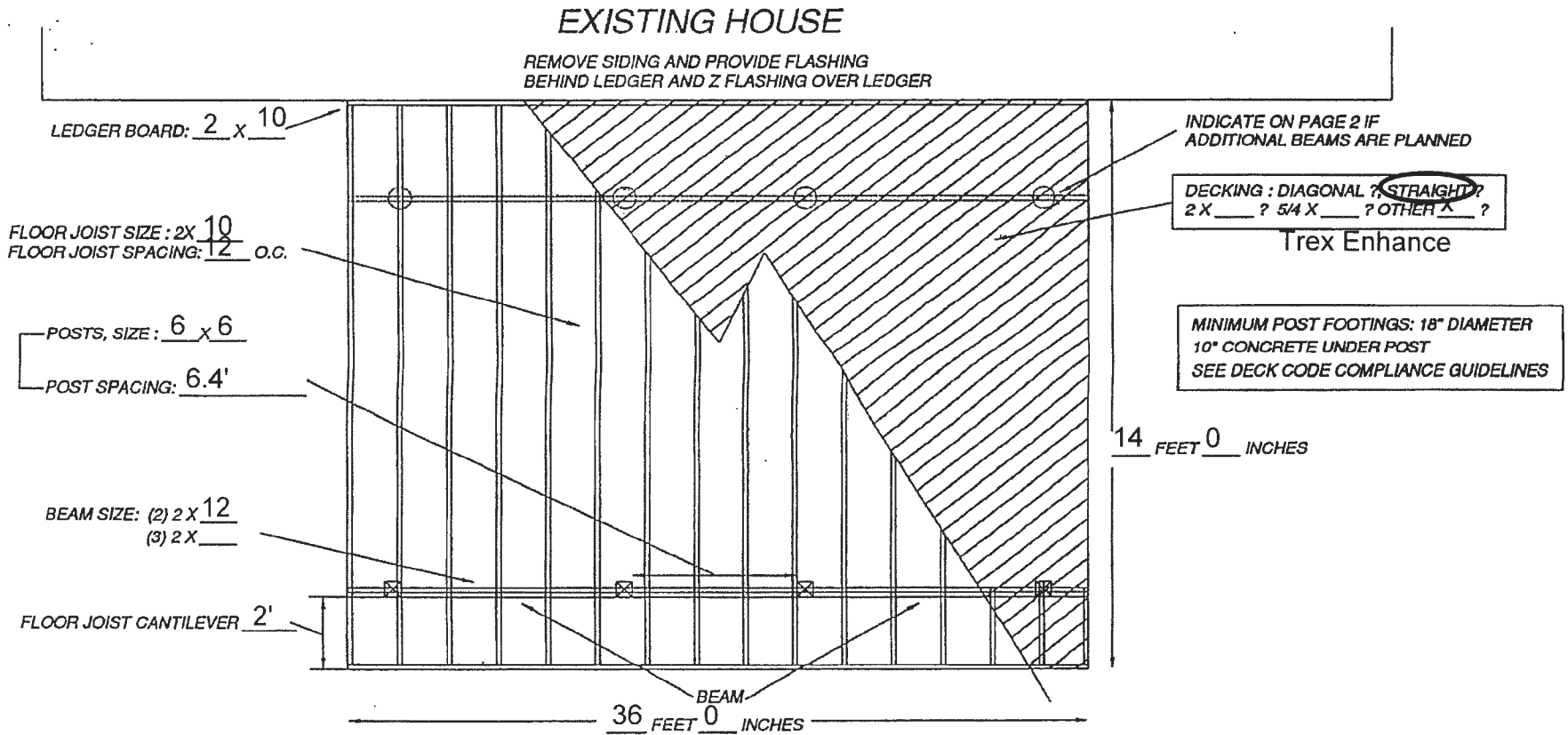

Sample ① DECK FLOOR FRAMING PLAN EXAMPLE

1 OF 2

OPEN DECK