

Bureau of Environmental Health  
 7178 Gateway Drive Columbia, MD 21046  
 (410) 313-2640 Fax (410) 313-2648  
 TDD (410) 313-2323 Toll Free 1-866-313-6300  
 website: www.hchealth.org

Maura J. Rossman, M.D., Health Officer

RECEIPT DATE: 12/05/12 **ONSITE SEWAGE DISPOSAL SYSTEM** P 544411

INSTALLATION APPROVAL DATE: 9/16/2014 **PERMIT** A \_\_\_\_\_  
**CONSTRUCTION**

PROPERTY ADDRESS: 6501 Prestwick Drive

SUBDIVISION: Willow Pond LOT: 7 TAX ID: 05-593280

CONTRACTOR: \_\_\_\_\_ EMAIL: \_\_\_\_\_

CONTRACTOR ADDRESS: \_\_\_\_\_ PHONE: \_\_\_\_\_

PROPERTY OWNER: Greenfield Homes EMAIL: \_\_\_\_\_

OWNER ADDRESS: 6656 Luster Drive, Highland, MD 20777 PHONE: 410-781-6782

SEPTIC TANK SIZE (GALLONS): 2000

PUMP CHAMBER CAPACITY (GALLONS): 1250 PUMP SIZE: \_\_\_\_\_

NUMBER OF BEDROOMS: 4 HOUSE SQ. FT. ±4,500 APPLICATION RATE: 1.2

DISTRIBUTION SYSTEM: GRAVITY FED  LOW PRESSURE DOSED

TRENCHES:	LINEAR FEET REQUIRED: <u>110 116'</u>	INLET DEPTH: <u>3 4.5'</u>
	TRENCH WIDTH: <u>2 3'</u>	MAXIMUM BOTTOM DEPTH: <u>8 7'</u>
	MINIMUM SPACE BETWEEN TRENCHES: <u>8</u>	EFFECTIVE AREA BEGINNING DEPTH: <u>3</u>
LOCATION:	PER APPROVED SITE PLAN. SEWAGE DISPOSAL AREA AND BAT UNIT LOCATION MUST BE STAKED BY LICENSED SURVEYOR PRIOR TO PRE-CONSTRUCTION INSPECTION.	
NOTES:	Set septic tank and pump tank per plan. Set distribution box at northwest corner of SDA. Install 2 x 55' trenches on contour in upper SDA. <u>2x33' + 50' Trenches</u>	

ISSUED BY: Robert Bricker ISSUE DATE: \_\_\_\_\_ EXPIRATION DATE: 12/05/13

- NOTE: CONTRACTOR MUST SCHEDULE A PRE-CONSTRUCTION INSPECTION PRIOR TO BEGINNING ANY INSTALLATION
- NOTE: CONTRACTOR MUST SCHEDULE AN INSPECTION AND GAIN APPROVAL OF ALL COMPONENTS PRIOR TO COVERING
- NOTE: STONE MUST BE APPROVED BY HEALTH DEPARTMENT AND GRAVEL TICKET MUST BE AVAILABLE FOR REVIEW.
- NOTE: WATERTIGHT SEPTIC TANKS REQUIRED
- NOTE: ALL PARTS OF SEPTIC SYSTEM SHALL BE AT LEAST 100 FEET DOWNGRADIENT FROM ANY WATER WELL
- NOTE: MANHOLE RISERS REQUIRED ON ALL SEPTIC TANKS AND PUMP CHAMBERS
- NOTE: AN ELECTRICAL PERMIT IS REQUIRED FOR INSTALLATION OF ANY ELECTRICAL COMPONENTS OF THE SYSTEM

**NEITHER THE HOWARD COUNTY COUNCIL NOR THE HEALTH DEPARTMENT IS RESPONSIBLE FOR THE SUCCESSFUL OPERATION OF ANY SYSTEM.  
 PERMITTEE RESPONSIBLE FOR OBTAINING FINAL APPROVAL ON THIS PERMIT.  
 CALL 410-313-1771 TO SCHEDULE INSPECTIONS.**

NOT TO SCALE

See Seperate Sheet  
for As-built

ROAD NAME

TRENCH/DRAINFIELD DATA

WIDTH	INLET	BOTTOM
2	4'	7'
NUMBER OF TRENCHES		3
TOTAL LENGTH		119'
ABSORPTION AREA		238'±SW
DISTRIBUTION BOX LEVEL		Yes
DISTRIBUTION BOX BAFFLE		45° bend
DISTRIBUTION BOX PORT		Yes

SEPTIC TANK DATA

SEPTIC TANK 1 LEVEL	Yes
MANUFACTURER	Babylon
CAPACITY	2000 GAL
SEAM LOC	Top
TANK LID DEPTH	2'-3"
BAFFLES	Yes
BAFFLE FILTER	—
MANHOLE LOC	Front
6" PORT LOC	Rear
WATERTIGHT TEST	—
SLOTTED	Yes
DATE ON LID	4-14-13
PUMP/SEPTIC TANK LEVEL	Yes
MANUFACTURER	Babylon
CAPACITY	1250 GAL
SEAM LOC	Top
TANK LID DEPTH	3'
BAFFLES	Front
BAFFLE FILTER	—
MANHOLE LOC	center
6" PORT LOC	none
WATERTIGHT TEST	—
SLOTTED	no
DATE ON LID	4-12-13

PRE-CONSTRUCTION:

5/22/2013 Install two 33' trenches and one 50' trench on contour across the top of the septic easement. Set tanks near where shown on the B.P. plan. (BB)

INSTALLATION:

5/30/13 Septic tank set per plans. Pump tank set. House connection and pump installed. No electrical. Starting force main now (KW)  
5/31/13. Tank components complete. Force main installed to Dbox. Trenches complete. Stone very clean. Soil consistent w/ perc's. OK to cover all work need p/A test for final approval. (KW)  
Well line inspected, passed.

9/16/2014 Pump and alarm working. (BB)

FINAL INSPECTOR

B. Baker

DATE OF APPROVAL

9/16/2014

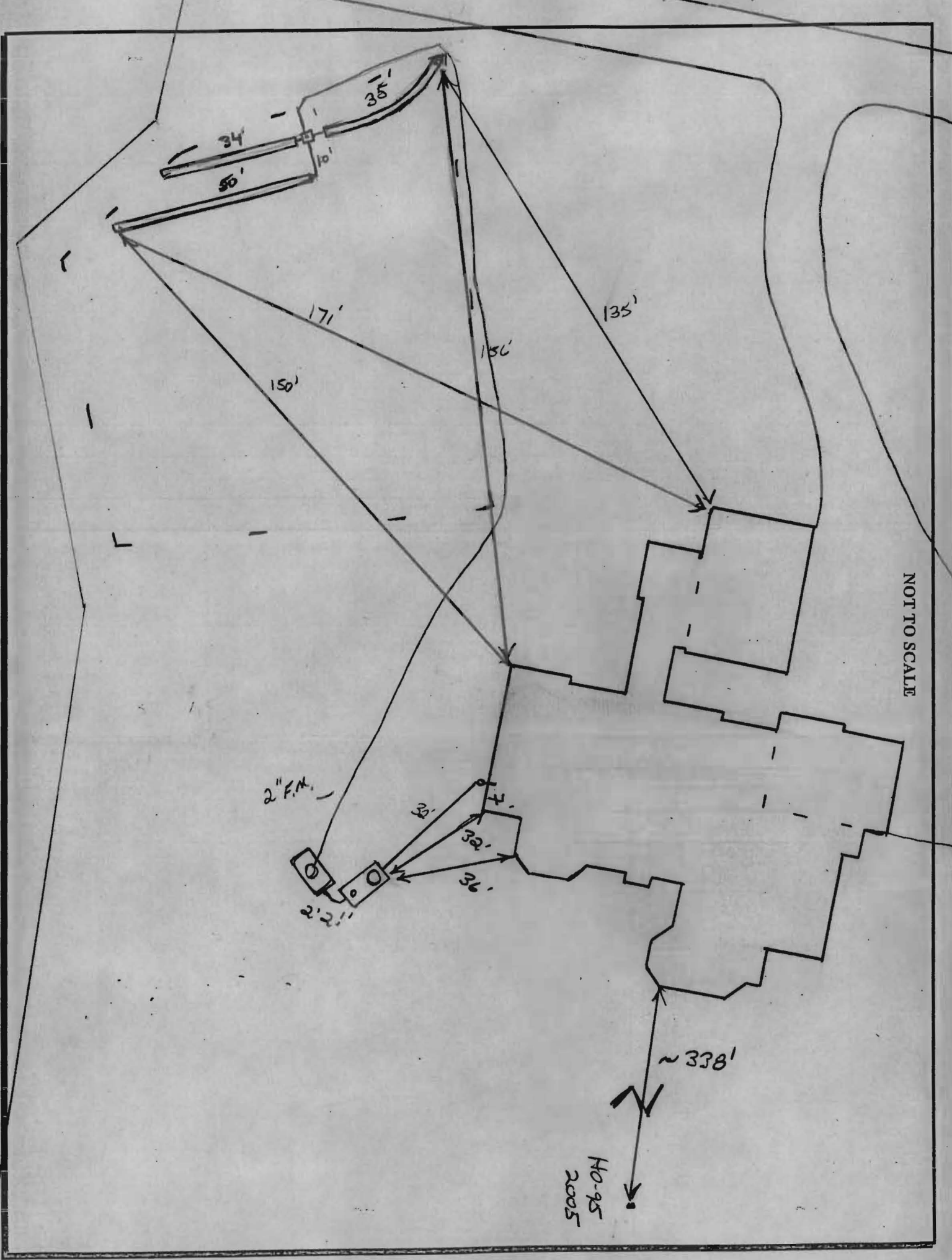

NOT TO SCALE

HO-95  
2005

RECEIPT DATE: 12/05/12

P 544411

INSTALLATION APPROVAL DATE: \_\_\_\_\_

# PERMIT

A \_\_\_\_\_

## ON-SITE SEWAGE DISPOSAL SYSTEM HOWARD COUNTY HEALTH DEPARTMENT BUREAU OF ENVIRONMENTAL HEALTH

PROPERTY OWNER: Greenfield Homes Inc.

OWNER'S ADDRESS: 6656 Luster Drive, Highland, MD 20777 PHONE: 410-781-6782

ADDRESS: 650 Prestwick Drive TAX ACC'T #: 05-593280

SUBDIVISION: Willow Pond LOT: 7

SEPTIC TANK CAPACITY (GALLONS): TBD

PUMP CHAMBER CAPACITY (GALLONS): TBD

NUMBER OF BEDROOMS: TBD APPLICATION RATE: TBD

SQUARE FOOTAGE OF HOUSE: TBD

LINEAR FEET OF TRENCH REQUIRED: TBD

TRENCHES:	TO BE DETERMINED ON APPROVED SUPPLEMENTAL PLAN
LOCATION:	TO BE DETERMINED ON APPROVED SUPPLEMENTAL PLAN
NOTES:	A SUPPLEMENTAL PLAN PROVIDING SYSTEM DETAILS IS REQUIRED PRIOR TO HEALTH APPROVAL OF BUILDING PERMIT, PLOT PLAN, AND WALL CHECK. AN APPROVED WALL CHECK IS REQUIRED PRIOR TO PRE-CONSTRUCTION INSPECTION. THE OSDS PERMITTED HEREIN IS NOT SUBJECT TO REVISIONS TO COMAR 26.04.02 EFFECTIVE 1/1/2013 ON THE CONDITION THAT FINAL HEALTH APPROVAL OF THE INSTALLATION IS GRANTED PRIOR TO PERMIT EXPIRATION.

ISSUED BY: JEFF WILLIAMS ISSUE DATE: 12/05/12 EXPIRATION DATE: 12/05/13

- NOTE: CONTRACTOR RESPONSIBLE FOR SCHEDULING A PRE-CONSTRUCTION INSPECTION PRIOR TO BEGINNING ANY INSTALLATION
- NOTE: WATERTIGHT SEPTIC TANKS REQUIRED
- NOTE: ALL PARTS OF SEPTIC SYSTEM SHALL BE 100 FEET FROM ANY WATER WELL
- NOTE: MANHOLE RISERS REQUIRED ON ALL SEPTIC TANKS AND PUMP CHAMBERS
- NOTE: AN ELECTRICAL PERMIT IS REQUIRED FOR INSTALLATION OF ANY ELECTRICAL COMPONENTS OF THE SYSTEM

**NEITHER THE HOWARD COUNTY COUNCIL OR THE HEALTH DEPARTMENT IS RESPONSIBLE FOR THE SUCCESSFUL OPERATION OF ANY SYSTEM. PERMITTEE RESPONSIBLE FOR OBTAINING FINAL APPROVAL ON THIS PERMIT. CALL 410-313-1771 FOR INSPECTION OF SEPTIC SYSTEM.**

6501 PRESTWICK DR.

Clerk of the Circuit Court for  
Howard County  
Land Records/Licensing

The Thomas Dorsey Building  
9250 Bendix Road  
Columbia, MD 21045  
410-313-5850

=====  
LR - Agreement Recording Fee  
1x 20.00 20.00

Grantor/Grantee Name: Canapp  
Reference/Control #: 96

LR - Agreement Surcharge  
1x 40.00 40.00

=====  
SubTotal: 60.00  
Total: 60.00

=====  
REV-Cash 60.00

09/12/2014 09:05 CC13-CH  
#3283919 /495/109

~ Thank you for visiting us today ~

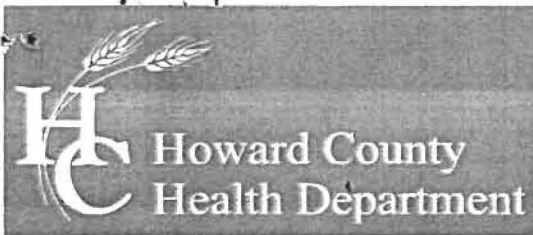

Bureau of Environmental Health  
7178 Columbia Gateway Drive, Columbia, MD 21046-2147  
Main: 410-313-2640 | Fax: 410-313-2648  
TDD 410-313-2323 | Toll Free 1-866-313-6300  
www.hchealth.org  
Facebook: www.facebook.com/hccohealth  
Twitter: HowardCoHealthDep

Maura J. Rossman, M.D., Health Officer

**AGREEMENT FOR APPROVAL OF AN INDIVIDUAL DRINKING WELL WITH AN  
ON-SITE TREATMENT SYSTEM**

This agreement is entered into by and between the Howard County Health Department (“the Health Department”) and SHERMAN AND DEBRA CAWAPP (“the Owner”).

WHEREAS, the Owner owns a tract of land at street address 6501 PRESTWICK DR, CLARKSVILLE MO 21029 and the deed and subdivision plat of the property is recorded among the Land Records of Howard County, Maryland, Tax Map # 34, Block # 9999, Parcel # 0444, Deed Reference # 13871/10096 and Tax Account # 05-593280 (“the Property”).

WHEREAS, the Property lacks an available public drinking water source and is required to have and individual well as the source of drinking water for the residence of the property.

WHEREAS, the Owner has installed a residential drinking well under well permit HO-95-2005 that has been tested by the Health Department (or a private laboratory certified to perform testing) for radionuclide particles. The results of the tests have shown that the gross alpha particle content and/or the gross beta particle content and/or the combined radium 226/228 levels exceeds the standards of 15 picocuries per liter (pCi /L), 4 millirems per year (mrem/yr) and/or 5pCi/L respectively.

WHEREAS, The Maryland Department of the Environment (MDE) has promulgated rules and regulations under which a Certificate of Potability may be issued and has delegated the authority to issue such Certificate to the Health Department.

WHEREAS, MDE regulations permit the Health Department to issue as a special condition, a permanent deviation to the Certificate of Potability for individual wells where treatment has been installed to meet the maximum contaminate levels (MCL's) for radionuclides.

WHEREAS, MDE has determined that radium can be effectively removed from the drinking water by the use of treatment devices (e.g., ion exchange or reverse osmosis).

WHEREAS, the Owner is requesting that the Health Department issue a Certificate of Potability contingent upon installation and maintenance of a water treatment device to reduce radionuclides.

WHEREAS, neither the Owner nor the Health Department has knowledge of an alternative safe source of water for the Property.

NOW THEREFORE, the parties have agreed to the following terms and conditions:

1. The Owner will record this Agreement among the Land Records of Howard County, Maryland and provide confirmation to the Health Dept.
2. The Owner agrees to install and maintain a water treatment device, which effectively reduces the gross alpha, gross beta and radium levels to below their respective MCL. The Health Department shall verify that the treatment device is operating effectively and the Owner agrees to allow access to the Health Department to collect a follow-up sample(s).
3. The Health Department shall issue a Certificate of Potability for the well once follow-up sampling shows acceptable gross alpha, gross beta (short and long term) and radium 226 / 228 levels.
4. The Owner agrees that there shall be no liability on part of the Health Department for any immediate or long term impacts to health or property, under any circumstance or including, but not limited to, treatment device failure, improper maintenance or installation, or defect. The Health Department does not warranty or guarantee that the device will adequately or properly function and the Owner agrees to implement and pay for any necessary changes or corrections.
5. The Owner acknowledges and agrees that neither the Health Department nor any of its agents or employees, either officially or individually, underwrites the operation of any system or treatment device.
6. This Agreement shall not be construed to limit any authority of the Health Department to protect the public health, safety or enjoyment of property or to issue any other orders to take any other action, which is now or may hereafter be within its authority.
7. This agreement contains the entire agreement and understanding between the Health Department and the Owner. There are no additional terms other than as contained in this Agreement. This Agreement may not be modified except in writing signed by each of the parties or their authorized representatives.
8. The Agreement shall run with the land and binds the Owner, his heirs, successors, and assigns. The owner agrees to provide a copy of this agreement to any purchaser or lessee of the property.
9. The laws of the State of Maryland govern the provisions of all transactions.

The parties have signed and sealed this Agreement on the dates set forth below.

Owner

Date

Witness

Date

Owner

Date

Witness

Date

Health Officer

Date

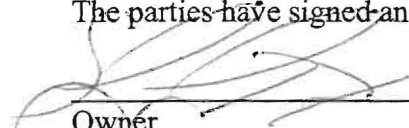
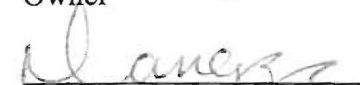
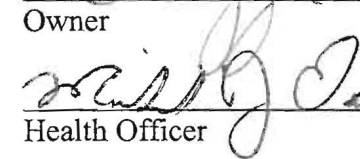
 9/11/2014  
 9/11/2014  
 9/12/14

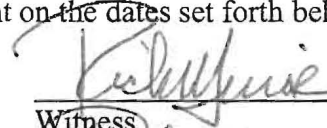
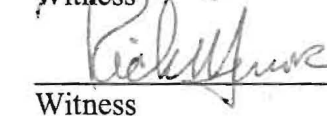
 9-11-14  
 9-11-14



**PERMANENT SEEDING NOTES**

APPLY TO GRADED OR CLEARED AREAS NOT SUBJECT TO IMMEDIATE FURTHER DISTURBANCE WHERE A PERMANENT LONG-LIVED VEGETATIVE COVER IS NEEDED.

**SEEDBED PREPARATION:** Loosen upper three inches of soil by raking, discing or other acceptable means before seeding. If not previously loosened, schedule: Apply 2 tons per acre dolomitic limestone (42 lbs/1000 sq. ft.) and 400 lbs. / acre (20.7 lbs./1000sq. ft.) of 10-20-20 before seeding. Harrow or disc into upper 3 in. of soil.

**SEEDING:** Apply a mixture of Turf Type Tall Fescue (60%) and Hard Fescue (20%) in accordance with seeding dates and rates shown in the Permanent Seeding Summary shown on this sheet. For stabilization outside of the seeding dates, apply straw mulch at rates and methods specified below and apply permanent seeding when within proper seeding dates.

**PLUGGING:** Immediately following seeding, apply a uniform 1-2 in. Deep layer of un-rotted small grain straw at a rate of 2 tons/acre. (Apply 2.5 Tons/acre if a mulch anchoring tool is used.) Straw may be anchored with wood cellulose fiber at a rate of 750 lbs. / acre mixed at a ratio of 50 lbs. of wood fiber/ 100 gal. of water. Synthetic liquid binders such as Terra Tax II, Acrylic DLR (Agra-Tack), DCA-10, Petrosol and other approved equals may be used at rates recommended by the manufacturers.

Permanent Seeding Summary					
Seed Mixture (Hardness Zone 7a and 6b)	Fertilizer Rate (10-20-20)	Lime Rate			
No.	Species	Application Rate (lb/ac)	Seeding Dates	Seeding Depth (in.)	Notes
1	Tall Fescue (60%) Hard Fescue (20%)	120 30	3/1-5/15 8/15-11/15	0.5 in. (2.0in) / (4in) / (1000sq ft)	2 tons/ac (100lb/1000sq ft)

**TEMPORARY SEEDING NOTES**

SEEDBED PREPARATION: Loosen upper three inches of soil by raking, discing or other acceptable means before seeding, if not previously loosened.

**SOIL AMENDMENTS:** In lieu of soil test recommendations, use the following schedule: Apply 2 tons per acre dolomitic limestone (42 lbs/1000 sq. ft.) and 600 lbs. / acre (30 lbs./1000sq. ft.) of 10-10-10 before seeding. Harrow or disc into upper 3 in. of soil.

**SEEDING:** Apply the Maryland State Highway approved seed mixture of Barley or Rye plus Fescue in accordance with seeding dates and rates shown in the Temporary Seeding Summary shown on this sheet. For stabilization outside of the seeding dates, apply straw mulch at rates and methods specified below.

**MULCHING:** Immediately following seeding, apply a uniform 1-2 in. Deep layer of un-rotted small grain straw at a rate of 2 tons/acre. (Apply 2.5 Tons/acre if a mulch anchoring tool is used.) Straw may be anchored with wood cellulose fiber at a rate of 750 lbs. / acre mixed at a ratio of 50 lbs. of wood fiber/ 100 gal. of water. Synthetic liquid binders such as Terra Tax II, Acrylic DLR (Agra-Tack), DCA-10, Petrosol and other approved equals may be used at rates recommended by the manufacturers.

REFER TO THE 1994 MARYLAND STANDARDS AND SPECIFICATIONS FOR SOIL EROSION AND SEDIMENT CONTROL FOR RATE AND METHODS NOT COVERED.

Temporary Seeding Summary					
Seed Mixture (Hardness Zone 6a and 7a)	Fertilizer Rate (10-10-10)	Lime Rate			
No.	Species	Application Rate (lb/ac)	Seeding Dates	Seeding Depth (in.)	Notes
2	Barley or Rye plus Fescue	150 lbs. (3.5lbs/ 1000sq ft)	2/1-11/30 3/15-10/31 (6a)	1/4 in. 1/2 in.	600 lb/ac (15lb/1000sq ft) (100lb/1000sq ft)

**DETAIL 33 - SUPER SILT FENCE**

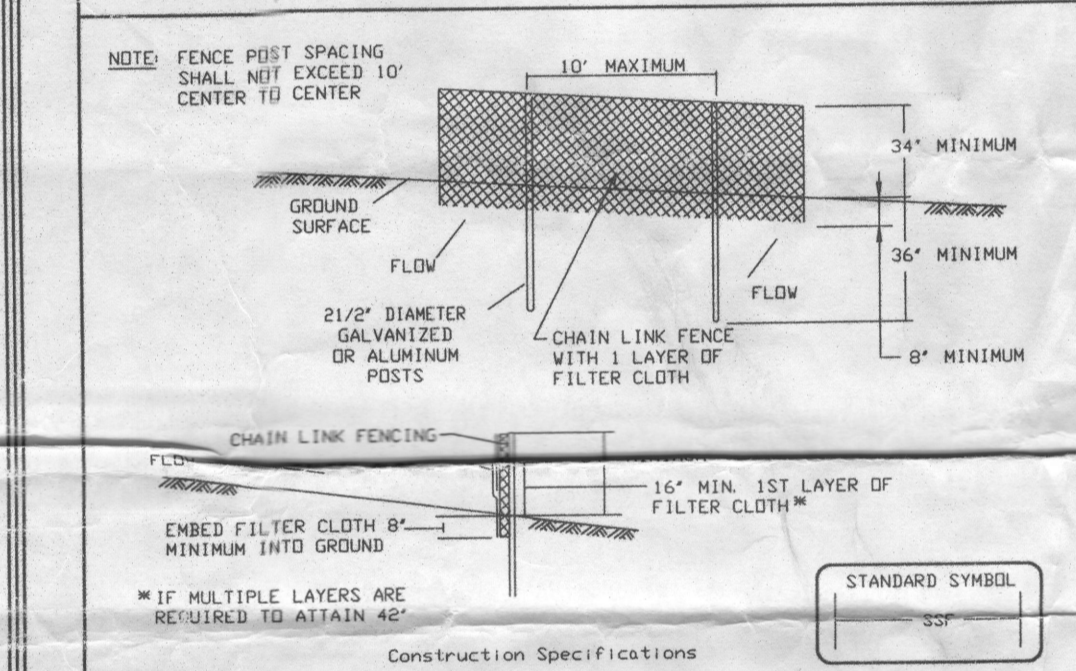

- Fencing shall be 42" in height and constructed in accordance with the latest Maryland State Highway Details for Chain Link Fencing. The specification for a 6' fence shall be used, substituting 42" fabric and 6' length posts.
- Chain link fence shall be fastened securely to the fence posts with wire ties. The lower tension wire, brace and truss rods, drive anchors and post caps are not required except on the ends of the fence.
- Filter cloth shall be fastened securely to the chain link fence with ties spaced every 24" at the top and mid section.
- Filter cloth shall be embedded a minimum of 8" into the ground.
- When two sections of filter cloth adjoin each other, they shall be overlapped by 6" and folded.
- Maintenance shall be performed as needed and silt buildups removed when 'bulges' develop in the silt fence, or when silt reaches 50% of fence height.
- Filter cloth shall be fastened securely to each fence post with wire ties or staples at top and mid section and shall meet the following requirements for Geotextile Class F:

Property	Value	Test Method
Tensile Strength	50 lbs/in (min.)	Test: MSMT 509
Tensile Modulus	20 lbs/in (min.)	Test: MSMT 509
Flow Rate	0.2 gal/177sq/minute (max.)	Test: MSMT 322
Filtering Efficiency	75% (min.)	Test: MSMT 322

**DEVELOPER'S CERTIFICATE**

I/WE CERTIFY THAT ALL DEVELOPMENT AND CONSTRUCTION WILL BE DONE ACCORDING TO THIS PLAN FOR SEDIMENT AND EROSION CONTROL, AND THAT ALL RESPONSIBLE PERSONNEL INVOLVED IN THE CONSTRUCTION OF THE ENVIRONMENT APPROVED TRAINING PROGRAM FOR THE CONTROL OF SEDIMENT AND EROSION BEFORE BEGINNING THE PROJECT. I ALSO AUTHORIZE PERIODIC ON-SITE INSPECTION BY THE HOWARD SOIL CONSERVATION DISTRICT.

*Signature of Developer*  
SIGNATURE OF DEVELOPER DATE 1-2-13

**ENGINEERS CERTIFICATE**

I CERTIFY THAT THIS PLAN FOR SEDIMENT AND EROSION CONTROL REPRESENTS A PRACTICAL AND WORKABLE PLAN BASED ON MY PERSONAL KNOWLEDGE OF THE SITE CONDITIONS AND THAT IT WAS PREPARED IN ACCORDANCE WITH THE REQUIREMENTS OF THE HOWARD SOIL CONSERVATION DISTRICT.

*Signature of Engineer*  
SIGNATURE OF ENGINEER DATE 12/20/12  
ZACHARIA Y. FISCH, P.E.

THIS DEVELOPMENT PLAN IS APPROVED FOR SOIL EROSION AND SEDIMENT CONTROL BY THE HOWARD SOIL CONSERVATION DISTRICT

*Signature of Howard SCD*  
HOWARD SCD DATE 1/13/13

**SEDIMENT CONTROL NOTES**

- A minimum of 48 hours notice must be given to the Howard County Department of Inspection, License and Permits Sediment Control Division prior to the start of any construction (410-313-1855).
- All vegetation and structural practices are to be installed according to the provisions of this plan and one to be in conformance with the 1994 MARYLAND STANDARDS AND SPECIFICATIONS FOR SOIL EROSION AND SEDIMENT CONTROL, and revisions thereto.
- Following initial soil disturbance or redistribution, permanent or temporary stabilization shall be completed within: (a) 7 calendar days for all perimeter sediment control structures, dikes, perimeter slopes, and all slopes greater than 3:1, (b) 14 days as to all other disturbed or graded areas on the project site.
- All sediment traps/basins shown must be finished and warning signs posted around their perimeter in accordance with Vol. 1, Chapter 7, HOWARD COUNTY DESIGN MANUAL, Storm Drainage.
- All disturbed areas must be stabilized within the time period specified above in accordance with the 1994 MARYLAND STANDARDS AND SPECIFICATIONS FOR SOIL EROSION AND SEDIMENT CONTROL for permanent seeding, soil, temporary seeding, and mulching (Sec. G). Temporary stabilization with mulch alone shall be done when recommended seeding dates do not allow for proper germination and establishment of grasses.
- All sediment control structures are to remain in place and are to be maintained in operative condition until permission for their removal has been obtained from the Howard County Sediment Control Inspector.
- Site Analysis:

Property	Value
Total Area	1.328 Acres
Area Disturbed	1.328 Acres
Area to be roofed or paved	0.561 Acres
Area to be vegetatively stabilized	1.304 Acres
Total Cut	500 CY±
Total Fill	500 CY±

- Any sediment control practice which is disturbed by grading activity for placement of utilities must be repaired on the same day of disturbance.
- Additional sediment controls must be provided, if deemed necessary by the Howard County Sediment Control Inspector.
- On all sites with disturbed areas in excess of 2 acres, approval of the inspection agency shall be requested upon completion of installation of perimeter erosion and sediment controls, but before proceeding with any other earth disturbance or grading. Other building or grading inspection approvals may not be authorized until this initial approval by the inspection agency is made.
- Trenches for the construction of utilities is limited to three pipe lengths or that which shall be back-filled and stabilized within one working day, whichever is shorter.
- Earthwork quantities are solely for the purpose of calculating fees. Contractor to verify all quantities prior to the start of construction.
- To be determined by contractor, with pre-approval of the Sediment Control Inspector with an approved and active grading permit.

**DETAIL 24 - STABILIZED CONSTRUCTION ENTRANCE**

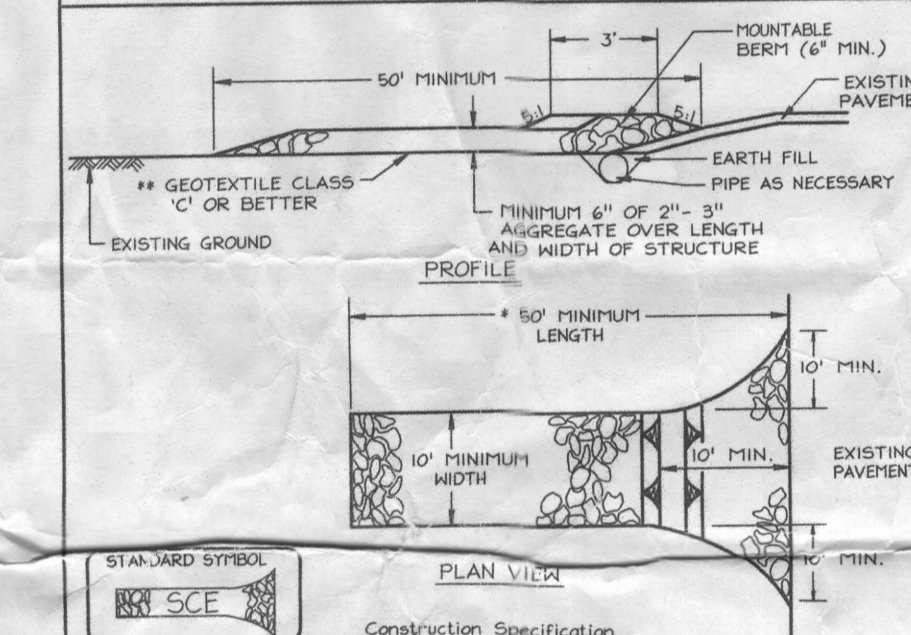

- Length - minimum of 50' (+30' for a single residence lot).
- Width - 10' minimum, should be flared at the entrance road to provide a turning radius.
- Geotextile fabric (filter cloth) shall be placed over the existing ground prior to placing stone. The plan approval authority may not require angle family residences to use geotextile.
- Stone - crushed aggregate (2 1/2" to 3") or reclaimed or recycled concrete equivalent shall be placed at least 6" deep over the top and width of the entrance.
- Surface Water - all surface water flowing to or diverted toward construction entrances shall be piped through the entrance, maintained drainage pipe installed through the stabilized construction entrance shall be protected with a mountable berm with slopes and a minimum of 6" of stone over the pipe. Pipe has to be sized according to the drainage. When the pipe is located at a high spot and has no drainage to convey, a pipe will not be necessary. Pipe should be sized according to the amount of runoff to be conveyed. A 6" minimum will be required.
- Location - A stabilized construction entrance shall be located at every point where construction traffic enters or leaves a construction site. Vehicles leaving the site must travel over the entire length of the stabilized construction entrance.

U.S. DEPARTMENT OF AGRICULTURE SOIL CONSERVATION SERVICE	PAGE F-17-3	MARYLAND DEPARTMENT OF ENVIRONMENT WATER MANAGEMENT ADMINISTRATION
--	-------------	--

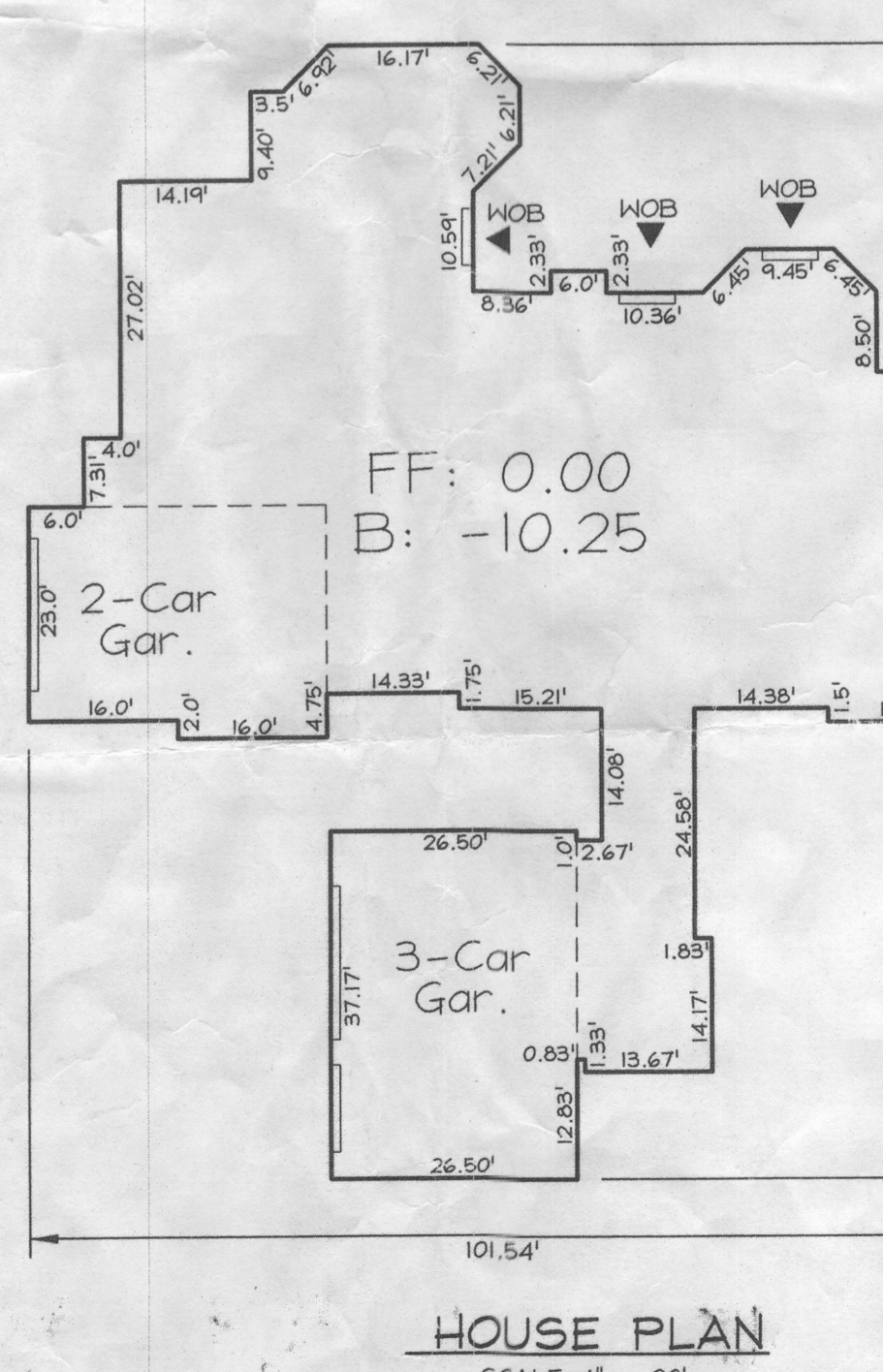

**GENERAL NOTES**

- This property is zoned "RR-DEO" per the 02/02/04 Comprehensive Zoning Plan and the Comp Lite Zoning Regulations Amendments effective 07/28/06.
- Total area of property = 3.579 Ac±
- Private well water and private septic will serve this lot.
- Topography based on a Field Run Topographic Survey prepared by FSH Associates October 2006.
- Storm Water Management for C/P, Rev and HWQ is provided by rooftop and non-roof-top disconnects. Approved under F-10-106.
- The existing well shown on this plan (identified with the attached well tag number: HO-95-2005) has been field located by FSH Associates, Inc on October 26, 2010 and is accurately shown.
- The material from the trenching operation is to be placed on the uphill side of the trench.
- A double row of super silt fence is to be used at the direction of the sediment control inspector.

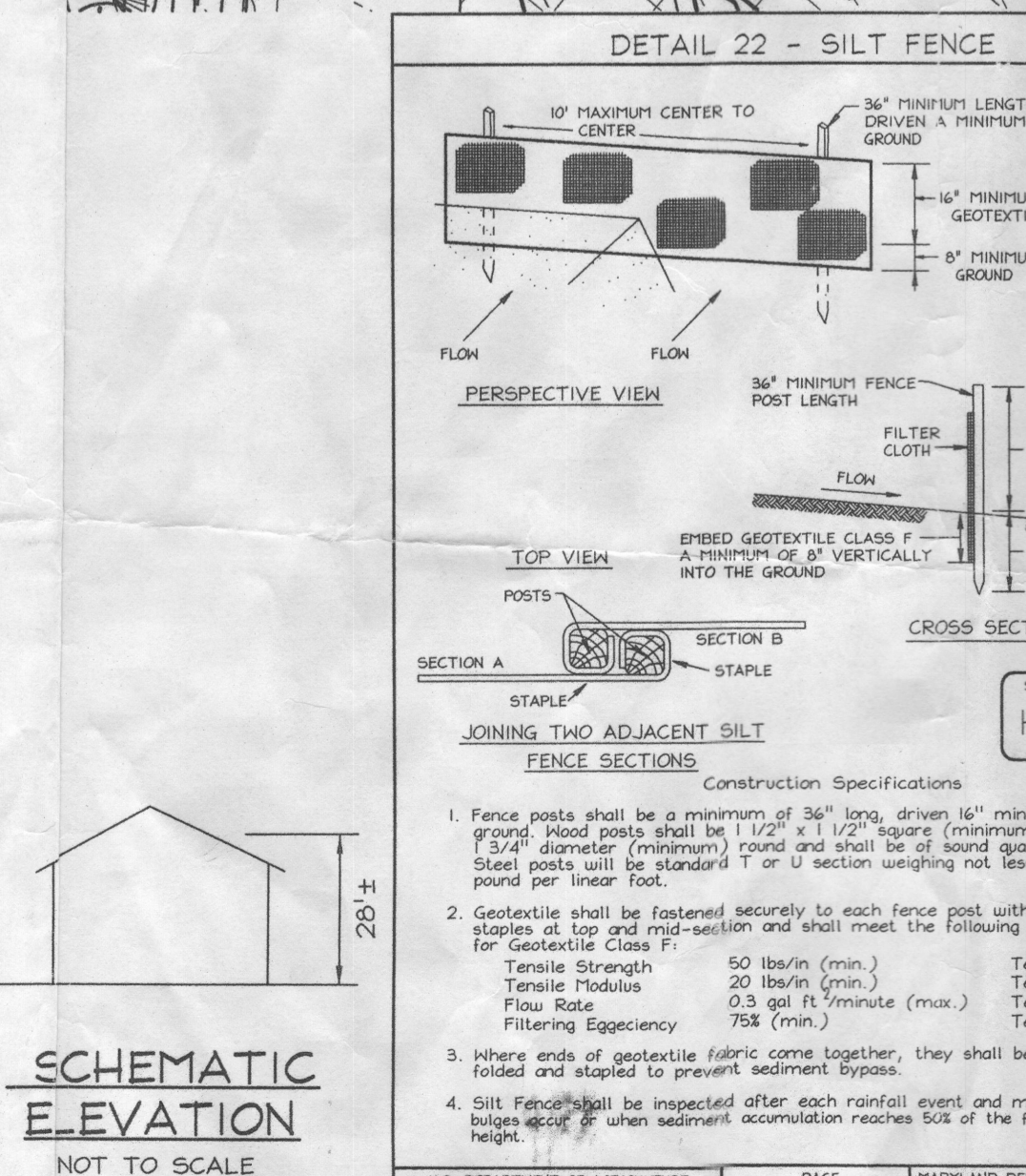

**LEGEND**

- Existing Contour: ---382---
- Proposed Contour: - - - - -82-
- Spot Elevation: +82.53
- Direction of Flow: --->---
- Super Silt Fence: ---SSF---SSF---
- Silt Fence: ---SF---SF---
- Limit of Disturbance: ---LOD---
- Soil Boundary: ---WCB---
- Walk Out Basement: ---WOB---
- Septic Easement: ---SE---
- Rooftop Drainage Disconnect (75'): ---75'---
- SWM Non-Rooftop Disconnect: ---SWM---

**GEODETC CONTROL STATIONS**

Coordinates shown herein are based on NAD 83, Maryland Coordinate System as projected by Howard County. Geodetic Control Stations no. 341A and no. 341B. Denotes approximate location (see vicinity map).

Sta. 341A N 553,271.914 E 1,325,838.75 Elev. 471.88 (NAVD 88)  
Sta. 341B N 554,975.544 E 1,327,076.76

SOILS LEGEND			
SYMBOL	NAME / DESCRIPTION	SOIL GROUP	
Gbb	Gladstone loam, 3 to 8 percent slopes	B	B
Gbc	Gladstone loam, 8 to 15 percent slopes	B	B
Gbd	Gladstone loam, 3 to 8 percent slopes	B	B
Gbe	Gladstone loam, 8 to 15 percent slopes	B	B

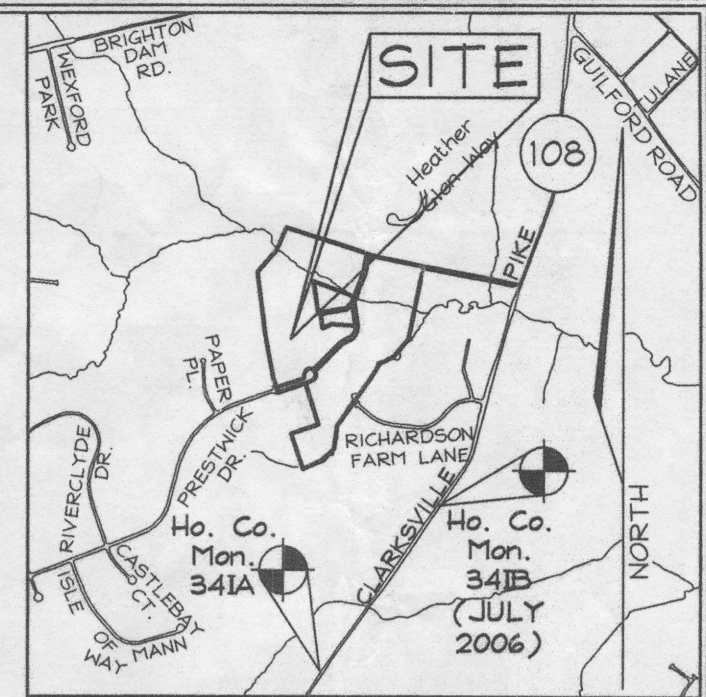

**DETAIL 22 - SILT FENCE**

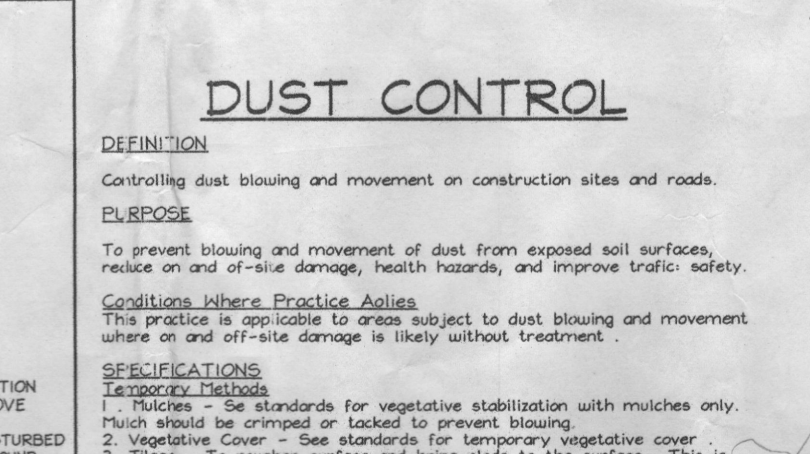

- Fence posts shall be a minimum of 3/4" dia, driven 16" minimum into the ground. Flood posts shall be 1 1/2" x 1 1/2" square (minimum) and, if used, shall be driven 20" into the ground. Steel posts will be standard T or U section weighing not less than 1000 lb/lin ft.
- Geotextile shall be fastened securely to each fence post with wire ties or staples at top and mid-section and shall meet the following requirements for Geotextile Class F:

Property	Value	Test Method
Tensile Strength	50 lbs/in (min.)	Test: MSMT 509
Tensile Modulus	20 lbs/in (min.)	Test: MSMT 509
Flow Rate	0.2 gal/177sq/minute (max.)	Test: MSMT 322
Filtering Efficiency	75% (min.)	Test: MSMT 322

**PLOT PLAN**

SCALE: 1" = 30'



**DUST CONTROL**

- DEFINITION**  
Controlling dust blowing and movement on construction sites and roads.
- EXPOSURE**  
To prevent blowing and movement of dust from exposed soil surfaces, reduce air and off-site damage, health hazards, and improve traffic safety.
- CONDITIONS WHERE PRACTICE APPLIES**  
This practice is applicable to areas subject to dust blowing and movement where on and off-site damage is likely without treatment.
- REQUIREMENTS**
- Vegetative Stabilization - See standards for permanent vegetative cover.
  - Vegetative Cover - See standards for temporary vegetative cover.
  - Wind Erosion Control - See standards for wind erosion control.
  - Water Control - This is generally done as an emergency treatment. Site is sprayed with water until the surface is moist. Rates, as needed, at no time exceed the site being graded to the point that runoff begins to flow.
  - Barriers - Solid board fences, silt fences, snow fences, berms, straw bales, and similar material can be used to control air currents and soil blowing. Barriers placed at right angles to prevailing winds at intervals of about 10 times their height are effective in controlling soil blowing.
  - Construction - Apply at rates that will keep surface moist. May need re-treatment.
- REFERENCES**  
1. Federal Register 34, Wind Erosion Forces in the United States and Their Use in Predicting Soil Loss  
2. ASHRAE Handbook 34, Wind Erosion Forces in the United States and Their Use in Predicting Soil Loss  
3. ASHRAE Handbook 34, Wind Erosion Forces in the United States and Their Use in Predicting Soil Loss

**PROFESSIONAL CERTIFICATE**

I hereby certify that these documents were prepared or approved by me, and that I am a duly licensed professional engineer under the laws of the State of Maryland, License No. 422418, Expiration Date: 07/29/2015.

**OWNER/DEVELOPER**  
GREENFIELD HOMES, Inc.  
6656 Luster Drive  
Highland, Maryland 20777  
410.781.6782

**PLOT PLAN**  
LOT 7  
Plat #21630

TAX MAP 34 GRID 17  
5TH ELECTION DISTRICT

PARCEL 382  
HOWARD COUNTY, MARYLAND

DESIGN BY: CRH2  
DRAWN BY: CRH2  
CHECKED BY: ZTF  
SCALE: 1" = 30'  
DATE: Dec. 28, 2012  
P.L.O. No.: 3199  
SHEET No.: 1 OF 1

**FSH Associates**  
Engineers Planners Surveyors  
6339 Howard Lane, Elkridge, MD 21075  
Tel: 410-567-5200 Fax: 410-796-1562  
E-mail: info@fsh.com

*Signature of Professional Engineer*  
ZACHARIA Y. FISCH, P.E.