

Bureau of Environmental Health
 8930 Stanford Boulevard, Columbia, MD 21045
 Main: 410-313-2640 | Fax: 410-313-2648
 TDD 410-313-2323 | Toll Free 1-866-313-6300
www.hchealth.org
 Facebook: www.facebook.com/hocohealth

Maura J. Rossman, M.D., Health Officer

RECEIPT DATE: 9/18/24 **ONSITE SEWAGE DISPOSAL SYSTEM** P 587810

APPROVAL DATE: 1/29/25 **PERMIT: NEW CONSTRUCTION** A _____

PROPERTY ADDRESS: 11079 Gaither Farm Road

SUBDIVISION: Gaither Farm LOT: 15 TAX ID: _____

CONTRACTOR: Marc D Hereth EMAIL: _____

CONTRACTOR ADDRESS: 2551 Florence Road, Woodbine, MD 21797 PHONE: 301-580-5977

PROPERTY OWNER: Goutam and Arathi Kundu EMAIL: _____

OWNER ADDRESS: 11079 Gaither Farm Road, Ellicott City, MD 21042 PHONE: _____

SEPTIC TANK SIZE (GALLONS): 2000 TANK MANUFACTURER: _____

PUMP MODEL: N/A PUMP SIZE N/A PUMP TANK CAPACITY: N/A

DISTRIBUTION SYSTEM: GRAVITY PRESSURE DOSED BEDROOMS: 6 APPLICATION RATE: 1.2

TRENCHES:	LINEAR FEET REQUIRED: <u>138' (3@46')</u>	INLET DEPTH: <u>4</u>
	TRENCH WIDTH: <u>3</u>	MAXIMUM BOTTOM DEPTH: <u>8</u>
	MINIMUM SPACE BETWEEN TRENCHES: <u>10</u>	EFFECTIVE AREA BEGINNING DEPTH: <u>5.5</u>
LOCATION:		
NOTES:		

ISSUED BY: Zack Silvast ^{H.O.} ISSUE DATE: 11/25/24 EXPIRATION DATE: 11/25/25

- NOTE: CONTRACTOR MUST SCHEDULE A PRE-CONSTRUCTION INSPECTION PRIOR TO BEGINNING ANY INSTALLATION
- NOTE: CONTRACTOR MUST SCHEDULE AN INSPECTION AND GAIN APPROVAL OF ALL COMPONENTS PRIOR TO COVERING
- NOTE: STONE MUST BE APPROVED BY HEALTH DEPARTMENT AND GRAVEL TICKET MUST BE AVAILABLE FOR REVIEW.
- NOTE: WATERTIGHT TANKS REQUIRED
- NOTE: ALL PARTS OF SEPTIC SYSTEM SHALL BE AT LEAST 100 FEET DOWNGRAIENT FROM ANY WATER WELL
- NOTE: MANHOLE RISERS REQUIRED ON ALL SEPTIC TANKS AND PUMP CHAMBERS
- NOTE: AN ELECTRICAL PERMIT IS REQUIRED FOR INSTALLATION OF ANY ELECTRICAL COMPONENTS OF THE SYSTEM
- ELECTRICAL PERMIT ISSUED E N/A
- NOTE: MDE RECOMMENDS SEPTIC TANKS, BAT, AND OTHER PRETREATMENT UNITS BE PUMPED AT A FREQUENCY ADEQUATE TO ENSURE THAT SOLIDS ARE NOT DISCHARGED TO THE DISPOSAL AREA

NEITHER THE HOWARD COUNTY COUNCIL NOR THE HEALTH DEPARTMENT IS RESPONSIBLE FOR THE SUCCESSFUL OPERATION OF ANY SYSTEM. PERMITTEE RESPONSIBLE FOR OBTAINING FINAL APPROVAL ON THIS PERMIT. CALL 410-313-1771 TO SCHEDULE INSPECTIONS.

NOT TO SCALE

12/26/24 Contractor completed the front line. Sch. 40 pipe used. Pipe is bedded with 57 stone. C/O installed 5' from house. Baffles installed in ST. OK to backfill (MB)

TRENCH/DRAINFIELD DATA

WIDTH 3 INLET 4 BOTTOM 8
NUMBER OF TRENCHES 3
TOTAL LENGTH 147'
ABSORPTION AREA 1764 ft²
DISTRIBUTION BOX LEVEL Yes
DISTRIBUTION BOX BAFFLE Yes
DISTRIBUTION BOX PORT Yes

SEPTIC TANK DATA

SEPTIC TANK 1 LEVEL Yes
MANUFACTURER Borden
CAPACITY 1500 GAL
SEAM LOC Top
TANK LID DEPTH 2.5'
BAFFLES 6" Front / 4" Back
BAFFLE FILTER -
MANHOLE LOC Front/Back
6" PORT LOC -
WATERTIGHT TEST -
SLOTTED Yes
DATE ON LID 11-5-24
PUMP/SEPTIC TANK LEVEL N/A
MANUFACTURER -
CAPACITY - GAL
SEAM LOC -
TANK LID DEPTH -
BAFFLES -
BAFFLE FILTER -
MANHOLE LOC -
6" PORT LOC -
WATERTIGHT TEST -
SLOTTED -
DATE ON LID -

See separate sheet for As-Built drawing
ROAD NAME

SEPTIC CONTRACTOR ONSITE INSTALLING SYTEM: Marc Hereth
SEPTIC CONTRACTOR ONSITE LICENSED WITH THE STATE OF MD: YES/NO

PRE-CONSTRUCTION NOTES:

12/19/2024 - Installer onsite for pre-con. things. sewer installed @

diff in front plan. Installer wants to move tank slightly so that's 106 levels in front line & outlet in line with upper septic trench. D-box also moved in front of upper trench. STA & trenches existed, some ft in on site existing trench beginning to move down 9' & end up 13' moved down 5'. Will not impact the existing or to start things.

INSTALLATION NOTES:

12/19/24 Contractor has trench #1 and #2 dug. Trench #2 has been backfilled with the end left open. Top of stone to grade is about 3.5'. Geotextile fabric added and absorption pipe added OK to backfill trench. Trench #1 bottom is per plan. Bottom of pipe is 4'. Contractor will leave front of trench open for tomorrow. Tank will be arriving on Monday at 10am. (MB) 12/20/24 Contractor installed d-box and lines running into trenches. Stoning the back line with 57 stone. Trench 3 has been dug. Top of stone is 3.5'. Geotextile fabric laid. D-box is level and has a baffle. OK to backfill trench 3 and pipe leading to trenches. Contractor to leave d-box open till Monday. Plans to dig the septic tank hole tomorrow (Saturday) (MB) 12/23/24 Contractor has septic tank installed and leveled. Completed back line to d-box bedding the overdig with 57 stone from ST to d-box. D-box is leveled. OK to backfill (MB) 1/29/25 Marc Hereth is now registered with MDE. (MB)

FINAL INSPECTOR

M. Burns

DATE OF APPROVAL

1/29/25

CONTROL PANEL DATA

CONTROL PANEL HEIGHT -
(MIN 30")
INSPECTION DATE -
INSPECTION: PASS/FAIL (CIRCLE ONE)

HO-18-0017

W

11079 Gaither
Farm Rd

11:30

NOT TO SCALE

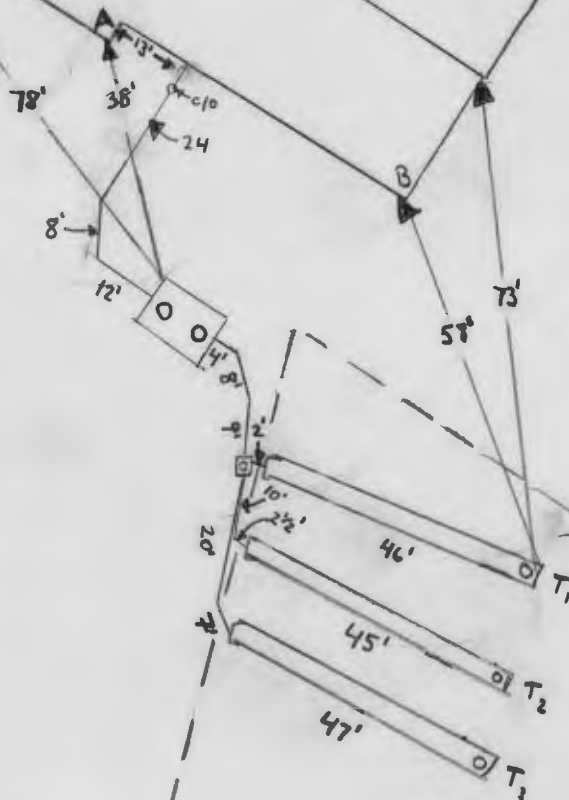

Measurements

D-box - B: 45'

D-box - A: 70'

T₁ beginning - A: 71'

T₁ beginning - B: 43'

Matthew Demmitt

From: Silvast, Zackary <zsilvast@howardcountymd.gov>
Sent: Friday, January 17, 2025 6:13 PM
To: Matthew Demmitt
Cc: Jennifer Wellen; Paul Cavanaugh
Subject: RE: (61807)- 11079 Gaither Farm Road Lot 15 Gaither Farm

Hey Matt,

Everything looks pretty good. Let's make sure we have 10' spacing between the initial system and the 1st replacement system, which means we may have to slide the two replacements downhill. Other than that, should be good to go.

Looking on how everything played out now, I should have had them stop the install that day. I had to make a call while on the phone with my field staff which I thought the right decisions were being made. Next time, I'll consult FCC right away and will recommend a field crew be sent.

The changes, while minor to some extent, were more than I had anticipated. I think both the grading issues and the re-routing of the main septic line we're two things that were out of everyone's control between our two parties.

Please submit paper copies when you're ready. Thanks.

- ZS

From: Matthew Demmitt <mdemmitt@fcc-eng.com>
Sent: Friday, January 17, 2025 3:34 PM
To: Silvast, Zackary <zsilvast@howardcountymd.gov>
Cc: Jennifer Wellen <Jwellen@fcc-eng.com>; Paul Cavanaugh <PaulC@fcc-eng.com>
Subject: (61807)- 11079 Gaither Farm Road Lot 15 Gaither Farm

[Note: This email originated from outside of the organization. Please only click on links or attachments if you know the sender.]

Zack,

Please see the attached pdf with the update to the Redline/as-built of the septic install at 11079 Gaither Farm Road Lot 15. Wanted to send this to you to make sure your good with the changes before submitting a paper copy.

Per your email with Jen Wellen, and the sketch that was provided. We did a best fit to represent your sketch and field adjustments.

In the future if there are any field adjustments that need to be made and want to be show on the plan, if it be helpful we can have a crew out there to location the installed system before it is covered to accurately show its location. Just let us know.

Please let me know what you think and if you good with submitting paper copies?

or if you have any questions?

Thank you

Matthew Demmitt
Fisher, Collins & Carter, Inc.
10272 Baltimore National Pike
Ellicott City, Maryland 21042
Phone: (410) 461-2855
Fax: (410) 750-3784



Silvast, Zackary

From: Silvast, Zackary
Sent: Wednesday, January 15, 2025 3:41 PM
To: Luke Groom
Cc: Wellen, Jennifer; Burns, Matthew; Page, Shepsura
Subject: regarding 11079 Gaither Farm Road (lot 15) septic changes
Attachments: 11079 Gaither Farm Road (Lot 15) as-built.pdf

Good Afternoon,

After reviewing the updated plan, I have decided that the changes that were made out in the field are significant enough and differing from the recently submitted & revised OSDS plan that one more re-draft will be required.

I have attached our as-built drawing per the installation. One key aspect, as you can see, that I found hard to ignore was the fact that the main septic line is coming out of the house at a different location. And I'm surprised the septic contractor did not reach out or provide more accurate details to your engineering firm regarding the tank location changes.

We are asking that the plans align more with the as-built and we will grant approval of the plan once re-submitted. We appreciate your efforts to move this project to the final resolution stages. Thank you.

- ZS

Zack Silvast (LEHS)

Plan Review Supervisor - Water & Sewer Division
410-313-1777

Environmental Health Bureau
Howard County Health Department

Transmittal

Via: Fax Mail Messenger E-Mail To Be Picked Up
 Fax (original to follow via U.S. Mail)

To: Bureau of Environmental Health 8930 Stanford Blvd Columbia, MD 21045	Attn: Zack Silvast Fax: Phone:
---	---

From: Luke A. Groom, P.E.	CC:
----------------------------------	-----

Re: Gaither Farm Lot 15	W.O.# 61807
Date: December 30, 2024	Pages: 5 Page(s) Including this cover

We are forwarding: <input checked="" type="checkbox"/> Prints <input type="checkbox"/> Copy of Letter <input type="checkbox"/> Specifications <input type="checkbox"/> Shop drawings <input type="checkbox"/> Other <input type="checkbox"/> Urgent <input type="checkbox"/> For your use <input type="checkbox"/> As requested <input type="checkbox"/> For Review & Comment
--

Remarks:

Mr. Silvast:

In conjunction with the submission of the above referenced project.

Attached you should find:

3 Sets of Septic Installation Plan with As-built condition reflected base on Health Department field inspection.

Copy of email corrispondance with health.

Please feel free to contact me if you require any additional information.

Regards,

Luke A. Groom, P.E.

CONFIDENTIALITY NOTICE

This transmission contains confidential information which may be legally privileged, and is intended only for the use of the individual named above. If you are not the intended recipient, you are hereby notified that any distribution (except to the intended recipient), copying, or disclosure of this transmission is strictly prohibited.

Matthew Demmitt

From: Silvast, Zackary <zsilvast@howardcountymd.gov>
Sent: Thursday, December 19, 2024 6:00 PM
To: Luke Groom
Cc: Page, Shepsura; Rappaport, Ryan; Burns, Matthew; Matthew Demmitt; Paul Cavanaugh
Subject: RE: 61807 RE: regarding OSDS install at 11079 Gaither Farm Road

Luke,

Those changes look accurate, but the distribution box will be at the start of the first trench. The elevation numbers should change to reflect that in the necessary places on the plans, and the hung sewer should be clearly showing the steeper line and be updated on profile. Hard to see the intended change with just the two very small red dashes. I would try to match up the trench details also with those new elevation points you show on the plan next to the drainfield ends for the initial system.

SO if all that's done, you can re-submit and that should work. Thanks. Let me know if you're in agreeance, and like I stated in the first e-mail I just wanted to keep the project progressing. I think I made the right choice for this particular case as things were minor.

- ZS

From: Luke Groom <L.groom@fcc-eng.com>
Sent: Thursday, December 19, 2024 4:13 PM
To: Silvast, Zackary <zsilvast@howardcountymd.gov>
Cc: Page, Shepsura <spage@howardcountymd.gov>; Rappaport, Ryan <RRappaport@howardcountymd.gov>; Burns, Matthew <mburns@howardcountymd.gov>; Matthew Demmitt <mdeemitt@fcc-eng.com>; Paul Cavanaugh <PaulC@fcc-eng.com>
Subject: 61807 RE: regarding OSDS install at 11079 Gaither Farm Road

[Note: This email originated from outside of the organization. Please only click on links or attachments if you know the sender.]

Zack,

Please let us know if the hand-drawn redline changes in the attached PDF are what you are looking for without any additional field located survey efforts. If so, we can modify the plan in CAD and send in paper copies.

Thanks,
Luke

Luke A. Groom, P.E.
Project Manager
Fisher, Collins and Carter, Inc.
10272 Baltimore National Pike - Ellicott City, MD 21042
Office: 410.461.2855 x555

From: Silvast, Zackary <zsilvast@howardcountymd.gov>
Sent: Thursday, December 19, 2024 10:42 AM
To: Luke Groom <L.groom@fcc-eng.com>
Cc: Page, Shepsura <spage@howardcountymd.gov>; Rappaport, Ryan <RRappaport@howardcountymd.gov>; Burns,

Matthew <mburns@howardcountymd.gov>

Subject: regarding OSDS install at 11079 Gaither Farm Road

Good Morning Luke,

There were some minor changes that occurred with this property now that the OSDS installation has started.

- 1. The main sewer line is no longer coming out of the basement but is now a hung sewer. (septic profile will need to be adjusted)**
- 2. Minor grading occurred at the SDA. (this should NOT have happened)**
- 3. The tank, dbox location, and drainfield lines have been altered to deal with these unforeseen changes.**
 - a. Tank turned slightly to get on contour better.**
 - b. Dbox re-located to be in line with first trench.**
 - c. Drainfield ends closest to dbox are being slid down 9-12 feet to get level with the new contour (caused by disrupted grading)**

All of these changes are very minor and do not negatively impact the replacement systems so I did NOT stop order the installation. We will need a redlined plan submitted ASAP. Contact septic contractor for more details.

Thank you.

- ZS

Zack Silvast (LEHS)

Plan Review Supervisor - Water & Sewer Division

410-313-1777

Environmental Health Bureau

Howard County Health Department