

Menu Refine Search GIS Help My Filters

Showing 1 of 1

<input type="checkbox"/> Permit #	Status	Record Type Alias	Street #	Street Name	Type	Unit Type	Unit #	City
<input type="checkbox"/> B23000762	Review In Process	Residential Interior Alteration Single Family Dwelling Permit	7156	MINK HOLLOW	RD			HIGHLA

Page  of 1

*Online*

Approved Septic System Plan  
 Howard County Health Department  
Dana Benard      3-13-23  
 Signature                                      Date



James Burke  
7150 Northwood Rd  
Highland MD 20777  
4317102

- Poly Injection
- Stone Pier
- Medical equipment enclosure
- Angular Treatment

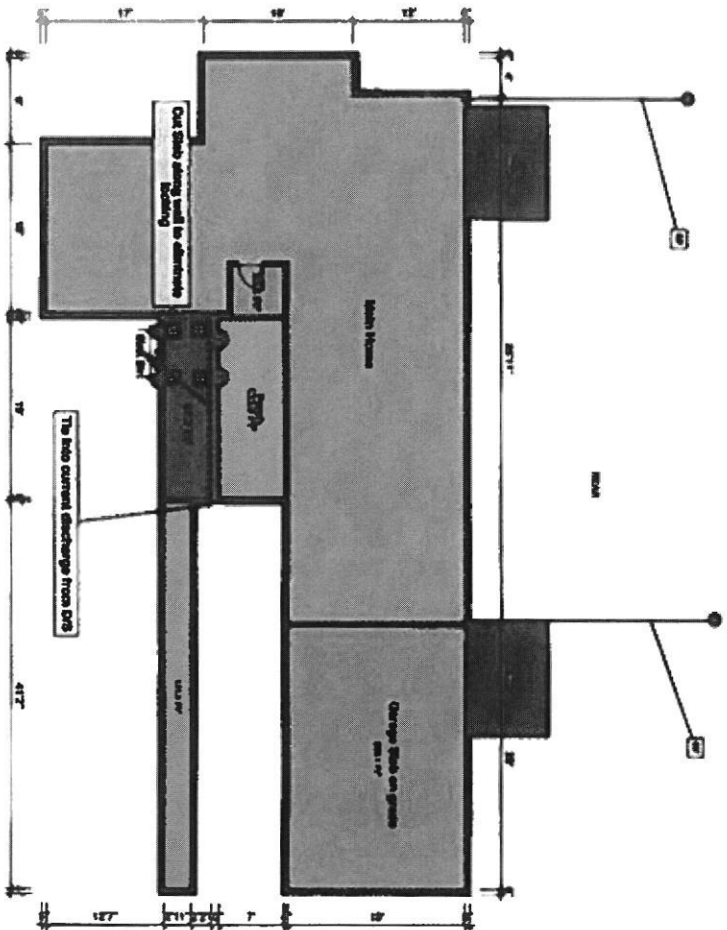

Approved Septic System Plan  
 Howard County Health Department  
 Signature Dana Burnard Date 3-13-23



# BUILDING PERMIT APPLICATION



PERMIT NO:

BLDG DEPT.:   
3430 Court House Drive  
Ellicott City, MD 21044

DATE:  [Report Format Rev. 1/17/18]

JES PROJECT:   
ADDRESS:   
CONTACT INFO:

JES INSP.:  INSP. DATE:

**OVERVIEW:** As requested by the owner/representative of the above referenced project (client), the JES inspector visited the project and performed a visual inspection of readily accessible foundation areas (walls and piers) and associated structural framing elements. Unless noted below, destructive testing and evaluation was not performed. Based on this inspection, the JES inspector and the client agreed to the following "Scope-Of-Work".

**SCOPE-OF-WORK:**  **QUANTITY:**  Each [SEE PLAN - PAGE 2]  
[SEE PRODUCT DETAILS - ATTACHED] **SPACING (Typ):**  Feet [+/-12" Is Allowable]

**GENERAL ISSUE:**   
**PROP. SOLUTION:**

### STRUCTURE DESCRIPTION:

- Classification:  • Year Built:
- Style:
- Stories:
- Construction:  • FEMA Zone:
- Exterior:
- Foundation:

### STRUCTURAL DETAILS (EXISTING):

- Foundation Wall Type:
- Wall Thickness:  - inches
- Wall Height:  - feet NOTE: Wall height might vary due to site grading and footing steps.
- Wall Reinforcement:
- Unbalanced Fill:  - feet NOTE: Fill depth for basement conditions may vary.
- Surcharge Load (On Walls):  plf
- Wall Bracing: [Assume Typ.]
- Loads: [ @ Footing Level ]  
[Based on Typical IRC Load Tables] Walls: [LL + DL]  plf NOTE: Non Load Bearing Wall  
[Add upper wall and point loads] Floor: [LL + DL]  psf NOTE: N/A
- Footing Embedment Depth (Typ.):  - inches (Below Final Exterior Grade)
- Footing Width (Typ.): [Cont. Wall + Isol. Pier]  - in. (Cont.)  - in. (Square)
- Footing Thickness (Typ.): [Cont. Wall + Isol. Pier]  - in. (Cont.)  - in. (Square)
- Footing Reinforcement (Typ.):

### SOIL CONDITIONS:

- Soil Type (USCS):  Coh. (psf):  Phi (°):  Y (pcf):
- Allow. Brg. Capacity:  psf • Shrink-Swell Potential:
- GWT (ft):  • Frost Depth (In):

### SITE CONDITIONS:

- A. Footing Characteristics and Soil Conditions provided by:
- B. Is Site Plan Available (Y/N)?  Gen. Grading & Topo.:



# SITE and LAYOUT PLAN / NOTES

**BUILDING DEPT.:**  
**JES PROJECT:**  
**DATE:**

Howard County Department of Permits
Jamie Burke #431782
February 22, 2023

**GENERAL COMMENTS:**

- 1 -
- 2 -
- 3 -

\*SEE ATTACHED DRAWING



**ADDITIONAL WORK or EXCLUSIONS:**

- Item 1 -
- Item 2 -
- Item 3 -

**JES CONSTRUCTION**  
*Engineered Solutions • Guaranteed Results • Serving the Entire Mid-Atlantic Region*