



**Howard County
Health Department**

Maura J. Rossman, M.D., Health Officer

Bureau of Environmental Health
8930 Stanford Boulevard, Columbia, MD 21045
Main: 410-313-2640 | Fax: 410-313-2648
TDD 410-313-2323 | Toll Free 1-866-313-6300
www.hchealth.org
Facebook: www.facebook.com/hocohealth

RECEIPT DATE: 9/23/24 **ONSITE SEWAGE DISPOSAL SYSTEM** P 587815

APPROVAL DATE: 10/28/2024 **PERMIT: Tank Upgrade** A _____

PROPERTY ADDRESS: 16750 A.E. Mullinix Road

SUBDIVISION: Warfield Limited Partnership LOT: 3 TAX ID: 04-344391

CONTRACTOR: Fogles Septic Clean Inc. EMAIL: john@foglesinc.com

CONTRACTOR ADDRESS: 580 Obrecht Road, Sykesville, MD 21784 PHONE: 410-795-5670

PROPERTY OWNER: Theodore V. Currier EMAIL: slangvardt@gmail.com

OWNER ADDRESS: 16750 A.E. Mullinix Road, Woodbine, MD 21797 PHONE: 443-280-5985

SEPTIC TANK SIZE (GALLONS): Existing (1000 gal) TANK MANUFACTURER: _____

PUMP MODEL: N/A PUMP SIZE N/A PUMP TANK CAPACITY: Existing (1000 gal)

DISTRIBUTION SYSTEM: GRAVITY PRESSURE DOSED BEDROOMS: 4 APPLICATION RATE: 0.8

TRENCHES:	LINEAR FEET REQUIRED: <u>N/A</u>	INLET DEPTH: <u>N/A</u>
	TRENCH WIDTH: <u>N/A</u>	MAXIMUM BOTTOM DEPTH: <u>N/A</u>
	MINIMUM SPACE BETWEEN TRENCHES: <u>N/A</u>	EFFECTIVE AREA BEGINNING DEPTH: <u>N/A</u>
LOCATION:	PER APPROVED SITE PLAN. SEWAGE DISPOSAL AREA AND TANK LOCATIONS MUST BE STAKED BY LICENSED SURVEYOR PRIOR TO PRE-CONSTRUCTION INSPECTION.	
NOTES:	Abandon existing septic tank and install new 1500gal septic tank. Existing 1000gal pump tank to remain. PC Plan to be used as tank upgrade plan.	

ISSUED BY: Hank Oswald ISSUE DATE: 10/1/24 EXPIRATION DATE: 10/1/25

- NOTE: CONTRACTOR MUST SCHEDULE A PRE-CONSTRUCTION INSPECTION PRIOR TO BEGINNING ANY INSTALLATION
- NOTE: CONTRACTOR MUST SCHEDULE AN INSPECTION AND GAIN APPROVAL OF ALL COMPONENTS PRIOR TO COVERING
- NOTE: STONE MUST BE APPROVED BY HEALTH DEPARTMENT AND GRAVEL TICKET MUST BE AVAILABLE FOR REVIEW.
- NOTE: WATERTIGHT TANKS REQUIRED
- NOTE: ALL PARTS OF SEPTIC SYSTEM SHALL BE AT LEAST 100 FEET DOWNGRADIENT FROM ANY WATER WELL
- NOTE: MANHOLE RISERS REQUIRED ON ALL SEPTIC TANKS AND PUMP CHAMBERS
- NOTE: AN ELECTRICAL PERMIT IS REQUIRED FOR INSTALLATION OF ANY ELECTRICAL COMPONENTS OF THE SYSTEM
 ELECTRICAL PERMIT ISSUED E N/A
- NOTE: MDE RECOMMENDS SEPTIC TANKS, BAT, AND OTHER PRETREATMENT UNITS BE PUMPED AT A FREQUENCY ADEQUATE TO ENSURE THAT SOLIDS ARE NOT DISCHARGED TO THE DISPOSAL AREA

**NEITHER THE HOWARD COUNTY COUNCIL NOR THE HEALTH DEPARTMENT IS RESPONSIBLE FOR THE SUCCESSFUL OPERATION OF ANY SYSTEM.
PERMITTEE RESPONSIBLE FOR OBTAINING FINAL APPROVAL ON THIS PERMIT.
CALL 410-313-1771 TO SCHEDULE INSPECTIONS.**

NOT TO SCALE 1" = 50'

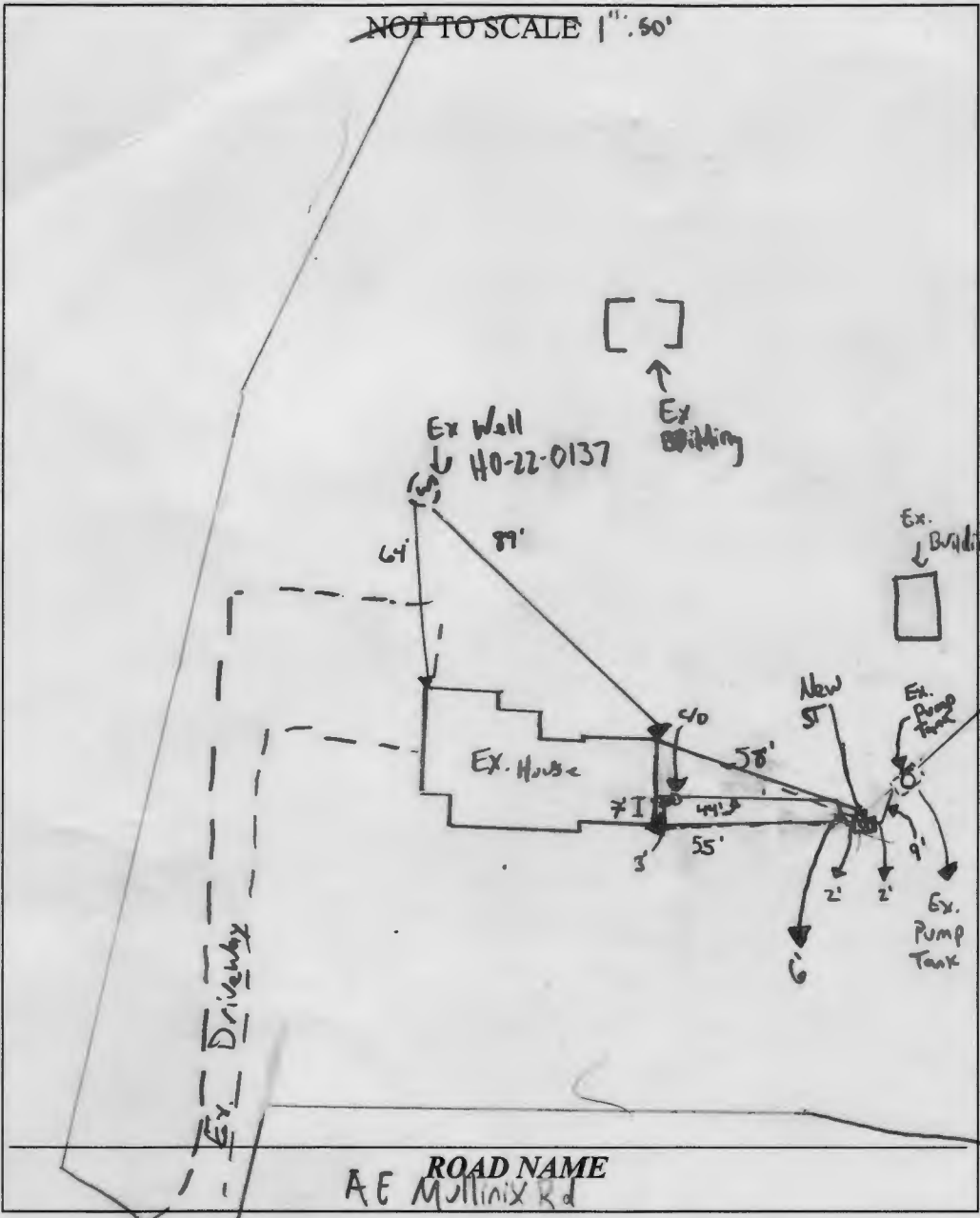

TRENCH/DRAINFIELD DATA		
WIDTH	INLET	BOTTOM
Ex.	Ex.	Ex.
NUMBER OF TRENCHES		Ex
TOTAL LENGTH		
ABSORPTION AREA		
DISTRIBUTION BOX LEVEL		
DISTRIBUTION BOX BAFFLE		
DISTRIBUTION BOX PORT		

SEPTIC TANK DATA	
SEPTIC TANK 1 LEVEL	Yes
MANUFACTURER	Baylon
CAPACITY	1500 GAL
SEAM LOC	Top
TANK LID DEPTH	1 1/2' - 2 1/2'
BAFFLES	6" front / 4" back
BAFFLE FILTER	
MANHOLE LOC	Front / back
6" PORT LOC	Top
WATERTIGHT TEST	
SLOTTED	Yes
DATE ON LID	9/23/24
PUMP/SEPTIC TANK LEVEL Ex	
MANUFACTURER	
CAPACITY	
SEAM LOC	
TANK LID DEPTH	
BAFFLES	
BAFFLE FILTER	
MANHOLE LOC	
6" PORT LOC	
WATERTIGHT TEST	
SLOTTED	
DATE ON LID	

SEPTIC CONTRACTOR ONSITE INSTALLING SYTEM: Ricky Colson, Jr.
 SEPTIC CONTRACTOR ONSITE LICENSED WITH THE STATE OF MD: YES/NO

PRE-CONSTRUCTION NOTES:
10/24/24 Contractor on site. observed effluent level in tank seems to be

lower than normal due to septic tank wall. Effluent level is 4' below baffles. Tank possibly leaking. Contractor
thus to replace the front line orangeburg pipe from the house to the old septic tank. He will also add a clean out.

Old ST will be pumped, crushed, and abandoned. New tank will be installed right next to the old one. Plenty of fall from
 INSTALLATION NOTES: house to ST location. OK to start (MD/RD)

10/25/24 Contractors on site. Old septic tank has been pumped, crushed, and abandoned. Contractor replaced entire
front line with Schedule 40 pipe. Clean out added 4' from house. New septic tank is level and has been
installed next to the abandoned ST. Baffles have been installed. Risers installed. Adequate fall from house to ST to
pump tank. Dirt around pipes has been tamped. Pipes are bedded. OK to backfill. (MD)

CONTROL PANEL DATA	
CONTROL PANEL HEIGHT	(MIN 30")
INSPECTION DATE	
INSPECTION: PASS/FAIL (CIRCLE ONE)	

FINAL INSPECTOR M. Burns DATE OF APPROVAL 10/28/2024