

C 1 **56576** SEQUENCE NO. (MDE USE ONLY)
 1 2 3 6
 (THIS NUMBER IS TO BE PUNCHED IN COLS. 3-6 ON ALL CARDS)
 ST/CO USE ONLY
 DATE Received MM DD YY 01 11 19
 8 13

STATE OF MARYLAND
WELL COMPLETION REPORT
 FILL IN THIS FORM COMPLETELY
 PLEASE TYPE

THIS REPORT MUST BE SUBMITTED WITHIN 45 DAYS AFTER WELL IS COMPLETED.
 COUNTY NUMBER
 PERMIT NO. FROM "PERMIT TO DRILL WELL"
OK 1/16/1950 HO-17-0338
 28 29 30 31 32 33 34 35 36 37

DATE WELL COMPLETED MM DD YY 12-17-18 15 20
 Depth of Well 22 300' 26 (TO NEAREST FOOT)
 OWNER Trinity Homes first name
 WELL SITE ADDRESS Atlanta Lane TOWN Highland
 SUBDIVISION The Estates at River Hill SECTION _____ LOT 14

WELL LOG
 Not required for driven wells

STATE THE KIND OF FORMATIONS PENETRATED, THEIR COLOR, DEPTH, THICKNESS AND IF WATER BEARING

DESCRIPTION (Use additional sheets if needed)	FEET		check if water bearing
	FROM	TO	
Clay	0	15	
Soft brown	15	62	
Grey H/S	62	240	
Fracture	240	242	✓
Grey H/S	242	300	

GROUTING RECORD
 WELL HAS BEEN GROUTED (Circle Appropriate Box) Y N
 TYPE OF GROUTING MATERIAL (Circle one)
 CEMENT CM BENTONITE CLAY BC
 NO. OF BAGS 30 NO. OF POUNDS 2000
 GALLONS OF WATER 180
 DEPTH OF GROUT SEAL (to nearest foot)
 from 0 TOP 48 52 ft. to 77 BOTTOM 54 58 ft.
 (enter 0 if from surface)

CASING RECORD
 casing types insert appropriate code below
 ST STEEL CO CONCRETE
 PL PLASTIC OT OTHER
 MAIN CASING TYPE ST Nominal diameter top (main) casing (nearest inch) 06 Total depth of main casing (nearest foot) 80
 60 61 63 64 66 70

OTHER CASING (if used)
 diameter inch _____ depth (feet) from _____ to _____
 E A C H C A S I N G

SCREEN RECORD
 screen type or open hole (insert appropriate code below)
 ST STEEL BR BRASS HO OPEN HOLE
 PL PLASTIC OT OTHER

NUMBER OF UNSUCCESSFUL WELLS: 0
 WELL HYDROFRACTURED Y N

CIRCLE APPROPRIATE LETTER
 A A WELL WAS ABANDONED AND SEALED WHEN THIS WELL WAS COMPLETED
 E ELECTRIC LOG OBTAINED
 P TEST WELL CONVERTED TO PRODUCTION WELL

I HEREBY CERTIFY THAT THIS WELL HAS BEEN CONSTRUCTED IN ACCORDANCE WITH COMAR 26.04.04 "WELL CONSTRUCTION" AND IN CONFORMANCE WITH ALL CONDITIONS STATED IN THE ABOVE CAPTIONED PERMIT, AND THAT THE INFORMATION PRESENTED HEREIN IS ACCURATE AND COMPLETE TO THE BEST OF MY KNOWLEDGE.

DRILLERS LIC. NO. MSD 224
 DRILLERS SIGNATURE [Signature]
 (MUST MATCH SIGNATURE ON APPLICATION)
 LIC. NO. D

SITE SUPERVISOR (sign. of driller or journeyman responsible for sitework if different from permittee)

C 2 DEPTH (nearest ft.)

T	2				
E	1	<u>HO</u>	<u>80</u>	<u>300</u>	
A	8	9	17	18	17
C	23	24	26	30	32
H					
S	38	39	41	45	47
C					
R	38	39	41	45	47
E					
E					
N					

SLOT SIZE 1 _____ 2 _____ 3 _____
 DIAMETER OF SCREEN _____ (NEAREST INCH)
 56 60
 from _____ to _____

GRAVEL PACK IF WELL DRILLED WAS FLOWING WELL INSERT F IN BOX 68 _____ 68

MDE USE ONLY (NOT TO BE FILLED IN BY DRILLER)
 T _____ (E.R.O.S.) W Q _____
 70 _____ 72 _____ 74 75 76
 TELESCOPE CASING LOG INDICATOR OTHER DATA

C 3
PUMPING TEST
 HOURS PUMPED (nearest hour) 3
 PUMPING RATE (gal. per min.) 8.5
 METHOD USED TO MEASURE PUMPING RATE 1900
 WATER LEVEL (distance from land surface)
 BEFORE PUMPING 28 ft.
 WHEN PUMPING 185 ft.
 TYPE OF PUMP USED (for test)
 A air P piston T turbine
 C centrifugal R rotary O other (describe below)
 J jet S submersible

PUMP INSTALLED
 DRILLER INSTALLED PUMP YES NO
 IF DRILLER INSTALLS PUMP, THIS SECTION MUST BE COMPLETED FOR ALL WELLS.
 TYPE OF PUMP INSTALLED PLACE (A,C,J,P,R,S,T,O) IN BOX 29 29
 CAPACITY: GALLONS PER MINUTE (to nearest gallon) _____ 31 _____ 35
 PUMP HORSE POWER _____ 37 _____ 41
 PUMP COLUMN LENGTH (nearest ft.) _____ 43 _____ 47
 CASING HEIGHT (circle appropriate box and enter casing height)
 + above } LAND SURFACE
 - below } 3 (nearest foot)
 49 50 51

LATITUDE 39.198870
 LONGITUDE 76.959432
 (DEFAULT COORD. WGS 84)

Pursuant to §10-624 of the State Govt. Article of the Maryland Code personal info. requested on this form is used in processing this form pursuant to COMAR 26.04.04. Failure to provide the info. may result in this form not being processed. You have the right to inspect, amend, or correct this form. The Maryland Department of the Environment is subject to the Maryland Public Information Act. This form may be made available on the Internet via MDE's website and is subject to inspection or copying, in whole or in part, by the public and other governmental agencies, if not protected by federal or state law.

Tax: 12/17/2018
GPS: 12/17/2018
110-17-0338
70 fill in this form completely 79

B 1
59736

SEQUENCE NO. (MDE USE ONLY)

STATE OF MARYLAND
APPLICATION FOR PERMIT TO DRILL WELL
please type

STATE PERMIT NUMBER
110-17-0338

OWNER INFORMATION
Date Received (APA) 01/28/18
8 MM DD YY 13
15 Last Name First Name
Trinity Homes
3675 Park Ave Suite 301
36 Street or RFD 55
Ellicott City, Md 21043
57 Town 70 State 72 Zip 76

B 3 LOCATION OF WELL
8 COUNTY 21
Howard
23 SUBDIVISION
The Estates at River Hill
42
SECTION 44 46 LOT 48 50
14
52 NEAREST TOWN
Highland 71

DRILLER INFORMATION
Driller's Name Allen Compton M S D 009
76 License No. 81
Firm Name Foates Well Drilling, LLC
Address P.O. Box 202 Woodbine Md 21797
Signature Date 7-27-18

B 4 SOURCES OF DRILLING WATER
1. Well Water
2.
3.

11 STREET ADDRESS 30
Allnutt Lane
ON WHICH SIDE OF ROAD (CIRCLE APPROPRIATE BOX)
NORTH N
WEST W EAST E
SOUTH S
34 850 37
DISTANCE FROM ROAD FT
ENTER FT OR MI 38 39
TAX MAP: 34 BLK: 23 PARCEL 389

B 2 WELL INFORMATION
1 2
APPROX. PUMPING RATE (GAL. PER MIN.) 5
8 12
AVERAGE DAILY QUANTITY NEEDED (GAL. PER DAY) 500
14 20

USE FOR WATER (CIRCLE APPROPRIATE BOX)
22
 DOMESTIC POTABLE SUPPLY & RESIDENTIAL IRRIGATION
 FARMING (LIVESTOCK WATERING & AGRICULTURAL IRRIGATION)
 INDUSTRIAL, COMMERCIAL, DEWATERING
 PUBLIC WATER SUPPLY WELL
 TEST, OBSERVATION, MONITORING
 OPEN LOOP GEOTHERMAL
 CLOSED LOOP GEOTHERMAL

NOT TO BE FILLED IN BY DRILLER HEALTH DEPARTMENT APPROVAL
Howard 13
COUNTY NAME COUNTY NO.
STATE SIGNATURE INSERT S 41
DATE ISSUED 9/18/18
43 MM DD YY 48
CO SIGNATURE SLCM 9/18/19
EXP. DATE

APPROXIMATE DEPTH OF WELL 300 FEET
24 28
APPROXIMATE DIAMETER OF WELL 6 INCH
NEAREST INCH

PROPOSED LOCATION OF WELL ON LOT
SHOW PERMANENT STRUCTURES SUCH AS BUILDINGS, SEPTIC SYSTEM, ROADS AND/OR LANDMARKS AND INDICATE NOT LESS THAN TWO DISTANCE MEASUREMENTS TO WELL

METHOD OF DRILLING (circle one)
30 BORED (or Augered) JETTED Jetted & DRIVEN
AIR-ROTary AIR-PERCussion ROTARY (Hydraulic Rotary)
31 CABLE REVERSE-ROTary DRIVE-POINT
other

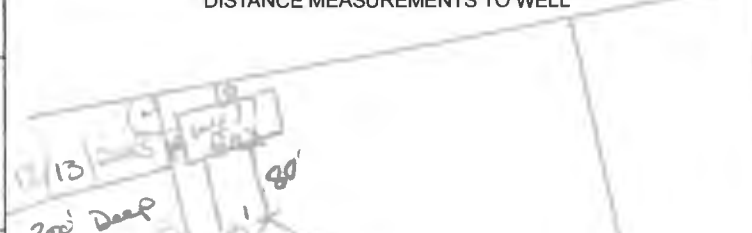

REPLACEMENT OR DEEPEMED WELLS (CIRCLE APPROPRIATE BOX)
39
 THIS WELL WILL NOT REPLACE AN EXISTING WELL
 THIS WELL WILL REPLACE A WELL THAT WILL BE ABANDONED AND SEALED
 THIS WELL WILL REPLACE A WELL THAT WILL BE USED AS A STANDBY-CONTACT LOCAL APPROVING AUTHORITY FOR POLICY ON STANDBY WELLS
 THIS WELL WILL DEEPEM AN EXISTING WELL
PERMIT NUMBER OF WELL TO BE REPLACED OR DEEPEMED (IF AVAILABLE) 41 52

Pursuant to § 10-624 of the State Govt. Article of the Maryland Code, personal info requested on this form is used in processing this form pursuant to COMAR 26.04.04. Failure to provide the info may result in this form not being processed. You have the right to inspect, amend, or correct this form. The Maryland Department of the Environment is subject to the Maryland Public Information Act. This form may be made available on the Internet via MDE's website and is subject to inspection or copying, in whole or in part, by the public and other governmental agencies, if not protected by federal or State Law.

Not to be filled in by driller (MDE OR COUNTY USE ONLY)
APPROP. PERMIT NUMBER H 0 2 0 1 2 G 0 0 5
PERMIT No. H 0 - 1 7 - 0 3 3 8
70 71 72 73 74 75 76 77 78 79

SPECIAL CONDITIONS
NOTE APPROVING AUTHORITIES SHOULD USE SEPARATE SHEET IF NEEDED- SEE ATTACHED MEMO

 WATER WELL ABANDONMENT-SEALING REPORT FORM

SUBMIT COPIES OF COMPLETED FORM TO:

- * COUNTY ENVIRONMENTAL AGENCY (contact MDE, WMA if address needed)
- * WELL OWNER
- * MDE, WATER MANAGEMENT ADMINISTRATION, WELL PROGRAM

APPROVED
 5/7/2019

DATE WELL ABANDONED: 4-9-19 (month/day/year)

* PERMIT NUMBER OF ABANDONED WELL (if any)

HO-73-4317

* PERMIT NUMBER OF REPLACEMENT WELL:

BO-19-0338

* PERSON ABANDONING WELL: Andrew Houseman WELL DRILLER'S LICENSE NUMBER: 224

CIRCLE: MWD (MSD) MGD

* OWNER'S NAME: Trinity Homes

SITE LOCATION MAP

* WELL LOCATION:
 COUNTY: Howard
 NEAREST TOWN: Highland
 TAX MAP 34 BLOCK 23 PARCEL 389
 SUBDIVISION: The Estates at River Hill
 SECTION: _____ LOT: 14
 STREET ADDRESS: Allnut Lane

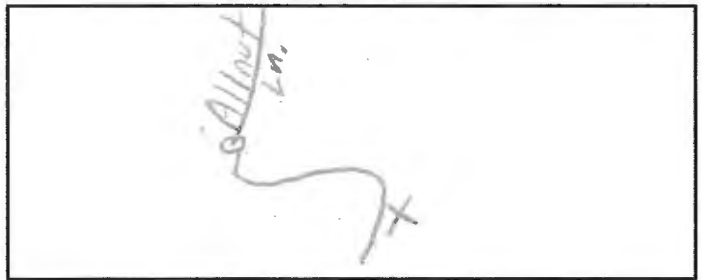

LATITUDE 39.198784

LONGITUDE 76.959873

LOG OF SEALING MATERIAL

MATERIAL	FEET	
	FROM	TO
Bentonite	175	0
VOLUME OF MATERIAL USED		
Bentonite	1800 lbs	(06)

* TYPE OF WELL BEING ABANDONED:
 DRILLED JETTED
 BORED HAND DUG
 OTHER (specify) _____

* USE CODE:
 DOMESTIC MUNICIPAL/PUBLIC
 IRRIGATION INDUSTRIAL
 TEST/OBSERVATION GEOTHERMAL

* TYPE OF CASING:
 STEEL PLASTIC
 CONCRETE OTHER (specify) _____

SIZE OF CASING: 6 INCHES IN DIAMETER

DEPTH OF WELL: 175 FEET DEEP

WAS ANY CASING REMOVED? YES NO
 If yes, length removed, in feet: 5

WAS CASING RIPPED OR PERFORATED? YES NO

SIGNATURE-MASTER WELL DRILLER OR SUPERVISING SANITARIAN LICENSE#

[Handwritten Signature]

224

MWD / MSD / MGS
 CIRCLE ONE

4-9-19

DATE

Pursuant to § 10-624 of the State Govt. Article of the Maryland Code, personal info requested on this form is used in processing this form pursuant to COMAR 26.04.04. Failure to provide the info may result in this form not being processed. You have the right to inspect, amend, or correct this form. The Maryland Department of the Environment is subject to the Maryland Public Information Act. This form may be made available on the Internet via MDE's website and is subject to inspection or copying, in whole or in part, by the public and other governmental agencies, if not protected by federal or State Law.

VERIFIED
 0 25
 H29/BM

CL

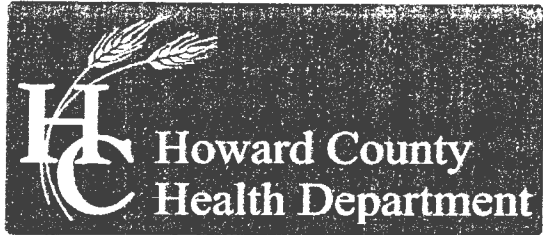

Bureau of Environmental Health

8930 Stanford Boulevard, Columbia, MD 21045 Main: 410-313-2640 | Fax: 410-313-2648 TDD 410-313-2323 | Toll Free 1-866-313-6300 www.hchealth.org

Facebook: www.facebook.com/hocohealth

Twitter: HowardCoHealthDep

Dr. Maura J. Rossman, M.D., Health Officer

TO ALL INTERESTED PARTIES

When submitting a well permit application for a proposed well for new construction, please indicate one of the following:

Well Site Location:

The Estates at River Hill 1-157 Area A - Allinitt Lane
Subdivision/Property Name Lot # Road Name

The well site has been staked by Robert H. Vogel Engineering, Inc.
(professional land surveyor or company employing professional land surveyors)
on _____ (date) and does not require a site inspection.

The well driller, builder or property owner will call the Health Department to schedule a time to meet in the field to verify the proposed well site location.

This sheet, along with two copies of an acceptable well site plan, must be attached to the green well permit application.

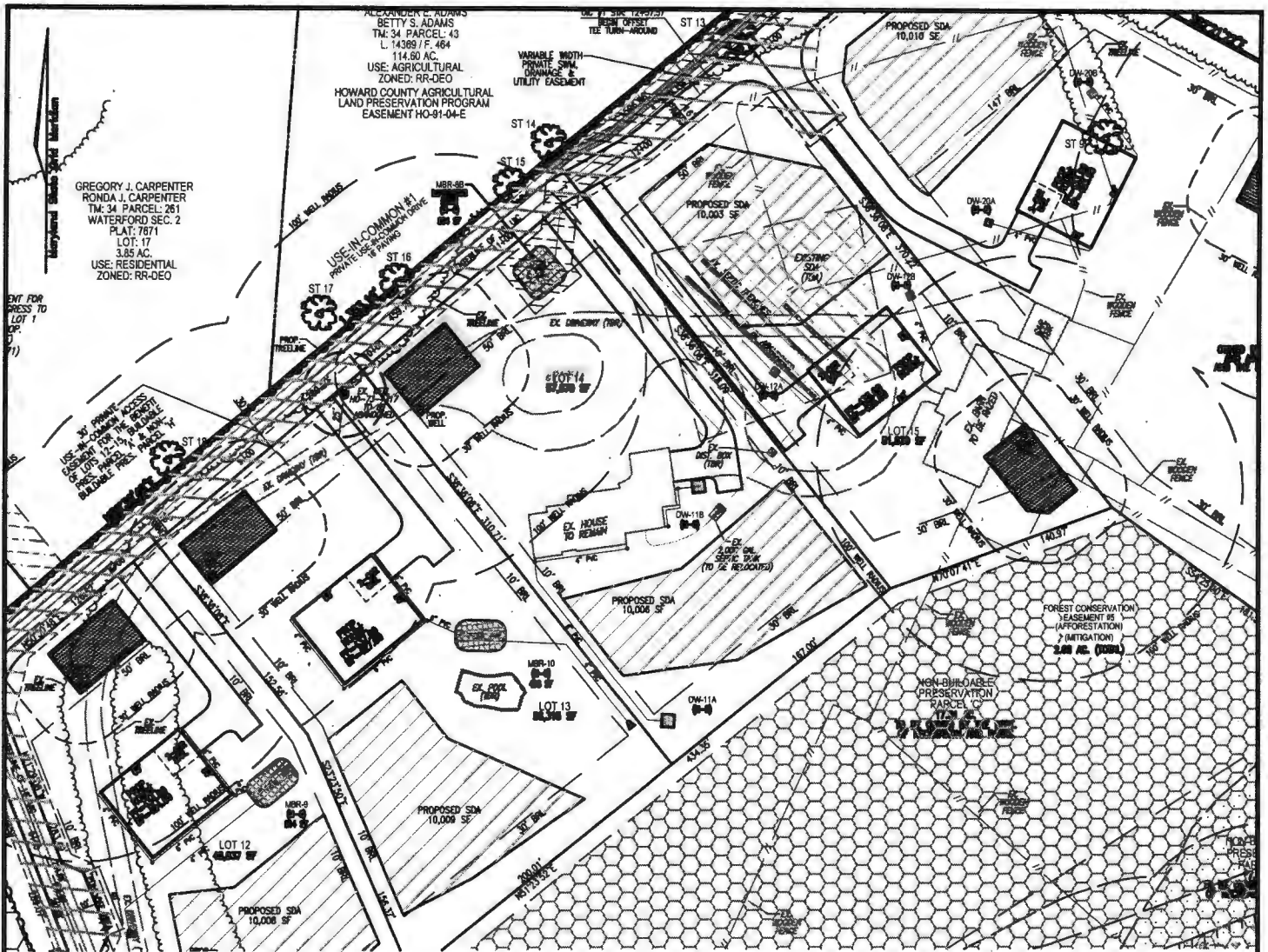

LOT 14 - WELL EXHIBIT



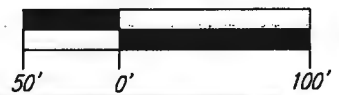

SCALE: 1"=100'

SCALE 1"=100'

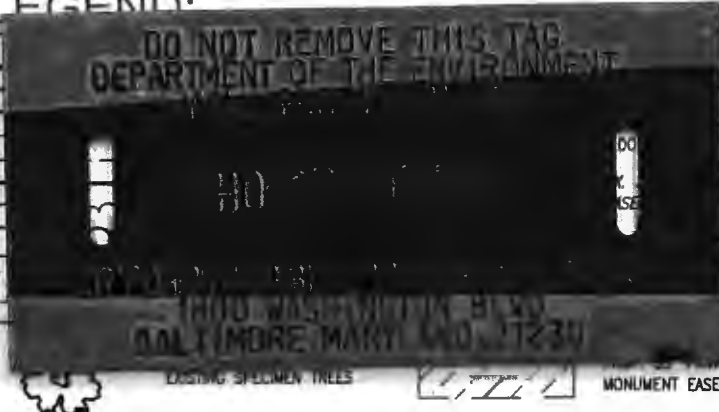

LEGEND:



-  PROP. SEWAGE DISPOSAL AREA
-  PROP. WELL AREA
-  PROP. STORMDRAIN
-  EXISTING WELL
-  PROPOSED WELL

ROBERT H. VOGEL ENGINEERING, INC.
 ENGINEERS • SURVEYORS • PLANNERS
 2300 N. RIDGE ROAD, SUITE 110 TEL: 410.461.7666
 ELICOTT CITY, MD 21043 FAX: 410.461.8961

SCALE: 1"=100'
 DRAWN BY: JMR
 CHECKED BY: RHV
 DATE: JUNE 2018
 W. O. #: 15-39
 SHEET #: 1 OF 1

Well box approved 9/18/18 sc
 Well box staked by Vogel Engineering
WELL EXHIBIT - LOT 14
THE ESTATES AT RIVER HILL
 LOTS 1-15, BUILDABLE PRESERVATION PARCEL 'A'
 AND NON-BUILDABLE PRESERVATION PARCELS 'B-H'
 A RE-SUBDIVISION OF THE "GREENE PROPERTY" LOT 1
 PARCEL: 389
 TAX MAP: 34 GRID: 23
 5TH ELECTION DISTRICT
 ZONED: RR-DEO
 L. 4772 / F. 265
 HOWARD COUNTY, MARYLAND

Maura J. Rossman, M.D., Health Officer

February 7, 2019

Tim Keane
Trinity Homes
3625 Park Avenue
Ellicott City, Maryland 21043

RE: Estates at River Hill Lot 14
Allnutt Lane
Well Tag: HO – 17 – 0338

Dear Mr. Keane:

A sample was collected during a yield test on December 17, 2018 and submitted to the Maryland Department of Health Laboratories to assess the possible presence of **Gross Alpha** and **Gross Beta** in the future well water supply. **Gross Alpha** and **Gross Beta** measure the total alpha and beta particle activity in a water supply. These naturally occurring radioactive nuclides have been demonstrated to be present in a certain type of geologic formation known as the Baltimore Gneiss which exists in your area of development within the County.

Results from this screening revealed a **Gross Alpha** of 10.5 ± 2.3 picocuries/liter (pCi/L), while the **Gross Beta** level was 10.6 ± 2.2 pCi/L. The **Gross Alpha** result was below its **maximum contaminant level (MCL)** of **15 pCi/L**, while the **Gross Beta** level was below its targeted standard of **50 pCi/L** (roughly equivalent to the **annual dose rate** of **4 millirems/year**).

At the time of testing and with respect to these parameters, the well water supply is **within** EPA regulatory standards. Additional testing **for these parameters** will not be required to secure the future Use & Occupancy. Please **note** that other standard testing parameters (bacteria, nitrate, turbidity and sand) will still be needed to help secure Use & Occupancy. Going forward, the property owner may wish to consider follow-up testing to ensure these parameters remain within applicable standards.

A copy of the test results is enclosed for your information. Please call this office at **410-313-1773** if you have any further questions.

Sincerely,



Bert Nixon, Director
Bureau of Environmental Health

✓ Enclosure
cc: Property file

Maura J. Rossman, M.D., Health Officer

MEMORANDUM

TO: Allen Compton (MSD 009)

FROM: Sarah Collins, L.E.H.S. SEC
Howard County Health Department
Well and Septic Program

DATE: September 17, 2018

RE: Well permits for the Estates at River Hill

The following conditions apply to the well permits for the Estates at River Hill:

- A radium sample is required at the yield test for all lots.
- Sodium, chloride, and total dissolved solids samples are required at the yield test for Lots 1, 2, 3, 4, 10, and 11.
- Steel casing to 50' or 10' into competent bedrock, whichever is deeper, is required for Lots 5, 7, and 8.
- Per the Groundwater Appropriations Permit from Maryland Department of the Environment, any well less than 100' from another well AND on a lot less than one acre requires a simultaneous yield test. Lot 10 is the only lot less than one acre; any well less than 100' from Lot 10 requires a simultaneous yield test with the Lot 10 well.

Feel free to contact me at 410-313-6287 or SCollins@howardcountymd.gov with any questions.

Cc: Vogel Engineering, Rob Vogel (rvogel@vogeleng.com)
File

Bricker, Robert

From: Tim Keane <tkeane@trinityhomes.com>
Sent: Monday, February 11, 2019 3:11 PM
To: Bricker, Robert
Subject: RE: Gelber existing residence
Attachments: Address_Chart_The_Estates_at_River_Hill_F_18_064.xlsx; ERH lot 14, Gelber house layout.pdf

[Note: This email originated from outside of the organization. Please only click on links or attachments if you know the sender.]

Hey Robert

Thanks for your patience

Please find attached the house layout for the Gelber House currently located at 13550 Allnutt Lane, However, the NEW address is Lot 14, Estates at River Hill, 13608 Olivia Way. (address chart attached)

The sketch is to scale, incidentally, there were two (2) very small, like nursery rooms, that we are removing the separation wall and making into one (1) small bedroom.

So the house will be like the others in the community, five (5) bedroom, this home has three (3) full baths, and two (2) half baths.

Thanks for your help, looking forward to your feedback.

We will have Freedom Septic of Fogel do the septic install.

Incidentally, Fogel has drill all of the well, they will be connecting the new wells to the new homes, and they will be connecting the new well to the existing house and abandoning the existing well.

I will keep you posted when we get closer to the install date on existing house, but it will be soon, like 30 days. Ok
tim

From: Bricker, Robert <RBricker@howardcountymd.gov>
Sent: Wednesday, February 6, 2019 4:49 PM
To: Tim Keane <tkeane@trinityhomes.com>
Subject: RE: Gelber existing residence

That'll be fine. Have a good evening.

From: Tim Keane <tkeane@trinityhomes.com>
Sent: Wednesday, February 06, 2019 4:40 PM
To: Bricker, Robert <RBricker@howardcountymd.gov>
Subject: Re: Gelber existing residence

[Note: This email originated from outside of the organization. Please only click on links or attachments if you know the sender.]

No, its 2story.

How soon do u need to know.

I was hoping I could get it to you on Monday at the latest