

Menu Save Reset Cancel Help

Record Detail (This section is required.)

Permit Type Building/Residential/Alteration/SFD Permit Number B22000400 Opened Date 02/10/2022

Description of Work  
SFD/ Finish 700 square feet of basement space to include a recreational room, shop, hallway and UNFINISHED utility room

check spelling

*Review Not Required  
In Metro Area  
New Construction  
To Be On Public  
Water + Sewer.  
RAE 2/15/2022*

Address (This section is required.)

Search Reset Clear Get Parcel & Owner

Street # 6168 Street Name PHELPS Street Type LN

Unit Type --Select-- Unit # X Coordinate -76.72479 Y Coordinate 39.19986

City HANOVER State MD Zip Code 21076 Primary Yes

Parcel (This section is required.)

Search Reset Clear Get Address & Owner

GIS ID *	Parcel	Parcel Area	Land Value	Improved Value	Exemption Value	Plan Area
11059523	871	13292	172300	536300	364000	ELKRID

Legal Description  
IMPSLOT 7 13,292 SQ[ ]6168 PHELPS LN[ ]ELKDALE GLENN PROP

check spelling

Block	Lot	Census Tract	Council Dist	Inspection Dist	Supervisor Dist	Map #	DAP Zone
	7	601201	1	6			

Plan Area State Tax Id Subdivision Name  
1401601474 Elkdale Glenn Property

Section Area Tax Map  
38

Grid Zoning District ADC Map  
38-14 R-12 4937-D9

SDP No. Final Plan No. WP File No.  
SDP-19-005 ECP-16-063

Record Plat No. WS Contract No. FDP No. Primary  
24910-2491 Yes

Owner Occupied Year Built Historic District  
 Yes  No 2020  Yes  No

Historic District Registry No. Stat Area Flood Plain  
1-10  Yes  No

Building No

Owner (This section is not required.)

Search Reset Clear

Name \*  
DALESSIO BENJAMIN

Address Line 1  
6168 PHELPS LN

Address Line 2

Address Line 3

Mail City Mail State Mail Zip Code  
HANOVER MD 21076

Phone Primary  
240-285-6007 Yes

E-mail

Cell Number Fax Number

Professionals (This section is not required.)

Search Reset Clear

License # *	Business Name		
08050136804	RJS RENOVATIONS INC		
License Type *	First Name	Middle Name	Last Name
MHIC Co <input type="checkbox"/>	LARNA		STONE
Primary	Address Line 1		
Yes <input type="checkbox"/>	16429 BATSON ROAD		
	Address Line 2		
	City	State	ZIP Code
	SPENCERVILLE	MD	20868
	Phone 1	Phone 2	Fax
	2406780741		
	E-mail		
	RSTONE@RJSRENOVATION.COM		

Applicant (This section is not required.)

Search As Owner As Lic. Prof As Contact

Type *	First Name	MI	Last Name
Applicant <input type="checkbox"/>	LARNA		STONE
Relationship	Full Name		
Applicant <input type="checkbox"/>	LARNA STONE		
Primary	Organization Name		
No <input type="checkbox"/>	RJS RENOVATIONS INC		
	Street Address		
	16429 BATSON ROAD		
	Address Line 2		
	City	State	Zip Code
	SPENCERVILLE	MD	20868
	Phone	Cell	Fax
	2406780741		
	E-mail *		
	RSTONE@RJSRENOVATION.COM		

Contact (This section is not required.)

Search As Owner As Lic. Prof As Contact

Type	First Name	MI	Last Name
Contact <input type="checkbox"/>	ROCKY		STONE
Relationship	Full Name		
Licensed Professional <input type="checkbox"/>	ROCKY STONE		
Primary	Organization Name		
Yes <input type="checkbox"/>	RJS RENOVATIONS INC		
	Street Address		
	16429 BATSON ROAD		
	Address Line 2		
	City	State	Zip Code
	SPENCERVILLE	MD	20868(-9756)
	Phone	Cell	Fax
	240-678-0741		
	E-mail		
	rstone@rjsrenovation.com		

Addtl Info

Est Construction Cost *	Housing Units *	Number of Buildings *	Public Owned
30000	0	0	No <input type="checkbox"/>
Construction Type	--Select--		

RESIDENTIAL ALTERATION INFO

RESIDENTIAL ALTERATION INFORMATION

Total Square Footage *	Bedrooms	Full Baths	Half Baths	Water *	Sewage *	Existing Utilities *
700 SQFT	0	0	0	Public <input type="checkbox"/>	Private <input type="checkbox"/>	Gas & Electric <input type="checkbox"/>
Existing Heating System *	Existing Sprinkler System *	Type of New Fireplace	Expiration Date	Fee Exempt *		
Electric & Natural Gas <input type="checkbox"/>	NFPA #13D <input type="checkbox"/>	--Select--	8/10/2022	<input type="checkbox"/> Yes <input checked="" type="radio"/> No		

PAYMENT INFORMATION

Check 1	Payee 1	Check 2	Payee 2	SAP Doc No	SAP Entered

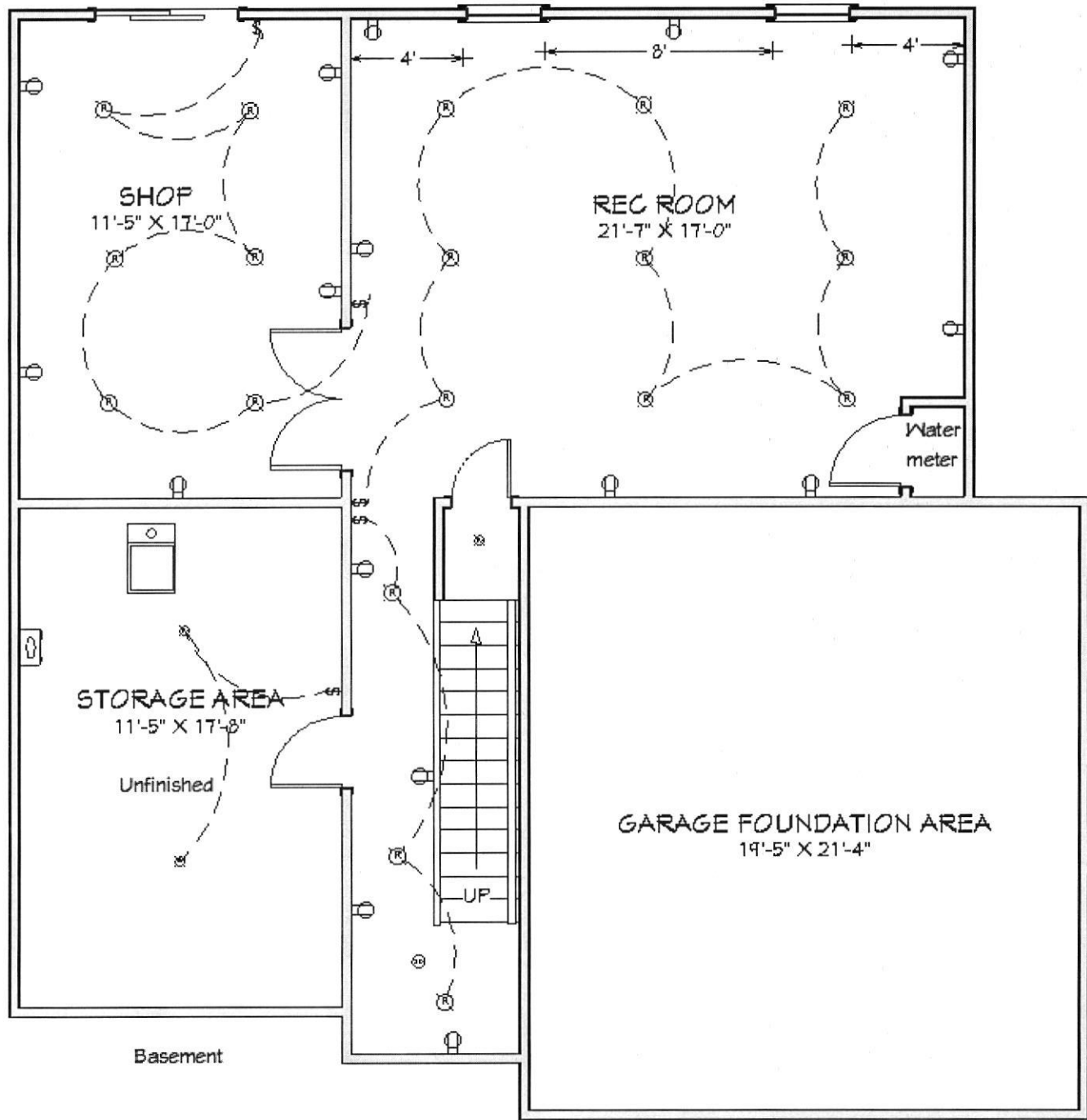

SHOP  
11'-5" X 17'-0"

REC ROOM  
21'-7" X 17'-0"

STORAGE AREA  
11'-5" X 17'-8"

Unfinished

GARAGE FOUNDATION AREA  
19'-5" X 21'-4"

Water  
meter

UP

Basement

View Map		View GroundRent Redemption			View GroundRent Registration				
Special Tax Recapture: None									
Account Identifier:		District - 01 Account Number - 601474							
Owner Information									
Owner Name:		DALESSIO BENJAMIN BEMIS BETHANEE		Use: Principal Residence:		RESIDENTIAL YES			
Mailing Address:		6168 PHELPS LN HANOVER MD 21076-		Deed Reference:		/19158/ 00210			
Location & Structure Information									
Premises Address:		6168 PHELPS LN HANOVER 21076-0000		Legal Description:		LOT 7 13,292 SQ 6168 PHELPS LN ELKDALE GLENN PROP			
Map:	Grid:	Parcel:	Neighborhood:	Subdivision:	Section:	Block:	Lot:	Assessment Year:	Plat No:
0038	0015	0871	1020202.14	2002			7	2021	Plat Ref: 24910-11
Town: None									
Primary Structure Built		Above Grade Living Area		Finished Basement Area		Property Land Area		County Use	
2020		2,192 SF		711 SF		13,292 SF			
Stories	Basement	Type	Exterior	Quality	Full/Half Bath	Garage	Last Notice of Major Improvements		
2	YES	STANDARD UNIT	SIDING/	5	3 full/ 1 half	1 Attached			
Value Information									
		Base Value		Value		Phase-in Assessments			
				As of		As of		As of	
				01/01/2021		07/01/2021		07/01/2022	
Land:		128,200		172,300					
Improvements		331,500		364,000					
Total:		459,700		536,300		485,233		510,767	
Preferential Land:		0		0					
Transfer Information									
Seller: HARMONY BUILDERS INC			Date: 01/31/2020			Price: \$240,000			
Type: ARMS LENGTH VACANT			Deed1: /19158/ 00210			Deed2:			
Seller:			Date:			Price: \$0			
Type:			Deed1: //			Deed2:			
Seller:			Date:			Price:			
Type:			Deed1:			Deed2:			
Exemption Information									
Partial Exempt Assessments:		Class		07/01/2021		07/01/2022			
County:		000		0.00					
State:		000		0.00					
Municipal:		000		0.00 0.00		0.00 0.00			
Special Tax Recapture: None									
Homestead Application Information									
Homestead Application Status: Approved 01/12/2021									
Homeowners' Tax Credit Application Information									
Homeowners' Tax Credit Application Status: No Application									
Date:									

1. This screen allows you to search the Real Property database and display property records.
2. Click [here](#) for a glossary of terms.
3. Deleted accounts can only be selected by Property Account Identifier.
4. The following pages are for information purpose only. The data is not to be used for legal reports or documents. While we have confidence in the accuracy of these records, the Department makes no warranties, expressed or implied, regarding the information.