

**COMPLETE THIS FORM WHEN DROPPING OFF ANY  
CORRESPONDENCE AND/OR PLANS TO THE HOWARD COUNTY  
DEPARTMENT OF INSPECTIONS, LICENSES AND PERMITS COUNTER:**

Date: 2/7/2023  
To: Plan Review  
(Person's Name and Division)  
From: Chris Choi (301) 312-1791  
(Your Name, Company Name and Telephone Number)  
Subject: Project name new shed  
Project site address 14821 Burntwoods rdi, Glenwood, Md. 21738  
Permit # B21003755 SDP # \_\_\_\_\_  
Other information pertinent to this project \_\_\_\_\_

*Approved  
RHC*

✓ Please check the attachments below that you are submitting with this transmittal:

- Letter of response to address plan review comment letter
- Revised plans and/or revised details: When submitting for a complete re-review, **duplicate sets shall be submitted.**
- Letter Summarizing Changes
- Energy conservation calculations
- Copies of \_\_\_\_\_ (be specific).  
 Health Department Request     DPZ/ DED Request     Applicant's Request
- Two sets of single family dwelling model plans to be placed on permanent file: Model name and/or # \_\_\_\_\_
- Other \_\_\_\_\_

*12x24 = 288 sq.*

**Contact Person Information: (Required)**

Chris Choi  
Please Print Name

Telephone No: 301-312-1791

E-Mail Address: cchoi@rocketmail.com

***PLEASE ASSURE ALL DOCUMENTS AND/OR REVISIONS ARE APPROPRIATELY SIGNED AND SEALED, IF NECESSARY, BY A LICENSED ARCHITECT OR ENGINEER. PLEASE BE ADVISED THAT INSUFFICIENT INFORMATION MAY RESULT IN THE DELAY OF REVIEW BY THE PLANS EXAMINER. THE DEPARTMENT OF INSPECTIONS, LICENSES AND PERMITS WILL CONTACT YOU IF THERE IS A PROBLEM. IN ADDITION, ONCE THE BUILDING PERMIT IS APPROVED BY THE PLAN REVIEW DIVISION AND ALL OTHER REQUIRED SIGNATORY AGENCIES, AND THE BUILDING PERMIT IS READY FOR ISSUANCE, THE PERMIT DIVISION WILL NOTIFY THE APPROPRIATE CONTACT PERSON FOR PERMIT PICK UP. ALL PERMIT STATUS INQUIRIES SHALL BE DIRECTED TO THE PERMIT DIVISION AT 410-313-2455. CODE RELATED QUESTIONS AND PLAN REVIEW INQUIRIES SHALL BE DIRECTED TO THE PLAN REVIEW DIVISION AT 410-313-2436. PLEASE ALLOW A MINIMUM OF FIVE (5) WORKING DAYS FOR ANY PLAN SUBMITTALS TO BE REVIEWED. THANK YOU.***

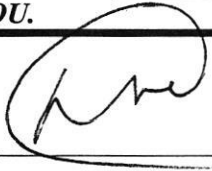
Received by 

**RECEIVED**

FEB 08 2023

LICENSES & PERMITS  
DIVISION

Date: February 7, 2023

Permit# B21003755

Property Owner: Chris Choi

Phone: 301-312-1791

Property address: 14821 Burntwoods rd, Glenwood, MD 21738

Purpose of this letter is to describe the plan change to the original permit# B21003755. Original plan was to build a very large custom Shed/building in the front yard, on a concrete slab, in addition to the existing current shed. The new change will do the following:

1. The new shed will now be replacing the existing current shed, in the same location as the existing current shed. Existing shed will be removed, and new one will go in its place.
2. The new shed will be placed on a gravel pad
3. The new shed is a prebuilt unit that gets delivered and placed.
4. The new shed is purchased and installed by "High Point buildings", company information is,

Company name: High Point Buildings

Web address: [www.highpointbuildings.com](http://www.highpointbuildings.com)

Phone: 888-697-6660

Address: 8651 Baltimore National Pike, Ellicott City, MD, 21043

Signed Owner,

Chris Choi



Feb 7, 2023

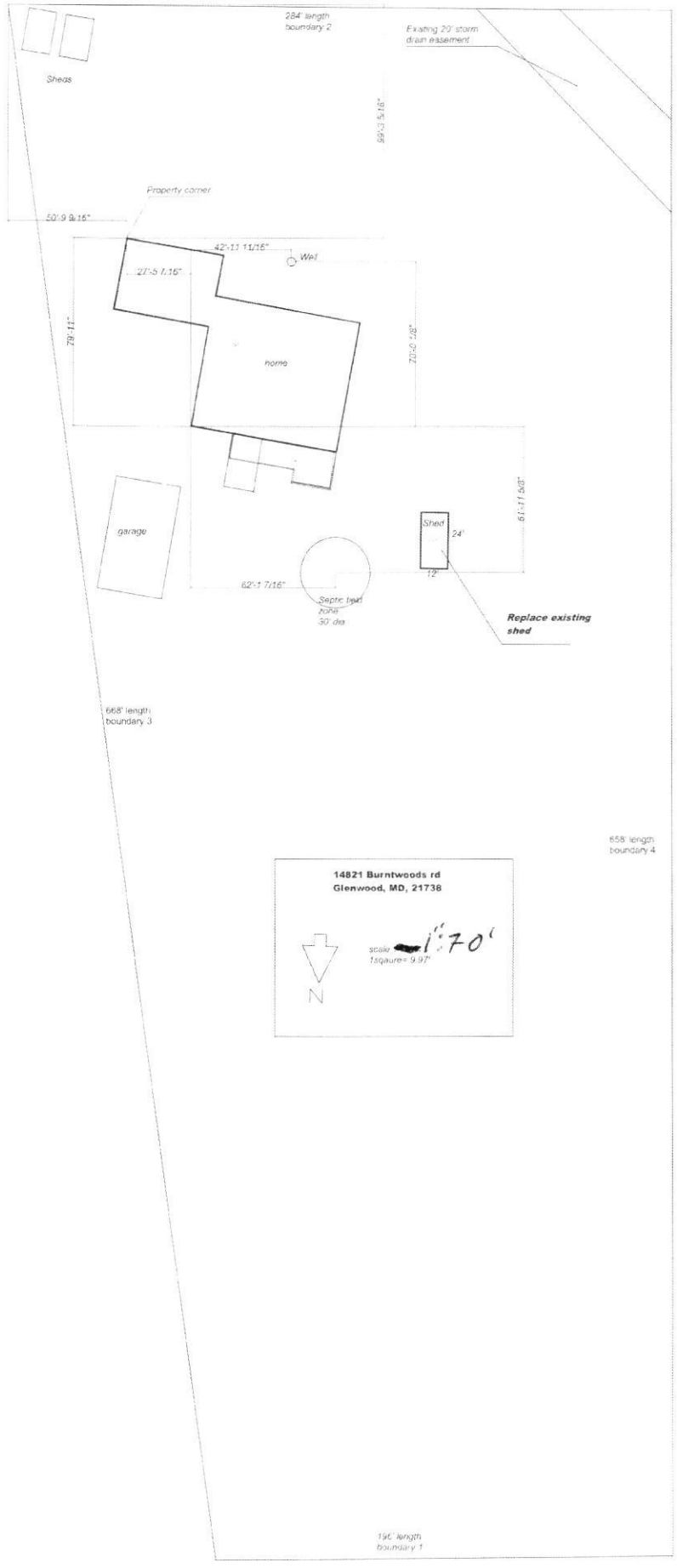

14821 Burntwoods rd  
 Glenwood, MD, 21738

scale 1" = 70'  
 1 square = 9.97'

N

## BARNs

4' Sidewalls

Size	Price	Rent to Own (24 Months)
6x6	\$ 1,922	\$ 123
6x8	2,046	131
8x8	2,261	145
8x10	2,574	165
8x12	2,846	183
8x16	3,308	212
10x10	3,075	197
10x12	3,308	212
10x14	3,548	228
10x16	4,092	263
10x20	4,493	288
12x12	3,758	241
12x16	4,480	287
12x20	5,148	330
12x24	6,188	397

Note: Pricing above assumes unpainted T1-11 exterior walls. See options section for cost to upgrade to a painted unit or vinyl siding. All 6' & 8' wide sheds come with single door. All 10' wide & larger come with double doors.

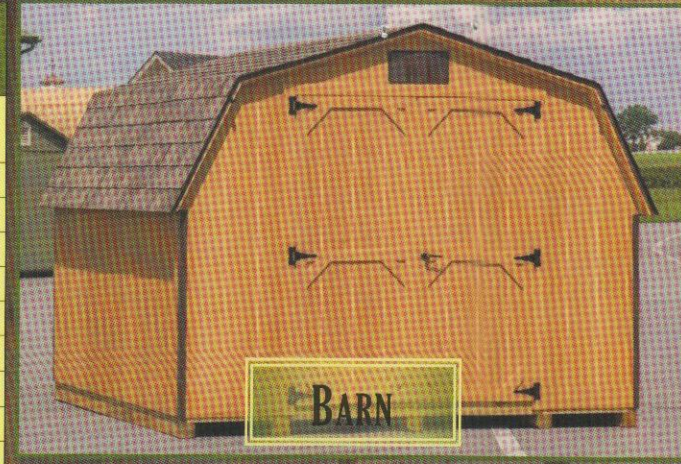

BARN



FREE DELIVERY!

## ESTATE BARNs

6'3" Sidewalls

Size	Price	Rent to Own (24 Months)
6x8	\$ 2,660	\$ 171
6x10	2,975	191
8x8	3,222	207
8x10	3,512	225
8x12	3,836	246
8x16	4,565	293
10x10	3,956	254
10x12	4,203	270
10x14	4,569	293
10x16	4,979	319
10x20	5,729	368
12x12	4,534	291
12x16	5,575	358
12x20	6,274	403
12x24	7,246	465
12x28	8,201	526
12x30	8,525	547
12x32	8,900	571
12x36	9,719	624
14x20	7,843	503
14x24	9,028	579
14x32	11,594	744
14x40	13,631	875

Note: Pricing above assumes unpainted T1-11 exterior walls. See options section for cost to upgrade to a painted unit or vinyl siding. All 6' & 8' wide sheds come with single door. All 10' wide & larger come with double doors.

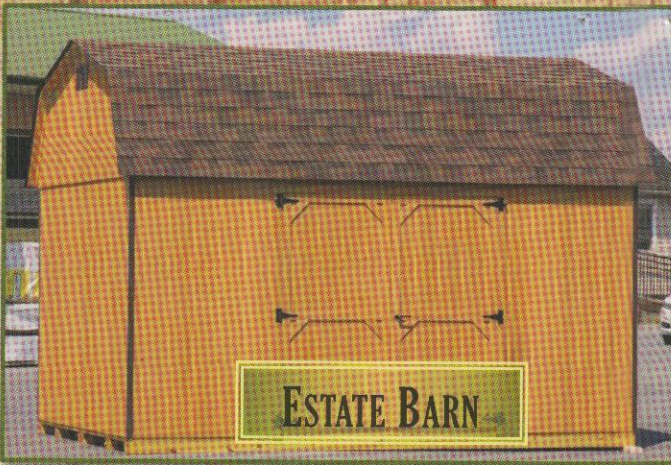

ESTATE BARN



FREE DELIVERY!

## GABLE SHEDs

6'3" Sidewalls

Size	Price	Rent to Own (24 Months)
6x8	\$ 2,293	\$ 147
6x10	2,600	167
8x8	2,737	176
8x10	3,018	194
8x12	3,376	217
8x16	3,922	252
10x10	3,615	232
10x12	3,904	251
10x14	4,254	273
10x16	4,552	292
10x20	5,516	354
12x12	4,126	265
12x16	5,371	345
12x20	6,087	391
12x24	7,161	459
12x28	8,312	533
12x30	8,713	559
12x32	8,994	577
12x36	9,923	637
14x20	7,655	491
14x24	8,687	557
14x32	10,997	706
14x40	13,418	861

Note: Pricing above assumes unpainted T1-11 exterior walls. See options section for cost to upgrade to a painted unit or vinyl siding. All 6' & 8' wide sheds come with single door. All 10' wide & larger come with double doors.

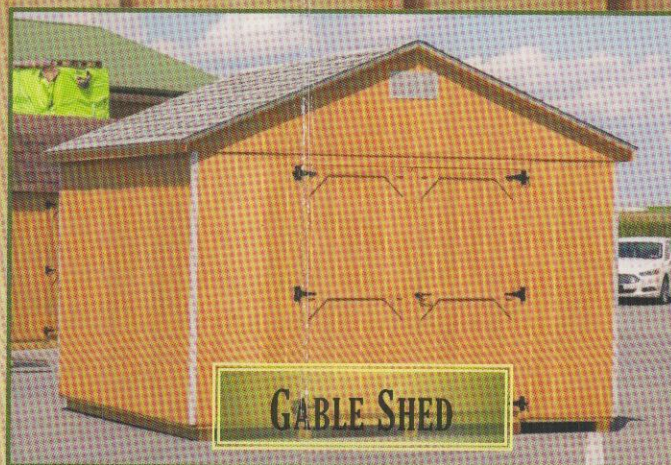

GABLE SHED



FREE DELIVERY!

## LEAN-TO

Size	Price	Rent to Own (24 Months)
4x10	2,457	\$ 158
4x12	2,723	175
6x8	2,520	162
6x10	2,842	182
6x12	3,107	199
6x14	3,493	224
6x16	3,633	233
6x18	3,885	249
8x8	2,891	186
8x10	3,241	208
8x12	3,570	229
8x14	3,824	245
8x16	4,095	263

Note: Pricing above assumes unpainted T1-11 exterior walls. See options section for cost to upgrade to a painted unit or vinyl siding.

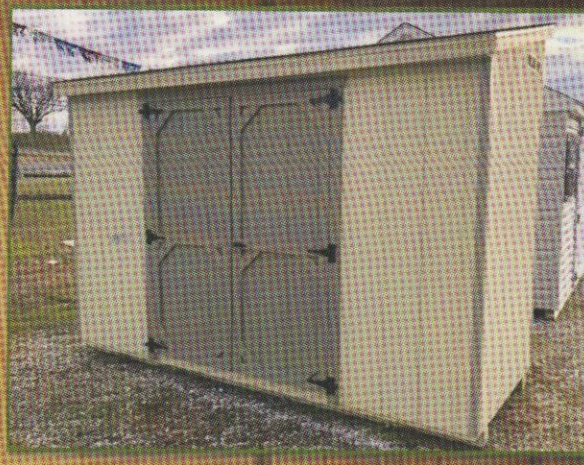

FREE DELIVERY!

## WANT TO CUSTOMIZE YOUR SHED?

### CUSTOM OPTIONS

Quaker Overhang/Hip Roof	See Sales Rep.
New England Trim Package	15% of base
18" x 27" window	\$ 120
2' x 3' window	\$ 150
Shutters/Window Trim	\$ 65
Replace Wood Door with Upgrade Door*	\$ 125
Additional 3' Door (wood)	\$ 190
Additional Double Doors (wood)	\$ 310
Vinyl Siding	See Sales Rep.
Exterior Paint	5% of base
Gable Vent (Wood Shed/Vinyl Shed)	\$30/\$40
Taller Side Walls (Up to 7'8")	15% of base
Metal Roof	20% of base
Pressure Treated Floor	\$1.20/sf
Pressure Treated Joists	\$0.65/sf
Ramp (4'x4', 4'x5' or 5'x5')	\$10/sf
Shelving/Loft	\$8/sq ft
Cupola	\$ 300
Flowerbox	\$ 60

Want vinyl siding instead of T1-11?

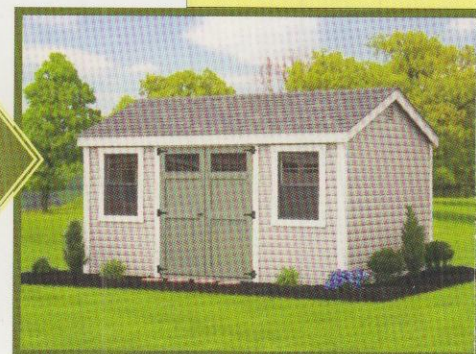

Want N.E. shed doors instead of barn doors?

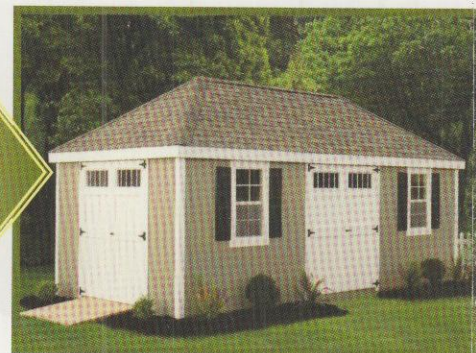

Want doors on the long side? Do it for no extra charge!



Want a painted shed with a ramp?

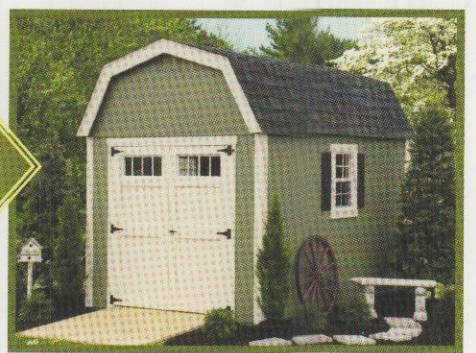

## YOU DECIDE: ROOF & EXTERIOR OPTIONS!

SHINGLE ROOF COLORS (no extra charge, add'l colors available)



METAL ROOF COLORS (add 20% of base price)



VINYL SIDING COLORS (add'l colors available, see chart for pricing)

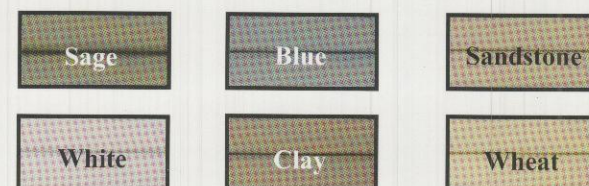

PAINT COLORS (add'l colors available, see chart for pricing)

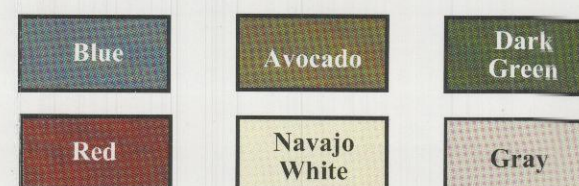

## ADD A PACKAGE TO ANY OF OUR SHEDS!

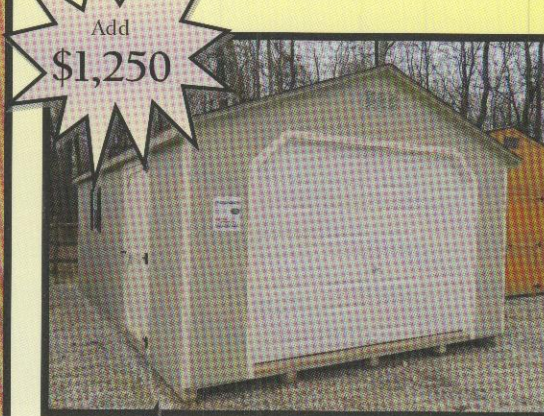

### GARAGE PACKAGE

- Steel 8'x6'6" Garage Door
- 36" Exterior Side Door

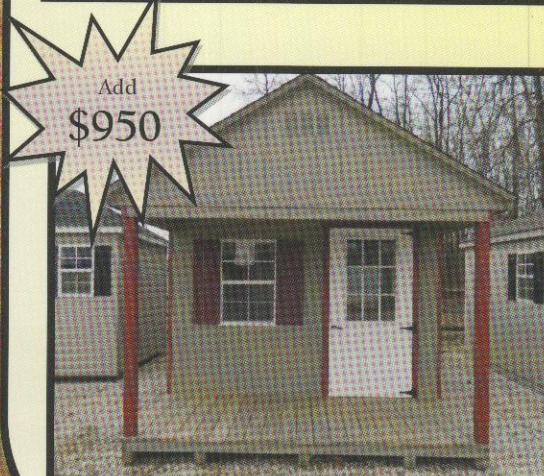

### COVERED PORCH PACKAGE

- 4' Covered Porch
- 9-lite Window Door
- Three 18"x27" Windows

Don't Forget to Ask About Our...  
**RENT-TO-OWN PROGRAM!**

**WHY PAY FOR SELF STORAGE?**

**SHEDS STARTING AT \$123/MONTH**

- **NO CREDIT CHECKS!**
- **A fully refundable deposit of 15% (of the total price) is all you need to take a shed home today.**
- **The rental term is month-to-month. Return your shed at any time with no penalty or cancellation fees.**
- **After only 24 months of rental payments, you own the shed!**

**DELIVERY AND SET-UP**

- ➔ All on-site buildings typically delivered within 7-10 business days of purchase.
- ➔ Custom order purchases delivered in approx. 6-8 weeks (peak season may vary).
- ➔ Delivery is free within 15 miles of one of our locations. Additional charge for longer distances.
- ➔ Need to get rid of an old shed? We can arrange for a contractor to remove your old building for you!

**SITE PREPARATION**

- ➔ No room to bring a shed into your yard? We can build all sheds on-site.
- ➔ You must provide a concrete or gravel pad for our driver to set the shed on. Or....
- ➔ **Don't have the time or money to build a pad?** We can set and level the shed on concrete pavers for only \$120, \$180 or \$225 (price depends on shed size)!
- ➔ Our EZ Mover allows for shed deliveries in tight side yards and back yards.
- ➔ Some sheds may require permits. Check with your local jurisdiction.

**Moving Soon?**

No problem...our sheds can easily be transported!

**I AM INTERESTED IN BUYING A SHED. WHAT IS THE NEXT STEP?**

**STEP 1**

Visit one of our retail locations and see if there are any buildings on site that work for you. If so, purchase or rent the shed and we can typically deliver it to your home within 7-10 business days.



**STEP 2**

If nothing on site works for you, speak with one of the representatives there about designing a shed specifically for you. There is no charge to build a custom shed! You may also use the 3D Custom Designer on our website to design & order the shed!

**STEP 3**

Work with one of our sales representatives to understand all of the available styles and options you have for the design of your custom building.

**STEP 4**

Place your order, and we will deliver the shed in approx. 6-8 weeks (peak season may vary).

**• ALL SHEDS CONSTRUCTED LOCALLY BY AMISH CRAFTSMEN AND DELIVERED TO OUR RETAIL SITES**

Upgraded 5/8" T1-11 and Duratemp sheathing, which provides superior protection against insect and fungus decay.

All 4"x4" skids pressure treated for weather and termite protection.

Floor decking is 5/8" plywood material.

Floor, wall and ceiling joists are 2"x4" studs on 12" or 16" centers, providing excellent structural support.

Architectural shingles with 30-year manufacturer's warranty.

**WARRANTY & GUARANTEE**

- **TWO YEAR STRUCTURAL WARRANTY:** We offer a two year warranty on all materials and workmanship related to any defects with our products.
- **MATERIAL WARRANTY:** T1-11, Duratemp, vinyl siding and architectural shingles all offer manufacturer's warranty of up to 30 years.

*NOTE: All prices & information in this brochure subject to change at any time. High Point Buildings not responsible for permits, setbacks and restrictive covenant searches. Shed widths are approximate and are roofline to roofline.*

**HIGH POINT BUILDINGS**



**Take a Shed Home Today For as Little as \$300!**



**FREE DELIVERY!**

**QUALITY BUILT BY AMISH CRAFTSMEN**



**ASK ABOUT OUR RENT TO OWN PROGRAM • NO CREDIT CHECK**

888.697.6660

www.highpointbuildings.com