

**Bureau of Environmental Health**

8930 Stanford Boulevard, Columbia, MD 21045

Main: 410-313-2640 | Fax: 410-313-2648

TDD 410-313-2323 | Toll Free 1-866-313-6300

[www.hchealth.org](http://www.hchealth.org)

Facebook: [www.facebook.com/hocohealth](https://www.facebook.com/hocohealth)

Twitter: HowardCoHealthDep

---

**Dr. Maura J. Rossman, M.D., Health Officer**

---

October 3, 2024

**MEMORANDUM**

*Sent via email to: [aleo@jmt.com](mailto:aleo@jmt.com)*

**TO:** Adam Leo

**FROM:** Shepsura Page  
Environmental Health Specialist  
Well and Septic Program

**DATE:** 10/3/2024

**RE:** Demo Release  
7751 Mayfield Avenue,  
Elkridge, MD 21075

---

**This is to advise that the Howard County Health Department recommends issuance of a demolition permit for the dwelling on the above referenced property.**

Current utility records show this parcel was connected to public sewer in 1983.

Current utility records show this parcel was connected to public water in 1979.

**If any wells or septic systems are found during site work, please notify this office immediately.**

Sincerely,

A handwritten signature in black ink, appearing to read 'Shepsura Page', is written over a circular stamp.

Shepsura Page  
Environmental Health Specialist  
Howard County Health Department  
Well and Septic Program

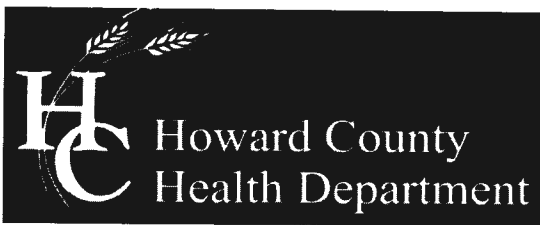

**Bureau of Environmental Health**  
 7178 Columbia Gateway Drive, Columbia, MD 21046-2147  
 Main: 410-313-2640 | Fax: 410-313-2648  
 TDD 410-313-2323 | Toll Free 1-866-313-6300  
 www.hchealth.org  
 Facebook: www.facebook.com/hocohealth  
 Twitter: HowardCoHealthDep

**Maura J. Rossman, M.D., Health Officer**

**DEMOLITION REQUEST FORM**

(Please fill in all blanks)

**Information of Property to be Demolished:**

Howard County Department of Public Works 7751 Mayfield Avenue, Elkridge, MD 21075  
 Current Owner's Name Property Address

P.541  
 Subdivision (if applicable) Lot #

0037 0541  
 All Prior Owners' Names (if requested or known) Tax Map Parcel # Tax ID #

Demo of Howard County DPW 2 salt barns to build new DPW facility. Capital Project No. C-0348-9005.  
 Purpose/Reason for Demolition

Build two (2) prefabricated engineered buildings for Howard County DPW/Highways Department.  
 Future plans of property after demo (i.e. subdivision, parking lot, re-build new house, etc...)

If a subdivision, SDP# \_\_\_\_\_ Has the structure(s) been deemed unsafe by DILP \_\_\_ YES X NO

**UTILITY RECORDS:**

Property currently connected to public water \_\_\_ YES X NO

Property currently connected to public sewer \_\_\_ YES X NO

Does the property currently have any wells and/or septic systems \_\_\_ YES X NO

→Explain:

\*Note: Any wells and/or septic systems that are to remain may require an approved percolation certification plan under *Howard County Code Sec. 3.805*

\*Note: Any septic systems that are to be abandoned must be done by a septic contractor with documentation of the process.

\*Note: All abandoned wells are to be sealed by a well driller licensed by the Maryland State Board of Well Drillers *COMAR Sec 26.04.04.11 Abandonment Standards D (3)*

**COMMENTS:**

This is just for 2 salt barns located at the address above. The address is for the main facility itself.

Adam Leo  
 Applicant's Name (please print)

410-316-2304  
 Applicant's Phone #

aleo@jmt.com  
 Applicant's Email

Applicant's Fax #

Adam Leo  
 Applicant's Signature

10/02/2024  
 Date

Acct. No. 37-06-3000

w/add  
s/add info.

Application No. 2-83-1522 ✓

W & S Contract No.

### Sewer Installation Card

Date Applied 6/10/83

545-S D.2

Date Sewer Acct. 11/16/83

Street	House No.	Lot No.	Block No.	Subdivision
--------	-----------	---------	-----------	-------------

Mayfield Road	7751	Par. 541	--	N/A
---------------	------	----------	----	-----

Type of Property	Town or Vicinity (& ZIP Code)	Applicants Name
Multiple use bldg.	Ellicott City 21043	Howard County D.P.W.

Control No.	Size S.H.C.	Acct. Control
07521	6"	

Type of Installation: Future  Capital Project  Utilities  Dev. Agreement  ADONa

Depth of Sewer *IN Under Conf.*

Length of Conn. from DH MH

Lateral

Plugged  
Sewer Information:

Howard  
Co  
Garage

DRIVE

Fence

Police Gate

Fence

Mayfield



7751 Mayfield

Application No. \_\_\_\_\_  
 Date Applied \_\_\_\_\_  
 Date Water Acct. \_\_\_\_\_

Dev. Agreement  ADO No.

Size Meter

SKETCH

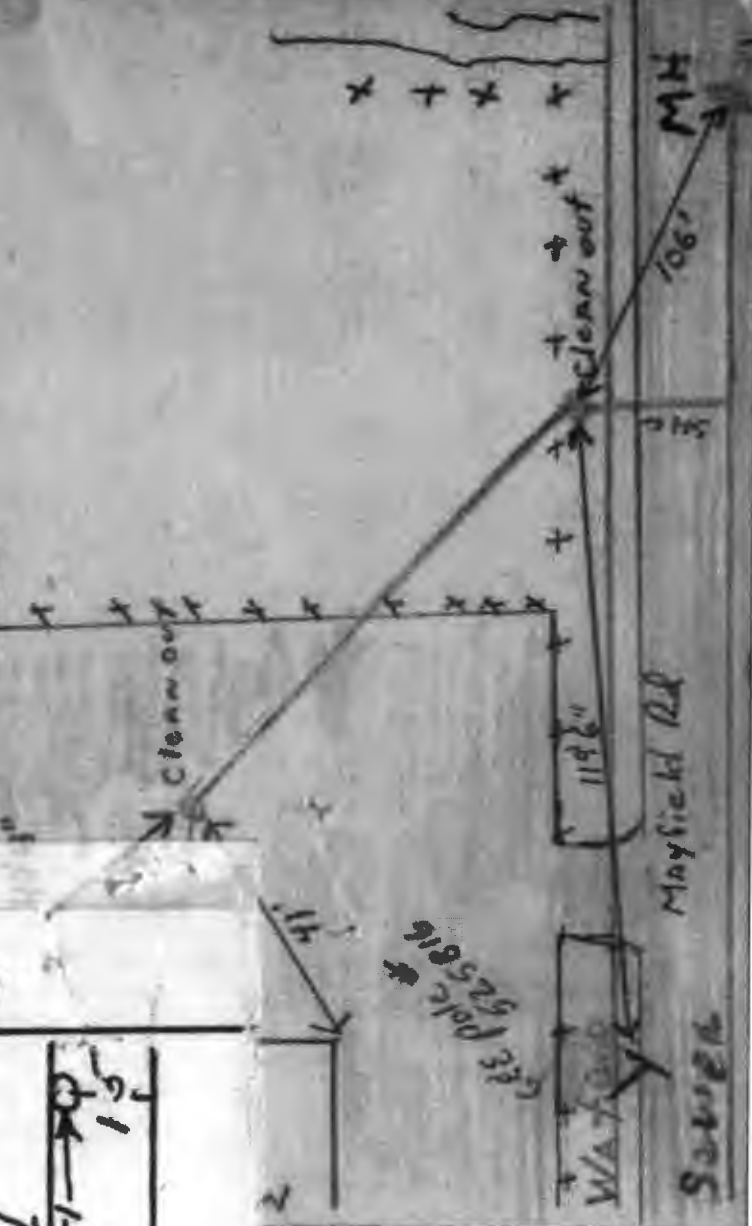

Make \_\_\_\_\_  
 Number \_\_\_\_\_  
 Date of Meter Setting \_\_\_\_\_  
 Meter Location \_\_\_\_\_

WATER & SEWER CONTRACT # 04048

(Start new book, 37-06-3000)

856 W

RECORD OF  
INSTALLATION OF SEWER CONNECTION

Date \_\_\_\_\_  
Installed by \_\_\_\_\_  
Tap Insp. by \_\_\_\_\_ Date \_\_\_\_\_

Street	House No.	Lot No.	Block No.	Subdivision	Permit No.
MAYFIELD AVE.	7751	P. 541	---	---	
Type of Property		District	Town or Vicinity		
MAINTENANCE BLDG.			ELLCOTT CITY		
Applicant		Plumber	Application Filed for		

DATA CONCERNING INSTALLATION

First - Second	On	Double with Lot	DATE CONSTRUCTED	
Single			Started:	Completed:
Depth of sewer invert at property line.....		Diameter and kind of pipe used.....		
.....		Length of connection.....		
.....		.....		
.....		.....		

(See Other Side for Water Connection and Complete Sketch)

DEPARTMENT OF PUBLIC WORKS OF HOWARD COUNTY

BUREAU OF WATER AND SEWER

Date 9/18/79, 19

80-664

Meter Setting	Inside	
	Outside	

CAPITAL PROJECTS FUTURE CONN.

RECORD OF INSTALLATION OF WATER CONNECTION

Installed by \_\_\_\_\_

Applicant <u>BUREAU OF FACILITIES</u>	Plumber	Application Filed For <u>1" MFC</u>	Plumbing Permit No.
--	---------	--	---------------------

DATA CONCERNING INSTALLATION

Single	On	Double with Lot	DATE CONSTRUCTED
			Started: _____ Completed: _____

Date of Tap Installation \_\_\_\_\_  
 Diameter and Kind of Pipe \_\_\_\_\_  
 Length of Connection \_\_\_\_\_  
 Size of Corp. Cock \_\_\_\_\_  
 Meter size, Make and No. { \_\_\_\_\_  
 \_\_\_\_\_  
 Date of Meter Setting \_\_\_\_\_  
 Brief description of Meter Location \_\_\_\_\_

SKETCH

COMPLETION OF OFFICE RECORDS

Meter Card Record \_\_\_\_\_  
 Meter Sheet and Completion Record \_\_\_\_\_  
 Assessment Record \_\_\_\_\_

(See Other Side for Sewer Connection Data)

04048

WATER & SEWER CONTRACT NO.

856-W

FAC - 17  
RECORD OF

INSTALLATION OF SEWER CONNECTION

Date \_\_\_\_\_

Installed by \_\_\_\_\_

Tap Insp. by \_\_\_\_\_ Date \_\_\_\_\_

Street	House No.	Lot No.	Block No.	Subdivision	Permit No.
Mayfield Ave.	7751	P. 541	--	--	
Type of Property		District		Town or Vicinity	
Maintenance Building				Ellicott City	
Applicant		Plumber		Application Filed for	
E.F. Watkins DPW Bureau of Facilities					

DATA CONCERNING INSTALLATION

First - Second	On	Double with Lot	DATE CONSTRUCTED	
Single			Started:	Completed:
Depth of sewer invert at property line _____		Diameter and kind of pipe used _____		
Length of connection _____				

(See Other Side for Water Connection and Complete Sketch)

I-80-258

DEPARTMENT OF PUBLIC WORKS OF HOWARD COUNTY

BUREAU OF WATER AND SEWER

Date 9/18/79, 19

Meter Setting	Inside	
	Outside	

WATER MOUNT SET UP RECORD OF 12/27/79 DATE INITIAL dr

INSTALLATION OF WATER CONNECTION Installed by \_\_\_\_\_

Applicant <u>Bureau of Facilities</u>	Plumber _____	Application Filed For <u>3/4" meter only</u>	Plumbing Permit No. _____
--	------------------	---	------------------------------

DATA CONCERNING INSTALLATION

Single	On	Double with Lot	DATE CONSTRUCTED
			Started: _____ Completed: _____

Date of Tap Installation \_\_\_\_\_

SKETCH

Diameter and Kind of Pipe \_\_\_\_\_

Length of Connection \_\_\_\_\_

Size of Corp. Cock \_\_\_\_\_

Meter size, Make and No. 3/4 Wall Box  
2512436

Date of Meter Setting 7/23/79

Brief description of Meter Location Inside  
wall box on right side of shop area.

COMPLETION OF OFFICE RECORDS

Meter Card Record \_\_\_\_\_

Meter Sheet and Completion Record \_\_\_\_\_

Assessment Record \_\_\_\_\_

(See Other Side for Sewer Connection Data)

Real Property Data Search ( )  
 Search Result for HOWARD COUNTY

[View Map](#)      [View GroundRent Redemption](#)      [View GroundRent Registration](#)

Special Tax Recapture: None

Account Identifier: District - 01 Account Number - 186515

**Owner Information**

Owner Name: HOWARD COUNTY MD      Use: EXEMPT COMMERCIAL  
 DEPT PUBLIC WORKS      Principal Residence: NO  
 Mailing Address: 3430 COURT HOUSE DR      Deed Reference: /20669/ 00222  
 ELLICOTT CITY MD 21043-4300

**Location & Structure Information**

Premises Address: 7751 MAYFIELD AVE      Legal Description: 27.23 A.  
 ELKRIDGE 21075-0000      7751 MAYFIELD AVE  
 ELKRIDGE

Map: Grid: Parcel: Neighborhood: Subdivision: Section: Block: Lot: Assessment Year: Plat No:  
 0037 0015 0541 30000.14 0000 2024 Plat Ref:

Town: None

Primary Structure Built Above Grade Living Area Finished Basement Area Property Land Area County Use  
 1974 8,820 SF 27.2300 AC

StoriesBasementType ExteriorQualityFull/Half BathGarageLast Notice of Major Improvements  
 GOVERNMENT BUILDING/ C4

**Value Information**

	Base Value	Value	Phase-in Assessments	
			As of	As of
Land:	3,252,800	3,422,800	01/01/2024	07/01/2025
Improvements	2,048,400	2,286,400		
Total:	5,301,200	5,709,200	5,437,200	5,573,200
Preferential Land:	0	0		

**Transfer Information**

Seller: BOARD OF COMMISSIONERS HOWARD COUNTY      Date: 06/20/2021      Price: \$0  
 Type: NON-ARMS LENGTH OTHER      Deed1: /20669/ 00222      Deed2:  
 Seller:      Date:      Price: \$0  
 Type: NON-ARMS LENGTH OTHER      Deed1: /00503/ 00457      Deed2:  
 Seller:      Date:      Price:  
 Type:      Deed1:      Deed2:

**Exemption Information**

Partial Exempt Assessments:	Class	07/01/2024	07/01/2025
County:	500	5,437,200.00	5,573,200.00
State:	500	5,437,200.00	5,573,200.00
Municipal:	500	0.00 0.00	0.00 0.00

Special Tax Recapture: None

**Homestead Application Information**

Homestead Application Status: No Application

**Homeowners' Tax Credit Application Information**

Homeowners' Tax Credit Application Status: No Application      Date: