



Bureau of Environmental Health
8930 Stanford Blvd | Columbia, MD 21045
410.313.2640 - Voice/Relay
410.313.2648 - Fax
1.866.313.6300 - Toll Free

1570983

Maura J. Rossman, M.D., Health Officer

APPLICATION

FOR PERCOLATION TESTING AND SITE EVALUATION

PROPERTY LOCATION

SUBDIVISION/PROPERTY NAME Corina Court Property

PROPERTY ADDRESS 6626 Corina Court, Columbia MD 21044
STREET TOWN ZIP

TAX ACCOUNT # 05-392667 TAX MAP 35 GRID 23 PARCEL 113 LOT NO. 5 PROPOSED LOT SIZE (ACRES) 3.009

ZONING CATEGORY R-20 TIER

PROPERTY OWNER(S) Mike Mosman

DAYTIME PHONE 410-336-0803 CELL EMAIL mikemosman@aol.com

MAILING ADDRESS 7614 Sweet Hours Way, Columbia MD 21046
STREET CITY, STATE ZIP

APPLICANT Taylor Bielski RELATIONSHIP TO OWNER: Engineering Consultant

DAYTIME PHONE 443-325-5076 ext. 106 CELL 443-821-2021 EMAIL taylor@sillengineering.com

MAILING ADDRESS 16005 Frederick Road, Woodbine MD 21797
STREET CITY, STATE ZIP

I HEREBY APPLY FOR THE NECESSARY TESTING/EVALUATION PRIOR TO ISSUANCE OF SEWAGE DISPOSAL SYSTEM PERMIT(S):

PROPERTY:

- SUBDIVISION: NUMBER OF LOTS INCLUDING RESIDUE: SUBDIVISION CLASSIFICATION (PER DEPT. OF PLANNING AND ZONING) MAJOR MINOR
CONSTRUCT NEW OSDS ON UNDEVELOPED LOT
REPAIR OR REPLACE FAILING OSDS
UPGRADE EXISTING OSDS

BUILDING:

- RESIDENTIAL WITH 3 EXISTING OR PROPOSED BEDROOMS IN THE COMPLETED STRUCTURE
COMMERCIAL (PROVIDE DETAIL OF TYPE OF USE AND NUMBERS OF EMPLOYEES/CUSTOMERS ON ACCOMPANYING PLAN)

IS THE PROPERTY WITHIN 2500 FEET OF ANY RESERVOIR?

- YES
NO

AS APPLICANT, I UNDERSTAND THE FOLLOWING:

- THIS APPLICATION IS VALID FOR TWO(2) YEARS FROM DATE OF FEE PAYMENT AND APPROVAL IS BASED UPON HEALTH OFFICER SIGNATURE OF A PERC CERTIFICATION PLAN PRIOR TO EXPIRATION OF THIS PERMIT.
THE APPLICATION FEE IS NON-REFUNDABLE
THIS APPLICATION MUST BE ACCOMPANIED BY ALL APPLICABLE FEES AND A SUITABLE SITE PLAN IN ORDER TO BE PROCESSED
THIS IS A PUBLIC DOCUMENT

I declare and affirm that to the best of my knowledge, the information contained herein is correct. I declare that I am the owner of the property or duly authorized to make this application on behalf of the owner. I agree to comply with all applicable state and county regulations.

By signature of this application, I hereby grant Howard County Health Department officials the right to enter onto the property for the purpose of inspecting the property as directly related to the requested permit/service.

Taylor Bielski

03/03/2022

SIGNATURE OF APPLICANT

DATE

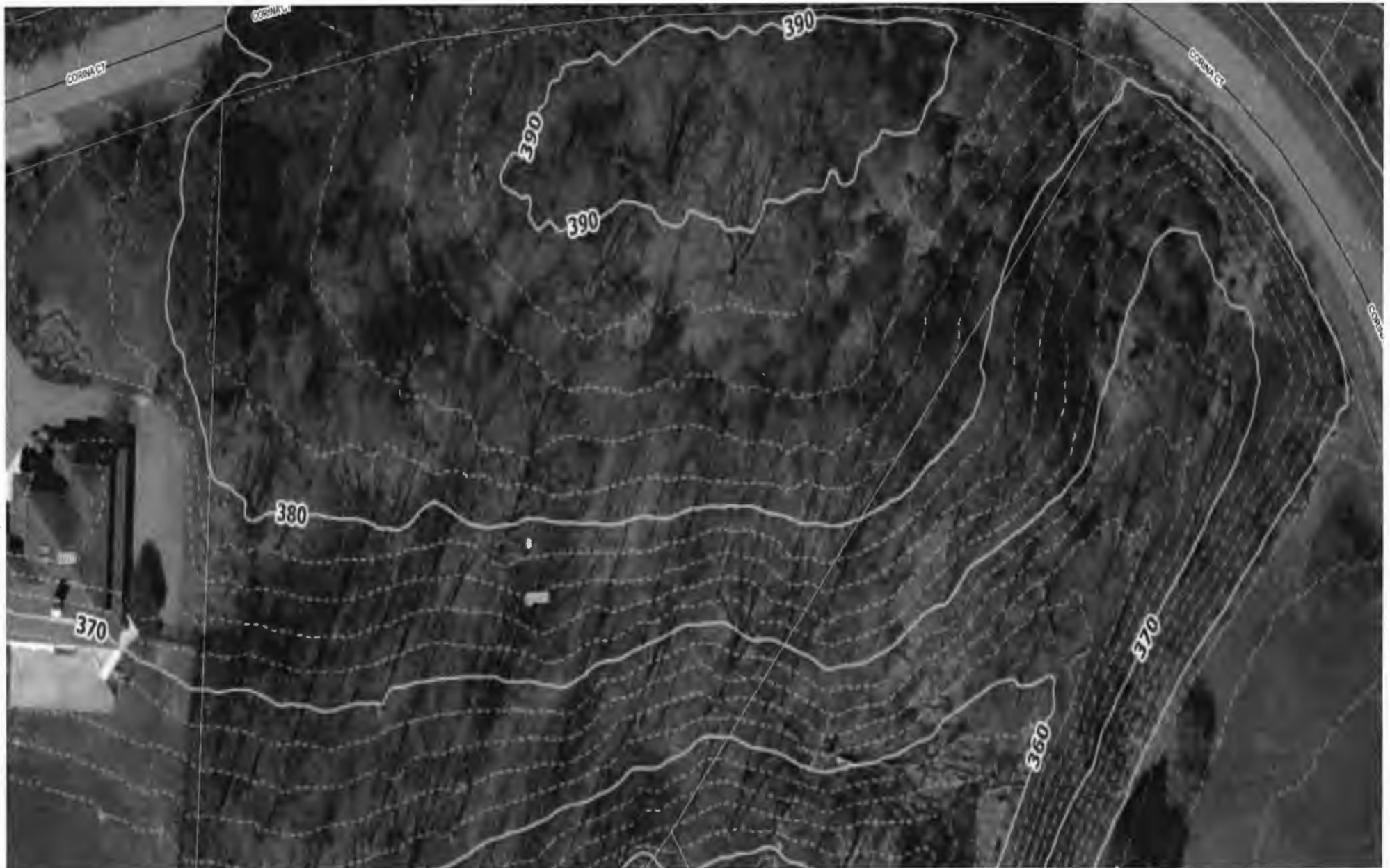

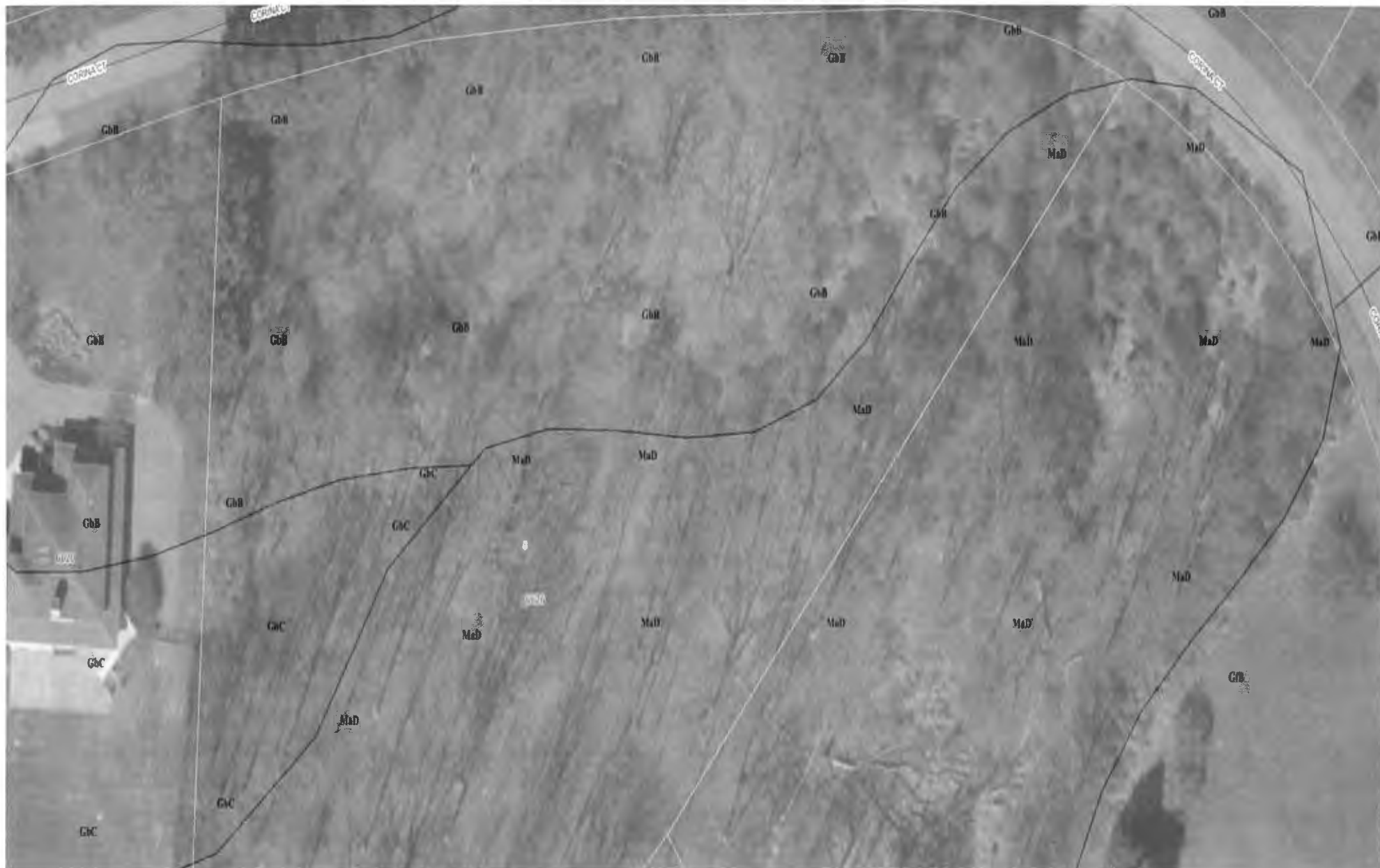

# APPLICATION

SEWAGE DISPOSAL TESTING

STATE OF MARYLAND - DEPARTMENT OF HEALTH AND MENTAL HYGIENE

HOWARD COUNTY HEALTH DEPARTMENT  
ENVIRONMENTAL HEALTH SERVICES  
P. O. BOX 473 ELLICOTT CITY, MARYLAND 21043  
TELEPHONE: 992-2330

A 31569

P \_\_\_\_\_

DISTRICT 5th

DATE 8/14/81

TO: THE COUNTY HEALTH OFFICER  
ELLICOTT CITY, MARYLAND

I, HEREBY, APPLY FOR THE NECESSARY TEST IN ORDER TO CONSTRUCT (OR RECONSTRUCT) A SEWAGE DISPOSAL SYSTEM.

PROPERTY OWNER Francisco Guzman Applicant: Greenhorne & O'Mara, Inc.  
6715 Kenilworth Avenue, Riverdale, MD  
ADDRESS 10959 Swansfield Road, Columbia, MD 21044 John Sakai 277-2121 x 177 20840  
PHONE \_\_\_\_\_

PROPERTY LOCATION:

SUBDIVISION La Isla LOT NO. 5

ROAD AND DESCRIPTION Cedar Lane 1,000 Ft. North of Intersection w/Rte. 32

SIZE OF LOT 3+ acre TYPE BLDG. Single Family Dwelling  
4 bedrooms  
(NUMBER OF BEDROOMS)

THE SYSTEM INSTALLED UNDER THIS APPLICATION IS ACCEPTABLE ONLY UNTIL PUBLIC FACILITIES BECOME AVAILABLE. I FULLY UNDERSTAND THE FEE CONNECTED WITH THE FILING OF THIS PERC TEST APPLICATION IS NON-REFUNDABLE UNDER ANY CIRCUMSTANCES. I ALSO AGREE TO COMPLY WITH ALL M.O.S.H.A. REQUIREMENTS IN TESTING THIS LOT.

(SIGNATURE OF APPLICANT)

APPROVED BY \_\_\_\_\_ FOR \_\_\_\_\_ DATE \_\_\_\_\_

REJECTED BY \_\_\_\_\_ FOR \_\_\_\_\_ DATE \_\_\_\_\_

HOLD PENDING FURTHER TESTS \_\_\_\_\_ DATE \_\_\_\_\_

REASONS FOR REJECTION OR HOLDING 8/14/81 for

initials of Howard County

\_\_\_\_\_

# THIS IS NOT A PERMIT

#5

SOIL PROFILE

SEE EACH HOLE BELOW



FIELD SHEET

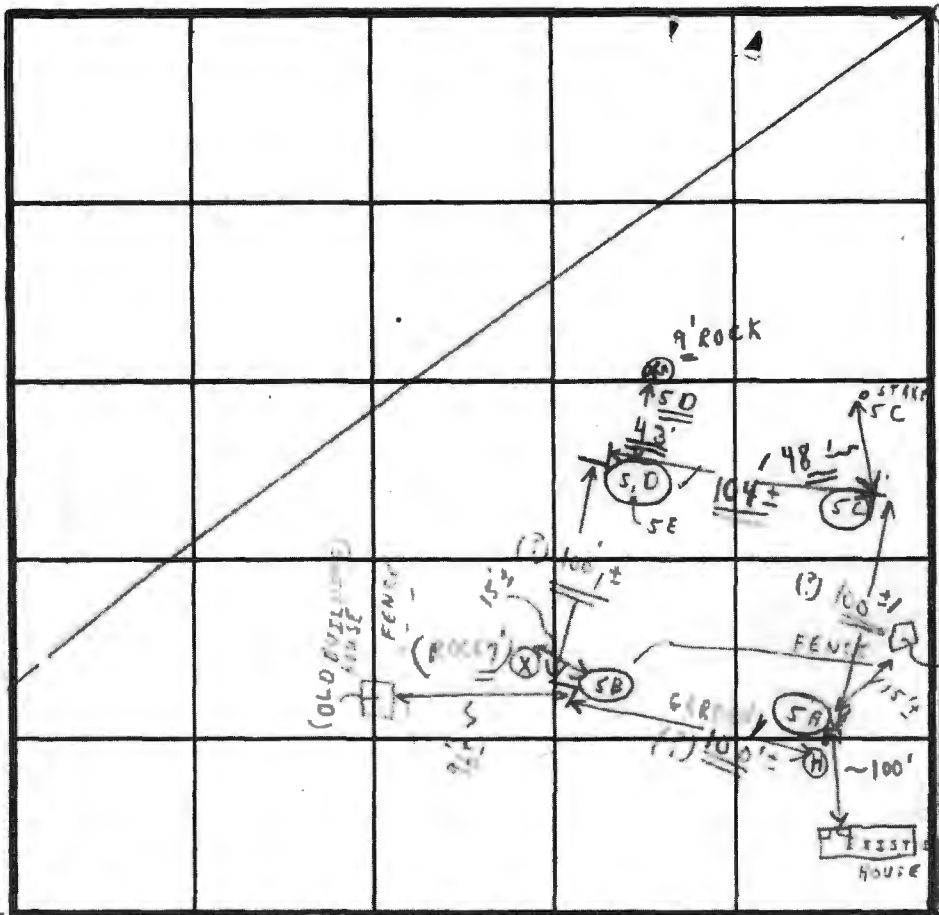

INDICATE NORTH - NAME ADJOINING ROADWAY AS BASE LINE.

UNNAMED ROAD (PROPOSED)

Recommended Shallow Trencher Soil 4'-8' (NEW HOLE)

SOIL PROFILE

1'-3' CLAY  
 3'-12 1/2' LOAM SANDY  
 1'-4' CLAY  
 1' SANDY LOAM 8 1/2'  
 1'-4' CLAY  
 4'-8' SANDY LOAM  
 1'-4' CLAY  
 4'-12' SANDY-LOAM

DATE	TEST NO.	DEPTH	PRE-WET		TEST - 1' DROP		TIME
			START	STOP	START	STOP	
8/19/81	5E S	3'	2:16	2:20	2:20	2:28	8 min
	5E D	12 1/2'	SANDY	MICH	LOAM	SIMILAR TO SHELF	
	5C S	4'	2:47	2:50	2:50	3:08	18 min
	5C D	8 1/2'	MORE	{SANDY LOAM STAY @ 4'			
	5A S	4'	3:18	3:19	3:19	3:21	2 min
	A D	8'	MORE	LOAM	THAN @ 4'		
	5B S	4'-3"	3:31	3:35	3:35	3:53	18 min
	5B D	12'	SIMILAR TO SHELF				
						4/46	

TEST (NOT PER STAKE)  
 TEST (NOT PER STAKE)  
 TEST NOT PER STAKE

(1) CERTIFIED HOLES

REMARKS: HIGH GRASS + BRUSH IN AREA HOLD ALSO (2) HOUSE SITE (3) WELL SITE  
 HOLD - EXISTING WATER WELL 74' FROM INITIAL STAKE 5C HOLE HOLD APPROVAL UNTIL WATER WELL SEALED + 10R MOVE 5C HOLE UP HILL

TYPE OF SOIL \_\_\_\_\_  
 TESTED BY: C. B. [Signature] 8/19/81 ALSO PRESENT: JOHN OF GREENHORNE + OMARA Phil + ASS'T. BRADFORD

EH-12-1079







# HOWARD COUNTY HEALTH DEPARTMENT

70983

DATE 3/19/22

AS

Received From

Michael Hasman

PHONE #

410-336-0803

For

Recap/ldd/coupa

CASH

CHECK

NO.

731

Five hundred \$

Dollars

\$ 500.00

Received By

[Signature]

We can work on  
this one together  
but I'll let you  
handle the scheduling.

And I'll forward some  
"starter" e-mails for you  
to see. "FYI" - ZS

Files are  
in HDrive under  
"Coring Ct."

-ZS

## Oswald, Hank

---

**From:** Oswald, Hank  
**Sent:** Friday, March 11, 2022 8:19 AM  
**To:** taylor@sillengineering.com  
**Cc:** Silvast, Zackary  
**Subject:** Perc Test\_6626 Corina Court

Hi Taylor:

Good morning. I would like to schedule the perc test date for 6626 Corina Court (Lot 5). Please choose from one of the following dates:

- **March 17 starting at 8:30.**
- **March 29 starting at 8:30.**

The perc test holes must be properly field located and staked prior to the test date. The owner will be responsible for hiring a septic contractor with a backhoe to dig the perc test holes.

Please let me know as soon as you can.

Thanks,

Hank

Hank Oswald, L.E.H.S.  
Howard County Health Department  
Well & Septic Program  
410.313.1786  
hoswald@howardcountymd.gov

Maura J. Rossman, M.D., Health Officer

August 22<sup>nd</sup>, 2022

TO: Mike Mosman, Applicants  
RE: 6626 Corina Court Percolation test results and data (Part 2)

Dear Mr. Mosman,

On August 19<sup>th</sup>, 2022, percolation tests were conducted as scheduled at 6626 Corina Court. The proposed sewage disposal area (SDA) was thoroughly re-tested and re-evaluated this day. The test site was dominated by two main soil types, Gladstone loam (GbC) and Manor loam (MaD).

Locations 609 and 610 were dug in that order in close proximity to their staked locations, trees were avoided. 609 & 610 were both a PASS. The difficult nature of the soils was pre-established during the first round of testing on 3/29/22; on that day, it was determined that the site contained some clay dominant soils, greater than 50% rock, and hardened sandstone that appeared to be impenetrable. Originally, the hired engineer attempted to expand the SDA by utilizing the only three passing perc holes to their maximum potential. However, there were several inconsistencies and unknowns so a quality SDA could not be rendered. The field work from "part 1" could not be properly analyzed until the testing was surveyed by the property owner's engineer. It was determined at that point, that the extra field work conducted on 8/18/22 was critical for the project. A proper SDA boundary was established.

All evaluated locations must be field-located and illustrated on the Percolation Certification Plan. Elevation stamps should be located on every perc hole tested by the HD this year. There is no guarantee that a complete 10,000 sf SDA can be created due to property limitations.

Locations of percolation tests that 'PASS' are used to define the soils that are suitable for inclusion in an SDA proposed on the Percolation Certification Plan. The results and suitable areas for wastewater discharge are certified by the Approving Authority's signature of the Percolation Certification Plan. After the Percolation Certification Plan is signed by the Bureau of Environmental Health Director, the Health Department's Environmental Health Specialists may consider review and approval of the subdivision and permit proposals such as well or septic system permits and building permits.

If you have questions related to this report, you may reply to me via email, [zsilvast@howardcountymd.gov](mailto:zsilvast@howardcountymd.gov), or call my desk, 410-313-1777.

Respectfully,



Zackary Silvast, REHS/RS, L.E.H.S.

Plan Review Supervisor

Well and Septic Program (*Howard County HD*)

Enclosures: Percolation Test Application and Field Worksheet

Copy: Paul Sill, Sill Engineering Group LLC.

# Goring Court (6626)

AP \_\_\_\_\_

609

0-2" top soil  
Br. L. lim  
2"-7" Br. Tan SL  
w/ gravel  
7"-1 1/2" Tan CL  
1 1/2"-4" Tan Clay  
4"-5" Tan/White SL  
5"-8" White LS  
8"-10" Tan/Br. LS  
10' rock  
bottom

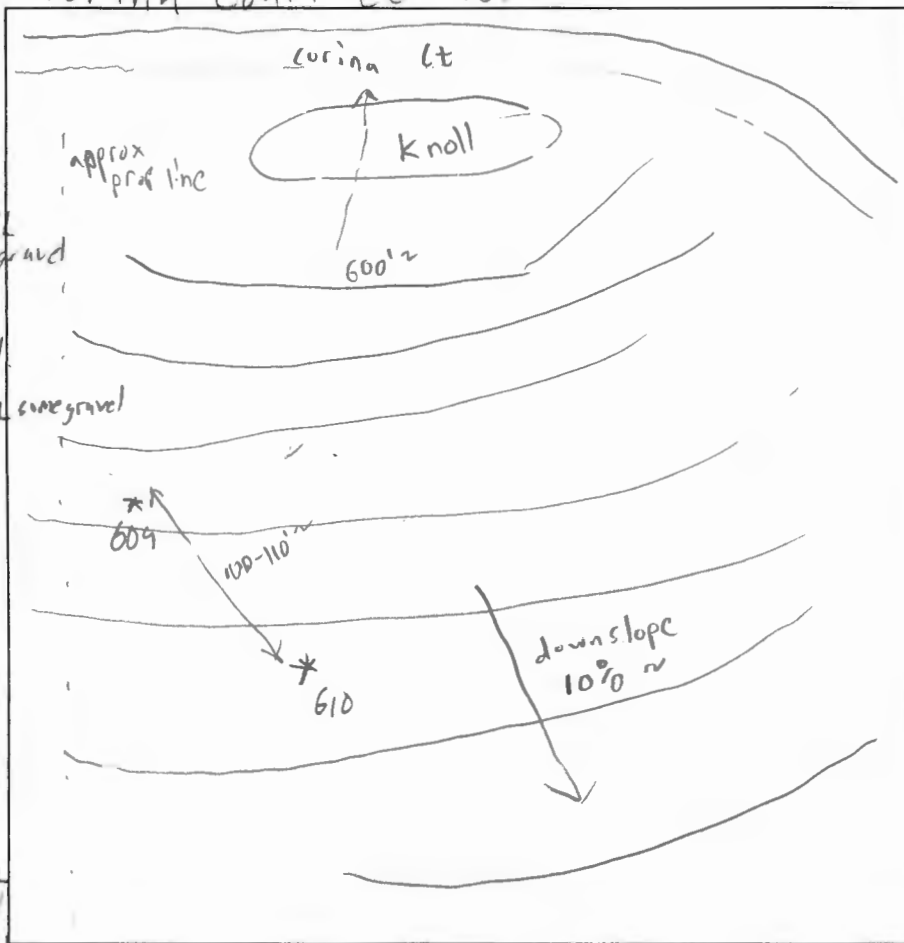

610

0-2" top soil  
Br. L. lim  
2"-7" Br. Tan SL  
w/ gravel  
7"-1 1/2" Br. Tan CL  
1 1/2"-3" Red/Br. Clay  
3"-4" Red/Br. SA  
4"-6" Br. Red SL  
very rock  
6"-9" Br. Red SL  
fine white  
clay pebbles  
9"-11" Tan/Greyish clay  
very fine SL  
11' rock bottom

DATE	TEST #	DEPTH	START	BREAK 1" DROP	STOP 2" DROP	TIME OF 2ND INCH	P/F/H
8/19/22	609	5.5'	10:19am	10:23am	10:27am	5mp	P
8/14/22	610	5'	10:49am	10:54am	11:08am	14mp	P

REMARKS 2nd day, establishing SDA edges  
 SANITARIAN Zack S. BACKHOE Ricky OTHERS Fogles, owner  
 TEST HOLES USED IN SDA 5, including 609 & 610 AVG. PERC TIME \_\_\_\_\_ SQ. FT/BR \_\_\_\_\_  
 TRENCH WIDTH \_\_\_\_\_ INLET DEPTH \_\_\_\_\_ MAX. BOT DEPTH \_\_\_\_\_ EFFECTIVE S/W \_\_\_\_\_



---

**Maura J. Rossman, M.D., Health Officer**

April 4<sup>th</sup>, 2022

TO: Mike Mosman, Applicants  
RE: 6626 Corina Court Percolation test results and data

Dear Mr. Mosman,

On March 29<sup>th</sup>, 2022, percolation tests were conducted as scheduled at 6626 Corina Court. The proposed sewage disposal area (SDA) was thoroughly tested and evaluated this day. The test site was dominated by two main soil types, Gladstone loam (GbC) and Manor loam (MaD).

Locations 601, 602, 604, 602, and 603 were dug in that order at their respective staked locations. 601 and 604 were a PASS. Holes 605, 602, and 603 were designated as FAIL. The soils were extremely inconsistent on this lot, there were holes composed mainly of clay dominant soils and there were holes failed due to encountering greater than 50% rock as well as hardened sandstone that could not be penetrated after numerous attempts. These holes also I attempted to expand the usable area, so I dug three more holes: they were designated as "606, 607, and 608." 606 was a PASS, while 607 & 608 were a FAIL. Passing holes 606, 604, & 601 are relatively on the same contour and within a decent proximity of each other.

All evaluated locations must be field-located and illustrated on the Percolation Certification Plan. There is no guarantee that a complete 10,000 sf SDA can be created with only three adequate, passing holes.

Locations of percolation tests that 'PASS' are used to define the soils that are suitable for inclusion in an SDA proposed on the Percolation Certification Plan. The results and suitable areas for wastewater discharge are certified by the Approving Authority's signature of the Percolation Certification Plan. After the Percolation Certification Plan is signed by the Bureau of Environmental Health Director, the Health Department's Environmental Health Specialists may consider review and approval of the subdivision and permit proposals such as well or septic system permits and building permits.

If you have questions related to this report, you may reply to me via email, [zsilvast@howardcountymd.gov](mailto:zsilvast@howardcountymd.gov), or call my desk, 410-313-1777.

Respectfully,



Zackary Silvast, REHS/RS, L.E.H.S.  
Plan Review Supervisor  
Well and Septic Program (*Howard County HD*)

Enclosures: Percolation Test Application and Field Worksheet  
Copy: Paul Sill, Sill Engineering Group LLC.

# 6626 Curina Ct

A/P

**605**  
 0-3" top soil  
 dark Br. Loam  
 3" - 1' Brown SL  
 1' - 3' Br./Red (thick) CL (light)  
 3' - 5' Br./Red SCL (light)  
 5' - 7' Tan/Red SCL (loose)  
 7' - 10' Tan/white SL w/ 15% shale  
 rock bottom  
 @ (stopped 10' dig)

**601**  
 0-4" top soil  
 Br. loam  
 4" - 1 1/2' Red/Br. CL (thick)  
 1 1/2' - 6' Red/Tan CL  
 6' - 8' Red/Tan/Gray SCL (hard but loose)  
 8' - 12' Tan/Gray SL w/ 20% shaly mica

**604 (middle)**  
 0-3" Dark Br. Loam  
 3" - 1' Brown SL  
 1' - 3' Brown CL  
 3' - 5' Red/Br. CL (thick)  
 5' - 6' Red/Tan SCL (light)  
 6' - 7' Tan/Red SCL (loose)  
 7' - 10' Br. Tan SL (very fine)  
 10' - 12' white/tan LS w/ 20% gravel/shaly mica

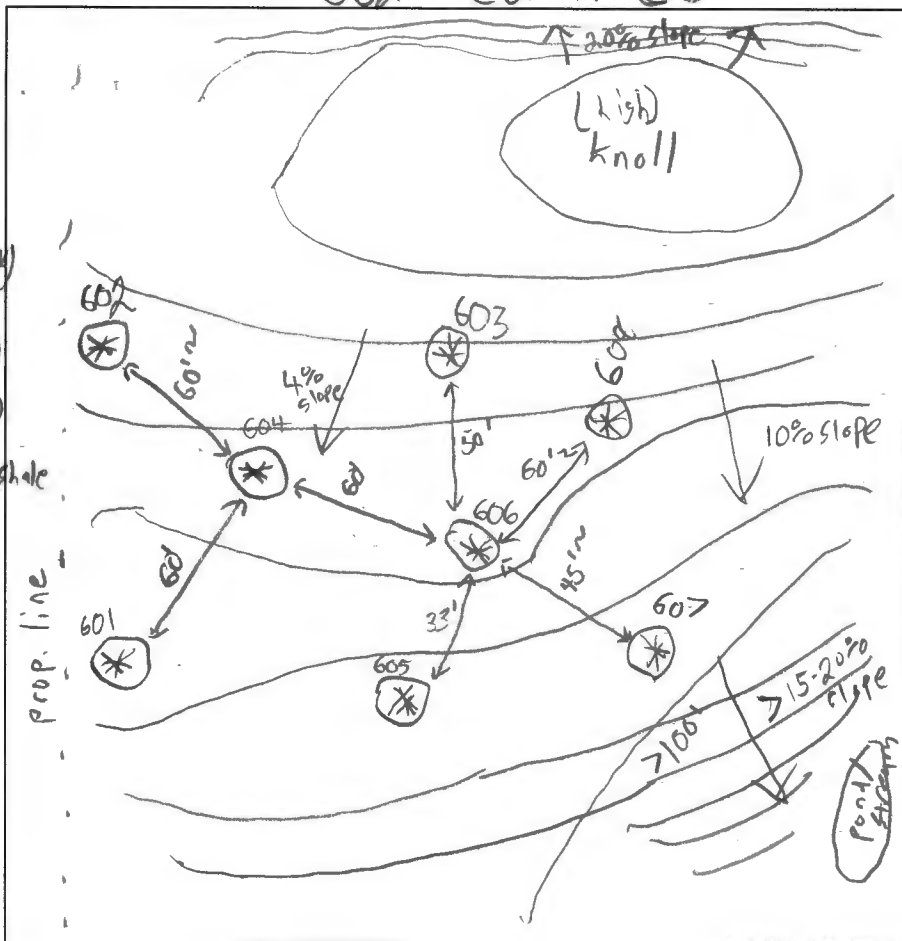

**602**  
 0-4" top soil  
 4" - 2' Tan/Reddish CL  
 2' - 7' Red/Brown CL (heavy)  
 7' - 8' Breakable (Blocky) rock layer  
 8' - 10' Tan/White/Red LS w/ gravel and clay plates  
 10' rock bottom (stopped dig)

**603**  
 0-4" top soil  
 4" - 2' Br. CL  
 2' - 7' Red/Br. CL  
 7' - 8 1/2' (very thick) Red/Tan SCL  
 8 1/2' - 9' Rock/Tan/Red SL  
 Rock Bottom > 50' 9'

**"606"**  
 0-3" top soil  
 3" - 9" Br. SCL without  
 9" - 2' Br. CL  
 2' - 4' Red/Br. CL  
 4' - 5' Red/Br. SCL  
 5' - 12' Gray/Tan sandstone

**"607"** stopped @ hard clay  
 0-6" top soil  
 6" - 2' Br. CL  
 2' - 5' Red/Br. CL  
 5' - 8' Tan/Red/Br. Clay

**"608"**  
 0-3" top soil  
 3" - 9" Brown SCL  
 9" - 4' Brown CL  
 4" - 3' hard Tan/SCL  
 5' - 6' rock  
 > 60% stopped

DATE	TEST #	DEPTH	START	BREAK 1" DROP	STOP 2" DROP	TIME OF 2ND INCH	P/F/H
3/29/22	605	5'	9:25am	>30mp	Pulled		(F)
3/24/22	605	6'	10:00am	>30mp	Ran Full Time		(F)
3/29/22	601	7'	9:52am	9:56am	10:05am	9mp	(P)
3/24/22	604	7'	10:21am	10:28am	10:48am	20mp	(P)
3/29/22	602		VISUAL FAIL				(F)
3/29/22	603		VISUAL FAIL				(F)
3/29/22	"606"	6'	11:29am	11:36am	11:32	2mp	(P)
3/29/22	"607"		VISUAL FAIL				(F)
3/29/22	"608"		VISUAL FAIL				(F)

REMARKS \_\_\_\_\_  
 SANITARIAN Zack S. BACKHOE Fogel-Jamie, Chris OTHERS owner  
 TEST HOLES USED IN SDA 601, 604, 606? AVG. PERC TIME 6-15mp ~~50~~ On 8 rate  
 TRENCH WIDTH \_\_\_\_\_ INLET DEPTH \_\_\_\_\_ MAX. BOT DEPTH \_\_\_\_\_ EFFECTIVE SW \_\_\_\_\_