

Ap 526681

10
1' brn fsl
low chroma matrix
5' water seeps
10' free water surface

14
1' brn sl
3 fg & msbk
yel-brn fsl
3 msbk & fslbk
4' brn sl
6' free water surface
grey brown fsl
7'

13
1' brn sl
3 fg & fslbk
brn fsl
2 msbk
3' brn fsl
1 fslbk
4.5' grey brn chls
5' shake channels
chls continues
25' puggy ls
13' water

12
0.8' brn sl
red-brn fsl
2 msbk
3.3' red-brn fsl
6' 8 fpl
red brn chls
8' owl
v ch fsl
12' >50 shale

16
0.8' brn gal
brn chls (heavy)
2 msbk
3' brn chsl
7.5' brn v fsl
40 to 50% fragments
vein appears near vertical
bedded shale appears bouldery
10.5' free water

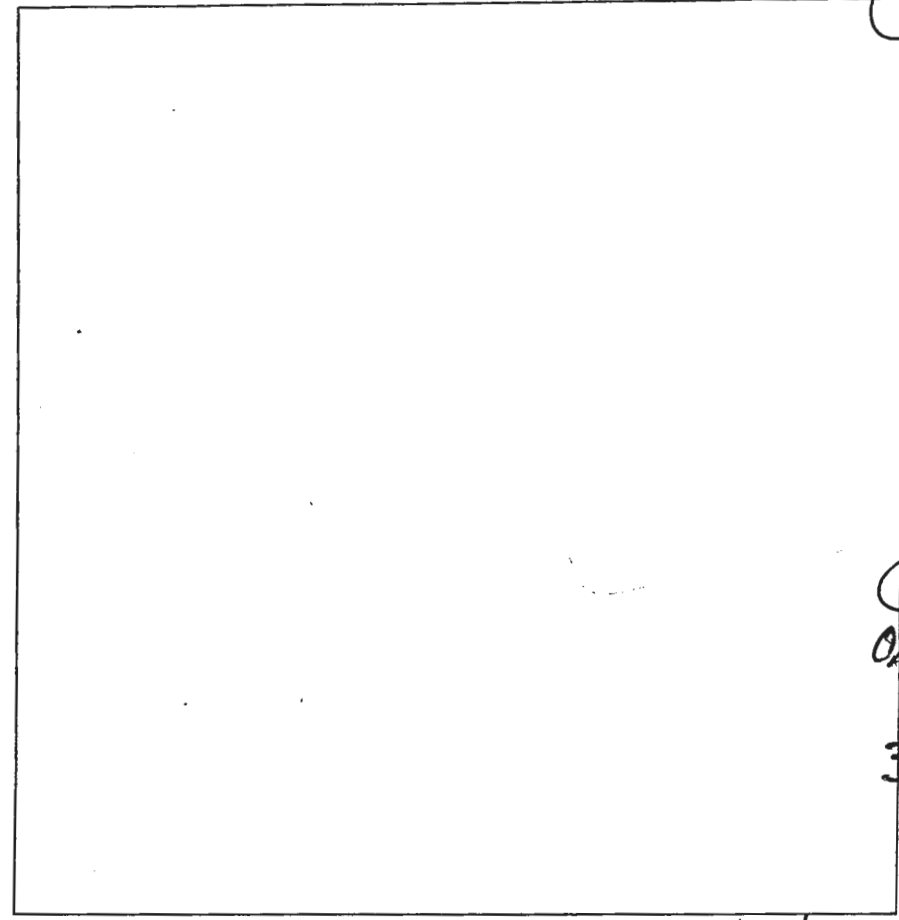

DATE	TEST #	DEPTH	START	BREAK 1" DROP	STOP 2" DROP	TIME OF 2ND INCH	P/F/H
6/1	13	5.5' / 3'	11:32	11:33	11:34	1 ±	F
	repeat 13	5.5' / 13'	0	1:20	2:50	m:sec 1:30	F
	repeat 13	5.5' / 13'	0	1:20	2:40	m:sec 1:20	F
6/1	14	6'	free water				F
6/1	10	5'	water seeps				F
6/1	11	4' / 10.5'	12:35	12:40	12:57	11	depth marginal P
6/1	12	5.5' / 12'	0	0:50	2:00	1:10	F

REMARKS _____
 SANITARIAN RB BACKHOE Duane OTHERS Laura, Michael
 TEST HOLES USED IN SDA _____ AVG. PERCENT TIME _____ SQ. FT. BR _____
 TRENCH WIDTH _____ INLET DEPTH _____ MAX. BOT DEPTH _____ EFFECTIVE S/W _____

Lot 7 & 26

A/P

26-D

Y-brn Ap
Chan. grcr
FSL

Red Yellow/grey
SL (chamney)
w/press mt.
Mottles CW

Red Yellow
SL - cham. in
press w/str.
Sapr.

Yellow Brn
SL w/~30%
hard saprolite
overall (some
pockets)

Water

7-A
Pnk Yel Brn
Ap (m. Chan)

Yellow Red
Yellow Brn.
Chan (~40%)
SL

Red Brn
Chan SL
~15%

Flags of
str. Sapr
Water

7-E
Yellow Brn
Chan Ap Lm

Yellow Red
Red Yellow
H/Lm-CL
chamney t-3

Yellow Brn
SL ~
60%
micaschist
chan. - flags
Boulders

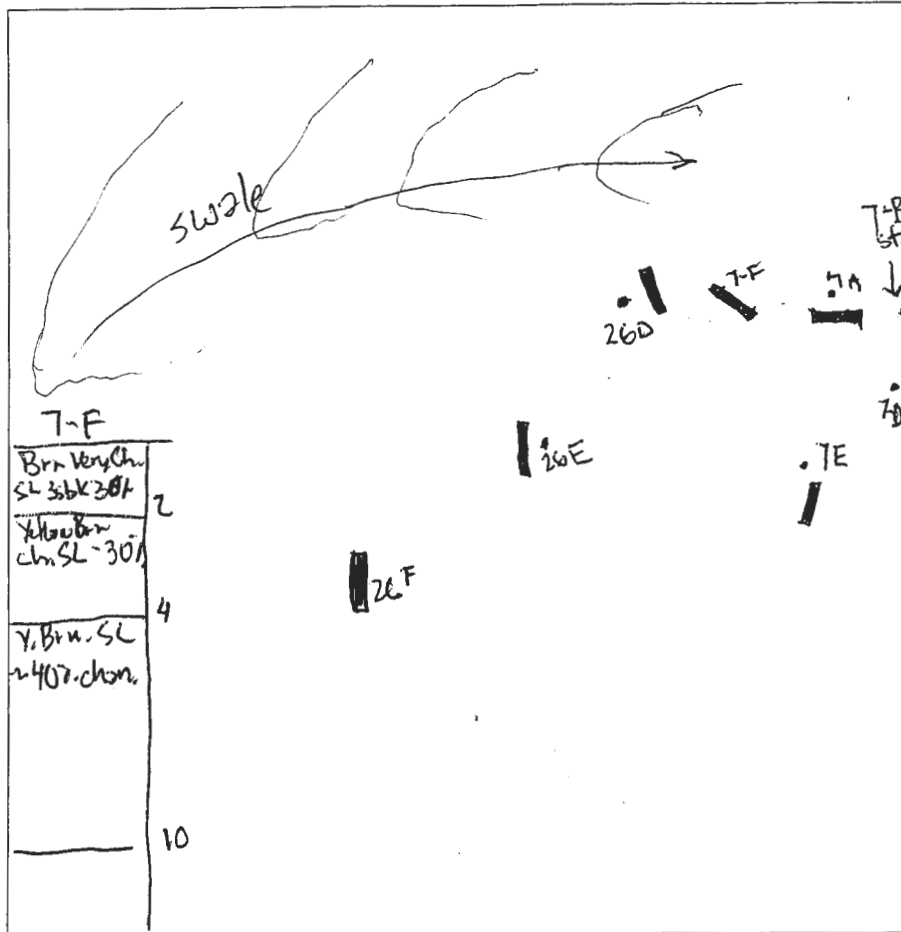

DATE	TEST #	DEPTH	START	BREAK 1" DROP	STOP 2" DROP	TIME OF 2ND INCH	P/F/H
9/18/07	26-D	5/15 1/2	11:59	12:06	12:13	7m	
	7-A	4/12 1/2	12:42	12:44	12:47	3m	
	7-E	V/11	>60 @ ~7'			V/F	
	7-D	5/13	1:36	1:44	1:55	11m	
	7-B	Not	Dug	due to proximity to 7A/7C			
	7-L	4/13	2:04	2:07	2:12	5m	P
9/20/07	26-F	4 1/2 / 12 1/2	3:46	missed	3:49		
		Repair	3:50	stopwatch 00:00	02:10	2m/10s	P
	7-F	4 1/2 / 12	00:00	00:50	01:50	1m pi	F

7-D
Chan. Yellow
Brn SL

Red Yellow
CW Chan.
SL

Yellow Red
FSL

West mica
Schist
Sapr. ~20-
25%

7-C
Yellow Brn Chan
SL

Red Yellow
FSL

Yellow Red
FSL

40% Sapr.
mica schist

Red Yellow
SL

~20%
Chan. mica
Schist Sapr.

Water/Bottom

26-F
Yel. Brn. ch.
SL 20%

Yellow Red
Ch. HSL
~20%

Yellow Red
Ch. SL 30%

Yellow Brn
Ch. SL(s)
30%
overall
pockets -
of 45-50%
in spots

REMARKS 7-D would have similar rate @ 4'

SANITARIAN GAC BACKHOE _____ OTHERS _____

TEST HOLES USED IN SDA _____ AVG. PERC TIME _____ SQ. FT/BR _____

TRENCH WIDTH _____ INLET DEPTH _____ MAX. BOT DEPTH _____ EFFECTIVE SW _____



Swale Lot 8

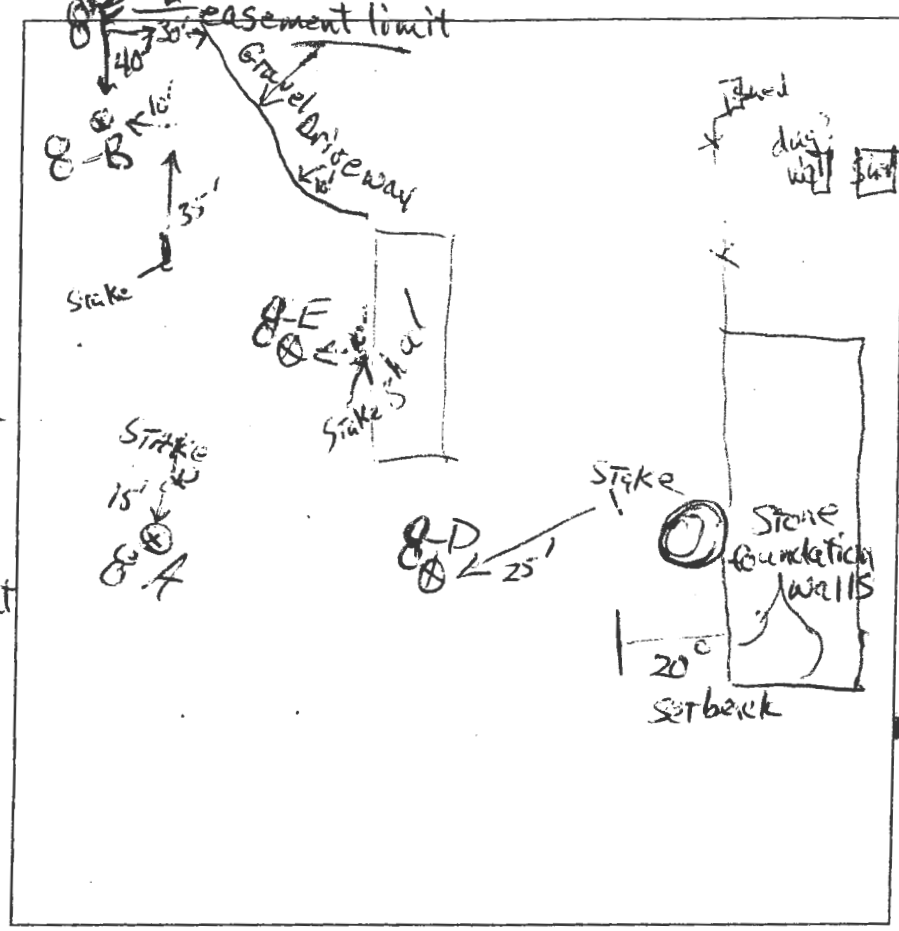

AP
8-E
1.5' brns 3msbk & msbk
brn sl 3msbk
4' 15% channers
red-brn sl common mica
7' red-brn sl micaceous 20% weak-cement rock

8-A
0.5' brn sl
1.5' 3f sbk
brn sl 2f sbk
2.5' red-brn vch sl 35% saprophyte
6' brn vfl ch sl 40% glass & channers
11' cemented shale

8-B
0.3' brn sl
red-brn sl 2f sbk
6.5' red-brn sl 7 mpi
3' brn & red-brn vch sl 40%
8' brn vfl sl 55%

8-D
brn sl
3msbk & msbk
red-brn sl
2msbk dense
pale red tan blk streaks
0 m, dense
4' red-brn ch sl
20% channers
7' brn ch sl
30% channers
10' vfl sl 40% flags
brn
13' vst sl 45%
3.5' Stone large increasing

8-F
0.3' brn sl, psbk
brn sl 2msbk
0.7' red-brn sl heavy, 1f sbk
3.5' pale red-brn fsl, 0 m
5' Tan & brn fsl, 10% channers
8.5' lt grey brn ch fsl
11.5' olive fsl
faint depleticous distinct enrichments
B' moist

DATE	TEST #	DEPTH	START	BREAK 1" DROP	STOP 2" DROP	TIME OF 2ND INCH	P/F/H	
9/17/07	8-D	5/3.5	3:05	3:15	3:33	18	P	
9/17/07	8-E	5.5/11	2:37	2:41	2:45	4	P	
9/18/07	8-B	4/8	9:00	9:02	9:05	3	P	
9/21/07	8-F	6.8/11.5	0	3	12	9	P	
9/18/07	8-A	VISUAL	Trench bottom to 7'					P

REMARKS 8-B, Trench bottom 4'; 8A, D & E, 7' Trench bottom; Did not perc 8C
 SANITARIAN PR BACKHOE Don & Jeff OTHERS Laura Riley Matt Mitchell
 TEST HOLES USED IN SDA _____ AVG. PERC TIME _____ SQ. FT/BR _____
 TRENCH WIDTH _____ INLET DEPTH _____ MAX. BOT DEPTH _____ EFFECTIVE SAW _____

Maura J. Rossman, M.D., Health Officer

October 5, 2021

TO: Wynne Family LLC, Owner/Applicant
c/o Brian Wynne, managing member

RE: 15683 Old Frederick Road, Percolation test results and data

Dear Mr Wynne,

Percolation tests were conducted, as scheduled, for the proposed tenant house at 15683 Old Frederick Road on October 1, 2021. These tests were conducted to establish a sewage disposal area (SDA) of about 10,000 sq.ft. to contain the initial drainfield and two replacement drainfields for the future tenant house.

Six of the seven locations dug were at the corresponding stake. The seventh location, 21-6, was dug about 15 feet uphill from the stake. Following is a brief description of results at each location.

- Location 21-4: As groundwater was observed at 8 feet depth, this location was tested at 4 feet depth. The infiltration rate was very slow and the location is a FAIL with only about ¼" water drop in 33 minutes
- Location 21-5 is a FAIL as loam soils were observed to more than 3 feet depth with groundwater occurring at 7 feet depth.
- Location 21-3 was not dug as it is on the same landscape position, and at a similar elevation as 21-4.
- Location 21-7 is a FAIL due to an abrupt drop-off of several feet adjacent to the stake location.
- Location 21-6 is a FAIL due to occurrence of rock much greater than 50 percent by volume at 3.5 feet and below.
- Location 21-2 is a FAIL as loam soils occur to at least 3 feet depth, and rock greater than 50 percent occurs at 6 feet depth and below.
- Location 21-1 is a PASS.
- Location 21-8 is a PASS.

Overall, the proposed SDA is judged unsuitable for wastewater treatment and disposal. All judged locations must be field-located and illustrated on the next iteration of the Percolation Certification Plan for this property.

The Percolation Test Application may remain active until September 17, 2023. If you have questions related to this report, you may reply to me via email, rbricker@howardcountymd.gov , or call my desk, 410-313-2691.

Respectfully,

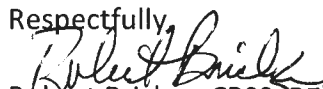

Robert Bricker, CPSS, REHS/RS, L.E.H.S.

Environmental Sanitarian II
Well and Septic Program

Enclosures: Percolation Test Application and Field Worksheet

Copy: Michael Tran, GLW

Jeffrey Williams, Supervisor, Well & Septic Program
file



Bureau of Environmental Health
 8930 Stanford Blvd | Columbia, MD 21045
 410.313.2640 - Voice/Relay
 410.313.2648 - Fax
 1.866.313.6300 - Toll Free

Maura J. Rossman, M.D., Health Officer

**APPLICATION
 FOR PERCOLATION TESTING AND SITE EVALUATION**

PROPERTY LOCATION

SUBDIVISION/PROPERTY NAME Tax Parcel 0002 (owner-- Wynne Family, LLC)

PROPERTY ADDRESS 15685 Old Frederick Road Woodbine 21797
STREET TOWN ZIP

TAX ACCOUNT # 315383 TAX MAP 0008 GRID 0001 PARCEL 0002 LOT NO. n/a PROPOSED LOT SIZE (ACRES) 58.0

ZONING CATEGORY RR (Ag. Pres.) TIER

PROPERTY OWNER(S) Wynne Family, LLC

DAYTIME PHONE 410-991-0665 CELL 410-991-0665 EMAIL wynnebrian65@gmail.com

MAILING ADDRESS 170 Cooley Ridge Dr. Sykesville, MD 21784
STREET CITY, STATE ZIP

APPLICANT Wynne Family, LLC (Brian Wynne, managing member)

RELATIONSHIP TO OWNER: same

DAYTIME PHONE 410-991-0665 CELL 410-991-0665 EMAIL wynnebrian65@gmail.com

MAILING ADDRESS 170 Cooley Ridge Dr. Sykesville, MD 21784
STREET CITY, STATE ZIP

I HEREBY APPLY FOR THE NECESSARY TESTING/EVALUATION PRIOR TO ISSUANCE OF SEWAGE DISPOSAL SYSTEM PERMIT(S):

PROPERTY:

- SUBDIVISION: NUMBER OF LOTS INCLUDING RESIDUE: _____
 SUBDIVISION CLASSIFICATION (PER DEPT. OF PLANNING AND ZONING) MAJOR MINOR
- CONSTRUCT NEW OSDS ON UNDEVELOPED LOT
- REPAIR OR REPLACE FAILING OSDS
- UPGRADE EXISTING OSDS

BUILDING:

- RESIDENTIAL WITH 5 (FIVE) ~~EXISTING OR~~ PROPOSED BEDROOMS IN A NEW TENANT HOUSE ~~THE COMPLETED STRUCTURE~~
- COMMERCIAL (PROVIDE DETAIL OF TYPE OF USE AND NUMBERS OF EMPLOYEES/CUSTOMERS ON ACCOMPANYING PLAN)

IS THE PROPERTY WITHIN 2500 FEET OF ANY RESERVOIR?

- YES
- NO

AS APPLICANT, I UNDERSTAND THE FOLLOWING:

- THIS APPLICATION IS VALID FOR TWO(2) YEARS FROM DATE OF FEE PAYMENT AND APPROVAL IS BASED UPON HEALTH OFFICER SIGNATURE OF A PERC CERTIFICATION PLAN PRIOR TO EXPIRATION OF THIS PERMIT.
- THE APPLICATION FEE IS NON-REFUNDABLE
- THIS APPLICATION MUST BE ACCOMPANIED BY ALL APPLICABLE FEES AND A SUITABLE SITE PLAN IN ORDER TO BE PROCESSED
- THIS IS A PUBLIC DOCUMENT

I declare and affirm that to the best of my knowledge, the information contained herein is correct. I declare that I am the owner of the property or duly authorized to make this application on behalf of the owner. I agree to comply with all applicable state and county regulations.

By signature of this application, I hereby grant Howard County Health Department officials the right to enter onto the property for the purpose of inspecting the property as directly related to the requested permit/service.

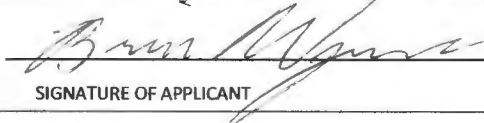
 SIGNATURE OF APPLICANT

9/13/21
 DATE

SP 570157

15683 Old Frederick

21-5

21-4

0.5' red
2.2' red-brn sl
4.5' red-brn sl
8' water

brn L, 2 f sbl
brn L, 2 msbl
red-brn sl
1 msbl
m2d (lt grey)
yel-red sl
thin platy
common mica
m1rd (lt grey)
water
grey-brn sl
w/ depletions

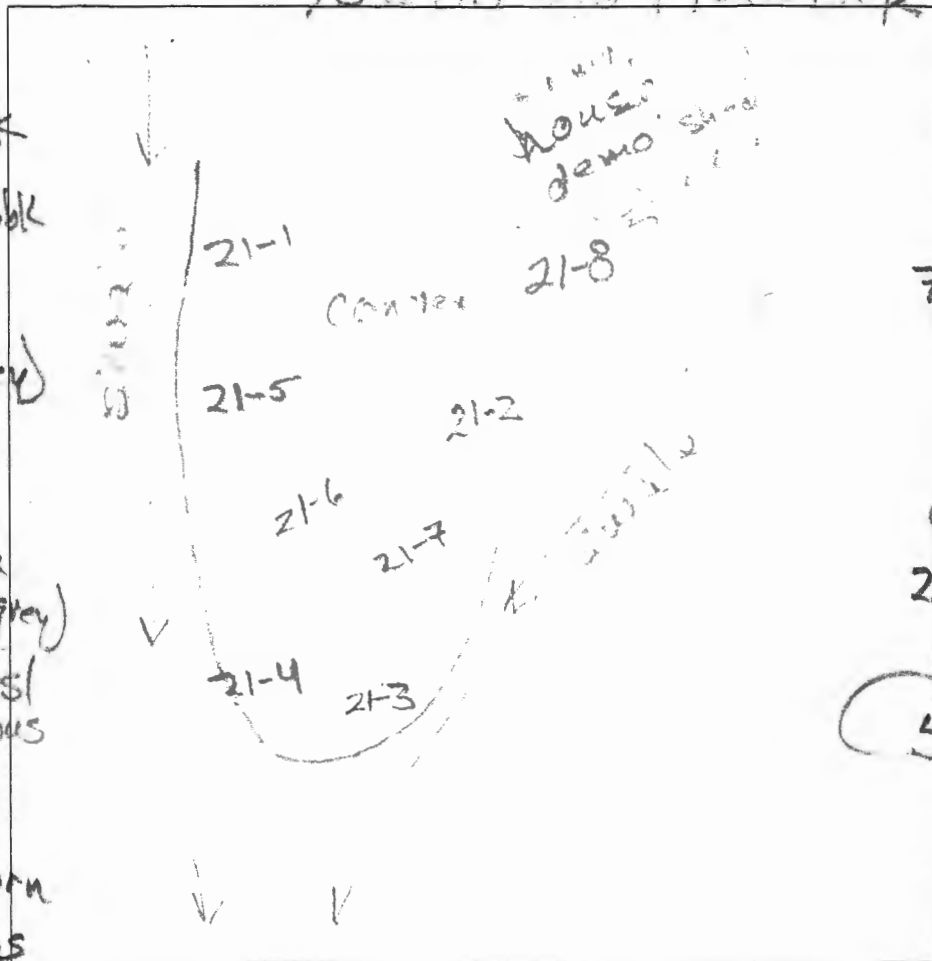

1.3' brn L
red-brn L
4.5' grey-brn
sl to
water

21-1

brn L
2 f sbl
0.2' red gsl
1 f sbl
25' red vels
thick platy
30-40% rock
41' brngls
platy, 20-30
rock

21-2

brng red-brn
& red lumps

2' red-brn
vst sl
35-45% rock
6' > 50% rock
8' STOP

DATE	TEST #	DEPTH	START	BREAK 1" DROP	STOP 2" DROP	TIME OF 2ND INCH	P/F/H
10/1/21	21-4	4' 8"	9:25:30	9:58"	1/4" movement		F
10/1/21	21-5	7'	Visual	loamy soils to water			F
10/1/21	21-1	6.5' / 12'	10:19:30	10:21:30	10:25	3.5	P
10/1/21	21-8	6' / 12'	10:52:30	10:55	10:58	3	P
10/1/21	21-2	6'	Visual	rock > 50%			F
10/1/21	21-7	Topo	Visual	stake next to steep bank			F
10/1/21	21-6	3.5'	Visual	rock > 50%			F

brn, grey-br
red-brn
gls, platy
8' brn & grey-br
v gls, platy
35-45% rock

21-8

brn fsl
1 f sbls
0.8' red-brn
9' 2 msbl
1.5' red gsl
1 f sbl
2.5' yel red sl
4' 1 f sbl
4.5' brn & red-brn
gls, platy

REMARKS 21-6 offset 15' uphill from stake

SANITARIAN R Ricker BACKHOE Fogle's OTHERS Brian
TEST HOLES USED IN SDA Ricky & Kevin AVG. PERC TIME Grey-brn SQ. FT/HR
TRENCH WIDTH _____ INLET DEPTH _____ MAX. BOT DEPTH _____ EFFECTIVE SW gls
30-40% rock
12' common mica

AP 570157

15683 Old Frederick

(21-5)

21-4

0.5' red
2.2' brn L, 2' sbk
red-brn sl
1 m sbk
m 2 d (lt. grey)
4.5' yel-red sl
thin platy
common mica
m 1/2 d (lt. grey)
8' water
grey-brn sl
w/ depletions

sewer

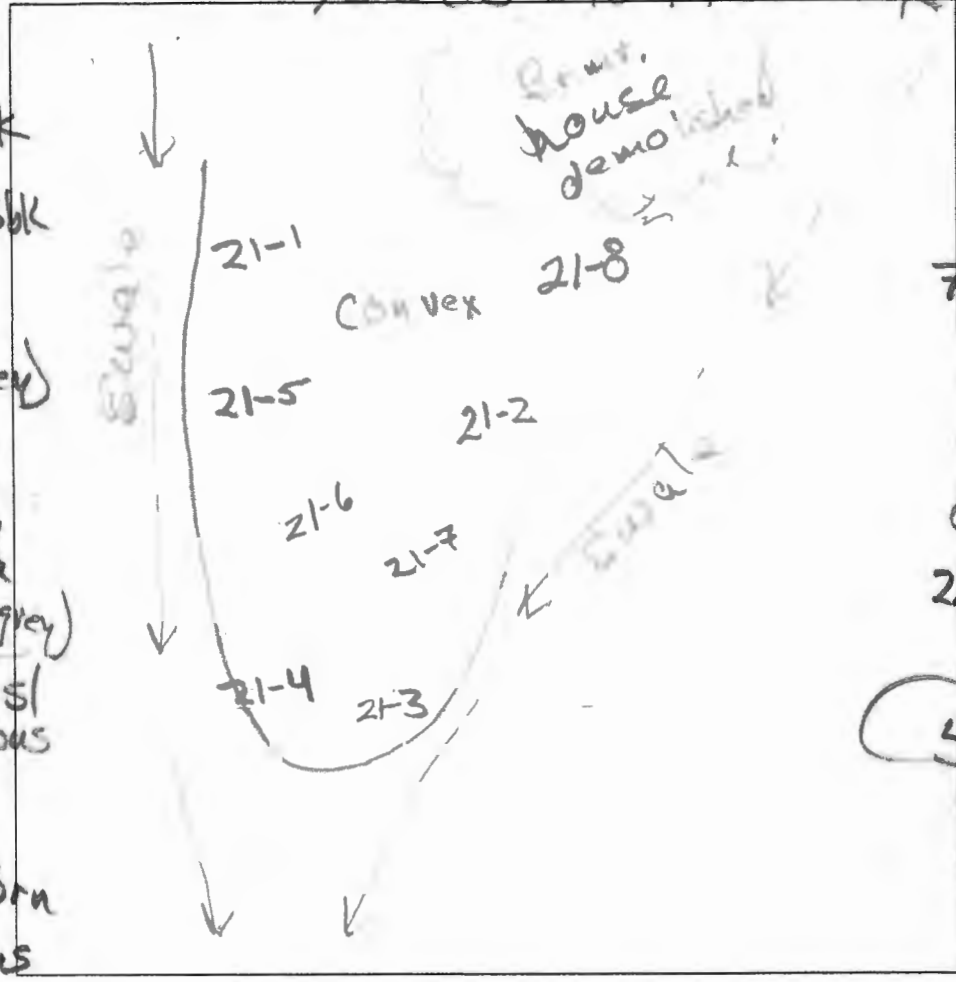

1.3' brn L
red-brn L
4.5' grey-brn
sl to
water
7'

(21-1)

brn L
2' sbk
0.2' red g/s
1' sbk
25' red vels
thick platy
30-40% rock
4' brn g/s
platy, 20-30%
rock

(21-2)

brn & red-brn
& red lenses

brn, grey-brn
& red-brn
g/s, platy
8' brn & grey-brn
v g/s, platy
35-45% rock

3' red-brn
vst sl
35-45% rock
6' > 50% rock
8' STOP

DATE	TEST #	DEPTH	START	BREAK 1" DROP	STOP 2" DROP	TIME OF 2ND INCH	P/F/H
10/1/21	21-4	4' 8"	9:25:30	9:58"	1/4" movement		F
10/1/21	21-5	7'	Visual	loamy soils to water			F
10/1/21	21-1	6.5' / 12'	10:19:30	10:21:30	10:25	3.5	P
10/1/21	21-8	6' / 12'	10:52:30	10:55	10:58	3	P
10/1/21	21-2	6'	Visual	rock > 50%			F
10/1/21	21-7	Topo	Visual	stake next to steep bank			F
10/1/21	21-6	3.5'	Visual	rock > 50%			F

12' (21-8)
brn fsl
1' sbk
0.8' red-brn
9' 2 m sbk
1.5' red g/s
1' sbk
2.5' yel red sl
1' sbk
4.5' brn & red-brn
g/s, platy

REMARKS 21-6 offset 15' uphill from stake

SANITARIAN R. Ricker BACKHOE Fogle's OTHERS Brian Wynne
 TEST HOLES USED IN SDA Ricky & Kevin AVG. PERC TIME Grey-brn SQ. FT/HR v g/s
 TRENCH WIDTH _____ INLET DEPTH _____ MAX. BOT DEPTH _____ EFFECTIVE SW 30-40% rock
12' common mica

October 2021

Perc Cert
proposal

Tenant's House SDA-

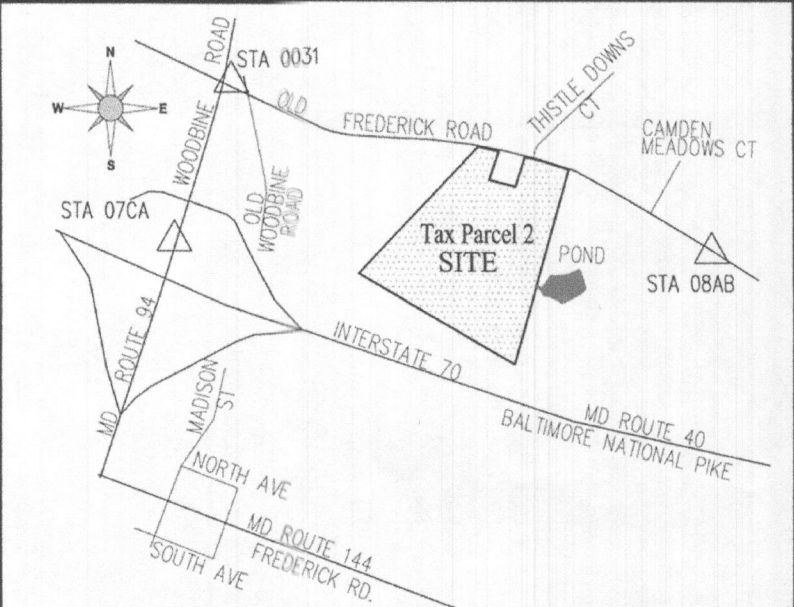

VICINITY MAP
SCALE: 1" = 2,000'
ADC MAP: 4
GRID: C4 & C5

SOILS LEGEND

SOIL	NAME	CLASS
GgA	Glenelig loam, 0 to 3 percent slopes	B
GgB	Glenelig loam, 3 to 8 percent slopes	B
GgC	Glenelig loam, 8 to 15 percent slopes	B
GmB	Glenville silt loam, 3 to 8 percent slopes	C
Mac	Monroe loam, 8 to 15 percent slopes	B

SOILS DELINEATION LINE

LEGEND

- 430 - EXISTING CONTOUR
- 430 - PROPOSED 2-FT CONTOUR
- FB - 100 YEAR FLOODPLAIN
- SB - STREAM BUFFER
- WB - 25' WETLAND BUFFER
- [Pattern] - EXISTING WETLANDS
- [Pattern] - EXISTING FOREST CONSERVATION EASEMENT
- [Symbol] - 1,500 S.F. WELL BOX LOCATION
- [Pattern] - PRIVATE SEWAGE DISPOSAL AREA
- PT-# - PERCOLATION TEST PIT FAILING WET-SEASON TESTING & WATER TABLE OBSERVATION BY HEALTH DEPARTMENT (SP-08-013)
- PT-# - PERCOLATION TEST PIT FAILED BY HEALTH DEPARTMENT (2007, SP-08-013)
- PT-# - PERCOLATION TEST PIT PASSED BY HEALTH DEPARTMENT (2007, SP-08-013)
- 21-# - PERCOLATION TEST HOLES PASSED BY THE HEALTH DEPARTMENT (2021-09)
- 21-# - PERCOLATION TEST HOLES FAILED BY THE HEALTH DEPARTMENT (2021-09)
- [Symbol] - SLOPES 25% AND STEEPER

- NOTES**
- THIS AREA SHOWN WITH [Pattern] DESIGNATES A PRIVATE SEWAGE DISPOSAL AREA AS REQUIRED BY THE MARYLAND DEPARTMENT OF THE ENVIRONMENT FOR INDIVIDUAL SEWAGE DISPOSAL. FOR LOTS CREATED PRIOR TO MARCH OF 1972 IT PROVIDES AT LEAST ENOUGH AREA TO ACCOMMODATE AN INITIAL AND TWO REPLACEMENT SEPTIC SYSTEMS AS REQUIRED BY THE HOWARD COUNTY HEALTH DEPARTMENT. IMPROVEMENTS OF ANY NATURE IN THIS AREA ARE RESTRICTED UNTIL PUBLIC SEWERAGE IS AVAILABLE. THIS AREA SHALL BECOME NULL AND VOID UPON CONNECTION TO A PUBLIC SEWERAGE SYSTEM. THE COUNTY HEALTH OFFICER SHALL HAVE THE AUTHORITY TO GRANT ADJUSTMENTS TO THE PRIVATE SEWAGE AREA. RECONSTRUCTION OF A MODIFIED SEWAGE AREA SHALL NOT BE NECESSARY.
 - TOTAL AREA OF THIS PROPERTY (TAX PARCEL 0002) IS 58.77± ACRES.
 - SEE PLAT 23626-23628 FOR PROPERTY BOUNDARY DESCRIPTION.
 - THIS PROPERTY IS ZONED RC-DEO AND IS UNDER AN EXISTING AGRICULTURAL LAND PRESERVATION EASEMENT (HO-16-01-E) AND HAS A HISTORIC STRUCTURE (the barn in HO-980) TO REMAIN.
 - EXISTING TOPOGRAPHY IS FROM AERIAL TOPOGRAPHY PREPARED BY MCKENZIE SNYDER, INC. ON MAY 15, 2007.
 - EXISTING WELLS, SEPTIC SYSTEMS AND SEWAGE DISPOSAL AREAS WITHIN 100' OF THE PROPOSED IMPROVEMENTS AND THOSE 200' DOWN GRADIENT OF EXISTING OR PROPOSED SEPTIC SYSTEMS OR SEWAGE DISPOSAL AREAS HAVE BEEN SHOWN.

THE PURPOSES FOR THIS REVISED PERCOLATION CERTIFICATION PLAN IS:

- TO ESTABLISH A NEW SEWAGE DISPOSAL AREA FOR NEW TENANT HOUSE ON THIS PARCEL.
- TO ESTABLISH A NEW WELL BOX FOR NEW TENANT HOUSE ON THIS PARCEL.

APPROVED FOR PRIVATE WATER AND PRIVATE SEWAGE SYSTEMS

Michael J. Davis
HEALTH OFFICER, HOWARD COUNTY HEALTH DEPT. 22 RB 11/2/21

GLW
PLANNING | ENGINEERING | SURVEYING
3909 NATIONAL DRIVE | SUITE 250 | BURTONSVILLE, MD 20866 | GLWPA.COM
PHONE: 301-421-4024 | BALT: 410-880-1820 | DC&VA: 301-989-2524 | FAX: 301-421-4166

DESIGNED BY:	DATE	REVISION	BY	APPR.
mbt				
DRAWN BY:				
kfp				
CHECKED BY:				
ckg				

PREPARED FOR:

OWNER:
BRYAN WYNNE
2065 HIGHWAY 174 UNIT 1203
INDIAN HARBOUR BEACH,
FLORIDA 32937
wynnebrian65@gmail.com

PROFESSIONAL CERTIFICATION

I HEREBY CERTIFY THAT THESE PLANS WERE PREPARED OR APPROVED BY ME, AND THAT I AM A DULY LICENSED PROFESSIONAL ENGINEER UNDER THE LAWS OF THE STATE OF MARYLAND, LICENSE NO. 129275.

EXPIRATION DATE: MAY 26, 2022

10/18/21

REVISED PERCOLATION CERTIFICATION PLAN

WYNNE PROPERTY
TAX PARCEL 2
15683 Old Frederick Road and 15685 Old Frederick Road
PLAT No. 23626-23628

SCALE: 1" = 50'
ZONING: RC-DEO
G. L. W. FILE No.: 21020

DATE: OCT. 2021
TAX MAP - GRID: 8-1
SHEET: 1 OF 2

ELECTION DISTRICT No. 4
HOWARD COUNTY, MARYLAND



TEST PIT	ELEV	TEST PIT	ELEV	TEST PIT	ELEV
PT 1A	574.50	PT 100	574.50	PT 199	574.50
PT 1B	574.50	PT 101	574.50	PT 200	574.50
PT 1C	574.50	PT 102	574.50	PT 201	574.50
PT 1D	574.50	PT 103	574.50	PT 202	574.50
PT 1E	574.50	PT 104	574.50	PT 203	574.50
PT 1F	574.50	PT 105	574.50	PT 204	574.50
PT 1G	574.50	PT 106	574.50	PT 205	574.50
PT 1H	574.50	PT 107	574.50	PT 206	574.50
PT 1I	574.50	PT 108	574.50	PT 207	574.50
PT 1J	574.50	PT 109	574.50	PT 208	574.50
PT 1K	574.50	PT 110	574.50	PT 209	574.50
PT 1L	574.50	PT 111	574.50	PT 210	574.50
PT 1M	574.50	PT 112	574.50	PT 211	574.50
PT 1N	574.50	PT 113	574.50	PT 212	574.50
PT 1O	574.50	PT 114	574.50	PT 213	574.50
PT 1P	574.50	PT 115	574.50	PT 214	574.50
PT 1Q	574.50	PT 116	574.50	PT 215	574.50
PT 1R	574.50	PT 117	574.50	PT 216	574.50
PT 1S	574.50	PT 118	574.50	PT 217	574.50
PT 1T	574.50	PT 119	574.50	PT 218	574.50
PT 1U	574.50	PT 120	574.50	PT 219	574.50
PT 1V	574.50	PT 121	574.50	PT 220	574.50
PT 1W	574.50	PT 122	574.50	PT 221	574.50
PT 1X	574.50	PT 123	574.50	PT 222	574.50
PT 1Y	574.50	PT 124	574.50	PT 223	574.50
PT 1Z	574.50	PT 125	574.50	PT 224	574.50
PT 2A	574.50	PT 126	574.50	PT 225	574.50
PT 2B	574.50	PT 127	574.50	PT 226	574.50
PT 2C	574.50	PT 128	574.50	PT 227	574.50
PT 2D	574.50	PT 129	574.50	PT 228	574.50
PT 2E	574.50	PT 130	574.50	PT 229	574.50
PT 2F	574.50	PT 131	574.50	PT 230	574.50
PT 2G	574.50	PT 132	574.50	PT 231	574.50
PT 2H	574.50	PT 133	574.50	PT 232	574.50
PT 2I	574.50	PT 134	574.50	PT 233	574.50
PT 2J	574.50	PT 135	574.50	PT 234	574.50
PT 2K	574.50	PT 136	574.50	PT 235	574.50
PT 2L	574.50	PT 137	574.50	PT 236	574.50
PT 2M	574.50	PT 138	574.50	PT 237	574.50
PT 2N	574.50	PT 139	574.50	PT 238	574.50
PT 2O	574.50	PT 140	574.50	PT 239	574.50
PT 2P	574.50	PT 141	574.50	PT 240	574.50
PT 2Q	574.50	PT 142	574.50	PT 241	574.50
PT 2R	574.50	PT 143	574.50	PT 242	574.50
PT 2S	574.50	PT 144	574.50	PT 243	574.50
PT 2T	574.50	PT 145	574.50	PT 244	574.50
PT 2U	574.50	PT 146	574.50	PT 245	574.50
PT 2V	574.50	PT 147	574.50	PT 246	574.50
PT 2W	574.50	PT 148	574.50	PT 247	574.50
PT 2X	574.50	PT 149	574.50	PT 248	574.50
PT 2Y	574.50	PT 150	574.50	PT 249	574.50
PT 2Z	574.50	PT 151	574.50	PT 250	574.50
PT 3A	574.50	PT 152	574.50	PT 251	574.50
PT 3B	574.50	PT 153	574.50	PT 252	574.50
PT 3C	574.50	PT 154	574.50	PT 253	574.50
PT 3D	574.50	PT 155	574.50	PT 254	574.50
PT 3E	574.50	PT 156	574.50	PT 255	574.50
PT 3F	574.50	PT 157	574.50	PT 256	574.50
PT 3G	574.50	PT 158	574.50	PT 257	574.50
PT 3H	574.50	PT 159	574.50	PT 258	574.50
PT 3I	574.50	PT 160	574.50	PT 259	574.50
PT 3J	574.50	PT 161	574.50	PT 260	574.50
PT 3K	574.50	PT 162	574.50	PT 261	574.50
PT 3L	574.50	PT 163	574.50	PT 262	574.50
PT 3M	574.50	PT 164	574.50	PT 263	574.50
PT 3N	574.50	PT 165	574.50	PT 264	574.50
PT 3O	574.50	PT 166	574.50	PT 265	574.50
PT 3P	574.50	PT 167	574.50	PT 266	574.50
PT 3Q	574.50	PT 168	574.50	PT 267	574.50
PT 3R	574.50	PT 169	574.50	PT 268	574.50
PT 3S	574.50	PT 170	574.50	PT 269	574.50
PT 3T	574.50	PT 171	574.50	PT 270	574.50
PT 3U	574.50	PT 172	574.50	PT 271	574.50
PT 3V	574.50	PT 173	574.50	PT 272	574.50
PT 3W	574.50	PT 174	574.50	PT 273	574.50
PT 3X	574.50	PT 175	574.50	PT 274	574.50
PT 3Y	574.50	PT 176	574.50	PT 275	574.50
PT 3Z	574.50	PT 177	574.50	PT 276	574.50
PT 4A	574.50	PT 178	574.50	PT 277	574.50
PT 4B	574.50	PT 179	574.50	PT 278	574.50
PT 4C	574.50	PT 180	574.50	PT 279	574.50
PT 4D	574.50	PT 181	574.50	PT 280	574.50
PT 4E	574.50	PT 182	574.50	PT 281	574.50
PT 4F	574.50	PT 183	574.50	PT 282	574.50
PT 4G	574.50	PT 184	574.50	PT 283	574.50
PT 4H	574.50	PT 185	574.50	PT 284	574.50
PT 4I	574.50	PT 186	574.50	PT 285	574.50
PT 4J	574.50	PT 187	574.50	PT 286	574.50
PT 4K	574.50	PT 188	574.50	PT 287	574.50
PT 4L	574.50	PT 189	574.50	PT 288	574.50
PT 4M	574.50	PT 190	574.50	PT 289	574.50
PT 4N	574.50	PT 191	574.50	PT 290	574.50
PT 4O	574.50	PT 192	574.50	PT 291	574.50
PT 4P	574.50	PT 193	574.50	PT 292	574.50
PT 4Q	574.50	PT 194	574.50	PT 293	574.50
PT 4R	574.50	PT 195	574.50	PT 294	574.50
PT 4S	574.50	PT 196	574.50	PT 295	574.50
PT 4T	574.50	PT 197	574.50	PT 296	574.50
PT 4U	574.50	PT 198	574.50	PT 297	574.50
PT 4V	574.50	PT 199	574.50	PT 298	574.50
PT 4W	574.50	PT 200	574.50	PT 299	574.50
PT 4X	574.50	PT 201	574.50	PT 300	574.50

APPROVED FOR PRIVATE WATER AND PRIVATE SEWAGE SYSTEMS
 [Signature] 11/2/21
 HEALTH OFFICER, HOWARD COUNTY HEALTH DEPT.

GLW
 PLANNING | ENGINEERING | SURVEYING
 3909 NATIONAL DRIVE | SUITE 250 | BURTONSVILLE, MD 20886 | GLWPA.COM
 PHONE: 301-421-4024 | BALT: 410-880-1820 | DC&VA: 301-989-2524 | FAX: 301-421-4186

DESIGNED BY:	DATE	REVISION	BY	APP'R
mbt				
klp				
ckg				

PREPARED FOR:
 OWNER:
 BRIAN WYNNE
 2065 HIGHWAY A4 UNIT 1201
 INDIAN HARBOUR BEACH,
 FLORIDA 32937
 wynnearian5@gmail.com

PROFESSIONAL CERTIFICATION
 I HEREBY CERTIFY THAT THESE PLANS
 WERE PREPARED OR APPROVED BY
 ME, AND THAT I AM A DULY LICENSED
 PROFESSIONAL ENGINEER UNDER THE
 LAWS OF THE STATE OF MARYLAND,
 LICENSE NO. 12876.
 EXPIRATION DATE: MAY 28, 2022
 10/18/21



REVISED PERCOLATION CERTIFICATION PLAN
WYNNE PROPERTY
TAX PARCEL 2
 15683 Old Frederick Road and 15685 Old Frederick Road
 PLAT No. 23626-23628
 ELECTION DISTRICT No. 4
 HOWARD COUNTY, MARYLAND

SCALE	ZONING	G. L. W. FILE No.
1" = 100'	RC-DEO	21020
DATE	TAX MAP - GRID	SHEET
OCT. 2021	8-1	2 OF 2

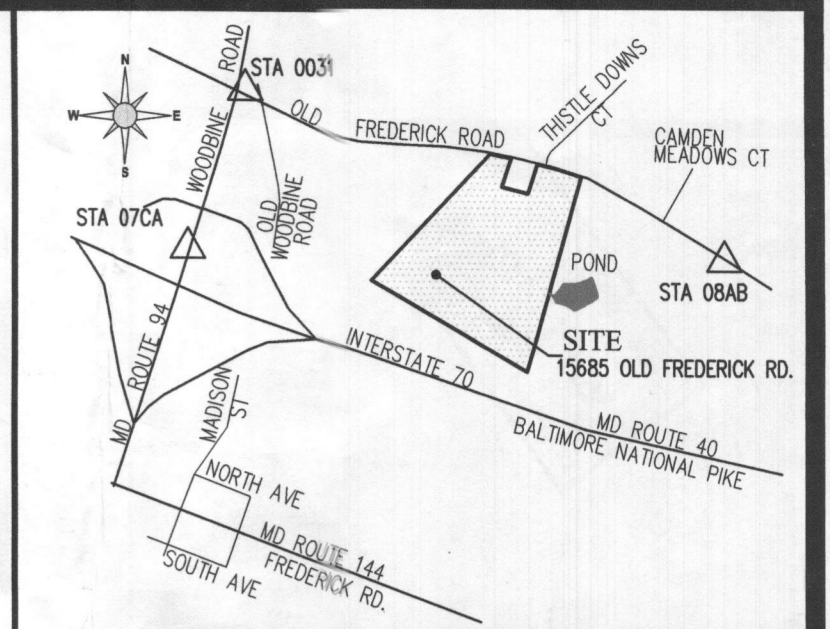

VICINITY MAP
SCALE: 1" = 2,000'
ADC MAP: 4
GRID: C4 & C5

SOILS LEGEND

SOIL	NAME	CLASS
GgA	Clerely loam, 0 to 3 percent slopes	B
GgB	Clerely loam, 3 to 8 percent slopes	B
GgC	Clerely loam, 8 to 15 percent slopes	B
GmB	Clerely silt loam, 3 to 8 percent slopes	C
MaC	Manor loam, 8 to 15 percent slopes	B

SOILS DELINEATION LINE

LEGEND

- 4.30 --- EXISTING CONTOUR
- 4.30 --- PROPOSED 2-FT CONTOUR
- FB --- 100 YEAR FLOODPLAIN
- SB --- STREAM BUFFER
- WB --- 25' WETLAND BUFFER
- [Pattern] --- EXISTING WETLANDS
- [Pattern] --- EXISTING FOREST CONSERVATION EASEMENT
- [Pattern] --- PROPOSED 1,500 S.F. WELL BOX LOCATION
- [Pattern] --- PROPOSED PRIVATE SEWAGE DISPOSAL AREA
- PT-4 [Symbol] --- PERCOLATION TEST PIT REQUIRING WET-SEASON TESTING & WATER TABLE OBSERVATION BY HEALTH DEPARTMENT (SP-08-013)
- PT-4 [Symbol] --- PERCOLATION TEST PIT FAILED BY HEALTH DEPARTMENT (2007, SP-08-013)
- PT-4 [Symbol] --- PERCOLATION TEST PIT PASSED BY HEALTH DEPARTMENT (2007, SP-08-013)
- 21-4 [Symbol] --- PROPOSED PERCOLATION TEST HOLES: 21-1 through 21-4 are primary 21-7 and 21-8 are alternates
- [Symbol] --- SLOPES 25% AND STEEPER

- NOTES**
- THIS AREA SHOWN WITH [Pattern] DESIGNATES A PRIVATE SEWAGE AREA AS REQUIRED BY THE MARYLAND DEPARTMENT OF THE ENVIRONMENT FOR INDIVIDUAL SEWAGE DISPOSAL. FOR LOTS CREATED PRIOR TO MARCH OF 1972 IT PROVIDES AT LEAST ENOUGH AREA TO ACCOMMODATE AN INITIAL AND TWO REPLACEMENT SEPTIC SYSTEMS AS REQUIRED BY THE HOWARD COUNTY HEALTH DEPARTMENT. IMPROVEMENTS OF ANY NATURE IN THIS AREA ARE RESTRICTED UNTIL PUBLIC SEWERAGE IS AVAILABLE. THIS AREA SHALL BECOME WELL AND VOID UPON CONNECTION TO A PUBLIC SEWERAGE SYSTEM. THE COUNTY HEALTH OFFICER SHALL HAVE THE AUTHORITY TO GRANT ADJUSTMENTS TO THE PRIVATE SEWAGE AREA. RECORDED OF A MODIFIED SEWAGE AREA SHALL NOT BE NECESSARY.
 - TOTAL AREA OF THIS PROPERTY (TAX PARCEL 0002) IS 58.77± ACRES.
 - SEE PLAT 23626-23628 FOR PROPERTY BOUNDARY DESCRIPTION.
 - THIS PROPERTY IS ZONED RC-DEO AND IS UNDER AN EXISTING AGRICULTURAL LAND PRESERVATION EASEMENT (HO-16-01-E) AND HAS A HISTORIC STRUCTURE (the barn in HO-980) TO REMAIN.
 - EXISTING TOPOGRAPHY IS FROM AERIAL TOPOGRAPHY PREPARED BY MCKENZIE SNYDER, INC. ON MAY 15, 2007.
 - EXISTING WELLS, SEPTIC SYSTEMS AND SEWAGE DISPOSAL AREAS WITHIN 100' OF THE PROPOSED IMPROVEMENTS AND THOSE 200' DOWN GRADIENT OF EXISTING OR PROPOSED SEPTIC SYSTEMS OR SEWAGE DISPOSAL AREAS HAVE BEEN SHOWN.

THE PURPOSES FOR THIS REVISED PERCOLATION CERTIFICATION PLAN IS:

- TO ESTABLISH A NEW SEWAGE DISPOSAL AREA FOR NEW TENANT HOUSE ON THIS PARCEL.
- TO ESTABLISH A NEW WELL BOX FOR NEW TENANT HOUSE ON THIS PARCEL.

APPROVED FOR PRIVATE WATER AND PRIVATE SEWAGE SYSTEMS

HEALTH OFFICER, HOWARD COUNTY HEALTH DEPT. _____ DATE _____

GLW
PLANNING | ENGINEERING | SURVEYING

3909 NATIONAL DRIVE | SUITE 250 | BURTONSVILLE, MD 20866 | GLWPA.COM
PHONE: 301-421-4024 | BALT: 410-880-1820 | DC&VA: 301-989-2524 | FAX: 301-421-4186

DESIGNED BY:	DATE	REVISION	BY	APPR.
mbt				
DRAWN BY:				
cktp				
CHECKED BY:				
ckg				

PREPARED FOR:

OWNER:
BRYAN WYNNE
2065 HIGHWAY A1A UNIT 1201
INDIAN HARBOUR BEACH,
FLORIDA 32937
wynnestar65@gmail.com

PROFESSIONAL CERTIFICATION

I HEREBY CERTIFY THAT THESE PLANS WERE PREPARED OR APPROVED BY ME, AND THAT I AM A DULY LICENSED PROFESSIONAL ENGINEER UNDER THE LAWS OF THE STATE OF MARYLAND, LICENSE NO. 12975.

EXPIRATION DATE: MAY 26, 2022

REVISED PERCOLATION CERTIFICATION PLAN

WYNNE PROPERTY
TAX PARCEL 2
15683 Old Frederick Road and 15685 Old Frederick Road
PLAT No. 23626-23628

ELECTION DISTRICT No. 4

HOWARD COUNTY, MARYLAND

SCALE	ZONING	G. L. W. FILE No.
1" = 50'	RC-DEO	21020
DATE	TAX MAP - GRID	SHEET
SEPT. 2021	8-1	1 OF 2