

LAYOUT _____ INSP 4 _____
 INSP 2 _____ INSP 5 _____
 INSP 3 _____ INSP 6 _____

ISSUE DATE: 2/9/11

PERMIT

P 534468
 A 511556

APPROVAL DATE: _____

Tax ID # 05-433754
ON-SITE SEWAGE DISPOSAL SYSTEM
HOWARD COUNTY HEALTH DEPARTMENT
BUREAU OF ENVIRONMENTAL HEALTH

Fogles Septic Clean Inc. IS PERMITTED TO INSTALL ALTER

ADDRESS: 580 Obrecht Rd Sykesville MD 21784 PHONE NUMBER: 410-795-5070

SUBDIVISION: Thaler Estates LOT NUMBER: 2

ADDRESS: 13550 Triadelphia Mill Road PROPERTY OWNER: GYC Group LTD

SEPTIC TANK CAPACITY (GALLONS): 2000 OUTLET BAFFLE FILTER REQUIRED

PUMP CHAMBER CAPACITY (GALLONS): 2000 COMPARTMENTED TANK REQUIRED

NUMBER OF BEDROOMS: 5 APPLICATION RATE: 1.2

SQUARE FOOTAGE OF HOUSE: Unkwn

LINEAR FEET OF TRENCH REQUIRED: 150'

| | |
|-----------|--|
| TRENCHES: | Trenches to be 2.0 feet wide. Inlet 4.0 feet below original grade. Bottom maximum depth 7.0 feet below original grade. Effective area begins at 4.5 feet below original grade with 3.0 feet of stone below distribution pipe. |
| LOCATION: | Set septic tank per plan Set distribution box at north septic reserve boundary, about 33 feet off of driveway. Install 3 x 50' trenches on contour. |
| NOTES: | Do not order the septic tank until after layout inspection and Sanitarian approval. Stake easement corners. Call for layout inspection. Mark utilities. Gravel tickets must be available for Environmental Sanitarians. Stone must be approved by the Howard County Health Department. A written variance request is required for tanks deeper than 3 feet. A traffic bearing lid is required for tanks deeper than 4 feet. <u>*Force main within 50' of existing or proposed well location must be fused HDPE or encased in concrete.</u> *Pump and alarm must pass inspection for final approval. * |

PLANS APPROVED: Robert Bricker DATE: 1/31/11

- NOTE: PERMIT VOID AFTER 2 YEARS
- NOTE: CONTRACTOR RESPONSIBLE FOR SCHEDULING A PRE-CONSTRUCTION INSPECTION FOR ALL INSTALLATIONS
- NOTE: WATERTIGHT SEPTIC TANKS REQUIRED
- NOTE: ALL PARTS OF SEPTIC SYSTEM SHALL BE 100 FEET FROM ANY WATER WELL
- NOTE: MANHOLE RISERS REQUIRED ON ALL SEPTIC TANKS AND PUMP CHAMBERS

NEITHER THE HOWARD COUNTY COUNCIL OR THE HEALTH DEPARTMENT IS RESPONSIBLE FOR THE SUCCESSFUL OPERATION OF ANY SYSTEM
PERMITTEE RESPONSIBLE FOR OBTAINING FINAL APPROVAL ON THIS PERMIT
CALL 410-313-1771 FOR INSPECTION OF SEPTIC SYSTEM

NOT TO SCALE

See As-Built Drawing
On Separate Sheet

ROAD NAME

TRENCH/DRAINFIELD DATA

| WIDTH | INLET | BOTTOM |
|-------------------------------|-------|--------|
| 2' | 4' | 7' |
| NUMBER OF TRENCHES 3 | | |
| TOTAL LENGTH 150' | | |
| ABSORPTION AREA 375 | | |
| DISTRIBUTION BOX LEVEL Yes | | |
| DISTRIBUTION BOX BAFFLE Elbow | | |
| DISTRIBUTION BOX PORT Yes | | |

SEPTIC TANK DATA

| | |
|---------------------|------------|
| SEPTIC TANK I LEVEL | Yes |
| MANUFACTURER | Babylon |
| CAPACITY | 2000 GAL |
| SEAM LOC | Top |
| TANK LID DEPTH | 1'-2.5' |
| BAFFLES | Yes |
| BAFFLE FILTER | N/A |
| MANHOLE LOC | Front/Rear |
| 6" PORT LOC | N/A |
| WATERTIGHT TEST | No |
| SLOTTED | No |
| DATE ON LID | 11/10/10 |

PUMP/SEPTIC TANK LEVEL O.K.

| | |
|-----------------|----------|
| MANUFACTURER | Babylon |
| CAPACITY | 2000 GAL |
| SEAM LOC | Top |
| TANK LID DEPTH | 1'-2.5' |
| BAFFLES | Front |
| BAFFLE FILTER | N/A |
| MANHOLE LOC | Rear |
| 6" PORT LOC | Front |
| WATERTIGHT TEST | No |
| SLOTTED | No |
| DATE ON LID | 12/5/10 |

PRE-CONSTRUCTION:

2/10/2011 Set the distribution box near the top middle of the easement and install 3 fifty foot trenches on contour towards the well box. Keep pump line 10+ from the well box. Abandon the septic system attached to the garage. (BB) 2/11/11 Garage and house connections made. Tanks set. Fogles reversed tanks. Pump

INSTALLATION:

Tank is compartmented. Told Fogles to cut out lowest part of partition to make the pump tank a single compartment tank. (BB) 2/15/2010 Part of pump line and septic tanks on adjoining property. Will have to move tanks and part of pump line or move property line. Tanks may be too deep since they will have to be moved uphill. (BB)

FINAL INSPECTOR

DATE OF APPROVAL

13550 Triadelphia
Mill Road

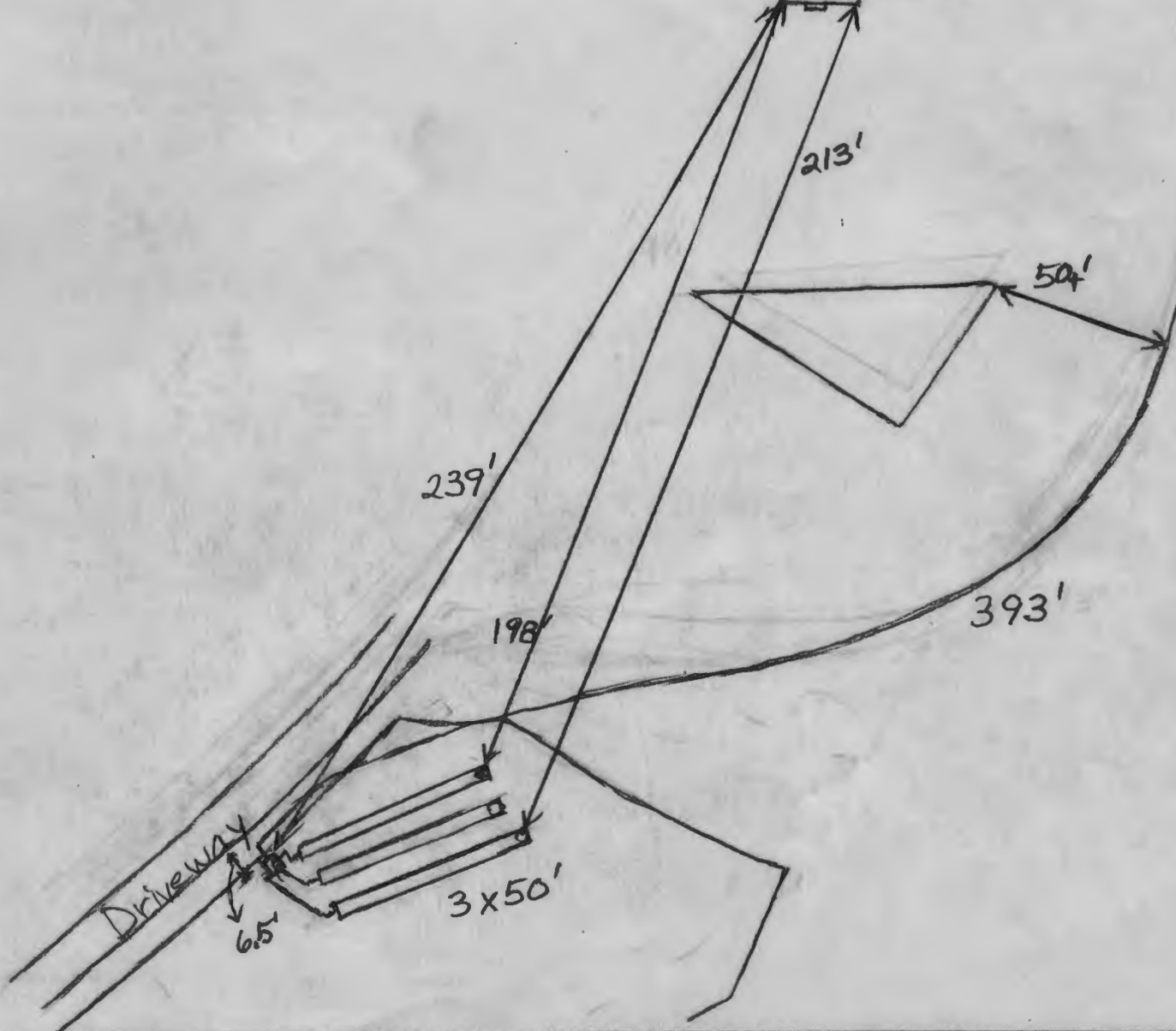
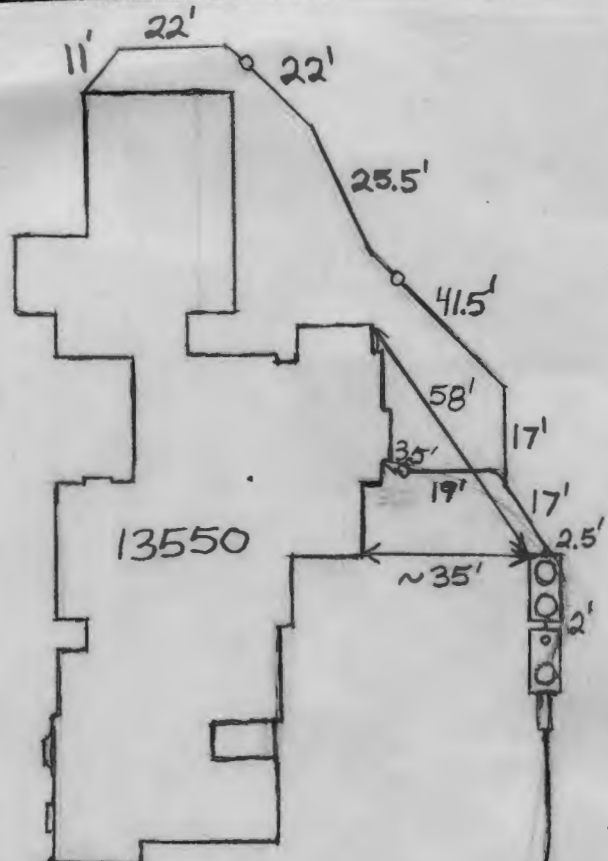

PUB. SEWER STATUS VERIFIED BY _____

ISSUE DATE: _____

APPROVAL DATE: _____

PERMIT INDEXED

P _____

A 511556

*RP#
05-433754*

ON-SITE SEWAGE DISPOSAL SYSTEM HOWARD COUNTY HEALTH DEPARTMENT BUREAU OF ENVIRONMENTAL HEALTH

IS PERMITTED TO INSTALL ALTER

ADDRESS: _____ PHONE NUMBER: _____

SUBDIVISION: Thaler Estates LOT NUMBER: 1

ADDRESS: 13550 Triadelphia Mill Road PROPERTY OWNER: Michael Londner

SEPTIC TANK CAPACITY (GALLONS): _____

PUMP CHAMBER CAPACITY (GALLONS): _____

NUMBER OF BEDROOMS: _____

SQUARE FEET PER BEDROOM: _____

LINEAR FEET OF TRENCH REQUIRED: _____

**BUILDING PERMIT SIGNED
AND RETURNED**

*6403-800142196-GARAGE + ADDITION
6403 Bldg Model - ENLARGE KITCHEN, OFFICE*

| | |
|-----------|---|
| TRENCHES: | Trench to be _____ feet wide. Inlet _____ feet below original grade. Bottom maximum depth _____ feet below original grade. Effective area begins at _____ feet below original grade. _____ feet of stone below distribution pipe. |
| LOCATION: | |
| PURPOSE: | |

PLANS APPROVED: _____ DATE: _____

- NOTE: PERMIT VOID AFTER 2 YEARS
- NOTE: CONTRACTOR RESPONSIBLE FOR SCHEDULING A PRE-CONSTRUCTION INSPECTION FOR ALL INSTALLATIONS
- NOTE: WATERTIGHT SEPTIC TANKS REQUIRED
- NOTE: ALL PARTS OF SEPTIC SYSTEM SHALL BE 100 FEET FROM ANY WATER WELL
- NOTE: MANHOLE RISERS REQUIRED ON ALL SEPTIC TANKS AND PUMP CHAMBERS

**NEITHER THE HOWARD COUNTY COUNCIL NOR THE HEALTH DEPARTMENT IS
RESPONSIBLE FOR THE SUCCESSFUL OPERATION OF ANY SYSTEM
PERMITTEE RESPONSIBLE FOR OBTAINING FINAL APPROVAL ON THIS PERMIT
CALL 410-313-2640 FOR INSPECTION OF SEPTIC SYSTEM**

451155408

Bricker , Robert

From: Bricker , Robert
Sent: Wednesday, March 02, 2011 4:05 PM
To: 'Bruce Burton'
Subject: easement proposal

Bruce,
I tried to contact you by telephone. 410-715-1070 is not responding or I get an automated phone company message, and 301-596-3424 rings but without answer.

Citing COMAR 26.04.03.01(A.) and MDE's interpretation thereof, the proposed easement to accommodate tanks and force-main serving 13550 Triadelphia Mill Road will not be approved by the Health Department. MDE interprets the regulation wording, i.e. "...for the safe disposal of sewerage on each building site" as a requirement for all components of a septic system to be contained within the boundaries of the property on which the structure being served is located. The septic tank, pump tank and force main installed in mid-February will all need to be relocated. Very likely, the force main will need to be re-installed as fusible HDPE where it is located within 50 feet of a proposed or existing well location. Also it seems likely that an ejector pit and pump will be required if there is wastewater flow from the structure's basement. All wastewater generated on the first and second floors are to exit the structure by gravity flow.

Robert Bricker, REHS/RS
Environmental sanitarian Supervisor
Well and Septic Program

410-313-2691