

1 2 3 4 5 6 (THIS NUMBER IS TO BE PUNCHED IN COLS. 3-6 ON ALL CARDS) COUNTY NUMBER

ST/CO USE ONLY DATE RECEIVED MM 10 DD 04 21 DATE WELL COMPLETED MM 09 DD 23 YY 21 Depth of Well 22 300 26 (TO NEAREST FOOT) Approved 2/1/20 PERMIT NO. FROM "PERMIT TO DRILL WELL" HO-20-0128

OWNER Lorenz John WELL SITE ADDRESS 16467 Frederick Rd. TOWN Woodbine SUBDIVISION Stanley Miller Property SECTION 1 LOT 13

WELL LOG
Not required for driven wells

STATE THE KIND OF FORMATIONS PENETRATED, THEIR COLOR, DEPTH, THICKNESS AND IF WATER BEARING

DESCRIPTION (Use additional sheets if needed)	FEET		check if water bearing
	FROM	TO	
Overburden	0	7	
brown / gray shale	7	148	✓
gray shale	148	300	✓

GROUTING RECORD YES NO
WELL HAS BEEN GROUTED (Circle Appropriate Box) Y N
TYPE OF GROUTING MATERIAL (Circle one)
CEMENT CM BENTONITE CLAY BC
NO. OF BAGS 45 46 37 NO. OF POUNDS 45 46 3178
GALLONS OF WATER 222
DEPTH OF GROUT SEAL (to nearest foot)
from 0 ft. to 66 ft.
(enter 0 if from surface)

CASING RECORD
casing types insert appropriate code below
STEEL ST CONCRETE CO
PLASTIC PL OTHER OT
MAIN CASING TYPE
Nominal diameter top (main) casing (nearest inch): 6
Total depth of main casing (nearest foot): 66

OTHER CASING (if used)
diameter inch depth (feet) from to

SCREEN RECORD
screen type or open hole
STEEL ST BRASS BR
BRONZE PL PLASTIC PL
OPEN HOLE HO OTHER OT

NUMBER OF UNSUCCESSFUL WELLS: 0
WELL HYDROFRACTURED YES NO Y N

CIRCLE APPROPRIATE LETTER
A A WELL WAS ABANDONED AND SEALED WHEN THIS WELL WAS COMPLETED
E ELECTRIC LOG OBTAINED
P TEST WELL CONVERTED TO PRODUCTION WELL

I HEREBY CERTIFY THAT THIS WELL HAS BEEN CONSTRUCTED IN ACCORDANCE WITH COMAR 26.04.04 "WELL CONSTRUCTION" AND IN CONFORMANCE WITH ALL CONDITIONS STATED IN THE ABOVE CAPTIONED PERMIT, AND THAT THE INFORMATION PRESENTED HEREIN IS ACCURATE AND COMPLETE TO THE BEST OF MY KNOWLEDGE.

DRILLERS LIC. NO. 1 MWD 548
DRILLERS SIGNATURE
LIC. NO. 1 D

SITE SUPERVISOR (sign. of driller or journeyman responsible for sitework if different from permittee)

C 2 DEPTH (nearest ft.)

1	2	3	4	5	6	7	8	9	10	11	12	13	14	15	16	17	18	19	20	21	22	23	24	25	26	27	28	29	30	31	32	33	34	35	36	37	38	39	40	41	42	43	44	45	46	47	48	49	50	51	52	53	54	55	56	57	58	59	60
---	---	---	---	---	---	---	---	---	----	----	----	----	----	----	----	----	----	----	----	----	----	----	----	----	----	----	----	----	----	----	----	----	----	----	----	----	----	----	----	----	----	----	----	----	----	----	----	----	----	----	----	----	----	----	----	----	----	----	----

SLOT SIZE 1 2 3
DIAMETER OF SCREEN (NEAREST INCH)
66 60
from to

GRAVEL PACK IF WELL DRILLED WAS FLOWING WELL INSERT F IN BOX 68

MDE USE ONLY (NOT TO BE FILLED IN BY DRILLER)
T (E.R.O.S.) W Q
70 72 74 75 76
TELESCOPE CASING LOG INDICATOR OTHER DATA

C 3 PUMPING TEST
HOURS PUMPED (nearest hour) 3
PUMPING RATE (gal. per min.) 12
METHOD USED TO MEASURE PUMPING RATE Watch/bucket
WATER LEVEL (distance from land surface)
BEFORE PUMPING 54 ft.
WHEN PUMPING 75 ft.
TYPE OF PUMP USED (for test)
A air P piston T turbine
C centrifugal R rotary O other (describe below)
J jet S submersible

PUMP INSTALLED
DRILLER INSTALLED PUMP (CIRCLE) (YES or NO) YES NO
IF DRILLER INSTALLS PUMP, THIS SECTION MUST BE COMPLETED FOR ALL WELLS.
TYPE OF PUMP INSTALLED PLACE (A,C,J,P,R,S,T,O) IN BOX 29
CAPACITY: GALLONS PER MINUTE (to nearest gallon) 31 35
PUMP HORSE POWER 37 41
PUMP COLUMN LENGTH (nearest ft.) 43 47
CASING HEIGHT (circle appropriate box and enter casing height) + above } LAND SURFACE (nearest foot)
- below }

LATITUDE 39.33629
LONGITUDE 77.08775
(DEFAULT COORD. WGS 84)

Pursuant to §10-624 of the State Govt. Article of the Maryland Code personal info. requested on this form is used in processing this form pursuant to COMAR 26.04.04. Failure to provide the info. may result in this form not being processed. You have the right to inspect, amend, or correct this form. The Maryland Department of the Environment is subject to the Maryland Public Information Act. This form may be made available on the Internet via MDE's website and is subject to inspection or copying, in whole or in part, by the public and other governmental agencies, if not protected by federal or state law.

B 1 63254 SEQUENCE NO. (MDE USE ONLY) **STATE OF MARYLAND** STATE PERMIT NUMBER HO-20-0128
APPLICATION FOR PERMIT TO DRILL WELL please type 570131 70 79
 fill in this form completely

OWNER INFORMATION
 Date Received (APA) 08/26/21
 8 MM DD YY 13
 15 Last Name Lorenz Owner John First Name
 36 Street or RFD 3 Hillview Drive
 57 Town Catonsville 70 State MD 72 Zip 21228-2238 76

B 3 LOCATION OF WELL
Howard
 8 COUNTY Howard 21
 23 SUBDIVISION Stanley Miller Property 42
 SECTION 1 44 46 LOT 13 48 50
Woodbine
 52 NEAREST TOWN 71

DRILLER INFORMATION
W W Reichart II MW D 548
 76 Driller's Name License No. 81
Wm W Reichart, Inc.
 Firm Name
1772 Baltimore Pike, Hanover, PA 17331
 Address
W W Reichart 08/23/21
 Signature Date

B 4 SOURCES OF DRILLING WATER
 1. Approved Well
 2. 9/22/21
 3. 12 GPM
Static 54
Level 75
Flow 250
100 ft apart

16467 Frederick Rd.
 11 STREET ADDRESS 30
 ON WHICH SIDE OF ROAD (CIRCLE APPROPRIATE BOX)
 NORTH N
 WEST W EAST E
 SOUTH S
 34 1600 37
 DISTANCE FROM ROAD E1
 ENTER FT OR MI 38 39
 TAX MAP: 07 BLK: 10 PARCEL 467

B 2 WELL INFORMATION
 APPROX. PUMPING RATE 5
 1 GAL. PER MIN. 8 12
 AVERAGE DAILY QUANTITY NEEDED 500
 (GAL. PER DAY) 14 20

NOT TO BE FILLED IN BY DRILLER HEALTH DEPARTMENT APPROVAL
Howard 13
 COUNTY NAME COUNTY NO.
 STATE SIGNATURE _____ INSERT S → 41
 DATE ISSUED 09/15/21 James Thomas 9/15/21
 43 MM DD YY 48 CO SIGNATURE EXP. DATE
DRR 9/22/21 (50) DRY 9/22/21

USE FOR WATER (CIRCLE APPROPRIATE BOX)
 DOMESTIC POTABLE SUPPLY & RESIDENTIAL IRRIGATION
 FARMING (LIVESTOCK WATERING & AGRICULTURAL IRRIGATION)
 INDUSTRIAL, COMMERCIAL, DEWATERING
 PUBLIC WATER SUPPLY WELL
 TEST, OBSERVATION, MONITORING
 OPEN LOOP GEOTHERMAL
 CLOSED LOOP GEOTHERMAL

APPROXIMATE DEPTH OF WELL 300 FEET
 24 28
 APPROXIMATE DIAMETER OF WELL 6 NEAREST INCH

PROPOSED LOCATION OF WELL ON LOT
 SHOW PERMANENT STRUCTURES SUCH AS BUILDINGS, SEPTIC SYSTEM, ROADS AND/OR LANDMARKS AND INDICATE NOT LESS THAN TWO DISTANCE MEASUREMENTS TO WELL

METHOD OF DRILLING (circle one)
 BORED (or Augered) JETTED Jetted & DRIVEN
 30 AIR-ROTary AIR-PERCussion ROTARY (Hydraulic Rotary)
 37 CABLE REVerse-ROTary Drive-POINT
 other _____

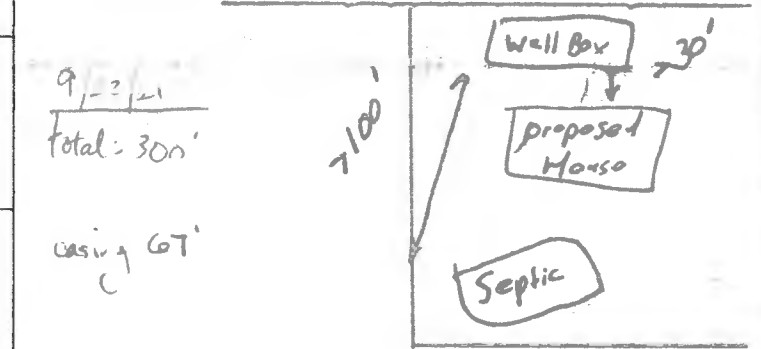

REPLACEMENT OR DEEPEMED WELLS (CIRCLE APPROPRIATE BOX)
 THIS WELL WILL NOT REPLACE AN EXISTING WELL
 THIS WELL WILL REPLACE A WELL THAT WILL BE ABANDONED AND SEALED
 THIS WELL WILL REPLACE A WELL THAT WILL BE USED AS A STANDBY-CONTACT LOCAL APPROVING AUTHORITY FOR POLICY ON STANDBY WELLS
 THIS WELL WILL DEEPEM AN EXISTING WELL
 PERMIT NUMBER OF WELL TO BE REPLACED OR DEEPEMED (IF AVAILABLE) 41 _____ 52

Not to be filled in by driller (MDE OR COUNTY USE ONLY)
 APPROX. PERMIT NUMBER _____ G _____
 PERMIT No. HO-20-0128
 70 71 72 73 74 75 76 77 78 79

Pursuant to § 10-624 of the State Govt. Article of the Maryland Code, personal info requested on this form is used in processing this form pursuant to COMAR 26.04.04. Failure to provide the info may result in this form not being processed. You have the right to inspect, amend, or correct this form. The Maryland Department of the Environment is subject to the Maryland Public Information Act. This form may be made available on the Internet via MDE's website and is subject to inspection or copying, in whole or in part, by the public and other governmental agencies, if not protected by federal or State Law.

B 1 **63254** SEQUENCE NO. (MDE USE ONLY) **STATE OF MARYLAND** STATE PERMIT NUMBER **HO-20-0128**
APPLICATION FOR PERMIT TO DRILL WELL **570131** please type **fill in this form completely**

OWNER INFORMATION
 Date Received (APA) **08/26/21**
 8 MM DD YY 13
 15 **Lorenz** Last Name **John** Owner First Name
 36 **3 Millview Drive** Street or RFD
 57 **Catonsville** Town **MD 21228-2238** State Zip

LOCATION OF WELL
 B 3 **Howard** COUNTY
 23 **Stanley Miller Property** SUBDIVISION
 SECTION **1** LOT **13**
 44 46 48 50
 52 **Woodbine** NEAREST TOWN

DRILLER INFORMATION
 76 **W W Reichart II** Driller's Name **M W D 548** License No.
 Firm Name **Wm W Reichart, Inc.**
 Address **1772 Baltimore Pike, Hanover, PA 17331**
 Signature **[Signature]** Date **08/23/21**

SOURCES OF DRILLING WATER
 1. **Approved Well**
 2. **9/22/21**
 3. **12 GPM Static 51' level 75' pump 250' Cement grout**
 11 **16467 Frederick Rd.** STREET ADDRESS 30
 ON WHICH SIDE OF ROAD (CIRCLE APPROPRIATE BOX)
 NORTH [] WEST [] EAST [] SOUTH []
 34 **1600** DISTANCE FROM ROAD 37
 ENTER FT OR MI **Ft** 38 39
 TAX MAP: **07** BLK: **10** PARCEL **467**

WELL INFORMATION
 1 **2** APPROX. PUMPING RATE **5** (GAL. PER MIN.) 8 12
 AVERAGE DAILY QUANTITY NEEDED **500** (GAL. PER DAY) 14 20

USE FOR WATER (CIRCLE APPROPRIATE BOX)
 DOMESTIC POTABLE SUPPLY & RESIDENTIAL IRRIGATION
 FARMING (LIVESTOCK WATERING & AGRICULTURAL IRRIGATION)
 INDUSTRIAL, COMMERCIAL, DEWATERING
 PUBLIC WATER SUPPLY WELL
 TEST, OBSERVATION, MONITORING
 OPEN LOOP GEOTHERMAL
 CLOSED LOOP GEOTHERMAL

NOT TO BE FILLED IN BY DRILLER HEALTH DEPARTMENT APPROVAL
 COUNTY NAME **Howard** COUNTY NO. **13**
 STATE SIGNATURE **[Signature]** INSERT S → 41
 DATE ISSUED **09/15/21** CO SIGNATURE **[Signature]** EXP. DATE **9/15/21**
 43 MM DD YY 48
DOG: 9/22/21 (SD) DOY: 9/22/21 (SD)

APPROXIMATE DEPTH OF WELL **300** FEET 24 28
 APPROXIMATE DIAMETER OF WELL **6** INCH NEAREST INCH

PROPOSED LOCATION OF WELL ON LOT
 SHOW PERMANENT STRUCTURES SUCH AS BUILDINGS, SEPTIC SYSTEM, ROADS AND/OR LANDMARKS AND INDICATE NOT LESS THAN TWO DISTANCE MEASUREMENTS TO WELL

METHOD OF DRILLING (circle one)
 BORED (or Augered) JETTED Jetted & DRIVEN
 30 AIR-ROTary AIR-PERcussion ROTARY (Hydraulic Rotary)
 37 CABLE REVerse-ROTary DRive-POINT
 other _____

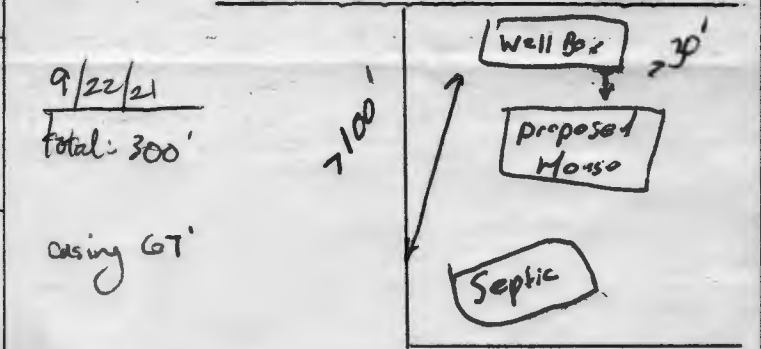

REPLACEMENT OR DEEPEINED WELLS (CIRCLE APPROPRIATE BOX)
 THIS WELL WILL NOT REPLACE AN EXISTING WELL
 THIS WELL WILL REPLACE A WELL THAT WILL BE ABANDONED AND SEALED
 THIS WELL WILL REPLACE A WELL THAT WILL BE USED AS A STANDBY-CONTACT LOCAL APPROVING AUTHORITY FOR POLICY ON STANDBY WELLS
 THIS WELL WILL DEEPEIN AN EXISTING WELL
 PERMIT NUMBER OF WELL TO BE REPLACED OR DEEPEINED (IF AVAILABLE) 41 _____ 52

Not to be filled in by driller (MDE OR COUNTY USE ONLY)
 APPROP. PERMIT NUMBER _____ G _____
 PERMIT No. **HO-20-0128**
 70 71 72 73 74 75 76 77 78 79

Pursuant to § 10-624 of the State Govt. Article of the Maryland Code, personal info requested on this form is used in processing this form pursuant to COMAR 26.04.04. Failure to provide the info may result in this form not being processed. You have the right to inspect, amend, or correct this form. The Maryland Department of the Environment is subject to the Maryland Public Information Act. This form may be made available on the Internet via MDE's website and is subject to inspection or copying, in whole or in part, by the public and other governmental agencies, if not protected by federal or State Law.

William W. Reichart, Inc.
1772 Baltimore Pike
Hanover, PA 17331

Yield Test Data Sheet

Tag # HO-20-0128

Date: 09/22/21

(717)-632-2249

Measuring Point: TOC
Well Depth: 300 ft.
Pump Setting: 200 ft.
Static Water Level: 54 ft.

<u>Time</u>	<u>Water Level (ft.)</u>	<u>Time-1 gallon (sec)</u>	<u>Flow Rate (gpm)</u>	<u>Duration (hr)</u>
8:20	54	5	12	0
8:35	68	5	12	.25
8:50	75	5	12	.5
9:05	75	5	12	.75
9:20	75	5	12	1
9:35	75	5	12	1.25
9:50	75	5	12	1.5
10:05	75	5	12	1.75
10:20	75	5	12	2
10:35	75	5	12	2.25
10:50	75	5	12	2.5
11:05	75	5	12	2.75
11:20	75	5	12	3

65' of sleeve

HOWARD COUNTY HEALTH DEPARTMENT
BUREAU OF ENVIRONMENTAL HEALTH
WELL & SEPTIC PROGRAM
TEL: (410)313-1771 FAX: (410)313-2648

Information Form for the Installation of the Well Pump, Pitless Adapter, and Supply Piping

NOTE: The installer is responsible for requesting an inspection prior to 9 am on the day of the desired inspection. No work is to be covered until approved by the Health Department. All installations must comply with the National Standard Plumbing Code (NSPC, as amended locally) and COMAR 26.04.04 (MD Well Construction Regulations). Submission of a complete form is required prior to Use and Occupancy approval.

Company Name: All Around Plumbing, Inc Telephone #: 301-698-1028
Address: PO Box 3596
Frederick, Md 21701

(Must circle one) Licensed Plumber Licensed Well Driller Licensed Well Pump Installer
License # and name of individual responsible for the field installation:
Name (Print): James B. Madden License# 18121

*A licensed individual must perform the actual installation. Apprentices must be under the supervision of a licensed journeyman or master plumber, pump installer or well driller. Licenses may be subjected to field verification. Unlicensed individuals may be reported to the appropriate licensing agency.

Name of Property Owner: Jasow Shadid Telephone #: 410-493-1782
Subdivision: Stanley Miller Property Lot #: 13 Well Tag #: HO-20-0128 ✓
Site Address: 16467 Frederick Road
Woodbine MD 21797

Submersible Pump Data

Make: Goulds
Model #: 76507422
Pump Capacity: 7 GPM
Well Yield: 12 GPM

Pitless Adapter

Make: Boshart
Model#: P-100-SS
Depth: 36" (36" min)
NSF/WSC approved: Y

Well Cap and Electric Conduit

Two piece watertight cap: Y
Screened, vented well cap: Y
Cap secured to casing: Y
Conduit min 18" B.G.: Y
Conduit secured to well cap: Y

Depth of well encountered at time of pump installation: 300' (feet)
If pump capacity exceeds well yield, a low water cut off switch is required by NSPC 1990 Section 17.8.4

Torque arrestors Cable guards or other acceptable method used- Must circle one
Safety rope, if used, attached to brass rope adapter or other acceptable method inside of well casing

Piping to house

Type: Plastic
PSI: 200 (160 psi min)
Depth of supply line: 36" (36" min)

House Connection

PVC sleeve to undisturbed soil at wall penetration: Y
Length of sleeve (5' minimum from foundation): Y
Sleeve sealed properly: Y

The water supply line is required to be at least ten feet from the septic tank, pump chamber, sewage piping, distribution box, drainfields, and sewage reserve area. If this cannot be accomplished, contact this office for approval prior to installation.

Signature of company representative responsible for installation: Cathy J Little date: 8-3-2023

For Health Department Use Only - Not to be completed by Installer

Date Insp. Requested: 8/4/23 Date Insp. Approved: 8/4/23 Inspector: RR
Inspection Data: Pitless adapter watertight & water supply line at least 36" below grade ✓
Two piece cap installed and attached to casing securely ✓
Elec. conduit extends at least 18" below grade/attached to cap properly ✓
Safety rope not outside of well cap/casing ✓
Correct well tag attached properly and casing 8" above finished grade ✓
Water supply line sleeved adequately at house connection ✓
Adequate grout observed below pitless adapter ✓

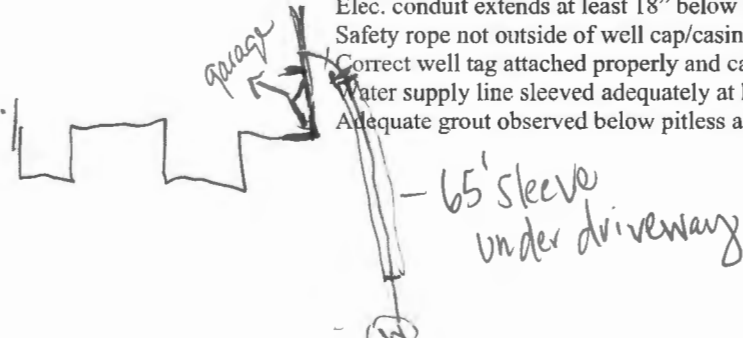

TO ALL INTERESTED PARTIES

When submitting a well permit application for a proposed well for new construction, please indicate one of the following:

Well Site Location:

<u>Stanley Miller Property</u>	<u>13</u>	<u>Frederick Rd</u>
Subdivision/Property Name	Lot#	Road Name

The well site has been staked by Fischer, Collins + Carter
(professional land surveyor or company employing professional land surveyors)
 on _____ (date) and does not require a site inspection.
previously & stakes are still evident.

The well driller, builder or property owner will call the Health Department to schedule a time to meet in the field to verify the proposed well site location.

This sheet, along with two copies of an acceptable well site plan, must be attached to the green well permit application.

Revised 3/16/2021

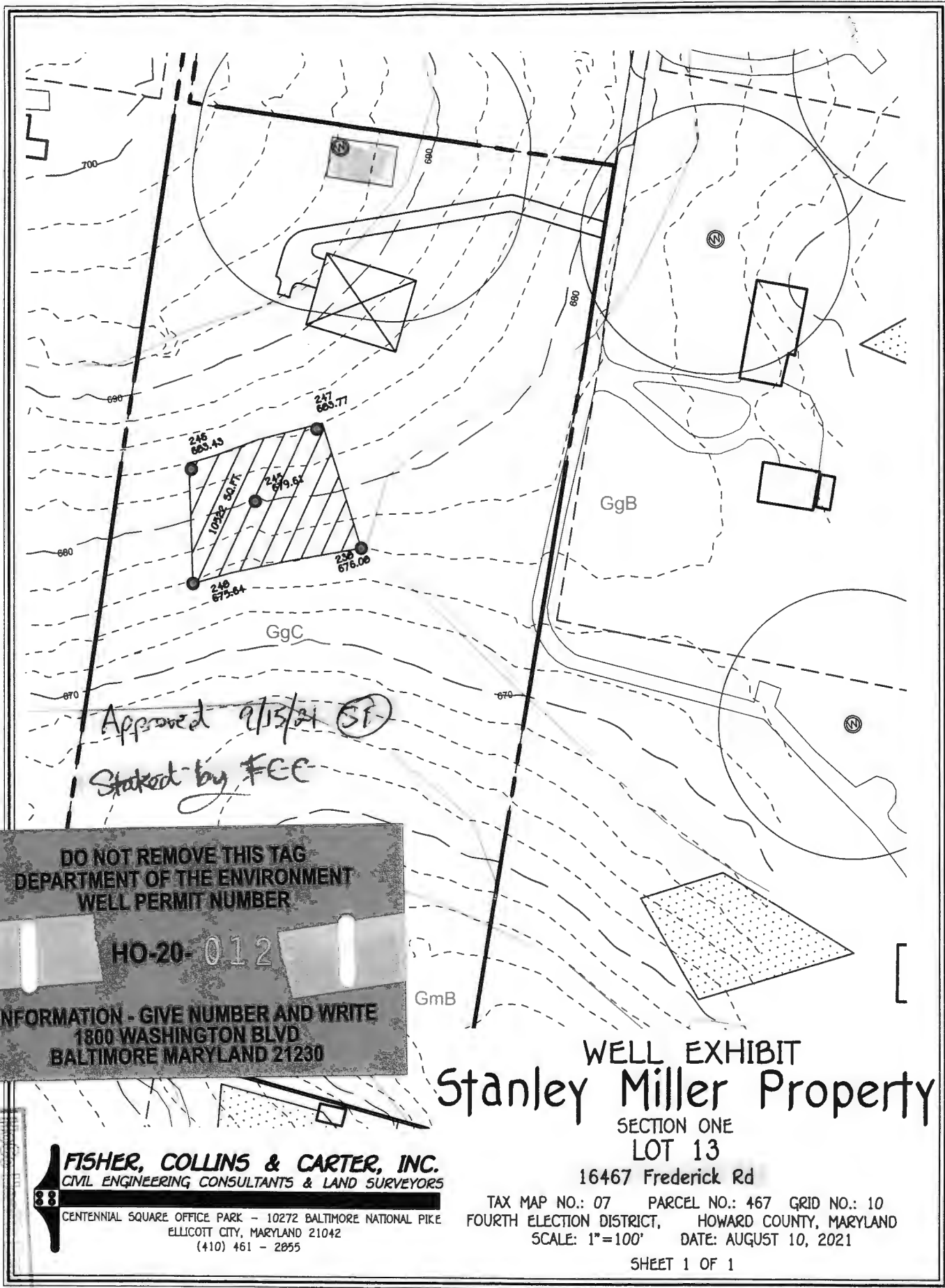

DO NOT REMOVE THIS TAG
DEPARTMENT OF THE ENVIRONMENT
WELL PERMIT NUMBER

HO-20-012

INFORMATION - GIVE NUMBER AND WRITE
1800 WASHINGTON BLVD
BALTIMORE MARYLAND 21230

WELL EXHIBIT
Stanley Miller Property

SECTION ONE
 LOT 13

16467 Frederick Rd

TAX MAP NO.: 07 PARCEL NO.: 467 GRID NO.: 10
 FOURTH ELECTION DISTRICT, HOWARD COUNTY, MARYLAND
 SCALE: 1"=100' DATE: AUGUST 10, 2021

SHEET 1 OF 1

FISHER, COLLINS & CARTER, INC.
 CIVIL ENGINEERING CONSULTANTS & LAND SURVEYORS

33 CENTENNIAL SQUARE OFFICE PARK - 10272 BALTIMORE NATIONAL PIKE
 ELLICOTT CITY, MARYLAND 21042
 (410) 461 - 2055

INTERIM CERTIFICATE OF POTABILITY

Expiration Date – NOVEMBER 20, 2024

May 20, 2024

Homeowner
16467 Frederick Road
Woodbine, MD 21797

**RE: Stanley Miller Property, Lot 13
16467 Frederick Road
Building Permit: B22002733
Well Permit: HO-20-0128**

Dear Homeowner:

This is to advise you that the septic system installation and water well construction for the above referenced property have been inspected and approved. Final approval of the septic system was granted on **8/11/2023**. Final approval of the well line connection to the dwelling was granted on **8/4/2023**. The well construction was completed on **2/7/2022**. Water samples were collected on **4/26/2024, 5/1/2024**.

The water sample results indicate that the water samples submitted for testing were free of coliform and fecal coliform bacteria at the time of sampling and are bacteriologically safe for drinking. This certifies that the initial sampling requirements of COMAR 26.04.04 "Well Regulations" have been met for the water supply system installed under well permit HO-20-0128. Although the submitted sample results are in compliance with COMAR standards, the Health Department does not guarantee water supplies.

This Interim Certificate of Potability will expire **six months** from the date of issuance. Submission of a second bacteriological test indicating the water is free of coliform and fecal coliform bacteria is required prior to the expiration date, after which time a Final Certificate of Potability will be issued. **Failure to submit an additional sample and obtain a Final Certificate of Potability will result in a Notice of Violation and is punishable as a misdemeanor under the *Annotated Code of Maryland, Environment Article, 9-1311*, subject to a fine of up to \$500 or imprisonment not to exceed three months.**

Please contact (410) 313-1773 to schedule a final water sample appointment or contact a Maryland certified water laboratory to schedule a water sample. A list of laboratories certified by the state of Maryland may be found at the following website:
<http://www.mde.state.md.us/assets/document/WSP-Labs-2010apr16.pdf>



Bureau of Environmental Health
8930 Stanford Blvd | Columbia, MD 21045
410.313.2640 - Voice/Relay
410.313.2648 - Fax
1.866.313.6300 - Toll Free

Maura J. Rossman, M.D., Health Officer

In closing, please refer to our "[Homeowner Fact Sheet](#)" which illustrates a better understanding for your Onsite Sewage Disposal System. You will also find a link to Maryland Department of the Environment's website which describes in further detail operation and maintenance of your septic system.

Approving Authority,

A handwritten signature in black ink, appearing to read 'Kevin M. Wolf', is written over a light blue horizontal line.

Kevin M. Wolf, LEHS, R.S./REHS, Supervisor
Groundwater Management Section
Well & Septic Program

cc: Howard County Dept. of Inspections, Licenses, and Permits
Community Hygiene Program
File

3020 VENTRIE COURT
MYERSVILLE, MD 21773



(301) 293-3340
INFO@FTLLAB.COM

Certificate of Analysis
Work order: **FYD0719**

Client:
Lancaster Craftsmen Builders, Inc.
3120 Old National Pike
Middletown, MD 21769-

Project: 16467 Frederick Road
HCHD U&O
Sample Site: Lancaster Craftsmen Builders, Inc.
Sample Address: 16467 Frederick Road
Woodbine, MD 21797

Received at lab: 4/25/24 13:45
Temp: 4.30 deg. C
Reported: 4/26/24 10:36

PWSID:
Treatment: No Treatment Devices ✓
Collected by: Ronald Demory ID:8072RD
Well Tag: HO-20-0128 ✓

Pressure Tank ✓
FYD0719-01 (Drinking Water)(Grab)

Date Collected: 04/25/24 11:10

Field Results

	Result	Units
Temperature	13.8	deg. C
pH	6.1	
Res. Chlorine	<0.1	mg/L
Chlorine, Total	N/A	mg/L

Microbiology

	Result	Units	MRL	MCL	Date Prepared	Date Analyzed	Analyst	Qual	Method
Bacteria - Total Coliform	<1.0 [1] ✓	MPN/100 mL	1.0	1	4/25/24 15:25	4/26/24 10:29	NM	18	9223B
Bacteria - E coli	<1.0 [1] ✓	MPN/100 mL	1.0	1	4/25/24 15:25	4/26/24 10:29	NM	18	9223B

Bacteriological analysis of this sample indicates the water is safe for human consumption and meets federal, state and local requirements. Analysis was performed according to the 23rd edition of Standard Methods

Inorganic

	Result	Units	MRL	MCL	Date Analyzed	Analyst	Qual	Method
Nitrate	1.67 ✓	mg/L	0.20	10	4/25/24 15:51	MW		300.0
Turbidity	0.26 ✓	NTUs	0.10	9.99	4/25/24 15:06	NM		180.1

Notes and Definitions

Item	Definition
18	Sample started using 18 hour media.

Sara E. Randall
Sara E. Randall, President

Fredericktowne Labs, Inc. is a State Certified Water Quality Laboratory
Maryland Cert. No. 116 Virginia Cert. No. 00444
West Virginia Cert. 415 MDOT WBE Cert. No.: 91-158

3020 VENTRIE COURT
MYERSVILLE, MD 21773



(301) 293-3340
INFO@FT.LAB.COM

Certificate of Analysis

Work order: **FYD0824**

Client:
Lancaster Craftsmen Builders, Inc.
3120 Old National Pike
Middletown, MD 21769-

Project: 16467 Frederick Road
HCHD U&O

Received at lab: 5/1/24 14:35
Temp: 5.80 deg. C
Reported: 5/2/24 13:20

Sample Site: Lancaster Craftsmen Builders, Inc.
Sample Address: 16467 Frederick Road
Woodbine, MD 21797

PWSID:
Treatment: No Treatment Devices
Collected by: Ronald Demory ID:8072RD
Well Tag: HO-20-0128

Pressure Tank
FYD0824-01 (Drinking Water)(Grab)

Date Collected: 05/01/24 13:10

Field Results

	Result	Units
Temperature	N/A	deg. C
pH	N/A	
Res. Chlorine	N/A	mg/L
Chlorine, Total	N/A	mg/L

Inorganic

	Result	Units	MRL	MCL	Date Analyzed	Analyst	Qual	Method
Sand	<2.00	mg/L	2.00	5	5/2/24 13:05	JD		0.065mmFilter

Notes and Definitions

Item	Definition
------	------------

Sara E. Randall
Sara E. Randall, President

Fredericktowne Labs, Inc. is a State Certified Water Quality Laboratory
Maryland Cert. No. 116 Virginia Cert. No. 00444
West Virginia Cert. 415 MDOT WBE Cert. No.: 91-158