



Bureau of Environmental Health
 8930 Stanford Boulevard, Columbia, MD 21045
 Main: 410-313-2640 | Fax: 410-313-2648
 TDD 410-313-2323 | Toll Free 1-866-313-6300
www.hchealth.org
 Facebook: www.facebook.com/hocohealth

Maura J. Rossman, M.D., Health Officer

RECEIPT DATE: 11/23/2023 **ONSITE SEWAGE DISPOSAL SYSTEM** P 575700

APPROVAL DATE: 11/30/2023 **PERMIT: REPAIR - TANK REPL** A _____

PROPERTY ADDRESS: 3234 Sharp Road

SUBDIVISION: Gwenlee Est. LOT: 17 TAX ID: 04-336658

CONTRACTOR: Legacy Septic EMAIL: info@legacyseptic.com

CONTRACTOR ADDRESS: 1538 Manchester Road, Westminster, MD 21157 PHONE: 410-840-8766

PROPERTY OWNER: Mathew Kozora EMAIL: n/a

OWNER ADDRESS: Same as above PHONE: n/a

SEPTIC TANK SIZE: 1500 PUMP SIZE: n/a PUMP TANK CAPACITY: n/a

DISTRIBUTION SYSTEM: GRAVITY LPD BEDROOMS: 3 APPLICATION RATE: n/a

TRENCHES:	LINEAR FEET REQUIRED: <u>n/a</u>	INLET DEPTH: _____
	TRENCH WIDTH: _____	MAXIMUM BOTTOM DEPTH: _____
	MINIMUM SPACE BETWEEN TRENCHES: _____	EFFECTIVE AREA BEGINNING DEPTH: _____
LOCATION:	SYSTEM STAKED BY INSTALLER AND VERIFIED BY APPROVING AUTHORITY DURING PRE-CONSTRUCTION INSPECTION.	
NOTES:	Install new 1500g septic tank per plan.	

ISSUED BY: Kevin M. Wolf, L.E.H.S. ISSUE DATE: 11/23/2023 EXPIRATION DATE: 11/23/2024

- NOTE: CONTRACTOR MUST SCHEDULE A PRE-CONSTRUCTION INSPECTION PRIOR TO BEGINNING ANY INSTALLATION
- NOTE: CONTRACTOR REGISTERED WITH THE STATE OF MD ON-SITE WASTEWATER PROFESSIONALS BOARD: CONFIRMED
- NOTE: CONTRACTOR MUST SCHEDULE AN INSPECTION AND GAIN APPROVAL OF ALL COMPONENTS PRIOR TO COVERING
- NOTE: STONE MUST BE APPROVED BY HEALTH DEPARTMENT AND GRAVEL TICKET MUST BE AVAILABLE FOR REVIEW.
- NOTE: WATERTIGHT SEPTIC TANKS REQUIRED
- NOTE: ALL PARTS OF SEPTIC SYSTEM SHALL BE AT LEAST 100 FEET DOWNGRADIENT FROM ANY WATER WELL
- NOTE: MANHOLE RISERS REQUIRED ON ALL SEPTIC TANKS AND PUMP CHAMBERS
- NOTE: AN ELECTRICAL PERMIT IS REQUIRED FOR INSTALLATION OF ANY ELECTRICAL COMPONENTS OF THE SYSTEM
 ELECTRICAL PERMIT ISSUED E n/a
- NOTE: THE HCHD DOES NOT WARRANTY ANY SYSTEM AND CANNOT GUARANTEE THE PERFORMANCE OF THIS SYSTEM AS DESIGNED. BY ACCEPTING THIS PERMIT, THE OWNER AND/OR APPLICANT ACKNOWLEDGE THAT THE SPECIFICATIONS DETAILED IN THIS DESIGN ARE ONE POSSIBLE OPTION AND THAT THE HCHD WILL REVIEW OTHER PROPOSALS. YOU HAVE THE OPTION TO SEEK THE ADVICE OF A QUALIFIED DESIGN CONSULTANT OR PROFESSIONAL ENGINEER FOR FURTHER GUIDANCE.
- NOTE: AN INDIVIDUAL CERTIFIED BY MDE AND THE MANUFACTURER FOR BAT INSTALLATION MUST BE PRESENT AT ALL TIMES DURING BAT INSTALLATION.
- NOTE: MDE RECOMMENDS SEPTIC TANKS, BAT, AND OTHER PRETREATMENT UNITS BE PUMPED AT A FREQUENCY ADEQUATE TO ENSURE THAT SOLIDS ARE NOT DISCHARGED TO THE DISPOSAL AREA

**NEITHER THE HOWARD COUNTY COUNCIL NOR THE HEALTH DEPARTMENT IS RESPONSIBLE FOR THE SUCCESSFUL OPERATION OF ANY SYSTEM.
 PERMITTEE RESPONSIBLE FOR OBTAINING FINAL APPROVAL ON THIS PERMIT.
 CALL 410-313-1771 TO SCHEDULE INSPECTIONS.**

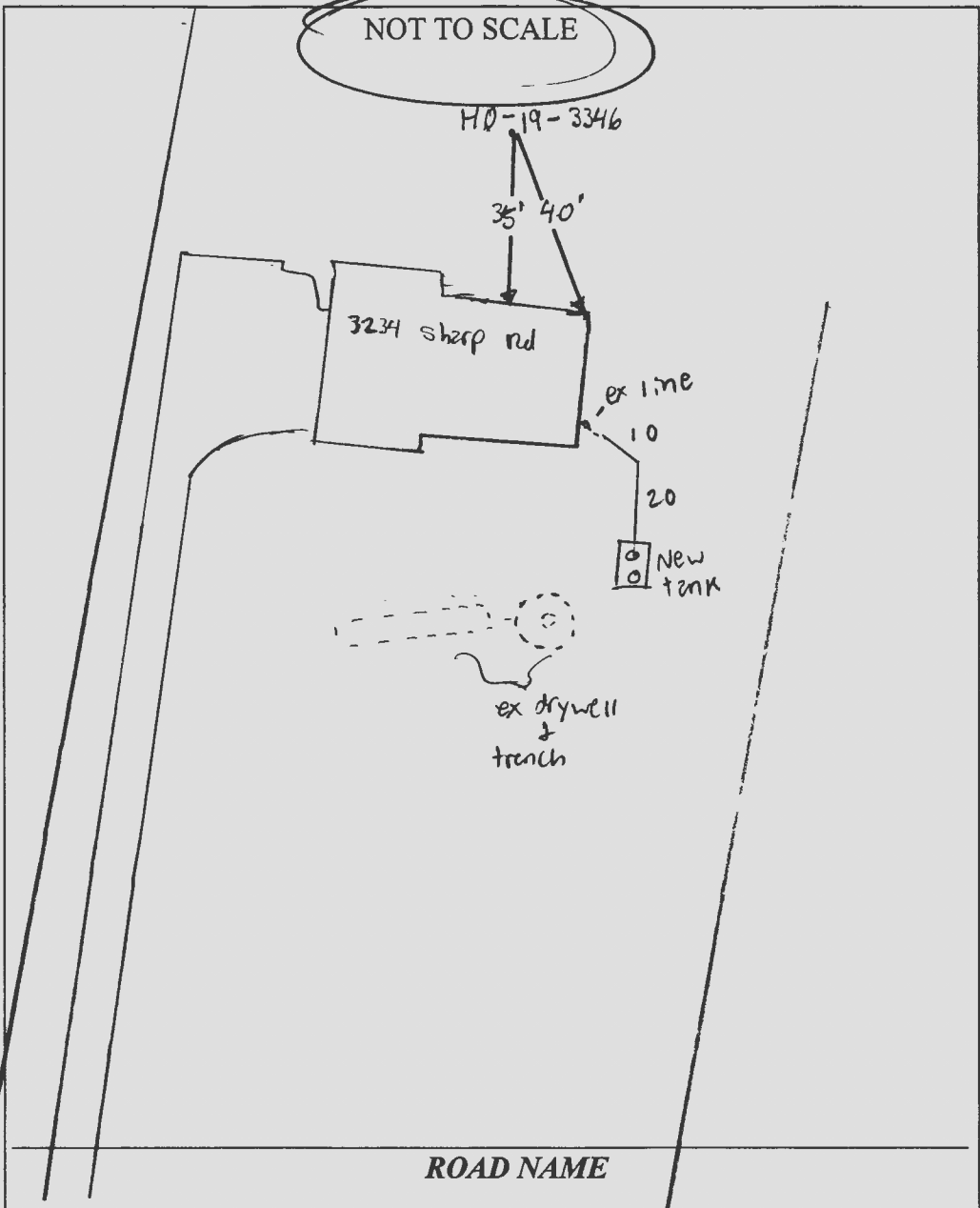

Ex: TRENCH/DRAINFIELD DATA

WIDTH	INLET	BOTTOM
_____	_____	_____
NUMBER OF TRENCHES _____		
TOTAL LENGTH _____		
ABSORPTION AREA _____		
DISTRIBUTION BOX LEVEL _____		
DISTRIBUTION BOX BAFFLE _____		
DISTRIBUTION BOX PORT _____		

SEPTIC TANK DATA

SEPTIC TANK 1 LEVEL yes

MANUFACTURER Babylon

CAPACITY 1500 GAL

SEAM LOC top

TANK LID DEPTH < 3'

BAFFLES 6" front & 4" back

BAFFLE FILTER _____

MANHOLE LOC front & back

6" PORT LOC _____

WATERTIGHT TEST _____

SLOTTED yes

DATE ON LID _____

PUMP/SEPTIC TANK LEVEL N/A

MANUFACTURER _____

CAPACITY _____ GAL

SEAM LOC _____

TANK LID DEPTH _____

BAFFLES _____

BAFFLE FILTER _____

MANHOLE LOC _____

6" PORT LOC _____

WATERTIGHT TEST _____

SLOTTED _____

DATE ON LID _____

SEPTIC CONTRACTOR ONSITE INSTALLING SYTEM: _____

SEPTIC CONTRACTOR ONSITE LICENSED WITH THE STATE OF MD: YES/NO _____

PRE-CONSTRUCTION NOTES:
11/23/2023 - Plan Approved. KW

CONTROL PANEL DATA

CONTROL PANEL HEIGHT _____ (MIN 30")

INSPECTION DATE _____

INSPECTION: PASS/FAIL (CIRCLE ONE) _____

INSTALLATION NOTES:
11/30/2023 - Installer finished connecting existing line to New tank. Pipe used is SCHD 40, w/ adequate fall. SP

FINAL INSPECTOR S. Pree DATE OF APPROVAL 11/30/2023

MATTIE W KOZORA 410-463-6434

installing a Baystar-1500 gal septic tank, 2 compartment
4 Bedroom home

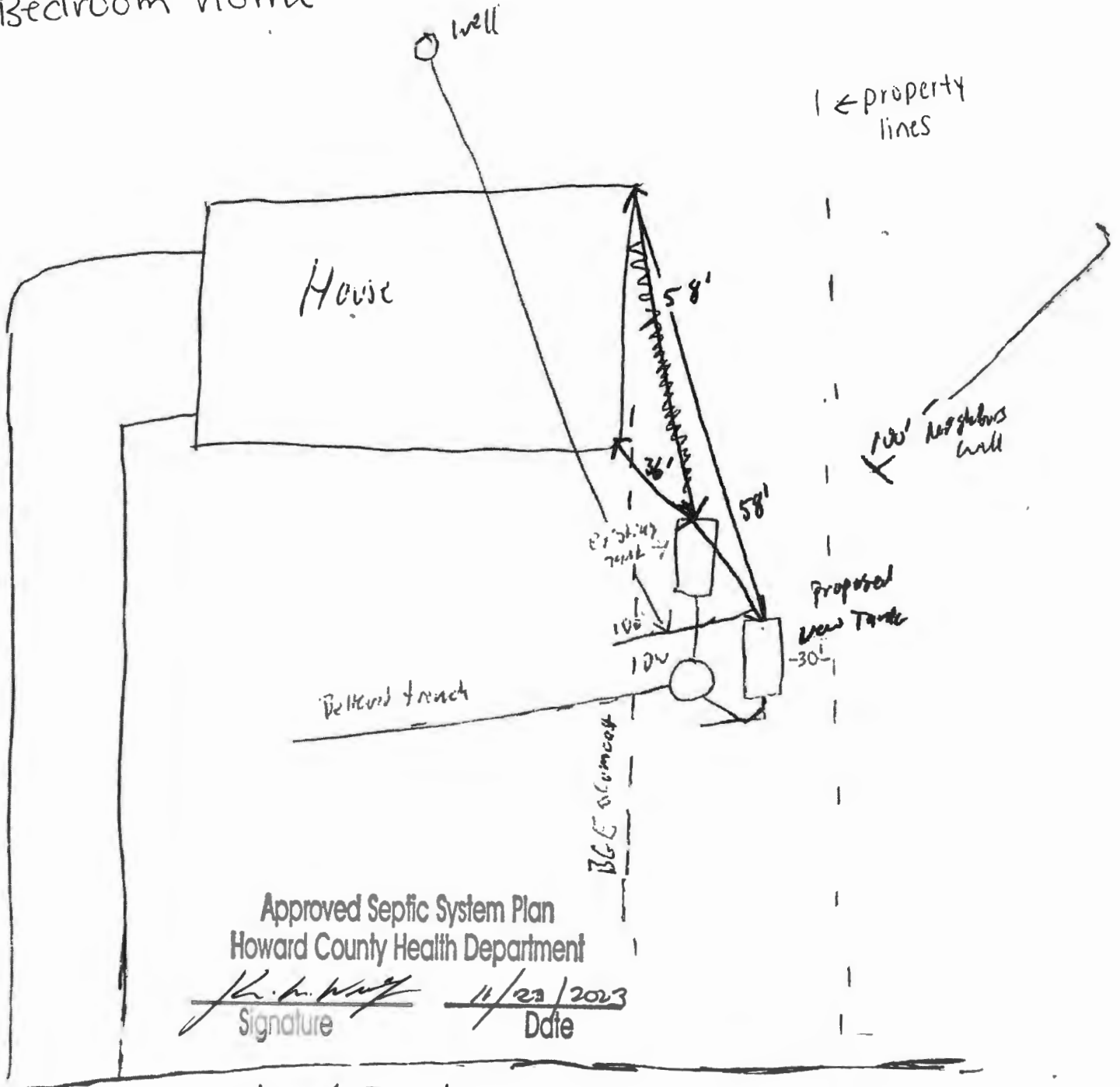

New S.T. only.
(Repair)

3234 Sharp Road

Wolf, Kevin

From: Wolf, Kevin
Sent: Tuesday, November 21, 2023 12:10 PM
To: Danielle Leister
Subject: RE: 3234 Sharp road tank replacement
Attachments: BRWDCE9946F86C9_015784.pdf

Danielle,

I need the property owner information on the plan, total number of bedrooms as well as the new septic tank information (i.e. tank manufacturer, tank size), and distances to the property lines.

Thanks,

Kevin M. Wolf, LEHS, REHS/RS
Groundwater Mgmt. Sec. Supervisor
Well & Septic Program
Howard County Health Department
8930 Stanford Blvd.
Columbia, MD 21045
410-313-2645 (Office)
410-313-2648 (Fax)
www.hchealth.org
kwolf@howardcountymd.gov



twitter.com/HoCoHealth



facebook.com/HoCoHealth



instagram.com/hocohealth

CONFIDENTIALITY NOTICE

This message and the accompanying documents are intended only for the use of the individual or entity to which they are addressed and may contain information that is privileged, confidential, or exempt from disclosure under applicable law. If the reader of this email is not the intended recipient, you are hereby notified that you are strictly prohibited from reading, disseminating, distributing, or copying this communication. If you have received this email in error, please notify the sender immediately and destroy the original transmission.

From: Danielle Leister <dleister@legacyseptic.com>
Sent: Tuesday, November 21, 2023 8:38 AM

To: Wolf, Kevin <KWolf@howardcountymd.gov>

Subject: 3234 Sharp road tank replacement

[Note: This email originated from outside of the organization. Please only click on links or attachments if you know the sender.]

Hi Kevin,

I have attached a copy of the drawing for 3234 Sharp road. Let me know if there is anything else needed for this permit o be issued. Thank you.

Danielle Leister

Legacy Septic & Excavation LLC

410-840-8766

240-372-2744 – text

dleister@legacyseptic.com

www.legacyseptic.com



Service oriented. Community driven.

HOME LAND

ENVIRONMENTAL

p:443-995-5385 | info@homelandhealthyhomes.com | www.homelandhealthyhomes.com



Date: October 16, 2023 Name of Evaluator: Nicholas Riehl Time: 11:30 AM Property Address: 3234 Sharp Road Glenwood, MD 21738 Recent Weather Conditions: Normal	Ordered By: Chrissy Kirk Buyers: Kaitlin & Matt Kozora Homeowner Interview: The homeowner interview was sent and was received prior to the evaluation.	Occupied: <input checked="" type="checkbox"/> Yes <input type="checkbox"/> No Length of Time Vacant: N/A # of People Living in Home: Unknown # of People moving in: Unknown Property Age: 1980 System Age: 1980 & 2012 Last Date of Cleaning: Unknown
Liquid level in tank is: <input type="checkbox"/> Above Normal <input checked="" type="checkbox"/> Normal <input type="checkbox"/> Below Normal		Bottom Solids Depth: 14 Inches
Depth of tank: 28 Inches	Type of Tank Access: Riser	Depth of tank access: At Grade
Maintenance appears: <input type="checkbox"/> Good <input checked="" type="checkbox"/> Fair <input type="checkbox"/> Poor	# of Bedrooms: 4	Depth to Distribution Box: N/A
Effluent Filter present: <input type="checkbox"/> Yes	Previous high liquid level: <input type="checkbox"/> Yes <input checked="" type="checkbox"/> No	Distance to well: ~100 Feet
Records Search: Records were requested and were received from Howard County prior to the evaluation.		
Were there any impermeable surfaces above the septic system (i.e. driveway)? <input type="checkbox"/> Yes <input checked="" type="checkbox"/> No :		
<input checked="" type="checkbox"/> Septic Tank (1 Tank)	<input type="checkbox"/> Metal <input checked="" type="checkbox"/> Concrete <input type="checkbox"/> Plastic	<input checked="" type="checkbox"/> Leaching Field <input type="checkbox"/> Raised Mound
<input type="checkbox"/> Aeration System	Tank Size: 1,000 gallons	<input checked="" type="checkbox"/> Drywell (Number of: 1) <input type="checkbox"/> Cesspool
<input type="checkbox"/> Other:	<input type="checkbox"/> Unknown: _____	
Septic Tank	<input type="checkbox"/> Acceptable <input checked="" type="checkbox"/> Unacceptable <input type="checkbox"/> Needs Further Evaluation	The septic tank appears to be composed of concrete and has approximately 1,000 gallons of total capacity. The septic tank was accessible via a riser at grade. The tank is approximately 28 inches below grade. Currently, there are 14 inches of solids within the tank. The back baffle is in place and composed of PVC. Root intrusion was observed within the front of the tank, outlet seal and through the outlet sidewall. A licensed septic contractor will need to replace the septic tank after permits have been pulled from the local county health department. Please see page 2 and the camera septic report for further information.
Absorption System	<input checked="" type="checkbox"/> Acceptable <input type="checkbox"/> Unacceptable <input type="checkbox"/> Needs Further Evaluation	One drywell and drainfield in series were located during the evaluation. The drywell was accessible via a PVC cleanout at grade. The drywell appears to have 3 feet of total liquid depth with no liquid depth remaining. The drainfield observation port was observed to be dry. Approximately 300 gallons of water were introduced into the system with no signs of a back-up.

Tank Replacement

HOME LAND

ENVIRONMENTAL

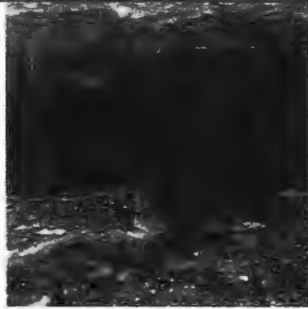
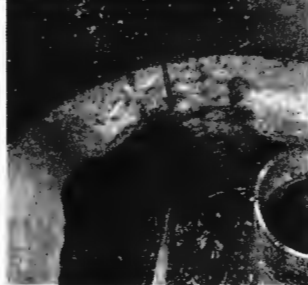
p:443-995-5385 | f:443-267-0098 | info@homelandhealthyhomes.com | www.homelandhealthyhomes.com

	<p>Picture 1:</p> <p>This shows the septic tank in relation to the house. There are two trees near the tank.</p>
	<p>Picture 2:</p> <p>This shows the root intrusion in the front of the tank.</p>
	<p>Picture 3:</p> <p>This shows the root intrusion through the sidewall and the outlet seal. There appears to be exposed rebar in the tank sidewalls.</p>
	<p>Picture 4:</p> <p>This shows the absorption system in relation to the tank.</p>

p:443-995-5385 | f:443-267-0098 | info@homelandhealthyhomes.com | www.homelandhealthyhomes.com

HOME LAND

ENVIRONMENTAL

p:443-995-5385 | info@homelandhealthyhomes.com | www.homelandhealthyhomes.com

Sketch of System

Please See Separate System Sketch

DISCLAIMERS

- This is a subjective and visual inspection only, the conclusions of which are based on the observed condition of the system components that could reasonably be accessed, and information known about the system at the time this report was completed. There may be unknown historical problems or unseen conditions which may compromise the conclusions stated in this report.
- Suggestions or recommendations for repairs or remediation may result in the need for further repair or remediation once the system components are fully excavated.
- A 'Satisfactory' evaluation does not mean the system will meet the local approving authority's criteria for determining compliance with state code: COMAR 26.04.02.02 D(4).
- The evaluation of the Sewage Disposal System as reported is based on the conditions observed on the day of the inspection.
- This report is neither a WARRANTY nor does it GUARANTEE continued acceptable functionality or performance of the Sewage Disposal Systems operations.
- If the house has been unoccupied the findings in this report may not be accurate, as limited or no use of the system may conceal or mask problems that may be revealed under typical sewage loading.
- If the general ground condition is excessively wet at the time of inspection, the findings in this report may not be accurate, as ground moisture may cover or hide septic effluent that may be on or near the ground surface.
- If the house is vacant or the conditions excessively wet during inspection, it is recommended that the system be reevaluated at a later date and/or alternate techniques be used to address those potential issues.
- Payment and/or use of this evaluation signify understanding and acceptances of the above clauses, as well as any noted faults with the system.
- Suggestions or recommendations for repairs or remediation may result in the need for further repair or remediation once the system components are fully excavated.

Representative's Signature:		Date: 10/16/2023
------------------------------------	--	-------------------------