

Bureau of Environmental Health
 8930 Stanford Boulevard, Columbia, MD 21045
 Main: 410-313-2640 | Fax: 410-313-2648
 TDD 410-313-2323 | Toll Free 1-866-313-6300
www.hchealth.org
 Facebook: www.facebook.com/hocohealth

Maura J. Rossman, M.D., Health Officer

RECEIPT DATE: 8/17/2023 **ONSITE SEWAGE DISPOSAL SYSTEM** P 574996

APPROVAL DATE: 10/18/23 **PERMIT: REPAIR** A _____

PROPERTY ADDRESS: 1132 Day Road

SUBDIVISION: n/a LOT: 1 TAX ID: 03-283992

CONTRACTOR: Fogle's EMAIL: Jeff@foglesinc.com

CONTRACTOR ADDRESS: 580 Obrecht Road, Sykesville 21784 PHONE: 410-795-5670

PROPERTY OWNER: Cynthia Cairns EMAIL: n/a

OWNER ADDRESS: Same as above PHONE: 410-330-4930

SEPTIC TANK SIZE: Existing PUMP SIZE: n/a PUMP TANK CAPACITY: n/a

DISTRIBUTION SYSTEM: GRAVITY LPD BEDROOMS: 3 APPLICATION RATE: 1.2

| | | |
|-----------|---|--|
| TRENCHES: | LINEAR FEET REQUIRED: <u>85</u> | INLET DEPTH: <u>2</u> |
| | TRENCH WIDTH: <u>3</u> | MAXIMUM BOTTOM DEPTH: <u>6</u> |
| | MINIMUM SPACE BETWEEN TRENCHES: <u>n/a</u> | EFFECTIVE AREA BEGINNING DEPTH: <u>3</u> |
| LOCATION: | SYSTEM TO BE STAKED BY INSTALLER AND VERIFIED BY APPROVING AUTHORITY DURING PRE-CONSTRUCTION INSPECTION. | |
| NOTES: | Install system per approved design plans. | |

ISSUED BY: Kevin M. Wolf, L.E.H.S. ISSUE DATE: 10/6/2023 EXPIRATION DATE: 10/6/2024

- NOTE: CONTRACTOR MUST SCHEDULE A PRE-CONSTRUCTION INSPECTION PRIOR TO BEGINNING ANY INSTALLATION
- NOTE: CONTRACTOR REGISTERED WITH THE STATE OF MD ON-SITE WASTEWATER PROFESSIONALS BOARD: CONFIRMED
- NOTE: CONTRACTOR MUST SCHEDULE AN INSPECTION AND GAIN APPROVAL OF ALL COMPONENTS PRIOR TO COVERING
- NOTE: STONE MUST BE APPROVED BY HEALTH DEPARTMENT AND GRAVEL TICKET MUST BE AVAILABLE FOR REVIEW.
- NOTE: WATERTIGHT SEPTIC TANKS REQUIRED
- NOTE: ALL PARTS OF SEPTIC SYSTEM SHALL BE AT LEAST 100 FEET DOWNGRADIENT FROM ANY WATER WELL
- NOTE: MANHOLE RISERS REQUIRED ON ALL SEPTIC TANKS AND PUMP CHAMBERS
- NOTE: AN ELECTRICAL PERMIT IS REQUIRED FOR INSTALLATION OF ANY ELECTRICAL COMPONENTS OF THE SYSTEM
 ELECTRICAL PERMIT ISSUED E n/a
- NOTE: THE HCHD DOES NOT WARRANTY ANY SYSTEM AND CANNOT GUARANTEE THE PERFORMANCE OF THIS SYSTEM AS DESIGNED. BY ACCEPTING THIS PERMIT, THE OWNER AND/OR APPLICANT ACKNOWLEDGE THAT THE SPECIFICATIONS DETAILED IN THIS DESIGN ARE ONE POSSIBLE OPTION AND THAT THE HCHD WILL REVIEW OTHER PROPOSALS. YOU HAVE THE OPTION TO SEEK THE ADVICE OF A QUALIFIED DESIGN CONSULTANT OR PROFESSIONAL ENGINEER FOR FURTHER GUIDANCE.
- NOTE: AN INDIVIDUAL CERTIFIED BY MDE AND THE MANUFACTURER FOR BAT INSTALLATION MUST BE PRESENT AT ALL TIMES DURING BAT INSTALLATION.
- NOTE: MDE RECOMMENDS SEPTIC TANKS, BAT, AND OTHER PRETREATMENT UNITS BE PUMPED AT A FREQUENCY ADEQUATE TO ENSURE THAT SOLIDS ARE NOT DISCHARGED TO THE DISPOSAL AREA

**NEITHER THE HOWARD COUNTY COUNCIL NOR THE HEALTH DEPARTMENT IS RESPONSIBLE FOR THE SUCCESSFUL OPERATION OF ANY SYSTEM.
 PERMITTEE RESPONSIBLE FOR OBTAINING FINAL APPROVAL ON THIS PERMIT.
 CALL 410-313-1771 TO SCHEDULE INSPECTIONS.**

NOT TO SCALE

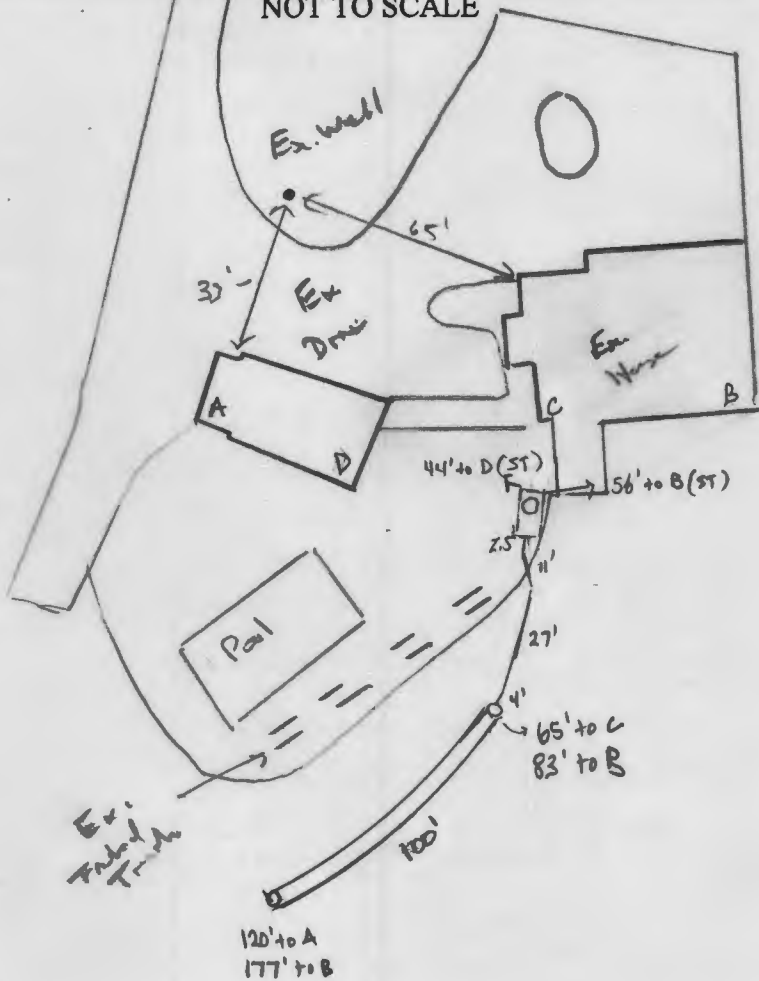

ROAD NAME

TRENCH/DRAINFIELD DATA

| | | |
|-------------------------|-------|-------------------------------|
| WIDTH | INLET | BOTTOM |
| 3' | 2' | 6' |
| NUMBER OF TRENCHES | | 1 |
| TOTAL LENGTH | | 100' |
| ABSORPTION AREA | | 300ft ² + sidewalk |
| DISTRIBUTION BOX LEVEL | | - |
| DISTRIBUTION BOX BAFFLE | | - |
| DISTRIBUTION BOX PORT | | - |

SEPTIC TANK DATA

| | |
|------------------------|-----------|
| SEPTIC TANK 1 LEVEL | |
| MANUFACTURER | _____ |
| CAPACITY | _____ GAL |
| SEAM LOC | _____ |
| TANK LID DEPTH | 2'-2.5' |
| BAFFLES | _____ |
| BAFFLE FILTER | _____ |
| MANHOLE LOC | _____ |
| 6" PORT LOC | _____ |
| WATERTIGHT TEST | _____ |
| SLOTTED | _____ |
| DATE ON LID | _____ |
| PUMP/SEPTIC TANK LEVEL | |
| MANUFACTURER | _____ |
| CAPACITY | _____ GAL |
| SEAM LOC | _____ |
| TANK LID DEPTH | _____ |
| BAFFLES | _____ |
| BAFFLE FILTER | _____ |
| MANHOLE LOC | _____ |
| 6" PORT LOC | _____ |
| WATERTIGHT TEST | _____ |
| SLOTTED | _____ |
| DATE ON LID | _____ |

PRE-CONSTRUCTION:

10/6/2023 Design plan approved. Staked out in field @ the
of perc. (100)

INSTALLATION: 10/17/23- Contractor onsite installing a new 4" baffle to the existing septic tank, observed the installation of the sewer line from the tank to the trench. Since it's 1 trench, no dbx was installed, a clo was installed at the beginning of the trench, inlet @ 2', stone looks ok, geotextile fabric installed, w/ obs port at the end of the trench, soils were consistent with the perc. data w/ few rock observed in the spnl piles. OK to backfill. (RM)

FINAL INSPECTOR R. Reppert DATE OF APPROVAL 10/18/23



**Howard County
Health Department**

Maura J. Rossman, M.D., Health Officer

Bureau of Environmental Health
8930 Stanford Boulevard, Columbia, MD 21045
Main: 410-313-2640 | Fax: 410-313-2648
TDD 410-313-2323 | Toll Free 1-866-313-6300
www.hchealth.org
Facebook: www.facebook.com/hocohealth

RECEIPT DATE: 8/17/2023 **ONSITE SEWAGE DISPOSAL SYSTEM** P 574996

APPROVAL DATE: 10/18/23 **PERMIT: REPAIR** A _____

PROPERTY ADDRESS: 1132 Day Road

SUBDIVISION: n/a LOT: 1 TAX ID: 03-283992

CONTRACTOR: Fogle's EMAIL: Jeff@foglesinc.com

CONTRACTOR ADDRESS: 580 Obrecht Road, Sykesville 21784 PHONE: 410-795-5670

PROPERTY OWNER: Cynthia Cairns EMAIL: n/a

OWNER ADDRESS: Same as above PHONE: 410-330-4930

SEPTIC TANK SIZE: Existing PUMP SIZE: n/a PUMP TANK CAPACITY: n/a

DISTRIBUTION SYSTEM: GRAVITY LPD BEDROOMS: 3 APPLICATION RATE: 1.2

| | | |
|-----------|---|--|
| TRENCHES: | LINEAR FEET REQUIRED: <u>85</u> | INLET DEPTH: <u>2</u> |
| | TRENCH WIDTH: <u>3</u> | MAXIMUM BOTTOM DEPTH: <u>6</u> |
| | MINIMUM SPACE BETWEEN TRENCHES: <u>n/a</u> | EFFECTIVE AREA BEGINNING DEPTH: <u>3</u> |
| LOCATION: | SYSTEM TO BE STAKED BY INSTALLER AND VERIFIED BY APPROVING AUTHORITY DURING PRE-CONSTRUCTION INSPECTION. | |
| NOTES: | Install system per approved design plans. | |

ISSUED BY: Kevin M. Wolf, L.E.H.S. ISSUE DATE: 10/6/2023 EXPIRATION DATE: 10/6/2024

- NOTE: CONTRACTOR MUST SCHEDULE A PRE-CONSTRUCTION INSPECTION PRIOR TO BEGINNING ANY INSTALLATION
- NOTE: CONTRACTOR REGISTERED WITH THE STATE OF MD ON-SITE WASTEWATER PROFESSIONALS BOARD: CONFIRMED
- NOTE: CONTRACTOR MUST SCHEDULE AN INSPECTION AND GAIN APPROVAL OF ALL COMPONENTS PRIOR TO COVERING
- NOTE: STONE MUST BE APPROVED BY HEALTH DEPARTMENT AND GRAVEL TICKET MUST BE AVAILABLE FOR REVIEW.
- NOTE: WATERTIGHT SEPTIC TANKS REQUIRED
- NOTE: ALL PARTS OF SEPTIC SYSTEM SHALL BE AT LEAST 100 FEET DOWNGRADIENT FROM ANY WATER WELL
- NOTE: MANHOLE RISERS REQUIRED ON ALL SEPTIC TANKS AND PUMP CHAMBERS
- NOTE: AN ELECTRICAL PERMIT IS REQUIRED FOR INSTALLATION OF ANY ELECTRICAL COMPONENTS OF THE SYSTEM
 ELECTRICAL PERMIT ISSUED E n/a
- NOTE: THE HCHD DOES NOT WARRANTY ANY SYSTEM AND CANNOT GUARANTEE THE PERFORMANCE OF THIS SYSTEM AS DESIGNED. BY ACCEPTING THIS PERMIT, THE OWNER AND/OR APPLICANT ACKNOWLEDGE THAT THE SPECIFICATIONS DETAILED IN THIS DESIGN ARE ONE POSSIBLE OPTION AND THAT THE HCHD WILL REVIEW OTHER PROPOSALS. YOU HAVE THE OPTION TO SEEK THE ADVICE OF A QUALIFIED DESIGN CONSULTANT OR PROFESSIONAL ENGINEER FOR FURTHER GUIDANCE.
- NOTE: AN INDIVIDUAL CERTIFIED BY MDE AND THE MANUFACTURER FOR BAT INSTALLATION MUST BE PRESENT AT ALL TIMES DURING BAT INSTALLATION.
- NOTE: MDE RECOMMENDS SEPTIC TANKS, BAT, AND OTHER PRETREATMENT UNITS BE PUMPED AT A FREQUENCY ADEQUATE TO ENSURE THAT SOLIDS ARE NOT DISCHARGED TO THE DISPOSAL AREA

**NEITHER THE HOWARD COUNTY COUNCIL NOR THE HEALTH DEPARTMENT IS RESPONSIBLE FOR THE SUCCESSFUL OPERATION OF ANY SYSTEM.
PERMITTEE RESPONSIBLE FOR OBTAINING FINAL APPROVAL ON THIS PERMIT.
CALL 410-313-1771 TO SCHEDULE INSPECTIONS.**

10/18/23 - septic install - 1132 Day Rd.



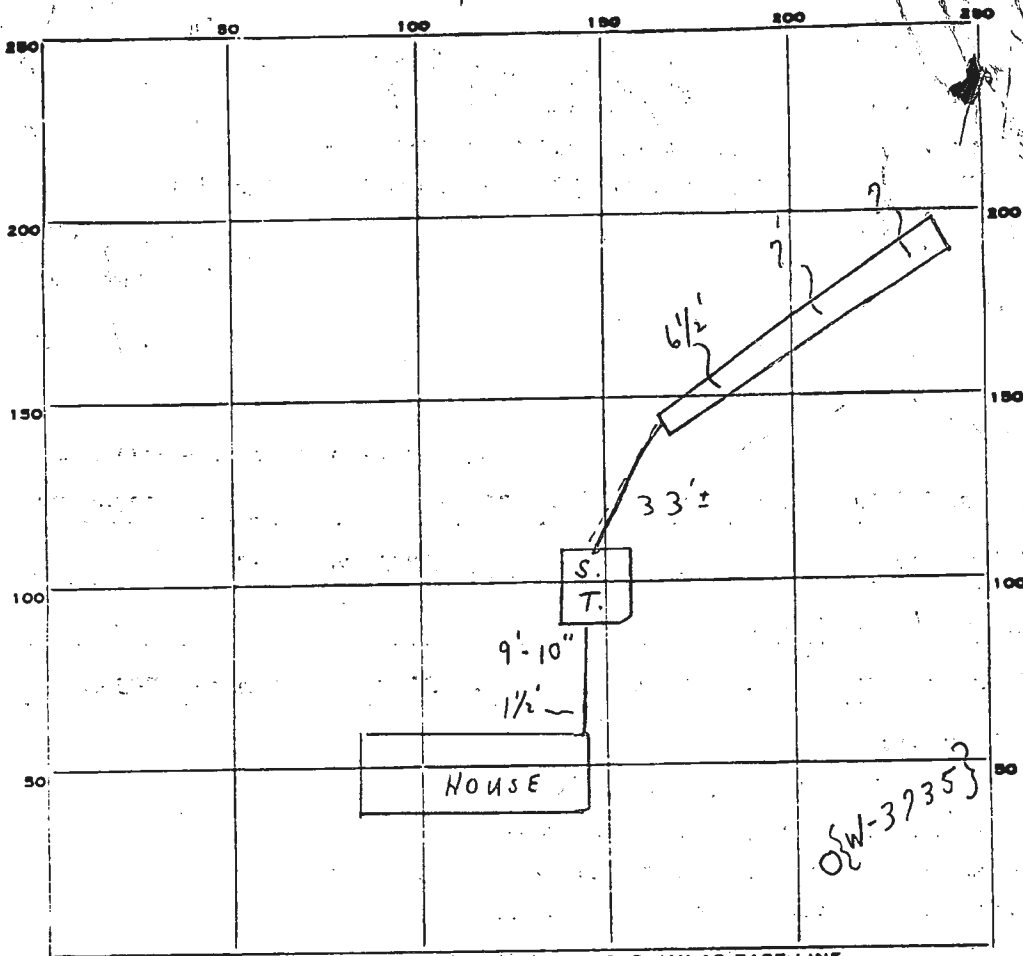

INDICATE NORTH. - NAME ADJOINING ROADWAY AS BASE LINE.

JIM'S WAY

PERMIT CARD

SEPTIC TANK, LEVEL CLEANOUTS S.T. *tenor coter*

DISTRIBUTION BOX, LEVEL

TILE FIELD, DEPTH $6\frac{1}{2}' = 7'$ FT. TRENCH WIDTH 2 FT.

GRAVEL DEPTH 5' IN. TOTAL LENGTH 90 FT.

NUMBER OF TRENCHES 1 TOTAL BOTTOM AREA 435

SEEPAGE PITS, INSIDE DIAMETER _____ FT. DEPTH BELOW INLET _____ FT.

ABSORBENT AREA 435 SQ. FT.

REMARKS 8/6/81 Some grading has been done in area of high test hole. F.S.

8/10/81 TRENCH OK FOR STONE

8/11/81 OK to cover all work. JS

DATE SYSTEM APPROVED 8/11/81 INSPECTOR Stayer

PERMIT

SEWAGE DISPOSAL SYSTEM

MARYLAND STATE DEPARTMENT OF HEALTH

HOWARD COUNTY

ELLICOTT CITY

DISTRICT 3rd

DATE 8/4/81

INDEX

approved 8/11/81
Stayed P 31528
A 29207

8/6/81
2:00 P.M.
8/10/81
8/11/81 AM

Jack Fyock

IS PERMITTED TO INSTALL X ALTER

ADDRESS 13775 Triadelphia Road, Glenelg, Md. 21737

PHONE 988-9270

SUBDIVISION Dickey Farms

ROAD 1063 Day Road

LOT 1

1132

PROPERTY OWNER Craig L. Cairns

ADDRESS 4590 London Bridge Road, Sykesville, Md. 21784

Phone: 795-6994

SPECIFICATIONS 3 bedrooms

SEPTIC TANK CAPACITY 1000 GALLONS

DRAIN FIELD _____ DEPTH _____ FEET, BOTTOM AREA _____ SQ. FT.

DEEP TRENCH _____ DEPTH _____ FEET, BOTTOM AREA _____ SQ. FT.

SEEPAGE PITS _____ ABSORBENT SIDE-WALL AREA _____ SQ. FT.

INLET PIPE _____ FT. BELOW ORIGINAL GRADE. MAXIMUM DEPTH _____ FT. BELOW ORIGINAL GRADE

EFFECTIVE DEPTH AT _____ FT. BELOW ORIGINAL GRADE.

LOCATE DISPOSAL AREA _____ FT. FROM _____ LOT LINE AND _____ FT. FROM _____ LOT LINE AS SEEN WHEN

FACING LOT FROM

1 1/2'

TRENCH(ES) - To be 2 ft. wide. Inlet to be ~~2'-2 1/2'~~ ^{1 1/2'} below original grade and effective ^{6 1/2'} absorbent area from ~~2'-2 1/2'~~ ^{1 1/2'} to ~~7'-7 1/2'~~ ^{7'} only. Maximum depth of trench(es) to be ~~7'~~ ^{7 1/2'} below original grade. A minimum of 145 sq. ft. effective absorbent sidewall area per bedroom needed. Trenches cannot exceed 100' in length. Distribution box to be used if more than 1 trench used. Two inspections of trenches required - before and after stone installed. If more than 1 trench used - need to have 15 ft. distance between trenches, center to center. Run trenches on contour. Start trench(es) at a point 30 ft. from right property line and 401 ft. from front property line when facing lot from Jim's Way, area of perc hole #13 as shown on house plan submitted by Cairns.

PLANS APPROVED BY Charles B. Streaker

DATE 1/16/81

COVER NO WORK UNTIL INSPECTED AND APPROVED. 8/6/81 Grading done in area of high hole. O.K. to use 90 ft long trench with trench ending at high hole (see drawing) F.S.
NEITHER THE HOWARD COUNTY COUNCIL NOR THE HEALTH DEPARTMENT IS RESPONSIBLE FOR THE SUCCESSFUL OPERATION OF ANY SYSTEM.

NOTE: IF TRENCH IS USED CALL FOR INSPECTION BEFORE PLACING GRAVEL IN TRENCH.

NOTE: NO DRY WELL SHALL EXCEED 15 FOOT IN DIAMETER.

NOTE: ALL PIPE FROM HOUSE TO DISPOSAL AREA MUST BE CAST IRON.

PERMIT VOID AFTER THREE YEARS.

NOTE: INSTALL STAND PIPE ON SEPTIC TANK AND DRY WELL. STAND PIPES MUST BE 6 INCHES IN DIAMETER. CAST IRON, CONCRETE OR TERRA COTTA ACCEPTED.

*INSTALLER IS RESPONSIBLE FOR OBTAINING FINAL APPROVAL ON THIS PERMIT.

A 29207

DICKEY FARMS

"JIM'S WAY + DAY ROAD EXTENDED" Lot Number 1

Septic tank 1 - 3 Bedrooms 1000 gallons
4 Bedrooms 1250 gallons

Trenches to be 2' wide. Inlet to be $2-2\frac{1}{2}$ ' below original grade and effective absorbant area from $2-2\frac{1}{2}' - 7-7\frac{1}{2}'$ only. Maximum depth of trenches to be $7\frac{1}{2}'$ below original grade. A minimum of 145' sq.ft. effective absorbant sidewall area per bedroom needed. Trenches can not exceed 100' in length. Distribution box to be used if more than 1 trench used. Two inspections of trenches required - before and after stone installed. If more than 1 trench used - need to have 15 ft. distance between trenches, center to center. Run trenches on contour.

LOCATION: Start trenches at a point 30' in from right property line and 40' from front property line when facing lot from JIM'S WAY. AREA OF PERC HOLE (13) AS SHOWN ON HOUSE PLAN SUBMITTED BY CAIRNS.

C.B.D.

Installer - Jack Fyock

Craig Calms
1132 Day Rd
Sykesville, MD 21784
Septic Repair
HCHD Permit # P574996

100 ft

Day Rd

3BR

120

570

No Neighboring
well within 100ft
Dropped off to
Kevin Wolf on
9-27-23

570

1132

Ex. Well

Garage

Ex. Tank

Pool

Ex. Trench

New
D-Box
w/ Riser

Retaining
wall

91'

208'

New 100'
Trench
Detail
1-100' Length
3'-wide
6'-Deep
4'-stone

550

540

Approved Septic System Plan
Howard County Health Department

[Signature]
Signature

10/3/2023
Date