

C1 56487

SEQUENCE NO. (MDE USE ONLY)

STATE OF MARYLAND WELL COMPLETION REPORT

THIS REPORT MUST BE SUBMITTED WITHIN 45 DAYS AFTER WELL IS COMPLETED.

(THIS NUMBER IS TO BE PUNCHED IN COLS. 3-6 ON ALL CARDS)

COUNTY NUMBER ATL

ST/CO USE ONLY DATE RECEIVED

DATE WELL COMPLETED

Depth of Well

PERMIT NO. FROM "PERMIT TO DRILL WELL"

OWNER, WELL SITE ADDRESS, TOWN, SUBDIVISION, SECTION, LOT

WELL LOG table with columns: DESCRIPTION, FEET (FROM, TO), check if water bearing. Includes handwritten entries: Soil, Brown shale, Med Gral, Rock.

GROUTING RECORD: WELL HAS BEEN GROUTED, TYPE OF GROUTING MATERIAL, CEMENT, BENTONITE CLAY, NO. OF BAGS, NO. OF POUNDS, GALLONS OF WATER, DEPTH OF GROUT SEAL.

CASING RECORD: casing types insert appropriate code below, MAIN CASING TYPE, Nominal diameter, Total depth of main casing.

OTHER CASING (if used) diameter, depth

SCREEN RECORD: screen type or open hole, insert appropriate code below.

NUMBER OF UNSUCCESSFUL WELLS, WELL HYDROFRACTURED

CIRCLE APPROPRIATE LETTER: A, E, P

I HEREBY CERTIFY THAT THIS WELL HAS BEEN CONSTRUCTED IN ACCORDANCE WITH COMAR 26.04.04 "WELL CONSTRUCTION"

DRILLERS LIC. NO., DRILLERS SIGNATURE

LIC. NO., SITE SUPERVISOR

DEPTH (nearest ft.), CASING HEIGHT, LAND SURFACE, SLOT SIZE, DIAMETER OF SCREEN

GRAVEL PACK IF WELL DRILLED WAS FLOWING WELL

MDE USE ONLY (NOT TO BE FILLED IN BY DRILLER)

PUMPING TEST: HOURS PUMPED, PUMPING RATE, METHOD USED TO MEASURE PUMPING RATE, WATER LEVEL, TYPE OF PUMP USED

PUMP INSTALLED: DRILLER INSTALLED PUMP, TYPE OF PUMP INSTALLED

CAPACITY: GALLONS PER MINUTE, PUMP HORSE POWER, PUMP COLUMN LENGTH

CASING HEIGHT, LAND SURFACE

LATITUDE, LONGITUDE (DEFAULT COORD. WGS 84)

Pursuant to §10-624 of the State Govt. Article of the Maryland Code personal info. requested on this form is used in processing this form pursuant to COMAR 26.04.04.

Tag # 9-1019 (51)

B 1 63176 SEQUENCE NO. (MDE USE ONLY) **STATE OF MARYLAND** STATE PERMIT NUMBER HO-18-0082
APPLICATION FOR PERMIT TO DRILL WELL 5/4/19 please type 70 79
 fill in this form completely

OWNER INFORMATION
 Date Received (APA) 03/15/19
 8 MM DD YY 13
Elm Street Development
 15 Last Name Owner First Name 34
1355 Beverly Road
 36 Street or RFD 55
Median VA 2201
 57 Town 70 State 72 Zip 76

B 3 **LOCATION OF WELL**
Howard
 8 COUNTY 21
Simpson Property
 23 SUBDIVISION 42
 SECTION 44 46 LOT 35 50
Dayton
 52 NEAREST TOWN 71

DRILLER INFORMATION
Michael Barber M WD 355
 76 Driller's Name License No. 81
Barber Well Drilling
 Firm Name
522 Underwood Lane 2B14
 Address
[Signature] 3-12-19
 Signature Date

B 4 **SOURCES OF DRILLING WATER**
 1. Well
 2.
 3.
Green Bridge Road
 11 STREET ADDRESS 30
 ON WHICH SIDE OF ROAD (CIRCLE APPROPRIATE BOX)
 NORTH
 WEST EAST
 SOUTH
 34 3600 37
200
 DISTANCE FROM ROAD ENTER FT OR MI 38 39
 TAX MAP: 27 BLK: 18 PARCEL

B 2 **WELL INFORMATION**
 1 2 APPROX. PUMPING RATE 5
 (GAL. PER MIN.) 8 12
 AVERAGE DAILY QUANTITY NEEDED 750
 (GAL. PER DAY) 14 20

USE FOR WATER (CIRCLE APPROPRIATE BOX)
 DOMESTIC POTABLE SUPPLY & RESIDENTIAL IRRIGATION
 FARMING (LIVESTOCK WATERING & AGRICULTURAL IRRIGATION)
 INDUSTRIAL, COMMERCIAL, DEWATERING
 PUBLIC WATER SUPPLY WELL
 TEST, OBSERVATION, MONITORING
 OPEN LOOP GEOTHERMAL
 CLOSED LOOP GEOTHERMAL

NOT TO BE FILLED IN BY DRILLER HEALTH DEPARTMENT APPROVAL
Howard COUNTY NAME XIII COUNTY NO.
 STATE SIGNATURE _____ INSERT S → 41
05/17/2019 DATE ISSUED 43 MM DD YY 48
[Signature] COUNTY SIGNATURE 05/17/2019 EXP. DATE
 Done: 6/27/2019 DOY: 9/17/19 DOG: DNI

APPROXIMATE DEPTH OF WELL 300 FEET
 24 28
 APPROXIMATE DIAMETER OF WELL 6 INCH
 NEAREST

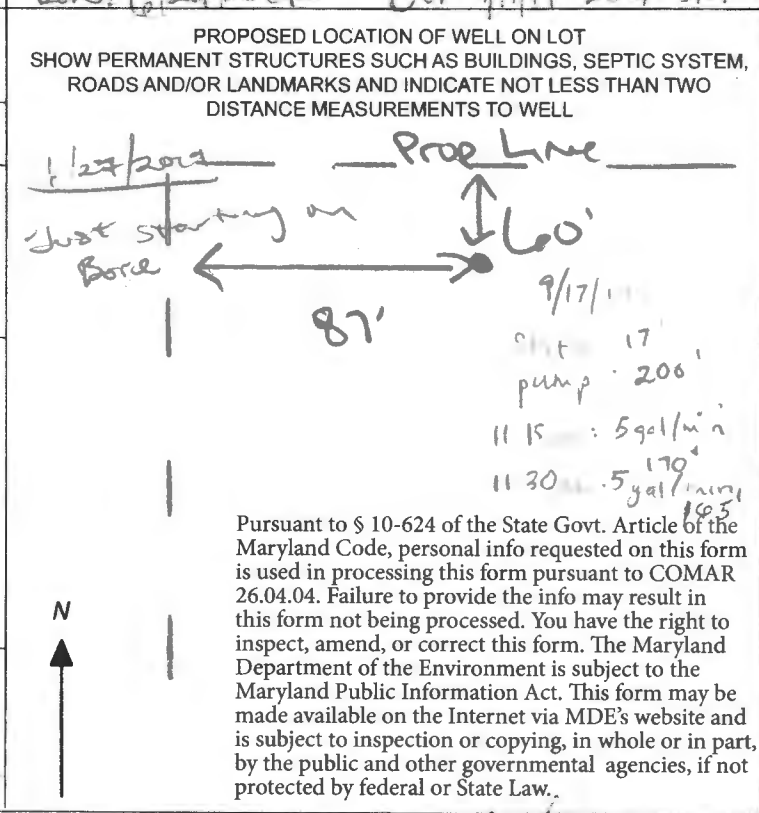

METHOD OF DRILLING (circle one)
 BORED (or Augered) JETTED Jetted & DRIVEN
 30 AIR-ROTARY AIR-PERCussion ROTARY (Hydraulic Rotary)
 37 CABLE REVERSE-ROTARY DRIVE-POINT
 other _____

REPLACEMENT OR DEEPEMED WELLS (CIRCLE APPROPRIATE BOX)
 THIS WELL WILL NOT REPLACE AN EXISTING WELL
 THIS WELL WILL REPLACE A WELL THAT WILL BE ABANDONED AND SEALED
 THIS WELL WILL REPLACE A WELL THAT WILL BE USED AS A STANDBY-CONTACT LOCAL APPROVING AUTHORITY FOR POLICY ON STANDBY WELLS
 THIS WELL WILL DEEPEM AN EXISTING WELL
 39 PERMIT NUMBER OF WELL TO BE REPLACED OR DEEPEMED (IF AVAILABLE) 41 _____ 52

Not to be filled in by driller (MDE OR COUNTY USE ONLY)
 APPROP. PERMIT NUMBER HO2017G_001
 PERMIT No. HO-18-0082
 70 71 72 73 74 75 76 77 78 79

SPECIAL CONDITIONS
 NOTE: APPROVING AUTHORITIES SHOULD USE SEPARATE SHEET IF NEEDED. SEE ATT MEMO UPDATED 5/17/2019



MICHAEL BARLOW WELL DRILLING & SERVICE, INC.

522 Underwood Lane
(410) 838-6910

Bel Air, Maryland 21014
Fax (410) 838-3582

WELL YIELD REPORT

Date Test Completed:	September 17, 2019		
Well Depth:	500	feet	
Customer	Elm Street Development	Permit #	HO-18-0082
Road	Green Bridge Rd	Subdivision	Simpson Property
City	Dayton	Section	
State	Maryland	Lot #	35

Time	Water Level feet Pump set at 200'	Time to Fill 1-gallon bucket seconds	G.P.M.
9:45 AM	17	4	15.00
10:00 AM	98	4	15.00
10:15 AM	159	5	12.00
10:30 AM	180	12	5.00
10:45 AM	181	12	5.00
11:00 AM	173	12	5.00
11:15 AM	170	12	5.00
11:30 AM	165	12	5.00
11:45 AM	160	12	5.00
12:00 PM	157	12	5.00
12:15 PM	152	12	5.00
12:30 PM	148	12	5.00
12:45 PM	143	12	5.00
1:00 PM	138	12	5.00

This yield test report is for informational purposes only. Please note the yield may increase or decrease over time and the GPM indicated above is not a guarantee.

Maura J. Rossman, M.D., Health Officer

Information Form for the Installation of the Well Pump, Pitless Adapter, and Supply Piping

NOTE: The installer is responsible for requesting an inspection prior to 9 am on the day of the desired inspection. No work is to be covered until approved by the Health Department. All installations must comply with the National Standard Plumbing Code (NSPC, as amended locally) and COMAR 26.04.04 (MD Well Construction Regulations). Submission of a complete form is required prior to Use and Occupancy approval.

Company Name: Fogle's Well Pump + Water Treatment, LLC Telephone #: 410-795-1535

Address: P.O. Box 63
Woodbine, Maryland 21797

Must circle one: Licensed Plumber / Licensed Well Driller / Licensed Well Pump Installer

License # and name of individual responsible for the field installation:

Name (Print): Dave C. Fogle License# MSD226

***A licensed individual must perform the actual installation. Apprentices must be under the supervision of a licensed journeyman or master plumber, pump installer or well driller. Licenses may be subjected to field verification. Unlicensed individuals may be reported to the appropriate licensing agency.**

Name of Property Owner: TOLL BROTHERS Telephone #: 410-795-1535
Subdivision: WILLOW CREEK Lot #: 35 Well Tag #: HO-18-0082 ✓
Site Address: 7040 COIT PLACE
Hamsville, MD 21754

Submersible Pump Data

Make: Grundfos
Model #: ISSQE15290
Pump Capacity: 15
Well Yield: 5

Pitless Adapter

Make: Campbell
Model#: N/A
GPM Depth: 36" (36" min)
GPM NSF/WSC approved: yes

Well Cap and Electric Conduit

Two piece watertight cap: yes
Screened, vented well cap: yes
Cap secured to casing: yes
Conduit min 18" B.G.: yes
Conduit secured to well cap: yes

Depth of well encountered at time of pump installation: 500 (feet)

If pump capacity exceeds well yield, a low water cut off switch is required by NSPC 1990 Section 17.8.4

Must circle one: Torque arrestors / Cable guards / Other acceptable method used

Safety rope, if used, attached to brass rope adapter or other acceptable method inside of well casing N/A

Piping to house

Type: 1" poly pipe
PSI: 200 psi (160 psi min)
Depth of supply line: 36" (36" min)

House Connection

PVC sleeve to undisturbed soil at wall penetration: yes
Length of sleeve (5' minimum from foundation): 6'
Sleeve sealed properly: yes

The water supply line is required to be at least ten feet from the septic tank, pump chamber, sewage piping, distribution box, drainfields, and sewage reserve area. If this cannot be accomplished, contact this office for approval prior to installation.

Signature of company representative responsible for installation: [Signature] Date: 4/19/23

For Health Department Use Only – Not to be completed by Installer

Date Insp. Requested: 4/20/23 Date Insp. Approved: 4/20/23 Inspector: RR
Inspection Data: Pitless adapter watertight & water supply line at least 36" below grade ✓
Two piece cap installed and attached to casing securely ✓
Elec. conduit extends at least 18" below grade/attached to cap properly ✓
Safety rope not outside of well cap/casing ✓
Correct well tag attached properly and casing 8" above finished grade ✓
Water supply line sleeved adequately at house connection ✓
Adequate grout observed below pitless adapter ✓

(Revised form 10/24/2018)

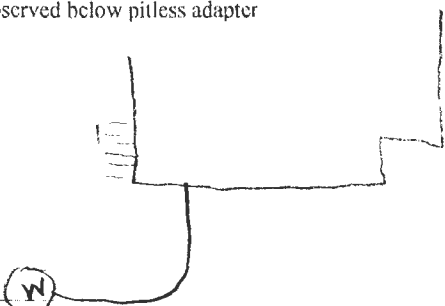

INTERIM CERTIFICATE OF POTABILITY
Expiration Date – MARCH 6, 2024

September 6, 2023

Homeowner
7040 Colt Place
Dayton, MD 21036

RE: Willowshire, Lot 35
7040 Colt Place
Building Permit: B22002740
Well Permit: HO-18-0082

Dear Homeowner:

This is to advise you that the septic system installation and water well construction for the above referenced property have been inspected and approved. Final approval of the septic system was granted on **9/6/2023**. Final approval of the well line connection to the dwelling was granted on **4/20/2023**. The well construction was completed on **9/17/2019**. Water samples were collected on **8/10/2023**.

The water sample results indicate that the water samples submitted for testing were free of coliform and fecal coliform bacteria at the time of sampling and are bacteriologically safe for drinking. This certifies that the initial sampling requirements of COMAR 26.04.04 "Well Regulations" have been met for the water supply system installed under well permit HO-18-0082. Although the submitted sample results are in compliance with COMAR standards, the Health Department does not guarantee water supplies.

This Interim Certificate of Potability will expire **six months** from the date of issuance. Submission of a second bacteriological test indicating the water is free of coliform and fecal coliform bacteria is required prior to the expiration date, after which time a Final Certificate of Potability will be issued. **Failure to submit an additional sample and obtain a Final Certificate of Potability will result in a Notice of Violation and is punishable as a misdemeanor under the *Annotated Code of Maryland, Environment Article, 9-1311*, subject to a fine of up to \$500 or imprisonment not to exceed three months.**

Please contact (410) 313-1773 to schedule a final water sample appointment or contact a Maryland certified water laboratory to schedule a water sample. A list of laboratories certified by the state of Maryland may be found at the following website:
<http://www.mde.state.md.us/assets/document/WSP-Labs-2010apr16.pdf>



Bureau of Environmental Health
8930 Stanford Blvd | Columbia, MD 21045
410.313.2640 - Voice/Relay
410.313.2648 - Fax
1.866.313.6300 - Toll Free

Maura J. Rossman, M.D., Health Officer

In closing, please refer to our "[Homeowner Fact Sheet](#)" which illustrates a better understanding for your Onsite Sewage Disposal System. You will also find a link to Maryland Department of the Environments website which describes in further detail operation and maintenance of your septic system.

Approving Authority,

A handwritten signature in black ink, appearing to read 'Kevin M. Wolf', is written over a horizontal line.

Kevin M. Wolf, LEHS, R.S./REHS, Supervisor
Groundwater Management Section
Well & Septic Program

cc: Howard County Dept. of Inspections, Licenses, and Permits
Community Hygiene Program
File

FOUNTAIN VALLEY ANALYTICAL LABORATORY, INC.

1413 Old Taneytown Rd. Westminster, MD (410) 848-1014 (410) 876-4554

REPORT OF ANALYSIS

Laboratory ID #: 160733 Account #: 1933
Reference: Willow Creek Lot 35 Client: Fogle's Well Pump & Treatment
Location: 7040 Colt Place Dayton, MD 21036 Requested By: Dave Fogle
Date/ Time Collected: 8/10/2023 0850 Source: Well Water
Date/Time Rec'd: 8/10/2023 1115 Site: Pressure Tank
Chlorine ppm: Free: ND Total: ND pH: 6.4
Collected By: T. Cassell 0767TC Well #: HO-18-0082

PARAMETERS	RESULTS	UNITS	REFERENCE	METHOD	DATE/TIME/ANALYST
Bacteria, Coliform, Total, MPN	<1.0	MPN/ 100 ml	<1.0	SM20 9223B	8/11/2023 / 0930 / LLO
Bacteria, E. coli, MPN	<1.0	MPN/ 100 ml	<1.0	SM20 9223B	8/11/2023 / 0930 / LLO
Nitrate.	5.72	mg/L (as N)	10	EPA 300.0	8/10/2023 / 1526 / CRS
Turbidity	0.49	NTU	<10	SM2130B	8/11/2023 / 1025 / TSD
Sand	ND	mg/L	5	Visual/Gravimetric	8/10/2023 / 1505 / CRS

NOTES:

- 1 mg/L = milligrams per liter (also, parts per million)
- 2 MPN/ 100 ml = Most Probable Number [of viable bacteria] per 100 ml of sample.
- 3 NTU = Nephelometric Turbidity Units
- 4 Results less than or within the reference range are considered satisfactory and within potable water limits at the time of sampling.
- 5 Sample collected by client, analyzed as received
- 6 ND:None Detected
- 7 pH and Chlorine level tested in lab (pH tested after recommended holding time)
- 8 Visual well check: Sealed, vented cap

Reason for Test : Use & Occupancy
Building Permit # : B22002740

Date Reported: 8/11/2023

Maura J. Rossman, M.D., Health Officer

MEMORANDUM

TO: Michael Barlow Well Drilling
Attn: Michael Barlow MWD 355
522 Underwood Lane
Bel Air, MD 21014

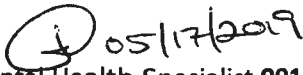
FROM: Joseph Cabahug  05/17/2019
Licensed Environmental Health Specialist **001997**
Howard County Health Department
Well & Septic Program

RE: Simpson and Denault Well Permit Special Conditions

DATE: 05/17/2019

This memorandum serves to inform the driller serving The Simpson and Denault Subdivision for construction of a new potable wells for residential use of the special conditions associated with the release of the well permits.

In accordance with current approved Percolation Certification (signed 03/27/2019), the following conditions apply:

Note 15(d) Wells installed on **Lots 2 – 8, 12 – 14, 23, 26 – 34, 38, and 39** must be installed as steel casing to depth of at least 50' below the soil surface or 10 feet into competent bedrock, whichever is deeper.

In accordance with the Water Appropriation and Use Permit (**HO2017G001(01)**), the following conditions apply:

Page 3, Section 15: The Permittee shall conduct simultaneous yield tests of wells closer than 100 feet apart, if at least one of the wells is on a lot less than one acre in size. The yield testing shall be conducted to ensure that the minimum yield requirements of COMAR 26.04.04.26 are met. In the event that a well that has been tested simultaneously with other wells does not meet minimum yield standards, the Permittee may relocate a well to achieve the 100-foot separation distance, deepen or otherwise modify the well to improve its yield or drill a second well to be used in tandem to meet the minimum yield standards during simultaneous testing. All wells shall comply with the well construction requirements.

Lots 26, 28, 38 – 44

Maura J. Rossman, M.D., Health Officer

Lots that are less than one acre are shown below.

MINIMUM LOT SIZE CHART			
LOT No.	GROSS AREA (SF)	PIPE STEM	NET AREA
1	54,825		54825
2	59,641		59641
3	55,018		55018
4	41,925		41925
5	40,840		40840
6	55,788		55788
7	55,833		55833
8	45,774		45774
9	42,992		42992
10	44,020		44020
11	42,068		42068
12	40,362		40362
13	41,330		41330
14	56,648	6700	49948
15	40,459		40459
16	49,871		49871
17	40,003		40003
18	40,443		40443
19	40,461		40461
20	40,461		40461
21	40,218		40218
22	54,686		54686
23	55,798		55798
24	44,052	1375	42677
25	41,612	2906	38706
26	48,488	5322	43166
27	46,396		46396
28	40,768		40768
29	44,270		44270
30	44,589		44589
31	46,366		46366
32	49,299		49299
33	47,918		47918
34	52,931		52931
35	54,827	2518	52309
36	44,800	9617	41183
37	55,035	4441	50595
38	33,223	2913	30310
39	31,227		31227
40	35,865		35865
41	40,100		40100
42	34,182		34182
43	41,390		41390
44	41,360		41360
45	45,097		45097
TOTAL AREA	2,043,259	AC	46.91
			S.F.

Please reach out to the Howard County Health Department – Bureau of the Environment with further questions.

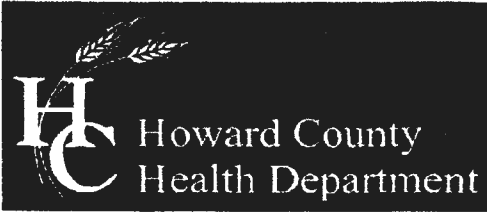

Bureau of Environmental Health

8930 Stanford Boulevard, Columbia, MD 21045

Main: 410-313-2640 | Fax: 410-313-2648

TDD 410-313-2323 | Toll Free 1-866-313-6300

www.hchealth.org

Facebook: www.facebook.com/hocohealth

Twitter: HowardCoHealthDep

Dr. Maura J. Rossman, M.D., Health Officer

TO ALL INTERESTED PARTIES

When submitting a well permit application for a proposed well for new construction, please indicate one of the following:

Well Site Location:

LOT #'S 1, 2, 3, 4, 7, 8, 9, 10, 11, 14, PARCEL C, 16, 17, 18, 19, 20, 21, 22, 23, 24, 25, 26, 27, 28, 29, 30, 31, 32, 33, 34, 35, 36, 37, 38, 39, 40, 41, 42, 43, 44, 45

SIMPSON/DENAULT
Subdivision/Property Name

Lot #

GREEN BRIDGE RD.
Road Name

X The well site has been staked by SHANABERGER & LANE
(professional land surveyor or company employing professional land surveyors)
on 1/9/19 (date) and does not require a site inspection.

The well driller, builder or property owner will call the Health Department to schedule a time to meet in the field to verify the proposed well site location.

This sheet, along with two copies of an acceptable well site plan, must be attached to the green well permit application.

Revised 4/22/14



THE NORTH ARROW POINTS TO THE NORTH
AND THE DIMENSIONS ARE IN FEET AND INCHES
UNLESS OTHERWISE NOTED.

NO CURB OR SIDEWALK SHALL BE REQUIRED
UNLESS OTHERWISE NOTED.
ALL DIMENSIONS SHALL BE TO THE CENTERLINE
UNLESS OTHERWISE NOTED.

0.48'

LOT 36
44,800 SF *

LOT 35
54,827 SF *

127

125

10,004 SF
S.D.A.

126

GgB
Mac

123

122

10,000 SF
S.D.A.

120

121

10' X 10' GRINDER
PUMP EASEMENT

WELL SITE DRAWING
SIMPSON & DENAULT PROPERTIES
LOT 35

TAX MAP 27 GRID 18
PARCELS 34, 36, 98, 111, & 112
5TH ELECTION DIST.
HOWARD COUNTY, MD.
SCALE: 1"=50' DATE: 2/21/19

APPROVED 5/17/2019 P 00997
STAKED BY SHAN/LANE

HO-18-0082

SHANABERGER & LANE
8726 TOWN AND COUNTRY BLVD., SUITE 201
ELLCOTT CITY, MD. 21043
(410)461-9563 FAX: (410)461-9693