

**SITE INSPECTION SHEET**

OWNER: Yanira Rubio PHONE #: 410-916-0644  
ADDRESS: 10711 Moosberger Ct CONTRACTOR: —  
Columbia, MD. 21044 WELL TAG #: H0-73-3059  
SUBDIVISION: Riverside Estates LOT: 26 COUNTY #: 05382424  
PROPOSAL: Sewage surfacing complaint - Community Hygiene  
Complaint - NO NUISANCE OBSERVED

**LOCATION DIAGRAM**

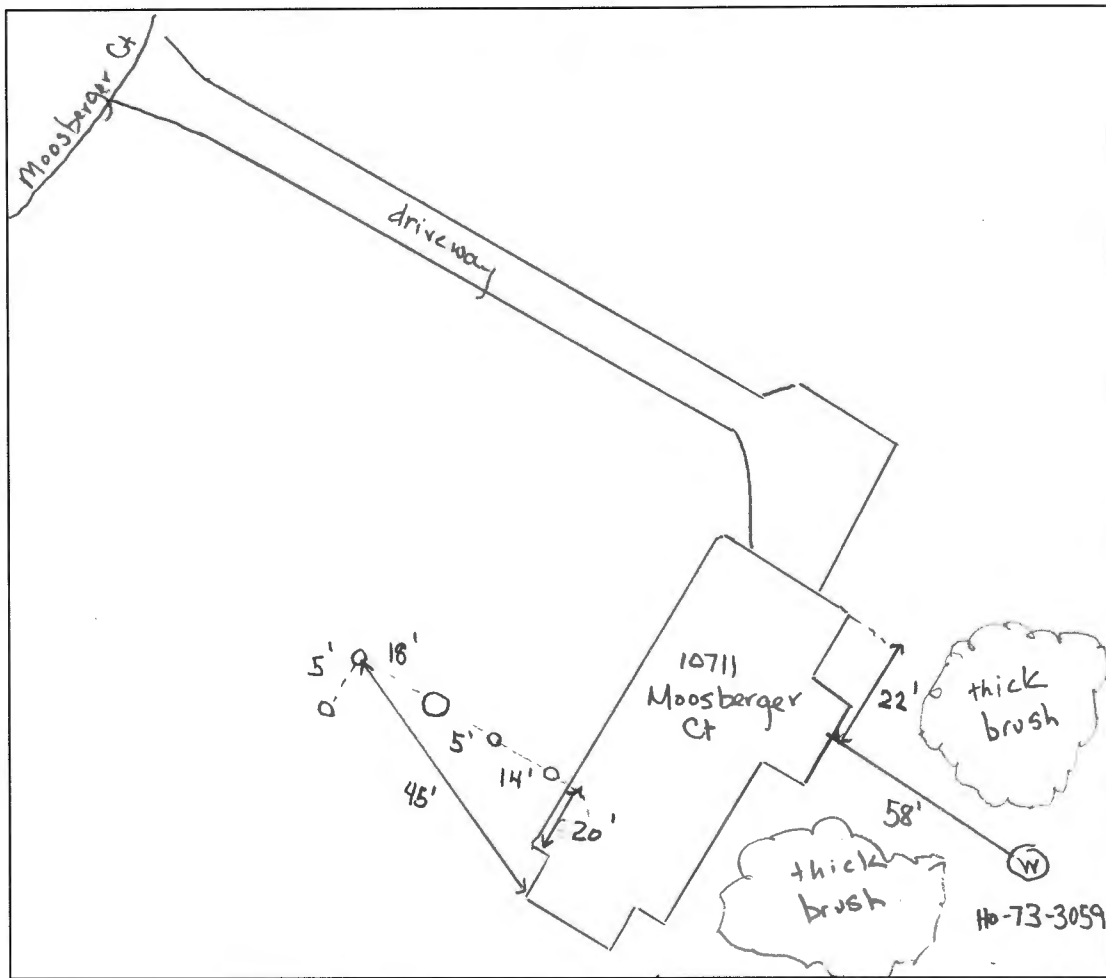

COMMENTS: \_\_\_\_\_

No sewage observed on the ground anywhere on the property.  
All the septic c/p's & riser look well intact, no damage observed.  
As built completed for BEH records, the onsite well was located, H0-73-3059  
and qps'd - also for BEH records.

DATE: 6/14/23 INSPECTOR: R. Rappaport

Real Property Data Search ( )  
 Search Result for HOWARD COUNTY

[View Map](#)      [View GroundRent Redemption](#)      [View GroundRent Registration](#)

Special Tax Recapture: None

Account Identifier: District - 05 Account Number - 382424

**Owner Information**

Owner Name: RUBIO YANIRA M      Use: RESIDENTIAL  
 VALLEJO GONZALEZ NERIS RAUL      Principal Residence: YES  
 Mailing Address: 10711 MOOSBERGER CT      Deed Reference: /21763/ 00074  
 COLUMBIA MD 21044-4215

As of June  
2023

**Location & Structure Information**

Premises Address: 10711 MOOSBERGER CT      Legal Description: LOT 26 BL-H .971 A  
 COLUMBIA MD 21044-0000      10711 MOOSBERGER CT  
 RIVERSIDE ESTATE

Map: Grid: Parcel: Neighborhood: Subdivision: Section: Block: Lot: Assessment Year: Plat No:  
 0041 0011 0420 5020203.14 2303 26 2023 Plat Ref:

Town: None

Primary Structure Built Above Grade Living Area Finished Basement Area Property Land Area County Use  
 1979 2,372 SF 42,296 SF

StoriesBasementType ExteriorQualityFull/Half Bath Garage Last Notice of Major Improvements  
 2 YES STANDARD UNITFRAME/4 2 full/ 1 half 1 Attached

**Value Information**

	Base Value	Value As of 01/01/2023	Phase-in Assessments	
			As of 07/01/2022	As of 07/01/2023
Land:	250,600	275,600		
Improvements	277,400	386,000		
Total:	528,000	661,600	528,000	572,533
Preferential Land:	0	0		

**Transfer Information**

Seller: WOLFE PEARL S      Date: 10/19/2022      Price: \$630,000  
 Type: ARMS LENGTH IMPROVED      Deed1: /21763/ 00074      Deed2:  
 Seller:      Date:      Price: \$0  
 Type: NON-ARMS LENGTH OTHER      Deed1: /00961/ 00219      Deed2:  
 Seller:      Date:      Price:  
 Type:      Deed1:      Deed2:

**Exemption Information**

Partial Exempt Assessments:Class      07/01/2022      07/01/2023  
 County: 000      0.00  
 State: 000      0.00  
 Municipal: 000      0.00|0.00      0.00|0.00

Special Tax Recapture: None

**Homestead Application Information**

Homestead Application Status: No Application

**Homeowners' Tax Credit Application Information**

Homeowners' Tax Credit Application Status: No Application      Date: