

Bureau of Environmental Health
 8930 Stanford Boulevard, Columbia, MD 21045
 Main: 410-313-2640 | Fax: 410-313-2648
 TDD 410-313-2323 | Toll Free 1-866-313-6300
www.hchealth.org
 Facebook: www.facebook.com/hocohealth

Maura J. Rossman, M.D., Health Officer

RECEIPT DATE: 7/20/2023 **ONSITE SEWAGE DISPOSAL SYSTEM** P 574949

APPROVAL DATE: 8/1/2023 **PERMIT:** **REPAIR** A Repair

PROPERTY ADDRESS: 11420 Homewood Road

SUBDIVISION: _____ LOT: _____ TAX ID: 03-299570

CONTRACTOR: Hatfield's Equipment EMAIL: Ken@hatfieldsequipment.com

CONTRACTOR ADDRESS: PO Box 519 Annapolis Junction PHONE: 410-984-4880

PROPERTY OWNER: Mary Joe Crabtree EMAIL: _____

OWNER ADDRESS: Same as above PHONE: _____

SEPTIC TANK SIZE: 1500 PUMP TANK CAPACITY: N/a PUMP SIZE: n/a

DISTRIBUTION SYSTEM: GRAVITY PRESSURE DOSED BEDROOMS: 4 APPLICATION RATE: 0.8

TRENCHES:	LINEAR FEET REQUIRED: <u>120</u>	INLET DEPTH: <u>2</u>
	TRENCH WIDTH: <u>2</u>	MAXIMUM BOTTOM DEPTH: <u>8</u>
	MINIMUM SPACE BETWEEN TRENCHES: <u>9</u>	EFFECTIVE AREA BEGINNING DEPTH: <u>3</u>
LOCATION:	TO BE STAKED BY SANITARIAN DURING PRE-CONSTRUCTION INSPECTION.	
NOTES:	Install system per approved design.	

ISSUED BY: K. Wolf, L.E.H.S. ISSUE DATE: 7/20/23 EXPIRATION DATE: 7/20/24

- NOTE: CONTRACTOR MUST SCHEDULE A PRE-CONSTRUCTION INSPECTION PRIOR TO BEGINNING ANY INSTALLATION
- NOTE: CONTRACTOR MUST SCHEDULE AN INSPECTION AND GAIN APPROVAL OF ALL COMPONENTS PRIOR TO COVERING
- NOTE: STONE MUST BE APPROVED BY HEALTH DEPARTMENT AND GRAVEL TICKET MUST BE AVAILABLE FOR REVIEW.
- NOTE: WATERTIGHT SEPTIC TANKS REQUIRED
- NOTE: ALL PARTS OF SEPTIC SYSTEM SHALL BE AT LEAST 100 FEET DOWNGRAIDENT FROM ANY WATER WELL
- NOTE: MANHOLE RISERS REQUIRED ON ALL SEPTIC TANKS AND PUMP CHAMBERS
- NOTE: AN ELECTRICAL PERMIT IS REQUIRED FOR INSTALLATION OF ANY ELECTRICAL COMPONENTS OF THE SYSTEM
 ELECTRICAL PERMIT ISSUED E n/a
- NOTE: THE HCHD DOES NOT WARRANTY ANY SYSTEM AND CANNOT GUARANTEE THE PERFORMANCE OF THIS SYSTEM AS DESIGNED. BY ACCEPTING THIS PERMIT, THE OWNER AND/OR APPLICANT ACKNOWLEDGE THAT THE SPECIFICATIONS DETAILED IN THIS DESIGN ARE ONE POSSIBLE OPTION AND THAT THE HCHD WILL REVIEW OTHER PROPOSALS. YOU HAVE THE OPTION TO SEEK THE ADVICE OF A QUALIFIED DESIGN CONSULTANT OR PROFESSIONAL ENGINEER FOR FURTHER GUIDANCE.
- NOTE: AN INDIVIDUAL CERTIFIED BY MDE AND THE MANUFACTURER FOR BAT INSTALLATION MUST BE PRESENT AT ALL TIMES DURING BAT INSTALLATION.
- NOTE: MDE RECOMMENDS SEPTIC TANKS, BAT, AND OTHER PRETREATMENT UNITS BE PUMPED AT A FREQUENCY ADEQUATE TO ENSURE THAT SOLIDS ARE NOT DISCHARGED TO THE DISPOSAL AREA

**NEITHER THE HOWARD COUNTY COUNCIL NOR THE HEALTH DEPARTMENT IS RESPONSIBLE FOR THE SUCCESSFUL OPERATION OF ANY SYSTEM.
 PERMITTEE RESPONSIBLE FOR OBTAINING FINAL APPROVAL ON THIS PERMIT.
 CALL 410-313-1771 TO SCHEDULE INSPECTIONS.**

NOT TO SCALE

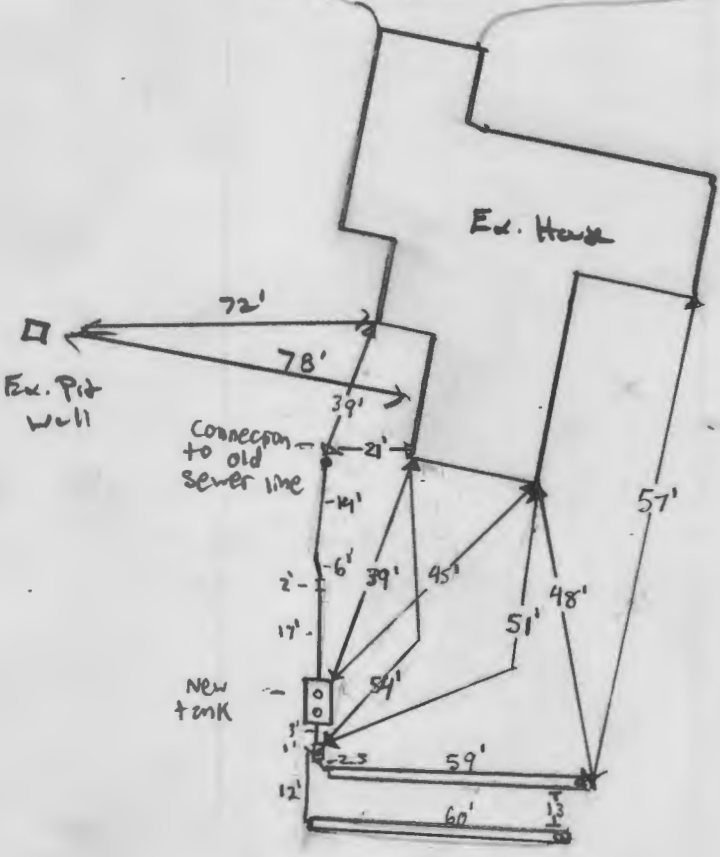

TRENCH/DRAINFIELD DATA		
WIDTH	INLET	BOTTOM
2'	2'	8'
NUMBER OF TRENCHES		2
TOTAL LENGTH		119
ABSORPTION AREA		238 ft ²
DISTRIBUTION BOX LEVEL		yes
DISTRIBUTION BOX BAFFLE		yes
DISTRIBUTION BOX PORT		yes

(New) SEPTIC TANK DATA	
SEPTIC TANK 1 LEVEL	yes
MANUFACTURER	Babylon
CAPACITY	1500 GAL
SEAM LOC	top
TANK LID DEPTH	
BAFFLES	4" back & 6" front
BAFFLE FILTER	
MANHOLE LOC	front & back
6" PORT LOC	
WATERTIGHT TEST	
SLOTTED	yes
DATE ON LID	6/20/2023
PUMP/SEPTIC TANK LEVEL N/A	
MANUFACTURER	
CAPACITY	GAL
SEAM LOC	
TANK LID DEPTH	
BAFFLES	
BAFFLE FILTER	
MANHOLE LOC	
6" PORT LOC	
WATERTIGHT TEST	
SLOTTED	
DATE ON LID	

ROAD NAME

PRE-CONSTRUCTION: 7/20/2023 Design plan approved. OK to draw permit (KIM)

INSTALLATION: 7/31/2023 - Installer finishing lower trench, staking end of trench & laying pipe. Fabric & stone for lower trench OK. Rubber boot used to connect ex. sewer line to new line, cap installed @ rubber boot. Adequate fall @ inlet. Tank set, 1500 2 compartment, slotted 6" front & 9" back baffle installed. Waited for D-box to be paged while onsite. Measured lower trench length @ 60' upper @ 59'. space between trench 13'. Inlet @ 2' per plan. Large boulders found in upper 3-4 feet of trench, side wall cured in. Installer stated boulders not found in bottom trench. D-box leveled while onsite, old part installed. OK to backfill all work. (P)

FINAL INSPECTOR S. Page DATE OF APPROVAL 8/1/2023
 8/1/2023 - Installer pumped & collapsed existing tanks. See attached pics sp

RECEIPT

Howard County, MD
HOWARD COUNTY HEALTH DEPARTMENT
ASCEND ONE BUILDING
Columbia, MD 21045
8930 STANFORD BLVD

Application: WS-SP-APP-23-00151
Application Type: EnvHealth/Well and Septic/Sewage Disposal System/Application
Address: 11420 Homewood RD,

Receipt No.	7541					
Payment Method	Ref Number	Amount Paid	Payment Date	Cashier ID	Received	Comments
Check	4640	\$265.00	08/01/2023	SMARTIN		PREVIOUSLY PAID 7/19/23

Work Description: Septic Repair/ 11420 Homewood Rd



Abandoned Septic Tanks
8/1/2023 (SP)

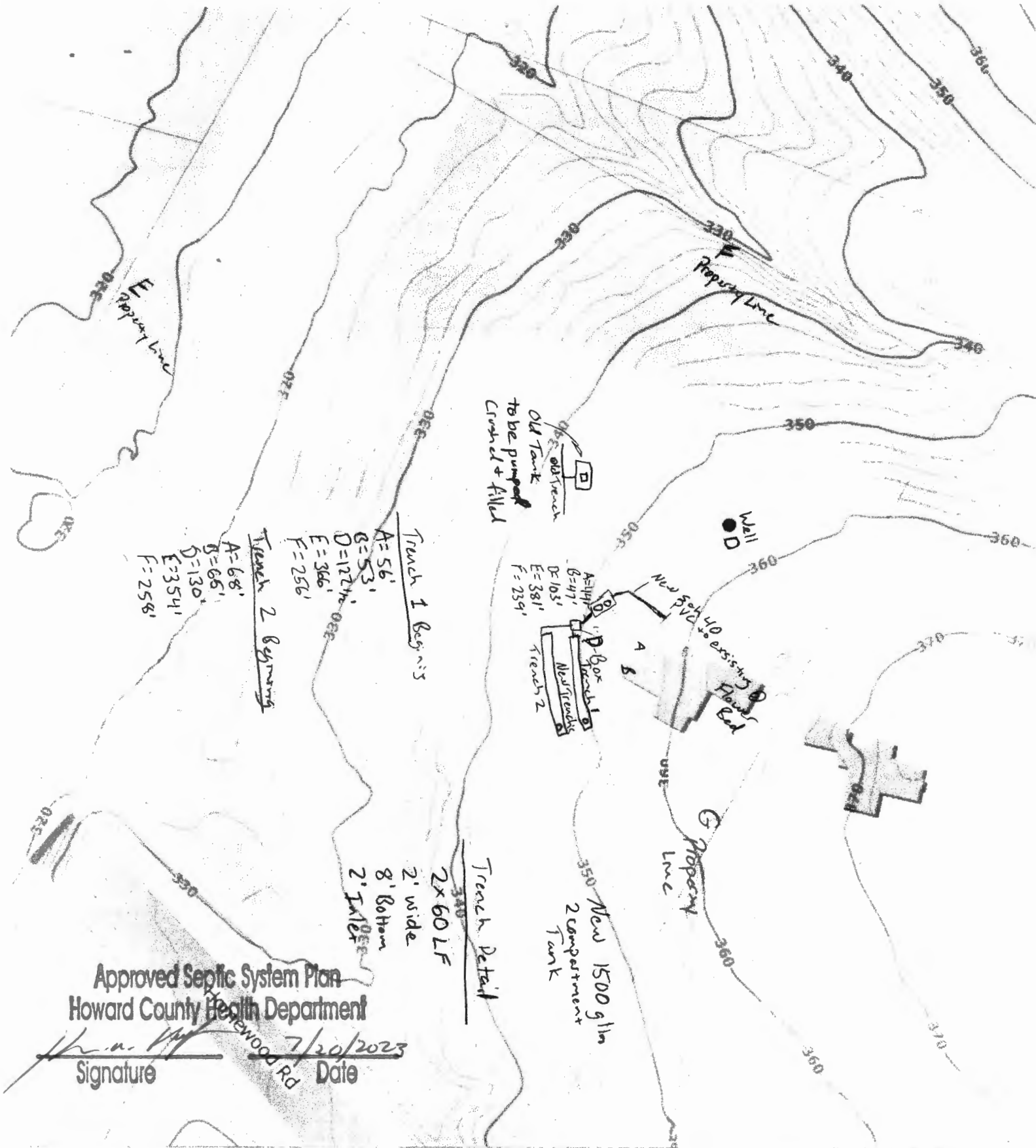

Trench 1 Begins
 A=56'
 B=53'
 D=127 1/2'
 E=366'
 F=256'

Trench 2 Begins
 A=68'
 B=65'
 D=130'
 E=354'
 F=258'

Trench Detail
 2x 60 LF
 2' wide
 8' Bottom
 2" 1/2" DIA

Approved Septic System Plan
 Howard County Health Department

[Signature] 7/20/2023
 Signature Date

11420 Homewood Road
 Elliot City