

DEPT. OF INSPECTIONS, LICENSES AND PERMITS 3430 COURT HOUSE DRIVE ELLICOTT CITY, MD 21043 PERMITS (410) 313-2453 INSPECTIONS (410) 313-1810 AUTOMATED INFORMATION (410) 313-3600		HOWARD COUNTY PERMIT APPLICATION		PERMIT NUMBER B09003139	
Building Address <u>1419 Triadelphia Mill Rd.</u> <u>Dayton, MD 21036</u>			Property Owner's Name <u>Dave and Vicki Baxter</u> Address <u>1419 Triadelphia Mill Rd.</u> City <u>Dayton</u> State <u>MD</u> Zip Code <u>21036</u> Home Phone <u>410-531-7383</u> Work Phone <u>410-925-8814</u> Applicant's Name & Mailing Address, (if other than stated herein):		
Suite/Apt. #: _____ SDP/WP/Petition #: _____ Census Tract _____ Subdivision _____ Section _____ Area _____ Lot _____ Tax Map _____ Parcel _____ Grid _____ Zoning _____ Map Coordinates _____ Lot Size _____			Contractor Company <u>WDL Carpentry, Inc.</u> Contact Person <u>Dan Lewis</u> Address _____ City _____ State _____ Zip Code _____ License No. _____ Phone <u>410-531-7383</u> Fax _____		
Existing Use _____ Proposed Use _____ Estimated Construction Cost \$ _____ Description of Work _____ Occupant or Tenant _____ Contact Name _____ Address _____ City _____ State _____ Zip Code _____ Phone _____ Fax _____			Engineer or Architect Company _____ Contact Person _____ Address _____ City _____ State _____ Zip Code _____ Phone _____ Fax _____		

BUILDING DESCRIPTION - COMMERCIAL		BUILDING DESCRIPTION - RESIDENTIAL	
Building Characteristics Height: _____ No. of stories: _____ Gross area, sq. ft. per floor: _____ Use group: _____ Construction type: <input type="checkbox"/> Reinforced Concrete <input type="checkbox"/> Structural Steel <input type="checkbox"/> Masonry <input type="checkbox"/> Wood Frame <input type="checkbox"/> State Certified Modular	Utilities Water Supply: <input type="checkbox"/> Public <input type="checkbox"/> Private Sewage Disposal: <input type="checkbox"/> Public <input type="checkbox"/> Private Electric Yes <input type="checkbox"/> No <input type="checkbox"/> Gas Yes <input type="checkbox"/> No <input type="checkbox"/> Heating System: Electric <input type="checkbox"/> Oil <input type="checkbox"/> Natural Gas <input type="checkbox"/> Propane Gas <input type="checkbox"/> Sprinkler system: N/A <input type="checkbox"/> <input type="checkbox"/> Full <input type="checkbox"/> Partial <input type="checkbox"/> Other Suppression <input type="checkbox"/> # of Heads	Building Characteristics SF Dwelling <input checked="" type="checkbox"/> SF Townhouse <input type="checkbox"/> Depth _____ Width _____ 1 st floor: _____ 2 nd floor: _____ Basement: _____ Finished Basement <input type="checkbox"/> Unfinished Basement <input type="checkbox"/> Crawl space <input type="checkbox"/> Slab on Grade <input type="checkbox"/> No. of Bedrooms <u>5</u> Multi-family dwellings: No. of efficiency units: _____ No. of 1 BR units: _____ No. of 2 BR units: _____ No. of 3 BR units: _____ Other Structure: _____ Dimensions: _____ Footings: _____ Roof: _____ <input type="checkbox"/> State Certified Modular <input type="checkbox"/> Manufactured Home	Utilities Water Supply: <input type="checkbox"/> Public <input checked="" type="checkbox"/> Private Sewage Disposal: <input type="checkbox"/> Public <input checked="" type="checkbox"/> Private Electric Yes <input checked="" type="checkbox"/> No <input type="checkbox"/> Gas Yes <input checked="" type="checkbox"/> No <input type="checkbox"/> Heating System: Electric <input type="checkbox"/> Oil <input type="checkbox"/> Natural Gas <input type="checkbox"/> Propane Gas <input checked="" type="checkbox"/> Sprinkler system: N/A <input checked="" type="checkbox"/> <input type="checkbox"/> NFPA #13D <input type="checkbox"/> NFPA #13R <input type="checkbox"/> Other:

THE UNDERSIGNED HEREBY CERTIFIES AND AGREES AS FOLLOWS: (1) THAT HE/SHE IS AUTHORIZED TO MAKE THIS APPLICATION; (2) THAT THE INFORMATION IS CORRECT; (3) THAT HE/SHE WILL COMPLY WITH ALL REGULATIONS OF HOWARD COUNTY WHICH ARE APPLICABLE THERETO; (4) THAT HE/SHE WILL PERFORM NO WORK ON THE ABOVE REFERENCED PROPERTY NOT SPECIFICALLY DESCRIBED IN THIS APPLICATION; (5) THAT HE/SHE GRANTS COUNTY OFFICIALS THE RIGHT TO ENTER ONTO THIS PROPERTY FOR THE PURPOSE OF INSPECTING THE WORK PERMITTED AND POSTING NOTICES.

Applicant's Signature WDL Carpentry, Inc. Title/Company
 Print Name Dan Lewis
 Date _____

Checks payable to: DIRECTOR OF FINANCE OF HOWARD COUNTY
 PLEASE WRITE NEATLY AND LEGIBLY
 FOR OFFICE USE ONLY -

AGENCY	DATE	SIGNATURE APPROVAL	DPZ SETBACK INFORMATION	PROPERTY ID #
Land Development, DPZ			Front: _____ Rear: _____ Side: _____ Side St: _____	Filing fee \$ _____ Permit fee \$ _____ Excise tax \$ _____ Add'l per fee \$ _____ TOTAL FEES \$ _____ Sub-total paid \$ _____ Balance due \$ _____ Check # _____ Validation # _____
State Highways				
Building Officials				
Dev. Engineering, DPZ				
Health	<u>01/29/09</u>	<u>[Signature]</u>	All minimum setbacks met? YES <input type="checkbox"/> NO <input type="checkbox"/>	
Fire Protection			Is Entrance Permit Required? YES <input type="checkbox"/> NO <input type="checkbox"/>	
Is Sediment Control approval required prior to issuance? YES <input type="checkbox"/> NO <input type="checkbox"/>			Historic District? YES <input type="checkbox"/> NO <input type="checkbox"/>	
CONTINGENCY CONSTRUCTION START: <input type="checkbox"/>			Lot Coverage for New Town Zone	
ONE STOP SHOP: <input type="checkbox"/>			SDP/Red-line approval date	Accepted by _____

TV

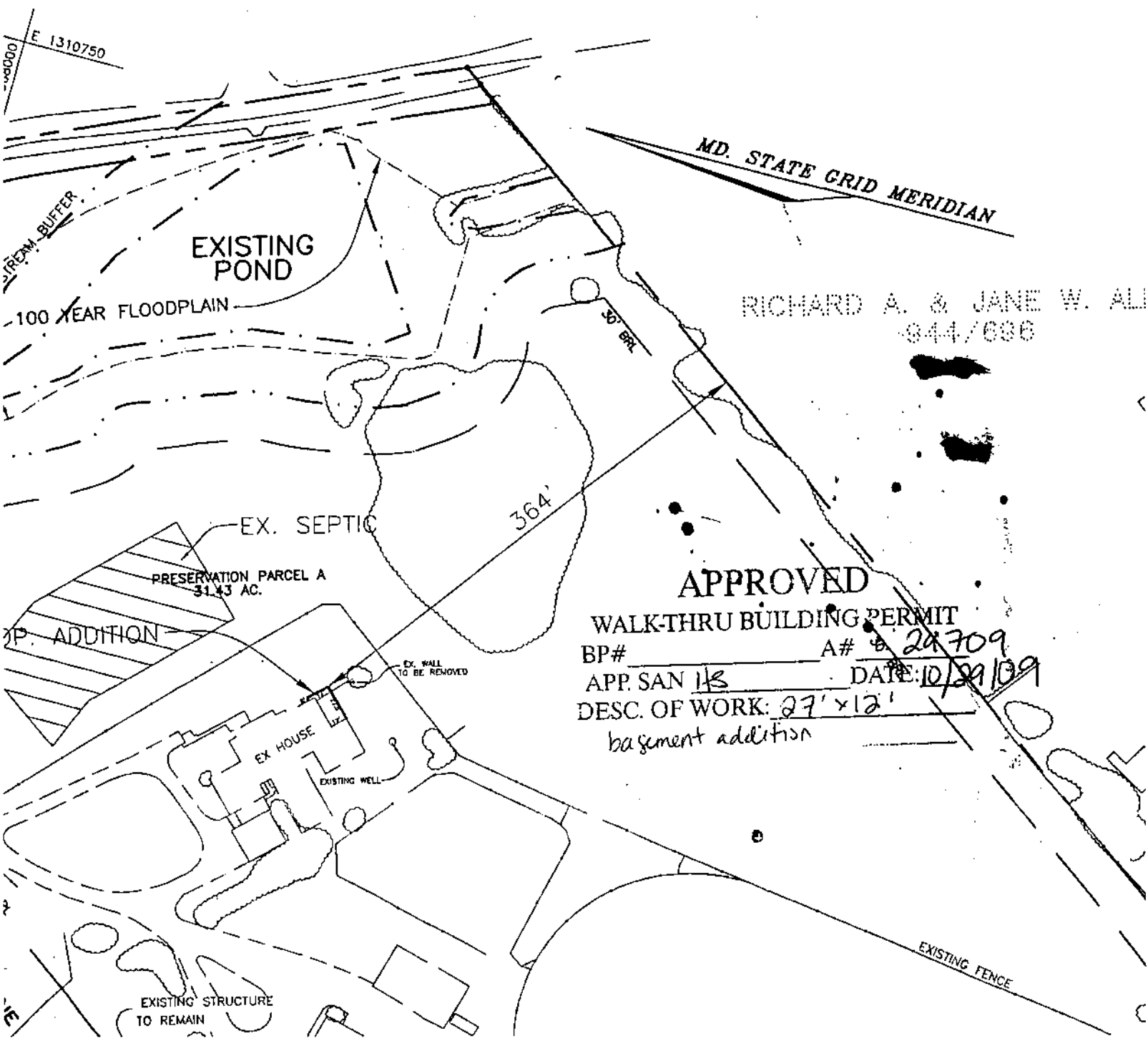

RICHARD A. & JANE W. ALI
 844/686

APPROVED
 WALK-THRU BUILDING PERMIT
 BP# _____ A# 24709
 APP. SAN 118 DATE: 10/29/09
 DESC. OF WORK: 27' x 12'
 basement addition

EXISTING STRUCTURE
 TO REMAIN

EXISTING FENCE