

C 1 71813

SEQUENCE NO. (MDE USE ONLY)

STATE OF MARYLAND WELL COMPLETION REPORT

THIS REPORT MUST BE SUBMITTED WITHIN 45 DAYS AFTER WELL IS COMPLETED.

1 2 3 6 (THIS NUMBER IS TO BE PUNCHED IN COLS. 3-6 ON ALL CARDS)

COUNTY NUMBER

ST/CO USE ONLY DATE RECEIVED

DATE WELL COMPLETED

Depth of Well

PERMIT NO. FROM "PERMIT TO DRILL WELL"

OWNER, WELL SITE ADDRESS, TOWN, SUBDIVISION, SECTION, LOT

WELL LOG table with columns: DESCRIPTION, FEET (FROM, TO), check if water bearing. Includes handwritten entries: Topsoil, Brn Clay, Brn Rock, Gray Rock.

GROUTING RECORD section with checkboxes for Y/N and fields for CEMENT, BENTONITE CLAY, NO. OF BAGS, NO. OF POUNDS, GALLONS OF WATER, DEPTH OF GROUT SEAL.

CASING RECORD section with checkboxes for ST, CO, PL, OT and fields for MAIN CASING TYPE, Nominal diameter, Total depth.

OTHER CASING (if used) section with fields for diameter and depth.

SCREEN RECORD section with checkboxes for ST, BR, HO, PL, OT and a DEPTH (nearest ft.) scale.

NUMBER OF UNSUCCESSFUL WELLS and WELL HYDROFRACTURED checkboxes.

- CIRCLE APPROPRIATE LETTER: A WELL WAS ABANDONED AND SEALED, E ELECTRIC LOG OBTAINED, P TEST WELL CONVERTED TO PRODUCTION WELL.

I HEREBY CERTIFY THAT THIS WELL HAS BEEN CONSTRUCTED IN ACCORDANCE WITH COMAR 26.04.04 "WELL CONSTRUCTION" AND IN CONFORMANCE WITH ALL CONDITIONS STATED IN THE ABOVE CAPTIONED PERMIT...

DRILLERS LIC. NO. and SIGNATURE (Michael Kohler)

LIC. NO. and SIGNATURE (Michael Kohler)

SITE SUPERVISOR (sign. of driller or journeyman responsible for sitework if different from permittee)

GRAVEL PACK IF WELL DRILLED WAS FLOWING WELL INSERT F IN BOX 68

MDE USE ONLY (NOT TO BE FILLED IN BY DRILLER) section with fields T, W, Q, 70, 72, 74, 75, 76.

PUMPING TEST section with fields for HOURS PUMPED, PUMPING RATE, METHOD USED TO MEASURE PUMPING RATE, WATER LEVEL, BEFORE PUMPING, WHEN PUMPING, TYPE OF PUMP USED.

PUMP INSTALLED section with fields for DRILLER INSTALLED PUMP, IF DRILLER INSTALLS PUMP, TYPE OF PUMP INSTALLED PLACE, CAPACITY, PUMP HORSE POWER, PUMP COLUMN LENGTH, CASING HEIGHT.

LATITUDE 39.112, LONGITUDE 76.56720 (DEFAULT COORD. WGS 84)

Pursuant to §10-624 of the State Govt. Article of the Maryland Code personal info. requested on this form is used in processing this form pursuant to COMAR 26.04.04. Failure to provide the info. may result in this form not being processed.

TAG: 9/9/22 (H)

B 1 87343 SEQUENCE NO. (MDE USE ONLY) **STATE OF MARYLAND** STATE PERMIT NUMBER HD - 20 - 0217
APPLICATION FOR PERMIT TO DRILL WELL
 please type fill in this form completely

OWNER INFORMATION
 Date Received (APA) _____
 8 MM DD YY 13
Tanner Micah + Analisa
 15 Last Name Owner First Name 34
10159 High Ridge Rd
 36 Street or RFD 55
Laurel MD 20723
 57 Town 70 State 72 Zip 76

B 3 **LOCATION OF WELL**
Howard
 8 COUNTY 21
 23 SUBDIVISION 42
 SECTION 44 46 LOT 48 50
Laurel
 52 NEAREST TOWN 71

DRILLER INFORMATION
Michael Kohler M SD 028
 Driller's Name 76 License No. 81
Applied Well Drilling
 Firm Name
PO Box 129 Annapolis Junction MD 20701
 Address
Michael Kohler 07/13/22
 Signature Date

B 4 **SOURCES OF DRILLING WATER**
 1. Public
 2. _____
 3. _____
10159 High Ridge Rd
 11 STREET ADDRESS 30
ON WHICH SIDE OF ROAD (CIRCLE APPROPRIATE BOX)
 NORTH
 WEST EAST
 SOUTH
 34 37
 DISTANCE FROM ROAD
 ENTER FT OR MI 38 39
 TAX MAP: 0047 BLK: _____ PARCEL 0567

B 2 **WELL INFORMATION**
 1 2 APPROX. PUMPING RATE (GAL. PER MIN.) _____ 8 _____ 12
 AVERAGE DAILY QUANTITY NEEDED (GAL. PER DAY) _____ 14 _____ 20

USE FOR WATER (CIRCLE APPROPRIATE BOX)
 DOMESTIC POTABLE SUPPLY & RESIDENTIAL IRRIGATION
 FARMING (LIVESTOCK WATERING & AGRICULTURAL IRRIGATION)
 INDUSTRIAL, COMMERCIAL, DEWATERING
 PUBLIC WATER SUPPLY WELL
 TEST, OBSERVATION, MONITORING
 OPEN LOOP GEOTHERMAL
 CLOSED LOOP GEOTHERMAL 2 loops

NOT TO BE FILLED IN BY DRILLER HEALTH DEPARTMENT APPROVAL
Howard COUNTY NAME 1111 COUNTY NO.
 STATE SIGNATURE _____ INSERT S → 41
 DATE ISSUED 08/17/22 43 MM DD YY 48 CO SIGNATURE _____ EXP. DATE 08/17/23
Don: 9/17/22 DOB: 7/8/22

APPROXIMATE DEPTH OF WELL 320 FEET
 24 28
 APPROXIMATE DIAMETER OF WELL 6 INCH NEAREST

PROPOSED LOCATION OF WELL ON LOT
 SHOW PERMANENT STRUCTURES SUCH AS BUILDINGS, SEPTIC SYSTEM, ROADS AND/OR LANDMARKS AND INDICATE NOT LESS THAN TWO DISTANCE MEASUREMENTS TO WELL
Gar
17' 20'
32' 28'

METHOD OF DRILLING (circle one)
 BORED (or Augered) JETTED Jetted & DRIVEN
 30 AIR-ROTary AIR-PERcussion ROTARY (Hydraulic Rotary)
 37 CABLE REVerse-ROTary DRive-POINT
 other _____

REPLACEMENT OR DEEPEMED WELLS (CIRCLE APPROPRIATE BOX)
 THIS WELL WILL NOT REPLACE AN EXISTING WELL
 THIS WELL WILL REPLACE A WELL THAT WILL BE ABANDONED AND SEALED
 THIS WELL WILL REPLACE A WELL THAT WILL BE USED AS A STANDBY-CONTACT LOCAL APPROVING AUTHORITY FOR POLICY ON STANDBY WELLS
 THIS WELL WILL DEEPEM AN EXISTING WELL
 PERMIT NUMBER OF WELL TO BE REPLACED OR DEEPEMED (IF AVAILABLE) 41 _____ 52

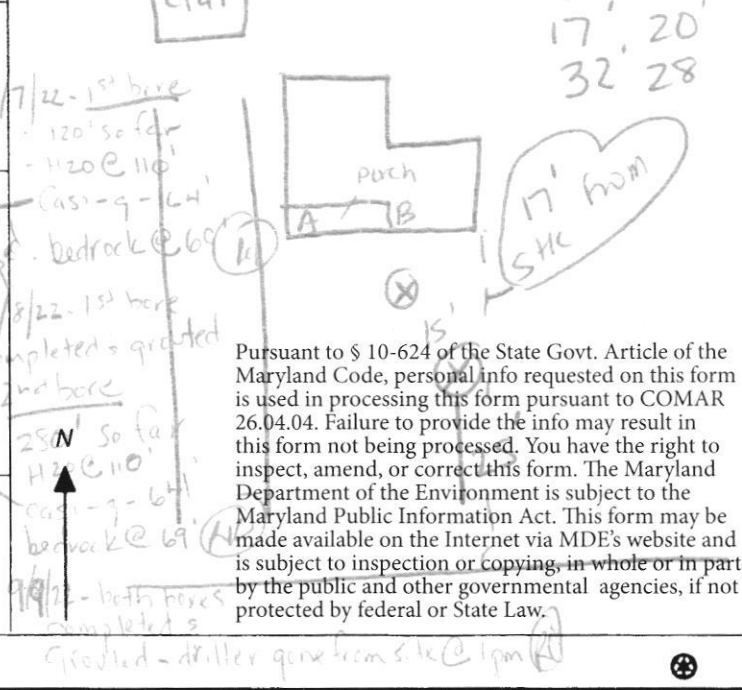

Not to be filled in by driller (MDE OR COUNTY USE ONLY)
 APPROX. PERMIT NUMBER _____ **G** _____
 PERMIT No. HD 20 0217
 70 71 72 73 74 75 76 77 78 79

SPECIAL CONDITIONS
 NOTE APPROVING AUTHORITIES SHOULD USE SEPARATE SHEET IF NEEDED-

AB
17 20
22 28



10159 High Ridge Rd
Laurel Md

2 wells 320' each
closed loop geo

Garage

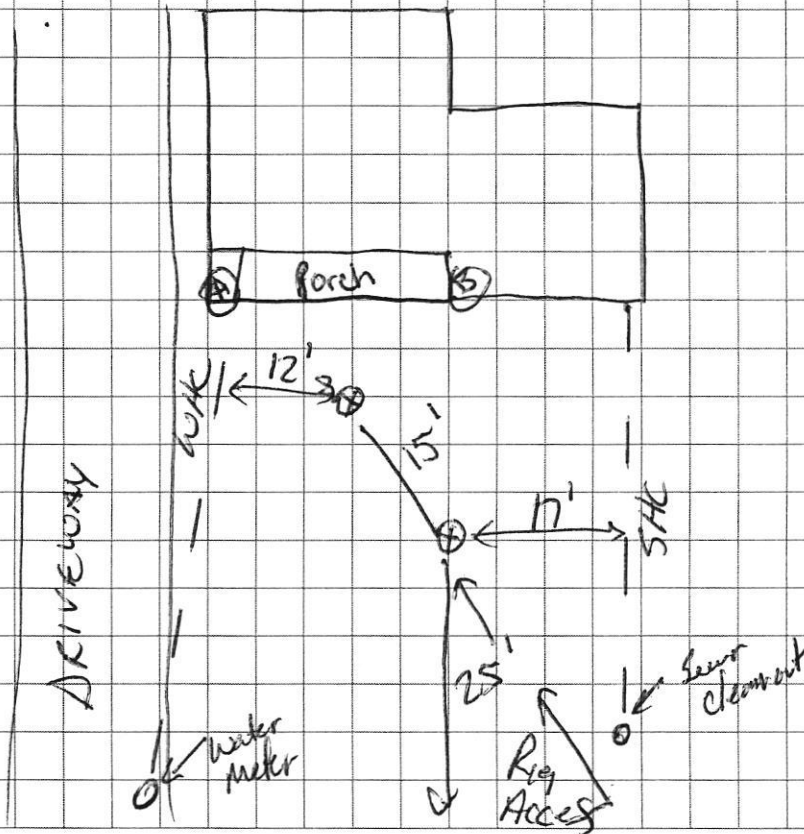

Approved 08/08/2022
Staked by Drill

Sediment Control Protocol: SILT FENCE

Distance From House: 20'
From Septic: N/A
From Sewer: 17' Cast Iron
From Property Line: 20'
From Street: 25'

Trees Nearby: NO
Utility Issues: NO
Mat
Acc
Neig

Comments: OVER HEAD Power, BACK A

Person Completing Form: Wes Wolfe

DO NOT REMOVE THIS TAG
DEPARTMENT OF THE ENVIRONMENT
WELL PERMIT NUMBER
HO-20-0217
INFORMATION - GIVE NUMBER AND WRITE
1800 WASHINGTON BLVD
BALTIMORE MARYLAND 21230

HOWARD COUNTY GROUTING PROCEDURE

Boreholes will be grouted from the bottom to the top via a tremie pipe and positive displacement pump. Bentonite grout, known as Quik-Grout will be used according to the manufacturer's specifications to achieve a consistency of at least 20% solids (24 gallons potable water/50 lb. sack of grout) and a permeability no more than $2.5 \text{ E}(-08) \text{ cm/sec}$. Grouting will be completed immediately after installing the geothermal loop and no later than twenty-four (24) hours after installing the geothermal loop. Open boreholes/annular space will be protected as necessary to prevent the entry of surface water or pollutants.

