

Bureau of Environmental Health
 8930 Stanford Boulevard, Columbia, MD 21045
 Main: 410-313-2640 | Fax: 410-313-2648
 TDD 410-313-2323 | Toll Free 1-866-313-6300
www.hchealth.org
 Facebook: www.facebook.com/hocohealth

Maura J. Rossman, M.D., Health Officer

RECEIPT DATE: 5/2/2023 **ONSITE SEWAGE DISPOSAL SYSTEM** P 574101

APPROVAL DATE: 6/16/2023 **PERMIT:** **REPAIR** A Repair

PROPERTY ADDRESS: 15225 Buck Run Road

SUBDIVISION: Wellington West LOT: P. A TAX ID: 04-365200

CONTRACTOR: Freedom Septic EMAIL: Christy@freedomseptic.com

CONTRACTOR ADDRESS: 2809 Liberty Rd, Sykesville, MD 21784 PHONE: 410-795-2947

PROPERTY OWNER: Timothy Stone EMAIL: _____

OWNER ADDRESS: Same as above PHONE: _____

SEPTIC TANK SIZE: Existing PUMP TANK CAPACITY: Existing PUMP SIZE: Existing

DISTRIBUTION SYSTEM: GRAVITY PRESSURE DOSED BEDROOMS: 4 APPLICATION RATE: 0.8

TRENCHES:	LINEAR FEET REQUIRED: <u>131</u>	INLET DEPTH: <u>2</u>
	TRENCH WIDTH: <u>3</u>	MAXIMUM BOTTOM DEPTH: <u>8</u>
	MINIMUM SPACE BETWEEN TRENCHES: <u>11</u>	EFFECTIVE AREA BEGINNING DEPTH: <u>4</u>

LOCATION: **TO BE STAKED BY SANITARIAN DURING PRE-CONSTRUCTION INSPECTION.**

NOTES: Install system per approved design plan. Will be utilizing existing septic tank and existing pump tank. Trenches staked out in field. Test of pump and the alarm is required for final approval of the septic.

ISSUED BY: K. Wolf ISSUE DATE: 5/2/2023 EXPIRATION DATE: 5/2/2024

- NOTE: CONTRACTOR MUST SCHEDULE A PRE-CONSTRUCTION INSPECTION PRIOR TO BEGINNING ANY INSTALLATION
- NOTE: CONTRACTOR MUST SCHEDULE AN INSPECTION AND GAIN APPROVAL OF ALL COMPONENTS PRIOR TO COVERING
- NOTE: STONE MUST BE APPROVED BY HEALTH DEPARTMENT AND GRAVEL TICKET MUST BE AVAILABLE FOR REVIEW.
- NOTE: WATERTIGHT SEPTIC TANKS REQUIRED
- NOTE: ALL PARTS OF SEPTIC SYSTEM SHALL BE AT LEAST 100 FEET DOWNGRADIENT FROM ANY WATER WELL
- NOTE: MANHOLE RISERS REQUIRED ON ALL SEPTIC TANKS AND PUMP CHAMBERS
- NOTE: AN ELECTRICAL PERMIT IS REQUIRED FOR INSTALLATION OF ANY ELECTRICAL COMPONENTS OF THE SYSTEM
 ELECTRICAL PERMIT ISSUED E
- NOTE: THE HCHD DOES NOT WARRANTY ANY SYSTEM AND CANNOT GUARANTEE THE PERFORMANCE OF THIS SYSTEM AS DESIGNED. BY ACCEPTING THIS PERMIT, THE OWNER AND/OR APPLICANT ACKNOWLEDGE THAT THE SPECIFICATIONS DETAILED IN THIS DESIGN ARE ONE POSSIBLE OPTION AND THAT THE HCHD WILL REVIEW OTHER PROPOSALS. YOU HAVE THE OPTION TO SEEK THE ADVICE OF A QUALIFIED DESIGN CONSULTANT OR PROFESSIONAL ENGINEER FOR FURTHER GUIDANCE.
- NOTE: AN INDIVIDUAL CERTIFIED BY MDE AND THE MANUFACTURER FOR BAT INSTALLATION MUST BE PRESENT AT ALL TIMES DURING BAT INSTALLATION.
- NOTE: MDE RECOMMENDS SEPTIC TANKS, BAT, AND OTHER PRETREATMENT UNITS BE PUMPED AT A FREQUENCY ADEQUATE TO ENSURE THAT SOLIDS ARE NOT DISCHARGED TO THE DISPOSAL AREA

NEITHER THE HOWARD COUNTY COUNCIL NOR THE HEALTH DEPARTMENT IS RESPONSIBLE FOR THE SUCCESSFUL OPERATION OF ANY SYSTEM.
PERMITTEE RESPONSIBLE FOR OBTAINING FINAL APPROVAL ON THIS PERMIT.
CALL 410-313-1771 TO SCHEDULE INSPECTIONS.

NOT TO SCALE

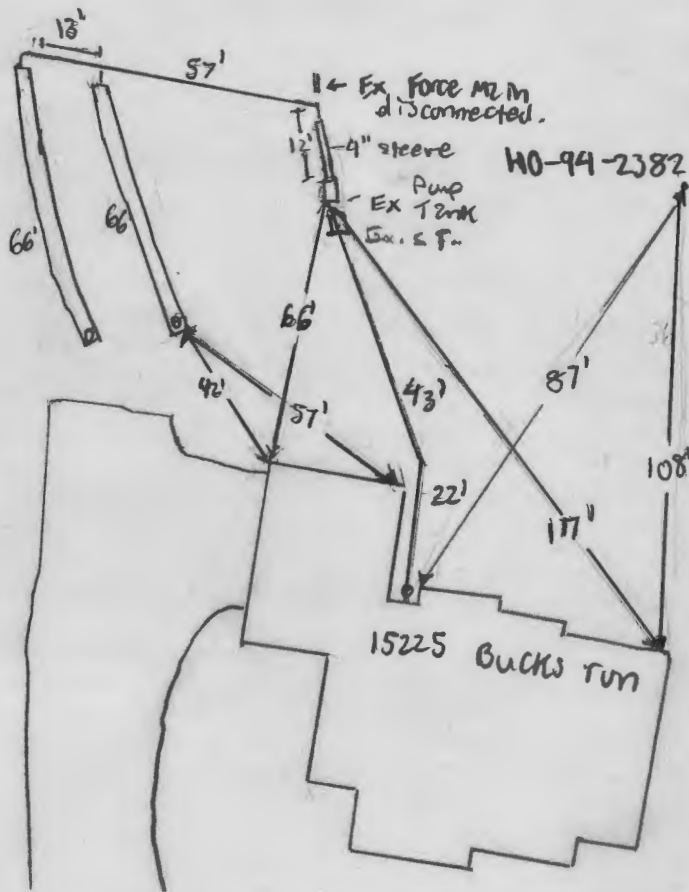

ROAD NAME

TRENCH/DRAINFIELD DATA

WIDTH	INLET	BOTTOM
3'	1.5'-2'	8'
NUMBER OF TRENCHES		3
TOTAL LENGTH _____		
ABSORPTION AREA _____		
DISTRIBUTION BOX LEVEL _____		
DISTRIBUTION BOX BAFFLE _____		
DISTRIBUTION BOX PORT <u>yes</u>		

SEPTIC TANK DATA

SEPTIC TANK 1 LEVEL	
MANUFACTURER	N/A
CAPACITY	1250 GAL
SEAM LOC	Top
TANK LID DEPTH	3'
BAFFLES	Yes
BAFFLE FILTER	—
MANHOLE LOC	Center
6" PORT LOC	Front
WATERTIGHT TEST	OK
SLOTTED	yes
DATE ON LID	—
SEPTIC TANK 2 LEVEL	
MANUFACTURER	N/A
CAPACITY	1250 GAL
SEAM LOC	Top
TANK LID DEPTH	3'
BAFFLES	no
BAFFLE FILTER	—
MANHOLE LOC	Center
6" PORT LOC	None
WATERTIGHT TEST	OK
SLOTTED	no
DATE ON LID	—

PRE-CONSTRUCTION:

5/11/2023 Design plan received approved (perm)

5/10/2023 met contractor onsite to discuss proposal. Tanks staked out per original design (perm)

INSTALLATION: 5/18/2023 - Installer finished 1st upper trench, obs part installed Inlet @ 1.5'-2'. 2nd trench started, installer waiting on stone. Measured bottom to be 8'-4". Stone in trenches OK, truck per stone came & had good stone. Measured obs part to house. Measured tank to house. Saw 12" of sleeve from tank 12' from tank is where old system was cut off (old PM). Saw new 12" boxes to trenches, measured lengths. (SP)

5/18/2023 - Installer finished 2nd trench, most of 2nd trench was backfilled. Inlet was 3', installer stated difference is due to contour. SCH40 40 pipe used on front line 1/2" F=211 achieved. P & A failed. No electricity going to pump. Alarm not properly set up. (SP)

6/16/2023 Test of the pump & alarms OK.

FINAL INSPECTOR K. [Signature] DATE OF APPROVAL 6/16/2023



HOWARD COUNTY HEALTH DEPARTMENT

72800

DATE 2/24/23

Received From

Fogles Septic

PHONE #

40 795-5070

For

Fogles - Septic

- CASH
- CHECK

15225 bucks
Kulid.

NO.

78525

Three hundred thirty

Dollars

\$

330.00

Received By

J Kemp

HOME LAND

ENVIRONMENTAL

p:443-995-5385 | info@homelandhealthyhomes.com | www.homelandhealthyhomes.com

Date: February 7, 2023 Name of Evaluator: Tyler Young Time: 8:00 AM Property Address: 15225 Bucks Run Road Woodbine, MD 21797 Recent Weather Conditions: Cloudy	Ordered By: Stephanie McClellan Buyers: Leslie Stone Homeowner Interview: The homeowner interview was sent but not received prior to the evaluation.	Occupied: <input type="checkbox"/> Yes <input checked="" type="checkbox"/> No Length of Time Vacant: Unknown # of People Living in Home: N/A # of People moving in: 5 Property Age: 2002 System Age: 2002 Last Date of Cleaning: Unknown Recomm'd Pumping Freq: Annually
Liquid level in tank is: <input type="checkbox"/> Above Normal <input checked="" type="checkbox"/> Normal <input type="checkbox"/> Below Normal	Bottom Solids Depth: >24 Inches	
Depth of tank: 38 Inches	Type of Tank Access: Cleanout & Riser	Depth of tank access: At Grade
Maintenance appears: <input type="checkbox"/> Good <input type="checkbox"/> Fair <input checked="" type="checkbox"/> Poor	# of Bedrooms: 5	Depth to Distribution Box: 12 Inches
Effluent Filter present: <input type="checkbox"/> Yes <input checked="" type="checkbox"/> No	Previous high liquid level: <input type="checkbox"/> Yes <input checked="" type="checkbox"/> No	Distance to well: ~100 Feet
Records Search: Records were requested and received from Howard County prior to the evaluation.		
Were there any impermeable surfaces above the septic system (i.e. driveway)? <input type="checkbox"/> Yes <input checked="" type="checkbox"/> No		
Type of Tank	Tank Composition and Size	Type of Absorption System
<input checked="" type="checkbox"/> Septic Tank (1 tank) <input type="checkbox"/> Aeration System <input type="checkbox"/> Other:	<input type="checkbox"/> Metal <input checked="" type="checkbox"/> Concrete <input type="checkbox"/> Plastic Tank Size: 1,250 gallons	<input checked="" type="checkbox"/> Leaching Field <input type="checkbox"/> Raised Mound <input type="checkbox"/> Drywell (Number of:) <input type="checkbox"/> Cesspool <input type="checkbox"/> Unknown: _____
System Component	Condition	Comments
Septic Tank	<input type="checkbox"/> Acceptable <input checked="" type="checkbox"/> Unacceptable <input type="checkbox"/> Needs Further Evaluation	The septic tank is 1,250 gallons in capacity and composed of concrete. The tank is 38 inches below grade; a cleanout and manhole riser serve as access at grade. The front and back baffles are in place and composed of PVC. The solids level in the tank is 24 inches with a thick scum layer, indicating poor maintenance. It is recommended the tank be cleaned immediately, then every year thereafter. During the inspection a large belly (~15' long) was observed in the front line. Due to the poor maintenance and the large belly, the septic tank is labeled as, "Unacceptable". The tank will need to be pumped and the front line remediated by a licensed septic contractor.
Pump Present? <input checked="" type="checkbox"/> Yes <input type="checkbox"/> No	<input checked="" type="checkbox"/> Acceptable <input type="checkbox"/> Unacceptable	The pump chamber is 1,250 gallons in capacity and composed of concrete. The pump chamber is 48 inches below grade with a manhole riser access at grade. The pump float was tested manually and found to cycle properly. The high-water alarm float was triggered manually and found to sound properly.

\$ Replace inlet line 70 ft 4" deep
 Tank already scheduled to be pumped
 Missing cap on 4" pipe of D/Box.

HOME LAND ENVIRONMENTAL

p:443-995-5385 | f:443-267-0098 | info@homelandhealthyhomes.com | www.homelandhealthyhomes.com

Absorption System	<input type="checkbox"/> Acceptable <input checked="" type="checkbox"/> Unacceptable <input type="checkbox"/> Needs Further Evaluation	During the inspection, a distribution box and 4 drainfields were located. The distribution box is 12 inches below grade with a 4" PVC cleanout access at grade. The cleanout is damaged and missing a cap, allowing stormwater and debris into the system. This cleanout and cap will need to be replaced. Drainfields A, B, and C were probed and found to be holding heavy moisture with signs of biomat, indicating they have reached the end of their useful lives. Drainfield D was probed and found to be dry to a depth of at least 4 inches to the top of the stone. Approximately 450 gallons of water were introduced into the system with no sign of a backup. However, due to the condition of the drainfields, this system is labeled as, "Unacceptable". The absorption system will need to be remediated by a licensed septic contractor once permits are issued from the local health department.
--------------------------	--	---

THIS SPACE INTENTIONALLY LEFT BLANK.

p:443-995-5385 | f:443-267-0098 | info@homelandhealthyhomes.com | www.homelandhealthyhomes.com

HOME LAND ENVIRONMENTAL

p:443-995-5385 | info@homelandhealthyhomes.com | www.homelandhealthyhomes.com

Sketch of System

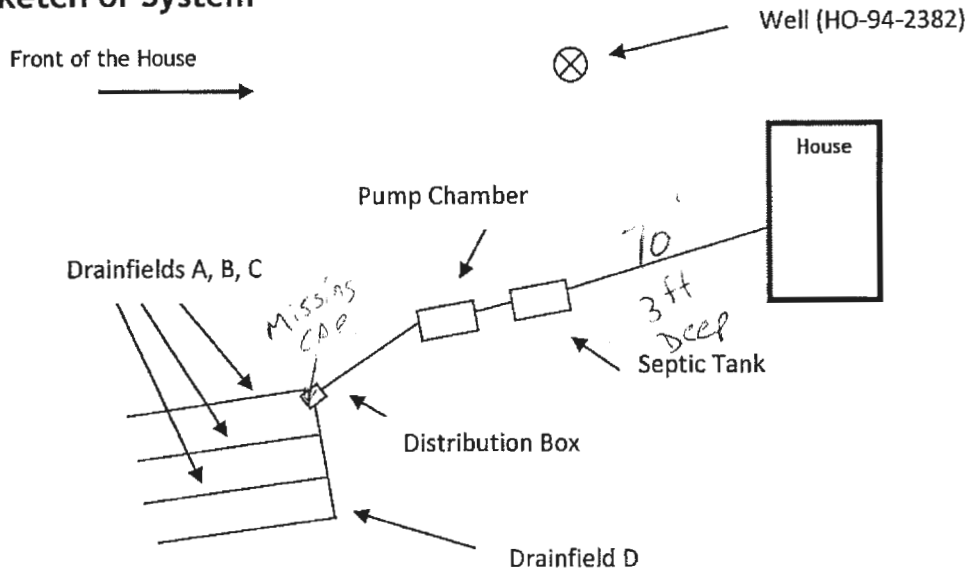

DISCLAIMERS

- This is a subjective and visual inspection only, the conclusions of which are based on the observed condition of the system components that could reasonably be accessed, and information known about the system at the time this report was completed. There may be unknown historical problems or unseen conditions which may compromise the conclusions stated in this report.
- Suggestions or recommendations for repairs or remediation may result in the need for further repair or remediation once the system components are fully excavated.
- A 'Satisfactory' evaluation does not mean the system will meet the local approving authority's criteria for determining compliance with state code: COMAR 26.04.02.02 D(4).
- The evaluation of the Sewage Disposal System as reported is based on the conditions observed on the day of the inspection.
- This report is neither a WARRANTY nor does it GUARANTEE continued acceptable functionality or performance of the Sewage Disposal Systems operations.
- If the house has been unoccupied the findings in this report may not be accurate, as limited or no use of the system may conceal or mask problems that may be revealed under typical sewage loading.
- If the general ground condition is excessively wet at the time of inspection, the findings in this report may not be accurate, as ground moisture may cover or hide septic effluent that may be on or near the ground surface.
- If the house is vacant or the conditions excessively wet during inspection, it is recommended that the system be reevaluated at a later date and/or alternate techniques be used to address those potential issues.
- Payment and/or use of this evaluation signify understanding and acceptances of the above clauses, as well as any noted faults with the system.

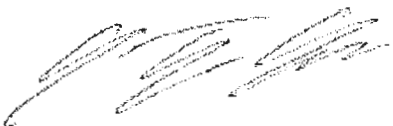
Representative's Signature:		Date: 2/7/2023
-----------------------------	--	----------------

LAYOUT 5/1/02 AM INSP 4 7/17/02 11:30
 INSP 2 5/15/02 PM INSP 5 7/18/02 11:00
 INSP 3 7/18/02 11:00 INSP 6 _____

ISSUE DATE: 4/25/02
 APPROVAL DATE: 7/19/02

P 516955
 A 58095-FF

**PERMIT
 INDEXED**

**ON-SITE SEWAGE DISPOSAL SYSTEM
 HOWARD COUNTY HEALTH DEPARTMENT
 BUREAU OF ENVIRONMENTAL HEALTH**

362500

Fogles Septic Clean, Inc IS PERMITTED TO INSTALL ALTER
 ADDRESS: 580 Obrecht Road, Sykesville PHONE NUMBER: 410-795-5670
 SUBDIVISION: Wellington West II LOT NUMBER: Parcel A
 ADDRESS: 15225 Bucks Run Drive PROPERTY OWNER: Pulte Homes, Inc.
 SEPTIC TANK CAPACITY (GALLONS): 1250 OUTLET BAFFLE FILTER REQUIRED
 PUMP CHAMBER CAPACITY (GALLONS): N/A COMPARTMENTED TANK REQUIRED
 NUMBER OF BEDROOMS: 4
 SQUARE FEET PER BEDROOM: 180
 LINEAR FEET OF TRENCH REQUIRED: 240 HOUSE SERVED BY PUBLIC WATER

TRENCHES:	Trench to be 3.0 feet wide. Inlet 2.0 feet below original grade. Bottom maximum depth 4.0 feet below original grade. Effective area begins at 3.0 feet below original grade. 2.0 feet of stone below distribution pipe.
LOCATION:	Start the first trench 210 feet from the rear (Union Chapel Rd. side) lot line and 80 feet from the left site line as seen from Bucks Run Drive, successive trenches parallel to and down slope of 1" trench.
NOTES:	Place the distribution box as shown on the approved site plan. System may need to be pumped.

PLANS APPROVED: Frank Skinner OK SRK 4/25/02 DATE: 2/25/2002

NOTES: PERMIT VOID AFTER 2 YEARS
 CONTRACTOR IS RESPONSIBLE FOR SCHEDULING A PRE-CONSTRUCTION INSPECTION FOR ALL INSTALLATIONS
 WATERTIGHT SEPTIC TANKS REQUIRED
 ALL PARTS OF SEPTIC SYSTEM SHALL BE 100 FEET FROM ANY WATER WELL UNLESS SPECIFICALLY AUTHORIZED
 MANHOLE RISERS REQUIRED ON ALL SEPTIC TANKS AND PUMP CHAMBERS UNLESS SPECIFICALLY AUTHORIZED
 CONTRACTOR RESPONSIBLE FOR COMPLIANCE WITH APPLICABLE REGULATIONS, GUIDELINES AND THE TERMS OF THIS PERMIT

NEITHER THE HOWARD COUNTY COUNCIL NOR THE HEALTH DEPARTMENT IS RESPONSIBLE FOR THE SUCCESSFUL OPERATION OF ANY SYSTEM
 PERMITTEE RESPONSIBLE FOR OBTAINING FINAL APPROVAL ON THIS PERMIT
 ALL 410-313-2640 FOR INSPECTION OF SEPTIC SYSTEM

**BUILDING PERMIT SIGNED
 AND RETURNED 3-19-02
 800134916-46 PROPANE TANK**

A58095-FF

NOT TO SCALE

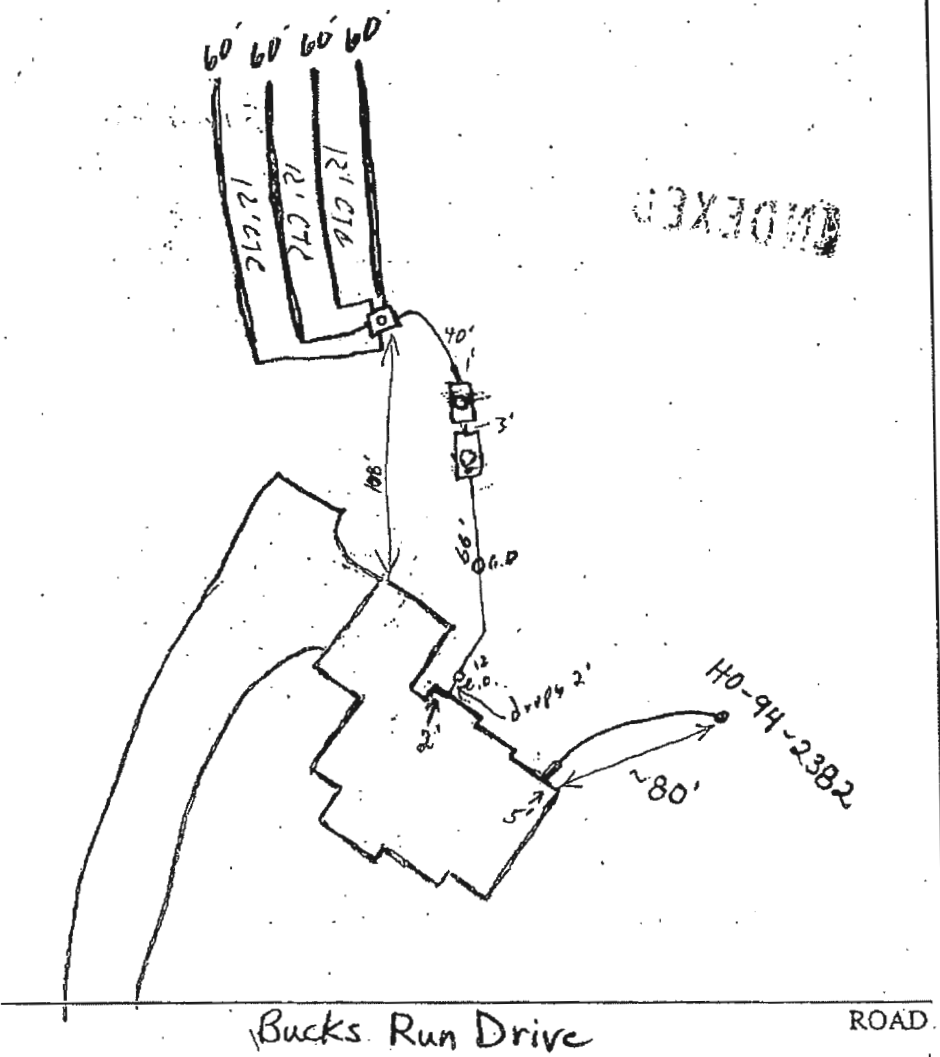

TRENCH/DRAINFIELD DATA		
WIDTH	INLET	BOTTOM
3	2'	4'
NUMBER OF TRENCHES		2'
TOTAL LENGTH		240'
ABSORPTION AREA		720 0
DISTRIBUTION BOX LEVEL		/
DISTRIBUTION BOX BAFFLE		/
DISTRIBUTION BOX PORT		—

SEPTIC TANK DATA	
SEPTIC TANK 1 LEVEL	✓
CAPACITY	1250 GAL
SEAM LOC	Top
TANK LID DEPTH	3'
BAFFLES	yes
BAFFLE FILTER	—
MANHOLE LOC	Center
6" PORT LOC	Front
WATERTIGHT TEST	—
SEPTIC TANK 2 LEVEL	✓
CAPACITY	1250 GAL
SEAM LOC	Top
TANK LID DEPTH	4'
BAFFLES	yes
BAFFLE FILTER	—
MANHOLE LOC	Center
6" PORT-LOC	—
WATERTIGHT TEST	—

PRE-CONSTRUCTION 5/1/02 To install as per plan. Top of tank to be at grade so that gravity can be made to distribution box. Builder to provide fill.

INSTALLATION 5/6/02 OK to cover trenches. Need to have 18" min cover over line from house conn to S.T. Want letter from builder guaranteeing 18" of cover or system must be lowered at house conn & pump tank added. (SO) 5/7/02 Called Maynard (cell # 410-977-3110) Disc. grading & cover. He wants to look at lot & get back to me. (SO) 5/8/02 Called Taylor about c.i.d. on 12' line. (SO) 5/15/02 S.T. lowered, P.T. set. OK to cover all work. Pump & alarm tests needed. (SO) 7/17/02 Alarm OK. Pump did not work. (SO) 7/18/02 Pump test OK. (SO)

FINAL INSPECTOR

DATE OF APPROVAL

BUILDING PERMIT SIGNED AND RETURNED

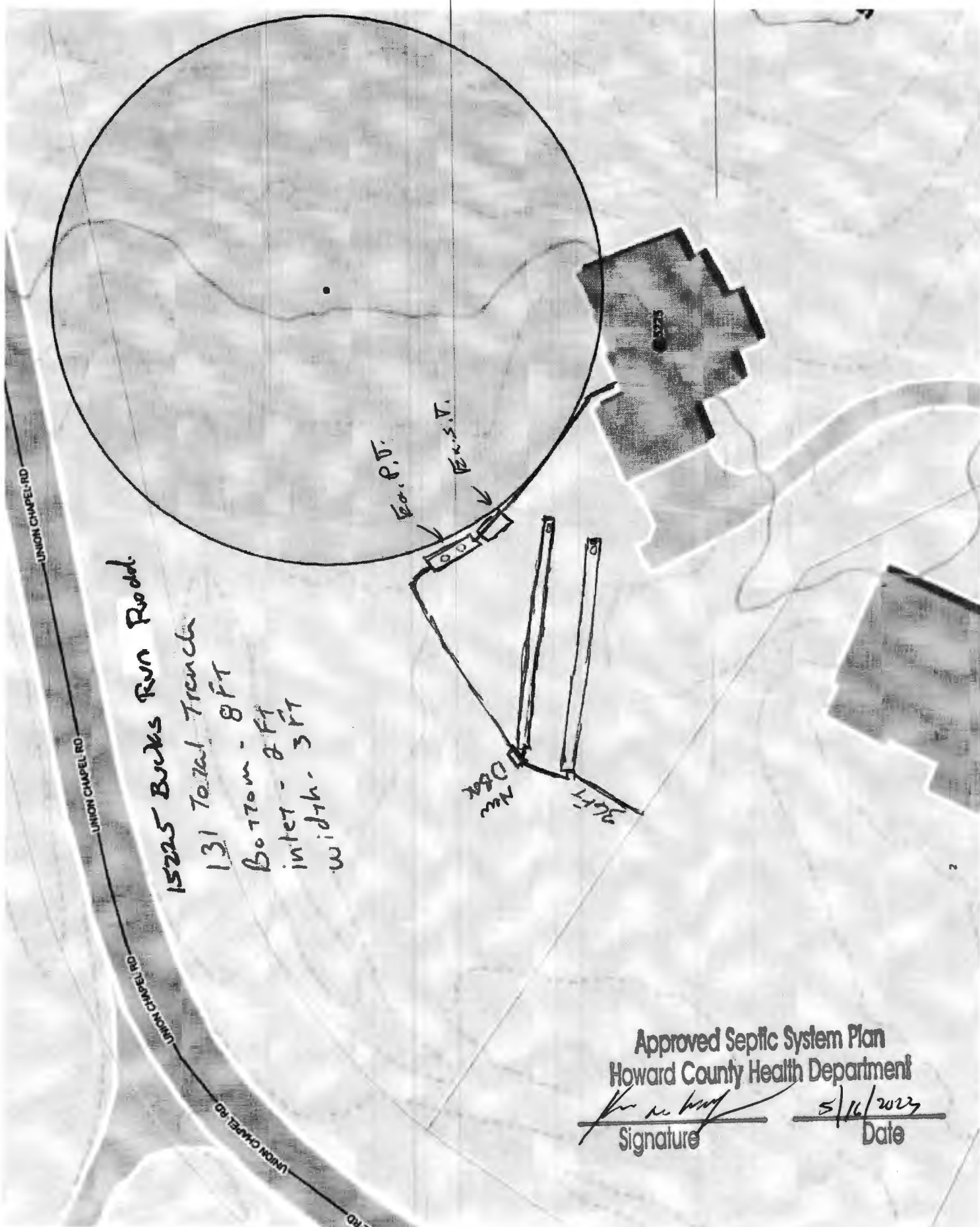

15225 Bucks Run Road
 131 Total Trench
 Bottom - 8 FT
 inter - 8 FT
 width - 3 FT

Approved Septic System Plan
 Howard County Health Department
[Signature] 5/16/2023
 Signature Date

LAYOUT 5/1/02 AM INSP 4 7/17/02 11:30
 INSP 2 5/15/02 PM INSP 5 7/18/02 11:00
 INSP 3 7/18/02 11:00 INSP 6 _____

ISSUE DATE: 4/25/02
 APPROVAL DATE: 7/18/02

P 516955
 A 58095-FF

**PERMIT
 INDEXED**

**ON-SITE SEWAGE DISPOSAL SYSTEM
 HOWARD COUNTY HEALTH DEPARTMENT
 BUREAU OF ENVIRONMENTAL HEALTH**

302500

Fogles Septic Clean, Inc IS PERMITTED TO INSTALL ALTER
 ADDRESS: 580 Obrecht Road, Sykesville PHONE NUMBER: 410-795-5670
 SUBDIVISION: Wellington West II LOT NUMBER: Parcel A
 ADDRESS: 15225 Bucks Run Drive PROPERTY OWNER: Pulte Homes, Inc.
 SEPTIC TANK CAPACITY (GALLONS): 1250 OUTLET BAFFLE FILTER REQUIRED
 PUMP CHAMBER CAPACITY (GALLONS): N/A COMPARTMENTED TANK REQUIRED
 NUMBER OF BEDROOMS: 4
 SQUARE FEET PER BEDROOM: 180
 LINEAR FEET OF TRENCH REQUIRED: 240 HOUSE SERVED BY PUBLIC WATER

TRENCHES:	Trench to be 3.0 feet wide. Inlet 2.0 feet below original grade. Bottom maximum depth 4.0 feet below original grade. Effective area begins at 3.0 feet below original grade. 2.0 feet of stone below distribution pipe.
LOCATION:	Start the first trench 210 feet from the rear (Union Chapel Rd. side) lot line and 80 feet from the left site line as seen from Bucks Run Drive, successive trenches parallel to and down slope of 1" trench.
NOTES:	Place the distribution box as shown on the approved site plan. System may need to be pumped.

PLANS APPROVED: Frank Skinner OK SRK 4/25/02 DATE: 2/25/2002

NOTES: PERMIT VOID AFTER 2 YEARS
 CONTRACTOR IS RESPONSIBLE FOR SCHEDULING A PRE-CONSTRUCTION INSPECTION FOR ALL INSTALLATIONS
 WATERTIGHT SEPTIC TANKS REQUIRED
 ALL PARTS OF SEPTIC SYSTEM SHALL BE 100 FEET FROM ANY WATER WELL UNLESS SPECIFICALLY AUTHORIZED
 MANHOLE RISERS REQUIRED ON ALL SEPTIC TANKS AND PUMP CHAMBERS UNLESS SPECIFICALLY AUTHORIZED
 CONTRACTOR RESPONSIBLE FOR COMPLIANCE WITH APPLICABLE REGULATIONS, GUIDELINES AND THE TERMS OF THIS PERMIT

**NEITHER THE HOWARD COUNTY COUNCIL NOR THE HEALTH DEPARTMENT IS
 RESPONSIBLE FOR THE SUCCESSFUL OPERATION OF ANY SYSTEM
 PERMITTEE RESPONSIBLE FOR OBTAINING FINAL APPROVAL ON THIS PERMIT
 ALL 410-313-2640 FOR INSPECTION OF SEPTIC SYSTEM**

**BUILDING PERMIT SIGNED
 AND RETURNED 3-19-02
 BOB 134916-46 PROPANE TANK**

A58095-FF

