

- (A)
- 12" Wk FPL, MSBK roots
- 1" Br CL
- Wk CoBK, Frable, CW
- 3" 1" Br / YSL
- Wk CoSBK
- Frable, mscous
- 5" Br / Rd / YFSL
- Wk Fpl, Frable, CW
- 15% sub + bark
- 16" mscous

(B)  
visual OK.  
similar to (A)  
no R. doc

DATE	TEST #	DEPTH	START	BREAK 1" DROP	STOP 2" DROP	TIME OF 2ND INCH	P/F/H
3/9/2023	(A)	4' 16" V	00:55	01:06	01:19	13	P
		5' 6"	00:40	00:43	00:50	7	P

REMARKS Homeowner used system send for 5 APR. (B) = obs. hole  
 SANITARIAN Kevin Wolf BACKHOE Chris = Fyke OTHERS owner  
 TEST HOLES USED IN SDA 2 AVG. PERC TIME 10.5 SQ. FT/BR \_\_\_\_\_  
 TRENCH WIDTH 3' INLET DEPTH 2' MAX. BOT DEPTH 9 EFFECTIVE SW 4'-8" (.42)  
 Wk 400 gr' SDA = 750 / 2.8 = 938 ÷ 3 = 312.5 (.42) = 131

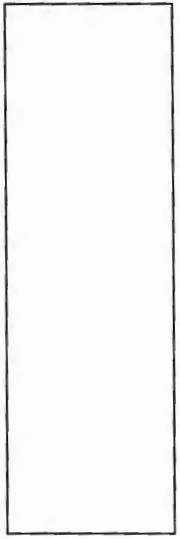

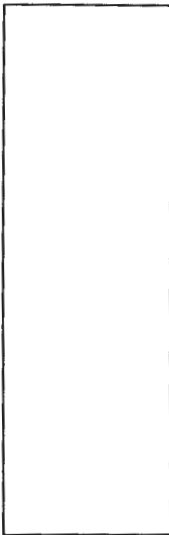
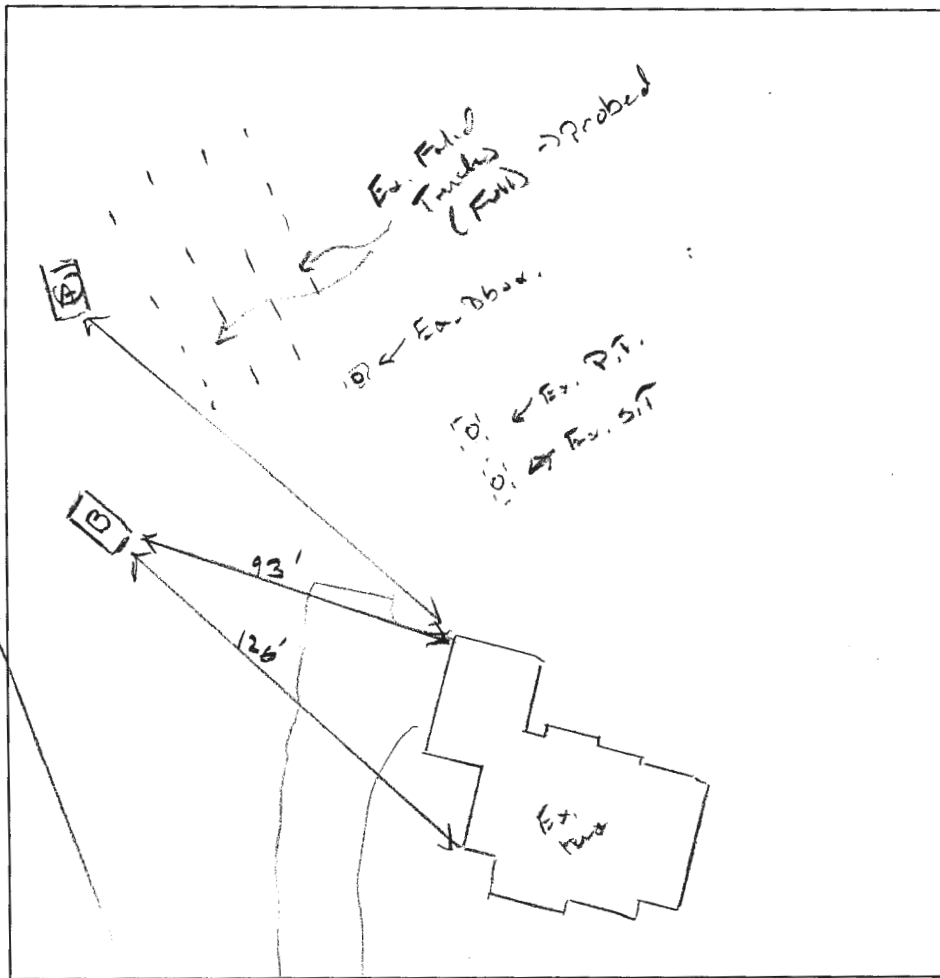
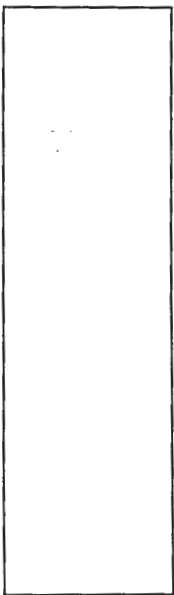

(B)  
 visual  
 ok.  
 similar  
 to  
 (A)  
 no 2. box

(A)  
 12" Drk Brk. / MSBK roots  
 1" Br CL  
 WK CoBK.  
 Friable, cw  
 3' 1" Br / YsL  
 WK CoSBK  
 Friable,  
 micaceous  
 5' Dr / Rd. / Y / FSL  
 WK Fpl.  
 Friable, cw  
 15% silt  
 clays  
 16' micaceous

DATE	TEST #	DEPTH	START	BREAK 1" DROP	STOP 2" DROP	TIME OF 2ND INCH	P/F/H
3/9/2023	(A)	4' / 16" V	00:55	01:06	01:19	13	P
		5' 6"	00:40	00:43	00:50	7	P



REMARKS Homeowner until system sized for 5 GPD. (B) = obs. hole.  
 SANITARIAN Kevin Wolf BACKHOE Chris = Fygi OTHERS owner

TEST HOLES USED IN SDA 2 AVG. PERC TIME 10.5 SQ. FT/BR \_\_\_\_\_

TRENCH WIDTH 3' INLET DEPTH 2' MAX. BOT DEPTH 8 EFFECTIVE SW 4-8 (.42)

1.8k = 600 gal  $SDA = 750 \div 2.4 = 938 \div 3 = 312.5 (.42) = 131$

**RECEIPT**

Howard County, MD  
HOWARD COUNTY HEALTH DEPARTMENT  
ASCEND ONE BUILDING  
Columbia, MD 21045  
8930 STANFORD BLVD

Application: WS-PT-23-00475  
Application Type: EnvHealth/Well and Septic/Percolation Test/Application  
Address: 15225 Bucks Run RD,

---

Receipt No.	5900					
Payment Method	Ref Number	Amount Paid	Payment Date	Cashier ID	Received	Comments
Cash	78525	\$165.00	02/27/2023	JUKING		Perc Repair
Work Description:	Perc Repair					

*receipt # 72802*