

Bureau of Environmental Health
 8930 Stanford Boulevard, Columbia, MD 21045
 Main: 410-313-2640 | Fax: 410-313-2648
 TDD 410-313-2323 | Toll Free 1-866-313-6300
www.hchealth.org
 Facebook: www.facebook.com/hocohealth

Maura J. Rossman, M.D., Health Officer

RECEIPT DATE: 12/29/2022 **ONSITE SEWAGE DISPOSAL SYSTEM** P 572684

APPROVAL DATE: 1/20/23 **PERMIT:** SP **REPAIR** A Repair

PROPERTY ADDRESS: 3274 Our Mile Court

SUBDIVISION: Gwenlee Est. LOT: 12 TAX ID: 04-334485

CONTRACTOR: Fogle's Septic Clean Inc. EMAIL: John@foglesinc.com

CONTRACTOR ADDRESS: 580 Obrecht Road Sykesville, MD 21784 PHONE: 410-795-5670

PROPERTY OWNER: Thomas Frketic EMAIL: tefrketic@gmail.com

OWNER ADDRESS: Same as above PHONE: 443-472-8071

SEPTIC TANK SIZE: Existing PUMP TANK CAPACITY: n/a PUMP SIZE: n/a

DISTRIBUTION SYSTEM: GRAVITY PRESSURE DOSED BEDROOMS: 4 APPLICATION RATE: 1.2

TRENCHES:	LINEAR FEET REQUIRED: <u>75</u>	INLET DEPTH: <u>5'</u>
	TRENCH WIDTH: <u>3'</u>	MAXIMUM BOTTOM DEPTH: <u>9.5'</u>
	MINIMUM SPACE BETWEEN TRENCHES: <u>n/a</u>	EFFECTIVE AREA BEGINNING DEPTH: <u>6.5'</u>
LOCATION:	TO BE STAKED BY SANITARIAN DURING PRE-CONSTRUCTION INSPECTION.	
NOTES:	Install system per approved plan. Current house is 3 bedroom. Homeowner wanted system sized for 4 bedroom.	

ISSUED BY: K. Wolf, LEHS ISSUE DATE: 12/29/2022 EXPIRATION DATE: 12/29/2023

- NOTE: CONTRACTOR MUST SCHEDULE A PRE-CONSTRUCTION INSPECTION PRIOR TO BEGINNING ANY INSTALLATION
- NOTE: CONTRACTOR MUST SCHEDULE AN INSPECTION AND GAIN APPROVAL OF ALL COMPONENTS PRIOR TO COVERING
- NOTE: STONE MUST BE APPROVED BY HEALTH DEPARTMENT AND GRAVEL TICKET MUST BE AVAILABLE FOR REVIEW.
- NOTE: WATERTIGHT SEPTIC TANKS REQUIRED
- NOTE: ALL PARTS OF SEPTIC SYSTEM SHALL BE AT LEAST 100 FEET DOWNGRADIENT FROM ANY WATER WELL
- NOTE: MANHOLE RISERS REQUIRED ON ALL SEPTIC TANKS AND PUMP CHAMBERS
- NOTE: AN ELECTRICAL PERMIT IS REQUIRED FOR INSTALLATION OF ANY ELECTRICAL COMPONENTS OF THE SYSTEM
 ELECTRICAL PERMIT ISSUED E n/a
- NOTE: THE HCHD DOES NOT WARRANT ANY SYSTEM AND CANNOT GUARANTEE THE PERFORMANCE OF THIS SYSTEM AS DESIGNED. BY ACCEPTING THIS PERMIT, THE OWNER AND/OR APPLICANT ACKNOWLEDGE THAT THE SPECIFICATIONS DETAILED IN THIS DESIGN ARE ONE POSSIBLE OPTION AND THAT THE HCHD WILL REVIEW OTHER PROPOSALS. YOU HAVE THE OPTION TO SEEK THE ADVICE OF A QUALIFIED DESIGN CONSULTANT OR PROFESSIONAL ENGINEER FOR FURTHER GUIDANCE.
- NOTE: AN INDIVIDUAL CERTIFIED BY MDE AND THE MANUFACTURER FOR BAT INSTALLATION MUST BE PRESENT AT ALL TIMES DURING BAT INSTALLATION.
- NOTE: MDE RECOMMENDS SEPTIC TANKS, BAT, AND OTHER PRETREATMENT UNITS BE PUMPED AT A FREQUENCY ADEQUATE TO ENSURE THAT SOLIDS ARE NOT DISCHARGED TO THE DISPOSAL AREA

**NEITHER THE HOWARD COUNTY COUNCIL NOR THE HEALTH DEPARTMENT IS RESPONSIBLE FOR THE SUCCESSFUL OPERATION OF ANY SYSTEM.
 PERMITTEE RESPONSIBLE FOR OBTAINING FINAL APPROVAL ON THIS PERMIT.
 CALL 410-313-1771 TO SCHEDULE INSPECTIONS.**

NOT TO SCALE

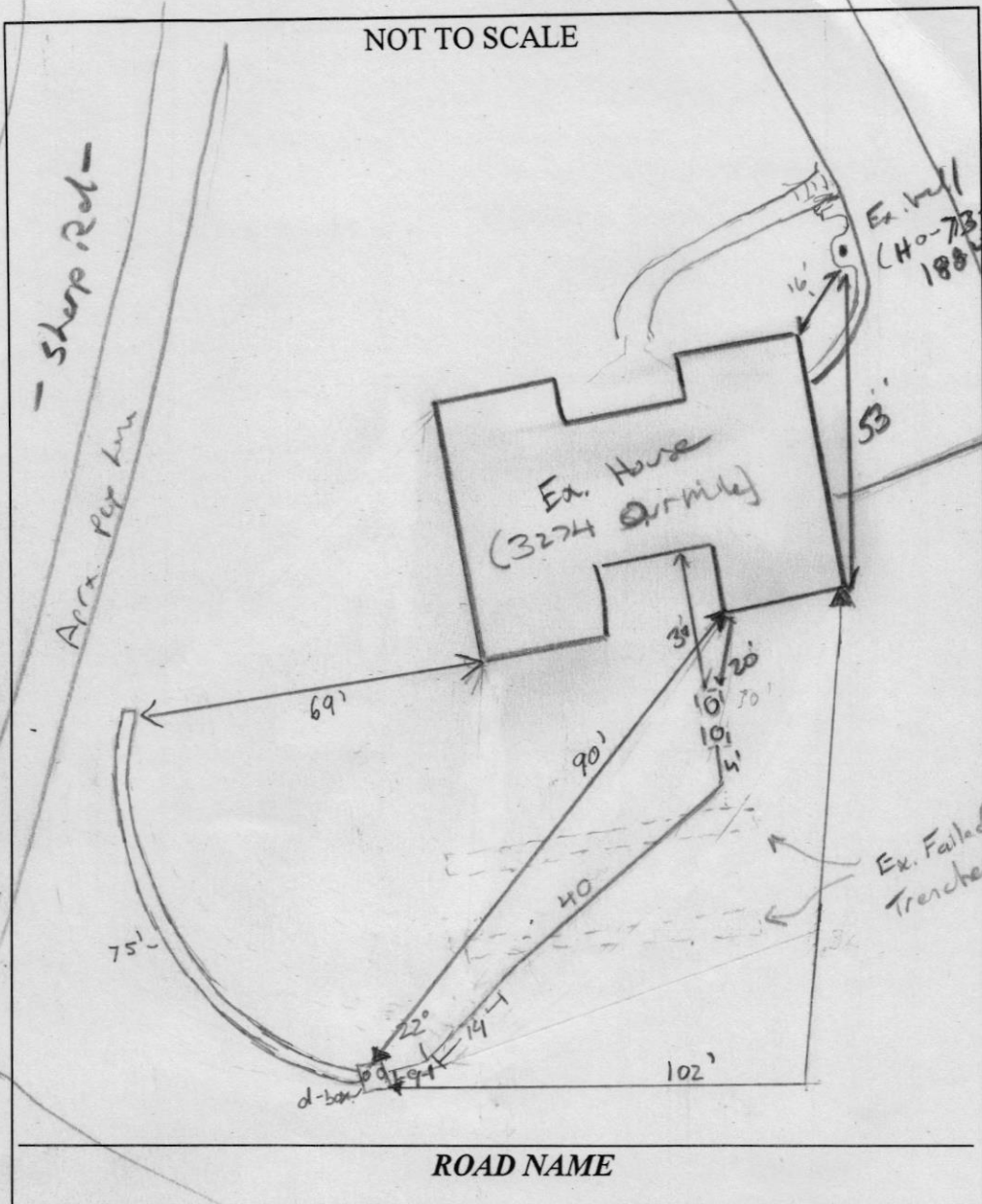

TRENCH/DRAINFIELD DATA

WIDTH	INLET	BOTTOM
3	4.5	9.5
NUMBER OF TRENCHES		1
TOTAL LENGTH		75
ABSORPTION AREA		225 sq ft
DISTRIBUTION BOX LEVEL		-
DISTRIBUTION BOX BAFFLE		yes
DISTRIBUTION BOX PORT		yes

Ex. SEPTIC TANK DATA

SEPTIC TANK 1 LEVEL	Yes
MANUFACTURER	N/A
CAPACITY	1000 GAL
SEAM LOC	mid
TANK LID DEPTH	6'
BAFFLES	Yes
BAFFLE FILTER	N/A
MANHOLE LOC	Front/Rear
6" PORT LOC	rim
WATERTIGHT TEST	OK
SLOTTED	no
DATE ON LID	N/A
PUMP/SEPTIC TANK LEVEL	N/A
MANUFACTURER	
CAPACITY	GAL
SEAM LOC	
TANK LID DEPTH	
BAFFLES	
BAFFLE FILTER	
MANHOLE LOC	
6" PORT LOC	
WATERTIGHT TEST	
SLOTTED	
DATE ON LID	

PRE-CONSTRUCTION:

12/28/2022 Met contractor on site to confirm trench layout w/ Designer (K) (K)

12/29/2022 Design plan received and approved (K)

1/18/2023 Met onsite. old trench excavated in same location as new trench. Adjusted trench downhill approx. 10'. Re-shot elevation, revised plan w/ new

INSTALLATION: set back distance (K)

1/18/2023 New outlet baffle installed w/ resin. 4" sub 40. back line run up to new trench location OK to continue (K)

1/20/2023 - Width & Inlet per plan. Saw Baffle in D-box. Measured length for round D-box to end of trench. Stone OK in trench. Fabric good. length of trench per plan. Measured D box to house & C/O to house. (S)

FINAL INSPECTOR Shepsura Page . DATE OF APPROVAL 1/20/2023

Emailed Re-vised
Drawing to Kevin
Wolfe @ HCHD on
12-29-22

3274 Our Mile Ct
Glenwood, Md 21738

Trench Detail

- 3 ft wide
- 9.5' Deep
- 75' - one Trench
- 4" Stone
- 5' - Inlet

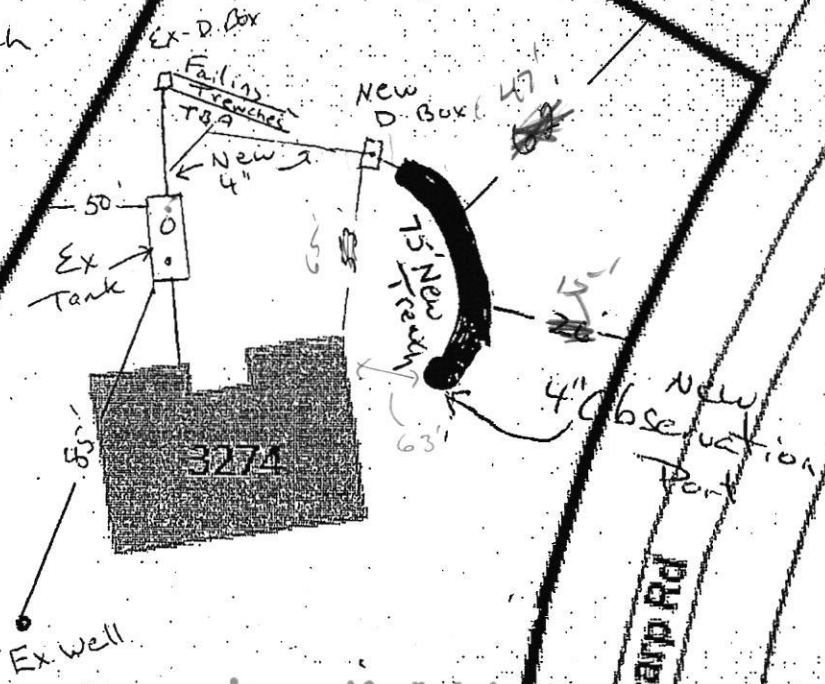
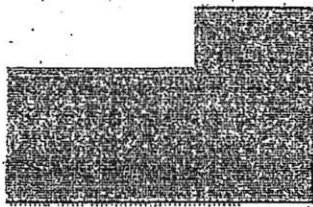

Approved Septic System Plan
Howard County Health Department

Signature

Date

Sharp Rd

Our Mile Ct

Note: No Neighboring
Wells within 100'

Howard County Health Department

Bureau of Environmental Health, Columbia, MD 21045 - 410-313-1771

SEWAGE DISPOSAL PERMIT NO. A- Repair P- 572684

RESIDENTIAL PERMIT
(NUMBER OF BEDROOMS: 4)

COMMERCIAL PERMIT
(DESIGN FLOW: _____ GPD)

PERMITEE: Fogle's Septic

LOCATION: 3274 Our Mile Court

****POST THIS CARD WHERE IT CAN BE SEEN FROM ROAD****

STOP ALL CONSTRUCTION ON SEWAGE DISPOSAL SYSTEM AND CONTACT HEALTH DEPARTMENT BEFORE CONTINUING

Inspector

Date

WORK IS SATISFACTORY, OK TO CONTINUE

Inspector

Date

COMMENTS: _____

FINAL INSPECTION MADE, OK TO COVER ALL WORK

Inspector

Date