

Bureau of Environmental Health
 8930 Stanford Boulevard, Columbia, MD 21045
 Main: 410-313-2640 | Fax: 410-313-2648
 TDD 410-313-2323 | Toll Free 1-866-313-6300
www.hchealth.org
 Facebook: www.facebook.com/hocohealth

Maura J. Rossman, M.D., Health Officer

RECEIPT DATE: 1/23/2023 **ONSITE SEWAGE DISPOSAL SYSTEM** P 572754

PERMIT: **REPAIR - Tank**
Repl. Only

APPROVAL DATE: _____ A Repair

PROPERTY ADDRESS: 11951 Scaggsville Road

SUBDIVISION: n/a LOT: n/a TAX ID: 05-348935

CONTRACTOR: Fogle's Septic Clean Inc. EMAIL: John@foglesinc.com

CONTRACTOR ADDRESS: 580 Obrecht Road Sykesville, MD 21784 PHONE: 410-795-5670

PROPERTY OWNER: Daniel Weiss EMAIL: _____

OWNER ADDRESS: Same as above PHONE: _____

SEPTIC TANK SIZE: 1500g PUMP TANK CAPACITY: n/a PUMP SIZE: n/a

DISTRIBUTION SYSTEM: GRAVITY PRESSURE DOSED BEDROOMS: 3 APPLICATION RATE: n/a

TRENCHES:	LINEAR FEET REQUIRED: <u>n/a</u>	INLET DEPTH: _____
	TRENCH WIDTH: _____	MAXIMUM BOTTOM DEPTH: _____
	MINIMUM SPACE BETWEEN TRENCHES: _____	EFFECTIVE AREA BEGINNING DEPTH: _____
LOCATION:	TO BE CONFIRMED IN FIELD AT TIME OF PRECONSTRUCTION MEETING	
NOTES:	Install new 1500g septic tank per approved plan submitted by Fogle's. Pre-construction meeting may be required to confirm layout of everything. Existing trench(s) to be verified at time of tank install.	

ISSUED BY: K. Wolf, LEHS ISSUE DATE: 1/23/2023 EXPIRATION DATE: 1/23/2024

- NOTE: CONTRACTOR MUST SCHEDULE A PRE-CONSTRUCTION INSPECTION PRIOR TO BEGINNING ANY INSTALLATION
- NOTE: CONTRACTOR MUST SCHEDULE AN INSPECTION AND GAIN APPROVAL OF ALL COMPONENTS PRIOR TO COVERING
- NOTE: STONE MUST BE APPROVED BY HEALTH DEPARTMENT AND GRAVEL TICKET MUST BE AVAILABLE FOR REVIEW.
- NOTE: WATERTIGHT SEPTIC TANKS REQUIRED
- NOTE: ALL PARTS OF SEPTIC SYSTEM SHALL BE AT LEAST 100 FEET DOWNGRADIENT FROM ANY WATER WELL
- NOTE: MANHOLE RISERS REQUIRED ON ALL SEPTIC TANKS AND PUMP CHAMBERS
- NOTE: AN ELECTRICAL PERMIT IS REQUIRED FOR INSTALLATION OF ANY ELECTRICAL COMPONENTS OF THE SYSTEM
 ELECTRICAL PERMIT ISSUED E n/a
- NOTE: THE HCHD DOES NOT WARRANTY ANY SYSTEM AND CANNOT GUARANTEE THE PERFORMANCE OF THIS SYSTEM AS DESIGNED. BY ACCEPTING THIS PERMIT, THE OWNER AND/OR APPLICANT ACKNOWLEDGE THAT THE SPECIFICATIONS DETAILED IN THIS DESIGN ARE ONE POSSIBLE OPTION AND THAT THE HCHD WILL REVIEW OTHER PROPOSALS. YOU HAVE THE OPTION TO SEEK THE ADVICE OF A QUALIFIED DESIGN CONSULTANT OR PROFESSIONAL ENGINEER FOR FURTHER GUIDANCE.
- NOTE: AN INDIVIDUAL CERTIFIED BY MDE AND THE MANUFACTURER FOR BAT INSTALLATION MUST BE PRESENT AT ALL TIMES DURING BAT INSTALLATION.
- NOTE: MDE RECOMMENDS SEPTIC TANKS, BAT, AND OTHER PRETREATMENT UNITS BE PUMPED AT A FREQUENCY ADEQUATE TO ENSURE THAT SOLIDS ARE NOT DISCHARGED TO THE DISPOSAL AREA

NEITHER THE HOWARD COUNTY COUNCIL NOR THE HEALTH DEPARTMENT IS RESPONSIBLE FOR THE SUCCESSFUL OPERATION OF ANY SYSTEM.
PERMITTEE RESPONSIBLE FOR OBTAINING FINAL APPROVAL ON THIS PERMIT.
CALL 410-313-1771 TO SCHEDULE INSPECTIONS.

NOT TO SCALE

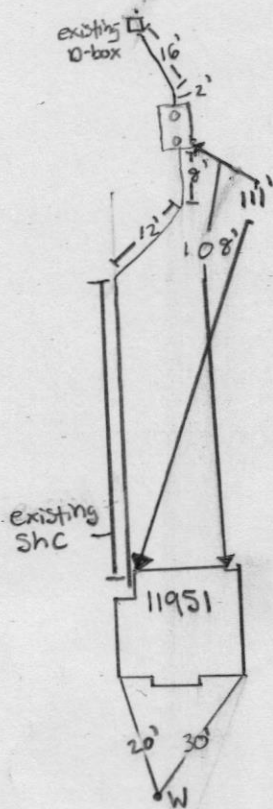

Scaggsville Rd
ROAD NAME

TRENCH/DRAINFIELD DATA

WIDTH	INLET	BOTTOM
_____	_____	_____
NUMBER OF TRENCHES _____		
TOTAL LENGTH _____		
ABSORPTION AREA _____		
DISTRIBUTION BOX LEVEL _____		
DISTRIBUTION BOX BAFFLE _____		
DISTRIBUTION BOX PORT _____		

SEPTIC TANK DATA

SEPTIC TANK 1 LEVEL YES

MANUFACTURER Babylon

CAPACITY 1500 GAL

SEAM LOC top

TANK LID DEPTH 2.5"-3"

BAFFLES 6" front + 4" back

BAFFLE FILTER _____

MANHOLE LOC front + back

6" PORT LOC _____

WATERTIGHT TEST _____

SLOTTED YES

DATE ON LID 1/14/23

PUMP/SEPTIC TANK LEVEL _____

MANUFACTURER _____

CAPACITY _____ GAL

SEAM LOC _____

TANK LID DEPTH _____

BAFFLES _____

BAFFLE FILTER _____

MANHOLE LOC _____

6" PORT LOC _____

WATERTIGHT TEST _____

SLOTTED _____

DATE ON LID _____

PRE-CONSTRUCTION:

2/3/2023 Design plan approved. May need pre-con meeting. Told contractor. (KAW)

INSTALLATION:

2/21/2023 - Tr. installed distance from well. Well did not have tag (SP)
2/22/2023 - Contractor onsite for inspection. Showed observation port for existing trenches. Tank has correct baffles, slots, lid depth @ 2.5-3. Gave OK to backfill. (SP)

FINAL INSPECTOR

Shepura Page

DATE OF APPROVAL

2/22/2023

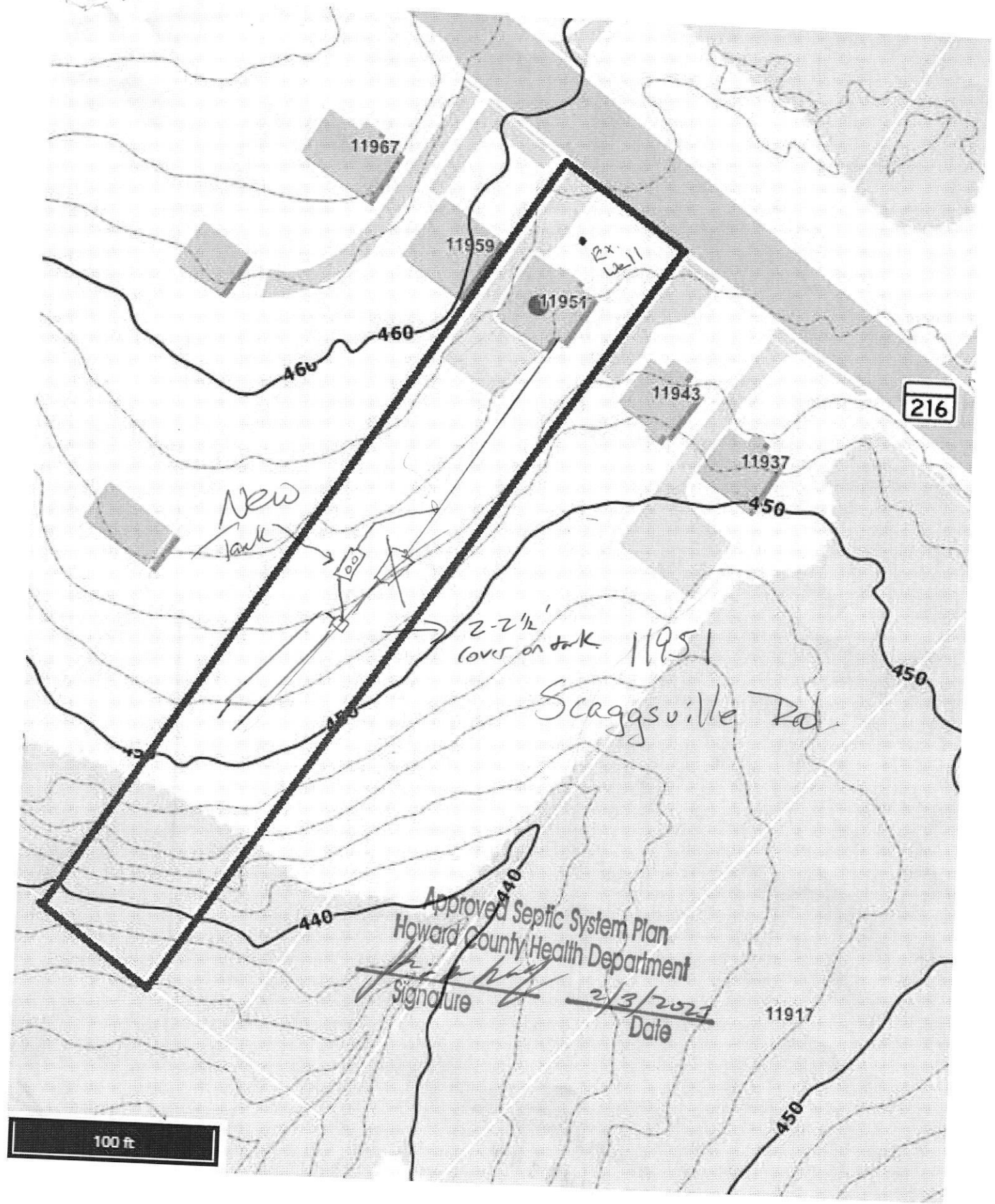

Approved Septic System Plan
Howard County Health Department

[Handwritten Signature]
Signature

2/3/2021
Date

100 ft

9/8/77
1:30 p.m.
A.M.
9/9/77

Approved
9/14/77
TSD.

PERMIT

P 26827
A _____

SEWAGE DISPOSAL SYSTEM

MARYLAND STATE DEPARTMENT OF HEALTH

HOWARD COUNTY

05-348935

ELLICOTT CITY

DISTRICT 2nd

DATE 9/1/77

John T. Quill, Plumber IS PERMITTED TO INSTALL ALTER X

ADDRESS 503 - 5th Street, Laurel, Md. PHONE _____

A SEWAGE DISPOSAL SYSTEM LOCATED AT _____

SUBDIVISION _____ ROAD 11951 Scaggsville Road LOT _____

PROPERTY OWNER Mr. Curtis Bost

ADDRESS 11951 Scaggsville Road, Scaggsville, Md.

SPECIFICATIONS 2 bedrooms

DRAIN FIELD _____ DEPTH _____ FEET, BOTTOM AREA _____ SQ. FT.

SEEPAGE PITS _____ ABSORBENT SIDE-WALL AREA _____ SQ. FT.

SEPTIC TANK CAPACITY 1000 GALLONS

FOR GARBAGE GRINDER, INCREASE DISPOSAL AREA 22% & TANK CAPACITY 50%.

OTHER REPAIR-CALL FOR INSPECTION WHEN GROUND IS OPENED SO SANITARIAN CAN

RECOMMEND REPAIR. 20' layout 4' 10' deep

PLANS APPROVED BY Palmer F. Wine DATE 9/1/77

FILL SEPTIC TANK AND DISTRIBUTION BOX WITH WATER BEFORE CALLING FOR AN INSPECTION. COVER NO WORK UNTIL INSPECTED AND APPROVED.

NEITHER THE HOWARD COUNTY COMMISSIONERS NOR THE HEALTH DEPARTMENT IS RESPONSIBLE FOR THE SUCCESSFUL OPERATION OF ANY SYSTEM.

P 26827

Test
9000
soil
3-4
- 10'

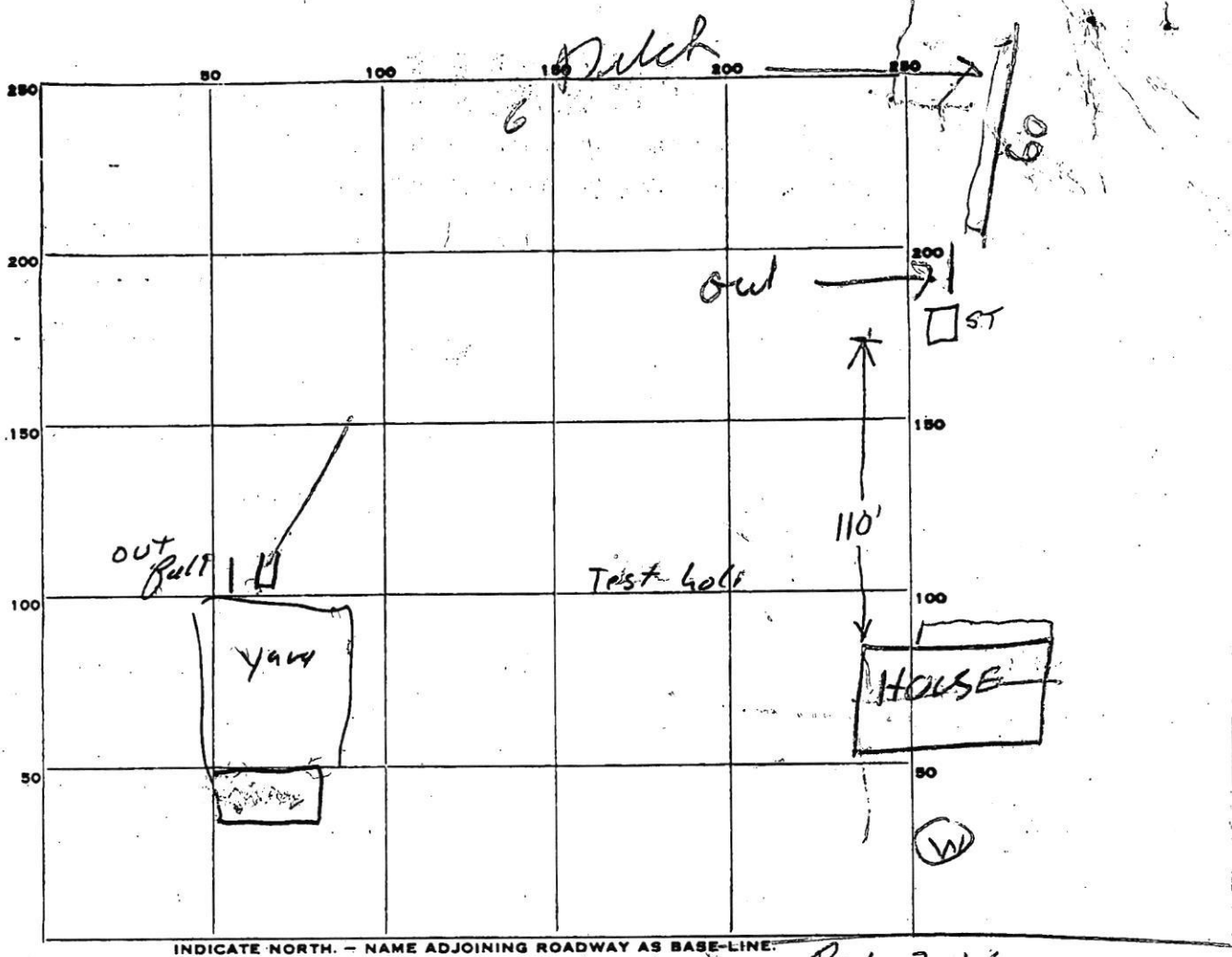

Rt 216

PERMIT CARD

SEPTIC TANK, LEVEL

CLEANOUTS

DISTRIBUTION BOX, LEVEL

TILE FIELD, DEPTH 10 FT. TRENCH WIDTH 2 FT.

GRAVEL DEPTH 7 FT IN. TOTAL LENGTH 60 FT.

NUMBER OF TRENCHES 1 TOTAL BOTTOM AREA 420 ONESIDE

SEEPAGE PITS, INSIDE DIAMETER _____ FT. DEPTH BELOW INLET _____ FT.

ABSORBENT AREA _____ SQ. FT.

REMARKS

9/9/77 Dave O'Neill was here yesterday
I said to put stone in ditch R.H. 9/9/77
OK To Cover Ditch. No one knows where tank
is located. Find Tank Put Cleanout on tank, Pump
tank out if needed & Repair Tees if needed R.H

9/14/77: Septic Tank located, new concrete cover w/ c.i. cleanout New 10' section into house line

DATE SYSTEM APPROVED

9/14/77

INSPECTOR

T.S. Ogle