

10/30/64
9:30

APPLICATION

A 08951

SEWAGE DISPOSAL TESTING

P _____

MARYLAND STATE DEPARTMENT OF HEALTH

HOWARD COUNTY

10/30/64 Wash. J. State. L. H. H.

ELLICOTT CITY

DISTRICT 4

DATE 8/28/64

TO: THE COUNTY HEALTH OFFICER
ELLICOTT CITY, MARYLAND

I, HEREBY, APPLY FOR THE NECESSARY TESTS IN ORDER TO CONSTRUCT (OR RECONSTRUCT) A SEWAGE DISPOSAL SYSTEM.

PROPERTY OWNER John L. Egerton

ADDRESS Rivardale, Maryland PHONE _____

PROPERTY LOCATION:

SUBDIVISION _____ LOT NO. _____

ROAD AND DESCRIPTION Hipsley ^{Mill} Road and Annapolis Rock Road. - at intersection

OCCUPANT _____ PHONE _____

PERSON TO CONSTRUCT SYSTEM _____

ADDRESS _____ PHONE _____

SIZE OF LOT 5.663 acres TYPE BLDG. 4
NUMBER OF BEDROOMS _____

IF NOT SINGLE RESIDENCE DESCRIBE _____

SIGNATURE OF APPLICANT *John L. Egerton*

APPROVED BY _____ FOR _____ (KIND OF SYSTEM) DATE _____

REJECTED BY _____ FOR _____ (KIND OF SYSTEM) DATE _____

HOLD PENDING FURTHER TESTS *Rejection* DATE 10/30/64

REASONS FOR REJECTION OR HOLDING *Low yield - roof and clay on high party*
lot unsuitable for construction

THIS IS NOT A PERMIT

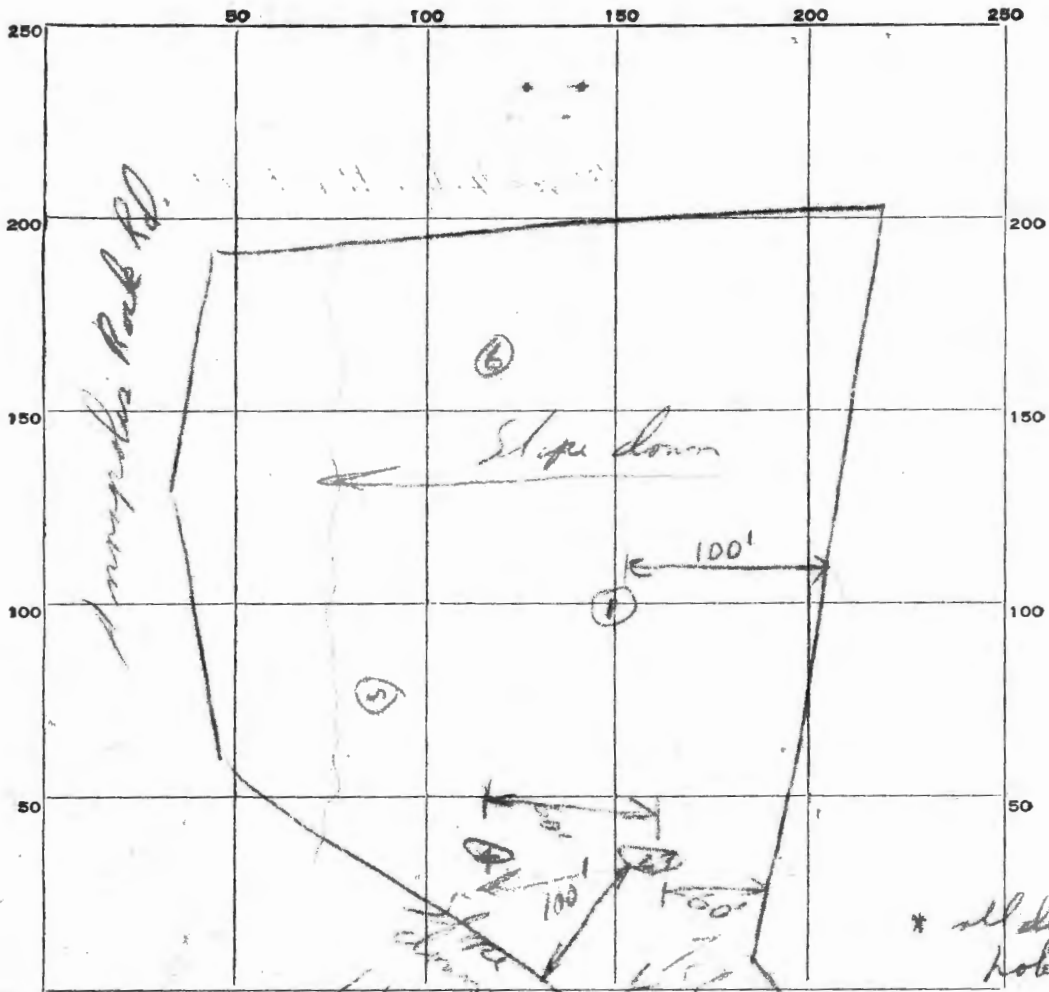

DATE	TEST NO.	DEPTH	PREWET		TEST 1" DROP		TIME
			START	STOP	START	STOP	
10/30/14	1	5 ft.	rock at 4 to 5 ft. - much could not dig below 5 ft.				
	2	8 1/2 ft.	1046	1048	1048	1055	7 min.
	3	4 ft.	1101				Over time on 1st wet. stop Pre.
	4	6 ft.	rock all way down				much. can dig below 6 ft.
	5	2 ft.	on low part of lot about 75 ft from station - grey clay water at 2 ft.				
	6	4 ft.	can't get below 4 ft all rock				

SOIL AUGER FINDING: Holes # 2 & 3 - Red Clay and rock all way down - extremely hard to dig

TESTED BY: R.D.F. 10/30/14

REMARKS: Poor soil, pressure. - Needs further tests - K.F.

ALSO PRESENT: _____ LOT NO. _____

APPLICATION

A 08951

SEWAGE DISPOSAL TESTING

P _____

MARYLAND STATE DEPARTMENT OF HEALTH

HOWARD COUNTY

14145 1/2 1/2 1/2 1/2 1/2

ELLICOTT CITY

DISTRICT 4

DATE 8/28/64

TO: THE COUNTY HEALTH OFFICER
ELLICOTT CITY, MARYLAND

I, HEREBY, APPLY FOR THE NECESSARY TESTS IN ORDER TO CONSTRUCT (OR RECONSTRUCT) A SEWAGE DISPOSAL SYSTEM.

PROPERTY OWNER John L. Egerton

ADDRESS Riverdale, Maryland PHONE _____

PROPERTY LOCATION:

SUBDIVISION _____ LOT NO. _____

ROAD AND DESCRIPTION *pill* Wipsley Road and Annapolis Rock Road. - at intersection

OCCUPANT _____ PHONE _____

PERSON TO CONSTRUCT SYSTEM _____

ADDRESS _____ PHONE _____

SIZE OF LOT 5.663 acres TYPE BLDG. 4
NUMBER OF BEDROOMS

IF NOT SINGLE RESIDENCE DESCRIBE _____

SIGNATURE OF APPLICANT *William J. Haines*

APPROVED BY _____ FOR _____ DATE _____
(KIND OF SYSTEM)

REJECTED BY _____ FOR _____ DATE _____
(KIND OF SYSTEM)

HOLD PENDING FURTHER TESTS *R. H. White* DATE *10/30/64*

REASONS FOR REJECTION OR HOLDING *Soil - rock and clay on high part of lot - water at 2 ft on lower part - etc.*

THIS IS NOT A PERMIT

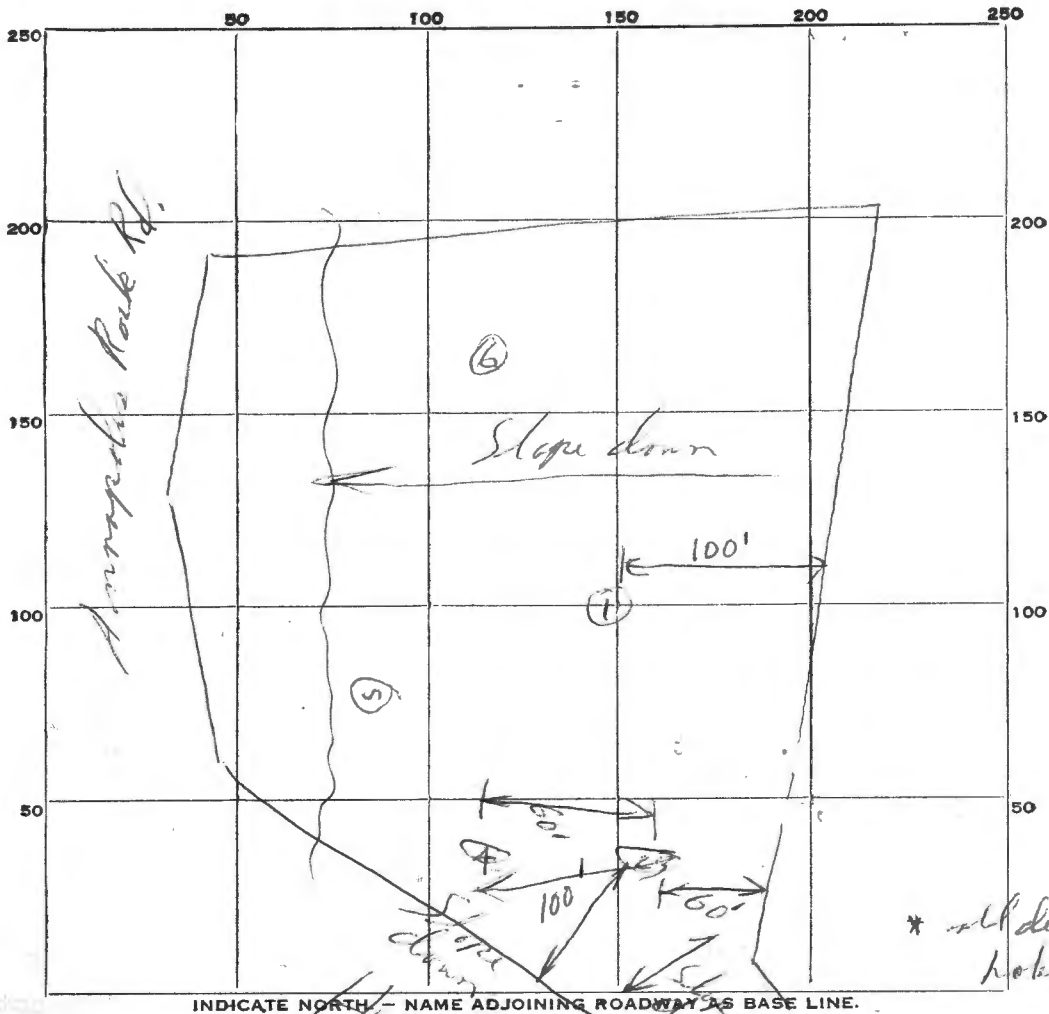

DATE	TEST NO.	DEPTH	PER WET		TEST - 1" DROP		TIME	
			START	STOP	START	STOP		
10/30/64	1	5 ft.	rock at 4 to 5 ft - mach. could not get below 5 ft.					
	2	8 1/2 ft.	1046	1048	1048	1055	7 min.	
	3	4 ft.	1101	Overturn on 1st rock - Slope Penc. - mach. can't dig below - 6 ft.				
	4	6 ft.	rock all way down					
	5	2 ft.	on lower part of lot about 75 ft from street - grey clay water at 2 ft.					
	6	4 ft.	can't get below 4 ft all rock					

SOIL AUGER FINDING Holes # 2 & 3 Red Clay and rock all way down - extremely hard to dig

TESTED BY R.D.F. 10/30/64

REMARKS Poor soil, no pore. - Needs further tests - R.D.F.

ALSO PRESENT _____ LOT NO. _____

