

# APPLICATION

A 03877

SEWAGE DISPOSAL TESTING

P \_\_\_\_\_

MARYLAND STATE DEPARTMENT OF HEALTH

HOWARD COUNTY

ELLICOTT CITY

DISTRICT \_\_\_\_\_

DATE 6/13/61

*Repair Job  
No charge*

TO: THE COUNTY HEALTH OFFICER  
ELLICOTT CITY, MARYLAND

I, HEREBY, APPLY FOR THE NECESSARY TESTS IN ORDER TO CONSTRUCT (OR RECONSTRUCT) A SEWAGE DISPOSAL SYSTEM.

PROPERTY OWNER Robert C. Rice

ADDRESS Route 99<sup>th</sup> Ellicott City, Md. PHONE \_\_\_\_\_

PROPERTY LOCATION:

SUBDIVISION \_\_\_\_\_ LOT NO. \_\_\_\_\_

ROAD AND DESCRIPTION Rt. 99<sup>th</sup> - 3rd. house west of Bethany Lane.

OCCUPANT \_\_\_\_\_ PHONE \_\_\_\_\_

PERSON TO CONSTRUCT SYSTEM \_\_\_\_\_

ADDRESS \_\_\_\_\_ PHONE \_\_\_\_\_

SIZE OF LOT 1/4 Acre TYPE BLDG. 4 NUMBER OF BEDROOMS \_\_\_\_\_

IF NOT SINGLE RESIDENCE DESCRIBE \_\_\_\_\_

SIGNATURE OF APPLICANT Donald Hoover

APPROVED BY \_\_\_\_\_ FOR \_\_\_\_\_ DATE \_\_\_\_\_

REJECTED BY John F. White FOR Under study - no charge DATE 6/13/61

HOLD PENDING FURTHER TESTS \_\_\_\_\_ DATE \_\_\_\_\_

REASONS FOR REJECTION OR HOLDING Water table at 6'

Suggest that repair job be done by installing  
100 gal. tank - 4' dia. in the field - set on 2 1/2 feet deep

# THIS IS NOT A PERMIT

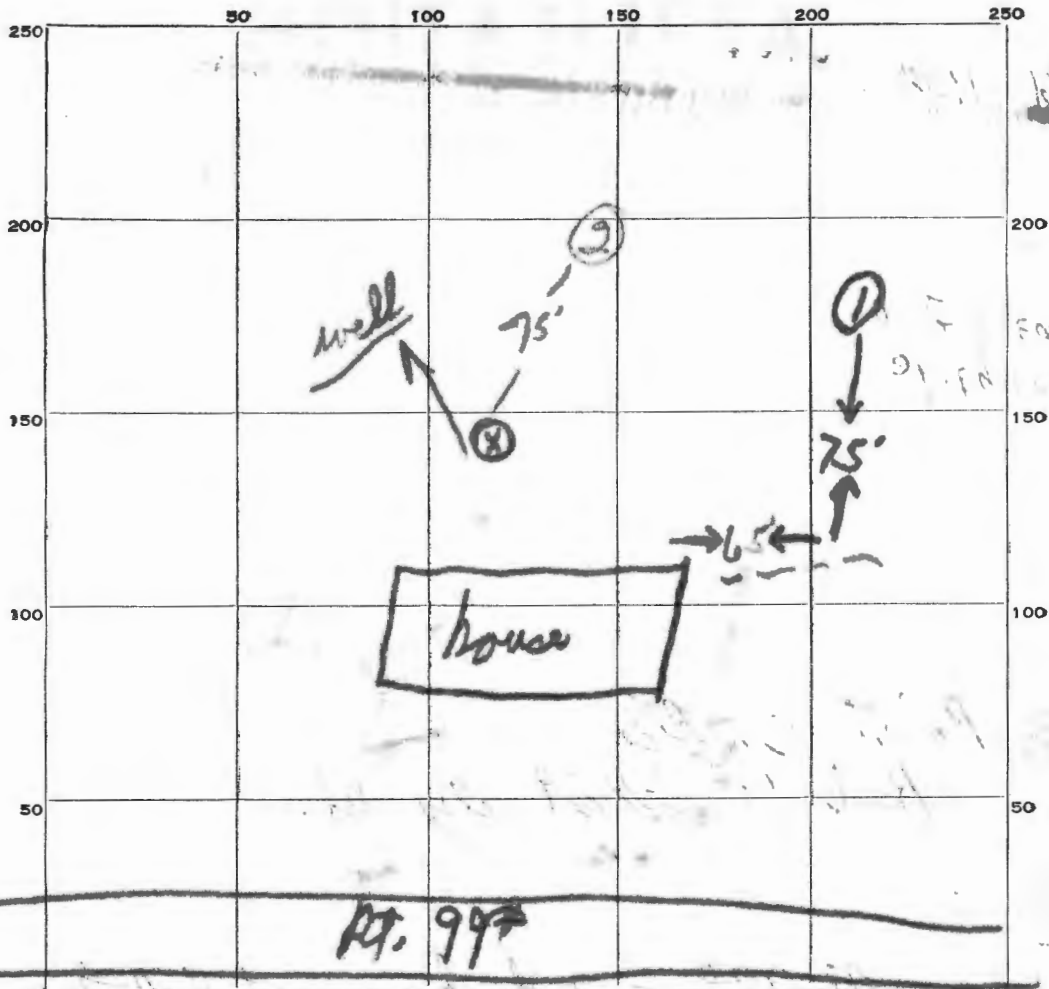

DATE	TEST NO.	DEPTH	PRE-WET		TEST - 1" DROP		TIME	
			START	STOP	START	STOP		
6/12/61	1#	5'	1:26	1:30	1:30	1:35	5-	
	2#	7'	water in test hole					

SOIL AUGER FINDING

TESTED BY

REMARKS

ALSO PRESENT

LOT NO.

Water came in test hole at 6'

# APPLICATION

A 03877

SEWAGE DISPOSAL TESTING

P \_\_\_\_\_

MARYLAND STATE DEPARTMENT OF HEALTH

HOWARD COUNTY

ELLICOTT CITY

DISTRICT \_\_\_\_\_

DATE 6/12/61

*Repair Job  
No charge*

TO: THE COUNTY HEALTH OFFICER  
ELLICOTT CITY, MARYLAND

I, HEREBY, APPLY FOR THE NECESSARY TESTS IN ORDER TO CONSTRUCT (OR RECONSTRUCT) A SEWAGE DISPOSAL SYSTEM.

PROPERTY OWNER Robert C. Rice

ADDRESS Route 99<sup>th</sup> Ellicott City, Md. PHONE \_\_\_\_\_

PROPERTY LOCATION:

SUBDIVISION \_\_\_\_\_ LOT NO. \_\_\_\_\_

ROAD AND DESCRIPTION Rt. 99<sup>th</sup> - 3rd. house west of Bethany Lane.

OCCUPANT 2 TEL DEPT DEPT DEPT 12 PHONE 1-1111

PERSON TO CONSTRUCT SYSTEM \_\_\_\_\_

ADDRESS \_\_\_\_\_ PHONE \_\_\_\_\_

SIZE OF LOT 4 acres TYPE BLDG. 4 NUMBER OF BEDROOMS \_\_\_\_\_

IF NOT SINGLE RESIDENCE DESCRIBE \_\_\_\_\_

SIGNATURE OF APPLICANT Donald Hoover

APPROVED BY \_\_\_\_\_ FOR \_\_\_\_\_ DATE \_\_\_\_\_

REJECTED BY Robert F. Wine FOR this field only well DATE 6/12/61

HOLD PENDING FURTHER TESTS \_\_\_\_\_ DATE \_\_\_\_\_

REASONS FOR REJECTION OR HOLDING Water table at 6'

Suggest that repair job be done by installing 100 gal. septa tank - 4.50 sq. ft. tile field - not over 2 1/2 feet deep.

# THIS IS NOT A PERMIT

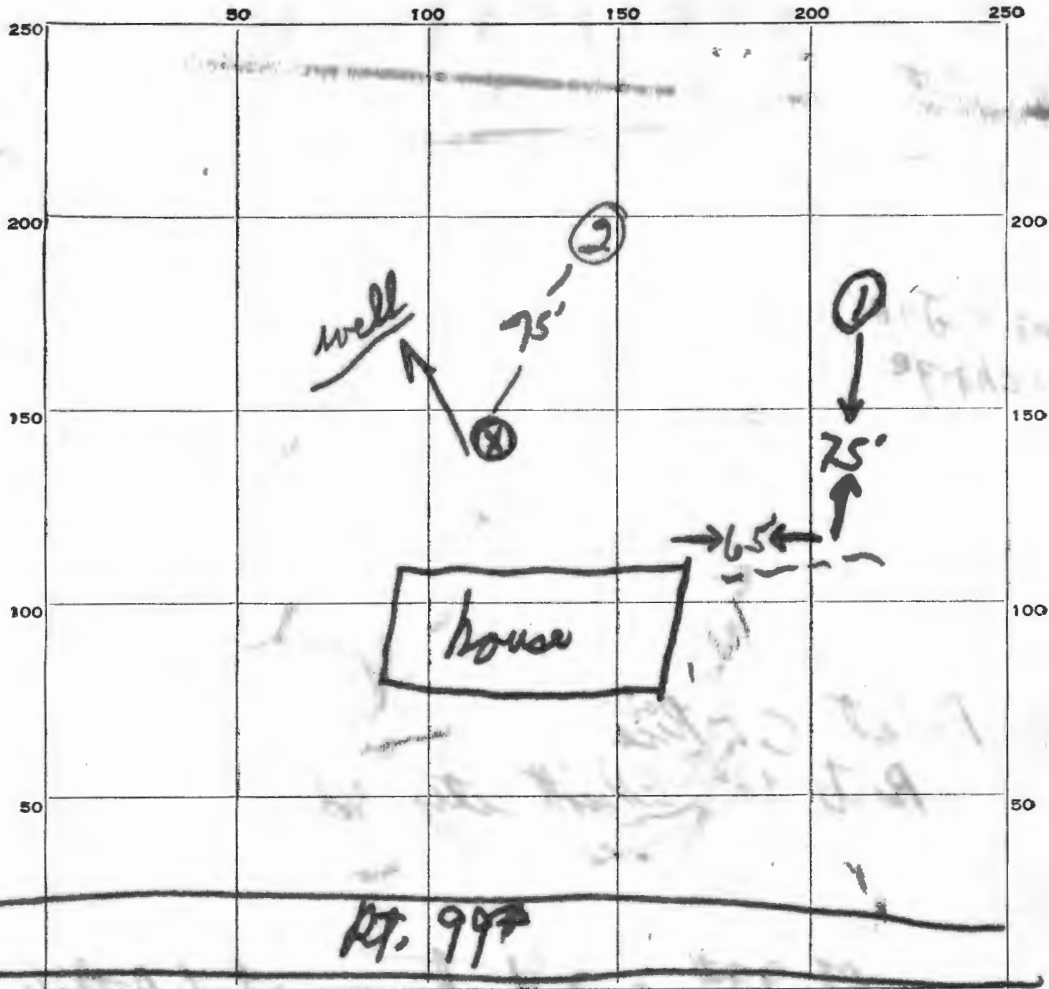

INDICATE NORTH. - NAME ADJOINING ROADWAY AS BASE LINE.

DATE	TEST NO.	DEPTH	PRE-WET		TEST - 1" DROP		TIME	
			START	STOP	START	STOP		
6/12/61	1#	5'	1:26	1:30	1:30	1:35	5 →	
	2#	7'	water on test hole					

SOIL AUGER FINDING Sand

TESTED BY Wms

REMARKS Water came on test hole at 6'

ALSO PRESENT \_\_\_\_\_ LOT NO. \_\_\_\_\_