

15-074078

EMERGENCY/TEMP NO. IF ANY

B 1	SEQUENCE NO. (MDE USE ONLY)	STATE OF MARYLAND APPLICATION FOR PERMIT TO DRILL WELL please type	STATE PERMIT NUMBER <u>HO-20-0255</u> <small>70 fill in this form completely 79</small>
------------	--------------------------------	--	---

OWNER INFORMATION

Date Received (APA) 05/21/24

8 MM DD YY 13

15 Last Name Monahan Owner Dubey First Name 34

36 11242 West Pine Way Street or RFD 55

57 Town 21000 70 State 21 Zip 76

B 3 LOCATION OF WELL

8 COUNTY Howard 21

23 SUBDIVISION 110 T 42

SECTION 44 46 LOT 48 50

52 NEAREST TOWN 10000 71

DRILLER INFORMATION

Driller's Name Wesley A. Wayne MWD License No. 598 76 81

Firm Name Wayne Drilling

Address 11242 West Pine Way

Signature Wesley A. Wayne Date 05/21/24

B 4 SOURCES OF DRILLING WATER

1. 11242 West Pine Way STREET ADDRESS 30

2.

3.

ON WHICH SIDE OF ROAD (CIRCLE APPROPRIATE BOX)

NORTH
 WEST
 EAST
 SOUTH

34 10' 37 DISTANCE FROM ROAD FT

ENTER FT OR MI 38 39

TAX MAP: 10 BLK: 10 PARCEL 0598

B 2 WELL INFORMATION

APPROX. PUMPING RATE (GAL. PER MIN.) 8 12

AVERAGE DAILY QUANTITY NEEDED (GAL. PER DAY) 14 20

USE FOR WATER (CIRCLE APPROPRIATE BOX)

D DOMESTIC POTABLE SUPPLY & RESIDENTIAL IRRIGATION

F FARMING (LIVESTOCK WATERING & AGRICULTURAL IRRIGATION)

I INDUSTRIAL, COMMERCIAL, DEWATERING

P PUBLIC WATER SUPPLY WELL

T TEST, OBSERVATION, MONITORING

O OPEN LOOP GEOTHERMAL

C CLOSED LOOP GEOTHERMAL

NOT TO BE FILLED IN BY DRILLER HEALTH DEPARTMENT APPROVAL

Howard COUNTY NAME 13 COUNTY NO.

STATE SIGNATURE _____ INSERT S → 41

DATE ISSUED 3/8/23 43 MM DD YY 48 CO SIGNATURE [Signature] 3/8/24 EXP. DATE

APPROXIMATE DEPTH OF WELL 24 FEET 28

APPROXIMATE DIAMETER OF WELL _____ INCH NEAREST

METHOD OF DRILLING (circle one)

BORED (or Augered) JETTED Jetted & DRIVEN

30 AIR-ROTary AIR-PERcussion ROTARY (Hydraulic Rotary)

37 CABLE REVerse-ROTary DRIVE-POINT

other _____

REPLACEMENT OR DEEPEINED WELLS (CIRCLE APPROPRIATE BOX)

N THIS WELL WILL NOT REPLACE AN EXISTING WELL

Y THIS WELL WILL REPLACE A WELL THAT WILL BE ABANDONED AND SEALED

39 S THIS WELL WILL REPLACE A WELL THAT WILL BE USED AS A STANDBY-CONTACT LOCAL APPROVING AUTHORITY FOR POLICY ON STANDBY WELLS

D THIS WELL WILL DEEPEIN AN EXISTING WELL

PERMIT NUMBER OF WELL TO BE REPLACED OR DEEPEINED (IF AVAILABLE) 41 _____ 52

Not to be filled in by driller (MDE OR COUNTY USE ONLY)

APPROX. PERMIT NUMBER _____ **G** _____

PERMIT No. HO-20-0255
70 71 72 73 74 75 76 77 78 79

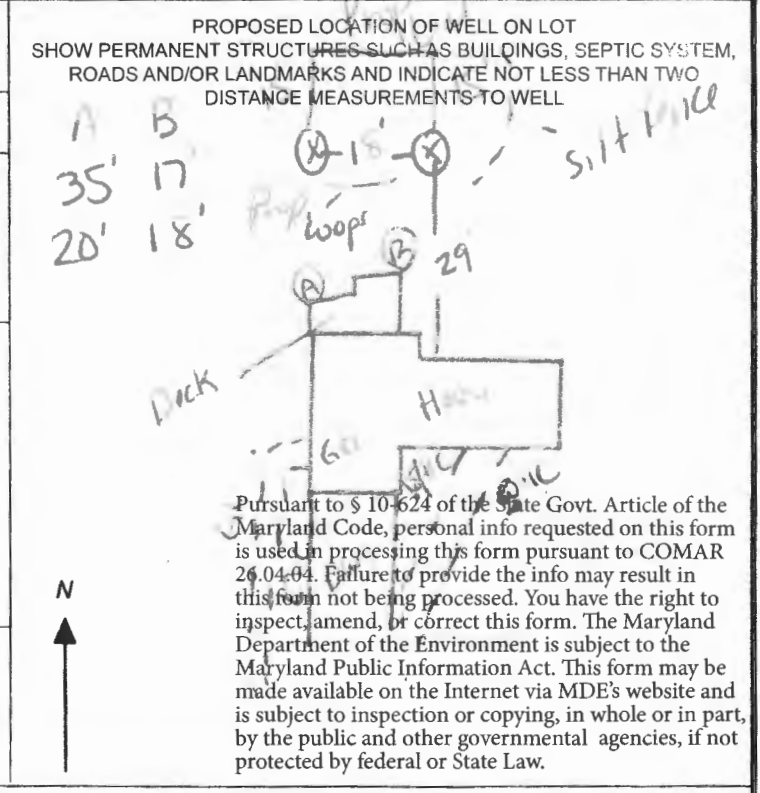

A B
5 17
20 18

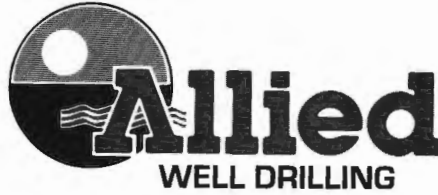

11242 Pentec Way
Columbia Md
2 wells @ 320 each closed
Loop geothermal

Property Line

SITE PLAN

Property Line

Well sites OK
3/18/23

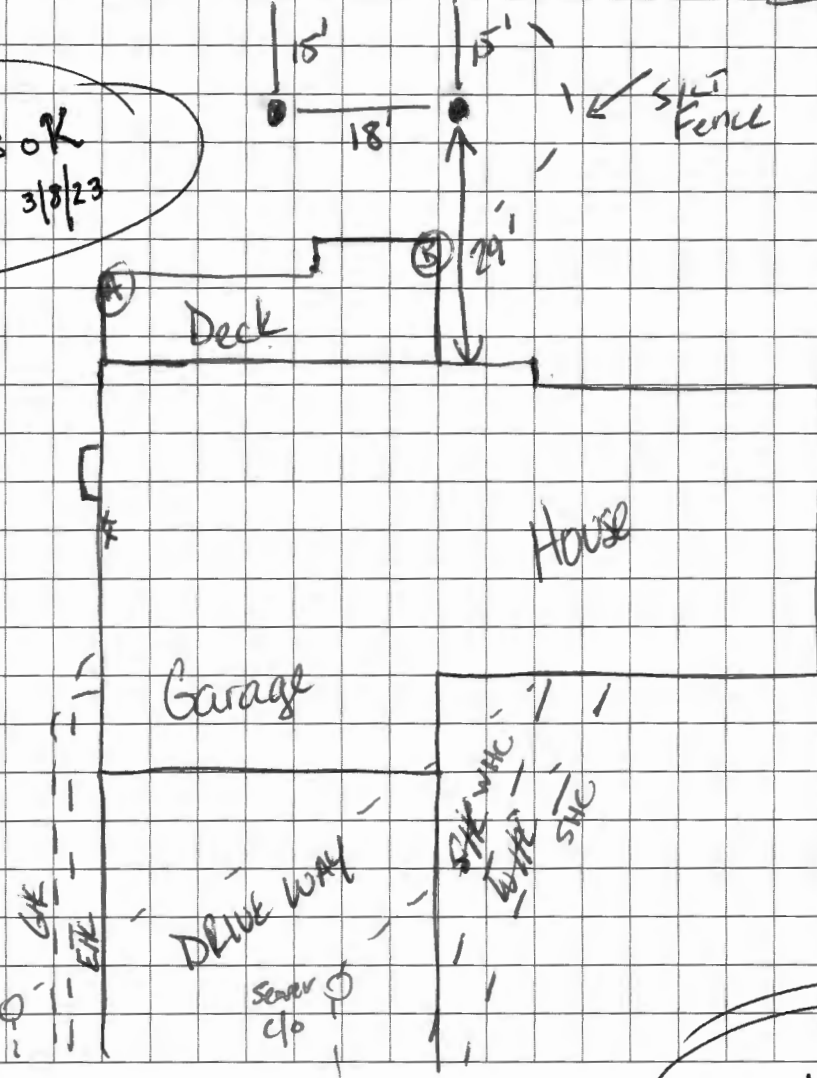

Ho-20-0255

Sediment Control Protocol: SILT Fence

Distance From House: 29'
From Septic: N/A
From Sewer: 50'+
From Property Line: 15' TO P.L. Easement
From Street: 100'

Trees Nearby: Yes BUT OK
Utility Issues: NO
Mats Needed: YES
Access For H/U: YES
Neighboring Tags: See Camps

Comments: Req Access from left side of house. Use Mats to protect side walk & blacktop path.

Person Completing Form: Wes Wolfe

HOWARD COUNTY GROUTING PROCEDURE

Boreholes will be grouted from the bottom to the top via a tremie pipe and positive displacement pump. Bentonite grout, known as Quik-Grout will be used according to the manufacturer's specifications to achieve a consistency of at least 20% solids (24 gallons potable water/50 lb. sack of grout) and a permeability no more than $2.5 \text{ E}(-08) \text{ cm/sec}$. Grouting will be completed immediately after installing the geothermal loop and no later than twenty-four (24) hours after installing the geothermal loop. Open boreholes/annular space will be protected as necessary to prevent the entry of surface water or pollutants.

RECEIPT

Howard County, MD
HOWARD COUNTY HEALTH DEPARTMENT
ASCEND ONE BUILDING
Columbia, MD 21045
8930 STANFORD BLVD

Application: WS-WP-23-00434

Application Type: EnvHealth/Well and Septic/Installation/Application

Address: 11242 peartree WAY,

Receipt No.	5856					
Payment Method	Ref Number	Amount Paid	Payment Date	Cashier ID	Received	Comments
Check	29452	\$160.00	02/22/2023	JUKING		Receipt # 72794

Work Description: Well Permit

GRADE

EACH BORE HOLE (TYP.)

HORIZONTAL BORE
DEPTH 4 FT

FOR CONT.
SEE PLANS

HORIZONTAL
PIPING

GROUT ENTIRE ANGULAR
SPACE AND VERTICAL
U-TUBE WITH (BENTONITE)
GROUT.

BORE DEPTH

TAPE

5 TO 10 FOOT SECTION OF
REBAR TO GUIDE TUBE
INTO BORE DURING
INSTALLATION

DEPTH MARKINGS IN FEET TO
INDICATE DEPTH OF INSERTION

TYPICAL VERTICAL U-TUBE
15 INCHES

TYPICAL BORE DIAMETER
60 INCHES

ANCHOR FITTINGS TO
PREVENT U-TUBE FROM
SURFACING AFTER
INSTALLATION

SEE OVER-SOLES FOR DETAILS

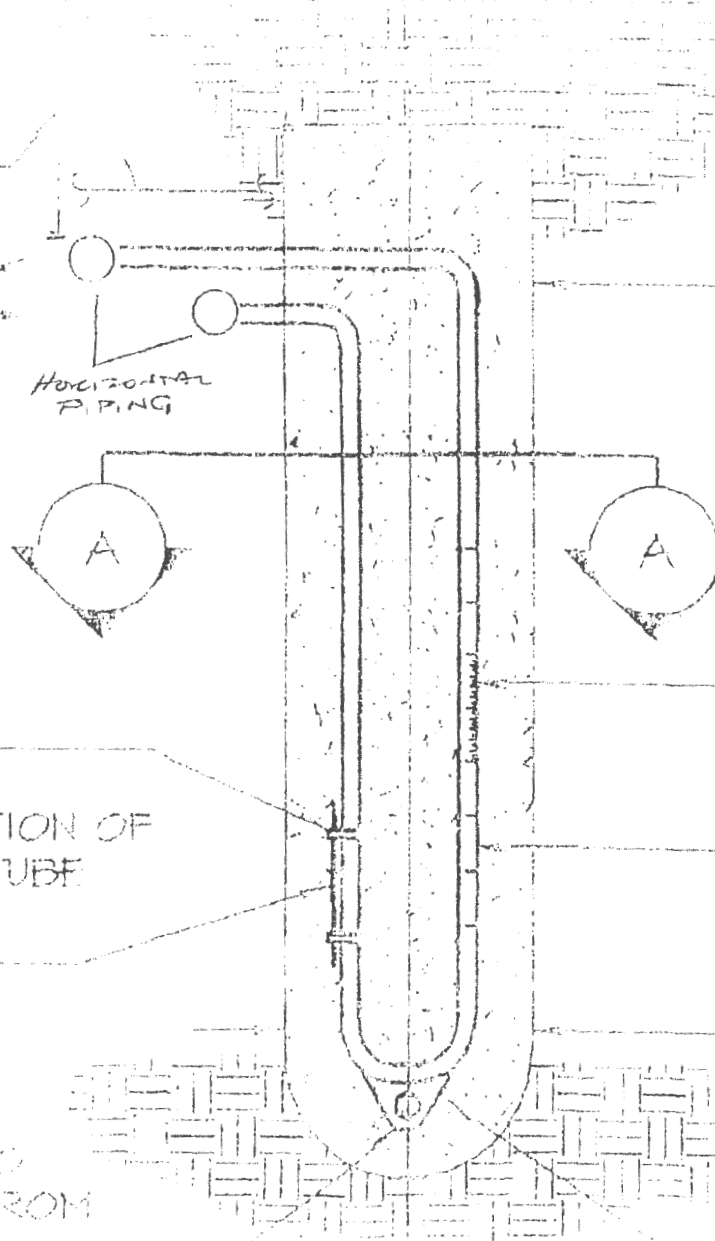



HOWARD COUNTY HEALTH DEPARTMENT

72794

DATE 2/21/23

WS

Received From

Allied Environmental Services

PHONE # 301 716-8370

Services

For

Wet Permit 11242

Fee - Fee Waiver

CASH

CHECK

NO.

29452

One hundred sixty

Dollars

\$

160.00

Received By

J Kemp