



HOWARD COUNTY HEALTH DEPARTMENT

55383

DATE
1 15 115

P5

Received From Fogle's

PHONE # _____

For Septic Permits

CASH

CHECK

NO.

48225

14920 Triadelphia Road \$396 / 1615 Old Annapolis

2830 Marriottsville Road \$396 2 \$100

~~1415 Old Annapolis~~ Eight hundred fifty eight ⁰⁰/₁₀₀ Dollars

\$ ~~858~~ 00

Received By Marian Curry

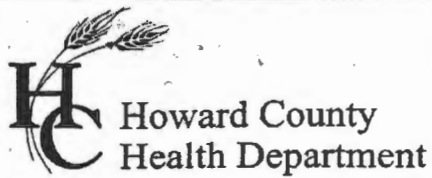

Bureau of Environmental Health
 8930 Stanford Boulevard, Columbia, MD 21045
 Main: 410-313-2640 | Fax: 410-313-2648
 TDD 410-313-2323 | Toll Free 1-866-313-6300
www.hchealth.org
 Facebook: www.facebook.com/hocohealth

Maura J. Rossman, M.D., Health Officer

RECEIPT DATE: 1/5/2015 **ONSITE SEWAGE DISPOSAL SYSTEM** P 55383

INSTALLATION APPROVAL DATE: 2/19/2015 **PERMIT** A _____
CONSTRUCTION

PROPERTY ADDRESS: 1615 Old Annapolis Road, Woodbine, MD 21797

SUBDIVISION: _____ LOT: 2 TAX ID: _____

CONTRACTOR: Fogle's EMAIL: _____

CONTRACTOR ADDRESS: 580 Obrecht Road, Sykesville, MD 21104 PHONE: _____

PROPERTY OWNER: Bach & Heidi Van Vu EMAIL: _____

OWNER ADDRESS: 1615 Old Annapolis Road, Woodbine, MD 21797 PHONE: _____

BAT UNIT MODEL: _____ PUMP SIZE: _____ PUMP TANK CAPACITY: _____

DISTRIBUTION SYSTEM: GRAVITY LOW PRESSURE DOSED NUMBER OF BEDROOMS: 5

TRENCHES:	LINEAR FEET REQUIRED: <u>427 226 275'</u>	INLET DEPTH: <u>4'</u>
	TRENCH WIDTH: <u>3'</u>	MAXIMUM BOTTOM DEPTH: <u>6'</u>
	MINIMUM SPACE BETWEEN TRENCHES: <u>9'</u>	EFFECTIVE AREA BEGINNING DEPTH: <u>5'</u>
LOCATION:	PER APPROVED SITE PLAN. SEWAGE DISPOSAL AREA AND BAT UNIT LOCATION MUST BE STAKED BY LICENSED SURVEYOR PRIOR TO PRE-CONSTRUCTION INSPECTION.	
NOTES:	CONNECT NEW TRENCH(S) TO THE EXISTING SEPTIC SYSTEM. <u>5x55' Trenches</u>	

ISSUED BY: _____ ISSUE DATE: 1/7/2015 EXPIRATION DATE: 1/7/2016

- NOTE: CONTRACTOR MUST SCHEDULE A PRE-CONSTRUCTION INSPECTION PRIOR TO BEGINNING ANY INSTALLATION
- NOTE: CONTRACTOR MUST SCHEDULE AN INSPECTION AND GAIN APPROVAL OF ALL COMPONENTS PRIOR TO COVERING
- NOTE: STONE MUST BE APPROVED BY HEALTH DEPARTMENT AND GRAVEL TICKET MUST BE AVAILABLE FOR REVIEW.
- NOTE: WATERTIGHT SEPTIC TANKS REQUIRED
- NOTE: ALL PARTS OF SEPTIC SYSTEM SHALL BE AT LEAST 100 FEET DOWNGRADIENT FROM ANY WATER WELL
- NOTE: MANHOLE RISERS REQUIRED ON ALL SEPTIC TANKS AND PUMP CHAMBERS
- NOTE: AN ELECTRICAL PERMIT IS REQUIRED FOR INSTALLATION OF ANY ELECTRICAL COMPONENTS OF THE SYSTEM
- NOTE: AN INDIVIDUAL CERTIFIED BY MDE AND THE MANUFACTURER FOR BAT INSTALLATION MUST BE PRESENT AT ALL TIMES DURING BAT INSTALLATION.
- NOTE: MDE RECOMMENDS SEPTIC TANKS, BAT, AND OTHER PRETREATMENT UNITS BE PUMPED AT A FREQUENCY ADEQUATE TO ENSURE THAT SOLIDS ARE NOT DISCHARGED TO THE DISPOSAL AREA

NEITHER THE HOWARD COUNTY COUNCIL NOR THE HEALTH DEPARTMENT IS RESPONSIBLE FOR THE SUCCESSFUL OPERATION OF ANY SYSTEM. PERMITTEE RESPONSIBLE FOR OBTAINING FINAL APPROVAL ON THIS PERMIT. CALL 410-313-1771 TO SCHEDULE INSPECTIONS.

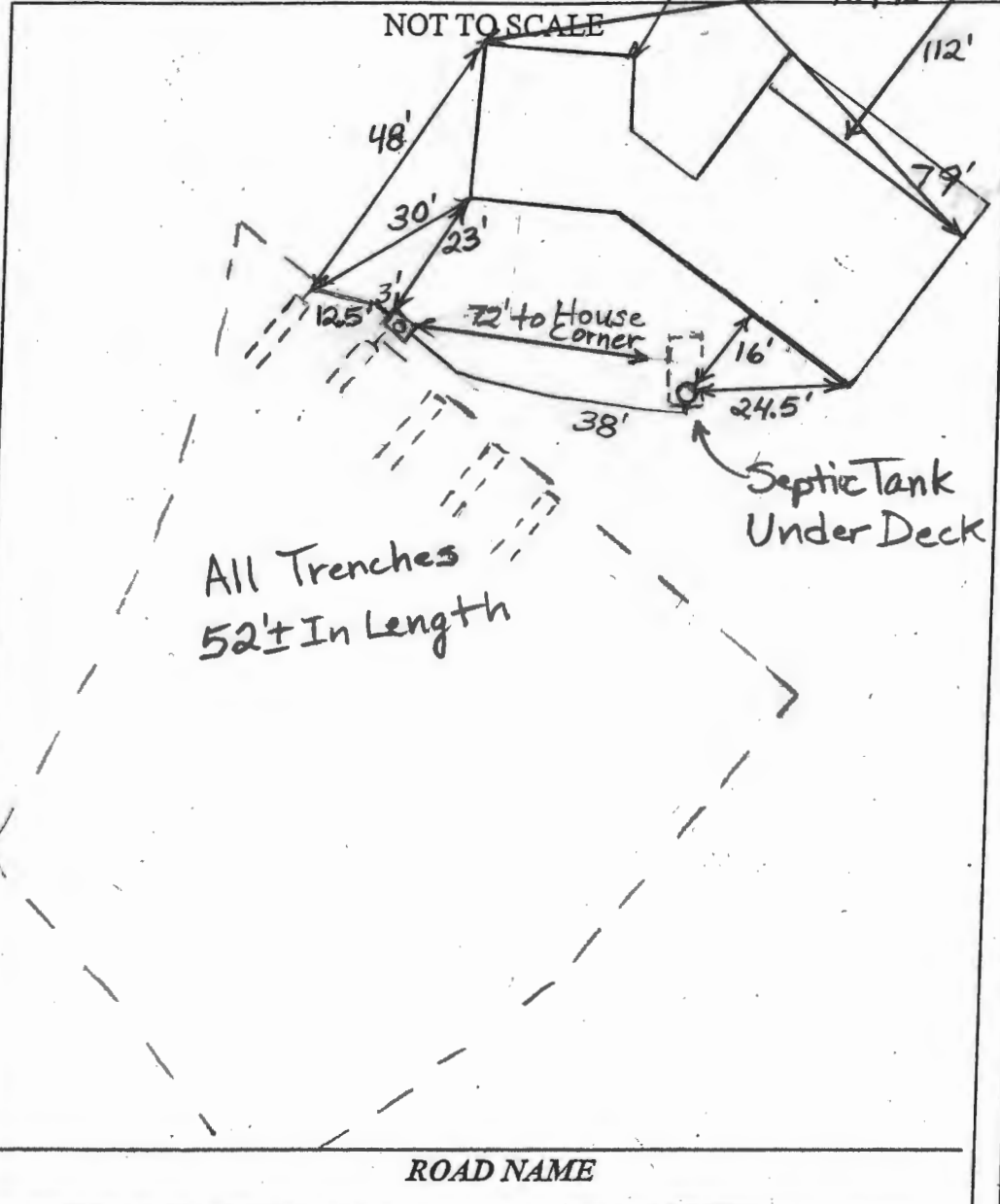

HO-73-0427 HO-14-0071 (Not Connected to House)

TRENCH/DRAINFIELD DATA		
WIDTH	INLET	BOTTOM
3'	4'-5'	6'
NUMBER OF TRENCHES		5
TOTAL LENGTH		261'
ABSORPTION AREA		783± Sidewall
DISTRIBUTION BOX LEVEL		Levelers
DISTRIBUTION BOX BAFFLE		Yes
DISTRIBUTION BOX PORT		Yes

SEPTIC TANK DATA	
SEPTIC TANK 1 LEVEL	As Is
MANUFACTURER	?
CAPACITY	As Is GAL
SEAM LOC	Mid seam
TANK LID DEPTH	1.5
BAFFLES	Rear
BAFFLE FILTER	No
MANHOLE LOC	Rear
6" PORT LOC	None
WATERTIGHT TEST	
SLOTTED	N/A
DATE ON LID	N/A
PUMP/SEPTIC TANK LEVEL N/A	
MANUFACTURER	
CAPACITY	GAL
SEAM LOC	
TANK LID DEPTH	
BAFFLES	
BAFFLE FILTER	
MANHOLE LOC	
6" PORT LOC	
WATERTIGHT TEST	
SLOTTED	
DATE ON LID	

PRE-CONSTRUCTION: 2/12/2015 Numerous trees further from the house makes it too difficult to install long trenches. I install five 55' trenches on contour in the highest part of the easement that is closest to the house. The inlet on the highest trench to be 5' or a pump system will have to be utilized. Trench inlets to get shallower the further downhill trenches are installed. (BB)

2/13/2015 Installing line from tank to dist. box. (BB) 2/18/2015 System finished but pipe going from dist. box to top trench didn't have fall. Water wasn't getting to top trench. (SC) 2/19/2015 Everything covered except for dist. box. Adjusted levelers. Top trench getting water. (BB)

FINAL INSPECTOR B. Baber DATE OF APPROVAL 2/19/2015

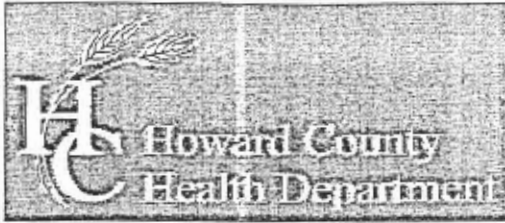

Bureau of Environmental Health

8930 Stanford Boulevard, Columbia, MD 21045
Main: 410-313-2640 | Fax: 410-313-2648
TDD 410-313-2323 | Toll Free 1-866-313-6300
www.hchealth.org

Facebook: www.facebook.com/hocohealth
Twitter: HowardCoHealthDep

Dr. Maura J. Rossman, M.D., Health Officer

INFORMATION FORM - SEPTIC SYSTEM REPAIR/UPGRADE

Reason for Request:

- Failing System / UPGRADE
System relocation for proposed addition
System upgrade for proposed addition
Inadequate treatment zone
Collapsed septic tank
Collapsed drywell

Has the septic tank been pumped within the last month?

- Yes
No

Was a visual inspection of the septic tank and/or drain fields conducted?

- Yes
No SEE ATTACHED

Was a visual inspection of the sewage line conducted?

- Yes
Blockage leading to the tank
Yes Explain:
No SEE ATTACHED
Blockage leading to the field
Yes Explain:
No SEE ATTACHED

Existing system design

- Drywell
Trench
Mound
Unknown
Other:

Is discharge surfacing on the ground?

- Yes
No

Additional Comments: * SEE ATTACHED

*For REPAIRS, are the owners proposing, or do they plan to add in the future, any additions or modifications to the property, i.e. pools, living space additions, garages, etc? This information must be disclosed at the time of this application. The Health Department will not be able to accommodate requests in the field for property modifications unrelated to the repair request. Such requests may require an additional fee, testing, and submittal of a Percolation Certification Plan, if the property does not meet current Code and Regulation.

Septic Contractor: FOGLE'S SEPTIC Contractor's Phone: 410-795-5670
Contractor's Address: 580 OBRECHT RD.

Property Address: 1615 Old Annapolis Rd County file:
Subdivision: Lot: 1 Year Built:
Owner's Name: Bach Van Vu Owner's Phone: 301-651-3036

Name of previous owners: Existing bedrooms:
Proposed bedrooms:

Has this request been previously discussed with a Sanitarian? (Name):
Public Sewer available/nearby:

*A Sanitarian will be in contact within three business days, depending upon the urgency of the situation, to coordinate the scheduling/review of the repair or upgrade.

Prior to scheduling inspections, scaled plans should be submitted to clarify the nature of the addition.

Print out a copy of Real Property Data via Dept. of Taxation website Indexed file found

If public sewer may be nearby, verify whether sewer is technically "available" through the Bureau of Engineering.

If sewer is available and the property is within the Metropolitan District, connection to sewer is required. If the owner believes reason for exemption exists, the owner should justify the request in writing.

If soil/site conditions are limited and sewer and/or Metro District status is not conducive to connection, the Sanitarian may recommend pursuit of Emergency Sewer Extension or Emergency Metro District Inclusion. The Owner should contact the Bureau of Utilities for details.

No permit is to be issued nor inspection to be scheduled without prior fee collection at the office unless an emergency situation exists. The contractor is to notify office of the emergency situation as soon as possible.