

C 1 **6801** SEQUENCE NO. (DENV USE ONLY) **STATE OF MARYLAND WELL COMPLETION REPORT** THIS REPORT MUST BE SUBMITTED WITHIN 45 DAYS AFTER WELL IS COMPLETED.

(THIS NUMBER IS TO BE PUNCHED IN COLS. 3-6 ON ALL CARDS) **FILL IN THIS FORM COMPLETELY PLEASE PRINT OR TYPE** COUNTY NUMBER **RW**

ST/CO USE ONLY DATE Received **JUN 26 1992** DATE WELL COMPLETED **050492** Depth of Well **200** PERMIT NO. FROM "PERMIT TO DRILL WELL" **40-92-0067**

OWNER **Fallmer, Jonathan** first name **Jonathan** TOWN **Sykesville**

STREET OR RFD. **835 Day Rd** last name **Day**

SUBDIVISION _____ SECTION _____ LOT _____

WELL LOG
Not required for driven wells
STATE THE KIND OF FORMATIONS PENETRATED, THEIR COLOR, DEPTH, THICKNESS AND IF WATER BEARING

DESCRIPTION (Use additional sheets if needed)	FEET		Check if water bearing
	FROM	TO	
Topsoil	0	1	
Br. Mica	1	4	
Br. Sandstone	4	6	
Thin Sandstone	6	39	
Br. Sandstone	39	41	
Thin Sandstone	41	50	
Br. Sandstone	50	52	
Thin Sandstone	52	55	
Granite	55	70	
Thin Sandstone	70	75	
Granite	75	95	
Thin Sandstone	95	98	
Granite	98	200	

GROUTING RECORD
WELL HAS BEEN GROUTED (Circle Appropriate Box) **Y** **N**

TYPE OF GROUTING MATERIAL
CEMENT **CM** BENTONITE CLAY **BC**

NO. OF BAGS **7** NO. OF POUNDS **700**

GALLONS OF WATER **35**

DEPTH OF GROUT SEAL (to nearest foot)
from **0** ft. to **18** ft.

CASING RECORD
casing types insert appropriate code below

ST **CO**
STEEL CONCRETE

PL **OT**
PLASTIC OTHER

MAIN CASING TYPE **ST** Nominal diameter top (main) casing (nearest inch) **2 1/2** Total depth of main casing (nearest foot) **21**

OTHER CASING (if used)
diameter inch _____ depth (feet) from _____ to _____

SCREEN RECORD
screen type or open hole insert appropriate code below

ST **BR** **HO**
STEEL BRASS BRONZE OPEN HOLE

PL **OT**
PLASTIC OTHER

C 2

DEPTH (nearest ft.)

EACH SCREEN

1	H10	19	200
2			
3			

SLOT SIZE 1 _____ 2 _____ 3 _____

DIAMETER OF SCREEN _____ (NEAREST INCH)

from _____ to _____

GRAVEL PACK IF WELL DRILLED WAS FLOWING WELL INSERT F IN BOX 68

OEP USE ONLY (NOT TO BE FILLED IN BY DRILLER)

T (E.R.O.S.) **W Q**

70 72 74 75 76

TELESCOPE CASING LOG INDICATOR OTHER DATA

C 3

PUMPING TEST

HOURS PUMPED (nearest hour) **3**

PUMPING RATE (gal. per min. to nearest gal.) **10**

METHOD USED TO MEASURE PUMPING RATE **Bucket**

WATER LEVEL (distance from land surface)

BEFORE PUMPING **50**

WHEN PUMPING **200**

TYPE OF PUMP USED (for test)

A air **P** piston **T** turbine

C centrifugal **R** rotary **O** other (describe below)

J jet **S** submersible

PUMP INSTALLED

DRILLER WILL INSTALL PUMP YES **NO**

IF DRILLER INSTALLS PUMP, THIS SECTION MUST BE COMPLETED FOR ALL WELLS EXCEPT HOME USE

TYPE OF PUMP INSTALLED PLACE (A,C,J,P,R,S,T,O) IN BOX - SEE ABOVE:

CAPACITY: GALLONS PER MINUTE (to nearest gallon) _____

PUMP HORSE POWER _____

PUMP COLUMN LENGTH (nearest ft.) _____

CASING HEIGHT (circle appropriate box and enter casing height)

+ above } LAND SURFACE **2** (nearest foot)

- below }

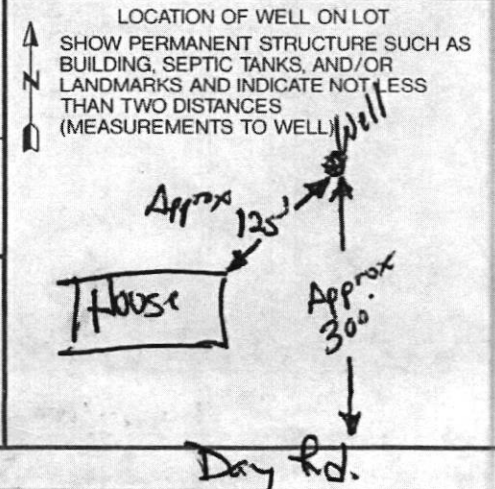

CIRCLE APPROPRIATE LETTER

A A WELL WAS ABANDONED AND SEALED WHEN THIS WELL WAS COMPLETED

E ELECTRIC LOG OBTAINED

P TEST WELL CONVERTED TO PRODUCTION WELL

I HEREBY CERTIFY THAT THIS WELL HAS BEEN CONSTRUCTED IN ACCORDANCE WITH COMAR 26.04.04 "WELL CONSTRUCTION" AND IN CONFORMANCE WITH ALL CONDITIONS STATED IN THE ABOVE CAPTIONED PERMIT, AND THAT THE INFORMATION PRESENTED HEREIN IS ACCURATE AND COMPLETE TO THE BEST OF MY KNOWLEDGE.

DRILLERS IDENT. NO. **40**

DRILLERS SIGNATURE **George E. Easton**

DRILLERS SIGNATURE (MUST MATCH SIGNATURE ON APPLICATION) **Wesley K. Blaney**

SME SUPERVISOR (sign. of driller or journeyman responsible for sitework if different from permittee)

ORIGINAL

B 1 01729

SEQUENCE NO. (DP USE ONLY)

STATE OF MARYLAND APPLICATION FOR PERMIT TO DRILL WELL

STATE PERMIT NUMBER

40-92-0067

fill in this form completely

(THIS NUMBER IS TO BE PUNCHED IN COLS. 3-6 ON ALL CARDS)

please print or type

Date Received (APA)

050192

OWNER INFORMATION

704 LMER JO ANATHAN

835 DAY RD

SYKESVILLE MD 21784

LOCATION OF WELL

HOWARD

SUBDIVISION

SECTION LOT

SYKESVILLE

MILES FROM TOWN

DRILLER INFORMATION

George F. Easterday

L. Franklin Easterday, Inc.

9265 Brown Church Rd., MT. Airy, Md. 21771

George F. Easterday 5/1/92

DIRECTION OF WELL FROM TOWN

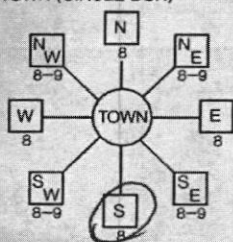

835 DAY RD

NEAR WHAT ROAD

ON WHICH SIDE OF ROAD

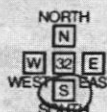

200 DISTANCE FROM ROAD

ENTER FT or MI

WELL INFORMATION

APPROX. PUMPING RATE (GAL. PER MIN.)

5

AVERAGE DAILY QUANTITY NEEDED (GAL. PER DAY)

500

USE FOR WATER

- Home, Farming, Industrial, Public, Test options with checkboxes.

NOT TO BE FILLED IN BY DRILLER HEALTH DEPARTMENT APPROVAL

Howard A12573

COUNTY NAME COUNTY NO.

DATE ISSUED 11-4-92

CO SIGNATURE EXP. DATE

NORTH GRID EAST GRID

APPROXIMATE DEPTH OF WELL 200 FEET

APPROXIMATE DIAMETER OF WELL 6 INCH

METHOD OF DRILLING

- Bored, Jetted, Cable, Drive-Point options.

REPLACEMENT OR DEEPEMED WELLS

- Not replace, Replace, Standby, Deepen options.

Not to be filled in by driller (OEP USE ONLY)

APPROP. PERMIT NUMBER GAP

FORCE RP PERMIT No. 40-92-0067

SPECIAL CONDITIONS

SHOW MAJOR FEATURES OF BOX & LOCATE WELL WITH AN X SOURCES OF DRILLING WATER

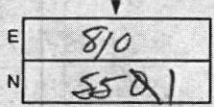

DRAW A SKETCH BELOW SHOWING LOCATION OF WELL IN RELATION TO NEARBY TOWNS AND ROADS

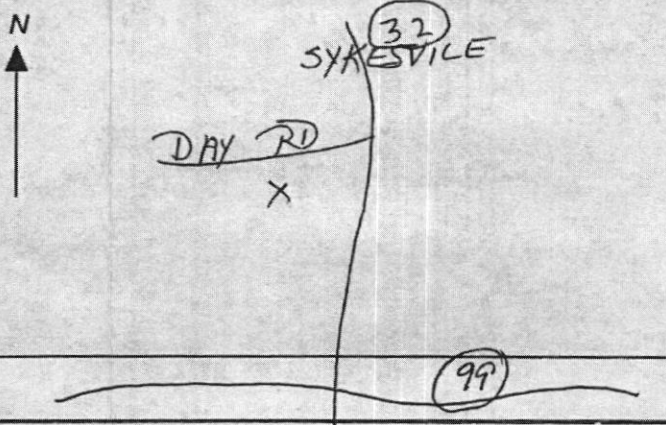

[View Map](#)

[View GroundRent Redemption](#)

[View GroundRent Registration](#)

Special Tax Recapture: None

Account Identifier: District - 03 Account Number - 297268

Owner Information

Owner Name: ALI KAZAM Use: RESIDENTIAL
ALI FARAH R Principal Residence: YES
Mailing Address: 835 DAY RD Deed Reference: /16621/ 00313
SYKESVILLE MD 21784-

Location & Structure Information

Premises Address: 835 DAY RD Legal Description: LOT 3 3.000 A
SYKESVILLE 21784-0000 835 DAY RD
TALLEY PROP RS LTS 1, 2

Map: Grid: Parcel: Neighborhood: Subdivision: Section: Block: Lot: Assessment Year: Plat No: 16723
0009 0004 0316 3010101.14 0001 3 2022 Plat Ref:

Town: None

Primary Structure Built Above Grade Living Area Finished Basement Area Property Land Area County Use
1965 1,820 SF 3.0000 AC

StoriesBasementType ExteriorQualityFull/Half BathGarageLast Notice of Major Improvements
1 NO STANDARD UNITBRICK/ 4 2 full

Value Information

	Base Value	Value As of 01/01/2022	Phase-in Assessments As of 07/01/2021	
Land:	225,000	241,200		As of 07/01/2022
Improvements	182,500	201,300		
Total:	407,500	442,500	407,500	419,167
Preferential Land:	0	0		

Transfer Information

Seller: SHARP CHARLES A Type: ARMS LENGTH IMPROVED	Date: 12/30/2015 Deed1: /16621/ 00313	Price: \$366,500 Deed2:
Seller: SHARP CHARLES A Type: NON-ARMS LENGTH OTHER	Date: 02/25/2013 Deed1: /14712/ 00438	Price: \$0 Deed2:
Seller: FOLLMER JONATHAN S Type: ARMS LENGTH MULTIPLE	Date: 08/28/2003 Deed1: /07548/ 00619	Price: \$800,000 Deed2:

Exemption Information

Partial Exempt Assessments:	Class	07/01/2021	07/01/2022
County:	000	0.00	
State:	000	0.00	
Municipal:	000	0.00 0.00	0.00 0.00

Special Tax Recapture: None

Homestead Application Information

Homestead Application Status: No Application

Homeowners' Tax Credit Application Information

Homeowners' Tax Credit Application Status: No Application Date:

Photos - 4/5/22 ~~RAH~~

SDA AREA



HO-92-0067

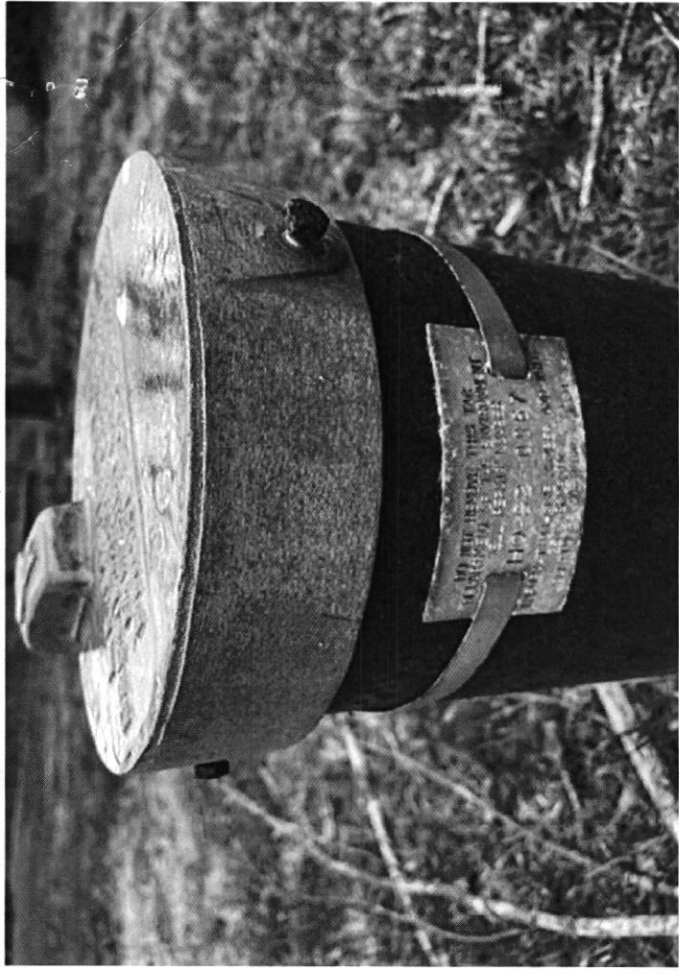

← pit well

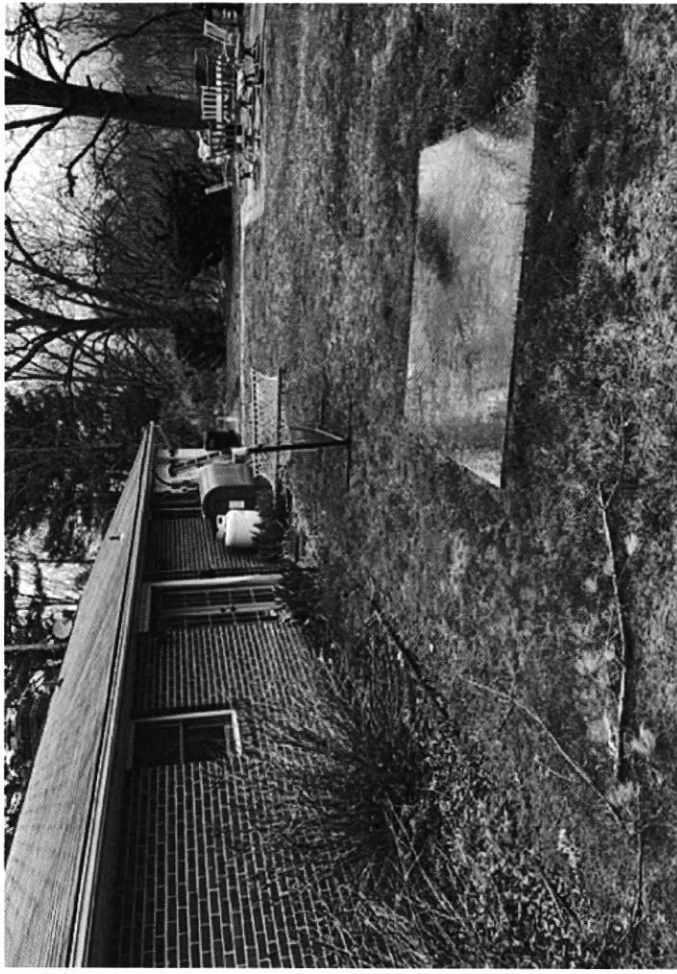

SITE INSPECTION SHEET

OWNER: Ali Kazam PHONE #: 301-458-5220
ADDRESS: 835 Day Rd CONTRACTOR: Miracle Contractor LLC
Sykesville, MD. 21784 WELL TAG #: HO-92-0067
SUBDIVISION: Tax ID: 1403297268 LOT: _____ COUNTY #: B22000826
PROPOSAL: SFD - construct office's family room addition

LOCATION DIAGRAM

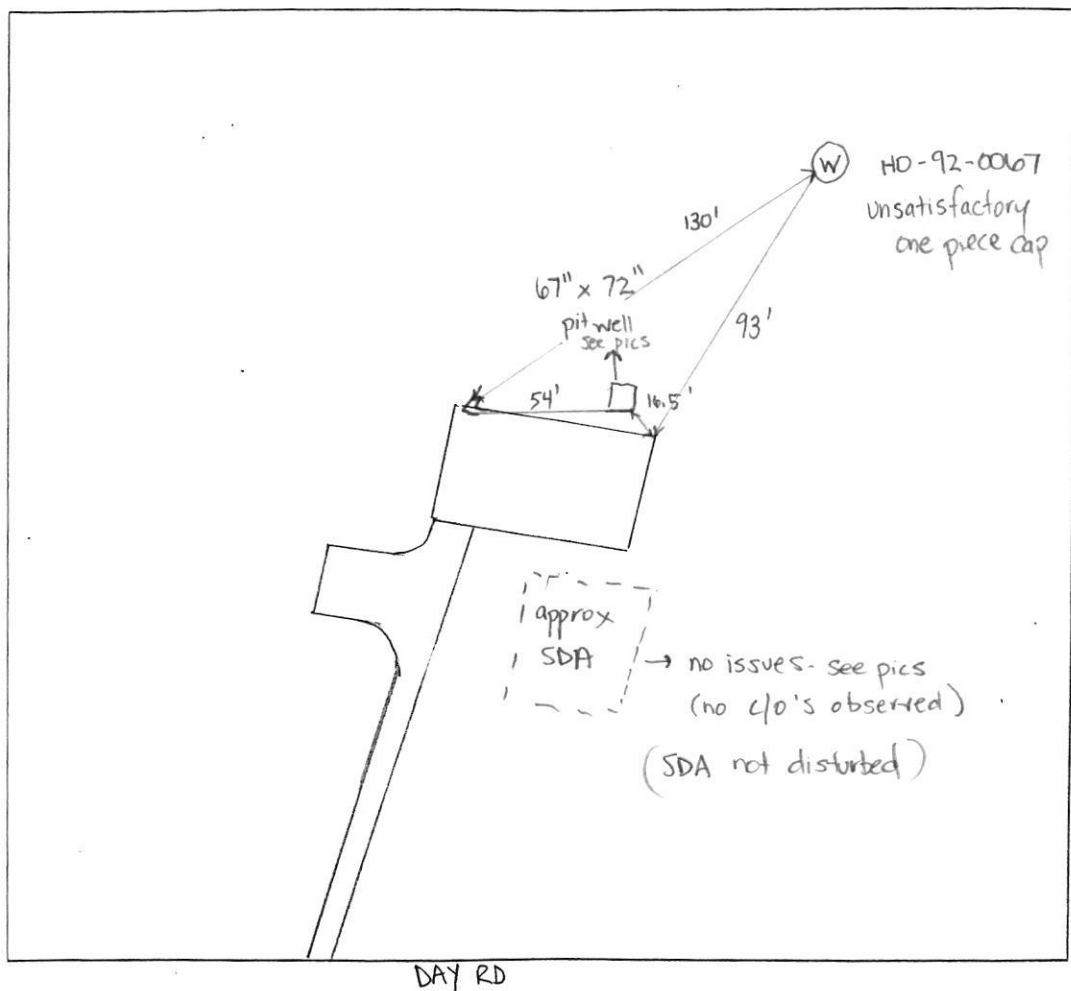

COMMENTS: _____
Well HO-92-0067 has a one piece cap and the pit well looks alright.
It's protected w/ a cover and appears to be connected and in use.

DATE: 4/5/22 INSPECTOR: R. Rappaport

Freemon, Robert

From: Kazam Ali <kazamali70@hotmail.com>
Sent: Thursday, April 14, 2022 11:16 AM
To: Freemon, Robert
Subject: Re: 835 Day Rd, Sykesville, MD

[Note: This email originated from outside of the organization. Please only click on links or attachments if you know the sender.]

Spencer,

Here is an explanation for why the existing well pit cannot be filled. We purchased this house in 2015. This pit was existing due to the fact of the house being built on a concrete slab. There is no location in the house where the items in the pit (caustic soda feed, expansion tank, and sediment separator.) could be placed in the home. With no basement nor crawl space, the pit was the only location for these items. Hope this helps, if you need any additional information, please do not hesitate to contact me.

Thanks
Kazam Ali

From: Freemon, Robert <rfeemon@howardcountymd.gov>
Sent: Thursday, April 7, 2022 3:05 PM
To: kazamali70@hotmail.com <kazamali70@hotmail.com>; Carlito Mitchell <carlito@miraclecontractors.net>; christy sheubrooks <christy@freedomseptic.com>
Subject: 835 Day Rd, Sykesville, MD

Hi All,
Here is what needs to happen with the property during percolation testing. Attached is a site plan of the property with the previous perc hole locations, new proposed test locations and designated sewage disposal area (SDA).

We need to do 2 perc test locations. One in the middle/lower end of the SDA and one closer to the previous test hole #16. Previous test locations #18 and #15 showed signs of water at 12 & 11 feet. We need to make sure, now that we are in wetseason, that the ground water has not risen any higher and to confirm a passing middle hole for the SDA. The proposed test location near hole #16 is to observe whether or not the rock issues documented are an isolated issue.

Since we already will have a back hoe out on site we will want to uncover and evaluate the existing system even if we are planning on installing a new one. Mostly we need to confirm that the septic system shown on records is in fact the one installed out in the field. Along with this we can gather elevation information of the sewage pipe leaving the house so it can be used to design a new system. Although we are not requiring an official Percolation Certification plan drawn up by an engineer Health will require and engineer to draw up the OSDS plan assuming the existing system will not be adequately sized for the proposed house.

Health Requirements Prior to Testing

1. Perc Application Completed and Submitted to Health Along with \$506 fee. We will use the attached to plan as the perc test plan. The proposed test locations along with the previous test locations will need to be staked. If there are other structures/utility lines within the vicinity those will need be drawn on the plan by the owner.

Dune wants to keep pit for equipment ~~(port)~~ storage.
I informed Dune the Health Dept needs documentation
Previous well in pit is abandoned by ~~the~~ according to
licensed well driller). May be able to ask for
waiver for pit storage alone (no well in pit). Other
well is currently serving the property. Need
additional information from driller about pit/wells
circumstance before waiver can be requested.

WATER WELL ABANDONMENT-SEALING REPORT FORM

SUBMIT COPIES OF COMPLETED FORM TO:

- * COUNTY ENVIRONMENTAL AGENCY (contact MDE, WMA if address needed)
- * WELL OWNER
- * MDE, WATER MANAGEMENT ADMINISTRATION, WELL PROGRAM

DATE WELL ABANDONED: 6-30-22 (month/day/year)

* PERMIT NUMBER OF ABANDONED WELL (if any) _____

No tag

* PERMIT NUMBER OF REPLACEMENT WELL: _____

* PERSON ABANDONING WELL: Andrew Hovnanian WELL DRILLER'S LICENSE NUMBER: 224

CIRCLE: MWD / MSD / MGD

* OWNER'S NAME: Ali Kazam

SITE LOCATION MAP

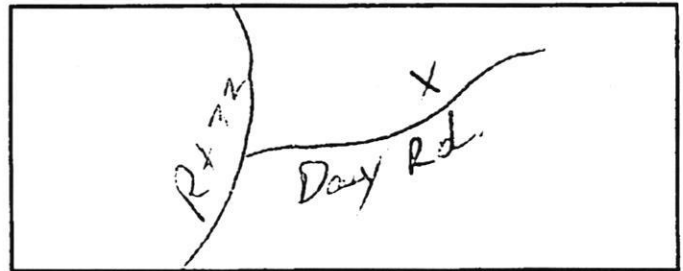

* WELL LOCATION:
 COUNTY: Howard
 NEAREST TOWN: Surreysville
 TAX MAP 9 BLOCK 4 PARCEL 316
 SUBDIVISION: Talley Tract
 SECTION: _____ LOT: 2
 STREET ADDRESS: 838 Day Rd

LATITUDE 39.347459

LONGITUDE 76.964292

LOG OF SEALING MATERIAL

MATERIAL	FEET	
	FROM	TO
<u>Bentonite</u>	<u>90</u>	<u>0</u>
VOLUME OF MATERIAL USED		
<u>Bentonite</u>	<u>1200 lbs</u>	

* TYPE OF WELL BEING ABANDONED:
 DRILLED JETTED
 BORED HAND DUG
 OTHER (specify) _____

* USE CODE:
 DOMESTIC MUNICIPAL/PUBLIC
 IRRIGATION INDUSTRIAL
 TEST/OBSERVATION GEOTHERMAL

* TYPE OF CASING:
 STEEL PLASTIC
 CONCRETE OTHER (specify) _____

SIZE OF CASING: 6 INCHES IN DIAMETER

DEPTH OF WELL: 90 FEET DEEP

WAS ANY CASING REMOVED? YES NO
 If yes, length removed, in feet: _____

WAS CASING RIPPED OR PERFORATED? YES NO

SIGNATURE-MASTER WELL DRILLER OR SUPERVISING SANITARIAN LICENSE# _____

Andrew Hovnanian

224 MWD / MSD / MGS 6-30-22

CIRCLE ONE

DATE

OWNER

Pursuant to § 10-624 of the State Govt. Article of the Maryland Code, personal info requested on this form is used in processing this form pursuant to COMAR 26.04.04. Failure to provide the info may result in this form not being processed. You have the right to inspect, amend, or correct this form. The Maryland Department of the Environment is subject to the Maryland Public Information Act. This form may be made available on the Internet via MDE's website and is subject to inspection or copying, in whole or in part, by the public and other governmental agencies, if not protected by federal or State Law.