

RECEIVED

JUN 01 2022

LICENSES & PERMITS DIVISION

PERMIT NUMBER: B

22002204

DATE ACCEPTED:



COMMERCIAL BUILDING PERMIT APPLICATION

HOWARD COUNTY DEPARTMENT OF INSPECTIONS, LICENSES, AND PERMITS

3430 COURT HOUSE DRIVE, ELLICOTT CITY, MD 21043

PHONE: (410) 313-2455 OPTION #4

www.howardcountymd.gov

BUILDING SITE ADDRESS REQUIRED

Street Address: 7540 Assateague Drive
City: Jessup
State: MD
Zip Code: 20794
Subdivision/Village/Complex Name:
SDP/WP/BA #:
Lot:
Tax Map:
Parcel:
Grading Permit #:

DESCRIPTION OF WORK REQUIRED

Existing Use: Warehouse storage
Proposed Use: Warehouse Storage
Estimated Cost: \$
Trade Work to Be Completed (Separate Permits Required):
Mechanical (HVACR)
Electrical
Plumbing
None
Install pallet racking

PROPERTY OWNER INFORMATION REQUIRED

Owner(s) Name(s) (As it appears on tax records): Jessup Cold Storage, Inc.
Owner's Street Address: c/o Heitman 191 North Wacker Drive Suite 250
City: Chicago
State: IL
Zip Code: 60606
Phone: (312) 425-0486
Email: ryan.matyas@heitman.com

TENANT INFORMATION REQUIRED

Business Name: Chefs' Warehouse Mid Atlantic, LLC
Contact Name: Lawrence Quinn
Street Address: 7540 Assateague Drive
City: Jessup
State: MD
Zip Code: 20794
Phone: (443) 661-1556
Email: lquinn@capitalseafood.com

APPLICANT NAME REQUIRED - INDIVIDUAL WHO SIGNS THIS APPLICATION

Business Name: Diversified Rack & Shelving
Contact Name: Ron Longo
Street Address: 603 Rt. 130 North
City: East Windsor
State: NJ
Zip Code: 08520
Phone: (609) 448-6262
Email: erick@diversifiedrack.com

CONTRACTOR INFORMATION REQUIRED

Business Name: Diversified Rack & Shelving
Licensee's Name: Diversified Rack & Shelving
License #: 13941747
Street Address: 603 Rt. 130 North
City: East Windsor
State: NJ
Zip Code: 08520
Phone: (609) 448-6262
Email: erick@diversifiedrack.com

ARCHITECT/ENGINEER INFORMATION REQUIRED - INDIVIDUAL WHO SIGNED PLANS

Business Name: Penn Fusion Engineering
Name: Andrew Leone
Street Address: 152 S. Broad St.
City: Lansdale
State: PA
Zip Code: 19446
Phone: (267) 640-2758
Email: aleone@pennfusioneng.com

BUILDING CHARACTERISTICS (PLEASE SELECT/COMPLETE ALL THAT APPLY)

Utilities: Electric Gas
Water Supply: Public Private (Well)
Sewage Disposal: Public Private (Septic)
Heating System: Electric Natural Gas Propane Other:
Roadside Tree Project: No Yes:#
Sprinkler System: NFPA 13 NFPA 13R None
Fire Alarm System: Yes No Voice Evac

ADDITIONAL COMMERCIAL INFORMATION (PLEASE SELECT/COMPLETE ALL THAT APPLY)

Area of Construction: 57,450 sq ft
Gross Area: sq ft
Height: ft
# of Stories: 1
Construction Classification(s):
Use Group:
Was the tenant space previously occupied? Yes No
Shell Building Permit # (for interior completions):

ADDITIONAL MULTI-FAMILY INFORMATION IF APPLICABLE

# of efficiency units (MF):
# of 1 BR (MF):
# of 2 BR (MF):
# of 3 BR (MF):
Energy Method: Performance UA Alternative ERI A 90.1
Gross Area: sq ft
Occupiable Area: sq ft

AGREEMENT/ DISCLAIMER REQUIRED

THE UNDERSIGNED HEREBY CERTIFIES AND AGREES AS FOLLOWS: (1) THAT HE/SHE IS AUTHORIZED TO MAKE THIS APPLICATION; (2) THAT THE INFORMATION IS CORRECT; (3) THAT HE/SHE WILL COMPLY WITH ALL REGULATIONS OF HOWARD COUNTY WHICH ARE APPLICABLE THERETO; (4) THAT HE/SHE WILL PERFORM NO WORK ON THE ABOVE REFERENCED PROPERTY NOT SPECIFICALLY DESCRIBED IN THIS APPLICATION; (5) THAT HE/SHE GRANTS COUNTY OFFICIALS THE RIGHT TO ENTER ONTO THIS PROPERTY FOR THE PURPOSE OF INSPECTING THE WORK PERMITTED AND POSTING NOTICES

APPLICANT'S ORIGINAL SIGNATURE DATE SIGNED

FOR OFFICE USE ONLY

CHECKS PAYABLE TO: DIRECTOR OF FINANCE OF HOWARD COUNTY

AGENCIES REQUIRED/APPROVALS:
PR DPZ DED Health SHA CID
SUBMITTAL FEES: 2200.00 PAYMENT: 257.00 ACCEPTED BY: mail



322002204

May 19, 2022

Mr. Erick Plaza  
Diversified Rack & Shelving, Inc.  
603 Route 130 North  
East Windsor, NJ 08520

Dear Mr. Plaza:

The Chefs' Warehouse Mid Atlantic, LLC, dba Capital Seaboard, the tenant at 7540 Assateague Drive, Jessup, Maryland, is a distributor of produce, seafood, dairy, and specialty food products. The racking that we are proposing to have installed will be used primarily for dry specialty products, including but not limited to specialty spices, condiments, and cooking and baking products. A portion of the racking will be used to store packing materials, mainly cardboard boxes.

If you need additional information, please do not hesitate to contact me.

Sincerely,



Lawrence J. Quinn  
President

7540 Assateague Drive  
Jessup, MD 20794

443.755.1733

CapitalSeaboard.com  
ChefsWarehouse.com

NOTES:

1. ALL WORK SHALL CONFORM TO THE REQUIREMENTS OF THE 2018 INTERNATIONAL BUILDING CODE AND UNIFORM CONSTRUCTION CODE, STATE OF MARYLAND, LATEST EDITION.
2. NEW PALLET RACK STRUCTURES SHALL MEET THE REQUIREMENTS OF SECTION 2209 OF THE IBC CODE FOR SEISMIC COMPLIANCE.
3. ADEQUACY OF FLOOR SLAB TO SUPPORT THE SUPERIMPOSED LOADS OF THE RACK STRUCTURE IS THE RESPONSIBILITY OF OTHERS.
4. TUNNEL BAY BEAM LEVELS TO BE EQUIPPED WITH EITHER PALLET SAFETY SUPPORTS, MINIMUM OF TWO UNDER EVERY PALLET, OR WIRE DECKING TO PALLET/PRODUCT FALL-THRU.
5. ALL EXIT/EMERGENCY LIGHTS SHALL MEET THE REQUIREMENTS OF SECTION 1013 OF THE IBC CODE.
6. ALL EXIT DISCHARGE & EGRESS AISLE LIGHTING SHALL MEET THE REQUIREMENTS OF SECTION 1008 OF THE IBC CODE.
7. EGRESS STRIPED PATH MAY BE SHOWN ON DRAWING, BUT MAY NOT BE REQUIRED BY THE TOWNSHIP. ALL STRIPED PATHS SHALL MEET THE REQUIREMENTS OF SECTION 1005 OF THE IBC CODE AND SHALL BE KEPT FREE OF ALL OBSTRUCTIONS.
8. WHERE THERE ARE TWO EXIT LIGHTS THAT ARE ADJACENT TO EACH OTHER, ONLY ONE COMBINATION EXIT WITH EMERGENCY LIGHTING IS REQUIRED.
9. GENERAL WAREHOUSE LIGHTING WITH ALL HIGH INTENSITY LIGHTS MUST HAVE A TIME DELAY OFF FEATURE FOR THE EMERGENCY LIGHTS WIRED IN CONJUNCTION WITH THE H.I.D. WAREHOUSE LIGHTING CIRCUIT. IF RESTRIKE LIGHTS ARE USED WITH H.I.D. LIGHTING, THEN THE TIME DELAY FEATURE IS NOT NEEDED. SEE REQUIREMENTS OF THE 2017 N.E.C., ART. 700.12 & 700.16.
10. RACK SHELF ELEVATIONS ARE NOT TO BE ALTERED WITHOUT THE PRIOR CONSENT OF AN ENGINEER.

NOTE: SOME FIXTURES SHOWN IN THIS DRAWING MAY HAVE AN EXISTING FIXTURE IN THAT LOCATION OR VICINITY IN THE BUILDING THAT MAY BE OK AS IS OR RELOCATED. IT IS ASSUMED THAT EXTERIOR BUILDING WALL DOORS HAVE EXISTING EXITS.

- PROPOSED DOUBLE FACED EXIT/EMERGENCY LIGHT COMBINATION WITH BATTERY BACK-UP, MODEL GR1224MRUW2LD10 (LIGHTALARMS) OR EQUAL. DIRECTION ARROWS SHOWN ON PLAN. UNITS TO BE INSTALLED @ 14'-0" A.F.F. OR ABOVE, WHERE FORKLIFT TRAVEL IS UNDER EXIT/EMERGENCY LIGHT COMBINATION, UNLESS UNITS ARE WITHIN RACKING, MOUNT TO UNDERSIDE OF EGRESS PATH.
- HIGH INTENSITY EMERGENCY LIGHTING MOUNTED ON WALL OR UNDERSIDE OF BAR JOIST MODEL 2M1201SP/115GFM (LIGHTALARMS) OR EQUAL. LOCATION/QUANTITY ARE APPROX.

NOTE: FOR MAX. DESIGN LOADS PER LEVEL & BASE PLATE LOADS REFER TO CALCULATIONS OF AN ENGINEER.

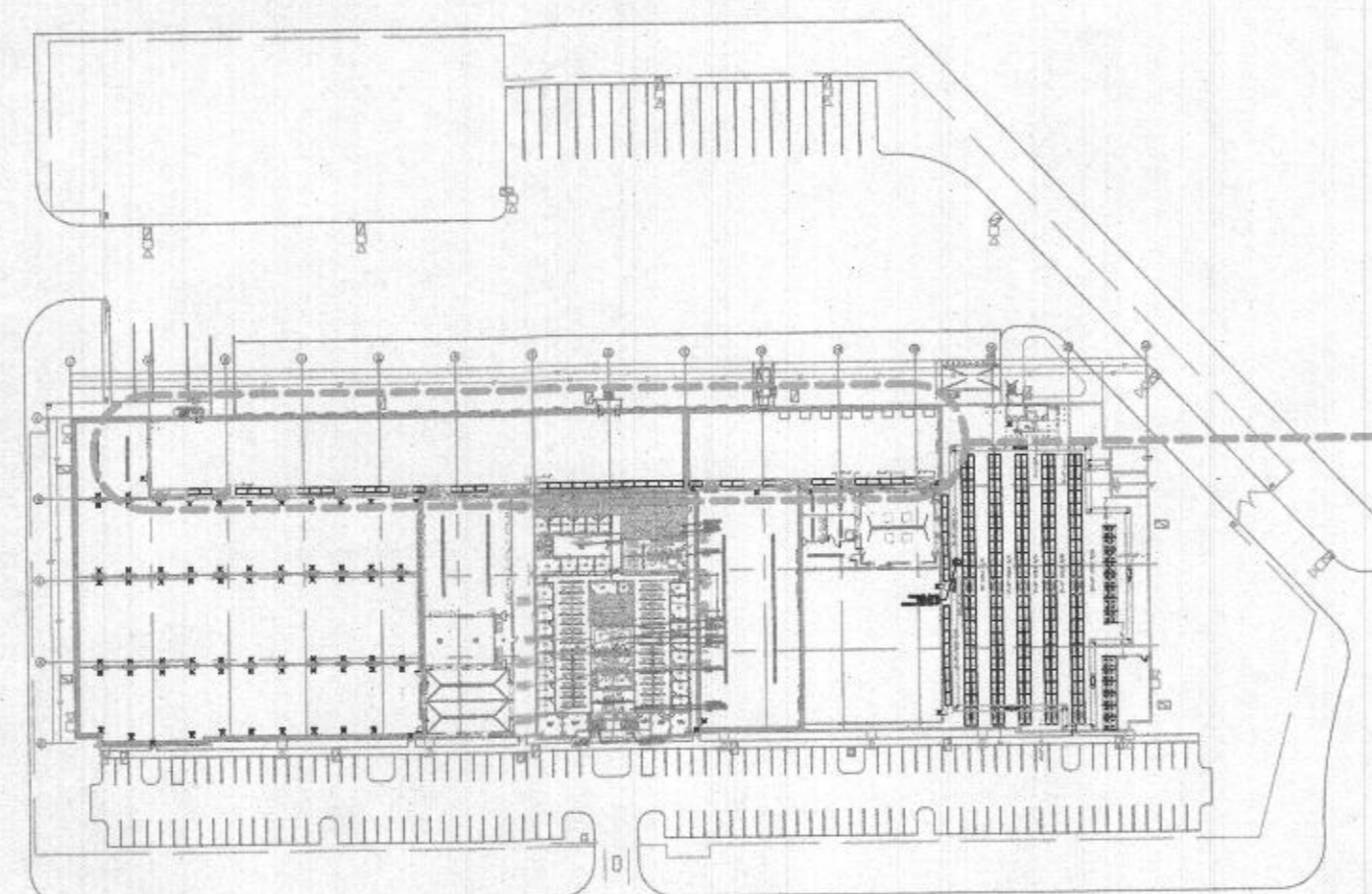

SITE PLAN  
SCALE: 1/128"=1'

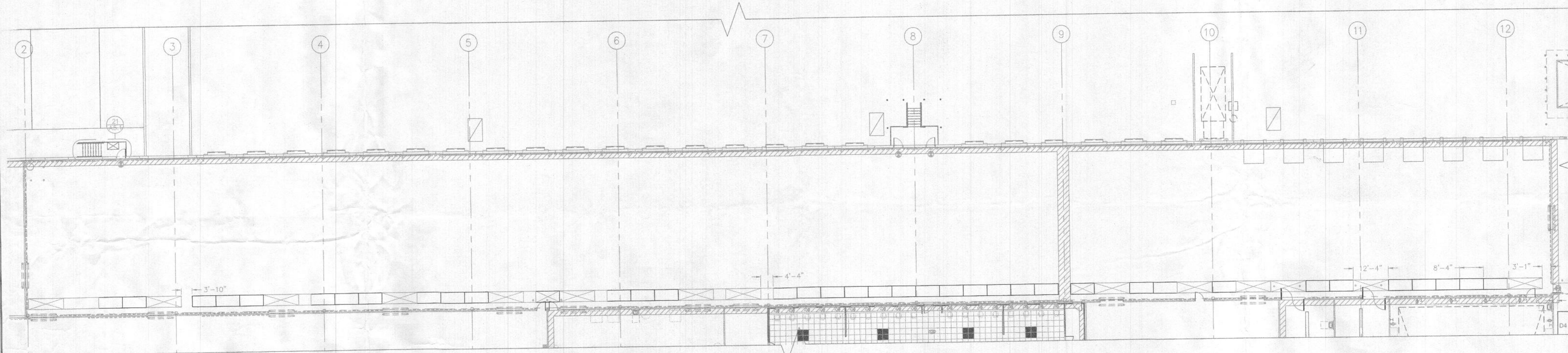
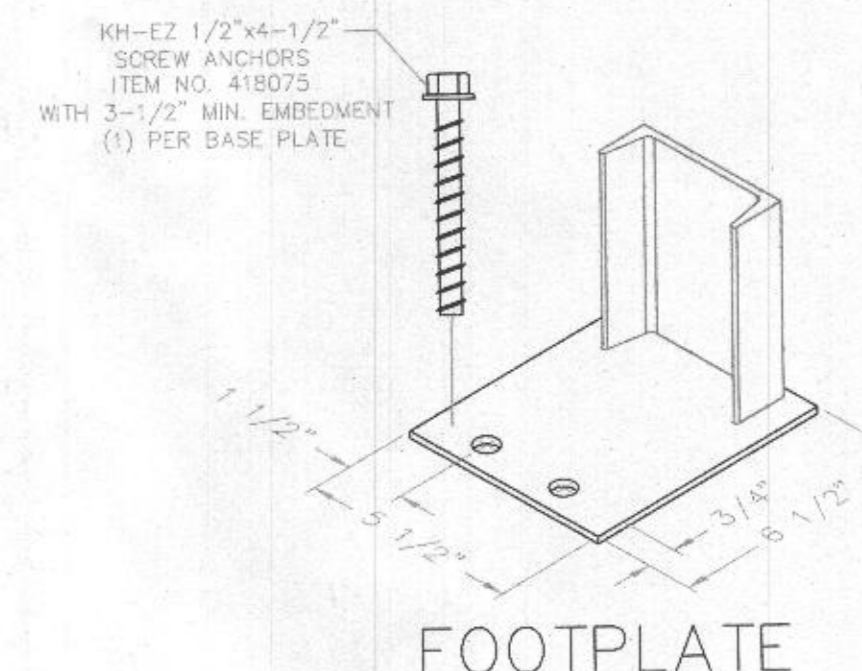

SUBJECT AREA - COLD DOCK  
SCALE: NTS

BAY COUNT  
(14) 12' TUNNELS  
(1) 12' BAY  
(36) 8' BAYS  
(2) 8' TUNNEL  
(5) 4' BAYS

ANDREW D. LEONE  
MARYLAND  
PROFESSIONAL ENGINEER  
LICENSE NO. 50002



STORAGE RACK  
STRUCTURAL REVIEW ONLY  
SHELVING EXCLUDED

This drawing is the property of Diversified Rack & Shelving Inc. and shall not be modified, reproduced or forwarded to anyone without the written consent of Diversified Rack & Shelving Inc. © 2018 - DIVERSIFIED RACK & SHELVING, INC.	
Date:	FINAL FOR APPROVAL
Block:	LOT:
FORK LIFT TYPE:	
LOAD DESCRIPTION -	
x	
SPRINKLER TYPE -	
SPRINKLER SYSTEM = XX OVER X000 (GPM)	(AREA)

ALL BAY WIDTHS ARE DIM. CENTER LINE TO CENTER LINE OF UPRIGHTS.

REV		DATE	DESCRIPTION	CHK.	APPD.	<b>DIVERSIFIED RACK &amp; SHELVING, INC.</b> 603 Rt. 130 North, East Windsor, NJ 08520 Phone (609)448-6262 Fax (609)448-6908		CUSTOMER: <b>THE CHEFS' WAREHOUSE</b> 7540 ASSATEAGUE DRIVE JESSUP, MD 20794	
CUSTOMER APPROVAL		DATE		DRAWN BY:		DATE:	CHK:	SCALE:	DWG. No.
				O.SANTOS		4/14/2022		AS NOTED	CHEFJEMD02

DWG. No. 1 OF 4

RECEIVED

JUN 06 2022  
LICENSES & PERMITS  
DIVISION

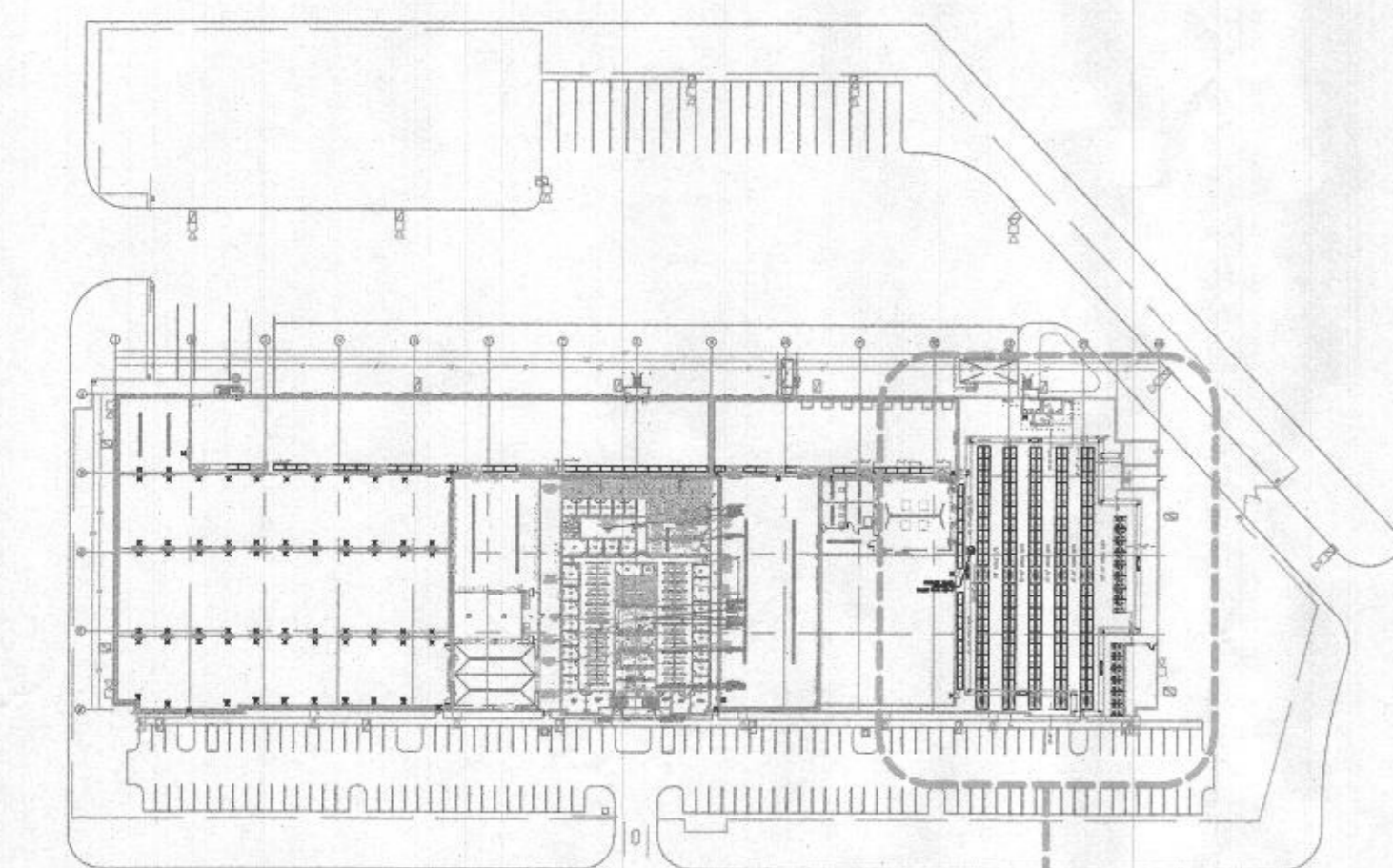

SITE PLAN  
SCALE: 1/128"=1'

SUBJECT AREA

KH-EZ 1/2"x4-1/2"  
SCREW ANCHORS  
ITEM NO. 41807S  
WITH 3-1/2" MIN. EMBEDMENT  
(1) PER BASE PLATE

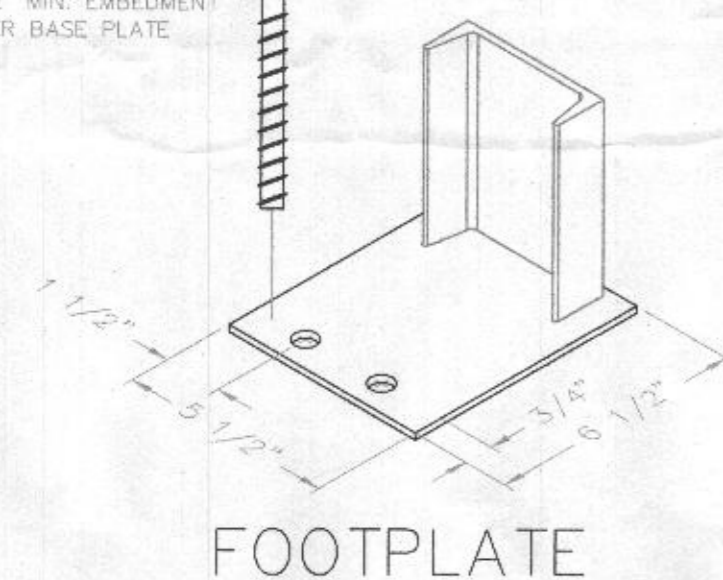

FOOTPLATE

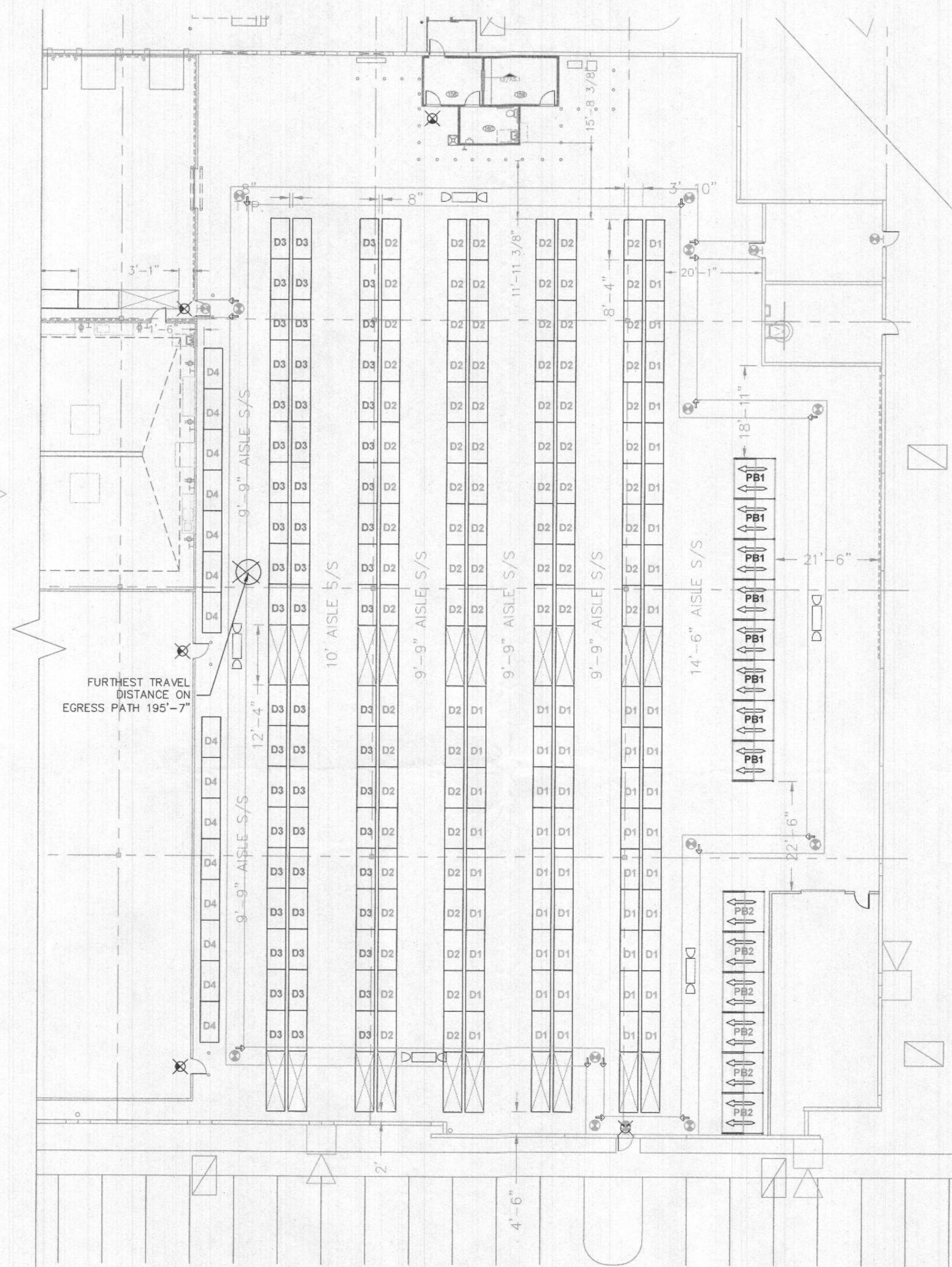

SUBJECT AREA - DRY STORAGE  
SCALE: 1/16"=1'

BAY COUNT  
(20) 12' TUNNELS  
(213) 8' BAYS  
(14) 2 DEEP PUSHBACK

- NOTES:
1. ALL WORK SHALL CONFORM TO THE REQUIREMENTS OF THE 2018 INTERNATIONAL BUILDING CODE AND UNIFORM CONSTRUCTION CODE, STATE OF MARYLAND, LATEST EDITION.
  2. NEW PALLET RACK STRUCTURES SHALL MEET THE REQUIREMENTS OF SECTION 2209 OF THE IBC CODE FOR SEISMIC COMPLIANCE.
  3. ADEQUACY OF FLOOR SLAB TO SUPPORT THE SUPERIMPOSED LOADS OF THE RACK STRUCTURE IS THE RESPONSIBILITY OF OTHERS.
  4. TUNNEL BAY BEAM LEVELS TO BE EQUIPPED WITH EITHER PALLET SAFETY SUPPORTS, MINIMUM OF TWO UNDER EVERY PALLET, OR WIRE DECKING TO PALLET/PRODUCT FALL-THRU.
  5. ALL EXIT/EMERGENCY LIGHTS SHALL MEET THE REQUIREMENTS OF SECTION 1013 OF THE IBC CODE.
  6. ALL EXIT DISCHARGE & EGRESS AISLE LIGHTING SHALL MEET THE REQUIREMENTS OF SECTION 1008 OF THE IBC CODE.
  7. EGRESS STRIPED PATH MAY BE SHOWN ON DRAWING, BUT MAY NOT BE REQUIRED BY THE TOWNSHIP. ALL STRIPED PATHS SHALL MEET THE REQUIREMENTS OF SECTION 1005 OF THE IBC CODE AND SHALL BE KEPT FREE OF ALL OBSTRUCTIONS.
  8. WHERE THERE ARE TWO EXIT LIGHTS THAT ARE ADJACENT TO EACH OTHER, ONLY ONE COMBINATION EXIT WITH EMERGENCY LIGHTING IS REQUIRED.
  9. GENERAL WAREHOUSE LIGHTING WITH ALL HIGH INTENSITY LIGHTS MUST HAVE A TIME DELAY OFF FEATURE FOR THE EMERGENCY LIGHTS WIRED IN CONJUNCTION WITH THE H.I.D. WAREHOUSE LIGHTING CIRCUIT. IF RESTRIKE LIGHTS ARE USED WITH H.I.D. LIGHTING, THEN THE TIME DELAY FEATURE IS NOT NEEDED. SEE REQUIREMENTS OF THE 2017 N.E.C., ART. 700.12 & 700.16.
  10. RACK SHELF ELEVATIONS ARE NOT TO BE ALTERED WITHOUT THE PRIOR CONSENT OF AN ENGINEER.

LEGEND:

— MINIMUM 44" WIDE, YELLOW STRIPED (4" WIDE STRIP) EMERGENCY EGRESS AISLE.

NOTE: SOME FIXTURES SHOWN IN THIS DRAWING MAY HAVE AN EXISTING FIXTURE IN THAT LOCATION OR VICINITY IN THE BUILDING THAT MAY BE OK AS IS OR RELOCATED. IT IS ASSUMED THAT EXTERIOR BUILDING WALL DOORS HAVE EXISTING EXITS.

— PROPOSED DOUBLE FACED EXIT/EMERGENCY LIGHT COMBINATION WITH BATTERY BACK-UP, MODEL GR1224MRUW2LD10 (LIGHTALARMS) OR EQUAL. DIRECTION ARROWS SHOWN ON PLAN. UNITS TO BE INSTALLED @ 14'-0" A.F.F. OR ABOVE, WHERE FORKLIFT TRAVEL IS UNDER EXIT/EMERGENCY LIGHT COMBINATION, UNLESS UNITS ARE WITHIN RACKING, MOUNT TO UNDERSIDE OF EGRESS PATH.

— HIGH INTENSITY EMERGENCY LIGHTING MOUNTED ON WALL OR UNDERSIDE OF BAR JOIST MODEL 2M12G1SP/L15GFM (LIG-TALARMS) OR EQUAL. LOCATION/QUANTITY ARE APPROX.

NOTE: FOR MAX. DESIGN LOADS PER LEVEL & BASE PLATE LOADS REFER TO CALCULATIONS

This drawing is the property of Diversified Rack & Shelving Inc. and shall not be modified, reproduced or forwarded to anyone without the written consent of Diversified Rack & Shelving Inc. © 2018 - DIVERSIFIED RACK & SHELVING, INC.

Date:	FINAL FOR APPROVAL
BLOCK:	LOT:
FORK LIFT TYPE:	LIFT HEIGHT:
LOAD DESCRIPTION -	x
SPRINKLER TYPE -	SPRINKLER SYSTEM = XX OVER X000 (GPM) (AREA)

ALL BAY WIDTHS ARE DIM. CENTER LINE TO CENTER LINE OF UPRIGHTS.

REV	DATE	DESCRIPTION	CHK.	APPD.

CUSTOMER APPROVAL DATE

**DIVERSIFIED RACK & SHELVING, INC.**  
603 Rt. 130 North, East Windsor, NJ 08520  
Phone (609)448-6262 Fax (609)448-6908

CUSTOMER: THE CHEFS' WAREHOUSE  
7540 ASSATEAGUE DRIVE JESSUP, MD 20794

DRAWN BY: O.SANTOS DATE: 4/14/2022

SCALE: AS NOTED DWG. No. CHEFJEMD02

ANDREW D. LEONE  
MARYLAND  
PROFESSIONAL ENGINEER  
LICENSE NO. 50002



STORAGE RACK  
STRUCTURAL REVIEW ONLY  
SHELVING EXCLUDED  
PROPOSED EGRESS PATH

ELEVATIONS  
SCALE: 1/4"=1'

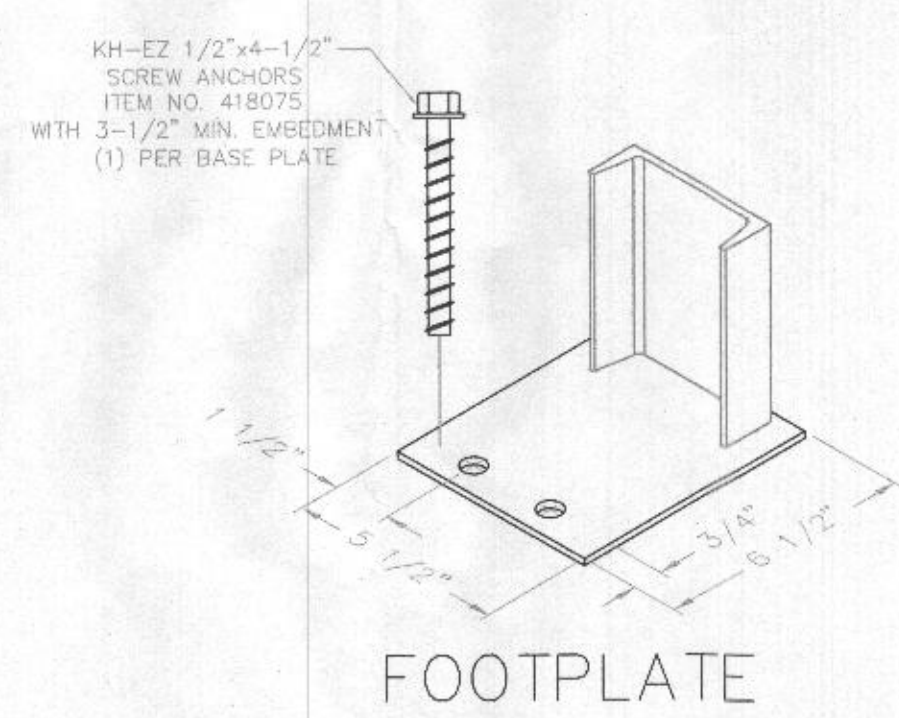
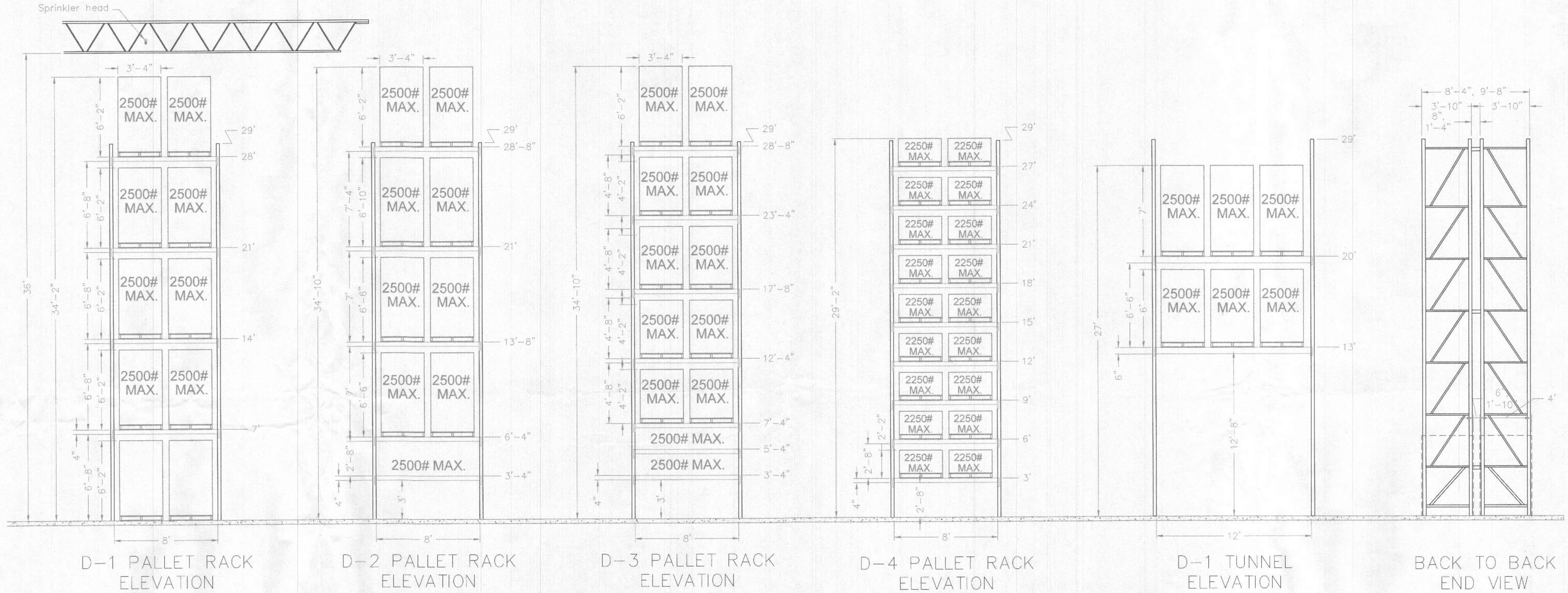

This drawing is the property of Diversified Rack & Shelving Inc. and shall not be modified, reproduced or forwarded to anyone without the written consent of Diversified Rack & Shelving Inc. © 2019 - DIVERSIFIED RACK & SHELVING, INC.

Date: FINAL FOR APPROVAL  
BLOCK: LOT:  
FORK LIFT TYPE:  
LIFT HEIGHT:  
LOAD DESCRIPTION -  
x  
SPRINKLER TYPE -  
SPRINKLER SYSTEM = XX OVER X000 (CPM) (AREA)

REV		DATE	DESCRIPTION	CHK.	APPD.	<b>DIVERSIFIED RACK &amp; SHELVING, INC.</b> 603 Rt. 130 North, East Windsor, NJ 08520 Phone (609)448-6262 Fax (609)448-6908		CUSTOMER: <b>THE CHEFS' WAREHOUSE</b> 7540 ASSATEAGUE DRIVE JESSUP, MD 20794	
CUSTOMER APPROVAL			DATE	DRAWN BY: O.SANTOS		DATE: 4/14/2022	CHK:	SCALE: AS NOTED	DWG. No. CHEFJEMD02

ANDREW D. LEONE  
MARYLAND  
PROFESSIONAL ENGINEER  
LICENSE NO. 50002



STORAGE RACK  
STRUCTURAL REVIEW ONLY  
SHELVING EXCLUDED

DWG. No. 3 OF 4

ELEVATIONS  
SCALE: 1/4" = 1'

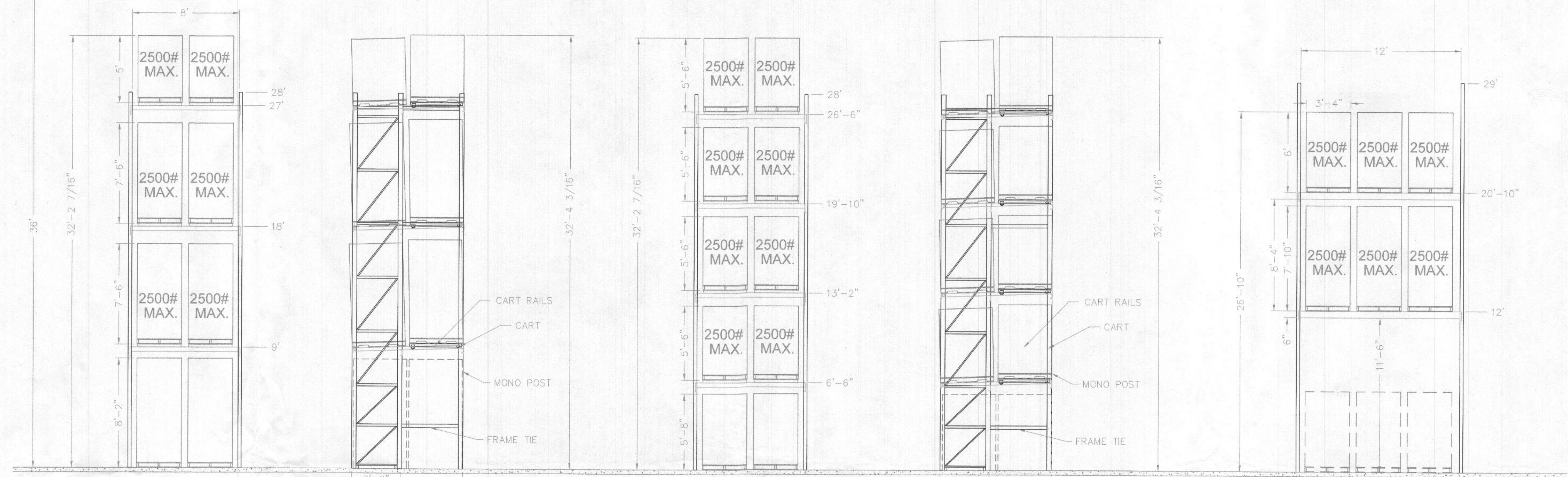
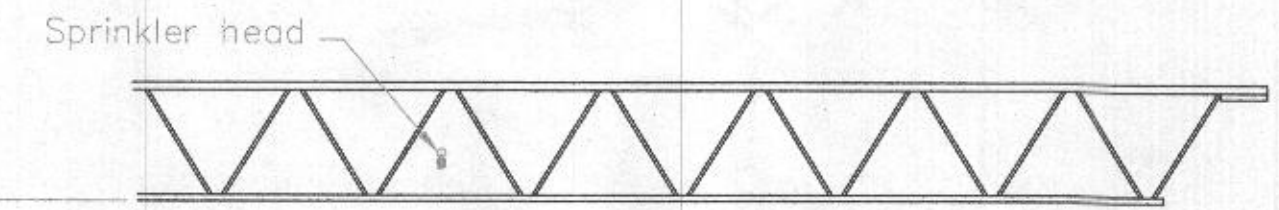

D-1 PUSHBACK RACK  
ELEVATION

SIDE VIEW

D-2 PUSHBACK RACK  
ELEVATION

SIDE VIEW

CD-1 PALLET RACK  
ELEVATION

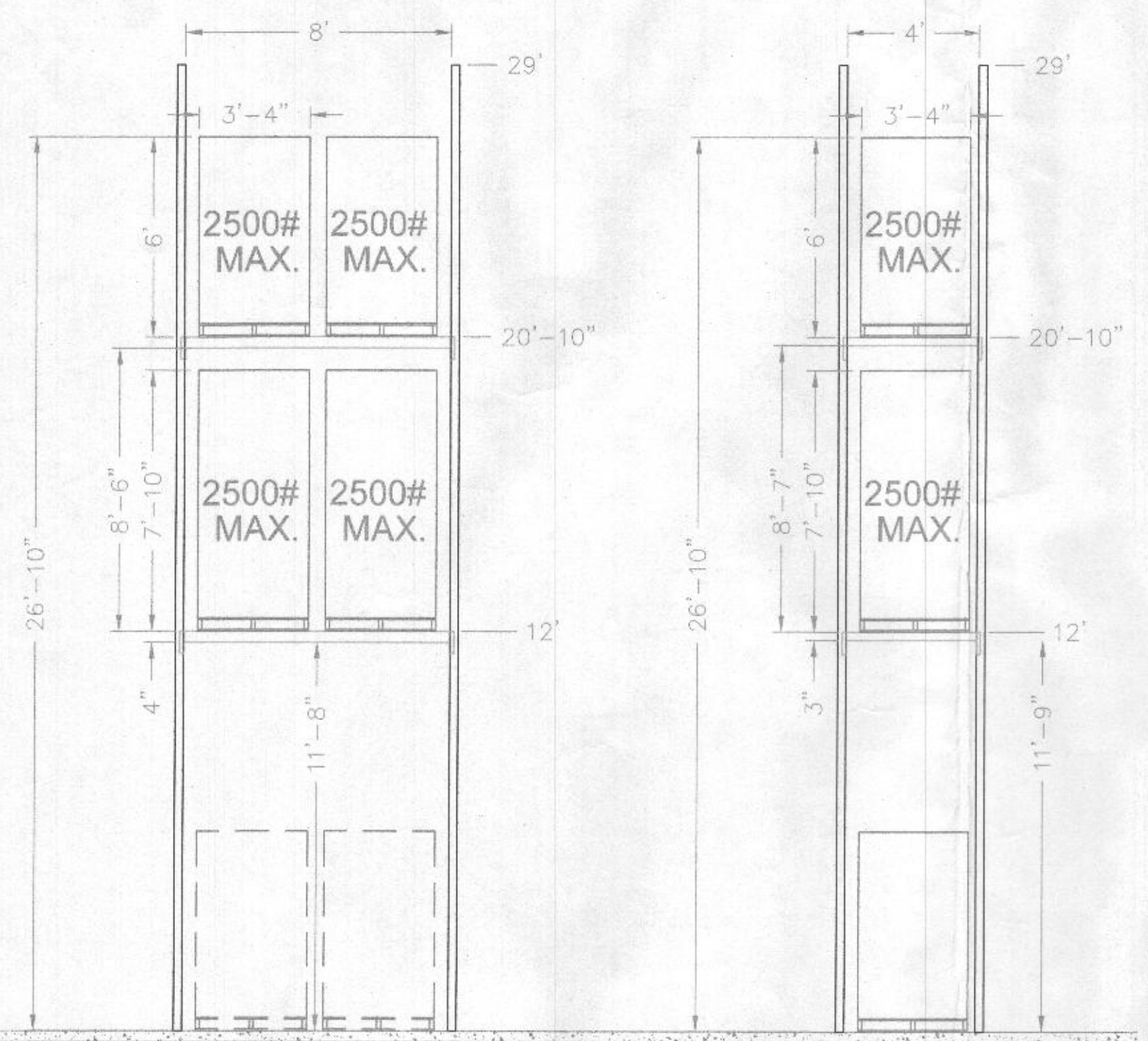

CD-1 PALLET RACK  
ELEVATION

KH-EZ 1/2"x4-1/2"  
SCREW ANCHORS  
ITEM NO. 418075  
WITH 3-1/2" MIN. EMBEDMENT  
(1) PER BASE PLATE

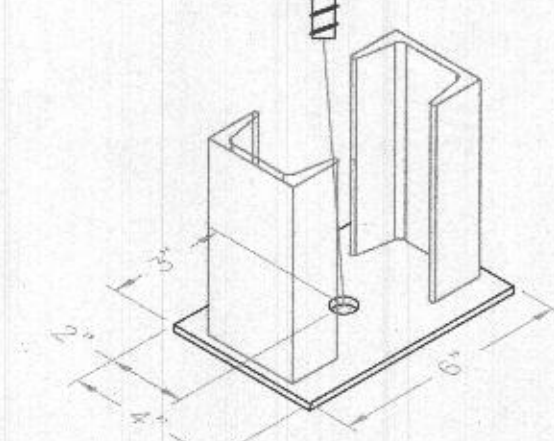

PUSHBACK  
FOOTPLATE

KH-EZ 1/2"x4-1/2"  
SCREW ANCHORS  
ITEM NO. 418075  
WITH 3-1/2" MIN. EMBEDMENT  
(1) PER BASE PLATE

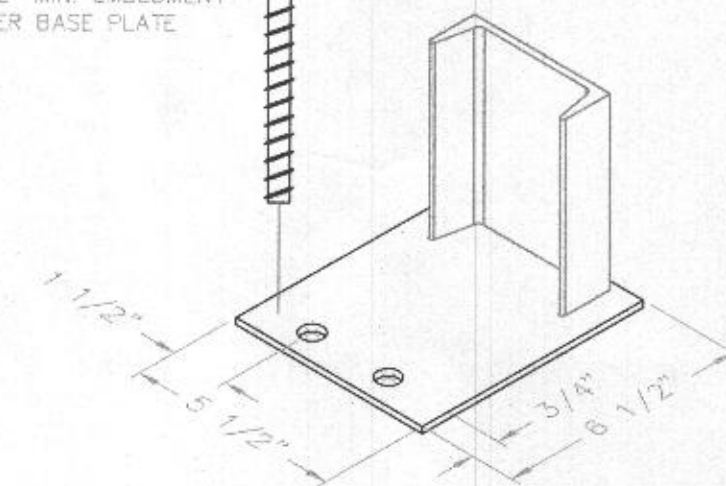

SELECT RACK FOOTPLATE

This drawing is considered preliminary until finalized & dated.  
This drawing is the property of Diversified Rack & Shelving Inc. and shall not be modified, reproduced or forwarded to anyone without the written consent of Diversified Rack & Shelving Inc. © 2010 - DIVERSIFIED RACK & SHELVING, INC.

Date:	FINAL FOR APPROVAL
BLOCK:	LOT:
FORK LIFT TYPE:	
LIFT HEIGHT:	
LOAD DESCRIPTION -	x
SPRINKLER TYPE -	
SPRINKLER SYSTEM = XX OVER X000 (CPM)	(AREA)

REV	DATE	DESCRIPTION	CHK.	APPD.

**DIVERSIFIED RACK & SHELVING, INC.**  
603 Rt. 130 North, East Windsor, NJ 08520  
Phone (609)448-6262 Fax (609)448-6908

CUSTOMER:  
**THE CHEFS' WAREHOUSE**  
7540 ASSATEAGUE DRIVE JESSUP, MD 20794

SCALE: AS NOTED  
DWG. No. CHEFJEMD02

ANDREW D. LEONE  
MARYLAND  
PROFESSIONAL ENGINEER  
LICENSE NO. 50002



STORAGE RACK  
STRUCTURAL REVIEW ONLY  
SHELVING EXCLUDED  
PROPOSED EGRESS PATH