

HOWARD COUNTY  
PERMIT APPLICATION

PERMIT NUMBER

B00159244

Building Address 3609 Sycamore Valley Run  
Woodbine Md. 21738

Property Owner's Name Andy + Melissa Wilson

Address same

Suite/Apt. #: \_\_\_\_\_ SDP/WP/Petition #: \_\_\_\_\_

Census Tract \_\_\_\_\_ Subdivision Cattail Creek

City \_\_\_\_\_ State \_\_\_\_\_ Zip Code \_\_\_\_\_

Section \_\_\_\_\_ Area \_\_\_\_\_ Lot 49

Home Phone \_\_\_\_\_ Work Phone 410 345 6104

Tax Map \_\_\_\_\_ Parcel \_\_\_\_\_ Grid \_\_\_\_\_

Applicant's Name & Mailing Address, (if other than stated hereon):

Zoning \_\_\_\_\_ Map Coordinates \_\_\_\_\_ Lot size \_\_\_\_\_

Phone 301 674 9785 Fax \_\_\_\_\_

Existing Use \_\_\_\_\_

Contractor Company Town Creek Inc.

Proposed Use \_\_\_\_\_

Contact Person Steve Cooley

Estimated Construction Cost \$ 5500.00

Address 5010 Shepard Ln

Description of Work Deck, walkway  
5x16, 5x23, 8x12 connected  
to house. Approximately 300 sq ft  
with handrails.

City Ellicott City State Md Zip Code \_\_\_\_\_

License No. 44984  
Phone 301 854 3510 Fax 410 531 6574

Occupant or Tenant Andy + Melissa Wilson

Engineer or Architect Company \_\_\_\_\_

Contact Name \_\_\_\_\_

Contact Person \_\_\_\_\_

Address \_\_\_\_\_

Address \_\_\_\_\_

City \_\_\_\_\_ State \_\_\_\_\_ Zip Code \_\_\_\_\_

City \_\_\_\_\_ State \_\_\_\_\_ Zip Code \_\_\_\_\_

Phone \_\_\_\_\_ Fax \_\_\_\_\_

Phone \_\_\_\_\_ Fax \_\_\_\_\_

BUILDING DESCRIPTION - COMMERCIAL

BUILDING DESCRIPTION - RESIDENTIAL

Building Characteristics	Utilities
Height: _____	Water Supply: <input type="checkbox"/> Public <input checked="" type="checkbox"/> Private
No. of stories: _____	Sewage Disposal: <input type="checkbox"/> Public <input checked="" type="checkbox"/> Private
Gross area, sq. ft. per floor: _____	Electric Yes <input type="checkbox"/> No <input type="checkbox"/> Gas Yes <input type="checkbox"/> No <input type="checkbox"/>
Use group: _____	Heating System: Electric <input type="checkbox"/> Oil <input type="checkbox"/> Natural Gas <input type="checkbox"/> Propane Gas <input type="checkbox"/>
Construction type: <input type="checkbox"/> Reinforced Concrete <input type="checkbox"/> Structural Steel <input type="checkbox"/> Masonry <input type="checkbox"/> Wood Frame <input type="checkbox"/> State Certified Modular	Sprinkler system: N/A <input type="checkbox"/> <input type="checkbox"/> Full <input type="checkbox"/> Partial <input type="checkbox"/> Other Suppression <input type="checkbox"/> # of Heads

Building Characteristics	Utilities
SF Dwelling <input type="checkbox"/> SF Townhouse <input type="checkbox"/> 1st floor: _____ 2nd floor: _____ Basement: _____ Finished Basement <input type="checkbox"/> Unfinished Basement <input type="checkbox"/> Crawl space <input type="checkbox"/> Slab on Grade <input type="checkbox"/> No. of Bedrooms: _____ Height: _____ Multi-family dwellings: No. of efficiency units: _____ No. of 1 BR units: _____ No. of 2 BR units: _____ No. of 3 BR units: _____ Other Structure: _____ Dimensions: _____ Footings: _____ Roof Height: _____ <input type="checkbox"/> State Certified Modular <input type="checkbox"/> Manufactured Home	Water Supply: <input type="checkbox"/> Public <input checked="" type="checkbox"/> Private Sewage Disposal: <input type="checkbox"/> Public <input checked="" type="checkbox"/> Private Electric Yes <input type="checkbox"/> No <input type="checkbox"/> Gas Yes <input type="checkbox"/> No <input type="checkbox"/> Heating System: Electric <input type="checkbox"/> Oil <input type="checkbox"/> Natural Gas <input type="checkbox"/> Propane Gas <input type="checkbox"/> Sprinkler system: N/A <input type="checkbox"/> <input type="checkbox"/> NFPA #13D <input type="checkbox"/> NFPA #13R <input type="checkbox"/> Other:

THE UNDERSIGNED HEREBY CERTIFIES AND AGREES AS FOLLOWS: (1) THAT HE/SHE IS AUTHORIZED TO MAKE THIS APPLICATION, (2) THAT THE INFORMATION IS CORRECT, (3) THAT HE/SHE WILL COMPLY WITH ALL REGULATIONS OF HOWARD COUNTY WHICH ARE APPLICABLE THERE TO; (4) THAT HE/SHE WILL PERFORM NO WORK ON THE ABOVE REFERENCED PROPERTY NOT SPECIFICALLY DESCRIBED IN THIS APPLICATION; (5) THAT HE/SHE GRANTS COUNTY OFFICIALS THE RIGHT TO ENTER ONTO THIS PROPERTY FOR THE PURPOSE OF INSPECTING THE WORK PERMITTED AND POSTING NOTICES.

Steve H. Cooley  
Applicant's Signature

Steven H. Cooley  
Print Name

Title/Company \_\_\_\_\_

Date 4-27-2006

Checks payable to: **DIRECTOR OF FINANCE OF HOWARD COUNTY**

\*\* PLEASE WRITE NEATLY AND LEGIBLY. \*\*

- FOR OFFICE USE ONLY -

AGENCY	DATE	SIGNATURE APPROVAL
Land Development, DPZ		
State Highways		
Building Official		
Dev. Engineering, DPZ		
Health	<u>4/27/06</u>	<u>[Signature]</u>
Fire Protection		

Is Sediment Control approval required prior to issuance?  
YES  NO

CONTINGENCY CONSTRUCTION START:   
ONE STOP SHOP:

DPZ SETBACK INFORMATION	PROPERTY ID#:
Front: _____	Filing fee \$ _____
Rear: _____	Permit fee \$ _____
Side: _____	Excise tax \$ _____
Side St.: _____	Add'l per. fee \$ _____
All minimum setbacks met? YES <input type="checkbox"/> NO <input type="checkbox"/>	TOTAL FEES \$ _____
Is Entrance Permit required? YES <input type="checkbox"/> NO <input type="checkbox"/>	Sub-total paid \$ _____
Historic District? YES <input type="checkbox"/> NO <input type="checkbox"/>	Balance due \$ _____
Lot Coverage for NewTown Zone _____	Check # _____
SDP/Red-line approval date _____	Validation # _____

Distribution of Copies- White: Building Official Green: LDD, DPZ

Yellow: DED, DPZ Pink: Health Gold: SHA

T:\Norms\PERMIT.FRM

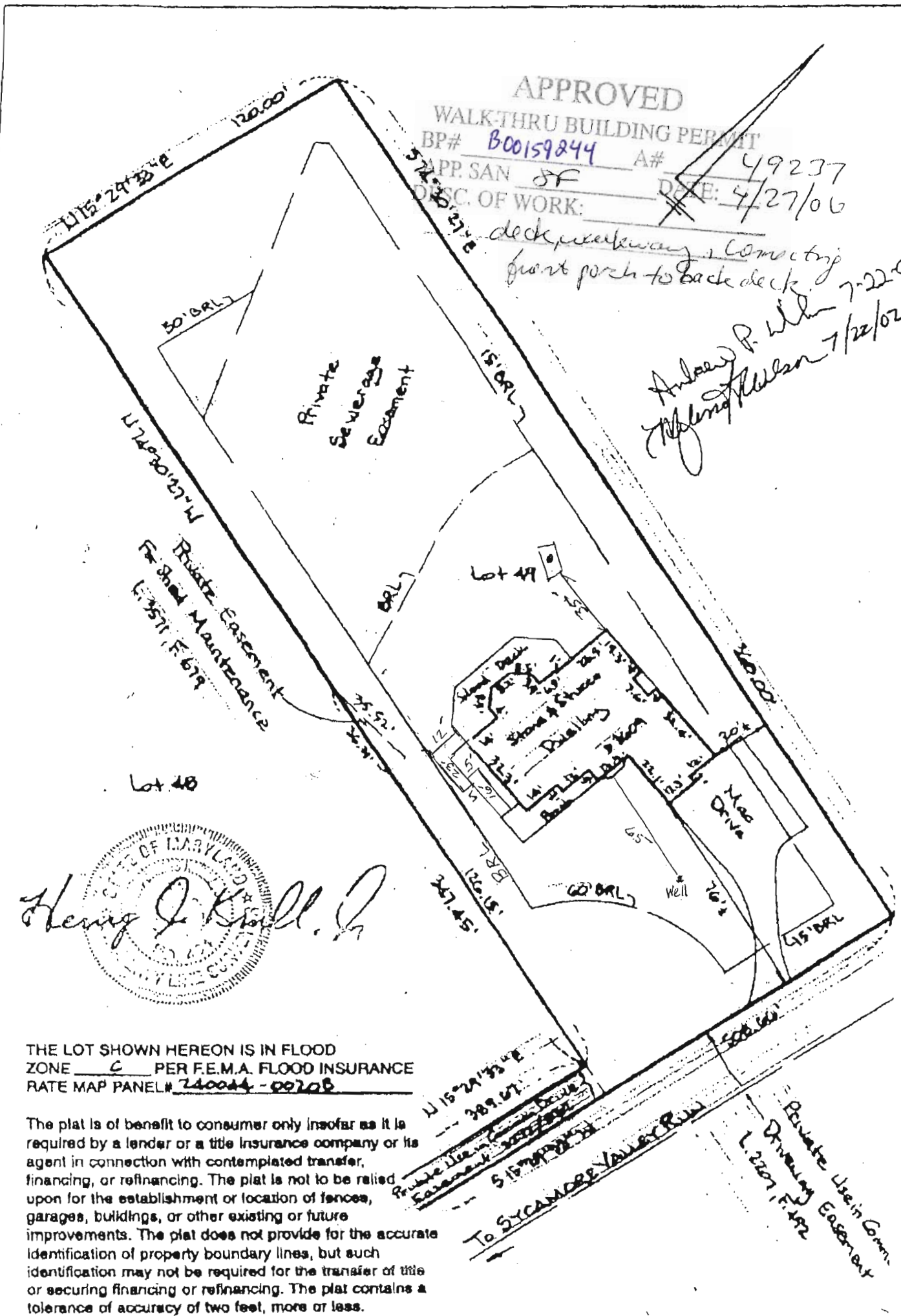

Ertel Associates, Inc.

8425 Hallmark Circle  
Baltimore, Maryland 21234  
Phone: 410-882-0989 • Fax: 410-882-0842

LOCATION DRAWING

# 3608 SYCAMORE VALLEY RUN, LOT 4  
"CAPTAIN CREEK COUNTRY CLUB, LOTS 48, 49,  
PARCEL A" HOWARD CO., MD. PLAT MDR 1164

DATE: 6/23/02	SCALE: 1"=40'	FILE: 02-9765
---------------	---------------	---------------