

Approved 5/4/22  
-HC

Record Detail \* (This section is required.)

<b>Permit Type</b>	<b>Permit Number</b>	<b>Opened Date</b>
Building/Residential/Misc/Deck	B22001616	04/26/2022
<b>Description of Work</b>		
SFD/ REMOVE EXISTING DECK AND REPLACE WITH A 26' X 16' OPEN WOOD DECK, 4' X 4' LANDING, AND STEPS		

[check spelling](#)

Address \* (This section is required.)

Search    Reset    Clear    Get Parcel & Owner

<b>Street #</b>	<b>Street Name</b>	<b>Street Type</b>	
8517	BEAUFORT	DR	
<b>Unit Type</b>	<b>Unit #</b>	<b>X Coordinate</b>	<b>Y Coordinate</b>
--Select--		-76.9411	39.13741
<b>City</b>	<b>State</b>	<b>Zip Code</b>	<b>Primary</b>
FULTON	MD	20759	Yes

Parcel \* (This section is required.)

Search    Reset    Clear    Get Address & Owner

<b>GIS ID *</b>	<b>Parcel</b>	<b>Parcel Area</b>	<b>Land Value</b>	<b>Improved Value</b>	<b>Exemption Value</b>	<b>Plan Area</b>
838701		42732	250800	558800	308000	RURAL
<b>Legal Description</b>						
IMPSLOT 2 BL E PLAT 2[ ]8514 BEAUFORT DR[ ]BEAUFORT DRIVE						

[check spelling](#)

<b>Block</b>	<b>Lot</b>	<b>Census Tract</b>	<b>Council Dist</b>	<b>Inspection Dist</b>	<b>Supervisor Dist</b>	<b>Map #</b>	<b>DAP Zone</b>
		605102	5				
<b>Plan Area</b>	<b>State Tax Id</b>	<b>Subdivision Name</b>					
	1405344034						
<b>Section</b>	<b>Area</b>	<b>Tax Map</b>					
		45					
<b>Grid</b>	<b>Zoning District</b>	<b>ADC Map</b>					
45-12	RR-DEO	5051-K9					
<b>SDP No.</b>	<b>Final Plan No.</b>	<b>WP File No.</b>					
<b>Record Plat No.</b>	<b>WS Contract No.</b>	<b>FDP No.</b>	<b>Primary</b>				
			Yes				
<b>Owner Occupied</b>	<b>Year Built</b>	<b>Historic District</b>					
<input type="radio"/> Yes <input type="radio"/> No	1980	<input type="radio"/> Yes <input checked="" type="radio"/> No					
<b>Historic District Registry No.</b>	<b>Stat Area</b>	<b>Flood Plain</b>					
	5-17A	<input type="radio"/> Yes <input checked="" type="radio"/> No					
<b>Building No</b>							

Owner \* (This section is required.)

Search    Reset    Clear

**Name \***  
MARC KALL

**Address Line 1**  
8517 BEAUFORT DR

**Address Line 2**

**Address Line 3**

<b>Mail City</b>	<b>Mail State</b>	<b>Mail Zip Code</b>
FULTON	MD	20759
<b>Phone</b>	<b>Primary</b>	
410-707-9209	Yes	
<b>E-mail</b>		
<b>Cell Number</b>	<b>Fax Number</b>	

**Professionals** (This section is not required.)

Search      Reset      Clear

<b>License # *</b> 08050009615-01	<b>Business Name</b> LONG FENCE COMPANY INCORPORATED		
<b>License Type *</b> MHIC Co	<b>First Name</b> MICHAEL	<b>Middle Name</b> J	<b>Last Name</b> RITTER
<b>Primary</b> Yes	<b>Address Line 1</b> 1910 BETSON COURT		
	<b>Address Line 2</b>		
	<b>City</b> ODENTON	<b>State</b> MD	<b>ZIP Code</b> 21113-1124
	<b>Phone 1</b> 3013502400	<b>Phone 2</b>	<b>Fax</b> 3013360743
	<b>E-mail</b> TCUNNINGHAM@LONGFENCE.COM		

**Applicant** (This section is not required.)

Search      As Owner      As Lic. Prof      As Contact

<b>Type *</b> Applicant	<b>First Name</b> STEVE	<b>MI</b>	<b>Last Name</b> BOWERS
<b>Relationship</b> Applicant	<b>Full Name</b> STEVE BOWERS		
<b>Primary</b> Yes	<b>Organization Name</b>		
	<b>Street Address</b> 7 HAYMARKET CRT		
	<b>Address Line 2</b>		
	<b>City</b> BALTIMORE	<b>State</b> MD	<b>Zip Code</b> 21236
	<b>Phone</b> 410-227-9843	<b>Cell</b> 410-227-9843	<b>Fax</b>
	<b>E-mail *</b> MRDECKSM@HOTMAIL.COM		

**Addtl Info**

<b>Est Construction Cost *</b> 48000	<b>Housing Units *</b> 0	<b>Number of Buildings *</b> 0	<b>Public Owned</b> No
<b>Construction Type</b> 434 - Additions, Alterations and Conversions - Residential			

**MISC PERMIT INFO**

**MISCELLANEOUS PERMIT INFORMATION**

<b>Capital Project-No Fee *</b> <input type="radio"/> Yes <input checked="" type="radio"/> No	<b>Capital Project Number</b> <input type="text"/>	<b>Fee Exempt *</b> <input type="radio"/> Yes <input checked="" type="radio"/> No	<b>Roadside Tree Project Permit *</b> <input type="radio"/> Yes <input checked="" type="radio"/> No	<b>Roadside Tree Project Permit #</b> <input type="text"/>
<b>Existing Use *</b> SFD	<b>Water</b> Private	<b>Sewage</b> Private	<b>Expiration Date</b> 10/24/2022	<input type="text"/>

**PAYMENT INFORMATION**

<b>Check 1</b> <input type="text"/>	<b>Payee 1</b> <input type="text"/>	<b>Check 2</b> <input type="text"/>	<b>Payee 2</b> <input type="text"/>	<b>SAP Doc No</b> <input type="text"/>	<b>SAP Entered</b> <input type="text"/>
--	--	--	--	---	--

Submit      Cancel

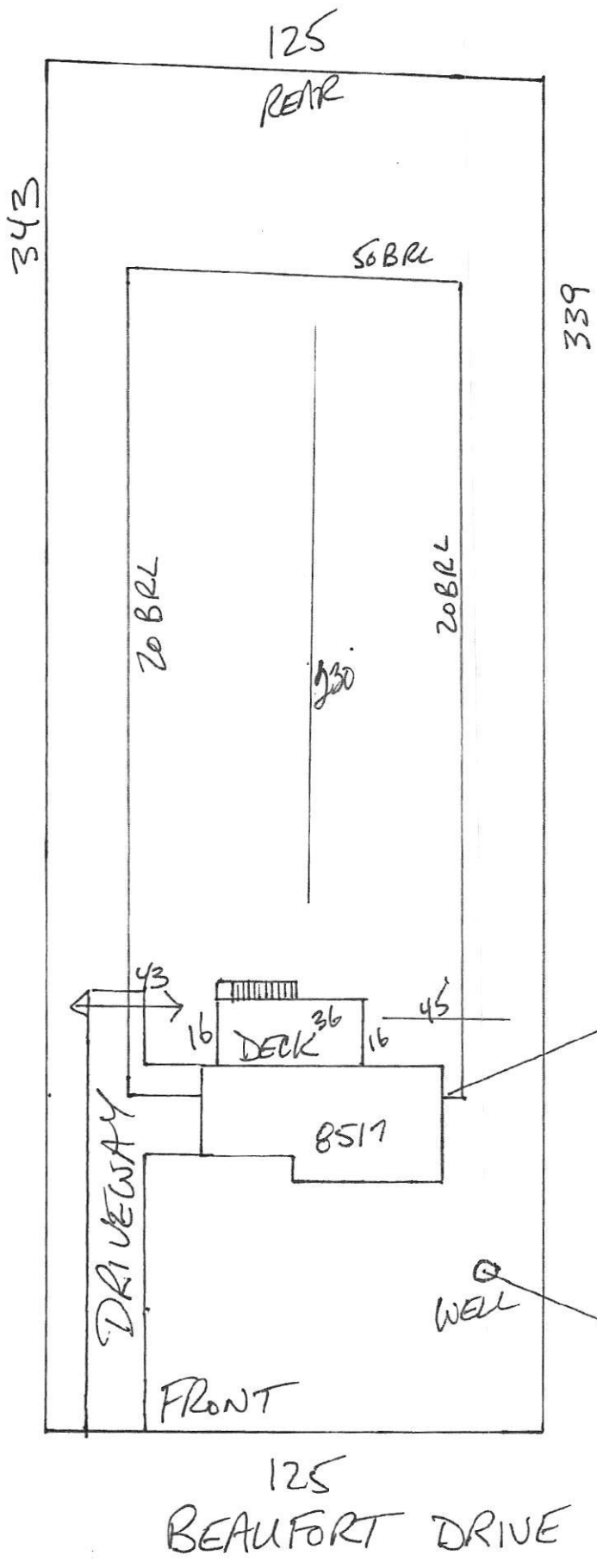

8517 BEAUFORT DRIVE  
 FULTON MD 20759  
 1" = 40'

LAYOUT 12/20/2005 INSP 4 \_\_\_\_\_  
 INSP 2 12/21/2005 INSP 5 \_\_\_\_\_  
 INSP 3 12/22/2005 INSP 6 \_\_\_\_\_

ISSUE DATE: 11/17/05  
 APPROVAL DATE: 10/10/06

# PERMIT

P 523689  
 A UPGRADE 09901

TAX ID # **05-344034**

**ON-SITE SEWAGE DISPOSAL SYSTEM  
 HOWARD COUNTY HEALTH DEPARTMENT  
 BUREAU OF ENVIRONMENTAL HEALTH**

Fogles Septic Clean, Inc. IS PERMITTED TO INSTALL  ALTER

ADDRESS: 580 Obrecht Rd., Sykesville 21784 PHONE NUMBER: 410-795-5670

SUBDIVISION: Beaufort Park LOT NUMBER: 2

ADDRESS: 8517 Beaufort Drive PROPERTY OWNER: Marlene Brescia

SEPTIC TANK CAPACITY (GALLONS): 1500 OUTLET BAFFLE FILTER REQUIRED   
**MICROFAST 0.75 TREATMENT SYSTEM**

PUMP CHAMBER CAPACITY (GALLONS) N/A COMPARTMENTED TANK REQUIRED

NUMBER OF BEDROOMS: 5

SQUARE FEET PER BEDROOM: 180

LINEAR FEET OF TRENCH REQUIRED: shared HOUSE SERVED BY PUBLIC WATER

TRENCHES:	Lot 2 will have a nitrogen pretreatment on the existing septic system with a MicroFast 0.75 Pretreatment along with the force main & trenches for lot #9 to be installed prior to building permit approval for lot #9.
LOCATION:	Pump and collapse old septic tank, place new septic tank with MicoFast 0.75 unit outside of well radii.
NOTES:	Purpose of permit is to upgrade septic system for lot 2 prior to building permit approval for lot 9 to create a perpetual septic easement between lot 2 & 9.

PLANS APPROVED: Sara Fegel Reviewed by: Gabe Creighton DATE: 11/18/05

NOTES: PERMIT VOID AFTER 2 YEARS  
 CONTRACTOR IS RESPONSIBLE FOR SCHEDULING A PRE-CONSTRUCTION INSPECTION FOR ALL INSTALLATIONS  
 WATERTIGHT SEPTIC TANKS REQUIRED  
 ALL PARTS OF SEPTIC SYSTEM SHALL BE 100 FEET FROM ANY WATER WELL UNLESS SPECIFICALLY AUTHORIZED  
 MANHOLE RISERS REQUIRED ON ALL SEPTIC TANKS AND PUMP CHAMBERS UNLESS SPECIFICALLY AUTHORIZED  
 CONTRACTOR RESPONSIBLE FOR COMPLIANCE WITH APPLICABLE REGULATIONS, GUIDELINES AND THE TERMS OF THIS PERMIT

**NEITHER THE HOWARD COUNTY COUNCIL NOR THE HEALTH DEPARTMENT IS  
 RESPONSIBLE FOR THE SUCCESSFUL OPERATION OF ANY SYSTEM  
 PERMITTEE RESPONSIBLE FOR OBTAINING FINAL APPROVAL ON THIS PERMIT  
 ALL 410-313-1771 FOR INSPECTION OF SEPTIC SYSTEM**

NOT TO SCALE

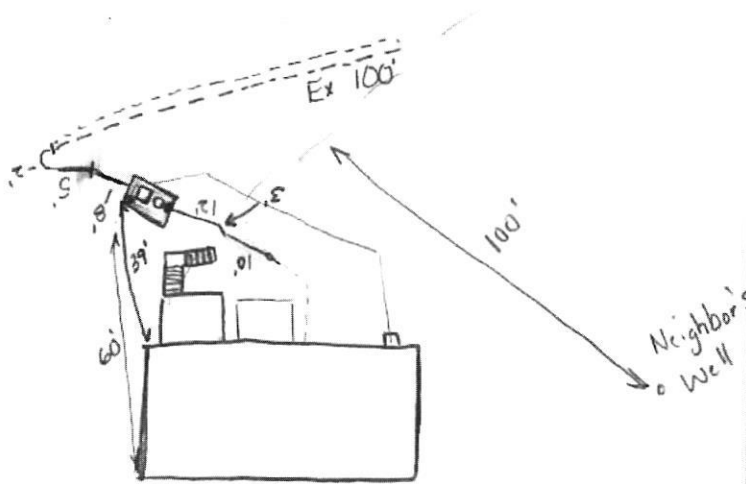

TRENCH/DRAINFIELD DATA		
WIDTH	INLET	BOTTOM
_____	_____	_____
NUMBER OF TRENCHES _____		
TOTAL LENGTH _____		
ABSORPTION AREA _____		
DISTRIBUTION BOX LEVEL _____		
DISTRIBUTION BOX BAFFLE _____		
DISTRIBUTION BOX PORT _____		

SEPTIC TANK DATA	
SEPTIC TANK 1 LEVEL _____	
w/	CAPACITY <u>1500</u> GAL
Micro	SEAM LOC <u>Top</u>
fast	TANK LID DEPTH <u>2-2 1/2'</u>
.75	BAFFLES <u>yes</u>
unit	BAFFLE FILTER <u>No</u>
	MANHOLE LOC <u>Mid Inlet</u>
	<u>8"</u> PORT LOC <u>Inlet &amp; Outlet</u>
	WATERTIGHT TEST <u>No</u>
SEPTIC TANK 2 LEVEL _____	
	CAPACITY _____ GAL
	SEAM LOC _____
	TANK LID DEPTH _____
	BAFFLES _____
	BAFFLE FILTER _____
	MANHOLE LOC _____
	6" PORT LOC _____
	WATERTIGHT TEST _____

PRE-CONSTRUCTION 12/20/05 Install New 1500 w/ FAST .75 unit (outside well radius) tie into existing 100' trench. Abandon old septic tank & fill w/ gravel

INSTALLATION to run line into new septic tank 12/20/05 Tank set and tied into. ok to cover line out of tank 12/21/05 line out of house tied into new tank, Old tank abandoned, filled w/ gravel line run over is. Original cast iron is in great shape. ok to cover. 12/22/05 Blower hooked up. Tank still needs 8" lids for cleanouts. Need start-up/aborn test. GAS 10/10/06 Aerator and aerator alarm working correctly. (BB)

FINAL INSPECTOR B. Baker DATE OF APPROVAL 10/10/06

## Oswald, Hank

---

**From:** Oswald, Hank  
**Sent:** Wednesday, April 27, 2022 10:29 AM  
**To:** MRDECKSMD@HOTMAIL.COM  
**Subject:** B22001616\_8517 Beaufort Dr\_Deck Permit  
**Attachments:** WS\_Beaufort\_8517\_SepticPermit-2006.pdf

Hi Mr. Bowers:

Please revise the site plan to show the septic tank meeting 5 foot setback to new deck and resubmit to permits office. Let me know when you do, so I can look for the revision in the system.

Thanks,

Hank

Hank Oswald, L.E.H.S.  
Howard County Health Department  
Well & Septic Program  
410.313.1786  
hoswald@howardcountymd.gov

## Oswald, Hank

---

**From:** STEVE BOWERS <mrdecksmd@hotmail.com>  
**Sent:** Wednesday, April 27, 2022 11:38 AM  
**To:** Oswald, Hank  
**Subject:** Re: B22001616\_8517 Beaufort Dr\_Deck Permit  
**Attachments:** 8517 BEAUFORT DRIVE SHOWING SEPTIC TANK.pdf

[Note: This email originated from outside of the organization. Please only click on links or attachments if you know the sender.]

Hank,

I will be attaching the revised property plat indicating the septic tank and that the deck meets the 5-foot setback in the system within minutes.

I have also attached the same drawing to this email.

Thanks for reviewing the permit application.

Have a good day.

Steve Bowers

---

**From:** Oswald, Hank <hoswald@howardcountymd.gov>  
**Sent:** Wednesday, April 27, 2022 10:28 AM  
**To:** MRDECKSMDSMD@HOTMAIL.COM <MRDECKSMDSMD@HOTMAIL.COM>  
**Subject:** B22001616\_8517 Beaufort Dr\_Deck Permit

Hi Mr. Bowers:

Please revise the site plan to show the septic tank meeting 5 foot setback to new deck and resubmit to permits office. Let me know when you do, so I can look for the revision in the system.

Thanks,

Hank

Hank Oswald, L.E.H.S.  
Howard County Health Department  
Well & Septic Program  
410.313.1786  
hoswald@howardcountymd.gov

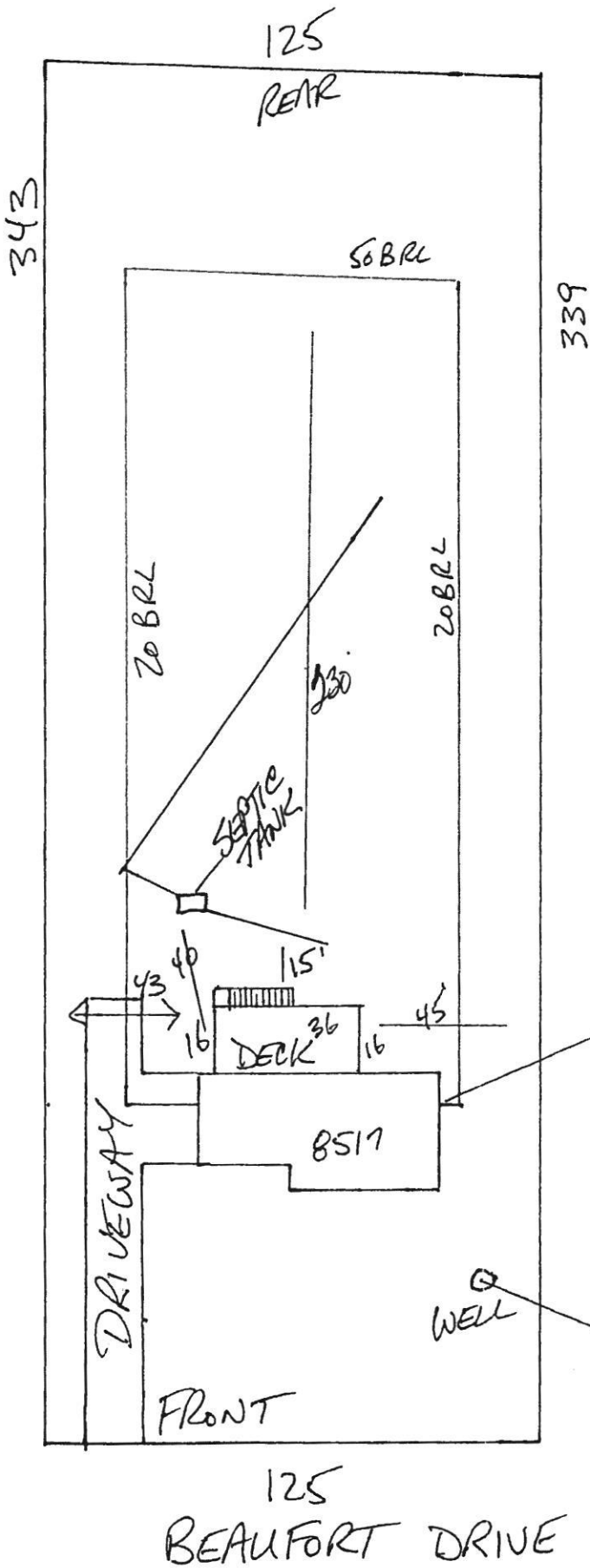

8517 BEAUFORT DRIVE  
 FULTON MD 20759  
 1" = 40'