

C 1 56577

SEQUENCE NO. (MDE USE ONLY)

STATE OF MARYLAND WELL COMPLETION REPORT

THIS REPORT MUST BE SUBMITTED WITHIN 45 DAYS AFTER WELL IS COMPLETED.

1 2 3 6 (THIS NUMBER IS TO BE PUNCHED IN COLS. 3-6 ON ALL CARDS)

COUNTY NUMBER 5639672

ST/CO USE ONLY DATE RECEIVED

DATE WELL COMPLETED 12-19-18

Depth of Well 300 (TO NEAREST FOOT)

OK 1/16/19 sc

PERMIT NO. FROM "PERMIT TO DRILL WELL" HD-17-0337

OWNER Trinity Homes WELL SITE ADDRESS Admitt Lane TOWN Highland SUBDIVISION The Estates @ River Hill SECTION LOT 13

WELL LOG table with columns: DESCRIPTION, FEET (FROM, TO), check if water bearing. Includes entries for Clay, Soft brown, Grey s/s, Fracture, etc.

GROUTING RECORD form with fields for WELL HAS BEEN GROUTED, TYPE OF GROUTING MATERIAL, CEMENT, BENTONITE CLAY, NO. OF BAGS, NO. OF POUNDS, GALLONS OF WATER, DEPTH OF GROUT SEAL.

CASING RECORD form with fields for MAIN CASING TYPE, Nominal diameter, Total depth, OTHER CASING (if used).

SCREEN RECORD form with fields for screen type or open hole, diameter, depth, and options for STEEL, BRASS, BRONZE, PLASTIC, OPEN HOLE, OTHER.

Administrative fields: NUMBER OF UNSUCCESSFUL WELLS, WELL HYDROFRACTURED, CIRCLE APPROPRIATE LETTER (A, E, P).

DEPTH (nearest ft.) table with columns 1-11 and 15-17, 21-26, 30-32, 36-41, 45-47, 51-56, 60-64, 68-72, 74-75, 76.

DRILLERS LIC. NO. M SD 2241, DRILLERS SIGNATURE, LIC. NO. D, SITE SUPERVISOR information.

MDE USE ONLY (NOT TO BE FILLED IN BY DRILLER) with fields for GRAVEL PACK, TELESCOPE CASING, LOG INDICATOR, OTHER DATA.

PUMPING TEST form with fields for HOURS PUMPED, PUMPING RATE, METHOD USED TO MEASURE PUMPING RATE, WATER LEVEL, BEFORE PUMPING, WHEN PUMPING, TYPE OF PUMP USED.

PUMP INSTALLED form with fields for DRILLER INSTALLED PUMP, TYPE OF PUMP INSTALLED, CAPACITY, GALLONS PER MINUTE, PUMP HORSE POWER, PUMP COLUMN LENGTH, CASING HEIGHT, LAND SURFACE.

LATITUDE 39.198590, LONGITUDE 76.959800 (DEFAULT COORD. WGS 84). Pursuant to §10-624 of the State Govt. Article of the Maryland Code...

TAG = 12/19/2018
STATE PERMIT NUMBER
H0-17-0337
fill in this form completely

B 1 SEQUENCE NO. (MDE USE ONLY) 59735
STATE OF MARYLAND APPLICATION FOR PERMIT TO DRILL WELL
please type

OWNER INFORMATION
Date Received (APA) 07/27/18
8 MM DD YY 13
15 Last Name Trinity Homes Owner First Name
36 Street or RFD 3675 Park Ave Suite 301 55
57 Town Ellcott City Md 21043 70 State 72 Zip 76

B 3 LOCATION OF WELL
8 COUNTY Howard 21
23 SUBDIVISION The Estates at River Hill 42
SECTION 44 46 LOT 13 48 50
52 NEAREST TOWN Highland 71

DRILLER INFORMATION Andrew Houseman MSO 224
Allen Compton MSO 009
Driller's Name 76 License No. 81
Firm Name Eagles Well Drilling, LLC
Address P.O. Box 202
Signature Andrew Houseman Date 7-27-18

B 4 SOURCES OF DRILLING WATER
1. well water
11 STREET ADDRESS 30
ON WHICH SIDE OF ROAD (CIRCLE APPROPRIATE BOX)
NORTH N
WEST W EAST E
SOUTH S
34 700 37
DISTANCE FROM ROAD FT
ENTER FT OR MI 38 39
TAX MAP: 34 BLK: 23 PARCEL 389

B 2 WELL INFORMATION
1 2 APPROX. PUMPING RATE (GAL. PER MIN.) 8 12
AVERAGE DAILY QUANTITY NEEDED (GAL. PER DAY) 14 20

USE FOR WATER (CIRCLE APPROPRIATE BOX)
D DOMESTIC POTABLE SUPPLY & RESIDENTIAL IRRIGATION
F FARMING (LIVESTOCK WATERING & AGRICULTURAL IRRIGATION)
I INDUSTRIAL, COMMERCIAL, DEWATERING
P PUBLIC WATER SUPPLY WELL
T TEST, OBSERVATION, MONITORING
O OPEN LOOP GEOTHERMAL
C CLOSED LOOP GEOTHERMAL

NOT TO BE FILLED IN BY DRILLER HEALTH DEPARTMENT APPROVAL
Howard 13
COUNTY NAME COUNTY NO.
STATE SIGNATURE INSERT S 41
DATE ISSUED 9/18/18 858
43 MM DD YY 48 CO SIGNATURE EXP. DATE 9/18/19
DOW: 12/17/2018 DCA: 12/19/2018 D: 12/19/2018

APPROXIMATE DEPTH OF WELL 24 28 FEET
APPROXIMATE DIAMETER OF WELL NEAREST INCH

PROPOSED LOCATION OF WELL ON LOT
SHOW PERMANENT STRUCTURES SUCH AS BUILDINGS, SEPTIC SYSTEM, ROADS AND/OR LANDMARKS AND INDICATE NOT LESS THAN TWO DISTANCE MEASUREMENTS TO WELL

METHOD OF DRILLING (circle one)
BORED (or Augered) JETTED Jetted & DRIVEN
30 AIR-ROTary AIR-PERcussion ROTARY (Hydraulic Rotary)
37 CABLE REVERSE-ROTary DRIVE-POINT
other

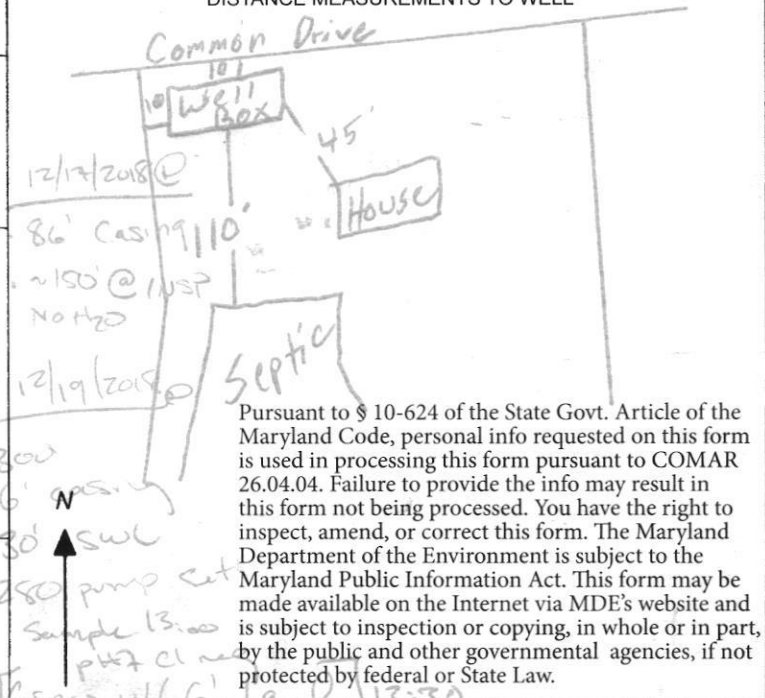

REPLACEMENT OR DEEPEMED WELLS (CIRCLE APPROPRIATE BOX)
N THIS WELL WILL NOT REPLACE AN EXISTING WELL
Y THIS WELL WILL REPLACE A WELL THAT WILL BE ABANDONED AND SEALED
39 S THIS WELL WILL REPLACE A WELL THAT WILL BE USED AS A STANDBY-CONTACT LOCAL APPROVING AUTHORITY FOR POLICY ON STANDBY WELLS
D THIS WELL WILL DEEPEM AN EXISTING WELL
PERMIT NUMBER OF WELL TO BE REPLACED OR DEEPEMED (IF AVAILABLE) 41 52

Not to be filled in by driller (MDE OR COUNTY USE ONLY)
APPROP. PERMIT NUMBER H02018G005
PERMIT No. H0-17-0337
70 71 72 73 74 75 76 77 78 79

SPECIAL CONDITIONS
NOTE APPROVING AUTHORITIES SHOULD USE SEPARATE SHEET IF NEEDED
SEE ATTACHED MEMO.

**HOWARD COUNTY HEALTH DEPARTMENT
BUREAU OF ENVIRONMENTAL HEALTH
WELL & SEPTIC PROGRAM
TEL: (410)313-1771 FAX: (410)313-2648**

Information Form for the Installation of the Well Pump, Pitless Adapter, and Supply Piping

NOTE: The installer is responsible for requesting an inspection prior to 9 am on the day of the desired inspection. No work is to be covered until approved by the Health Department. All installations must comply with the National Standard Plumbing Code (NSPC, as amended locally) and COMAR 26.04.04 (MD Well Construction Regulations). Submission of a complete form is required prior to Use and Occupancy approval.

Company Name: Do-It Plumbing & Heating Telephone #: 240-882-0069
Address: 104 Estelle Ct
Sykesville, Md. 21784

(Must circle one) Licensed Plumber Licensed Well Driller Licensed Well Pump Installer

License # and name of individual responsible for the field installation:

Name (Print): Duane Gilbert License# 21899

***A licensed individual must perform the actual installation. Apprentices must be under the supervision of a licensed journeyman or master plumber, pump installer or well driller. Licenses may be subjected to field verification. Unlicensed individuals may be reported to the appropriate licensing agency.**

Name of Property Owner: TBF Telephone #: 410-480-0023
Subdivision: Estates of River Hill Lot #: 13 Well Tag #: HO-17-0337 SD
Site Address: 13604 OLIVIA WAY
Highland Md

Submersible Pump Data

Make: Myers

Model #: 23T52-12 Plus P4-R

Pump Capacity: 12 GPM

Well Yield: 10 GPM

Depth of well encountered at time of pump installation: 300 (feet)

If pump capacity exceeds well yield, a low water cut off switch is required by NSPC 1990 Section 17.8.4

Torque arrestor: Cable guards or other acceptable method used- Must circle one

Safety rope, if used, attached to brass rope adapter or other acceptable method inside of well casing

Pitless Adapter

Make: Bushart

Model #: P-800-SS

Depth: yes (36" min)

NSF/WSC approved: yes

Well Cap and Electric Conduit

Two piece watertight cap: yes

Screened, vented well cap: yes

Cap secured to casing: yes

Conduit min 18" B.G.: yes

Conduit secured to well cap: yes

Piping to house

Type: Black Poly

PSI: yes (160 psi min)

Depth of supply line: yes (36" min)

House Connection

PVC sleeve to undisturbed soil at wall penetration: yes

Length of sleeve (5' minimum from foundation): 10 ft

Sleeve sealed properly: yes

The water supply line is required to be at least ten feet from the septic tank, pump chamber, sewage piping, distribution box, drainfields, and sewage reserve area. If this cannot be accomplished, contact this office for approval prior to installation.

Signature of company representative responsible for installation: Duane Gilbert

date: Oct-21-2021

For Health Department Use Only - Not to be completed by Installer

Date Insp. Requested: 10/21/21 Date Insp. Approved: 10/22/21 Inspector: SD

Inspection Data: Pitless adapter watertight & water supply line at least 36" below grade ✓ 45"

Two piece cap installed and attached to casing securely ✓

Elec. conduit extends at least 18" below grade/attached to cap properly x 11" ✓ 26"

Safety rope not outside of well cap/casing ✓

Correct well tag attached properly and casing 8" above finished grade ✓ 23"

Water supply line sleeved adequately at house connection ✓ 10'

Adequate grout observed below pitless adapter ✓



10/22/21



Bureau of Environmental Health
8930 Stanford Blvd | Columbia, MD 21045
410.313.2640 - Voice/Relay
410.313.2648 - Fax
1.866.313.6300 - Toll Free

Maura J. Rossman, M.D., Health Officer

INTERIM CERTIFICATE OF POTABILITY

Expiration Date – September 22, 2022

March 22, 2022

Homeowner
13604 Olivia Way
Highland, MD 20777

**RE: Estates @ River Hill, Lot 13
13604 Olivia Way
Building Permit: B19003296
Well Permit: HO-17-0337**

Dear Homeowner:

This is to advise you that the septic system installation and water well construction for the above referenced property have been inspected and approved. Final approval of the septic system was granted on **11/8/2021**. Final approval of the well line connection to the dwelling was granted on **10/22/2021**. The well construction was completed on **12/19/2018**. Water samples were collected on **2/28/2022, 3/9/2022**.

The water sample results indicate that the water samples submitted for testing were free of coliform and fecal coliform bacteria at the time of sampling and are bacteriologically safe for drinking. This certifies that the initial sampling requirements of COMAR 26.04.04 "Well Regulations" have been met for the water supply system installed under well permit HO-17-0337. Although the submitted sample results are in compliance with COMAR standards, the Health Department does not guarantee water supplies.

This Interim Certificate of Potability will expire **six months** from the date of issuance. Submission of a second bacteriological test indicating the water is free of coliform and fecal coliform bacteria is required prior to the expiration date, after which time a Final Certificate of Potability will be issued. **Failure to submit an additional sample and obtain a Final Certificate of Potability will result in a Notice of Violation and is punishable as a misdemeanor under the *Annotated Code of Maryland, Environment Article, 9-1311*, subject to a fine of up to \$500 or imprisonment not to exceed three months.**

Please contact (410) 313-1773 to schedule a final water sample appointment or contact a Maryland certified water laboratory to schedule a water sample. A list of laboratories certified by the state of Maryland may be found at the following website:
<http://www.mde.state.md.us/assets/document/WSP-Labs-2010apr16.pdf>



Bureau of Environmental Health
8930 Stanford Blvd | Columbia, MD 21045
410.313.2640 - Voice/Relay
410.313.2648 - Fax
1.866.313.6300 - Toll Free

Maura J. Rossman, M.D., Health Officer

In closing, please refer to our "[Homeowner Fact Sheet](#)" which illustrates a better understanding for your Onsite Sewage Disposal System. You will also find a link to Maryland Department of the Environment's website which describes in further detail operation and maintenance of your septic system.

Approving Authority,

A handwritten signature in black ink, appearing to read 'Kevin M. Wolf', is written over a light blue horizontal line.

Kevin M. Wolf, LEHS, R.S./REHS, Supervisor
Groundwater Management Section
Well & Septic Program

cc: Howard County Dept. of Inspections, Licenses, and Permits
Community Hygiene Program
File

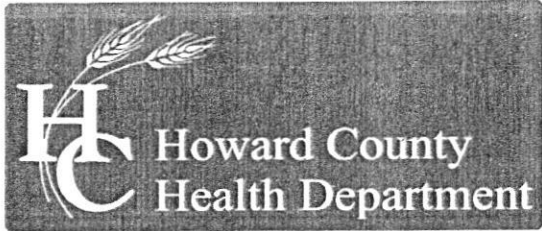

Bureau of Environmental Health

8930 Stanford Boulevard, Columbia, MD 21045 Main: 410-313-2640 | Fax: 410-313-2648 TDD 410-313-2323 | Toll Free 1-866-313-6300 www.hchealth.org

Facebook: www.facebook.com/hocohealth

Twitter: HowardCoHealthDep

Dr. Maura J. Rossman, M.D., Health Officer

TO ALL INTERESTED PARTIES

When submitting a well permit application for a proposed well for new construction, please indicate one of the following:

Well Site Location:

The Estates at River Hill 1-15 Parcel A - Alhutt Lane
Subdivision/Property Name Lot # Road Name

The well site has been staked by Robert H. Vogel Engineering, Inc.
(professional land surveyor or company employing professional land surveyors)
on _____ (date) and does not require a site inspection.

The well driller, builder or property owner will call the Health Department to schedule a time to meet in the field to verify the proposed well site location.

This sheet, along with two copies of an acceptable well site plan, must be attached to the green well permit application.

Maura J. Rossman, M.D., Health Officer

February 5, 2019

Tim Keane
Trinity Homes
3625 Park Avenue
Ellicott City, Maryland 21043

RE: Estates at River Hill Lot 13
Allnut Lane
Well Tag: HO – 17 – 0337

Dear Mr. Keane:

A sample was collected during a yield test on December 19, 2018 and submitted to the Maryland Department of Health Laboratories to assess the possible presence of **Gross Alpha** and **Gross Beta** in the future well water supply. **Gross Alpha** and **Gross Beta** measure the total alpha and beta particle activity in a water supply. These naturally occurring radioactive nuclides have been demonstrated to be present in a certain type of geologic formation known as the Baltimore Gneiss which exists in your area of development within the County.

Results from this screening revealed a **Gross Alpha** of 4.9 ± 1.6 picocuries/liter (pCi/L), while the **Gross Beta** level was 6.8 ± 2.0 pCi/L. The **Gross Alpha** result was below its **maximum contaminant level (MCL)** of 15 pCi/L, while the **Gross Beta** level was below its targeted standard of 50 pCi/L (roughly equivalent to the **annual dose rate** of 4 millirems/year).

At the time of testing and with respect to these parameters, the well water supply **is within** EPA regulatory standards. Additional testing **for these parameters** will not be required to secure the future Use & Occupancy. Please **note** that other standard testing parameters (bacteria, nitrate, turbidity and sand) will still be needed to help secure Use & Occupancy.

A copy of the test results is enclosed for your information. Please call this office at 410-313-1773 if you have any further questions.

Sincerely,

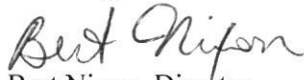

Bert Nixon, Director
Bureau of Environmental Health

✓ Enclosure

cc: Property file

SEND REPORT TO:

Howard County Health Department
Bureau of Environmental Health
8930 Stanford Blvd.
Columbia, Maryland 21045

State of Maryland
DHMH - Laboratories Administration
Division of Environmental Sciences
RADIATION LABORATORY
1770 Ashland Avenue
Baltimore, Maryland 21205

Lab No.

LABORATORY ANALYSIS REQUEST FORM

Plant/Site Name: ESTATES AT RIVER HILL County: HOWARD

Sample Source: ALCANTARA LANE - LOT 13 Location: HO-17-03-37
(Well no., lab sink, sample tap, etc.)

Radon-222 Bottle A HOJC03378A Radon-222 Field Blank Bottle A _____
Bottle B _____ Bottle B _____

County 13 Plant No. _____

CHECK (one per Box)

Type	Service	Point of Collection	Testing
Drinking Water <input checked="" type="checkbox"/>	Community <input type="checkbox"/>	Source (Raw) <input checked="" type="checkbox"/>	Emergency <input type="checkbox"/>
Landfill <input type="checkbox"/>	Non-Community <input type="checkbox"/>	Distribution (treated) <input type="checkbox"/>	Routine <input checked="" type="checkbox"/>
Stream <input type="checkbox"/>	Private <input checked="" type="checkbox"/>	MCL <input type="checkbox"/>	Recheck <input type="checkbox"/>
Other <input type="checkbox"/>	Other <input type="checkbox"/>		Special <input type="checkbox"/>

Submitters Code: 4 F Federal Project: _____

Collector: CABANIG, J Telephone No.: (410) 313-2643

Date Collected: 12/19/2018 Time Collected: _____ a.m. 13:00 p.m.

Field pH: 7.0 Field Chlorine: NEG

Nitric Acid Preserved: Yes No Iced: Yes No

Remarks: SAMPLE COLLECTED AT YIELD

TEST	EPA Code	Lab No.	Method No.	Results (pCi/L)	Date Analyzed	Analyst	Date Reported
<input checked="" type="checkbox"/> Gross Alpha	4000	1306	EPA 900.0	4.9 ± 1.6	12/27/18	RM	01/21/19
<input checked="" type="checkbox"/> Gross Beta	4100	1306	EPA 900.0	6.8 ± 2.0	12/27/18	RM	01/21/19
<input type="checkbox"/> Radium-226	4020						
<input type="checkbox"/> Radium-228	4030						
<input type="checkbox"/> Total Uranium	4006						
<input type="checkbox"/> Radon-222 (Bottle A)	4004						
<input type="checkbox"/> Radon-222 (Bottle B)	4004						
<input type="checkbox"/> Radon Field Blank A	4004						
<input type="checkbox"/> Radon Field Blank B	4004						
<input type="checkbox"/> Tritium							
<input type="checkbox"/>							
<input type="checkbox"/>							

Date Received: 12/26/18 Received By: W. Tuckman

Data Release Signature: _____ Date: 1/4/19

Lab Use Only	Yes	No	N/A
Sample Intact upon arrival?	<input checked="" type="checkbox"/>		
Sample pH <2.0?	<input checked="" type="checkbox"/>		
Received within holding time?	<input checked="" type="checkbox"/>		

Tel. No.: (443) 681-3766 Fax No.: (443) 681-4507

FORM REVISED 05/15
DHMH 4540 05/17

PROGRAM COPY

SAMPLE TESTED AS RECEIVED

SEND REPORT TO:

Howard County Health Department
Bureau of Environmental Health
8930 Stanford Blvd.
Columbia, Maryland 21045

State of Maryland
DHMH - Laboratories Administration
Division of Environmental Sciences
RADIATION LABORATORY
1770 Ashland Avenue
Baltimore, Maryland 21205

Lab No.

LABORATORY ANALYSIS REQUEST FORM

Plant/Site Name: HCHD

County: HOWARD

Sample Source: WEGIMINS DISTILLED

Location: LAB

(Well no., lab sink, sample tap, etc.)

Radon-222 Bottle A FIELD BLANK Radon-222 Field Blank

Bottle A _____

RADIUM
Bottle B _____

Bottle B _____

County 13

Plant No.

--	--	--	--	--	--	--	--	--	--	--	--

CHECK (one per Box)

Type	
Drinking Water	<input checked="" type="checkbox"/>
Landfill	<input type="checkbox"/>
Stream	<input type="checkbox"/>
Other	<input type="checkbox"/>

Service	
Community	<input type="checkbox"/>
Non-Community	<input type="checkbox"/>
Private	<input checked="" type="checkbox"/>
Other	<input type="checkbox"/>

Point of Collection	
Source (Raw)	<input checked="" type="checkbox"/>
Distribution (treated)	<input type="checkbox"/>
MCL	<input type="checkbox"/>

Testing	
Emergency	<input type="checkbox"/>
Routine	<input checked="" type="checkbox"/>
Recheck	<input type="checkbox"/>
Special	<input type="checkbox"/>

Submitters Code: H F

Federal Project:

Collector: CABAHUG, J

Telephone No.: (410) 313-2643

Date Collected: 12/26/2018

Time Collected: 08:15 a.m. _____ p.m.

Field pH: 6.5

Field Chlorine: NEG

Nitric Acid Preserved: Yes No

Iced: Yes No

Remarks: _____

<input checked="" type="checkbox"/>	TEST	EPA Code	Lab No.	Method No.	Results (pCi/L)	Date Analyzed	Analyst	Date Reported
<input checked="" type="checkbox"/>	Gross Alpha	4000	13011	EPMA010	< 2.0	12/27/18	RH	01/21/19
<input checked="" type="checkbox"/>	Gross Beta	4100	13011	EPMA010	< 4.0	12/27/18	RH	01/21/19
<input type="checkbox"/>	Radium-226	4020						
<input type="checkbox"/>	Radium-228	4030						
<input type="checkbox"/>	Total Uranium	4006						
<input type="checkbox"/>	Radon-222 (Bottle A)	4004						
<input type="checkbox"/>	Radon-222 (Bottle B)	4004						
<input type="checkbox"/>	Radon Field Blank A	4004						
<input type="checkbox"/>	Radon Field Blank B	4004						
<input type="checkbox"/>	Tritium							
<input type="checkbox"/>								
<input type="checkbox"/>								

Date Received: 12/26/18 Received By: W. T. ...

Data Release Signature: [Signature] Date: 1/4/19

Lab Use Only	Yes	No	N/A
Sample Intact upon arrival?	<input checked="" type="checkbox"/>		
Sample pH <2.0?	<input checked="" type="checkbox"/>		
Received within holding time?	<input checked="" type="checkbox"/>		

•Tel. No.: (443) 681-3766 •Fax No.: (443) 681-4507

FORM REVISED 05/15
DHMH 4540 05/17

PROGRAM COPY

SAMPLE TESTED AS RECEIVED

ORIG MARISA 1/16/2019

Invoice

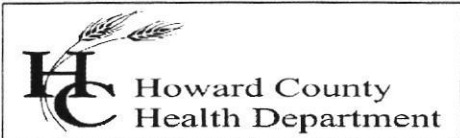

Bureau of Environmental Health
Attn: Bert Nixon, Director

DATE: JANUARY 16, 2019
DATES OF SERVICE: DECEMBER 19 & 21, 2018
INVOICE #: 2018-008

8930 Stanford Boulevard, Columbia, MD 21045
Phone 410-313-2640 Fax 410-313-2648
www.hchealth.org

BILL TO: Tim Keane
Trinity Homes
3625 Park Avenue
Ellicott City, Maryland 21043

COMMENTS: Payment due upon receipt. Letter and results will be released upon receipt of payment.

DATE	DESCRIPTION	BALANCE	AMOUNT
12/21/18	Gross Alpha/Beta testing performed for Lot 2 Estates at River Hill HO - 17 - 0326		\$45.00
12/19/18	Gross Alpha/Beta testing performed for Lot 14 Estates at River Hill HO - 17 - 0337		\$45.00
			AMOUNT DUE
			\$90.00

Please detach and return with payment.

REMITTANCE	
Invoice #	2018-008
Site Information	Estates at River Hill Lots 2 & 13
Amount Due	\$90.00

Receipt 64746
rec'd 1/30/19

Make Checks Payable to: **Director of Finance** Mail Payments to: **Bureau of Env. Health**

Fogle's Well Drilling, LLC

**P.O. Box 202
Woodbine, Md 21797
443-609-4195
410-795-5670{24hrs}**

Invoice

Date	Invoice #
4/17/2019	10398279

Job Location

**The Estates @ River Hill Lot #14
Allnutt Lane
Highland, Md**

Bill To:

**Trinity Homes
Tim Keane
3675 Park Ave Suite 301
Ellicott City, Md 21043**

<u>Amount of Remittance</u>

P.O. No.	Terms	Project	** 1-1/2 % Late charge due on balances outstanding more than 15 days from date of invoice** (18% per annum)	
	Due on receipt	The Estates at River Hill Lot #14		
Qty	Description	Price Each	Serviced	Amount
1	Abandon Well per State & County Regulations. Mail Completed Abandonment report to the County & State.	1,750.00	4/9/2019	1,750.00
It's been a pleasure working with you!			Total	\$1,750.00
			Payments/Credits	\$0.00
			Balance Due	\$1,750.00

WATER WELL ABANDONMENT-SEALING REPORT FORM

SUBMIT COPIES OF COMPLETED FORM TO:

- * COUNTY ENVIRONMENTAL AGENCY (contact MDE, WMA if address needed)
- * WELL OWNER
- * MDE, WATER MANAGEMENT ADMINISTRATION, WELL PROGRAM

DATE WELL ABANDONED: 4-9-19 (month/day/year)

* PERMIT NUMBER OF ABANDONED WELL (if any)

HO-73-4317

* PERMIT NUMBER OF REPLACEMENT WELL:

HO-17-0338

* PERSON ABANDONING WELL: Andrew Houson - WELL DRILLER'S LICENSE NUMBER: 224

CIRCLE: MWD / MSD / MGD

* OWNER'S NAME: Trinity Homes

SITE LOCATION MAP

* WELL LOCATION:
 COUNTY: Howard
 NEAREST TOWN: Highland
 TAX MAP 34 BLOCK 23 PARCEL 389
 SUBDIVISION: The Estates at River Hill
 SECTION: _____ LOT: 14
 STREET ADDRESS: Allnut Lane

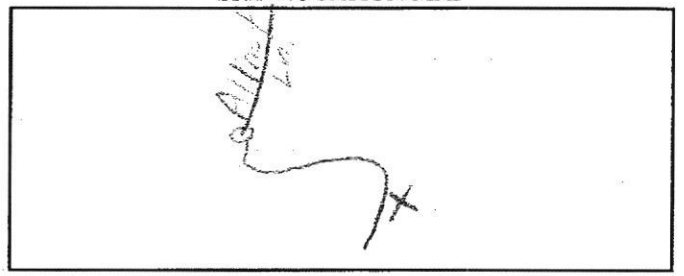

LATITUDE 3 9.198784
 LONGITUDE 7 6.959873

LOG OF SEALING MATERIAL

MATERIAL	FEET	
	FROM	TO
<u>Bentonite</u>	<u>175</u>	<u>0</u>
VOLUME OF MATERIAL USED		
<u>Bentonite</u>	<u>1800 lbs</u>	<u>(00)</u>

* TYPE OF WELL BEING ABANDONED:
 DRILLED _____ JETTED
 BORED _____ HAND DUG
 OTHER (specify) _____

* USE CODE:
 DOMESTIC _____ MUNICIPAL/PUBLIC
 IRRIGATION _____ INDUSTRIAL
 TEST/OBSERVATION _____ GEOTHERMAL

* TYPE OF CASING:
 STEEL _____ PLASTIC
 CONCRETE _____ OTHER (specify) _____

SIZE OF CASING: 6 INCHES IN DIAMETER

DEPTH OF WELL: 175 FEET DEEP

WAS ANY CASING REMOVED? YES _____ NO
 If yes, length removed, in feet: 5

WAS CASING RIPPED OR PERFORATED? _____ YES NO

SIGNATURE-MASTER WELL DRILLER OR SUPERVISING SANITARIAN LICENSE#

Andrew Houson
224

MWD / MSD / MGS
 CIRCLE ONE

4-9-19
 DATE

OWNER

Pursuant to § 10-624 of the State Govt. Article of the Maryland Code, personal info requested on this form is used in processing this form pursuant to COMAR 26.04.04. Failure to provide the info may result in this form not being processed. You have the right to inspect, amend, or correct this form. The Maryland Department of the Environment is subject to the Maryland Public Information Act. This form may be made available on the Internet via MDE's website and is subject to inspection or copying, in whole or in part, by the public and other governmental agencies, if not protected by federal or State Law.

 WATER WELL ABANDONMENT-SEALING REPORT FORM

SUBMIT COPIES OF COMPLETED FORM TO:

- * COUNTY ENVIRONMENTAL AGENCY (contact MDE, WMA if address needed)
- * WELL OWNER
- * MDE, WATER MANAGEMENT ADMINISTRATION, WELL PROGRAM

APPROVED
 5/7/2019

DATE WELL ABANDONED: 4-9-19 (month/day/year)

* PERMIT NUMBER OF ABANDONED WELL (if any)

HO - 73 - 4317

* PERMIT NUMBER OF REPLACEMENT WELL:

BO - 17 - 0338

* PERSON ABANDONING WELL: Andrew Houseman WELL DRILLER'S LICENSE NUMBER: 224

CIRCLE: MWD / MSD / MGD

* OWNER'S NAME: Trinity Homes

SITE LOCATION MAP

* WELL LOCATION:
 COUNTY: Howard
 NEAREST TOWN: Highland
 TAX MAP 34 BLOCK 23 PARCEL 389
 SUBDIVISION: The Estates at River Mill
 SECTION: _____ LOT: 14
 STREET ADDRESS: Allnut Lane

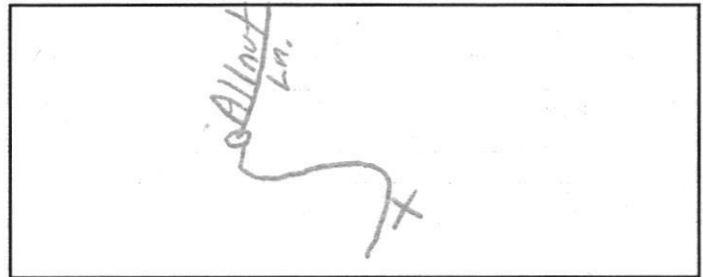

LATITUDE 3 9.198784

LONGITUDE 7 6.959873

LOG OF SEALING MATERIAL

MATERIAL	FEET	
	FROM	TO
Bentonite	175	0
VOLUME OF MATERIAL USED		
Bentonite	1800 lbs	(06)

* TYPE OF WELL BEING ABANDONED:
 DRILLED _____ JETTED
 BORED _____ HAND DUG
 OTHER (specify) _____

* USE CODE:
 DOMESTIC _____ MUNICIPAL/PUBLIC
 IRRIGATION _____ INDUSTRIAL
 TEST/OBSERVATION _____ GEOTHERMAL

* TYPE OF CASING:
 STEEL _____ PLASTIC
 CONCRETE _____ OTHER (specify) _____

SIZE OF CASING: 6 INCHES IN DIAMETER

DEPTH OF WELL: 175 FEET DEEP

WAS ANY CASING REMOVED? YES _____ NO

If yes, length removed, in feet: 5

WAS CASING RIPPED OR PERFORATED? _____ YES NO

SIGNATURE-MASTER WELL DRILLER OR SUPERVISING SANITARIAN LICENSE#

Andrew Houseman
 224

MWD / MSD / MGS

CIRCLE ONE

DATE

4-9-19

COUNTY

Pursuant to § 10-624 of the State Govt. Article of the Maryland Code, personal info requested on this form is used in processing this form pursuant to COMAR 26.04.04. Failure to provide the info may result in this form not being processed. You have the right to inspect, amend, or correct this form. The Maryland Department of the Environment is subject to the Maryland Public Information Act. This form may be made available on the Internet via MDE's website and is subject to inspection or copying, in whole or in part, by the public and other governmental agencies, if not protected by federal or State Law.

VERIFIED
 0 25g
 H₂O / B

CL

Wolf, Kevin

From: Wolf, Kevin
Sent: Tuesday, March 8, 2022 11:41 AM
To: Sarah Jahng
Cc: Martin, Sharhonda; Tim Keane
Subject: RE: REVISED REPORT to add IRON, 13604 Olivia Way
Attachments: Analysis Report - Revised to add Fe.pdf

Sarah,

To answer your question, yes from the looks of the water test report, it appears that the iron is what is causing the elevated turbidity. In order to confirm this, I will need a "post-treatment" sample of the turbidity and iron. You already have a water softener in place which should take care of the excess iron. Please forward me the post-treated result when you get a chance.

Thanks

Kevin

From: Sarah Jahng <sjahng@trinityhomes.com>
Sent: Monday, March 7, 2022 6:06 PM
To: Wolf, Kevin <KWolf@howardcountymd.gov>
Cc: Martin, Sharhonda <smmartin@howardcountymd.gov>; Tim Keane <tkeane@trinityhomes.com>
Subject: RE: REVISED REPORT to add IRON, 13604 Olivia Way

[Note: This email originated from outside of the organization. Please only click on links or attachments if you know the sender.]

Hello,

I'm just following up on this question. Thanks!

Tim,

This is for ERH13. Can you let me know if we already have ICOP?

Thanks!

NOTICE TO VEDORS AND CONTRACTORS – Please provide invoices by 2pm the Monday PRIOR to the 10th and 25th of each month for payment to be processed in those corresponding check runs.

Sarah Jahng
Trinity Homes
Operations/AP Manager
410.480.0023

From: Sarah Jahng
Sent: Wednesday, March 2, 2022 10:17 AM

To: kwolf@howardcountymd.gov
Cc: smmartin@howardcountymd.gov
Subject: RE: REVISED REPORT to add IRON, 13604 Olivia Way

Kevin,
Good day! Does the iron result explain the turbidity, and will this suffice now to proceed with ICOP?

Thanks!

NOTICE TO VEDORS AND CONTRACTORS – Please provide invoices by 2pm the Monday PRIOR to the 10th and 25th of each month for payment to be processed in those corresponding check runs.

Sarah Jahng
Trinity Homes
Operations/AP Manager
410.480.0023

From: B Dutterer <bdutterer@fval.com>
Sent: Tuesday, March 1, 2022 6:53 PM
To: Sarah Jahng <sjahng@trinityhomes.com>
Cc: kwolf@howardcountymd.gov; smmartin@howardcountymd.gov
Subject: REVISED REPORT to add IRON, 13604 Olivia Way

Feel free to call with any questions or comments you may have. Thank you.

Bradley C. Dutterer

Laboratory Compliance Manager
Fountain Valley Analytical Laboratory, Inc.
1413 Old Taneytown Road
Westminster, MD 21158
410-848-1014
www.fval.com

Celebrating our 36th year (1986 – 2022)



This message (including any attachments) is intended only for the use of the individual or entity to which it is addressed and may contain information that is non-public, proprietary, privileged, confidential, and exempt from disclosure under applicable laws. If you are not the intended recipient, you are hereby notified that any use, dissemination, distribution or copying of this communication is strictly prohibited. If you have received this communication in error, delete this message immediately. Thank you.



Maura J. Rossman, M.D., Health Officer

MEMORANDUM

TO: Allen Compton (MSD 009)

FROM: Sarah Collins, L.E.H.S. SEC
Howard County Health Department
Well and Septic Program

DATE: September 17, 2018

RE: Well permits for the Estates at River Hill

The following conditions apply to the well permits for the Estates at River Hill:

- A radium sample is required at the yield test for all lots.
- Sodium, chloride, and total dissolved solids samples are required at the yield test for Lots 1, 2, 3, 4, 10, and 11.
- Steel casing to 50' or 10' into competent bedrock, whichever is deeper, is required for Lots 5, 7, and 8.
- Per the Groundwater Appropriations Permit from Maryland Department of the Environment, any well less than 100' from another well AND on a lot less than one acre requires a simultaneous yield test. Lot 10 is the only lot less than one acre; any well less than 100' from Lot 10 requires a simultaneous yield test with the Lot 10 well.

Feel free to contact me at 410-313-6287 or SCollins@howardcountymd.gov with any questions.

Cc: Vogel Engineering, Rob Vogel (rvogel@vogeleng.com)
File

FOUNTAIN VALLEY ANALYTICAL LABORATORY, INC.

1413 Old Taneytown Rd. Westminster, MD (410) 848-1014 (410) 876-4554

REPORT OF ANALYSIS

Laboratory ID #: 150716 Account #: 4035
Reference: Estates at River Hill Lot 13 Client: Trinity Quality Homes, Inc.
Location: 13604 Olivia Way Requested By: Michael Pfau
Highland, MD 20777 Source: Well Water
Date/ Time Collected: 2/28/2022 1235 Site: Kitchen Sink Tap
Date/Time Rec'd: 2/28/2022 1415 Treatment: Softener/Sediment Filter
Chlorine ppm: Free: ND Total: ND pH: 6.4
Collected By: J. Yeager 0819JY Well #: HO-17-0337

PARAMETERS	RESULTS	UNITS	REFERENCE	METHOD	DATE/TIME/ANALYST
Gross Alpha, Short Term	1.3	pCi/L	15	900.0	3/4/2022 / 0554 / MJN
Gross Beta, Short Term	<1.2	pCi/L	50	900.0	3/4/2022 / 0554 / MJN
Gross Alpha, Long Term	<1.0	pCi/L	15	900.0	3/11/2022 / 0608 / MJN
Gross Beta, Long Term	<1.2	pCi/L	50	900.0	3/11/2022 / 0608 / MJN
Radium-226	0.3	pCi/L	****	903.1	3/14/2022 / 1157 / MJN
Radium-228	<0.5	pCi/L	****	Ra-05	3/11/2022 / 0735 / MJN

NOTES:

- ****Radium 226 and Radium 228 combined have a reference of 5 pCi/L
- Long Term Gross Alpha Detection Limit: 1.0 pCi/L; Gross Alpha Error: +/- 0.9 pCi/L
- Long Term Gross Beta Detection Limit: 1.2 pCi/L; Gross Beta Error: +/- 0.9 pCi/L
- pCi/L = picocuries per liter
- Radium 226 Detection Limit: 0.1 pCi/L; Radium 226 Error: +/- 0.2 pCi/L
- Radium 228 Detection Limit: 0.5 pCi/L; Radium 228 Error: +/- 0.4 pCi/L
- Results less than or within the reference range are considered satisfactory and within potable water limits at the time of sampling.
- Short Term Gross Alpha Detection Limit: 0.9 pCi/L; Gross Alpha Error: +/- 0.9 pCi/L
- Short Term Gross Beta Detection Limit: 1.2 pCi/L; Gross Beta Error: +/- 1.0 pCi/L
- Sub-contracted to Reference Lab #278
- ND:None Detected, pH & Chlorine level tested on site
- Visual well check: Sealed, vented cap

Reason for Test : Use & Occupancy

Building Permit # : B19003296

Date Reported: 3/15/2022

Reviewed By: Catherine C Holland

FOUNTAIN VALLEY ANALYTICAL LABORATORY, INC.

1413 Old Taneytown Rd. Westminster, MD (410) 848-1014 (410) 876-4554

REPORT OF ANALYSIS

Laboratory ID #: 150867 Account #: 4035
Reference: Estates at River Hill Lot 13 Client: Trinity Quality Homes, Inc.
Location: 13604 Olivia Way Requested By: Michael Pfau
Highland, MD 20777 Source: Well Water
Date/ Time Collected: 3/9/2022 1237 Site: Kitchen Sink Tap
Date/Time Rec'd: 3/9/2022 1405 Treatment: Softener/Sediment Filter
Chlorine ppm: Free: ND Total: ND pH: 6.1
Collected By: J. Yeager 0819JY Well #: HO-17-0337

PARAMETERS	RESULTS	UNITS	REFERENCE	METHOD	DATE/TIME/ANALYST
Manganese	<0.010	mg/L	0.05*	200.7	3/16/2022 / 1033 / MAP

NOTES:

- 1 * SMCL = Secondary Maximum Contaminant Level
- 2 Manganese Detection Limit: 0.010 mg/L
- 3 mg/L = milligrams per liter (also, parts per million)
- 4 Sub-contracted to Reference Lab #192
- 5 ND:None Detected
- 6 Visual well check: Sealed, vented cap
- 7 pH & Chlorine level tested on site

Reason for Test : Use & Occupancy
Building Permit # : B19003296

Date Reported: 3/17/2022

FOUNTAIN VALLEY ANALYTICAL LABORATORY, INC.

1413 Old Taneytown Rd. Westminster, MD (410) 848-1014 (410) 876-4554

REPORT OF ANALYSIS

Laboratory ID #: 150866 Account #: 4035
Reference: Estates at River Hill Lot 13 Client: Trinity Quality Homes, Inc.
Location: 13604 Olivia Way Requested By: Michael Pfau
Highland, MD 20777 Source: Well Water
Date/ Time Collected: 3/9/2022 1237 Site: Kitchen Sink Tap
Date/Time Rec'd: 3/9/2022 1405 Treatment: Softener/Sediment Filter
Chlorine ppm: Free: ND Total: ND pH: 6.1
Collected By: J. Yeager 0819JY Well #: HO-17-0337

PARAMETERS	RESULTS	UNITS	REFERENCE	METHOD	DATE/TIME/ANALYST
Turbidity	5.01	NTU	<10	SM2130B	3/9/2022 / 1435 / MEH
Iron	0.31	mg/L	0.3*	Hach 8146	3/9/2022 / 1500 / CRS

NOTES:

- 1 *SMCL = Secondary Maximum Contaminant Level
- 2 mg/L = milligrams per liter (also, parts per million)
- 3 NTU = Nephelometric Turbidity Units
- 4 Results less than or within the reference range are considered satisfactory and within potable water limits at the time of sampling.
- 5 ND:None Detected
- 6 Visual well check: Sealed, vented cap
- 7 pH & Chlorine level tested on site

Reason for Test : Use & Occupancy

Building Permit # : B19003296

Date Reported: 3/9/2022

Reviewed By: Catherine C Holland

FOUNTAIN VALLEY ANALYTICAL LABORATORY, INC.

1413 Old Taneytown Rd. Westminster, MD (410) 848-1014 (410) 876-4554

REPORT OF ANALYSIS

Laboratory ID #:	150867	Account #:	4035
Reference:	Estates at River Hill Lot 13	Client:	Trinity Quality Homes, Inc.
Location:	13604 Olivia Way Highland, MD 20777	Requested By:	Michael Pfau
Date/ Time Collected:	3/9/2022 1237	Source:	Well Water
Date/Time Rec'd:	3/9/2022 1405	Site:	Kitchen Sink Tap
Chlorine ppm:	Free: ND Total: ND	Treatment:	Softener/Sediment Filter
Collected By:	J. Yeager 0819JY	pH:	6.1
		Well #:	HO-17-0337

PARAMETERS	RESULTS	UNITS	REFERENCE	METHOD	DATE/TIME/ANALYST
Manganese	<0.010	mg/L	0.05*	200.7	3/16/2022 / 1033 / MAP

NOTES:

- 1 * SMCL = Secondary Maximum Contaminant Level
- 2 Manganese Detection Limit: 0.010 mg/L
- 3 mg/L = milligrams per liter (also, parts per million)
- 4 Sub-contracted to Reference Lab #192
- 5 ND:None Detected
- 6 Visual well check: Sealed, vented cap
- 7 pH & Chlorine level tested on site

Reason for Test : Use & Occupancy
Building Permit # : B19003296

Date Reported: 3/17/2022

FOUNTAIN VALLEY ANALYTICAL LABORATORY, INC.

1413 Old Taneytown Rd. Westminster, MD (410) 848-1014 (410) 876-4554

REPORT OF ANALYSIS

Laboratory ID #: 150714 Account #: 4035
Reference: Estates at River Hill Lot 13 Client: Trinity Quality Homes, Inc.
Location: 13604 Olivia Way Requested By: Michael Pfau
Highland, MD 20777 Source: Well Water
Date/ Time Collected: 2/28/2022 1210 Site: Pressure Tank
Date/Time Rec'd: 2/28/2022 1415 Treatment: Prior to Softener & Sediment Filter
Chlorine ppm: Free: ND Total: ND pH: 6.6
Collected By: J. Yeager 0819JY Well #: HO-17-0337

PARAMETERS	RESULTS	UNITS	REFERENCE	METHOD	DATE/TIME/ANALYST
Bacteria, Coliform, Total, MPN	<1.0	MPN/ 100 ml	<1.0	SM20 9223B	3/1/2022 / 0930 / MEH
Bacteria, E. coli, MPN	<1.0	MPN/ 100 ml	<1.0	SM20 9223B	3/1/2022 / 0930 / MEH
Nitrate	0.41	mg/L	10	Hach 10206	3/1/2022 / 1000 / CRS
Sand	ND	mg/L	5	Visual/Gravimetric	3/1/2022 / 1100 / MEH
Turbidity	22.4	NTU	<10	SM2130B	3/1/2022 / 0830 / MEH

NOTES:

- 1 mg/L = milligrams per liter (also, parts per million)
- 2 MPN/ 100 ml = Most Probable Number [of viable bacteria] per 100 ml of sample.
- 3 NTU = Nephelometric Turbidity Units
- 4 Results less than or within the reference range are considered satisfactory and within potable water limits at the time of sampling.
- 5 ND:None Detected
- 6 Visual well check: Sealed, vented cap
- 7 pH & Chlorine level tested on site

Reason for Test : Use & Occupancy
Building Permit # : B19003296

Date Reported: 3/1/2022

Reviewed By: 

FOUNTAIN VALLEY ANALYTICAL LABORATORY, INC.

1413 Old Taneytown Rd. Westminster, MD (410) 848-1014 (410) 876-4554

REPORT OF ANALYSIS

Laboratory ID #: 150715 Account #: 4035
Reference: Estates at River Hill Lot 13 Client: Trinity Quality Homes, Inc.
Location: 13604 Olivia Way Requested By: Michael Pfau
Highland, MD 20777 Source: Well Water
Date/ Time Collected: 2/28/2022 1210 Site: Pressure Tank
Date/Time Rec'd: 2/28/2022 1415 Treatment: **
Chlorine ppm: Free: ND Total: ND pH: 6.6
Collected By: J. Yeager 0819JY Well #: HO-17-0337

PARAMETERS	RESULTS	UNITS	REFERENCE	METHOD	DATE/TIME/ANALYST
Gross Alpha, Short Term	3.0	pCi/L	15	900.0	3/4/2022 / 0554 / MJN
Gross Beta, Short Term	2.8	pCi/L	50	900.0	3/4/2022 / 0554 / MJN
Gross Alpha, Long Term	1.2	pCi/L	15	900.0	3/11/2022 / 0608 / MJN
Gross Beta, Long Term	2.8	pCi/L	50	900.0	3/11/2022 / 0608 / MJN
Radium-226	0.3	pCi/L	****	903.1	3/14/2022 / 1157 / MJN
Radium-228	1.1	pCi/L	****	Ra-05	3/11/2022 / 0735 / MJN

NOTES:

- ****Radium 226 and Radium 228 combined have a reference of 5 pCi/L
- **Sample collected prior to Softener & Sediment Filter
- Long Term Gross Alpha Detection Limit: 0.6 pCi/L; Gross Alpha Error: +/- 0.7 pCi/L
- Long Term Gross Beta Detection Limit: 1.1 pCi/L; Gross Beta Error: +/- 0.9 pCi/L
- pCi/L = picocuries per liter
- Radium 226 Detection Limit: 0.1 pCi/L; Radium 226 Error: +/- 0.2 pCi/L
- Radium 228 Detection Limit: 0.5 pCi/L; Radium 228 Error: +/- 0.4 pCi/L
- Results less than or within the reference range are considered satisfactory and within potable water limits at the time of sampling.
- Short Term Gross Alpha Detection Limit: 0.8 pCi/L; Gross Alpha Error: +/- 1.2 pCi/L
- Short Term Gross Beta Detection Limit: 1.2 pCi/L; Gross Beta Error: +/- 1.0 pCi/L
- Sub-contracted to Reference Lab #278
- ND:None Detected, pH & Chlorine level tested on site
- Visual well check: Sealed, vented cap

Reason for Test : Use & Occupancy
Building Permit # : B19003296

Date Reported: 3/15/2022

Reviewed By: Catherine C Holland