

Bureau of Environmental Health

8930 Stanford Boulevard, Columbia, MD 21045

Main: 410-313-2640 | Fax: 410-313-2648

TDD 410-313-2323 | Toll Free 1-866-313-6300

www.hchealth.org

Facebook: www.facebook.com/hocohealth

Maura J. Rossman, M.D., Health Officer

RECEIPT DATE: 10/13/20 ONSITE SEWAGE DISPOSAL SYSTEM P 572814

APPROVAL DATE: 1/19/21 (SF) PERMIT: REPAIR A

PROPERTY ADDRESS: 1845 Florence Road

SUBDIVISION: LOT: TAX ID: 04-315359

CONTRACTOR: Sam's Creek EMAIL: Sams.creek@aol.com

CONTRACTOR ADDRESS: 2810 Sams Creek Road, New Windsor, MD 21776 PHONE: 443-690-0082

PROPERTY OWNER: Jennifer and Mark Grossman EMAIL:

OWNER ADDRESS: 3998 Rye Lane, Monrovia, Maryland 21770 PHONE:

SEPTIC TANK SIZE (GALLONS): PUMP CHAMBER CAPACITY (GALLONS): PUMP SIZE:

NUMBER OF BEDROOMS: HOUSE SQ. FT. APPLICATION RATE:

DISTRIBUTION SYSTEM: GRAVITY FED [] LOW PRESSURE DOSED []

Table with 2 columns: Field Name (TRENCHES, LOCATION, NOTES) and Field Value (Linear feet required, Inlet depth, etc.)

ISSUED BY: ISSUE DATE: EXPIRATION DATE:

- NOTE: CONTRACTOR MUST SCHEDULE A PRE-CONSTRUCTION INSPECTION PRIOR TO BEGINNING ANY INSTALLATION
NOTE: CONTRACTOR MUST SCHEDULE AN INSPECTION AND GAIN APPROVAL OF ALL COMPONENTS PRIOR TO COVERING
NOTE: STONE MUST BE APPROVED BY HEALTH DEPARTMENT AND GRAVEL TICKET MUST BE AVAILABLE FOR REVIEW.
NOTE: WATERTIGHT SEPTIC TANKS REQUIRED
NOTE: ALL PARTS OF SEPTIC SYSTEM SHALL BE AT LEAST 100 FEET DOWNGRADIENT FROM ANY WATER WELL
NOTE: MANHOLE RISERS REQUIRED ON ALL SEPTIC TANKS AND PUMP CHAMBERS
NOTE: AN ELECTRICAL PERMIT IS REQUIRED FOR INSTALLATION OF ANY ELECTRICAL COMPONENTS OF THE SYSTEM
NOTE: THE HCHD DOES NOT WARRANTY ANY SYSTEM AND CANNOT GUARANTEE THE PERFORMANCE OF THIS SYSTEM AS DESIGNED.
NOTE: MDE RECOMMENDS SEPTIC TANKS, BAT, AND OTHER PRETREATMENT UNITS BE PUMPED AT A FREQUENCY ADEQUATE TO ENSURE THAT SOLIDS ARE NOT DISCHARGED TO THE DISPOSAL AREA

NEITHER THE HOWARD COUNTY COUNCIL NOR THE HEALTH DEPARTMENT IS RESPONSIBLE FOR THE SUCCESSFUL OPERATION OF ANY SYSTEM. PERMITTEE RESPONSIBLE FOR OBTAINING FINAL APPROVAL ON THIS PERMIT. CALL 410-313-1771 TO SCHEDULE INSPECTIONS.

Florence Rd
NOT TO SCALE

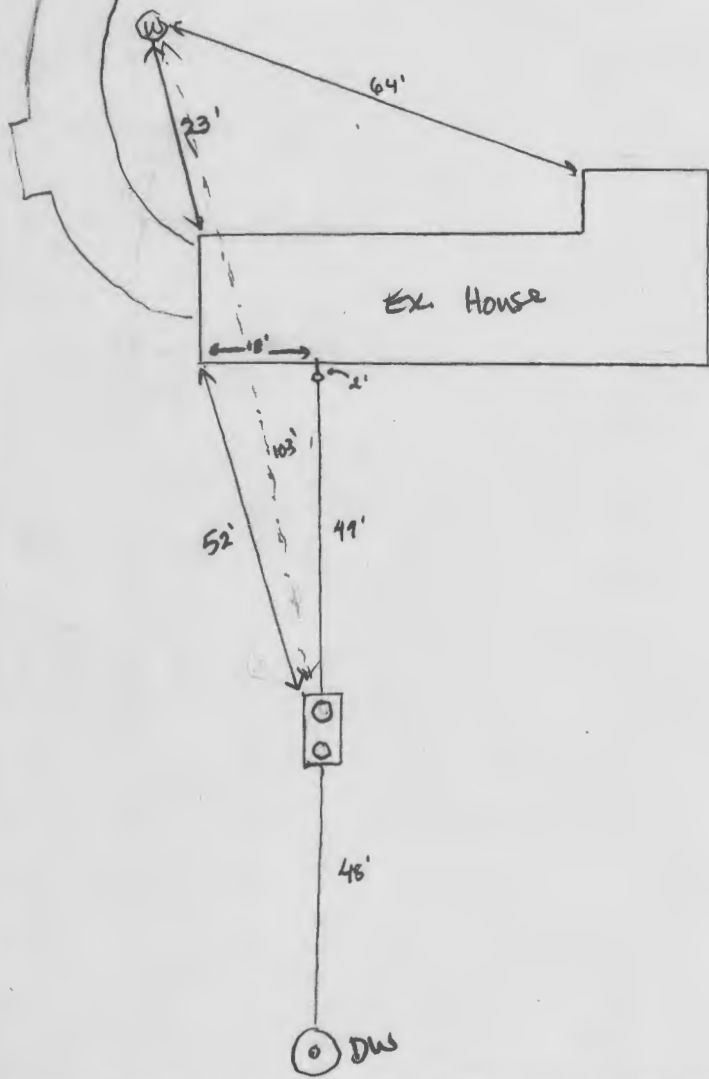

ROAD NAME

TRENCH/DRAINFIELD DATA

WIDTH _____ INLET _____ BOTTOM _____
 NUMBER OF TRENCHES _____
 TOTAL LENGTH _____
 ABSORPTION AREA _____
 DISTRIBUTION BOX LEVEL _____
 DISTRIBUTION BOX BAFFLE _____
 DISTRIBUTION BOX PORT _____

SEPTIC TANK DATA

SEPTIC TANK 1 LEVEL _____
 MANUFACTURER Balylon
 CAPACITY 1500 GAL
 SEAM LOC top
 TANK LID DEPTH 3'
 BAFFLES inlet + outlet
 BAFFLE FILTER _____
 MANHOLE LOC inlet + outlet
 6" PORT LOC _____
 WATERTIGHT TEST _____
 SLOTTED yes
 DATE ON LID 12-14-20

PUMP/SEPTIC TANK LEVEL

MANUFACTURER _____
 CAPACITY _____ GAL
 SEAM LOC _____
 TANK LID DEPTH _____
 BAFFLES _____
 BAFFLE FILTER _____
 MANHOLE LOC _____
 6" PORT LOC _____
 WATERTIGHT TEST _____
 SLOTTED _____
 DATE ON LID _____

PRE-CONSTRUCTION:

INSTALLATION: 1/19/21 Old tank collapsed and filled with gravel. Old cast iron line removed (packed with waste). New sewer line connected via Ferraco to cast iron coming out of the house. Cast iron pipe to later be replaced inside. New tank connected to ST and dry well. New obs. pipe connected to dry well obs. pipe via Ferraco. Dry well has very little liquid (ST)

FINAL INSPECTOR

Susan Thomas

DATE OF APPROVAL

1/19/21



**Howard County
Health Department**

Bureau of Environmental Health
8930 Stanford Boulevard, Columbia, MD 21045
Main: 410-313-2640 | Fax: 410-313-2648
TDD 410-313-2323 | Toll Free 1-866-313-6300
www.hchealth.org

Facebook: www.facebook.com/hocohealth

Maura J. Rossman, M.D., Health Officer

RECEIPT DATE: 10/13/20 **ONSITE SEWAGE DISPOSAL SYSTEM** P 572814

APPROVAL DATE: _____ **PERMIT:** **REPAIR** A _____

PROPERTY ADDRESS: 1845 Florence Road

SUBDIVISION: _____ LOT: _____ TAX ID: 04-315359

CONTRACTOR: Sam's Creek EMAIL: Sams.creek@aol.com

CONTRACTOR ADDRESS: 2810 Sams Creek Road, New Windsor, MD 21776 PHONE: 443-690-0082

PROPERTY OWNER: Jennifer and Mark Grossman EMAIL: _____

OWNER ADDRESS: 3998 Rye Lane, Monrovia, Maryland 21770 PHONE: _____

SEPTIC TANK SIZE (GALLONS): _____ PUMP CHAMBER CAPACITY (GALLONS): _____ PUMP SIZE: _____

NUMBER OF BEDROOMS: _____ HOUSE SQ. FT. _____ APPLICATION RATE: _____

DISTRIBUTION SYSTEM: GRAVITY FED LOW PRESSURE DOSED

TRENCHES:	LINEAR FEET REQUIRED: _____	INLET DEPTH: _____
	TRENCH WIDTH: _____	MAXIMUM BOTTOM DEPTH: _____
	MINIMUM SPACE BETWEEN TRENCHES: _____	EFFECTIVE AREA BEGINNING DEPTH: _____
LOCATION:	TO BE STAKED BY SANITARIAN DURING PRE-CONSTRUCTION INSPECTION.	
NOTES:		

ISSUED BY: _____ ISSUE DATE: _____ EXPIRATION DATE: _____

NOTE: CONTRACTOR MUST SCHEDULE A PRE-CONSTRUCTION INSPECTION PRIOR TO BEGINNING ANY INSTALLATION

NOTE: CONTRACTOR MUST SCHEDULE AN INSPECTION AND GAIN APPROVAL OF ALL COMPONENTS PRIOR TO COVERING

NOTE: STONE MUST BE APPROVED BY HEALTH DEPARTMENT AND GRAVEL TICKET MUST BE AVAILABLE FOR REVIEW.

NOTE: WATERTIGHT SEPTIC TANKS REQUIRED

NOTE: ALL PARTS OF SEPTIC SYSTEM SHALL BE AT LEAST 100 FEET DOWNGRAIENT FROM ANY WATER WELL

NOTE: MANHOLE RISERS REQUIRED ON ALL SEPTIC TANKS AND PUMP CHAMBERS

NOTE: AN ELECTRICAL PERMIT IS REQUIRED FOR INSTALLATION OF ANY ELECTRICAL COMPONENTS OF THE SYSTEM

ELECTRICAL PERMIT ISSUED E _____

NOTE: THE HCHD DOES NOT WARRANTY ANY SYSTEM AND CANNOT GUARANTEE THE PERFORMANCE OF THIS SYSTEM AS DESIGNED. BY ACCEPTING THIS PERMIT, THE OWNER AND/OR APPLICANT ACKNOWLEDGE THAT THE SPECIFICATIONS DETAILED IN THIS DESIGN ARE ONE POSSIBLE OPTION AND THAT THE HCHD WILL REVIEW OTHER PROPOSALS. YOU HAVE THE OPTION TO SEEK THE ADVICE OF A QUALIFIED DESIGN CONSULTANT OR PROFESSIONAL ENGINEER FOR FURTHER GUIDANCE.

NOTE: MDE RECOMMENDS SEPTIC TANKS, BAT, AND OTHER PRETREATMENT UNITS BE PUMPED AT A FREQUENCY ADEQUATE TO ENSURE THAT SOLIDS ARE NOT DISCHARGED TO THE DISPOSAL AREA

NEITHER THE HOWARD COUNTY COUNCIL NOR THE HEALTH DEPARTMENT IS RESPONSIBLE FOR THE SUCCESSFUL OPERATION OF ANY SYSTEM.

PERMITTEE RESPONSIBLE FOR OBTAINING FINAL APPROVAL ON THIS PERMIT.

CALL 410-313-1771 TO SCHEDULE INSPECTIONS.

NOT TO SCALE

TRENCH/DRAINFIELD DATA

WIDTH _____ INLET _____ BOTTOM _____
NUMBER OF TRENCHES _____
TOTAL LENGTH _____
ABSORPTION AREA _____
DISTRIBUTION BOX LEVEL _____
DISTRIBUTION BOX BAFFLE _____
DISTRIBUTION BOX PORT _____

SEPTIC TANK DATA

SEPTIC TANK 1 LEVEL _____
MANUFACTURER _____
CAPACITY _____ GAL
SEAM LOC _____
TANK LID DEPTH _____
BAFFLES _____
BAFFLE FILTER _____
MANHOLE LOC _____
6" PORT LOC _____
WATERTIGHT TEST _____
SLOTTED _____
DATE ON LID _____

PUMP/SEPTIC TANK LEVEL _____

MANUFACTURER _____
CAPACITY _____ GAL
SEAM LOC _____
TANK LID DEPTH _____
BAFFLES _____
BAFFLE FILTER _____
MANHOLE LOC _____
6" PORT LOC _____
WATERTIGHT TEST _____
SLOTTED _____
DATE ON LID _____

ROAD NAME

PRE-CONSTRUCTION:

INSTALLATION:

FINAL INSPECTOR _____, DATE OF APPROVAL _____

Howard County Health Department

Bureau of Environmental Health, Columbia, MD 21045 - 410-313-1771

SEWAGE DISPOSAL PERMIT NO. A- _____ P- 582814

RESIDENTIAL PERMIT
(NUMBER OF BEDROOMS: _____)

COMMERCIAL PERMIT
(DESIGN FLOW: _____ GPD)

PERMITEE: Sams Creek
LOCATION: 1845 Florence Road

****POST THIS CARD WHERE IT CAN BE SEEN FROM ROAD****

STOP ALL CONSTRUCTION ON SEWAGE DISPOSAL SYSTEM AND CONTACT HEALTH DEPARTMENT BEFORE CONTINUING
Inspector _____ Date _____

WORK IS SATISFACTORY, OK TO CONTINUE
Inspector _____ Date _____

COMMENTS: _____

FINAL INSPECTION MADE, OK TO COVER ALL WORK
Inspector _____ Date _____

SITE INSPECTION SHEET

OWNER: _____ PHONE #: _____
ADDRESS: 1845 Florence Rd CONTRACTOR: _____
Mt. Airy WELL TAG #: N/A
SUBDIVISION: _____ LOT: _____ COUNTY #: Henderson
PROPOSAL: _____

LOCATION DIAGRAM

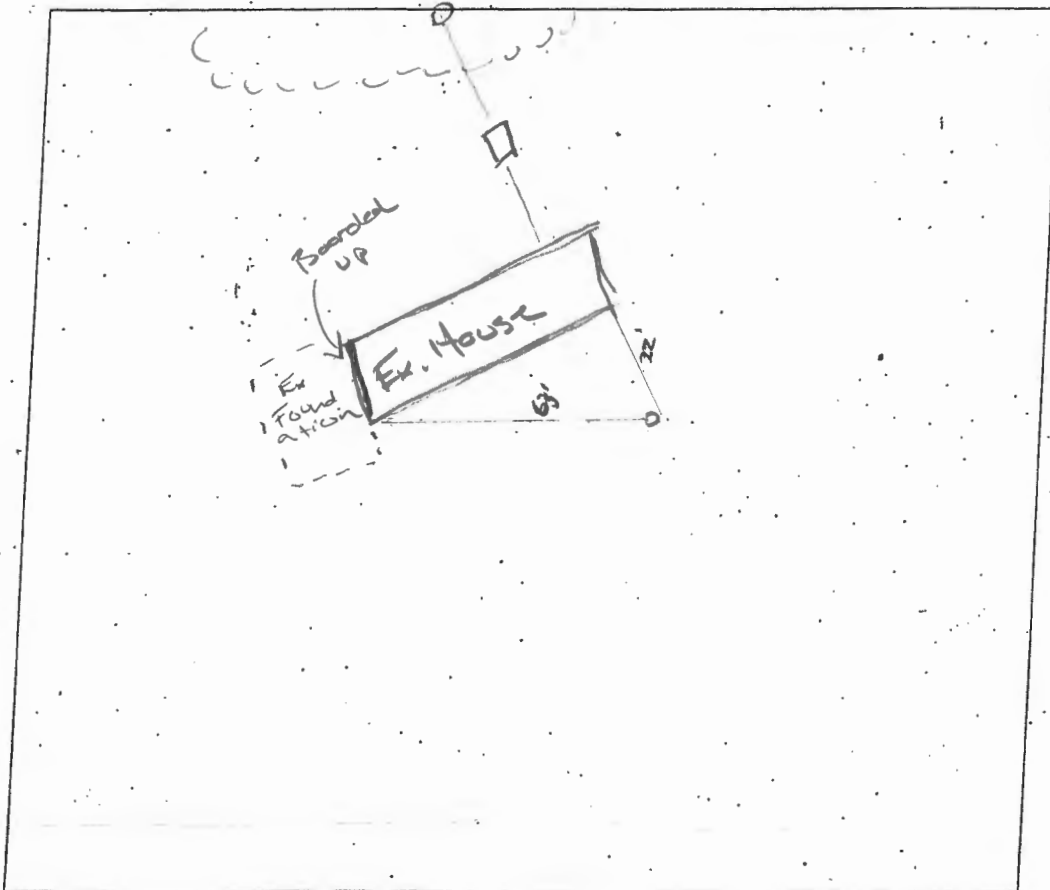

COMMENTS: Wall up to code. 1 piece up secure, 2-3' above grade.
Septic Tank no elevation. Drywell c/o broken off. No signs
of surface failure. Area dug up where tank is appear to
be slightly wet. House is falling apart. Siding coming off
missing 1/3 of house. Inside of house has all new framing.

Inside has been stripped.

DATE: November 2000 INSPECTOR: RSF

