



HOWARD COUNTY HEALTH DEPARTMENT

60632A

DATE 5/15/17

PA5  
795 5000

Received From

Fogles Septic Clean PHONE #

For

Bank Repair / Tank Roddionet  
19529 Timberlake Way / #15304  
Howard County

- CASH
- CHECK

NO.

50809

Septic Tank Empty

Dollar

\$ 600.00

Received By

SK

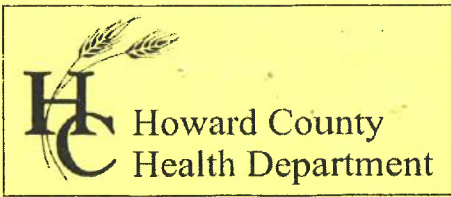

**Bureau of Environmental Health**  
 8930 Stanford Boulevard, Columbia, MD 21045  
 Main: 410-313-2640 | Fax: 410-313-2648  
 TDD 410-313-2323 | Toll Free 1-866-313-6300  
[www.hchealth.org](http://www.hchealth.org)

Facebook: [www.facebook.com/hocohealth](http://www.facebook.com/hocohealth)

Maura J. Rossman, M.D., Health Officer

RECEIPT DATE: 5/15/17      **ONSITE SEWAGE DISPOSAL SYSTEM**      P 560632-A

APPROVAL DATE: 5/24/17 (SEC)      **PERMIT:**      **REPAIR**      A \_\_\_\_\_

PROPERTY ADDRESS: 17529 Timberleigh Way

SUBDIVISION: Timberleigh Ridge      LOT: 7      TAX ID: 04-343980

CONTRACTOR: Fogle's Septic Clean Inc.      EMAIL: kim@foglesinc.com

CONTRACTOR ADDRESS: 580 Obrecht Road, Sykesville, MD 21784      PHONE: 410-795-5670

PROPERTY OWNER: Chuck Harris      EMAIL: \_\_\_\_\_

OWNER ADDRESS: 17529 Timberleigh Way, Woodbine, MD 21797      PHONE: 410-963-8788

SEPTIC TANK SIZE (GALLONS): 2000      PUMP CHAMBER CAPACITY (GALLONS): \_\_\_\_\_      PUMP SIZE: \_\_\_\_\_

NUMBER OF BEDROOMS: \_\_\_\_\_      HOUSE SQ. FT. \_\_\_\_\_      APPLICATION RATE: \_\_\_\_\_

DISTRIBUTION SYSTEM:      GRAVITY FED       LOW PRESSURE DOSED

TRENCHES:	LINEAR FEET REQUIRED: _____	INLET DEPTH: _____
	TRENCH WIDTH: _____	MAXIMUM BOTTOM DEPTH: _____
	MINIMUM SPACE BETWEEN TRENCHES: _____	EFFECTIVE AREA BEGINNING DEPTH: _____
LOCATION:	<b>TO BE STAKED BY SANITARIAN DURING PRE-CONSTRUCTION INSPECTION.</b>	
NOTES:	<i>Install a 2000-gal, 2-compartment, slotted tank. Pump + crush old tank.</i>	

ISSUED BY: Sarah Collins      ISSUE DATE: 5/23/17      EXPIRATION DATE: 5/23/18

- NOTE: CONTRACTOR MUST SCHEDULE A PRE-CONSTRUCTION INSPECTION PRIOR TO BEGINNING ANY INSTALLATION**
- NOTE: CONTRACTOR MUST SCHEDULE AN INSPECTION AND GAIN APPROVAL OF ALL COMPONENTS PRIOR TO COVERING
- NOTE: STONE MUST BE APPROVED BY HEALTH DEPARTMENT AND GRAVEL TICKET MUST BE AVAILABLE FOR REVIEW.
- NOTE: WATERTIGHT SEPTIC TANKS REQUIRED
- NOTE: ALL PARTS OF SEPTIC SYSTEM SHALL BE AT LEAST 100 FEET DOWNGRADIENT FROM ANY WATER WELL
- NOTE: MANHOLE RISERS REQUIRED ON ALL SEPTIC TANKS AND PUMP CHAMBERS
- NOTE: **AN ELECTRICAL PERMIT IS REQUIRED FOR INSTALLATION OF ANY ELECTRICAL COMPONENTS OF THE SYSTEM**  
 ELECTRICAL PERMIT ISSUED      E \_\_\_\_\_
- NOTE: **THE HCHD DOES NOT WARRANTY ANY SYSTEM AND CANNOT GUARANTEE THE PERFORMANCE OF THIS SYSTEM AS DESIGNED. BY ACCEPTING THIS PERMIT, THE OWNER AND/OR APPLICANT ACKNOWLEDGE THAT THE SPECIFICATIONS DETAILED IN THIS DESIGN ARE ONE POSSIBLE OPTION AND THAT THE HCHD WILL REVIEW OTHER PROPOSALS. YOU HAVE THE OPTION TO SEEK THE ADVICE OF A QUALIFIED DESIGN CONSULTANT OR PROFESSIONAL ENGINEER FOR FURTHER GUIDANCE.**
- NOTE: MDE RECOMMENDS SEPTIC TANKS, BAT, AND OTHER PRETREATMENT UNITS BE PUMPED AT A FREQUENCY ADEQUATE TO ENSURE THAT SOLIDS ARE NOT DISCHARGED TO THE DISPOSAL AREA

**NEITHER THE HOWARD COUNTY COUNCIL NOR THE HEALTH DEPARTMENT IS RESPONSIBLE FOR THE SUCCESSFUL OPERATION OF ANY SYSTEM.**  
**PERMITTEE RESPONSIBLE FOR OBTAINING FINAL APPROVAL ON THIS PERMIT.**  
**CALL 410-313-1771 TO SCHEDULE INSPECTIONS.**

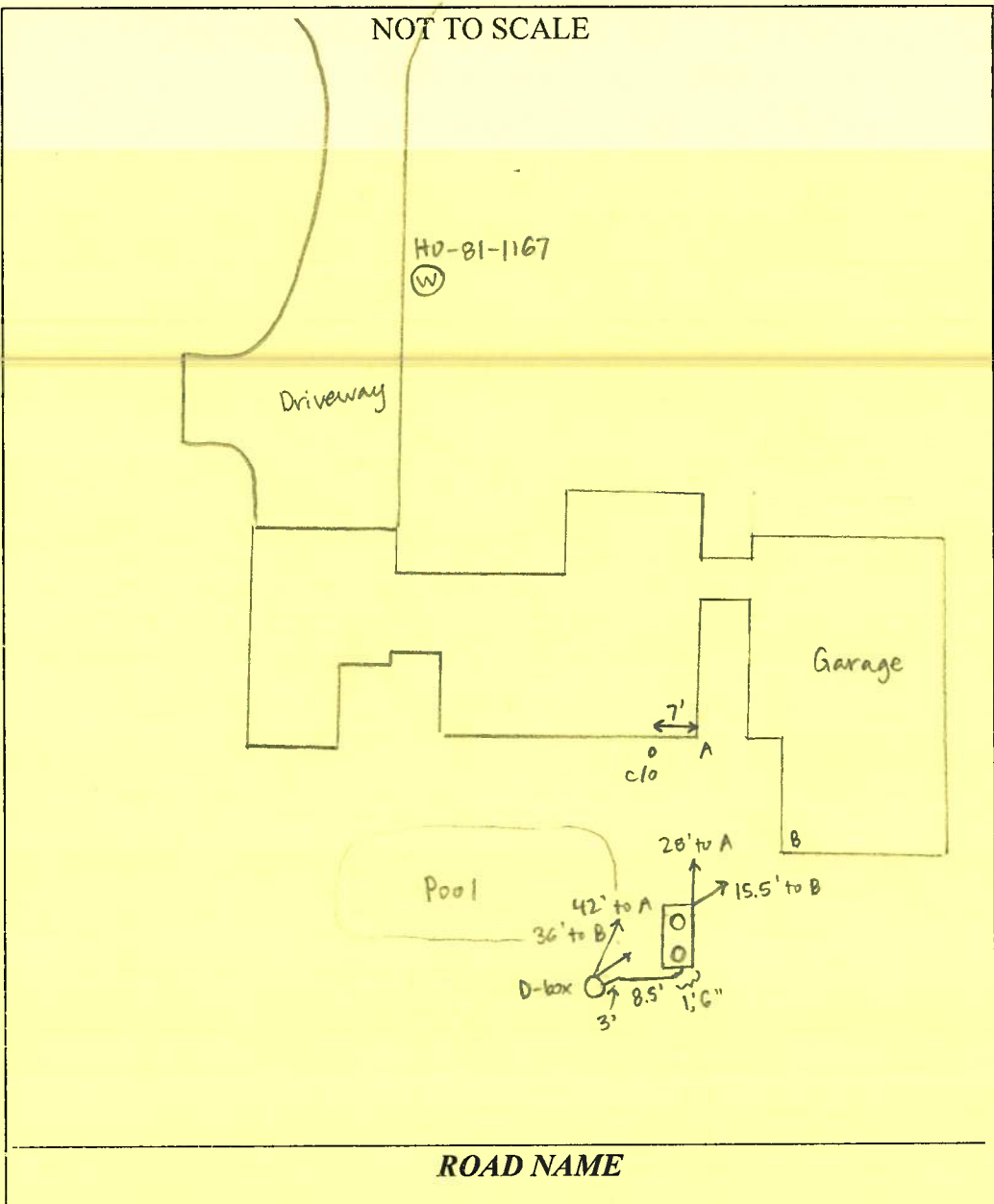

**TRENCH/DRAINFIELD DATA**

WIDTH	INLET	BOTTOM
_____	_____	_____
NUMBER OF TRENCHES _____		
TOTAL LENGTH _____		
ABSORPTION AREA _____		
DISTRIBUTION BOX LEVEL _____		
DISTRIBUTION BOX BAFFLE _____		
DISTRIBUTION BOX PORT _____		

**SEPTIC TANK DATA**

SEPTIC TANK I LEVEL YES

MANUFACTURER BABYLON

CAPACITY 2000 GAL

SEAM LOC TOP

TANK LID DEPTH 2'

BAFFLES YES

BAFFLE FILTER NO

MANHOLE LOC FRONT - REAR

6" PORT LOC NONE

WATERTIGHT TEST NO

SLOTTED YES

DATE ON LID 3-26-17

---

~~PUMP/SEPTIC TANK LEVEL \_\_\_\_\_~~

~~MANUFACTURER \_\_\_\_\_~~

~~CAPACITY \_\_\_\_\_ GAL~~

~~SEAM LOC \_\_\_\_\_~~

~~TANK LID DEPTH \_\_\_\_\_~~

~~BAFFLES \_\_\_\_\_~~

~~BAFFLE FILTER \_\_\_\_\_~~

~~MANHOLE LOC \_\_\_\_\_~~

~~6" PORT LOC \_\_\_\_\_~~

~~WATERTIGHT TEST \_\_\_\_\_~~

~~SLOTTED \_\_\_\_\_~~

~~DATE ON LID \_\_\_\_\_~~

**PRE-CONSTRUCTION:**

5/23/17 Met Fogle's and the homeowner on site. Homeowner is opting to upgrade to a 2000-gal tank for potential future increase in # of bedrooms. Pulled 20' off existing house + garage to determine site for new tank. Fogle's will pump + collapse old tank. Homeowner will submit garage floor plans - house is 3BR, trenches sized for 4BR, will need more trench if house + garage  $\geq$  5 BR. (SC)

**INSTALLATION:**

5/24/17 New tank set and connected to house + D-box. Old tank to be pumped + collapsed (Fogle's waiting on pump truck). D-box has a circular cover - Fogle's marked location w/ 4" standpipe. Drain line from pool patio water runs over tank + daylights below swingset, below lower trench. (SC)

FINAL INSPECTOR Sarah Collins DATE OF APPROVAL 5/24/17

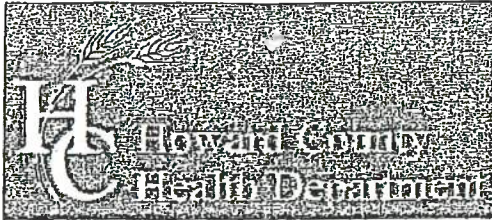

Bureau of Environmental Health

8930 Stanford Boulevard, Columbia, MD 21045

Main: 410-313-2640 | Fax: 410-313-2648

TDD 410-313-2323 | Toll Free 1-866-313-6300

www.hchealth.org

Facebook: www.facebook.com/hocohealth

Twitter: HowardCoHealthDep

Dr. Maura J. Rossman, M.D., Health Officer

INFORMATION FORM - SEPTIC SYSTEM REPAIR/UPGRADE

Reason for Request:

- Reason for Request options: Failing System, System relocation for proposed addition, System upgrade for proposed addition, Inadequate treatment zone, Collapsed septic tank, Collapsed drywell

Has the septic tank been pumped within the last month?

- Has the septic tank been pumped options: Yes, No

Was a visual inspection of the septic tank and/or drain fields conducted?

- Was a visual inspection of the septic tank and/or drain fields conducted options: Yes, No

Existing system design

- Existing system design options: Drywell, Trench, Mound, Unknown, Other

Was a visual inspection of the sewage line conducted?

- Was a visual inspection of the sewage line conducted options: Yes, No

Is discharge surfacing on the ground?

- Is discharge surfacing on the ground options: Yes, No

Additional Comments:

\*For REPAIRS, are the owners proposing, or do they plan to add in the future, any additions or modifications to the property, i.e. pools, living space additions, garages, etc? This information must be disclosed at the time of this application. The Health Department will not be able to accommodate requests in the field for property modifications unrelated to the repair request. Such requests may require an additional fee, testing, and submittal of a Percolation Certification Plan, if the property does not meet current Code and Regulation.

Septic Contractor: Fogle's Septic Clean Contractor's Phone: 410-795-5670
Contractor's Address: 580 Obrecht Rd Sykesville Md 21784
Property Address: 17529 Timberleigh Way County file:
Subdivision: Timberleigh Ridge 0 Lot: 17 Year Built: 1985
Owner's Name: Chuck Harris Owner's Phone: 410-963-8788
Name of previous owners: Taylor Martin Existing bedrooms: 3
Proposed bedrooms: 3

Has this request been previously discussed with a Sanitarian? (Name): Robert Spencer
Public Sewer available/nearby: NO

\*A Sanitarian will be in contact within three business days, depending upon the urgency of the situation, to coordinate the scheduling/review of the repair or upgrade.

\*Prior to scheduling inspections, scaled plans should be submitted to clarify the nature of the addition.\*

Print out a copy of Real Property Data via Dept. of Taxation website Indexed file found

If public sewer may be nearby, verify whether sewer is technically "available" through the Bureau of Engineering.

If sewer is available and the property is within the Metropolitan District, connection to sewer is required. If the owner believes reason for exemption exists, the owner should justify the request in writing.

If soil/site conditions are limited and sewer and/or Metro District status is not conducive to connection, the Sanitarian may recommend pursuit of Emergency Sewer Extension or Emergency Metro District Inclusion. The Owner should contact the Bureau of Utilities for details.

No permit is to be issued nor inspection to be scheduled without prior fee collection at the office unless an emergency situation exists. The contractor is to notify office of the emergency situation as soon as possible.