

Bureau of Environmental Health

8930 Stanford Boulevard, Columbia, MD 21045

Main: 410-313-2640 | Fax: 410-313-2648

TDD 410-313-2323 | Toll Free 1-866-313-6300

www.hchealth.org

Facebook: www.facebook.com/hocohealth

Twitter: [HowardCoHealthDep](https://twitter.com/HowardCoHealthDep)

Maura J. Rossman, M.D., Health Officer

Date: May 25, 2018

To: Justin Earp & Kirsten Earp
12124 Carroll Mill Ct.
Ellicott City, MD 21042

Re: Percolation Test Report
Woodmark, Lot 63 BL E S 3
12124 Carroll Mill Ct.
Ellicott City, MD 21042

Percolation tests were conducted at 12124 Carroll Mill Ct. (Tax Map 23, Parcel 89) on May 22nd 2018. Tests and profile descriptions were documented for locations 1, 2, 3, 4 and 5. All five test holes passed (1, 2, 3, 4 and 5). All holes must be field located and accurately represented on the perc certification plan.

All percolation tests conducted were standard tests, measuring rate of fall for a pre-wet period followed by measurement and recordation of the time required for the water level to drop 1 inch. Areas that may be included in the septic reserve area are represented by test locations having satisfactory soil conditions. The area must be large enough to accommodate an initial and two replacement systems. If three systems will not fit an initial and one replacement with Best Available Technology will be required.

The next step in the process is to have an engineer/consultant submit a percolation certification plan to confirm the design of the sewage disposal area.

Should you have any questions regarding this evaluation, please contact me. I may be reached at (410) 313-6357 or by email rfreemon@howardcountymd.gov

Respectfully,

A handwritten signature in black ink, appearing to read 'Robert Freemon', is written above the printed name.

Robert Freemon
Bureau of Environmental Health
Well & Septic Program

Attachment: Percolation Field Notes

Carroll Mill Court

AP AS62970

- (5)
 - 4" PB SL
 - 17" DYS, SL, MSBK, Few Fine Mica, MFI
 - 27" SB, L, 2FSBK, Many Fine Mica, SS
 - 35" SB, FSL, 2FSBK, Many Fine Mica
 - 144" RY, YR, LS Thin Platy, Micaceous
- (2)
 - 4" DB, SL, VFSBK
 - 21" DYS, LS, Thick Platy, Few Fine Mica
 - 38" SB, L, 2FSBK, Many Fine Mica, SS
 - 40" BY, LS, Thin platy
 - 144" ↓
- (3)
 - 4" PB, SL
 - 22" DYS, LS, 75% Cobble,
 - 76" SB, Heavy L, SS, OM
 - 168" Whitish, Greyish, Sand

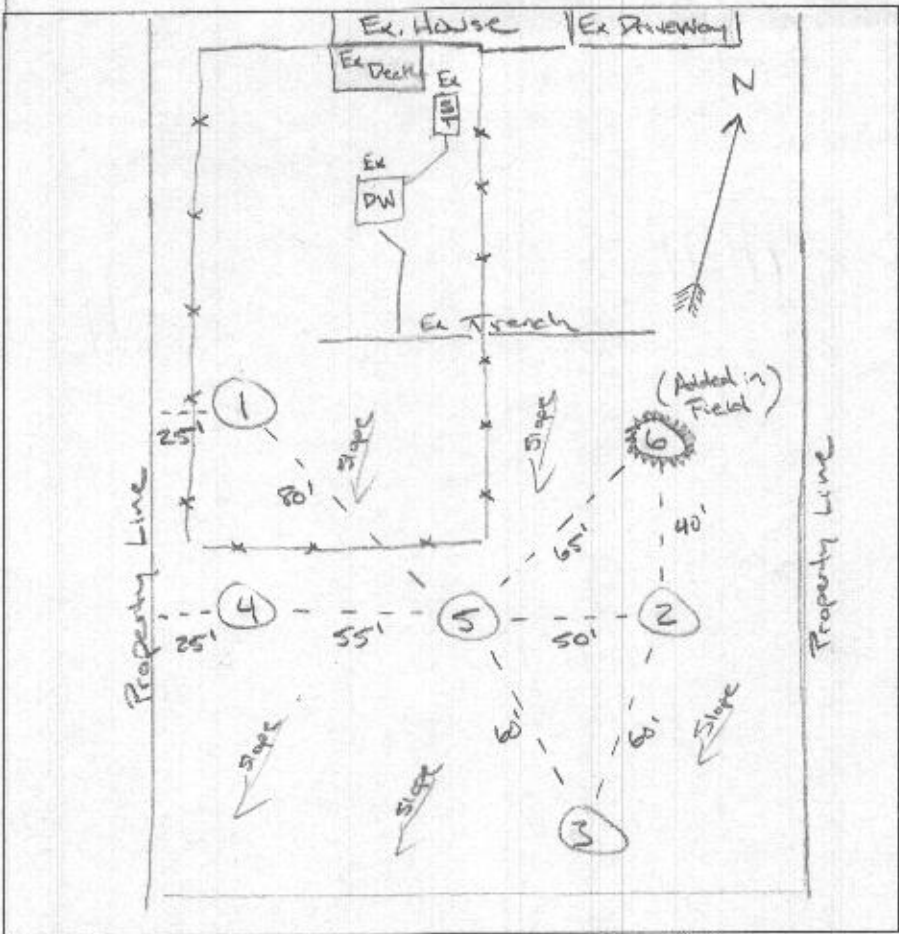

- (6)
 - 5" DB Loam
 - 22" DYS, SL, FSBK
 - 26" YR, SL, Thick Platy
 - 32" DB, Gray, LS Thick Platy
 - 144" BY, LS, OM, CW
- (4)
 - 24" DYS, SL, Wear FSBK
 - 57" SB, L, 3FSBK, Few Fine Mica
 - 72" SB, Heavy SL, 3FSBK
 - 192" CW, LS, Platy
- (1) S A M E A S
- (2)

DATE	TEST #	DEPTH	START	BREAK 1" DROP	STOP 2" DROP	TIME OF 2ND INCH	P/F/H
5/24/2018	5	5' / 12'	9:59	10:03	10:09	6	P
	2	5' / 12'	10:09	10:11	10:16	5	P
	3	5' / 14'	11:05	11:25	11:55	>30	F
	6	5' / 12'	1:33	1:36	1:41	5	P
	4	5' / 16'	2:04	2:24	2:44 Not 1/2 way	>30	F
	4	6' / 25'	2:50	3:06	3:31	25	P
	1	12'	VISUAL				P

REMARKS Down poured rain between 12:00 - 1:30
 SANITARIAN RSF BACKHOE Maryland Excavators OTHERS Justin Eare (owner)
 TEST HOLES USED IN SDA _____ AVG. PERC TIME _____ SQ. FT/BR _____
 TRENCH WIDTH _____ INLET DEPTH _____ MAX. BOT DEPTH _____ EFFECTIVE SW _____

Tax ID 1403286746

Freemon, Robert

From: Freemon, Robert
Sent: Friday, May 25, 2018 1:37 PM
To: Justin Earp; 'Kirsten E'
Cc: 'Mike Tran'
Subject: 12124 Carroll Mill Ct.
Attachments: Perc Results Letter.pdf; Spec Sheet.pdf; SDA.pdf; Well & Septic SETBACKS.PDF; Perc-Site Plan REQ.PDF; OSDS Req.pdf

Hi,

Attached is your perc results letter. Also attached is the spec sheet for the septic system design and the test plan showing the new SDA. If more area is needed to fit the systems you can expand the SDA east and west up to 5' from the property line. If expansions north and south are needed additional perc testing will be required prior to allowing these areas to be used. The perc cert plan will need to show everything required on the "Perc-Site Plan" attachment. It will also need to show the 3 systems trench layout along with the calculations. This is so we can verify that all three systems do in fact fit inside the new SDA. I will be off all next week so if you have any questions please call 410-313-1771 and ask to speak to the sanitarian on desk. They may be able to answer your questions.

Robert "Spencer" Freemon
Howard County Health Department
8930 Stanford Blvd. Columbia, MD 21045
Bureau of Environmental Health
Well and Septic Program
Phone: 410-313-6357
Email: rfreemon@howardcountymd.gov
Website: <https://www.howardcountymd.gov/Departments/Health/Environmental-Health/Well-and-Septic>

SEPTIC SYSTEM TRENCH DESIGN SPECIFICATIONS

<p>INITIAL SYSTEM:</p> <ul style="list-style-type: none"> - APPLICATION RATE: 0.8 - EFFECTIVE AREA BEGINNING DEPTH: 4' - BOTTOM MAXIMUM DEPTH: 8' <p>1. DESIGN FLOW:</p> <ul style="list-style-type: none"> - 5 BEDROOMS AT 150 GAL/DAY - 5 X 150 GPD = 750 GPD <p>2. SQUARE FOOTAGE OF DRAIN FIELD REQUIRED:</p> <ul style="list-style-type: none"> - DESIGN FLOW (750 GPD) / APPLICATION RATE (0.8) = 937.5 SF <p>3. SIDEWALL REDUCTION CREDIT:</p> <ul style="list-style-type: none"> - TRENCH WIDTH (W) = 3' - TRENCH EFFECTIVE DEPTH (D) = 4' - $(W+2) / (W+1+2D) \times 100 = 41.67\% = 0.4167$ <p>4. LINEAR LENGTH OF TRENCH REQUIRED:</p> <ul style="list-style-type: none"> - DRAIN FIELD SQUARE FOOTAGE (937.5) X SIDEWALL REDUCTION CREDIT (0.4167) / TRENCH WIDTH (3) = 131.2 LF <p>5. LINEAR LENGTH OF TRENCH PROVIDED = 132 LF</p> <ul style="list-style-type: none"> - TWO TRENCHES 66 LF/EACH <p>6. EXISTING GRADE: TRENCH R1-A: 399.7 TRENCH R1-B: 399.0</p> <p>7. INVERT: TRENCH R1-A: 395.7 TRENCH R1-B: 395.0</p>	<p>REPLACEMENT SYSTEM #1:</p> <ul style="list-style-type: none"> - APPLICATION RATE: 0.8 - EFFECTIVE AREA BEGINNING DEPTH: 4' - BOTTOM MAXIMUM DEPTH: 8' <p>1. DESIGN FLOW:</p> <ul style="list-style-type: none"> - 5 BEDROOMS AT 150 GAL/DAY - 5 X 150 GPD = 750 GPD <p>2. SQUARE FOOTAGE OF DRAIN FIELD REQUIRED:</p> <ul style="list-style-type: none"> - DESIGN FLOW (750 GPD) / APPLICATION RATE (0.8) = 937.5 SF <p>3. SIDEWALL REDUCTION CREDIT:</p> <ul style="list-style-type: none"> - TRENCH WIDTH (W) = 3' - TRENCH EFFECTIVE DEPTH (D) = 4' - $(W+2) / (W+1+2D) \times 100 = 41.67\% = 0.4167$ <p>4. LINEAR LENGTH OF TRENCH REQUIRED:</p> <ul style="list-style-type: none"> - DRAIN FIELD SQUARE FOOTAGE (937.5) X SIDEWALL REDUCTION CREDIT (0.4167) / TRENCH WIDTH (3) = 131.2 LF <p>5. LINEAR LENGTH OF TRENCH PROVIDED = 132 LF</p> <ul style="list-style-type: none"> - TWO TRENCHES 66 LF/EACH <p>6. EXISTING GRADE: TRENCH R1-A: 399.3 TRENCH R1-B: 398.3</p> <p>7. INVERT: TRENCH R1-A: 395.3 TRENCH R1-B: 394.3</p>	<p>REPLACEMENT SYSTEM #2:</p> <ul style="list-style-type: none"> - APPLICATION RATE: 0.8 - EFFECTIVE AREA BEGINNING DEPTH: 4' - BOTTOM MAXIMUM DEPTH: 8' <p>1. DESIGN FLOW:</p> <ul style="list-style-type: none"> - 5 BEDROOMS AT 150 GAL/DAY - 5 X 150 GPD = 750 GPD <p>2. SQUARE FOOTAGE OF DRAIN FIELD REQUIRED:</p> <ul style="list-style-type: none"> - DESIGN FLOW (750 GPD) / APPLICATION RATE (0.8) = 937.5 SF <p>3. SIDEWALL REDUCTION CREDIT:</p> <ul style="list-style-type: none"> - TRENCH WIDTH (W) = 3' - TRENCH EFFECTIVE DEPTH (D) = 4' - $(W+2) / (W+1+2D) \times 100 = 41.67\% = 0.4167$ <p>4. LINEAR LENGTH OF TRENCH REQUIRED:</p> <ul style="list-style-type: none"> - DRAIN FIELD SQUARE FOOTAGE (937.5) X SIDEWALL REDUCTION CREDIT (0.4167) / TRENCH WIDTH (3) = 131.2 LF <p>5. LINEAR LENGTH OF TRENCH PROVIDED = 132 LF</p> <ul style="list-style-type: none"> - TWO TRENCHES 66 LF/EACH <p>6. EXISTING GRADE: TRENCH R2-A: 398.0 TRENCH R2-B: 397.3</p> <p>7. INVERT: TRENCH R2-A: 394.0 TRENCH R2-B: 393.3</p>
---------------------------------------------------------------------------------------------------------------------------------------------------------------------------------------------------------------------------------------------------------------------------------------------------------------------------------------------------------------------------------------------------------------------------------------------------------------------------------------------------------------------------------------------------------------------------------------------------------------------------------------------------------------------------------------------------------------------------------------------------------------------------------------------------------------------------------------------------------------------------------------------------------------------------------------------------------------------------------------------------------------------------------------------------------------------------------------------------------------------------------------------------------------------------------------------------------------------------------------------------------	----------------------------------------------------------------------------------------------------------------------------------------------------------------------------------------------------------------------------------------------------------------------------------------------------------------------------------------------------------------------------------------------------------------------------------------------------------------------------------------------------------------------------------------------------------------------------------------------------------------------------------------------------------------------------------------------------------------------------------------------------------------------------------------------------------------------------------------------------------------------------------------------------------------------------------------------------------------------------------------------------------------------------------------------------------------------------------------------------------------------------------------------------------------------------------------------------------------------------------------------------------------	----------------------------------------------------------------------------------------------------------------------------------------------------------------------------------------------------------------------------------------------------------------------------------------------------------------------------------------------------------------------------------------------------------------------------------------------------------------------------------------------------------------------------------------------------------------------------------------------------------------------------------------------------------------------------------------------------------------------------------------------------------------------------------------------------------------------------------------------------------------------------------------------------------------------------------------------------------------------------------------------------------------------------------------------------------------------------------------------------------------------------------------------------------------------------------------------------------------------------------------------------------------

- NOTES:**
- THE PURPOSE OF THIS PLAT IS TO OBTAIN APPROVAL FOR A PRIVATE SEWAGE AREA OF 10,000 SQUARE FEET TO ACCOMMODATE AN ADDITION TO THE HOUSE.
 - TOPOGRAPHY SHOWN ON THIS LOT WAS FIELD RUN BY SHANABERGER & LANE IN JUNE, 2018, ON THE NAVD85 SYSTEM, USING BENCHMARK 22FM, ELEVATION 402.400. TOPOGRAPHY ON SURROUNDING PROPERTIES IS FROM 2013 HOWARD COUNTY LIDAR.
 - BOUNDARY LINES ON THIS PLAT ARE FROM PLAT BOOK 15, FOLIO 40, AND FROM PROPERTY CORNER LOCATIONS BY SHANABERGER & LANE IN JUNE, 2018. BOUNDARY LINES SHOWN HEREON DO NOT REPRESENT A BOUNDARY SURVEY.
 - ONSITE IMPROVEMENTS WITHIN THE LIMITS OF FIELD RUN TOPOGRAPHY WERE LOCATED BY SHANABERGER & LANE IN JUNE, 2018. OTHER IMPROVEMENTS SHOWN ARE FROM 2013 HOWARD COUNTY LIDAR. ONSITE WELL AND SEPTIC SYSTEM COMPONENTS, AND 2 OFFSITE SEPTIC SYSTEM COMPONENTS WERE FIELD-LOCATED IN JUNE, 2018.
 - OTHER EXISTING WELL AND SEPTIC SYSTEM LOCATIONS SHOWN HEREON ARE FROM AVAILABLE HOWARD COUNTY HEALTH DEPARTMENT RECORDS.
6. FUTURE WELL
 EXISTING WELL
--- SOIL TYPE BOUNDARY
--- WOODS/LINE/TREES
 SUCCESSFUL PERC TEST
 FAILED PERC TEST
7. SOIL TYPES PER N.R.C.S. WEB SOIL SURVEY:
GgB-Glenelig loam, 3 to 8 percent slopes
GgC-Glenelig loam, 8 to 15 percent slopes
GnB-Glenelig-silt loam, 0 to 8 percent slopes
8. --- DESIGNATES LIMITS OF FIELD-RUN TOPOGRAPHY
9. ANY CHANGE TO A PRIVATE SEWAGE AREA SHALL REQUIRE A REVISED PERC CERTIFICATION PLAN.
10. ALL KNOWN EXISTING WELLS AND SEWAGE DISPOSAL AREAS WITHIN 100' OF THE PROPERTY AND WELLS WITHIN 200' DOWNSLOPE OF THE PROPOSED SDA HAVE BEEN SHOWN PER FIELD LOCATION WHEN POSSIBLE AND PER AVAILABLE RECORDS WHEN NOT POSSIBLE.
11. THIS AREA DESIGNATES A PRIVATE SEWAGE AREA TO ACCOMMODATE 3 SYSTEMS AS REQUIRED BY THE MARYLAND STATE DEPARTMENT OF THE ENVIRONMENT FOR INDIVIDUAL SEWAGE DISPOSAL (COMAR 26.04.03). IMPROVEMENTS OF ANY NATURE IN THIS AREA ARE RESTRICTED UNTIL PUBLIC SEWERAGE IS AVAILABLE. THESE AREAS SHALL BECOME NULL AND VOID UPON CONNECTION TO A PUBLIC SEWERAGE SYSTEM. THE COUNTY HEALTH OFFICER SHALL HAVE THE AUTHORITY TO GRANT ADJUSTMENTS TO THE PRIVATE SEWAGE AREA. RECORDATION OF A MODIFIED SEWAGE AREA SHALL NOT BE NECESSARY.
12. THE LOT SHOWN HEREON COMPLIES WITH THE MINIMUM OWNERSHIP WIDTH AND LOT AREA AS REQUIRED BY THE MARYLAND DEPARTMENT OF THE ENVIRONMENT.
13. THE NEW SEPTIC SYSTEM MUST BE INSTALLED PRIOR TO HEALTH DEPARTMENT APPROVAL OF A BUILDING PERMIT.
14. DESIGNATES APPROVED PERC AREA.

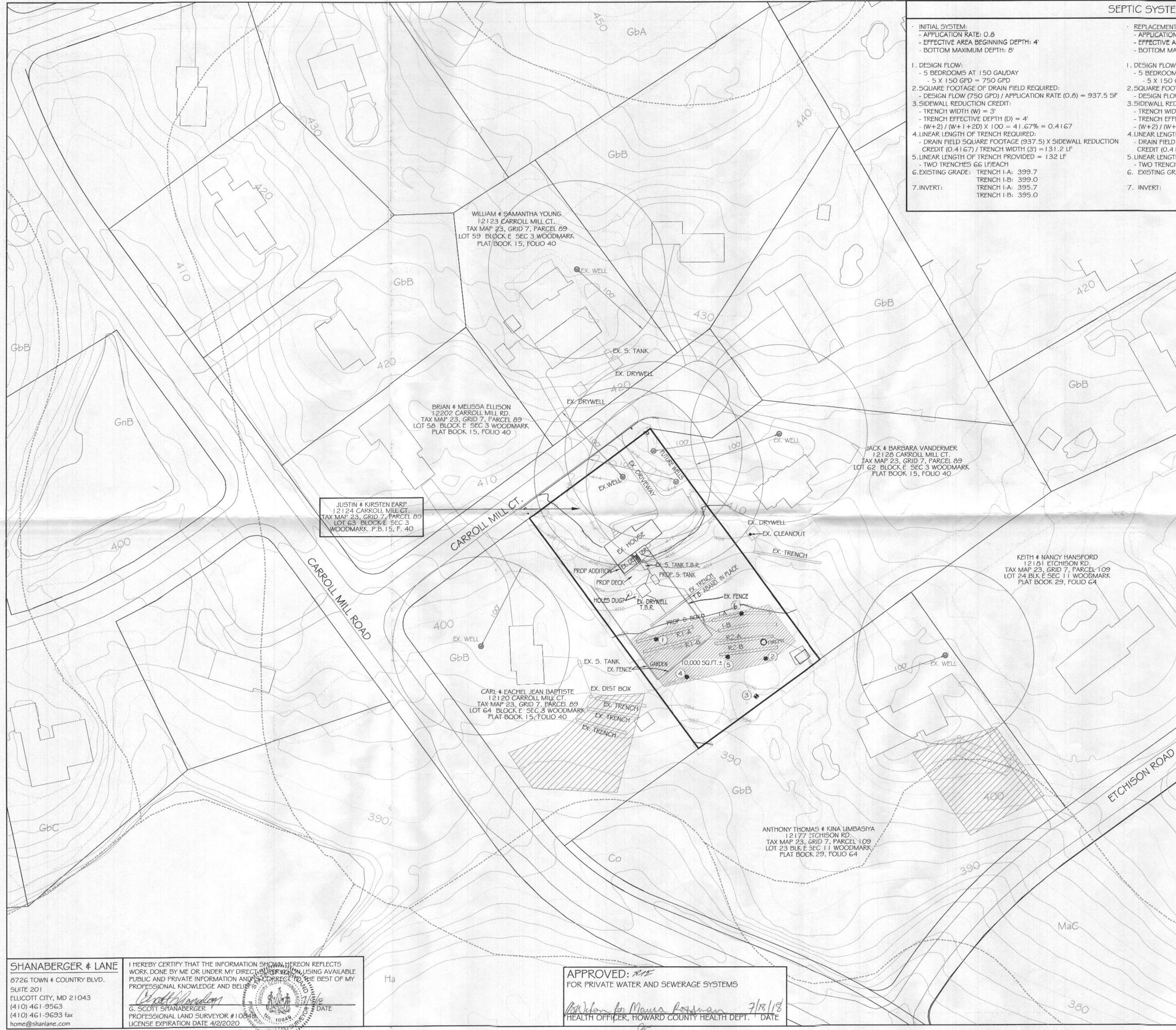

SHANABERGER & LANE
8726 TOWN & COUNTRY BLVD.
SUITE 201
ELLCOTT CITY, MD 21043
(410) 461-9563
(410) 461-9693 fax
home@shanlane.com

I HEREBY CERTIFY THAT THE INFORMATION SHOWN HEREON REFLECTS WORK DONE BY ME OR UNDER MY DIRECT SUPERVISION, USING AVAILABLE PUBLIC AND PRIVATE INFORMATION AND IS CORRECT TO THE BEST OF MY PROFESSIONAL KNOWLEDGE AND BELIEF.

G. Scott Shanaberger
G. SCOTT SHANABERGER
PROFESSIONAL LAND SURVEYOR #10049
LICENSE EXPIRATION DATE 4/2/2020

APPROVED: *[Signature]*
FOR PRIVATE WATER AND SEWERAGE SYSTEMS

[Signature] 7/18/18
HEALTH OFFICER, HOWARD COUNTY HEALTH DEPT. DATE

OWNERS
JUSTIN C. EARP
KIRSTEN C. EARP
12124 CARROLL MILL CT.
ELLCOTT CITY, MD. 21042

PERC CERTIFICATION PLAT
12124 CARROLL MILL COURT
LOT 63 BLOCK E SEC. 3 WOODMARK
PLAT BOOK 15, FOLIO 40 TITLE DEED: 12394/23
TAX MAP 23, GRID 7, PARCEL 89
3rd ELECTION DISTRICT, HOWARD COUNTY, MD.
SCALE: 1" = 50' DATE: 6/14/18 REV: 6/27/18, 7/15/18
PURPOSE: TO EXPAND SEWAGE DISPOSAL AREA TO ACCOMMODATE ADDITION

SEPTIC SYSTEM TRENCH DESIGN SPECIFICATIONS

INITIAL SYSTEM:	REPLACEMENT SYSTEM #1:	REPLACEMENT SYSTEM #2:
- APPLICATION RATE: 0.8	- APPLICATION RATE: 0.8	- APPLICATION RATE: 0.8
- EFFECTIVE AREA BEGINNING DEPTH: 4'	- EFFECTIVE AREA BEGINNING DEPTH: 4'	- EFFECTIVE AREA BEGINNING DEPTH: 4'
- BOTTOM MAXIMUM DEPTH: 8'	- BOTTOM MAXIMUM DEPTH: 8'	- BOTTOM MAXIMUM DEPTH: 8'
1. DESIGN FLOW: - 5 BEDROOMS AT 150 GAL/DAY - 5 X 150 GPD = 750 GPD	1. DESIGN FLOW: - 5 BEDROOMS AT 150 GAL/DAY - 5 X 150 GPD = 750 GPD	1. DESIGN FLOW: - 5 BEDROOMS AT 150 GAL/DAY - 5 X 150 GPD = 750 GPD
2. SQUARE FOOTAGE OF DRAIN FIELD REQUIRED: - DESIGN FLOW (750 GPD) / APPLICATION RATE (0.8) = 937.5 SF	2. SQUARE FOOTAGE OF DRAIN FIELD REQUIRED: - DESIGN FLOW (750 GPD) / APPLICATION RATE (0.8) = 937.5 SF	2. SQUARE FOOTAGE OF DRAIN FIELD REQUIRED: - DESIGN FLOW (750 GPD) / APPLICATION RATE (0.8) = 937.5 SF
3. SIDEWALL REDUCTION CREDIT: - TRENCH WIDTH (W) = 3' - TRENCH EFFECTIVE DEPTH (D) = 4' - $(W+2) / (W+1+2D) \times 100 = 41.67\% = 0.4167$	3. SIDEWALL REDUCTION CREDIT: - TRENCH WIDTH (W) = 3' - TRENCH EFFECTIVE DEPTH (D) = 4' - $(W+2) / (W+1+2D) \times 100 = 41.67\% = 0.4167$	3. SIDEWALL REDUCTION CREDIT: - TRENCH WIDTH (W) = 3' - TRENCH EFFECTIVE DEPTH (D) = 4' - $(W+2) / (W+1+2D) \times 100 = 41.67\% = 0.4167$
4. LINEAR LENGTH OF TRENCH REQUIRED: - DRAIN FIELD SQUARE FOOTAGE (937.5) X SIDEWALL REDUCTION CREDIT (0.4167) / TRENCH WIDTH (3) = 131.2 LF	4. LINEAR LENGTH OF TRENCH REQUIRED: - DRAIN FIELD SQUARE FOOTAGE (937.5) X SIDEWALL REDUCTION CREDIT (0.4167) / TRENCH WIDTH (3) = 131.2 LF	4. LINEAR LENGTH OF TRENCH REQUIRED: - DRAIN FIELD SQUARE FOOTAGE (937.5) X SIDEWALL REDUCTION CREDIT (0.4167) / TRENCH WIDTH (3) = 131.2 LF
5. LINEAR LENGTH OF TRENCH PROVIDED = 132 LF - TWO TRENCHES 66 LF/EACH	5. LINEAR LENGTH OF TRENCH PROVIDED = 132 LF - TWO TRENCHES 66 LF/EACH	5. LINEAR LENGTH OF TRENCH PROVIDED = 132 LF - TWO TRENCHES 66 LF/EACH
6. EXISTING GRADE: TRENCH I-A: 399.7 TRENCH I-B: 399.0	6. EXISTING GRADE: TRENCH R1-A: 399.3 TRENCH R1-B: 398.3	6. EXISTING GRADE: TRENCH R2-A: 398.0 TRENCH R2-B: 397.3
7. INVERT: TRENCH I-A: 395.7 TRENCH I-B: 395.0	7. INVERT: TRENCH R1-A: 395.3 TRENCH R1-B: 394.3	7. INVERT: TRENCH R2-A: 394.0 TRENCH R2-B: 393.3

NOTES:

- THE PURPOSE OF THIS PLAT IS TO OBTAIN APPROVAL FOR A PRIVATE SEWAGE AREA OF 10,000 SQUARE FEET TO ACCOMMODATE AN ADDITION TO THE HOUSE.
- TOPOGRAPHY SHOWN ON THIS LOT WAS FIELD RUN BY SHANABERGER & LANE IN JUNE, 2018, ON THE NAVD83 SYSTEM, USING BENCHMARK 22FM, ELEVATION 402.408. TOPOGRAPHY ON SURROUNDING PROPERTIES IS FROM 2013 HOWARD COUNTY LIDAR.
- BOUNDARY LINES ON THIS PLAT ARE FROM PLAT BOOK 15, FOLIO 40, AND FROM PROPERTY CORNER LOCATIONS BY SHANABERGER & LANE IN JUNE, 2018. BOUNDARY LINES SHOWN HEREON DO NOT REPRESENT A BOUNDARY SURVEY.
- ONSITE IMPROVEMENTS WITHIN THE LIMITS OF FIELD RUN TOPOGRAPHY WERE LOCATED BY SHANABERGER & LANE IN JUNE, 2018. OTHER IMPROVEMENTS SHOWN ARE FROM 2013 HOWARD COUNTY LIDAR. ONSITE WELL AND SEPTIC SYSTEM COMPONENTS, AND 2 OFFSITE SEPTIC SYSTEM COMPONENTS WERE FIELD-LOCATED IN JUNE, 2018.
- OTHER EXISTING WELL AND SEPTIC SYSTEM LOCATIONS SHOWN HEREON ARE FROM AVAILABLE HOWARD COUNTY HEALTH DEPARTMENT RECORDS.
- (W) FUTURE WELL
 - (W) EXISTING WELL
 - SOIL TYPE BOUNDARY
 - WOODLINE/TREES
 - (3) SUCCESSFUL PERC TEST
 - (5) FAILED PERC TEST
- SOIL TYPES PER N.R.C.S WEB SOIL SURVEY:
GdB - Glenelg loam, 3 to 8 percent slopes
GdC - Glenelg loam, 8 to 15 percent slopes
GdB - Glenelg-Bell silt loam, 0 to 8 percent slopes
- DESIGNATES LIMITS OF FIELD-RUN TOPOGRAPHY
- ANY CHANGE TO A PRIVATE SEWAGE AREA SHALL REQUIRE A REVISED PERC CERTIFICATION PLAN.
- ALL KNOWN EXISTING WELLS AND SEWAGE DISPOSAL AREAS WITHIN 100' OF THE PROPERTY AND WELLS WITHIN 200' DOWNSLOPE OF THE PROPOSED SDA HAVE BEEN SHOWN PER FIELD LOCATION WHEN POSSIBLE AND PER AVAILABLE RECORDS WHEN NOT POSSIBLE.
- THIS AREA DESIGNATES A PRIVATE SEWAGE AREA TO ACCOMMODATE 3 SYSTEMS AS REQUIRED BY THE MARYLAND STATE DEPARTMENT OF THE ENVIRONMENT FOR INDIVIDUAL SEWAGE DISPOSAL (COMAR 26.04.03). IMPROVEMENTS OF ANY NATURE IN THIS AREA ARE RESTRICTED UNTIL PUBLIC SEWERAGE IS AVAILABLE. THESE AREAS SHALL BECOME NULL AND VOID UPON CONNECTION TO A PUBLIC SEWERAGE SYSTEM. THE COUNTY HEALTH OFFICER SHALL HAVE THE AUTHORITY TO GRANT ADJUSTMENTS TO THE PRIVATE SEWAGE AREA. RECORDATION OF A MODIFIED SEWAGE AREA SHALL NOT BE NECESSARY.
- THE LOT SHOWN HEREON COMPLIES WITH THE MINIMUM OWNERSHIP WIDTH AND LOT AREA AS REQUIRED BY THE MARYLAND DEPARTMENT OF THE ENVIRONMENT.
- THE NEW SEPTIC SYSTEM MUST BE INSTALLED PRIOR TO HEALTH DEPARTMENT APPROVAL OF A BUILDING PERMIT.
- DESIGNATES APPROVED PERC AREA.

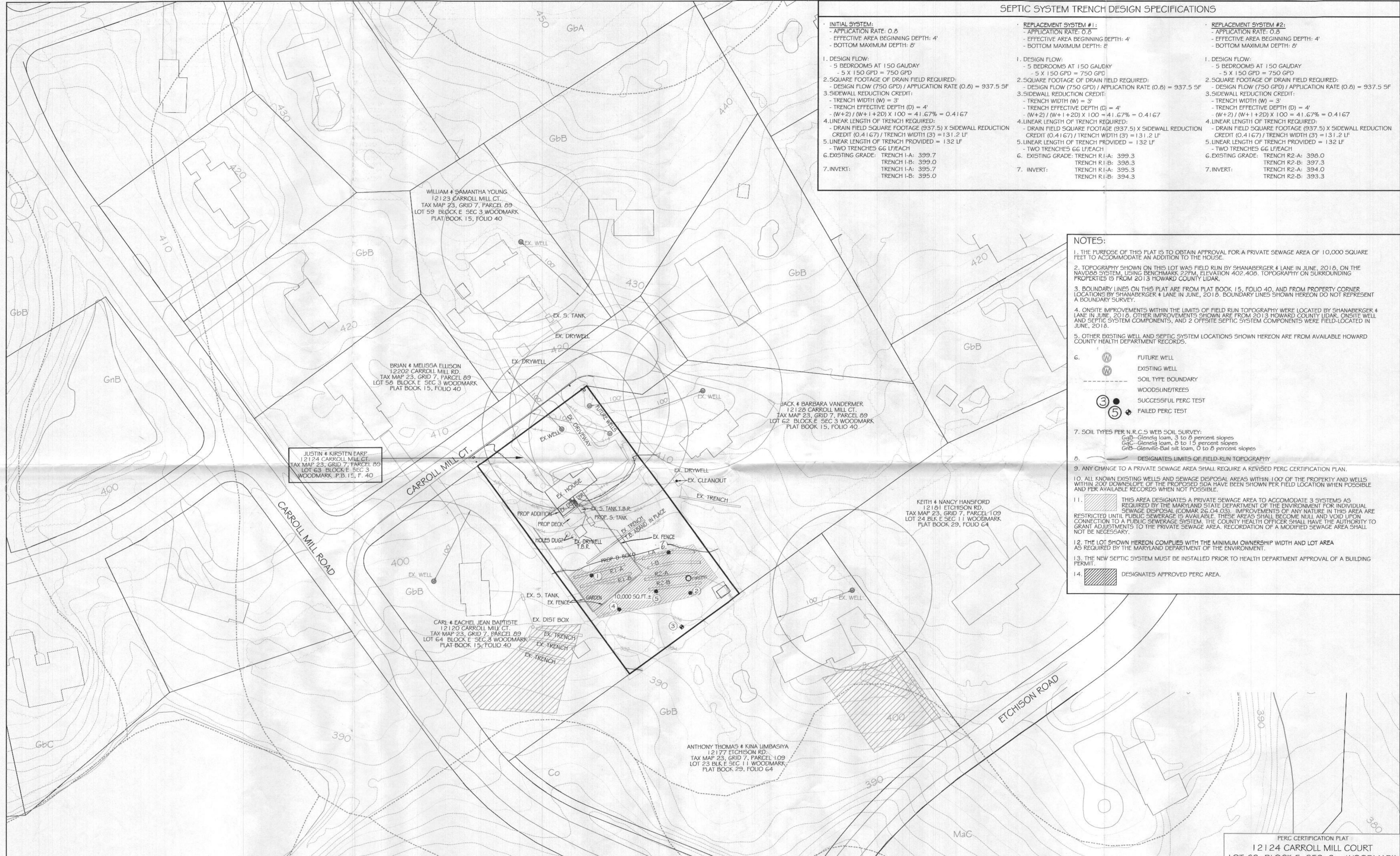

SHANABERGER & LANE
8726 TOWN # COUNTRY BLVD.
SUITE 201
ELICOTT CITY, MD 21043
(410) 461-9563
(410) 461-9693 fax
home@shanlane.com



I HEREBY CERTIFY THAT THE INFORMATION SHOWN HEREON REFLECTS WORK DONE BY ME OR UNDER MY DIRECT SUPERVISION USING AVAILABLE PUBLIC AND PRIVATE INFORMATION AND IS CORRECT TO THE BEST OF MY PROFESSIONAL KNOWLEDGE AND BELIEF.

Scott Shanaberger
6 SCOTT SHANABERGER
PROFESSIONAL LAND SURVEYOR #10839
LICENSE EXPIRATION DATE 4/2/2020

APPROVED: *Michelle Marie Rossman* 7/18/18
FOR PRIVATE WATER AND SEWERAGE SYSTEMS
HEALTH OFFICER, HOWARD COUNTY HEALTH DEPT. DATE

OWNERS
JUSTIN C. EARP
KIRSTEN C. EARP
12124 CARROLL MILL CT.
ELICOTT CITY, MD. 21042

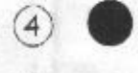
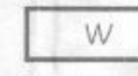
PERC CERTIFICATION PLAT
12124 CARROLL MILL COURT
LOT 63 BLOCK E SEC. 3 WOODMARK
PLAT BOOK 15, FOLIO 40 TITLE DEED: 12394/23
TAX MAP 23, GRID 7, PARCEL 89
3rd ELECTION DISTRICT, HOWARD COUNTY, MD.
SCALE: 1" = 50' DATE: 6/14/18 REV: 6/27/18, 7/5/18
PURPOSE: TO EXPAND SEWAGE DISPOSAL AREA TO ACCOMMODATE ADDITION

- NOTES:**
1. TOPOGRAPHY SHOWN HEREON IS FROM HOWARD COUNTY AERIAL PHOTOGRAMMETRY.
 2. HOUSES, DRIVEWAYS, ROAD PAVING, AND TREELINES ARE FROM HOWARD COUNTY GIS DATA
 3. EXISTING WELL AND SEPTIC COMPONENTS SHOWN HEREON ARE FROM HOWARD COUNTY HEALTH DEPARTMENT RECORDS
 4.  PROPOSED SEWAGE AREA OF AT LEAST 10,000 SQUARE FEET AS REQUIRED BY THE MD. STATE DEPT. OF THE ENVIRONMENT FOR INDIVIDUAL SEWAGE DISPOSAL.
 5.  SUGGESTED PERC TEST LOCATION & NUMBER
 -  PROPOSED WELL AREA
 -  EXISTING SEWAGE DISPOSAL EASEMENT
 - SOIL TYPE BOUNDARY
 - WOODSLINE/TREES
 - DRAINAGE DIVIDES
 7. SOIL TYPES:
 - GaB—Glenelg loam, 3 to 8 percent slopes
 - GaC—Glenelg loam, 8 to 15 percent slopes
 - GnB—Glenville-Ball silt loam, 0 to 8 percent slopes
 8. BEARINGS AND DISTANCES SHOWN HEREON ARE FROM RECORDED PLAT.

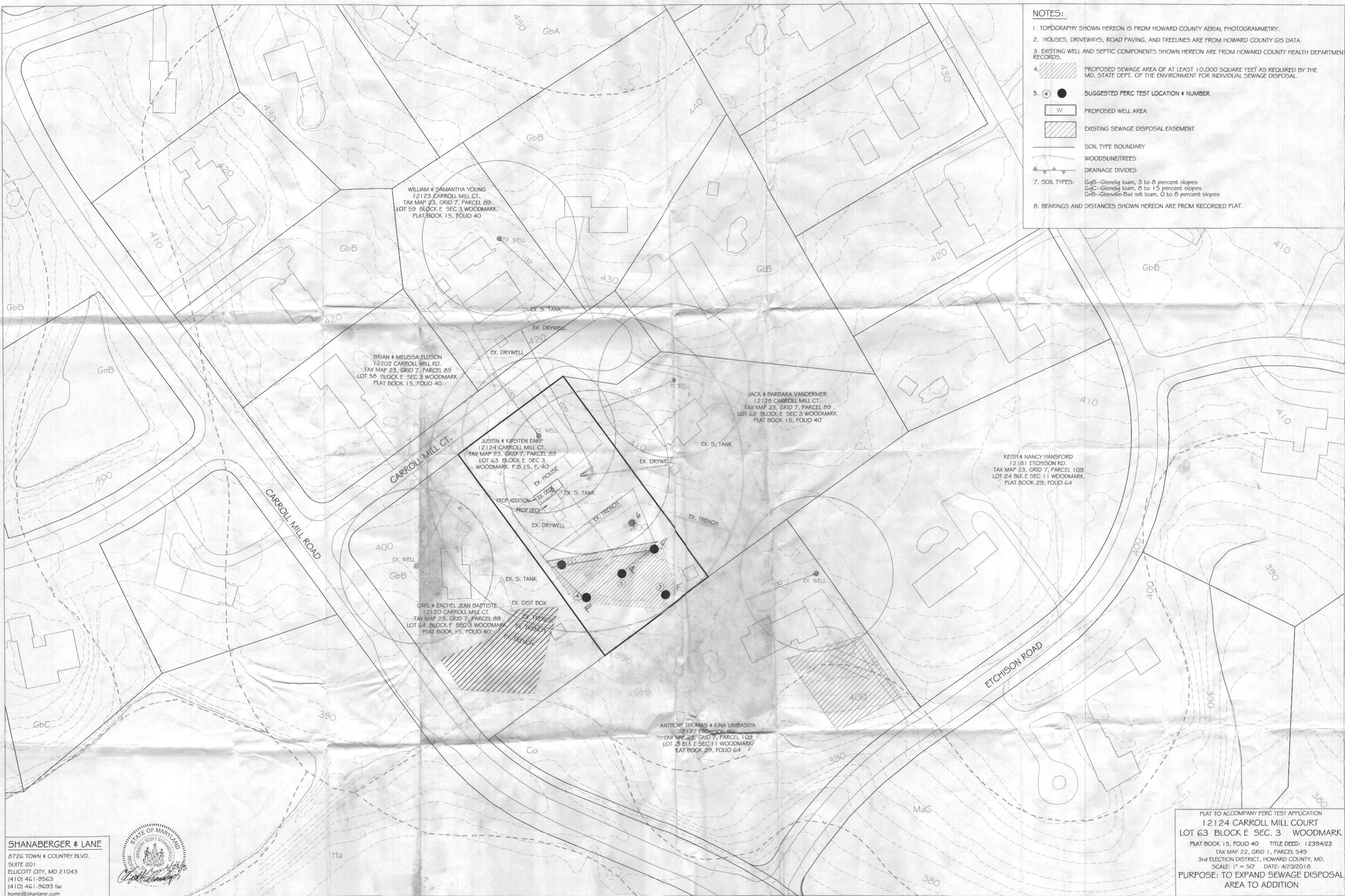

WILLIAM & SAMANTHA YOUNG
12123 CARROLL MILL CT.
TAX MAP 23, GRID 7, PARCEL 89
LOT 59 BLOCK E SEC 3 WOODMARK
PLAT BOOK 15, FOLIO 40

BRIAN & MELISSA ELISON
12202 CARROLL MILL RD.
TAX MAP 23, GRID 7, PARCEL 89
LOT 58 BLOCK E SEC 3 WOODMARK
PLAT BOOK 15, FOLIO 40

JACK & BARBARA VANDERMER
12128 CARROLL MILL CT.
TAX MAP 23, GRID 7, PARCEL 89
LOT 62 BLOCK E SEC 3 WOODMARK
PLAT BOOK 15, FOLIO 40

KEITH & NANCY HANSFORD
12181 ETCHISON RD.
TAX MAP 23, GRID 7, PARCEL 109
LOT 24 BLK E SEC 11 WOODMARK
PLAT BOOK 29, FOLIO 64

JUSTIN & KRISTEN EARP
12124 CARROLL MILL CT.
TAX MAP 23, GRID 7, PARCEL 89
LOT 63 BLOCK E SEC 3
WOODMARK P.B.15, F. 40

CARL & EACHEL JEAN BARTISTE
12120 CARROLL MILL CT.
TAX MAP 23, GRID 7, PARCEL 89
LOT 64 BLOCK E SEC 3 WOODMARK
PLAT BOOK 15, FOLIO 40

ANTHONY THOMAS & KINA LIMBASIA
12177 ETCHISON RD.
TAX MAP 23, GRID 7, PARCEL 109
LOT 23 BLK E SEC 11 WOODMARK
PLAT BOOK 29, FOLIO 64

SHANABERGER & LANE
8726 TOWN & COUNTRY BLVD.
SUITE 201
ELLCOTT CITY, MD 21043
(410) 461-9563
(410) 461-9693 fax
home@shanlane.com



PLAT TO ACCOMPANY PERC TEST APPLICATION
12124 CARROLL MILL COURT
LOT 63 BLOCK E SEC. 3 WOODMARK
PLAT BOOK 15, FOLIO 40 TITLE DEED: 12394/23
TAX MAP 22, GRID 1, PARCEL 549
3rd ELECTION DISTRICT, HOWARD COUNTY, MD.
SCALE: 1" = 50' DATE: 4/23/2018
PURPOSE: TO EXPAND SEWAGE DISPOSAL
AREA TO ADDITION

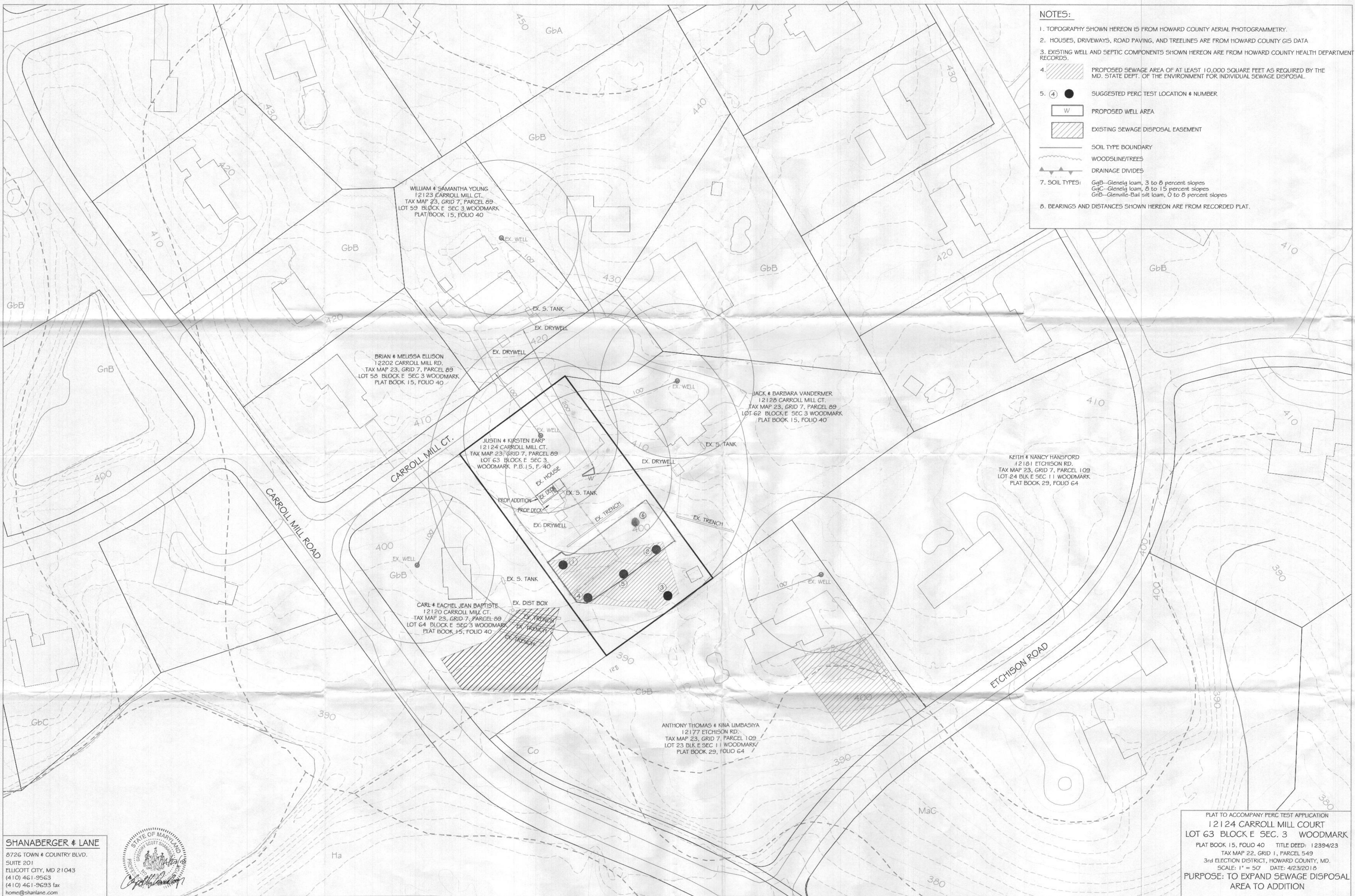

- NOTES:**
1. TOPOGRAPHY SHOWN HEREON IS FROM HOWARD COUNTY AERIAL PHOTOGRAMMETRY.
 2. HOUSES, DRIVEWAYS, ROAD PAVING, AND TREELINES ARE FROM HOWARD COUNTY GIS DATA
 3. EXISTING WELL AND SEPTIC COMPONENTS SHOWN HEREON ARE FROM HOWARD COUNTY HEALTH DEPARTMENT RECORDS.
 4. PROPOSED SEWAGE AREA OF AT LEAST 10,000 SQUARE FEET AS REQUIRED BY THE MD. STATE DEPT. OF THE ENVIRONMENT FOR INDIVIDUAL SEWAGE DISPOSAL.
 5. SUGGESTED PERC TEST LOCATION # NUMBER
 PROPOSED WELL AREA
 EXISTING SEWAGE DISPOSAL EASEMENT
 SOIL TYPE BOUNDARY
 WOODSLINE/TREES
 DRAINAGE DIVIDES
 7. SOIL TYPES: GgB—Glenelg loam, 3 to 8 percent slopes
GgC—Glenelg loam, 8 to 15 percent slopes
GnB—Glenville-Ball silt loam, 0 to 8 percent slopes
 8. BEARINGS AND DISTANCES SHOWN HEREON ARE FROM RECORDED PLAT.





SHANABERGER # LANE
8726 TOWN # COUNTRY BLVD.
SUITE 201
ELLICOTT CITY, MD 21043
(410) 461-9563
(410) 461-9693 fax
home@shanelane.com

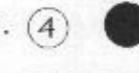
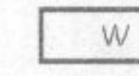

PLAT TO ACCOMPANY PERC TEST APPLICATION
12124 CARROLL MILL COURT
LOT 63 BLOCK E SEC. 3 WOODMARK
PLAT BOOK 15, FOLIO 40 TITLE DEED: 12394/23
TAX MAP 22, GRID 1, PARCEL 549
3rd ELECTION DISTRICT, HOWARD COUNTY, MD.
SCALE: 1" = 50' DATE: 4/23/2018
PURPOSE: TO EXPAND SEWAGE DISPOSAL
AREA TO ADDITION

1.6 Acres

NOTES:

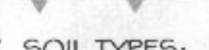
1. TOPOGRAPHY SHOWN HEREON IS FROM HOWARD COUNTY AERIAL PHOTOGRAMMETRY.
2. HOUSES, DRIVEWAYS, ROAD PAVING, AND TREELINES ARE FROM HOWARD COUNTY GIS DATA
3. EXISTING WELL AND SEPTIC COMPONENTS SHOWN HEREON ARE FROM HOWARD COUNTY HEALTH DEPARTMENT RECORDS.
4.  PROPOSED SEWAGE AREA OF AT LEAST 10,000 SQUARE FEET AS REQUIRED BY THE MD. STATE DEPT. OF THE ENVIRONMENT FOR INDIVIDUAL SEWAGE DISPOSAL.
5.  SUGGESTED PERC TEST LOCATION # NUMBER
-  PROPOSED WELL AREA
-  EXISTING SEWAGE DISPOSAL EASEMENT
-  SOIL TYPE BOUNDARY
-  WOODSLINE/TREES
-  DRAINAGE DIVIDES
7. SOIL TYPES: G**a**B—Glenelg loam, 3 to 8 percent slopes
G**b**C—Glenelg loam, 8 to 15 percent slopes
G**b**D—Glenville-Bal silt loam, 0 to 8 percent slopes
8. BEARINGS AND DISTANCES SHOWN HEREON ARE FROM RECORDED PLAT.

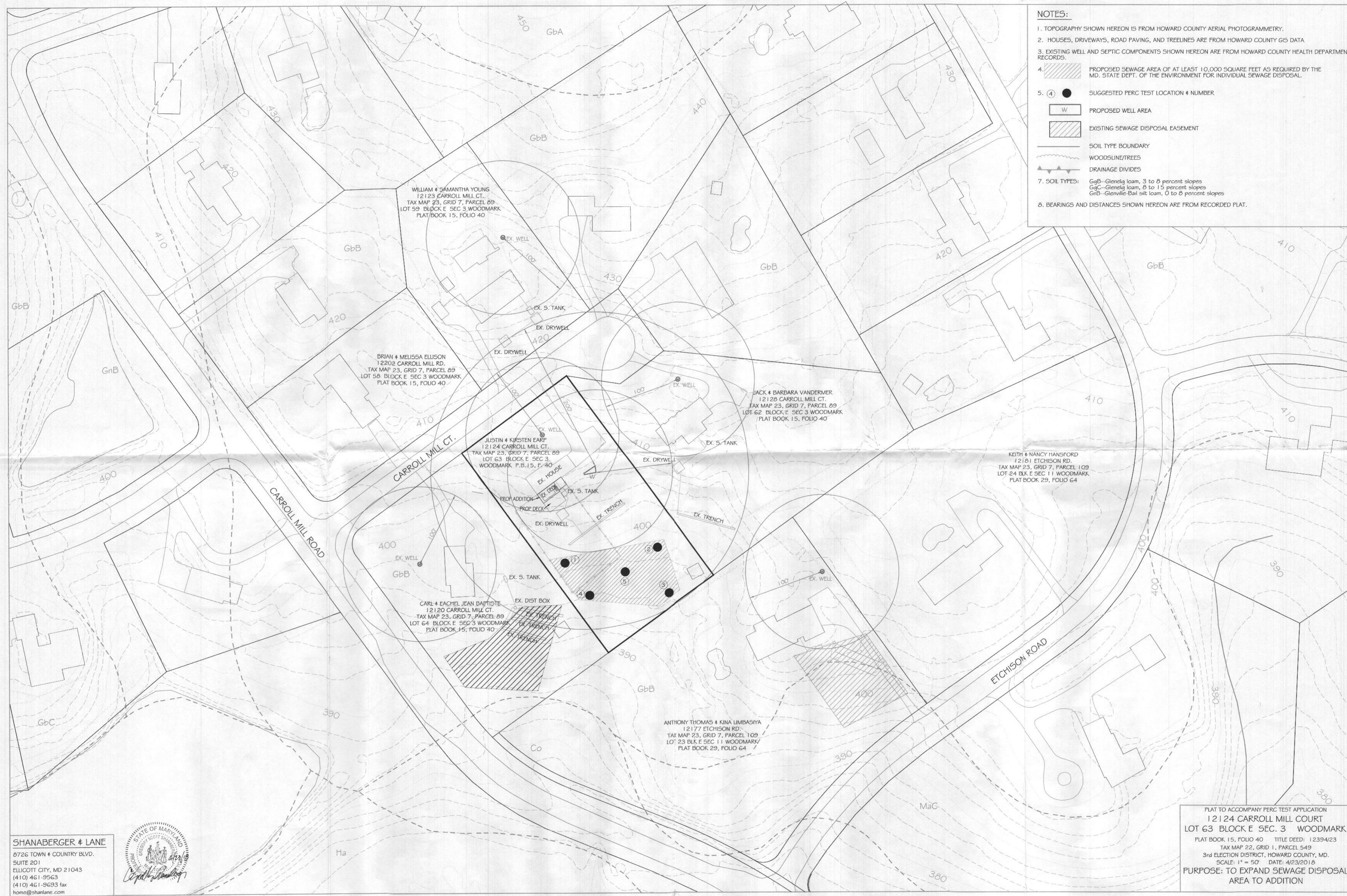

WILLIAM & SAMANTHA YOUNG
12123 CARROLL MILL CT.
TAX MAP 23, GRID 7, PARCEL 89
LOT 59 BLOCK E SEC 3 WOODMARK
PLAT BOOK 15, FOLIO 40

BRIAN & MELISSA ELISON
12202 CARROLL MILL RD.
TAX MAP 23, GRID 7, PARCEL 89
LOT 58 BLOCK E SEC 3 WOODMARK
PLAT BOOK 15, FOLIO 40

JACK & BARBARA VANDERMER
12128 CARROLL MILL CT.
TAX MAP 23, GRID 7, PARCEL 89
LOT 62 BLOCK E SEC 3 WOODMARK
PLAT BOOK 15, FOLIO 40

KEITH & NANCY HANSFORD
12181 ETCHISON RD.
TAX MAP 23, GRID 7, PARCEL 109
LOT 24 BLK E SEC 11 WOODMARK
PLAT BOOK 29, FOLIO 64

JUSTIN & KIRSTEN EARP
12124 CARROLL MILL CT.
TAX MAP 23, GRID 7, PARCEL 89
LOT 63 BLOCK E SEC 3
WOODMARK P.B.15, F.40

CARL & EACHEL JEAN BAPTISTE
12120 CARROLL MILL CT.
TAX MAP 23, GRID 7, PARCEL 89
LOT 64 BLOCK E SEC 3 WOODMARK
PLAT BOOK 15, FOLIO 40

ANTHONY THOMAS & KINA LIMBASRYA
12177 ETCHISON RD.
TAX MAP 23, GRID 7, PARCEL 109
LOT 23 BLK E SEC 11 WOODMARK
PLAT BOOK 29, FOLIO 64

SHANABERGER & LANE
8726 TOWN & COUNTRY BLVD.
SUITE 201
ELLCOTT CITY, MD 21043
(410) 461-9563
(410) 461-9693 fax
home@shanlane.com



PLAT TO ACCOMPANY PERC TEST APPLICATION
12124 CARROLL MILL COURT
LOT 63 BLOCK E SEC. 3 WOODMARK
PLAT BOOK 15, FOLIO 40 TITLE DEED: 12394/23
TAX MAP 22, GRID 1, PARCEL 549
3rd ELECTION DISTRICT, HOWARD COUNTY, MD.
SCALE: 1" = 50' DATE: 4/23/2018
PURPOSE: TO EXPAND SEWAGE DISPOSAL
AREA TO ADDITION