



HOWARD COUNTY HEALTH DEPARTMENT

69616

DATE 7/22/21

Received From

Legacy Septic & Excav. PHONE # 301 370 1121

For

Peric / repairs - 14396
101 Old Frederick Rd.

CASH

CHECK

NO

10415

Three hundred thirty _____ Dollars

\$ 330.00

Received By

King

Maura J. Rossman, M.D., Health Officer

INFORMATION FORM - SEPTIC SYSTEM REPAIR/UPGRADE

Reason for Request:

- Failing System
- System relocation for proposed addition
- System upgrade for proposed addition
- Inadequate treatment zone
- Collapsed septic tank
- Collapsed drywell

Has the septic tank been pumped within the last month?

Yes Date pumped: _____
 No

Was a visual inspection of the septic tank and/or drain fields conducted?

Yes Explain observation: _____
 No

Existing system design

- Drywell
- Trench
- Mound
- Unknown
- Other: _____

Was a visual inspection of the sewage line conducted?

Yes
 No

Blockage Leading to the field

Yes Explain _____
 No

Is discharge surfacing on the ground?

Yes
 No

Additional Comments:

HomeLand Report

*For REPAIRS, are the owners proposing, or do they plan to add in the future any additions or modifications to the property, i.e. pools, living space additions, garages, etc? This information must be disclosed at the time of this application. The Health Department will not be able to accommodate requests in the field for property modifications unrelated to the repair request. Such requests may require an additional fee, testing, and submittal of a Percolation Certification Plan, if the property does not meet current Code and Regulations.

Septic Contractor: LEGACY Septic Contractor's Phone: 410 840 5764
301-370-4121
 Contractor's Address: 1538 manchester Rd, WESTMINSTER, MD 21157
 Property Address: 14396 Old Frederick Rd. County File: 322584
SYKESVILLE, MD. 21784
 Subdivision: 1001 Lot: _____ Year Built: 1917
 Owner's Name: KRISTEN STACK Existing bedrooms: 5
 Name of previous owners: ZCFOLD VOIT Existing bedrooms: _____
 Proposed bedrooms: _____

*A Sanitarian will be in contact within three business days, depending upon the urgency of the situation, to coordinate the scheduling/review of the repair or upgrade.

Prior to scheduling inspections, scaled plans should be submitted to clarify the nature of the addition.

Print out a copy of Real Property Data via Dept. of Taxation website _____ Indexed file found _____

If soil/site conditions are limited and sewer and/or Metro District status is not conducive to connection, the Sanitarian may recommend pursuit of Emergency Sewer Extension or Emergency Metro District Inclusion. The Owner should contact the Bureau of Utilities for details.

No permit is to be issued nor inspection to be scheduled without prior fee collection at the office unless an emergency exists.

The contractor is to notify the office of the emergency as soon as possible.

2/2020

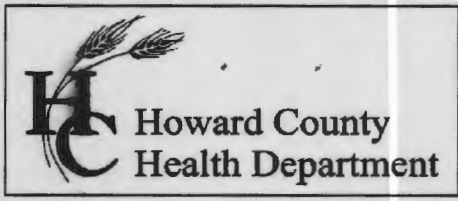

Bureau of Environmental Health
 8930 Stanford Boulevard, Columbia, MD 21045
 Main: 410-313-2640 | Fax: 410-313-2648
 TDD 410-313-2323 | Toll Free 1-866-313-6300
www.hchealth.org
 Facebook: www.facebook.com/hocohealth

Maura J. Rossman, M.D., Health Officer

RECEIPT DATE: 07/20/2021 **ONSITE SEWAGE DISPOSAL SYSTEM** P 569616
 APPROVAL DATE: 08/05/2021 **PERMIT: TANK REPLACEMENT REPAIR** A 569616
 PROPERTY ADDRESS: 14396 Old Frederick Road, Sykesville, MD 21784
 SUBDIVISION: - LOT: - TAX ID: 04-322584
 CONTRACTOR: Legacy Septic EMAIL: _____
 CONTRACTOR ADDRESS: 1538 Manchester Road, Westminster, MD 21157 PHONE: (301) 370-4121
 PROPERTY OWNER: Stack, Kristen EMAIL: _____
 OWNER ADDRESS: 14396 Old Frederick Road, Sykesville, MD 21784 PHONE: _____

SEPTIC TANK SIZE (GALLONS): 2000 PUMP CHAMBER CAPACITY (GALLONS): - PUMP SIZE: -
 NUMBER OF BEDROOMS: 5 HOUSE SQ. FT. - APPLICATION RATE: _____
 DISTRIBUTION SYSTEM: GRAVITY FED LOW PRESSURE DOSED

TRENCHES: (1987)	LINEAR FEET REQUIRED: <u>(EX) 100'</u>	INLET DEPTH: <u>5'</u>
	TRENCH WIDTH: <u>2'</u>	MAXIMUM BOTTOM DEPTH: <u>10.5'</u>
	MINIMUM SPACE BETWEEN TRENCHES: _____	EFFECTIVE AREA BEGINNING DEPTH: <u>4.5'</u>

LOCATION: **TO BE STAKED BY SANITARIAN DURING PRE-CONSTRUCTION INSPECTION.**

NOTES: * SOIL IS HARD BOTTOM AT 10.5'

ISSUED BY: Cabahug 001997 ISSUE DATE: 07/20/2021 EXPIRATION DATE: 07/20/2022

- NOTE: CONTRACTOR MUST SCHEDULE A PRE-CONSTRUCTION INSPECTION PRIOR TO BEGINNING ANY INSTALLATION
- NOTE: CONTRACTOR MUST SCHEDULE AN INSPECTION AND GAIN APPROVAL OF ALL COMPONENTS PRIOR TO COVERING
- NOTE: STONE MUST BE APPROVED BY HEALTH DEPARTMENT AND GRAVEL TICKET MUST BE AVAILABLE FOR REVIEW.
- NOTE: WATERTIGHT SEPTIC TANKS REQUIRED
- NOTE: ALL PARTS OF SEPTIC SYSTEM SHALL BE AT LEAST 100 FEET DOWNGRAIDENT FROM ANY WATER WELL
- NOTE: MANHOLE RISERS REQUIRED ON ALL SEPTIC TANKS AND PUMP CHAMBERS
- NOTE: AN ELECTRICAL PERMIT IS REQUIRED FOR INSTALLATION OF ANY ELECTRICAL COMPONENTS OF THE SYSTEM
 ELECTRICAL PERMIT ISSUED E _____
- NOTE: THE HCHD DOES NOT WARRANTY ANY SYSTEM AND CANNOT GUARANTEE THE PERFORMANCE OF THIS SYSTEM AS DESIGNED. BY ACCEPTING THIS PERMIT, THE OWNER AND/OR APPLICANT ACKNOWLEDGE THAT THE SPECIFICATIONS DETAILED IN THIS DESIGN ARE ONE POSSIBLE OPTION AND THAT THE HCHD WILL REVIEW OTHER PROPOSALS. YOU HAVE THE OPTION TO SEEK THE ADVICE OF A QUALIFIED DESIGN CONSULTANT OR PROFESSIONAL ENGINEER FOR FURTHER GUIDANCE.
- NOTE: MDE RECOMMENDS SEPTIC TANKS, BAT, AND OTHER PRETREATMENT UNITS BE PUMPED AT A FREQUENCY ADEQUATE TO ENSURE THAT SOLIDS ARE NOT DISCHARGED TO THE DISPOSAL AREA

**NEITHER THE HOWARD COUNTY COUNCIL NOR THE HEALTH DEPARTMENT IS RESPONSIBLE FOR THE SUCCESSFUL OPERATION OF ANY SYSTEM.
 PERMITTEE RESPONSIBLE FOR OBTAINING FINAL APPROVAL ON THIS PERMIT.
 CALL 410-313-1771 TO SCHEDULE INSPECTIONS.**

NOT TO SCALE

AB CESSPIT
REV RECORDED AS 1250/2000g TANK

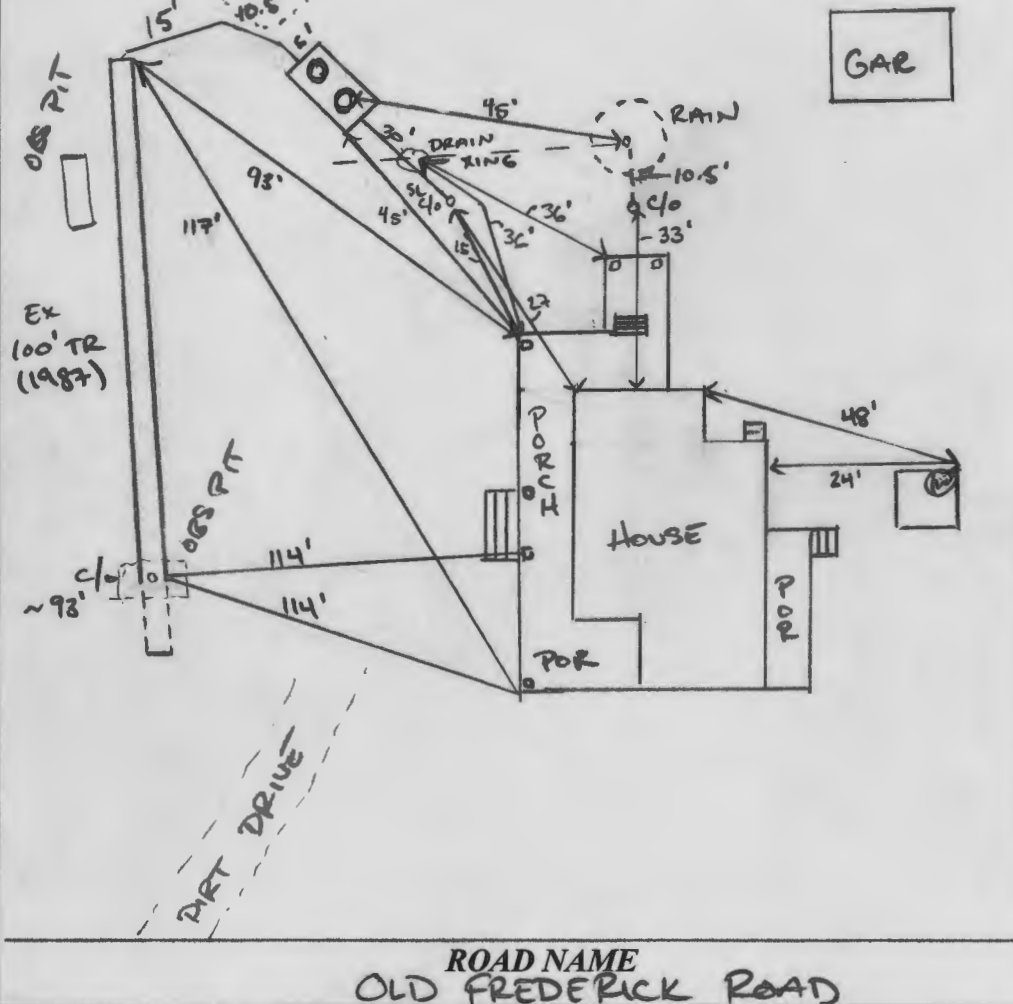

TRENCH/DRAINFIELD DATA		
WIDTH	INLET	BOTTOM
2'	5'	10.5'
NUMBER OF TRENCHES 1		
TOTAL LENGTH 100'		
ABSORPTION AREA 200 SF + 5.5' SIDE WALL		
DISTRIBUTION BOX LEVEL -		
DISTRIBUTION BOX BAFFLE -		
DISTRIBUTION BOX PORT -		

SEPTIC TANK DATA	
SEPTIC TANK I LEVEL	YES
MANUFACTURER	BABYLOON
CAPACITY	2000 GAL
SEAM LOC	TOP
TANK LID DEPTH	2' - 1'
BAFFLES	YES
BAFFLE FILTER	-
MANHOLE LOC	FRONT/BACK
6" PORT LOC	-
WATERTIGHT TEST	-
SLOTTED	YES
DATE ON LID	05/14/2021
PUMP/SEPTIC TANK LEVEL	
MANUFACTURER	
CAPACITY	GAL
SEAM LOC	
TANK LID DEPTH	
BAFFLES	
BAFFLE FILTER	
MANHOLE LOC	
6" PORT LOC	
WATERTIGHT TEST	
SLOTTED	
DATE ON LID	

ROUTE 97

ROAD NAME
OLD FREDERICK ROAD

PRE-CONSTRUCTION: 08/03/2021 UNCOVERED SEWER LINE AND TANK. TANK WAS CESSPIT. LOCATED EX TRENCH (1987). TRENCH APPEARS CLEAN OF BIOMAT AND COMPLETELY DRY.

* OBS PIT REVEALS HARD BOTTOM AT 10.5'

INSTALLATION: 08/05/2021 INSTALLED OBS PORT 93'-100' AT TRENCH END; SECTION FULL OF FINES. CONT. THOUGHT THEY WERE AT TRENCH END. NOT IDEAL BUT OK. 08/05/2021 (AM) TIE IN TO EX TERRA COTTA SL w/ SWEEP 90 C/O. SET TANK. CRUSHED AND FILLED EX CESSPIT. (PM) EFFLUENT LINE INSTALLED TO EX TR. #

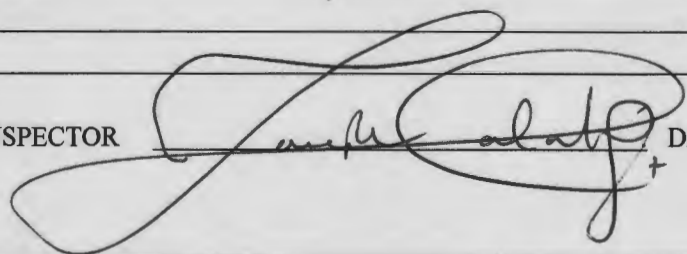
FINAL INSPECTOR  DATE OF APPROVAL 08/05/2021

HOME LAND

ENVIRONMENTAL

p:443-995-5385 | info@homelandhealthyhomes.com | www.homelandhealthyhomes.com

Date: June 18, 2021 Name of Evaluator: Nicholas Riehl Time: 12:00 PM Property Address: 14396 Old Frederick Road Sykesville, MD 21784 Recent Weather Conditions: Normal	Ordered By: Well Water Solutions Buyers: Homeowner Interview: The homeowner interview was sent but was not received prior to the evaluation.	Occupied: <input checked="" type="checkbox"/> Yes <input type="checkbox"/> No Length of Time Vacant: N/A # of People Living in Home: 1 # of People moving in: Unknown Property Age: 1917 System Age: Unknown & 1984 Last Date of Cleaning: 2019 Recomm'd Pumping Freq: 2-3 Years
Liquid level in tank is: <input type="checkbox"/> Above Normal <input type="checkbox"/> Normal <input checked="" type="checkbox"/> Below Normal	Bottom Solids Depth: 3 Inches	
Depth of tank: 16 Inches	Type of Tank Access: Cleanout	Depth of tank access: At Grade
Maintenance appears: <input type="checkbox"/> Good <input type="checkbox"/> Fair <input checked="" type="checkbox"/> Poor	Depth to Distribution Box: N/A	
Effluent Filter present: <input type="checkbox"/> Yes <input checked="" type="checkbox"/> No	Previous high liquid level: <input type="checkbox"/> Yes <input checked="" type="checkbox"/> No	Distance to well: -100 Feet
Records Search: Records were requested and were received from Howard County prior to the evaluation.		
Were there any impermeable surfaces above the septic system (i.e. driveway)? <input type="checkbox"/> Yes <input checked="" type="checkbox"/> No		
Type of Tank	Tank Composition and Size	Type of Absorption System
<input checked="" type="checkbox"/> Septic Tank (1 Tank) <input type="checkbox"/> Aeration System <input type="checkbox"/> Other:	<input type="checkbox"/> Metal <input checked="" type="checkbox"/> Stone <input type="checkbox"/> Plastic Tank Size: 2,000 Gallons	<input checked="" type="checkbox"/> Leeching Field <input type="checkbox"/> Sand Mound <input type="checkbox"/> Drywell (Number of:) <input type="checkbox"/> Cesspool <input type="checkbox"/> Unknown: _____
System Component	Condition	Comments
Septic Tank	<input type="checkbox"/> Acceptable <input checked="" type="checkbox"/> Unacceptable <input type="checkbox"/> Needs Further Evaluation	The septic tank is composed of stone and is approximately 2,000 gallons in total capacity. The septic tank is accessible via a cleanout at grade. The septic tank is 16 inches below grade. The back baffle is in place and composed of PVC. Currently there are 3 inches of solids in the septic tank. Upon arrival, the liquid level was below the normal operating level. The side walls of the septic tank are collapsing into the tank. The septic tank will need to be replaced by a licensed septic contractor after permits have been pulled from the local county health department. Please refer to page 2 for further information.
Pump Present? <input type="checkbox"/> Yes <input checked="" type="checkbox"/> No	<input checked="" type="checkbox"/> Acceptable <input type="checkbox"/> Unacceptable	
Absorption System	<input type="checkbox"/> Acceptable <input type="checkbox"/> Unacceptable <input checked="" type="checkbox"/> Needs Further Evaluation	One drainfield was located during the evaluation. The drainfield was probed and found to be dry to a depth of at least 4 inches from the top of the stone. Due to the leaking/collapsing septic tank, a hydraulic load test could not be conducted. When the septic tank is replaced, the absorption system should be re-evaluated to verify its viability.

COPY

HOME LAND ENVIRONMENTAL

p: 443-995-5385 | info@homelandhealthyhomes.com | www.homelandhealthyhomes.com

Sketch of System

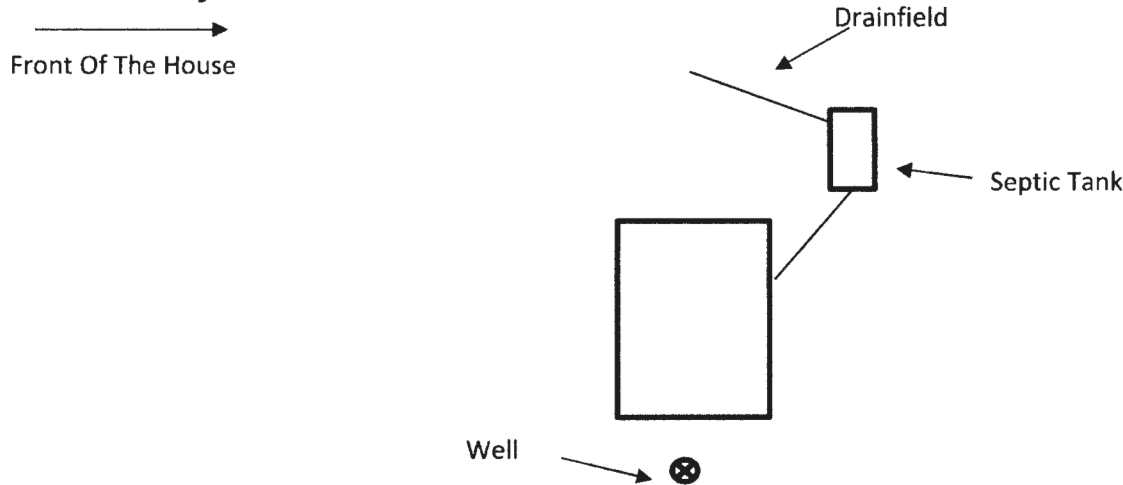

DISCLAIMERS



- This is a subjective and visual inspection only, the conclusions of which are based on the observed condition of the system components that could reasonably be accessed, and information known about the system at the time this report was completed. There may be unknown historical problems or unseen conditions which may compromise the conclusions stated in this report.
- A 'Satisfactory' evaluation does not mean the system will meet the local approving authority's criteria for determining compliance with state code: COMAR 26.04.02.02 D(4).
- The evaluation of the Sewage Disposal System as reported is based on the conditions observed on the day of the inspection.
- This report is neither a WARRANTY nor does it GUARANTEE continued acceptable functionality or performance of the Sewage Disposal Systems operations.
- If the house has been unoccupied the findings in this report may not be accurate, as limited or no use of the system may conceal or mask problems that may be revealed under typical sewage loading.
- If the general ground condition is excessively wet at the time of inspection, the findings in this report may not be accurate, as ground moisture may cover or hide septic effluent that may be on or near the ground surface.
- If the house is vacant or the conditions excessively wet during inspection, it is recommended that the system be reevaluated at a later date and/or alternate techniques be used to address those potential issues.
- Payment and/or use of this evaluation signify understanding and acceptances of the above clauses, as well as any noted faults with the system.
- Suggestions or recommendations for repairs or remediation may result in the need for further repair or remediation once the system components are fully excavated.

Representative's Signature:		Date: 6/18/2021
------------------------------------	---	------------------------

HOME LAND

ENVIRONMENTAL

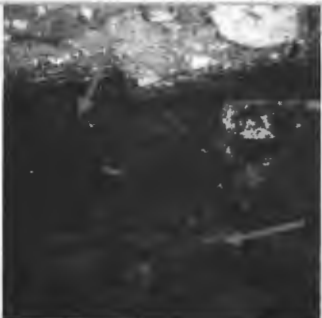
p:443-995-5385 | f:443-267-0098 | info@homelandhealthyhomes.com | www.homelandhealthyhomes.com

		<p>Picture 1:</p> <p>This shows the septic tank in relation to the woods.</p>
		<p>Picture 2:</p> <p>This shows the stone walls of the septic tank.</p>
		<p>Picture 3:</p> <p>This shows the drainfield in relation to the septic tank. Labeled white flag were left above the tank and trench.</p>
<p>No Picture.</p>		<p>Picture 4:</p> <p>This space was intentionally left blank.</p>

p:443-995-5385 | f:443-267-0098 | info@homelandhealthyhomes.com | www.homelandhealthyhomes.com