



**Howard County
Health Department**

Maura J. Rossman, M.D., Health Officer

Bureau of Environmental Health
8930 Stanford Boulevard, Columbia, MD 21045
Main: 410-313-2640 | Fax: 410-313-2648
TDD 410-313-2323 | Toll Free 1-866-313-6300
www.hchealth.org
Facebook: www.facebook.com/hocohealth

RECEIPT DATE: 7/7/21 **ONSITE SEWAGE DISPOSAL SYSTEM** P 569595
APPROVAL DATE: 8/13/21 **PERMIT:** **REPAIR** A 569595
PROPERTY ADDRESS: 1258 Heritage Farms Court
SUBDIVISION: HERITAGE FARMS LOT: 4 TAX ID: 03-306224
CONTRACTOR: Fogles Septic Clean Inc EMAIL: kim@foglesinc.com
CONTRACTOR ADDRESS: 580 Obrecht Road, Sykesville, MD 21784 PHONE: 410-795-5670
PROPERTY OWNER: Lee Dinterman EMAIL: _____
OWNER ADDRESS: 1258 Heritage Farms Court, Sykesville, MD 21784 PHONE: _____

SEPTIC TANK SIZE (GALLONS): EX PUMP CHAMBER CAPACITY (GALLONS): — PUMP SIZE: —
NUMBER OF BEDROOMS: 3 HOUSE SQ. FT. — APPLICATION RATE: 1.2
DISTRIBUTION SYSTEM: GRAVITY FED LOW PRESSURE DOSED

TRENCHES:	LINEAR FEET REQUIRED: <u>79'</u>	INLET DEPTH: <u>4'</u>
	TRENCH WIDTH: <u>2'</u>	MAXIMUM BOTTOM DEPTH: <u>8'</u>
	MINIMUM SPACE BETWEEN TRENCHES: <u>9'</u>	EFFECTIVE AREA BEGINNING DEPTH: <u>4'</u>
LOCATION:	TO BE STAKED BY SANITARIAN DURING PRE-CONSTRUCTION INSPECTION.	
NOTES:	INSTALL 1x 79' TRENCH + D BOX. TIE INTO EX EFFLUENT LINE IF NO EX D BOX IS DISCOVERED.	

ISSUED BY: CABANUG 001997 ISSUE DATE: 07/26/2021 EXPIRATION DATE: 07/26/2022

- NOTE: CONTRACTOR MUST SCHEDULE A PRE-CONSTRUCTION INSPECTION PRIOR TO BEGINNING ANY INSTALLATION
- NOTE: CONTRACTOR MUST SCHEDULE AN INSPECTION AND GAIN APPROVAL OF ALL COMPONENTS PRIOR TO COVERING
- NOTE: STONE MUST BE APPROVED BY HEALTH DEPARTMENT AND GRAVEL TICKET MUST BE AVAILABLE FOR REVIEW.
- NOTE: WATERTIGHT SEPTIC TANKS REQUIRED
- NOTE: ALL PARTS OF SEPTIC SYSTEM SHALL BE AT LEAST 100 FEET DOWNGRADIENT FROM ANY WATER WELL
- NOTE: MANHOLE RISERS REQUIRED ON ALL SEPTIC TANKS AND PUMP CHAMBERS
- NOTE: AN ELECTRICAL PERMIT IS REQUIRED FOR INSTALLATION OF ANY ELECTRICAL COMPONENTS OF THE SYSTEM
 ELECTRICAL PERMIT ISSUED E _____
- NOTE: THE HCHD DOES NOT WARRANT ANY SYSTEM AND CANNOT GUARANTEE THE PERFORMANCE OF THIS SYSTEM AS DESIGNED. BY ACCEPTING THIS PERMIT, THE OWNER AND/OR APPLICANT ACKNOWLEDGE THAT THE SPECIFICATIONS DETAILED IN THIS DESIGN ARE ONE POSSIBLE OPTION AND THAT THE HCHD WILL REVIEW OTHER PROPOSALS. YOU HAVE THE OPTION TO SEEK THE ADVICE OF A QUALIFIED DESIGN CONSULTANT OR PROFESSIONAL ENGINEER FOR FURTHER GUIDANCE.
- NOTE: MDE RECOMMENDS SEPTIC TANKS, BAT, AND OTHER PRETREATMENT UNITS BE PUMPED AT A FREQUENCY ADEQUATE TO ENSURE THAT SOLIDS ARE NOT DISCHARGED TO THE DISPOSAL AREA

**NEITHER THE HOWARD COUNTY COUNCIL NOR THE HEALTH DEPARTMENT IS RESPONSIBLE FOR THE SUCCESSFUL OPERATION OF ANY SYSTEM.
PERMITTEE RESPONSIBLE FOR OBTAINING FINAL APPROVAL ON THIS PERMIT.
CALL 410-313-1771 TO SCHEDULE INSPECTIONS.**

NOT TO SCALE

110-73-2889

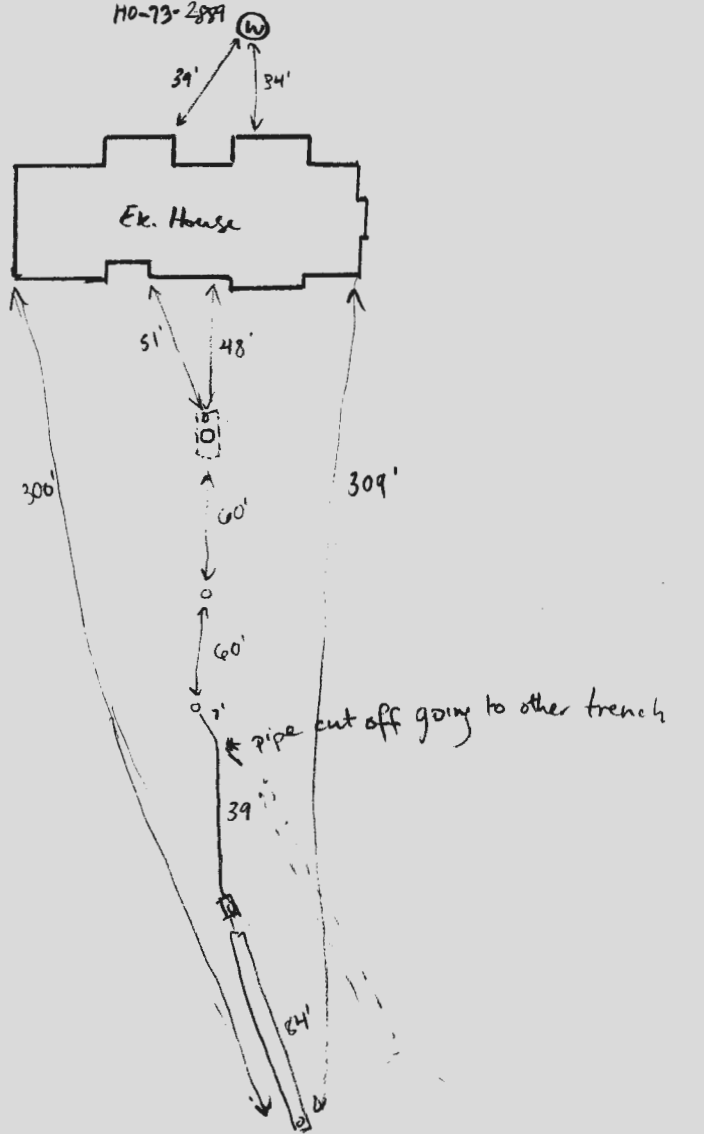

TRENCH/DRAINFIELD DATA

WIDTH	INLET	BOTTOM
2'	4'	8'

NUMBER OF TRENCHES 1
 TOTAL LENGTH 84'
 ABSORPTION AREA 1608 sq ft + sidewalk
 DISTRIBUTION BOX LEVEL _____
 DISTRIBUTION BOX BAFFLE N/A
 DISTRIBUTION BOX PORT _____

SEPTIC TANK DATA

existing
 SEPTIC TANK I LEVEL _____
 MANUFACTURER unknown
 CAPACITY 1250 GAL
 SEAM LOC top
 TANK LID DEPTH 2'
 BAFFLES inlet outlet (new)
 BAFFLE FILTER _____
 MANHOLE LOC center
 6" PORT LOC inlet
 WATERTIGHT TEST -
 SLOTTED no
 DATE ON LID _____

PUMP/SEPTIC TANK LEVEL

MANUFACTURER _____
 CAPACITY _____ GAL
 SEAM LOC _____
 TANK LID DEPTH _____
 BAFFLES _____
 BAFFLE FILTER _____
 MANHOLE LOC _____
 6" PORT LOC _____
 WATERTIGHT TEST _____
 SLOTTED _____
 DATE ON LID _____

ROAD NAME

PRE-CONSTRUCTION:

07/26/2021 LAID OUT 1 x 79' TRENCH 10' ETE w/ EXISTING TRENCH

INSTALLATION: 8/13/21 New outlet baffle installed in tank and new center riser. Pipe to old trenches cutoff. Effluent pipe connected to new d-box and new 84' trench. (S)

FINAL INSPECTOR

Susan Thomas

DATE OF APPROVAL

8/13/21

PS 69595

Maura J. Rossman, M.D., Health Officer

INFORMATION FORM - SEPTIC SYSTEM REPAIR/UPGRADE

Reason for Request:

- Failing System
- System relocation for proposed addition
- System upgrade for proposed addition
- Inadequate treatment zone
- Collapsed septic tank
- Collapsed drywell

Has the septic tank been pumped within the last month?

- Yes
 - No
- Date pumped: _____

Was a visual inspection of the septic tank and/or drain fields conducted?

- Yes Explain observation: See Attached
- No HomeLand report

Existing system design

- Drywell
- Trench
- Mound
- Unknown
- Other: _____

Was a visual inspection of the sewage line conducted?

- Yes
- No

Blockage Leading to the field

- Yes Explain _____
- No

Is discharge surfacing on the ground?

- Yes
- No

Additional Comments:

*For REPAIRS, are the owners proposing, or do they plan to add in the future any additions or modifications to the property, i.e. pools, living space additions, garages, etc? This information must be disclosed at the time of this application. The Health Department will not be able to accommodate requests in the field for property modifications unrelated to the repair request. Such requests may require an additional fee, testing, and submittal of a Percolation Certification Plan, if the property does not meet current Code and Regulations.

Septic Contractor: Fogles Septic Contractor's Phone: 410 795-5670

Contractor's Address: 580 Obrecht Rd Sykesville, Md.

Property Address: 1258 Heritage Farms Ct County File: _____

Subdivision: Heritage Farms Lot: 4 Year Built: 1983

Owner's Name: Lee/Pam Dinterman Existing bedrooms: 3

Name of previous owners: David Rosenberger Existing bedrooms: _____

Proposed bedrooms: 5

*A Sanitarian will be in contact within three business days, depending upon the urgency of the situation, to coordinate the scheduling/review of the repair or upgrade.

Prior to scheduling inspections, scaled plans should be submitted to clarify the nature of the addition.

Print out a copy of Real Property Data via Dept. of Taxation website _____ Indexed file found _____

If soil/site conditions are limited and sewer and/or Metro District status is not conducive to connection, the Sanitarian may recommend pursuit of Emergency Sewer Extension or Emergency Metro District Inclusion. The Owner should contact the Bureau of Utilities for details.

No permit is to be issued nor inspection to be scheduled without prior fee collection at the office unless an emergency exists.

The contractor is to notify the office of the emergency as soon as possible.