

3/20/20 14285 Old Frederick Rd  
insp. on 3/20 - accepted  
pics for final install.

HL

SEE ATTACHED  
AS BUILT

TRENCH/DRAINFIELD DATA

WIDTH \_\_\_\_\_ INLET \_\_\_\_\_ BOTTOM \_\_\_\_\_  
NUMBER OF TRENCHES \_\_\_\_\_  
TOTAL LENGTH \_\_\_\_\_  
ABSORPTION AREA \_\_\_\_\_  
DISTRIBUTION BOX LEVEL \_\_\_\_\_  
DISTRIBUTION BOX BAFFLE \_\_\_\_\_  
DISTRIBUTION BOX PORT \_\_\_\_\_

PRE-CONSTRUCTION:

SEPTIC TANK DATA

SEPTIC TANK I LEVEL yes  
MANUFACTURER Babylon  
CAPACITY 2000 GAL  
SEAM LOC top  
TANK LID DEPTH 3'  
BAFFLES 6" front 4" back  
BAFFLE FILTER -  
MANHOLE LOC front/back  
6" PORT LOC -  
WATERTIGHT TEST -  
SLOTTED yes  
DATE ON LID 1/2/19

PUMP/SEPTIC TANK LEVEL \_\_\_\_\_

MANUFACTURER \_\_\_\_\_  
CAPACITY \_\_\_\_\_ GAL  
SEAM LOC \_\_\_\_\_  
TANK LID DEPTH \_\_\_\_\_  
BAFFLES \_\_\_\_\_  
BAFFLE FILTER \_\_\_\_\_  
MANHOLE LOC \_\_\_\_\_  
6" PORT LOC \_\_\_\_\_  
WATERTIGHT TEST \_\_\_\_\_  
SLOTTED \_\_\_\_\_  
DATE ON LID \_\_\_\_\_

ROAD NAME

03/09/2020 TANK AND SOA STAKED. HOUSE RAISED BY ~1'  
CONFIRMED CONTOUR OF 2x48' TRENCHES. OK TO START. (te)

INSTALLATION: 03/18/2020 SL INSTALLED IN ROCK OUT CROP. BEDDED  
AND COVERED IN GRAVEL 10' BELOW TOP OF WALL. TANK FRIDAY  
3/20/20 - tank in place w/ line to dbox installed, contractor stated that he'd continue  
working on the trenches and will leave the dbox and trench ends open for  
inspection & leveler install. (te)

FINAL INSPECTOR \_\_\_\_\_

DATE OF APPROVAL \_\_\_\_\_

NOT TO SCALE

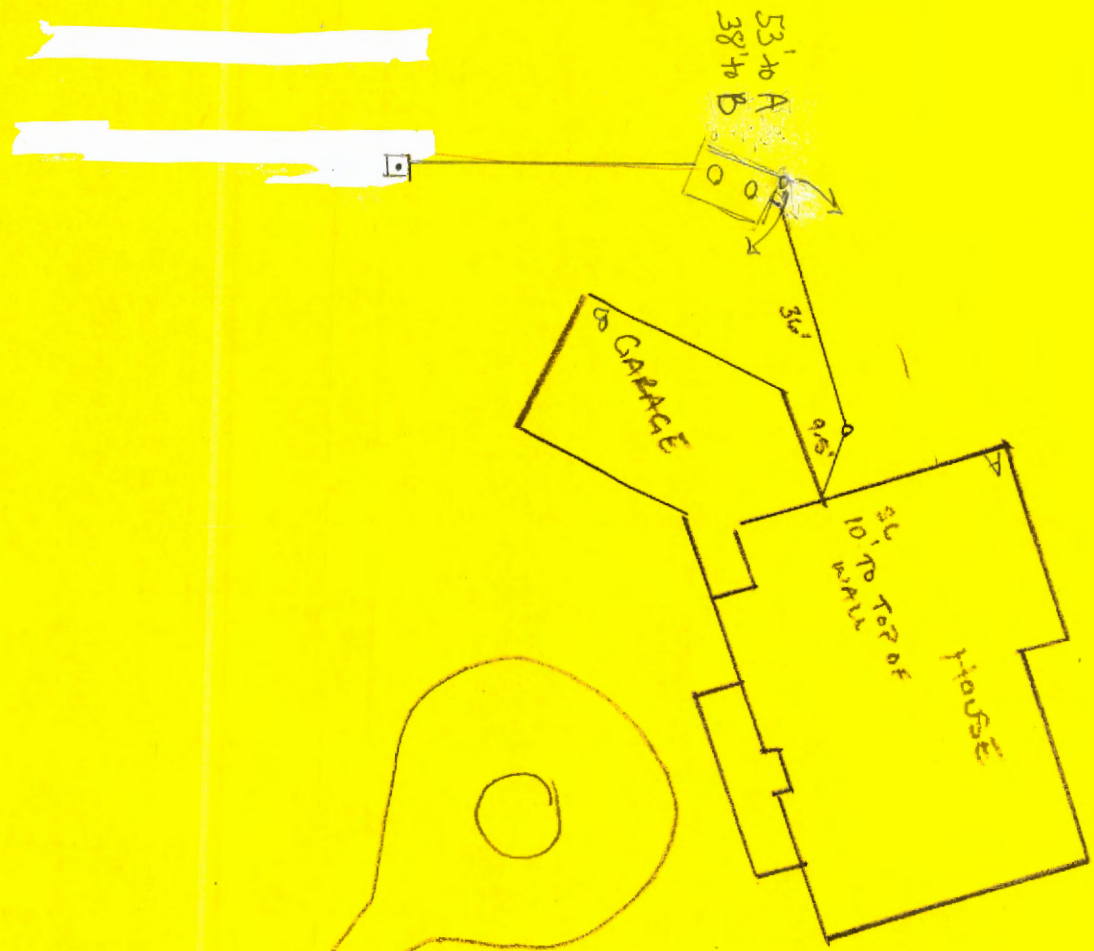

12/21/85 - H-9-21