

12.6.21 - Approved B.P. - H.O.

Menu Save Reset Cancel Help

Record Detail * (This section is required.)

Permit Type Building/Residential/Misc/Pool Spa Permit Number B21002633 Opened Date 07/21/2021

Description of Work
SFD/ Installation of 20'-40' in-ground concrete pool with cartridge filter to be filled by truck. 3.5'-6' deep.

[check spelling](#)

Address * (This section is required.)

Search Reset Clear Get Parcel & Owner

Street # 11748 Street Name PINDELL CHASE Street Type DR

Unit Type --Select-- Unit # X Coordinate -76.92447 Y Coordinate 39.16842

City FULTON State MD Zip Code 20759 Primary Yes

Parcel * (This section is required.)

Search Reset Clear Get Address & Owner

GIS ID * 911168 Parcel Parcel Area 1.14 Land Value 351400 Improved Value 1006000 Exemption Value 654600 Plan Area RURAL

Legal Description
IMPSLOT 12 1.147 A[]11748 PINDELL CHASE DR[]PINDELL CHASE

[check spelling](#)

Block Lot Census Tract Council Dist Inspection Dist Supervisor Dist Map # DAP Zone

Plan Area State Tax Id Subdivision Name

Section Area Tax Map

Grid Zoning District ADC Map

SDP No. Final Plan No. WP File No.

Record Plat No. WS Contract No. FDP No. Primary Yes

Owner Occupied Year Built Historic District

Historic District Registry No. Stat Area Flood Plain

Building No

Owner * (This section is required.)

Search Reset Clear

Name * KIM SUNG T

Address Line 1 11748 PINDELL CHASE DR

Address Line 2

Address Line 3

Mail City FULTON Mail State MD Mail Zip Code 20759

Phone 301-452-0955 Primary Yes

E-mail sungtkim@hotmail.com

Cell Number Fax Number

[Empty input fields]

Professionals (This section is not required.)

Search Reset Clear

License # * Business Name
 08010071753 HERITAGE ELITE LLC

License Type * First Name Middle Name Last Name
 MHIC Ind MICHAEL RAYMOND SHAFFERY

Primary Address Line 1
 Yes 8335 PULASKI HWY

Address Line 2

City State ZIP Code
 BALTIMORE MD 21237-0000

Phone 1 Phone 2 Fax
 4108086988 4437037152

E-mail
 MIKE@ELITEPOOLS.COM

Applicant (This section is not required.)

Search As Owner As Lic. Prof As Contact

Type * First Name MI Last Name
 Applicant Michael Shaffery

Relationship Full Name
 Applicant

Primary Organization Name
 Yes Heritage Elite LLC "Elite Pools"

Street Address
 8335 Pulaski Hwy

Address Line 2

City State Zip Code
 Rosedale MD 21237

Phone Cell Fax
 410-808-6988

E-mail *
 mike@elitepools.com

Addl Info

Est Construction Cost * Housing Units * Number of Buildings * Public Owned
 40000 0 0 No

Construction Type
 329 - Structures Other Than Buildings (Retaining Walls/Tents)

POOL INFORMATION

MISCELLANEOUS POOL INFORMATION

Capital Project-No Fee * Capital Project Number Fee Exempt * Water Supply * Sewage Disposal *
 Yes No Yes No Private Private

Existing Use Type of Pool or Spa * Electrical Permit Number Expiration Date
 SFD In Ground Pool 2/7/2022

PAYMENT INFORMATION

Check 1 Payee 1 SAP Doc No SAP Entered

Submit Cancel

Oswald, Hank

From: Oswald, Hank
Sent: Wednesday, September 15, 2021 8:03 AM
To: 'MIKE@ELITEPOOLS.COM'
Subject: FW: B21002633_11748 Pindell Chase_Site Plan Revision
Attachments: Septic Record_11748 Pindell Chase.pdf; Well and Septic Setback Distances.pdf

Hi Mike:

Did you have any questions regarding my email dated 8.11.21 for building permit # B21002633? Once you submit the revision to permits office, please let me know, so I can look for it in the system.

Thanks,

Hank

Hank Oswald, L.E.H.S.
Howard County Health Department
Bureau of Environmental Health
Well & Septic Program
8930 Stanford Boulevard
Columbia, MD 21045
(410) 313 - 1786
hoswald@howardcountymd.gov

From: Oswald, Hank
Sent: Wednesday, August 11, 2021 2:50 PM
To: 'MIKE@ELITEPOOLS.COM' <MIKE@ELITEPOOLS.COM>
Subject: B21002633_11748 Pindell Chase_Site Plan Revision

Hi Mike:

Please revise the site plan for building permit # B21002633 (11748 Pindell Chase Dr) to scale between 1:30 and 1:100 and show the well and septic components. I need to see the pool etc. meets the required well and septic setback distances. You will need to submit the revised site plan to DILP. I've attached a copy of the septic record/As-built drawing for reference.

Let me know if you have any questions.

Thanks,

Hank

Hank Oswald, L.E.H.S.
Howard County Health Department
Bureau of Environmental Health
Well & Septic Program

8930 Stanford Boulevard
Columbia, MD 21045
(410) 313 - 1786
hoswald@howardcountymd.gov

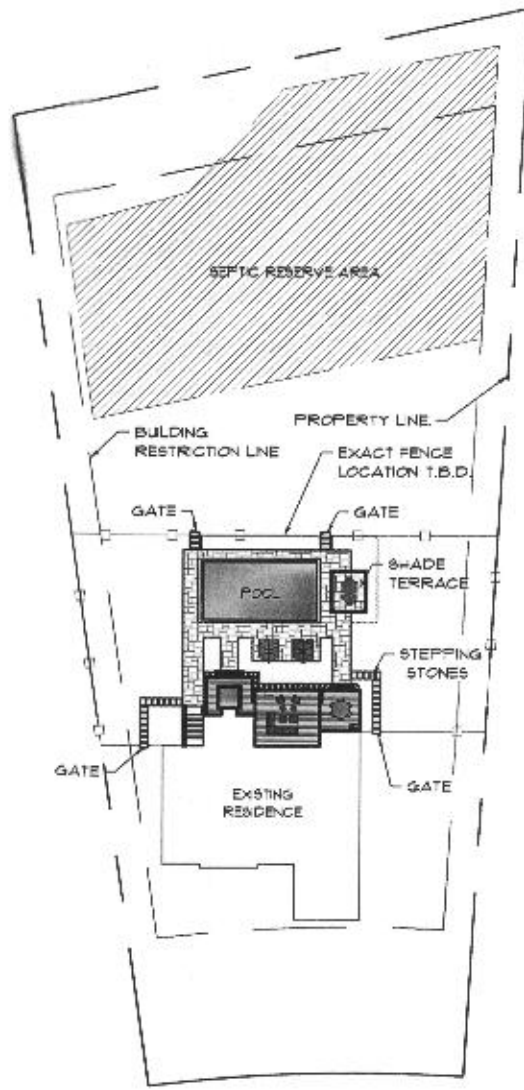

OVERALL SITE PLAN

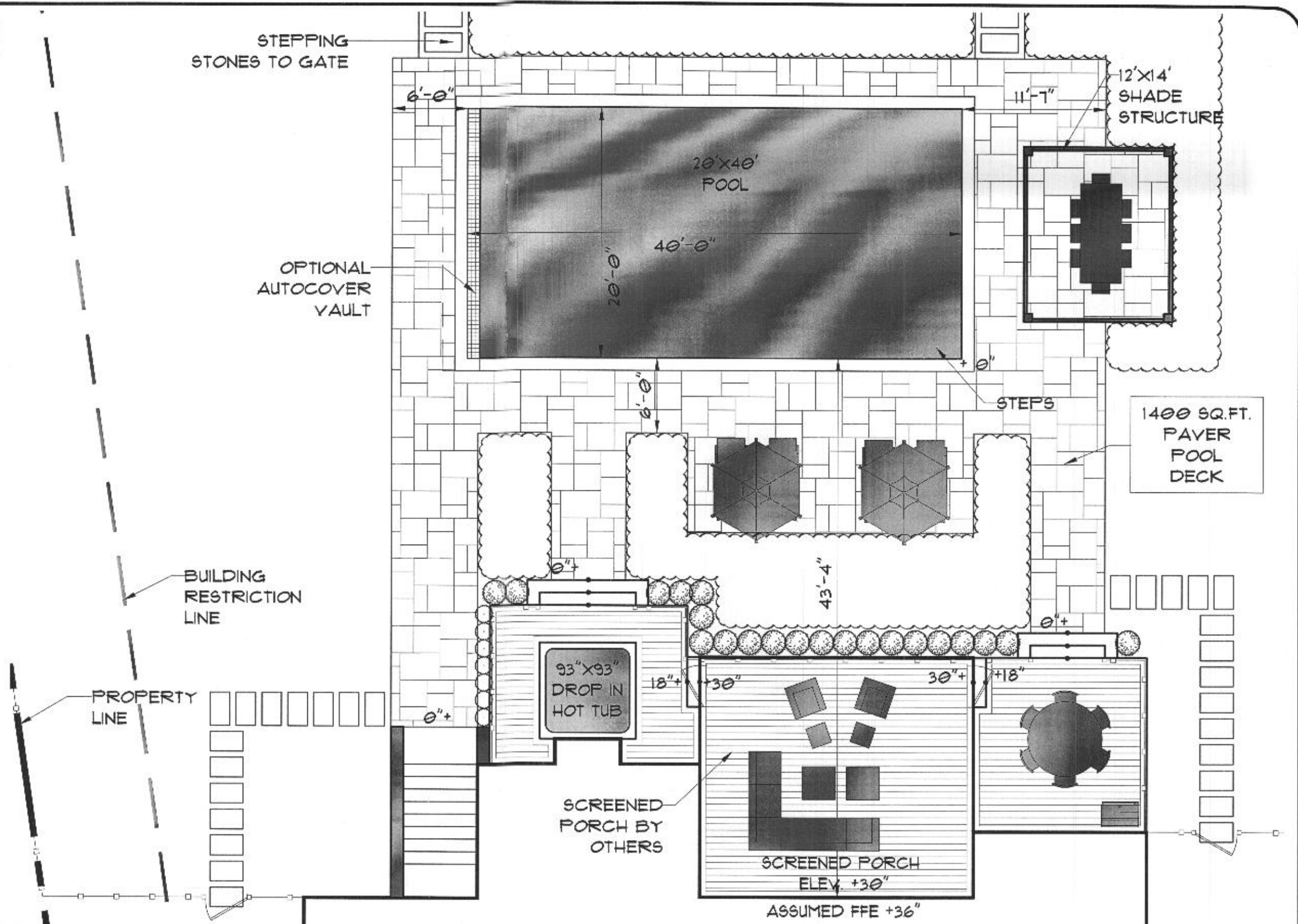

Elite Pools

400 EAST PRATT STREET, SUITE 800
BALTIMORE, MARYLAND 21201
410-454-1546 OFFICE
WWW.ELITEPOOLS.COM

KIM RESIDENCE

11748 PINDELL CHASE DRIVE
FULTON, MD

SCHEMATIC PLANS

01-EE*

DATE 1/13/2012
SCALE 1/8"=1'-0"

L1

NO. REVISIONS DATE

Oswald, Hank

From: Oswald, Hank
Sent: Wednesday, August 11, 2021 2:50 PM
To: 'MIKE@ELITEPOOLS.COM'
Subject: B21002633_11748 Pindell Chase_Site Plan Revision
Attachments: Septic Record_11748 Pindell Chase.pdf; Well and Septic Setback Distances.pdf

Hi Mike:

Please revise the site plan for building permit # B21002633 (11748 Pindell Chase Dr) to scale between 1:30 and 1:100 and show the well and septic components. I need to see the pool etc. meets the required well and septic setback distances. You will need to submit the revised site plan to DILP. I've attached a copy of the septic record/As-built drawing for reference.

Let me know if you have any questions.

Thanks,

Hank

Hank Oswald, L.E.H.S.
Howard County Health Department
Bureau of Environmental Health
Well & Septic Program
8930 Stanford Boulevard
Columbia, MD 21045
(410) 313 - 1786
hoswald@howardcountymd.gov

