

77-01013

C 1	63895	SEQUENCE NO. (MDE USE ONLY)	STATE OF MARYLAND WELL COMPLETION REPORT	THIS REPORT MUST BE SUBMITTED WITHIN 45 DAYS AFTER WELL IS COMPLETED.
1 2 3 4 5 6 (THIS NUMBER IS TO BE PUNCHED IN COLS. 3-6 ON ALL CARDS)		FILL IN THIS FORM COMPLETELY PLEASE TYPE		
ST/CO USE ONLY DATE Received MM DD YY		DATE WELL COMPLETED MM DD YY		COUNTY NUMBER

DATE Received: MM 04 DD 01 YY 2021
 DATE WELL COMPLETED: MM 04 DD 01 YY 2021
 Depth of Well: 240 (TO NEAREST FOOT)
 PERMIT NO. FROM "PERMIT TO DRILL WELL": HO-20-0077
 COUNTY NUMBER: 28 29 30 31 32 33 34 35 36 37

OWNER: Kirkley Douglas
 WELL SITE ADDRESS: 7538 Cherry Tree Drive TOWN FULTON
 SUBDIVISION: Manesfield 2205 SECTION _____ LOT 5

WELL LOG		
Not required for driven wells		
STATE THE KIND OF FORMATIONS PENETRATED, THEIR COLOR, DEPTH, THICKNESS AND IF WATER BEARING		
DESCRIPTION (Use additional sheets if needed)	FEET	
	FROM	TO
Top Soil	0	1
Silty Sand	1	10'
Fractured, Weathered Rock Sand & gravel	10'	100'
Rock. M. Hard Grey	100'	240'
Installed closed loop geothermal x2		

GROUTING RECORD	
WELL HAS BEEN GROUTED (Circle Appropriate Box) <input checked="" type="radio"/> Y <input type="radio"/> N	
TYPE OF GROUTING MATERIAL (Circle one) CEMENT <input checked="" type="radio"/> CM BENTONITE CLAY <input type="radio"/> BC	
NO. OF BAGS <u>13</u>	NO. OF POUNDS <u>650</u>
GALLONS OF WATER <u>312</u>	
DEPTH OF GROUT SEAL (to nearest foot) from <u>0</u> TOP <u>240</u> ft. to <u>240</u> BOTTOM <u>58</u>	

CASING RECORD		
casing types insert appropriate code below	<input checked="" type="radio"/> ST STEEL	<input type="radio"/> CO CONCRETE
	<input type="radio"/> PL PLASTIC	<input type="radio"/> OT OTHER
MAIN CASING TYPE	Nominal diameter top (main) casing (nearest inch):	Total depth of main casing (nearest foot):
<u>60</u> <u>61</u>	<u>63</u> <u>64</u>	<u>66</u> <u>70</u>

E A C H C A S I N G	OTHER CASING (if used)			
	diameter inch	depth (feet) from	to	
	_____	_____	_____	_____
	_____	_____	_____	_____

SCREEN RECORD	
screen type or open hole	<input checked="" type="radio"/> ST <input type="radio"/> BR <input type="radio"/> HO
(insert appropriate code below)	STEEL BRASS OPEN HOLE
	<input type="radio"/> PL <input type="radio"/> OT
	PLASTIC OTHER

NUMBER OF UNSUCCESSFUL WELLS: 0

WELL HYDROFRACTURED: Y N

CIRCLE APPROPRIATE LETTER
A A WELL WAS ABANDONED AND SEALED WHEN THIS WELL WAS COMPLETED
E ELECTRIC LOG OBTAINED
P TEST WELL CONVERTED TO PRODUCTION WELL

I HEREBY CERTIFY THAT THIS WELL HAS BEEN CONSTRUCTED IN ACCORDANCE WITH COMAR 26.04.04 "WELL CONSTRUCTION" AND IN CONFORMANCE WITH ALL CONDITIONS STATED IN THE ABOVE CAPTIONED PERMIT, AND THAT THE INFORMATION PRESENTED HEREIN IS ACCURATE AND COMPLETE TO THE BEST OF MY KNOWLEDGE.

DRILLERS LIC. NO. M 46598
 DRILLERS SIGNATURE: Wesley A. Wloper
 (MUST MATCH SIGNATURE ON APPLICATION)

DEPTH (nearest ft.)	
1	2
8	9 11 15 17 21
23	24 26 30 32 36
38	39 41 45 47 51
SLOT SIZE 1 _____ 2 _____ 3 _____	
DIAMETER OF SCREEN _____ (NEAREST INCH)	
_____	_____
from	to

GRAVEL PACK IF WELL DRILLED WAS FLOWING WELL INSERT F IN BOX 68

PUMPING TEST	
HOURS PUMPED (nearest hour)	<u>N/A</u>
PUMPING RATE (gal. per min.)	<u>N/A</u>
METHOD USED TO MEASURE PUMPING RATE	<u>N/A</u>
WATER LEVEL (distance from land surface)	
BEFORE PUMPING	<u>20</u> ft.
WHEN PUMPING	<u>N/A</u> ft.
TYPE OF PUMP USED (for test)	
<input type="radio"/> A air	<input type="radio"/> P piston
<input type="radio"/> C centrifugal	<input type="radio"/> R rotary
<input type="radio"/> J jet	<input type="radio"/> S submersible
<input type="radio"/> T turbine	<input type="radio"/> O other (describe below)

PUMP INSTALLED	
DRILLER INSTALLED PUMP (CIRCLE) (YES OR NO)	YES <input type="radio"/> NO <input checked="" type="radio"/>
IF DRILLER INSTALLS PUMP, THIS SECTION MUST BE COMPLETED FOR ALL WELLS.	
TYPE OF PUMP INSTALLED PLACE (A,C,J,P,R,S,T,O) IN BOX 29	_____
CAPACITY: GALLONS PER MINUTE (to nearest gallon)	_____
PUMP HORSE POWER	_____
PUMP COLUMN LENGTH (nearest ft.)	_____
CASING HEIGHT (circle appropriate box and enter casing height)	_____
<input type="radio"/> + above	LAND SURFACE
<input checked="" type="radio"/> - below	<u>5</u> (nearest foot)

LATITUDE 39.162514
 LONGITUDE 76.922090
 (DEFAULT COORD. WGS 84)

Pursuant to §10-624 of the State Govt. Article of the Maryland Code personal info. requested on this form is used in processing this form pursuant to COMAR 26.04.04. Failure to provide the info. may result in this form not being processed. You have the right to inspect, amend, or correct this form. The Maryland Department of the Environment is subject to the Maryland Public

B 1	SEQUENCE NO. (MDE USE ONLY) 48289	STATE OF MARYLAND APPLICATION FOR PERMIT TO DRILL WELL please type 508754	STATE PERMIT NUMBER HO - 20 - 0077 <small>70 fill in this form completely 79</small>
------------	--	--	---

OWNER INFORMATION

Date Received (APA) **02/11/21**

8 MM DD YY 13

15 Last Name **Kirkley** Owner **Douglas** First Name 34

36 **7538 Cherry Tree Dr** Street or RFD 55

57 **FULTON** Town 70 **MD** State 72 **20759** Zip 76

B 3 LOCATION OF WELL

8 COUNTY **HOWARD** 21

23 SUBDIVISION **MCDRESFIELD 2205** 42

SECTION **44** 46 LOT **5** 48 50

52 NEAREST TOWN 71

DRILLER INFORMATION

Driller's Name **Wesley Wolfe** License No. **MWD 598** 76 81

Firm Name **Chesapeake Geosystems Inc**

Address **6720 Ft. Smallwood Rd Baltimore Md 21226**

Signature **Wesley Wolfe** Date **02-08-21**

B 4 SOURCES OF DRILLING WATER

1. **Public**

2.

3.

11 STREET ADDRESS **7538 Cherry Tree Dr** 30

ON WHICH SIDE OF ROAD (CIRCLE APPROPRIATE BOX)

34 **32** 37 DISTANCE FROM ROAD FT

ENTER FT OR MI **38** 39

TAX MAP: **0041** BLK: _____ PARCEL **0279**

B 2 WELL INFORMATION

APPROX. PUMPING RATE (GAL. PER MIN.) **N/A** 8 12

AVERAGE DAILY QUANTITY NEEDED (GAL. PER DAY) **N/A** 14 20

USE FOR WATER (CIRCLE APPROPRIATE BOX)

DOMESTIC POTABLE SUPPLY & RESIDENTIAL IRRIGATION

FARMING (LIVESTOCK WATERING & AGRICULTURAL IRRIGATION)

INDUSTRIAL, COMMERCIAL, DEWATERING

PUBLIC WATER SUPPLY WELL

TEST, OBSERVATION, MONITORING

OPEN LOOP GEOTHERMAL

CLOSED LOOP GEOTHERMAL

NOT TO BE FILLED IN BY DRILLER HEALTH DEPARTMENT APPROVAL

COUNTY NAME **Howard** COUNTY NO. **13**

STATE SIGNATURE _____ INSERT S → 41

DATE ISSUED **03/02/21** APPROVED **03/02/22**

43 MM DD YY 48 CO SIGNATURE _____ EXP. DATE

DOV: 3/29/21 (S) DOG: 4/1/21 (S)

APPROXIMATE DEPTH OF WELL **240** FEET 24 28

APPROXIMATE DIAMETER OF WELL **6** INCH NEAREST INCH

PROPOSED LOCATION OF WELL ON LOT

SHOW PERMANENT STRUCTURES SUCH AS BUILDINGS, SEPTIC SYSTEM, ROADS AND/OR LANDMARKS AND INDICATE NOT LESS THAN TWO DISTANCE MEASUREMENTS TO WELL

METHOD OF DRILLING (circle one)

BORED (or Augered) JETTED Jetted & DRIVEN

30 AIR-ROTary AIR-PERCussion ROTARY (Hydraulic Rotary)

37 CABLE REVERSE-ROTary DRIVE-POINT

other _____

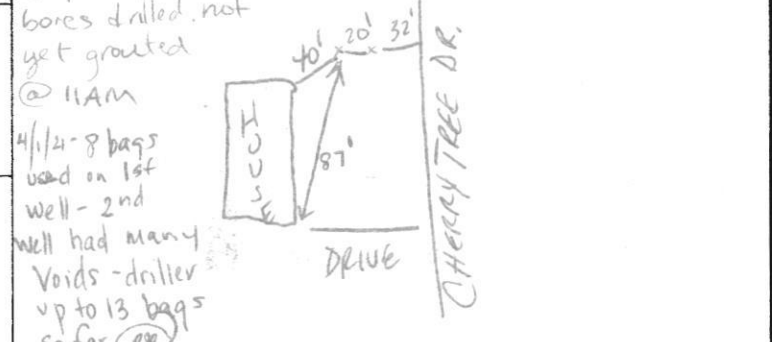

REPLACEMENT OR DEEPEMED WELLS (CIRCLE APPROPRIATE BOX)

THIS WELL WILL NOT REPLACE AN EXISTING WELL

THIS WELL WILL REPLACE A WELL THAT WILL BE ABANDONED AND SEALED

39 THIS WELL WILL REPLACE A WELL THAT WILL BE USED AS A STANDBY-CONTACT LOCAL APPROVING AUTHORITY FOR POLICY ON STANDBY WELLS

THIS WELL WILL DEEPEM AN EXISTING WELL

PERMIT NUMBER OF WELL TO BE REPLACED OR DEEPEMED (IF AVAILABLE) 41 _____ 52

Pursuant to § 10-624 of the State Govt. Article of the Maryland Code, personal info requested on this form is used in processing this form pursuant to COMAR 26.04.04. Failure to provide the info may result in this form not being processed. You have the right to inspect, amend, or correct this form. The Maryland Department of the Environment is subject to the Maryland Public Information Act. This form may be made available on the Internet via MDE's website and is subject to inspection or copying, in whole or in part, by the public and other governmental agencies, if not protected by federal or State Law.

Not to be filled in by driller (MDE OR COUNTY USE ONLY)

APPROX. PERMIT NUMBER _____ **G** _____

PERMIT No. **HO - 20 - 0077**
70 71 72 73 74 75 76 77 78 79

SPECIAL CONDITIONS

NOTE: APPROVING AUTHORITIES SHOULD USE SEPARATE SHEET IF NEEDED

DO NOT REMOVE THIS TAG
 DEPARTMENT OF THE ENVIRONMENT
 WELL PERMIT NUMBER
 HO-20-0077
 INFORMATION - GIVE NUMBER AND WRITE
 1800 WASHINGTON BLVD
 BALTIMORE MARYLAND 21230

DOUG KIRKLEY
 7538 Cherry Tree Dr.
 Fulton Md 20759
 2 wells @ 240' each
 Closed loop geothermal
 with Factory U-Bends

Approved 03/02/21 (87)
 Staked by driller

OK Cleanout

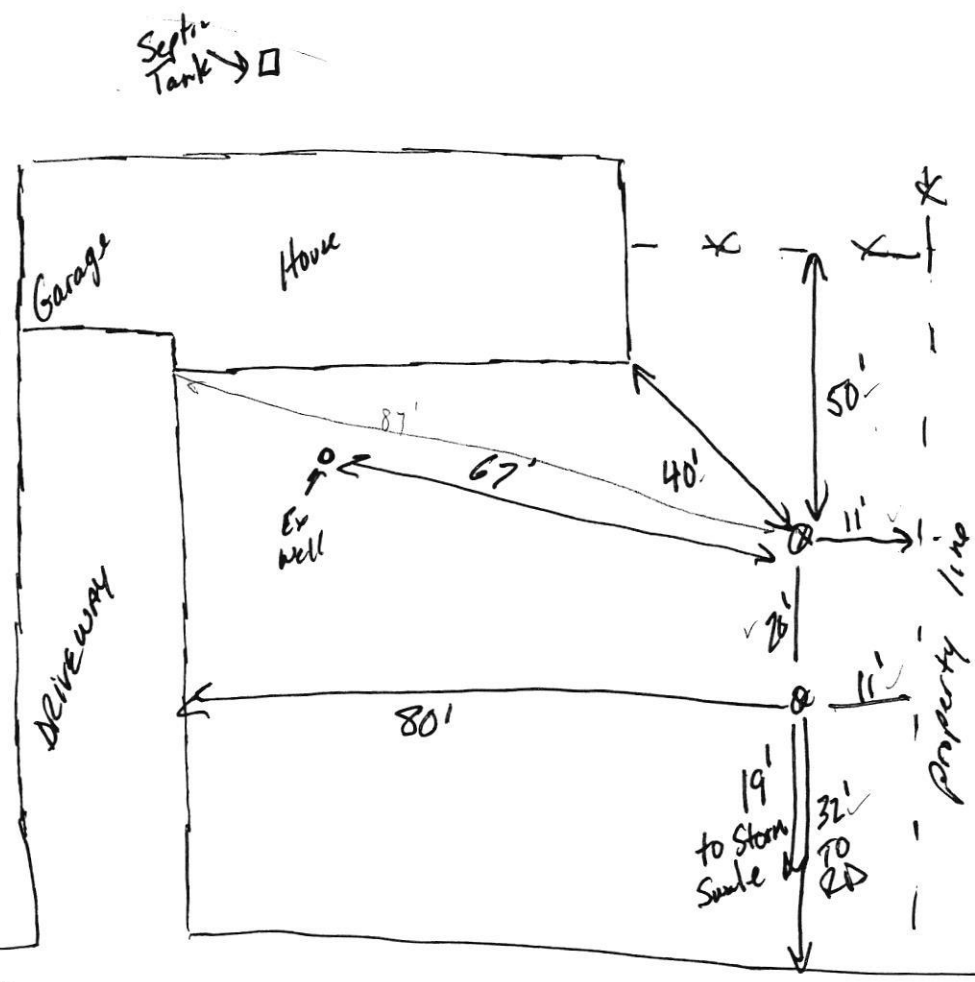

Cherry Tree Drive

Real Property Data Search

Search Result for HOWARD COUNTY

[View Map](#) [View GroundRent Redemption](#) [View GroundRent Registration](#)

Special Tax Recapture: None

Account Identifier: District - 05 Account Number - 367638

Owner Information

Owner Name:	KIRKLEY DOUGLASS COLLINS KIRKLEY SARAH GIFT	Use:	RESIDENTIAL
Mailing Address:	7538 CHERRY TREE DR FULTON MD 20759-9736	Principal Residence:	YES
		Deed Reference:	/19041/ 00488

Location & Structure Information

Premises Address:	7538 CHERRY TREE DR FULTON 20759-0000	Legal Description:	LOT 5 BL A 7538 CHERRY TREE DR MOORESFIELD
--------------------------	--	---------------------------	--

Map:	Grid:	Parcel:	Neighborhood:	Subdivision:	Section:	Block:	Lot:	Assessment Year:	Plat No:
0041	0014	0279	5020202.14	2205			5	2020	Plat Ref:

Town: None

Primary Structure Built	Above Grade Living Area	Finished Basement Area	Property Land Area	County Use
1963	1,560 SF		40,685 SF	

Stories	Basement	Type	Exterior	Quality	Full/Half Bath	Garage	Last Notice of Major Improvements
1	YES	STANDARD UNIT	BRICK/	4	1 full/ 1 half		

Value Information

	Base Value	Value	Phase-in Assessments	
		As of	As of	As of
		01/01/2020	07/01/2020	07/01/2021
Land:	216,200	269,800		
Improvements	165,100	189,800		
Total:	381,300	459,600	407,400	433,500
Preferential Land:	0	0		

Transfer Information

Seller: SMITH ANNA D	Date: 12/02/2019	Price: \$440,000
Type: ARMS LENGTH IMPROVED	Deed1: /19041/ 00488	Deed2:
Seller:	Date:	Price: \$0
Type:	Deed1: /00696/ 00209	Deed2:
Seller:	Date:	Price:
Type:	Deed1:	Deed2:

Exemption Information

Partial Exempt Assessments:	Class	07/01/2020	07/01/2021
County:	000	0.00	
State:	000	0.00	
Municipal:	000	0.00 0.00	0.00 0.00

Special Tax Recapture: None

Homestead Application Information

Homestead Application Status: No Application

Homeowners' Tax Credit Application Information

Homeowners' Tax Credit Application Status: No Application

Date: