

04-600011

B 1 63651

SEQUENCE NO. (MDE USE ONLY)

STATE OF MARYLAND APPLICATION FOR PERMIT TO DRILL WELL please type

STATE PERMIT NUMBER

70 fill in this form completely 79

504841

OWNER INFORMATION: Date Received (APA) 04/15/19, Capelle Andrew + Lauren, 1023 Fairlane Road, Woodbine MD 21797

LOCATION OF WELL: Howard County, Fairlane Farm Pt 1, SECTION 44, LOT 18, Woodbine

DRILLER INFORMATION: Marshal Amuth M SD 106, Allied Well Drilling, PO Box 129 Annapolis Junction MD 20701, Signature: Marshal Amuth, Date: 04/10/19

SOURCES OF DRILLING WATER: 1. Public, 1023 Fairlane Rd, DISTANCE FROM ROAD 65 FT, TAX MAP: 0008, PARCEL: 0008

WELL INFORMATION: APPROX. PUMPING RATE 8 GAL. PER MIN., AVERAGE DAILY QUANTITY NEEDED 14 GAL. PER DAY

NOT TO BE FILLED IN BY DRILLER HEALTH DEPARTMENT APPROVAL. COUNTY NAME, STATE SIGNATURE, DATE ISSUED, CO SIGNATURE, EXP. DATE

USE FOR WATER (CIRCLE APPROPRIATE BOX): [C] CLOSED LOOP GEOTHERMAL, 3 loops

APPROXIMATE DEPTH OF WELL 400 FEET, APPROXIMATE DIAMETER OF WELL 6 INCH

PROPOSED LOCATION OF WELL ON LOT SHOW PERMANENT STRUCTURES SUCH AS BUILDINGS, SEPTIC SYSTEM, ROADS AND/OR LANDMARKS AND INDICATE NOT LESS THAN TWO DISTANCE MEASUREMENTS TO WELL

METHOD OF DRILLING (circle one): BORED (or Augered) AIR-ROTary, JETTED AIR-PERcussion, Jetted & DRIVEN ROTARY (Hydraulic Rotary), Drive-POINT

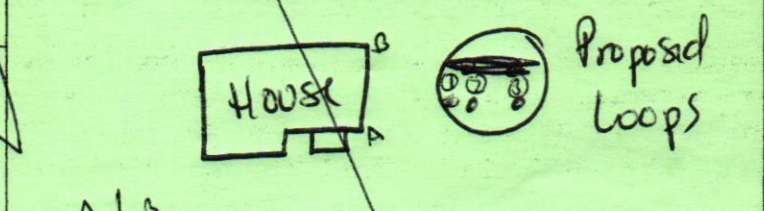

REPLACEMENT OR DEEPEMED WELLS (CIRCLE APPROPRIATE BOX): [N] THIS WELL WILL NOT REPLACE AN EXISTING WELL

Pursuant to § 10-624 of the State Govt. Article of the Maryland Code, personal info requested on this form is used in processing this form pursuant to COMAR 26.04.04. Failure to provide the info may result in this form not being processed.

Not to be filled in by driller (MDE OR COUNTY USE ONLY): APPROX. PERMIT NUMBER G, PERMIT No. 70 71 72 73 74 75 76 77 78 79

SPECIAL CONDITIONS NOTE APPROVING AUTHORITIES SHOULD USE SEPARATE SHEET IF NEEDED

04-60001

B 1 **63651** SEQUENCE NO. (MDE USE ONLY) STATE OF MARYLAND APPLICATION FOR PERMIT TO DRILL WELL STATE PERMIT NUMBER

504841 please type 70 fill in this form completely 79

1 2 3 6

Date Received (APA) 04/15/19

8 MM DD YY 13

15 Last Name First Name 34

36 Street or RFD 55

57 Town 70 State 72 Zip 76

OWNER INFORMATION

Capelle Andrew + Lauren

1023 Fairlane Road

Woodbine MD 21797

B 3 LOCATION OF WELL

8 COUNTY 21

23 SUBDIVISION 42

SECTION 44 46 LOT 18 48 50

52 NEAREST TOWN 71

Howard

Fairlane Farm PH 1

Woodbine

DRILLER INFORMATION

Driller's Name Marshall Amette M S D License No. 106 76 81

Firm Name Allied Well Drilling

Address PO Box 129 Annapolis Junction MD 20701

Signature Marshall Amette Date 04/10/19

B 4 SOURCES OF DRILLING WATER

1. Public

2.

3.

11 STREET ADDRESS 30

1023 Fairlane Rd.

ON WHICH SIDE OF ROAD (CIRCLE APPROPRIATE BOX)

34 37

DISTANCE FROM ROAD ENTER FT OR MI 38 39

TAX MAP: 0008 BLK: PARCEL 0008

NORTH N WEST S EAST E SOUTH S

B 2 WELL INFORMATION

APPROX. PUMPING RATE (GAL. PER MIN.) 8 12

AVERAGE DAILY QUANTITY NEEDED (GAL. PER DAY) 14 20

USE FOR WATER (CIRCLE APPROPRIATE BOX)

D DOMESTIC POTABLE SUPPLY & RESIDENTIAL IRRIGATION

F FARMING (LIVESTOCK WATERING & AGRICULTURAL IRRIGATION)

I INDUSTRIAL, COMMERCIAL, DEWATERING

P PUBLIC WATER SUPPLY WELL

T TEST, OBSERVATION, MONITORING

O OPEN LOOP GEOTHERMAL

C CLOSED LOOP GEOTHERMAL

22

3 loops

NOT TO BE FILLED IN BY DRILLER HEALTH DEPARTMENT APPROVAL

COUNTY NAME COUNTY NO.

STATE SIGNATURE INSERT S 41

DATE ISSUED

43 MM DD YY 48 CO SIGNATURE EXP. DATE

APPROXIMATE DEPTH OF WELL 400 FEET

24 28

APPROXIMATE DIAMETER OF WELL 6 INCH

NEAREST INCH

METHOD OF DRILLING (circle one)

BORED (or Augered) JETTED Jetted & DRIVEN

30 AIR-ROTary AIR-PERCussion ROTARY (Hydraulic Rotary)

37 CABLE REVERSE-ROTary DRIVE-POINT

other

REPLACEMENT OR DEEPEMED WELLS (CIRCLE APPROPRIATE BOX)

N THIS WELL WILL NOT REPLACE AN EXISTING WELL

Y THIS WELL WILL REPLACE A WELL THAT WILL BE ABANDONED AND SEALED

39 S THIS WELL WILL REPLACE A WELL THAT WILL BE USED AS A STANDBY-CONTACT LOCAL APPROVING AUTHORITY FOR POLICY ON STANDBY WELLS

D THIS WELL WILL DEEPEM AN EXISTING WELL

PERMIT NUMBER OF WELL TO BE REPLACED OR DEEPEMED (IF AVAILABLE) 41 52

Not to be filled in by driller (MDE OR COUNTY USE ONLY)

APPROP. PERMIT NUMBER G

PERMIT No. 70 71 72 73 74 75 76 77 78 79

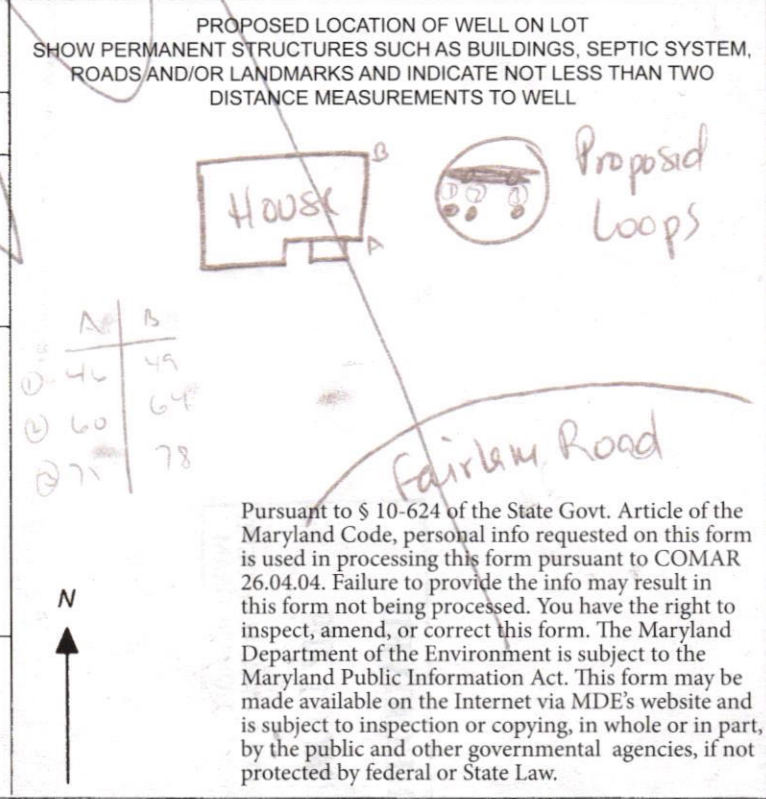

B 1

63651

SEQUENCE NO. (MDE USE ONLY)

STATE OF MARYLAND APPLICATION FOR PERMIT TO DRILL WELL

STATE PERMIT NUMBER

please type

70 fill in this form completely 79

Date Received (APA)

8 MM DD YY 13

OWNER INFORMATION

Capelle Andrew + Lauren, 1023 Fairlane Road, Woodbine MD 21797

B 3

LOCATION OF WELL

Howard County, Fairlane Farm PH I, SECTION 44, LOT 18, Woodbine

DRILLER INFORMATION

Driller's Name: Marshal Amette, License No. M SD 106, Firm Name: Allied Well Drilling, Address: PO Box 129 Annapolis Junction MD 20701, Signature: Marshal Amette, Date: 04/10/19

B 4

SOURCES OF DRILLING WATER

1. Public

1023 Fairlane Rd, STREET ADDRESS, ON WHICH SIDE OF ROAD (CIRCLE APPROPRIATE BOX), DISTANCE FROM ROAD ENTER FT OR MI, TAX MAP: 0008, BLK: PARCEL 0008

B 2

WELL INFORMATION

APPROX. PUMPING RATE (GAL. PER MIN.) 8 12, AVERAGE DAILY QUANTITY NEEDED (GAL. PER DAY) 14 20

USE FOR WATER (CIRCLE APPROPRIATE BOX)

- D DOMESTIC POTABLE SUPPLY & RESIDENTIAL IRRIGATION, F FARMING (LIVESTOCK WATERING & AGRICULTURAL IRRIGATION), I INDUSTRIAL, COMMERCIAL, DEWATERING, P PUBLIC WATER SUPPLY WELL, T TEST, OBSERVATION, MONITORING, O OPEN LOOP GEOTHERMAL, C CLOSED LOOP GEOTHERMAL

NOT TO BE FILLED IN BY DRILLER HEALTH DEPARTMENT APPROVAL

COUNTY NAME, COUNTY NO., STATE SIGNATURE, DATE ISSUED, CO SIGNATURE, EXP. DATE

APPROXIMATE DEPTH OF WELL 400 FEET

APPROXIMATE DIAMETER OF WELL NEAREST INCH

METHOD OF DRILLING (circle one)

BORED (or Augered) AIR-ROTary, AIR-PERcussion, CABLE, JETTED, ROTARY (Hydraulic Rotary), Drive-POINT

REPLACEMENT OR DEEPEMED WELLS (CIRCLE APPROPRIATE BOX)

- N THIS WELL WILL NOT REPLACE AN EXISTING WELL, Y THIS WELL WILL REPLACE A WELL THAT WILL BE ABANDONED AND SEALED, S THIS WELL WILL REPLACE A WELL THAT WILL BE USED AS A STANDBY-CONTACT LOCAL APPROVING AUTHORITY FOR POLICY ON STANDBY WELLS, D THIS WELL WILL DEEPEM AN EXISTING WELL

PERMIT NUMBER OF WELL TO BE REPLACED OR DEEPEMED (IF AVAILABLE) 41 52

Not to be filled in by driller (MDE OR COUNTY USE ONLY)

APPROP. PERMIT NUMBER G

PERMIT No. 70 71 72 73 74 75 76 77 78 79

PROPOSED LOCATION OF WELL ON LOT SHOW PERMANENT STRUCTURES SUCH AS BUILDINGS, SEPTIC SYSTEM, ROADS AND/OR LANDMARKS AND INDICATE NOT LESS THAN TWO DISTANCE MEASUREMENTS TO WELL



Pursuant to § 10-624 of the State Govt. Article of the Maryland Code, personal info requested on this form is used in processing this form pursuant to COMAR 26.04.04. Failure to provide the info may result in this form not being processed. You have the right to inspect, amend, or correct this form. The Maryland Department of the Environment is subject to the Maryland Public Information Act. This form may be made available on the Internet via MDE's website and is subject to inspection or copying, in whole or in part, by the public and other governmental agencies, if not protected by federal or State Law.

SPECIAL CONDITIONS

NOTE APPROVING AUTHORITIES SHOULD USE SEPARATE SHEET IF NEEDED-

B 1 SEQUENCE NO. (MDE USE ONLY) 63651

STATE OF MARYLAND APPLICATION FOR PERMIT TO DRILL WELL please type

STATE PERMIT NUMBER 70 fill in this form completely 79

OWNER INFORMATION Date Received (APA) 04/15/19 8 MM DD YY 13 Capelle Andrew + Lauren 15 Last Name Owner First Name 34 1023 Fairlane Road 36 Street or RFD 55 Woodbine MD 21797 57 Town 70 State 72 Zip 76

B 3 LOCATION OF WELL Howard 8 COUNTY 21 Fairlane Farm PH 1 23 SUBDIVISION 42 SECTION 44 46 LOT 18 48 50 Woodbine 52 NEAREST TOWN 71

DRILLER INFORMATION Marshall Annette M S D 106 76 Driller's Name License No. 81 Allied Well Drilling Firm Name PO Box 129 Annapolis Junction MD 20701 Address Marshall Annette 04/10/19 Signature Date

B 4 SOURCES OF DRILLING WATER 1. Public 2. 3.

1023 Fairlane Rd 11 STREET ADDRESS 30 ON WHICH SIDE OF ROAD (CIRCLE APPROPRIATE BOX) NORTH N WEST W SOUTH S EAST E 34 37 DISTANCE FROM ROAD ENTER FT OR MI 38 39 TAX MAP: 0008 BLK: PARCEL 0008

B 2 WELL INFORMATION APPROX. PUMPING RATE (GAL. PER MIN.) 8 12 AVERAGE DAILY QUANTITY NEEDED (GAL. PER DAY) 14 20

NOT TO BE FILLED IN BY DRILLER HEALTH DEPARTMENT APPROVAL COUNTY NAME COUNTY NO. STATE SIGNATURE INSERT S 41 DATE ISSUED 43 MM DD YY 48 CO SIGNATURE EXP. DATE

USE FOR WATER (CIRCLE APPROPRIATE BOX) [D] DOMESTIC POTABLE SUPPLY & RESIDENTIAL IRRIGATION [F] FARMING (LIVESTOCK WATERING & AGRICULTURAL IRRIGATION) [I] INDUSTRIAL, COMMERCIAL, DEWATERING [P] PUBLIC WATER SUPPLY WELL [T] TEST, OBSERVATION, MONITORING [O] OPEN LOOP GEOTHERMAL [C] CLOSED LOOP GEOTHERMAL @ 36 loops

APPROXIMATE DEPTH OF WELL 400 24 28 FEET APPROXIMATE DIAMETER OF WELL 6 NEAREST INCH

PROPOSED LOCATION OF WELL ON LOT SHOW PERMANENT STRUCTURES SUCH AS BUILDINGS, SEPTIC SYSTEM, ROADS AND/OR LANDMARKS AND INDICATE NOT LESS THAN TWO DISTANCE MEASUREMENTS TO WELL HOUSE Proposed Loops Fairlane Road Pursuant to § 10-624 of the State Govt. Article of the Maryland Code, personal info requested on this form is used in processing this form pursuant to COMAR 26.04.04. Failure to provide the info may result in this form not being processed. You have the right to inspect, amend, or correct this form. The Maryland Department of the Environment is subject to the Maryland Public Information Act. This form may be made available on the Internet via MDE's website and is subject to inspection or copying, in whole or in part, by the public and other governmental agencies, if not protected by federal or State Law.

METHOD OF DRILLING (circle one) BORED (or Augered) JETTED Jetted & DRIVEN AIR-ROTary AIR-PERcussion ROTARY (Hydraulic Rotary) 30 CABLE REVerse-ROTary DRive-POINT 37 other

REPLACEMENT OR DEEPEMED WELLS (CIRCLE APPROPRIATE BOX) [N] THIS WELL WILL NOT REPLACE AN EXISTING WELL [Y] THIS WELL WILL REPLACE A WELL THAT WILL BE ABANDONED AND SEALED [S] THIS WELL WILL REPLACE A WELL THAT WILL BE USED AS A STANDBY-CONTACT LOCAL APPROVING AUTHORITY FOR POLICY ON STANDBY WELLS [D] THIS WELL WILL DEEPEM AN EXISTING WELL PERMIT NUMBER OF WELL TO BE REPLACED OR DEEPEMED (IF AVAILABLE) 41 52

Not to be filled in by driller (MDE OR COUNTY USE ONLY) APPROP. PERMIT NUMBER G PERMIT No. 70 71 72 73 74 75 76 77 78 79

SPECIAL CONDITIONS NOTE APPROVING AUTHORITIES SHOULD USE SEPARATE SHEET IF NEEDED-

Cabahug, Joseph

From: Cabahug, Joseph
Sent: Friday, May 10, 2019 3:48 PM
To: 'Donna Perez'
Cc: Wolf, Kevin; Martin, Sharhonda; Rappaport, Ryan; Williams, Jeffrey
Subject: 1023 Fairlane Geotech Well Permit

Hi Donna,

I cannot approve the location of these wells associated with new geotechnical well permit P564841. The site plan shows that they are within 50' of the SDA. All three geo bore locations are within 30' of the SDA.

Thank you,

Joseph C. Cabahug - LEHS
Environmental Health Specialist
Howard County Health Department - Well & Septic Program
Bureau of Environmental Health
8930 Stanford Blvd.
Columbia, MD 21045
(o) 410-313-2643
(f) 410-313-2648



jcabahug@howardcountymd.gov

*tag destroyed,
permit void
9/3/21 (ST)*

CONFIDENTIALITY NOTICE

This message and the accompanying documents are intended only for the use of the individual or entity to which they are addressed and may contain information that is privileged, confidential, or exempt from disclosure under applicable law. If the reader of this email is not the intended recipient, you are hereby notified that you are strictly prohibited from reading, disseminating, distributing, or copying this communication. If you have received this email in error, please notify the sender immediately and destroy the original transmission.

Maura J. Rossman, M.D., Health Officer

MEMORANDUM

TO: Marshal Arnette (MSD 106)
Allied Well Drilling

FROM: Sarah Collins, L.E.H.S. SEC
Howard County Health Department
Well and Septic Program

DATE: April 17, 2019

RE: Geothermal Well Permit for 1023 Fairlane Road

The Health Department received a geothermal well permit for 1023 Fairlane Road. The well permit is missing several pieces of information:

- The well permit must show a site plan for the proposed geothermal wells including at least two distances to permanent structures such as buildings, septic systems, roads and/or landmarks. This is a requirement of Maryland Department of the Environment listed on the well permit.
- The well permit must list a distance of the proposed geothermal wells to the road.
- The accompanying site plan must show distance from the proposed geothermal wells to the existing potable well and septic system on the property.

Please complete the above information and return the permit to our office for review. Feel free to contact me at 410-313-6287 or SCollins@howardcountymd.gov with any questions.

Cc: File