

C1 09422

SEQUENCE NO. (MDE USE ONLY)

STATE OF MARYLAND WELL COMPLETION REPORT

FILL IN THIS FORM COMPLETELY PLEASE PRINT OR TYPE

THIS REPORT MUST BE SUBMITTED WITHIN 45 DAYS AFTER WELL IS COMPLETED.

COUNTY NUMBER A 27487

(THIS NUMBER IS TO BE PUNCHED IN COLS. 3-6 ON ALL CARDS)

ST/CO USE ONLY

DATE WELL COMPLETED

Depth of Well

PERMIT NO. FROM "PERMIT TO DRILL WELL"

DATE RECEIVED MM 12 DD 31 YY 97

MM 12 DD 17 YY 97

22 200 26 (TO NEAREST FOOT)

HO-94-1342

OWNER Sommerer John STREET OR RFD 14702 Betawa Way TOWN Dayton SUBDIVISION Kalmia Farms SECTION LOT 7

WELL LOG Not required for driven wells

STATE THE KIND OF FORMATIONS PENETRATED, THEIR COLOR, DEPTH, THICKNESS AND IF WATER BEARING

Table with columns: DESCRIPTION, FEET (FROM, TO), check if water bearing. Includes entries like Top soil, Shale, Sandstone, Brown milt, Gray milt, etc.

GROUTING RECORD yes no Y N

WELL HAS BEEN GROUTED (Circle Appropriate Box) TYPE OF GROUTING MATERIAL (Circle one) CEMENT CM BENTONITE CLAY BC NO. OF BAGS 12 NO. OF POUNDS 1200 GALLONS OF WATER 60 DEPTH OF GROUT SEAL (to nearest foot) from 0 to 35 ft.

CASING RECORD casing types insert appropriate code below

MAIN CASING TYPE ST Nominal diameter top (main) casing (nearest inch): 6 Total depth of main casing (nearest foot): 40

OTHER CASING (if used) diameter inch depth (feet) from to

SCREEN RECORD screen type or open hole insert appropriate code below ST BR HO PL OT

NUMBER OF UNSUCCESSFUL WELLS: 0

WELL HYDROFRACTURED yes no Y N

CIRCLE APPROPRIATE LETTER A A WELL WAS ABANDONED AND SEALED WHEN THIS WELL WAS COMPLETED E ELECTRIC LOG OBTAINED P TEST WELL CONVERTED TO PRODUCTION WELL

I HEREBY CERTIFY THAT THIS WELL HAS BEEN CONSTRUCTED IN ACCORDANCE WITH COMAR 26.04.04 "WELL CONSTRUCTION" AND IN CONFORMANCE WITH ALL CONDITIONS STATED IN THE ABOVE CAPTIONED PERMIT...

DRILLERS LIC. NO. M WD 040 DRILLERS SIGNATURE (MUST MATCH SIGNATURE ON APPLICATION)

LIC. NO. M WD 481

SITE SUPERVISOR (sign. of driller or journeyman responsible for sitework if different from permittee)

C2 DEPTH (nearest ft.)

Table with columns: E A C H S R E E N, 1-21, 23-36, 38-51. Includes slot size and diameter of screen.

GRAVEL PACK IF WELL DRILLED WAS FLOWING WELL INSERT F IN BOX 68

MDE USE ONLY (NOT TO BE FILLED IN BY DRILLER) T (E.R.O.S.) W Q TELESCOPE CASING LOG INDICATOR OTHER DATA

C3 PUMPING TEST

HOURS PUMPED (nearest hour) 3 PUMPING RATE (gal. per min.) 15 METHOD USED TO MEASURE PUMPING RATE Bucket WATER LEVEL (distance from land surface) BEFORE PUMPING 52 ft. WHEN PUMPING 69 ft. TYPE OF PUMP USED (for test) S submersible

PUMP INSTALLED

DRILLER WILL INSTALL PUMP YES NO IF DRILLER INSTALLS PUMP, THIS SECTION MUST BE COMPLETED FOR ALL WELLS. TYPE OF PUMP INSTALLED PLACE (A,C,J,P,R,S,T,O) IN BOX 29. CAPACITY: GALLONS PER MINUTE (to nearest gallon) 31 35 PUMP HORSE POWER 37 41 PUMP COLUMN LENGTH (nearest ft.) 43 47 CASING HEIGHT (circle appropriate box and enter casing height) above below LAND SURFACE 2 (nearest foot)

LOCATION OF WELL ON LOT SHOW PERMANENT STRUCTURE SUCH AS BUILDING, SEPTIC TANKS, AND /OR LANDMARKS AND INDICATE NOT LESS THAN TWO DISTANCES (MEASUREMENTS TO WELL)

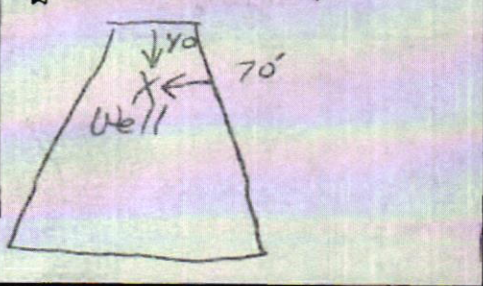



Bureau of Environmental Health
 8930 Stanford Blvd | Columbia, MD 21045
 410.313.2640 - Voice/Relay
 410.313.2648 - Fax
 1.866.313.6300 - Toll Free

Maura J. Rossman, M.D., Health Officer

Information Form for the Installation of the Well Pump, Pitless Adapter, and Supply Piping

NOTE: The installer is responsible for requesting an inspection prior to 9 am on the day of the desired inspection. No work is to be covered until approved by the Health Department. All installations must comply with the National Standard Plumbing Code (NSPC, as amended locally) and COMAR 26.04.04 (MD Well Construction Regulations). Submission of a complete form is required prior to Use and Occupancy approval.

Company Name: Burgin Inc Telephone #: 410-259-8924
 Address: 640 Kloss Hill Rd
Westminster MD 21157

Must circle one: Licensed Plumber Licensed Well Driller / Licensed Well Pump Installer
 License # and name of individual responsible for the field installation:

Name (Print): T.M. Burgin License# 64892

*A licensed individual must perform the actual installation. Apprentices must be under the supervision of a licensed journeyman or master plumber, pump installer or well driller. Licenses may be subjected to field verification. Unlicensed individuals may be reported to the appropriate licensing agency.

Name of Property Owner: John Sommerel Telephone #: 401-7581
 Subdivision: _____ Lot #: 7 Well Tag #: HO-94-1342
 Site Address: 14762 Betula Way
Dexon MD 21036

Submersible Pump Data

Make: DAB
 Model #: 3/4 hp
 Pump Capacity: 70 gpm
 Well Yield: 15 gal pum
 Depth of well encountered at time of pump installation: 180 (feet)

Pitless Adapter

Make: American Gandy
 Model#: PT800NL
 GPM Depth: 36 (36" min)
 GPM NSF/WSC approved:

Well Cap and Electric Conduit

Two piece watertight cap:
 Screened, vented well cap:
 Cap secured to casing:
 Conduit min 18" B.G.:
 Conduit secured to well cap:

If pump capacity exceeds well yield, a low water cut off switch is required by NSPC 1990 Section 17.8.4

Must circle one: Torque arrestors / Cable guards / Other acceptable method used
 Safety rope, if used, attached to brass rope adapter or other acceptable method inside of well casing

Piping to house

Type: 200 Silverline
 PSI: 200 (160 psi min)
 Depth of supply line: 36 (36" min)

House Connection

PVC sleeve to undisturbed soil at wall penetration:
 Length of sleeve (5" minimum from foundation):
 Sleeve sealed properly:

The water supply line is required to be at least ten feet from the septic tank, pump chamber, sewage piping, distribution box, drainfields, and sewage reserve area. If this cannot be accomplished, contact this office for approval prior to installation.

[Signature]
 Signature of company representative responsible for installation

6/24/2021
 date

For Health Department Use Only -- Not to be completed by Installer

Date Insp. Requested: _____ Date Insp. Approved: _____ Inspector: _____
 Inspection Data: Pitless adapter watertight & water supply line at least 36" below grade _____
 Two piece cap installed and attached to casing securely _____
 Elec. conduit extends at least 18" below grade/attached to cap properly _____
 Safety rope not outside of well cap/casing _____
 Correct well tag attached properly and casing 8" above finished grade _____
 Water supply line sleeved adequately at house connection _____
 Adequate grout observed below pitless adapter _____

(Revised form 10/24/2018)

**HOWARD COUNTY HEALTH DEPARTMENT
BUREAU OF ENVIRONMENTAL HEALTH
WELL & SEPTIC PROGRAM
TEL: (410)313-1771 FAX: (410)313-2648**

Information Form for the Installation of the Well Pump, Pitless Adapter, and Supply Piping

NOTE: The installer is responsible for requesting an inspection prior to 9 am on the day of the desired inspection. No work is to be covered until approved by the Health Department. All installations must comply with the National Standard Plumbing Code (NSPC, as amended locally) and COMAR 26.04.04 (MD Well Construction Regulations). Submission of a complete form is required prior to Use and Occupancy approval.

Company Name: _____ Telephone #: _____
Address: _____

(Must circle one) Licensed Plumber Licensed Well Driller Licensed Well Pump Installer
License # and name of individual responsible for the field installation:
Name (Print): _____ License# _____

*A licensed individual must perform the actual installation. Apprentices must be under the supervision of a licensed journeyman or master plumber, pump installer or well driller. Licenses may be subjected to field verification. Unlicensed individuals may be reported to the appropriate licensing agency.

Name of Property Owner: _____ Telephone #: _____
Subdivision: _____ Lot #: _____ Well Tag #: HO - 94-1342
Site Address: _____

<u>Submersible Pump Data</u>	<u>Pitless Adapter</u>	<u>Well Cap and Electric Conduit</u>
Make: _____	Make: _____	Two piece watertight cap: _____
Model #: _____	Model#: _____	Screened, vented well cap: _____
Pump Capacity _____ GPM	Depth: _____ (36" min)	Cap secured to casing: _____
Well Yield: _____ GPM	NSF/WSC approved: _____	Conduit min 18" B.G.: _____
Depth of well encountered at time of pump installation: _____ (feet)		Conduit secured to well cap: _____
If pump capacity exceeds well yield, a low water cut off switch is required by NSPC 1990 Section 17.8.4		
Torque arrestors, Cable guards, or other acceptable method used— Must circle one		
Safety rope, if used, attached to brass rope adapter or other acceptable method <u>inside of well casing</u> _____		

<u>Piping to house</u>	<u>House Connection</u>
Type: _____	PVC sleeve to undisturbed soil at wall penetration: _____
PSI: _____ (160 psi min)	Length of sleeve (5' minimum from foundation): _____
Depth of supply line: _____ (36" min)	Sleeve sealed properly: _____

The water supply line is required to be at least ten feet from the septic tank, pump chamber, sewage piping, distribution box, drainfields, and sewage reserve area. If this cannot be accomplished, contact this office for approval prior to installation.

Signature of company representative responsible for installation _____ date _____

For Health Department Use Only – Not to be completed by Installer

Date Insp. Requested: 06/25/2021 Date Insp. Approved: 6/29/21 Inspector: (ST)
 Inspection Data: Pitless adapter watertight & water supply line at least 36" below grade 48" 06/25/2021 (ST)
 Two piece cap installed and attached to casing securely
 Elec. conduit extends at least 18" below grade/attached to cap properly 42" 6/29/21 (ST)
 Safety rope not outside of well cap/casing
 Correct well tag attached properly and casing 8" above finished grade 19" 06/25/2021 (ST)
 Water supply line sleeved adequately at house connection
 Adequate grout observed below pitless adapter

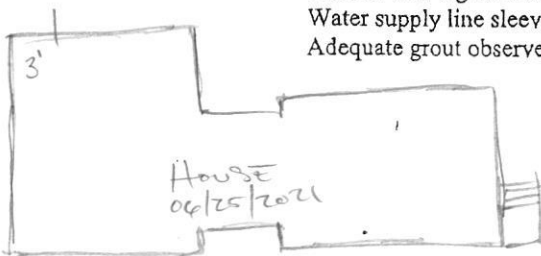

06/25/2021 CONDUIT FAILED. NOT SECURE TO CAP. (ST)

6/29/21

Sharkonda has
WLI form



Bureau of Environmental Health
8930 Stanford Blvd | Columbia, MD 21045
410.313.2640 - Voice/Relay
410.313.2648 - Fax
1.866.313.6300 - Toll Free

Maura J. Rossman, M.D., Health Officer

INTERIM CERTIFICATE OF POTABILITY
Expiration Date – MAY 18, 2022

November 18, 2021

Homeowner
14762 Betula Way
Dayton, MD 21036

RE: Kalmia Farms, Sec 2, Lot 7
14762 Betula Way
Building Permit: B20003596
Well Permit: HO-94-1342

Dear Homeowner:

This is to advise you that the septic system installation and water well construction for the above referenced property have been inspected and approved. Final approval of the septic system was granted on **5/25/2021**. Final approval of the well line connection to the dwelling was granted on **6/29/2021**. The well construction was completed on **12/17/1997**. Water samples were collected on **11/3/2021**.

The water sample results indicate that the water samples submitted for testing were free of coliform and fecal coliform bacteria at the time of sampling and are bacteriologically safe for drinking. This certifies that the initial sampling requirements of COMAR 26.04.04 "Well Regulations" have been met for the water supply system installed under well permit HO-94-1342. Although the submitted sample results are in compliance with COMAR standards, the Health Department does not guarantee water supplies.

This Interim Certificate of Potability will expire **six months** from the date of issuance. Submission of a second bacteriological test indicating the water is free of coliform and fecal coliform bacteria is required prior to the expiration date, after which time a Final Certificate of Potability will be issued. **Failure to submit an additional sample and obtain a Final Certificate of Potability will result in a Notice of Violation and is punishable as a misdemeanor under the Annotated Code of Maryland, Environment Article, 9-1311, subject to a fine of up to \$500 or imprisonment not to exceed three months.**

Please contact (410) 313-1773 to schedule a final water sample appointment or contact a Maryland certified water laboratory to schedule a water sample. A list of laboratories certified by the state of Maryland may be found at the following website:
<http://www.mde.state.md.us/assets/document/WSP-Labs-2010apr16.pdf>



Bureau of Environmental Health
8930 Stanford Blvd | Columbia, MD 21045
410.313.2640 - Voice/Relay
410.313.2648 - Fax
1.866.313.6300 - Toll Free

Maura J. Rossman, M.D., Health Officer

In closing, please refer to our "[Homeowner Fact Sheet](#)" which illustrates a better understanding for your Onsite Sewage Disposal System. You will also find a link to Maryland Department of the Environment's website which describes in further detail operation and maintenance of your septic system.

Approving Authority,

A handwritten signature in black ink, appearing to read 'Kevin M. Wolf', written in a cursive style.

Kevin M. Wolf, LEHS, R.S./REHS, Supervisor
Groundwater Management Section
Well & Septic Program

cc: Howard County Dept. of Inspections, Licenses, and Permits
Community Hygiene Program
File

FOUNTAIN VALLEY ANALYTICAL LABORATORY, INC.

1413 Old Taneytown Rd. Westminster, MD (410) 848-1014 (410) 876-4554

REPORT OF ANALYSIS

Laboratory ID #: 148539 Account #: 7085
Reference: Laswell Client: Cumberland Dev. Custom Homes
Location: 14762 Betula Way Requested By: Curtis L. Cumberland
Dayton, MD 21036 Source: Well Water
Date/ Time Collected: 11/3/2021 1220 Site: Pressure Tank
Date/Time Rec'd: 11/3/2021 1520 Treatment: None
Chlorine ppm: Free: ND Total: ND pH: 5.8
Collected By: J. Yeager 0819JY Well #: HO-94-1342

PARAMETERS	RESULTS	UNITS	REFERENCE	METHOD	DATE/TIME/ANALYST
Bacteria, Coliform, Total, MPN	<1.0	MPN/ 100 ml	<1.0	SM20 9223B	11/4/2021 / 1030 / TSD
Bacteria, E. coli, MPN	<1.0	MPN/ 100 ml	<1.0	SM20 9223B	11/4/2021 / 1030 / TSD
Nitrate	0.47	mg/L	10	601	11/4/2021 / 0930 / CRS
Turbidity	0.40	NTU	<10	SM20 2130B	11/4/2021 / 0845 / TSD
Sand	ND	mg/L	5	Visual/Gravimetric	11/3/2021 / 1630 / TSD

NOTES:

- 1 mg/L = milligrams per liter (also, parts per million)
- 2 MPN/ 100 ml = Most Probable Number [of viable bacteria] per 100 ml of sample.
- 3 NTU = Nephelometric Turbidity Units
- 4 Results less than or within the reference range are considered satisfactory and within potable water limits at the time of sampling.
- 5 ND:None Detected
- 6 Visual well check: Sealed, vented cap
- 7 pH & Chlorine level tested on site

Reason for Test : Use & Occupancy

Building Permit # : BP20003596

Date Reported: 11/4/2021