

**FINISHED LOWER LEVEL PLAN
WITH 3RD CAR GARAGE**

SCALE (1/4"=1'-0") 1/8" = 1'-0"
SCALE (3/16"=1'-0") 1/16" = 1'-0"

© David H. Robbins expressly reserves his copyright and other property rights in these plans and drawings. These plans and drawings are not to be reproduced in any form or manner without written consent.

Architecture Collaborative, Inc.
 8334 Main Street
 Ellicott City, MD 21043
 www.archcool.com
 Tel.: (410) 405-7500 Fax: (410) 485-0903

DATE: 5/5/16
 DRAWN: [Signature]
 CHECKED: [Signature]
TIMBERLAKE HOMES
 HAWTHORNE
 U.S.A.

NO.	DATE	REVISION

4.2D
 SHEET 4
 PROFESSIONAL CERTIFICATION
 I hereby certify that these documents were prepared by me or under my direct supervision and that I am a duly licensed professional architect in the State of Maryland.
 License number: 000000
 expiration date: 04-02-2020



Architecture Collaborative, Inc. 10/12/2020 2:40 PM

PWS AWCN 2:10/12/2020 2:49:43 PM ARCHITECTURE COLLABORATIVE, INC.

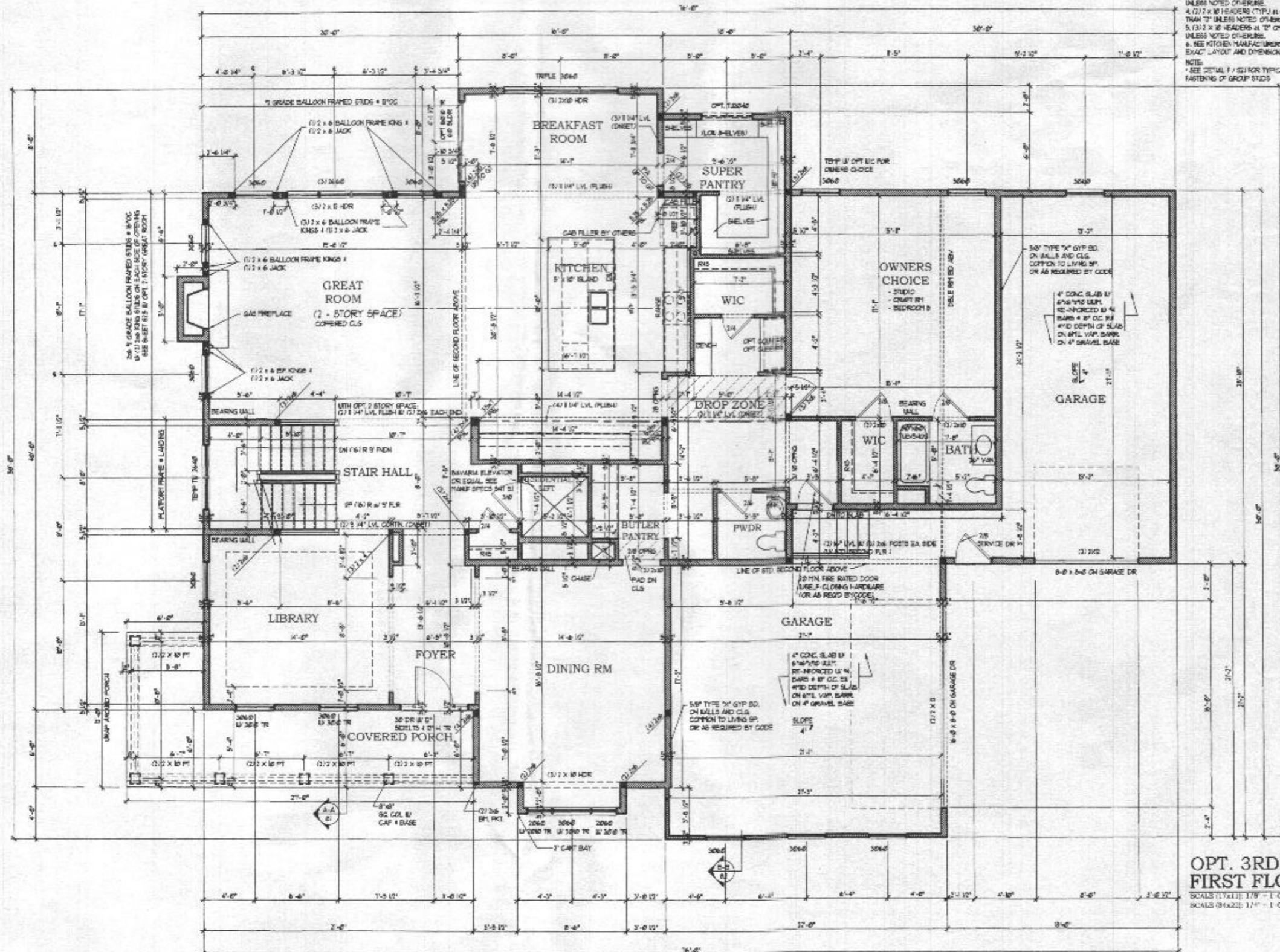

- NOTES**
1. ALL EXTERIOR WALLS ARE TO BE 2x4 STUDS FRAMED 4" OC, UNLESS NOTED OTHERWISE.
 2. ALL INTERIOR WALLS ARE TO BE 2x4 STUDS FRAMED 8" OC, UNLESS NOTED OTHERWISE.
 3. SOLID BLOCK ALL DEEPS 4" HEADERS (GREATER THAN 4" IS 12" JACK STUDS UNLESS NOTED OTHERWISE).
 4. 12" x 8" HEADERS (TYPICAL) OPENINGS LESS THAN 12" UNLESS NOTED OTHERWISE.
 5. 12" x 8" HEADERS AT 12" OPENINGS UNLESS NOTED OTHERWISE.
 6. SEE KITCHEN MANUFACTURERS' PLANS FOR EXACT LAYOUT AND DIMENSIONS.
- NOTE**
- * SEE DETAIL F-10 FOR TYPICAL FASTENING OF GROUP STUDS.

**OPT. 3RD CAR GARAGE
FIRST FLOOR PLAN**

SCALE (1/4" = 1'-0")
SCALE (3/16" = 1'-0")

Architecture Collaborative, Inc.
8334 Main Street
Baltimore City, MD 21043
www.archcollab.com
Tel.: (410) 485-7500 Fax: (410) 485-0800

content: **FIRST FLOOR PLAN - OPT. 3RD CAR GARAGE**
drawing: 1-1-2-8 (34422) (10)
U.S.D. 1-1-2-8 (17217) (10)
date: 6/6/15
TIMBERLAKE HOMES
HAWTHORNS

date	revision	by

SHEET 4
5.1D

Professional seal:
I hereby certify that these documents were prepared or supervised by me, and that I am a duly licensed professional architect in the State of Maryland.
license number: 06-05-3668
expiration date: 06-05-2025



