

PERMIT NUMBER: B

21000098

DATE ACCEPTED:

Cancelled - H.O.



RESIDENTIAL BUILDING PERMIT APPLICATION

HOWARD COUNTY DEPARTMENT OF INSPECTIONS, LICENSES, AND PERMITS
3430 COURT HOUSE DRIVE, ELLICOTT CITY, MD 21043 - PHONE: (410) 313-2455 OPTION #4
www.howardcountymd.gov

BUILDING SITE ADDRESS REQUIRED

Street Address: 3855 Route 97
City: Glenwood
State: MD
Zip Code: 21738
Subdivision/Village/Complex Name: Duval's Range
SDP/WP/BA #:
Lot: 3
Tax Map:
Parcel:
Grading Permit #:

DESCRIPTION OF WORK REQUIRED

Existing Use:
Proposed Use:
Estimated Cost: \$ 200
Trade Work to Be Completed (Separate Permits Required):
Addition of Washroom's utility sink: high over sink + electric power.
Electric Power to Car Port (new too)

PROPERTY OWNER INFORMATION REQUIRED

Owner(s) Name(s) (As it appears on tax records): Youn Myles
Primary Residence: Yes
Owner's Street Address: 3855 Route 97
City: Glenwood
State: MD
Zip Code: 21738
Phone: 240-643-0797
Email: Youn Myles@gmail.com

APPLICANT NAME REQUIRED - INDIVIDUAL WHO SIGNS THIS APPLICATION

Business Name:
Contact Name: Youn Myles
Street Address: 3855 Route 97
City: Glenwood
State: MD
Zip Code: 21738
Phone: 240-643-0797
Email: Youn Myles@a mail.com

CONTRACTOR INFORMATION REQUIRED

Business Name:
Licensee's Name:
License #:
Street Address:
City:
State:
Phone:
Email:
RECEIVED DEC 24 2020
LICENSES & PERMITS DIVISION

ARCHITECT/ENGINEER INFORMATION INDIVIDUAL WHO SIGNED PLANS, IF APPLICABLE

Business Name:
Name:
Street Address:
City:
State:
Zip Code:
Phone:
Email:

BUILDING CHARACTERISTICS REQUIRED

Primary Structure: SF Dwelling
Utilities: Electric
Water Supply: Private (Well)
Sewage Disposal: Private (Septic)
Heating System: Electric
Roadside Tree Project: No
Sprinkler System: NFPA 13
Fire Alarm System: Yes

ADDITIONAL RESIDENTIAL INFORMATION (PLEASE SELECT/COMPLETE ALL THAT APPLY)

Model Name & Options:
of Bedrooms (SF): 2
of efficiency units (MF*): 1
of 1 BR (MF*):
of 2 BR (MF*):
of 3 BR (MF*):
Rooms: 2
Full Baths: 2
Half Baths:
Fireplaces:
Garage/Carport Info: Detached Garage
Basement/Foundation Info: Post & Pier
1st Fl Width:
1st Fl Depth:
2nd Fl Width:
2nd Fl Depth:
Bsmt Width: 36
Bsmt Depth: 24
Energy Method: Prescriptive
Gross Area: 1730 sq ft
Occupiable Area: ~ sq ft

AGREEMENT/ DISCALIMER REQUIRED

THE UNDERSIGNED HEREBY CERTIFIES AND AGREES AS FOLLOWS: (1) THAT HE/SHE IS AUTHORIZED TO MAKE THIS APPLICATION; (2) THAT THE INFORMATION IS CORRECT; (3) THAT HE/SHE WILL COMPLY WITH ALL REGULATIONS OF HOWARD COUNTY WHICH ARE APPLICABLE THERETO; (4) THAT HE/SHE WILL PERFORM NO WORK ON THE ABOVE REFERENCED PROPERTY NOT SPECIFICALLY DESCRIBED IN THIS APPLICATION; (5) THAT HE/SHE GRANTS COUNTY OFFICIALS THE RIGHT TO ENTER ONTO THIS PROPERTY FOR THE PURPOSE OF INSPECTING THE WORK PERMITTED AND POSTING NOTICES.

APPLICANT'S ORIGINAL SIGNATURE: [Signature]
DATE SIGNED: Dec 21, 2020

FOR OFFICE USE ONLY

CHECKS PAYABLE TO: DIRECTOR OF FINANCE OF HOWARD COUNTY

AGENCIES REQUIRED/APPROVALS:
PR
DPZ
DED
Health
SHA
CID
SUBMITTAL FEES:
PAYMENT: CR # 4048 \$50
ACCEPTED BY: [Signature]

Youn Myles 3855 Route 27 Glenwood MD 21738

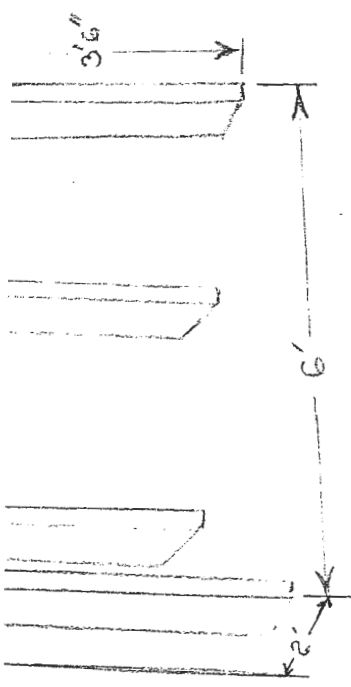
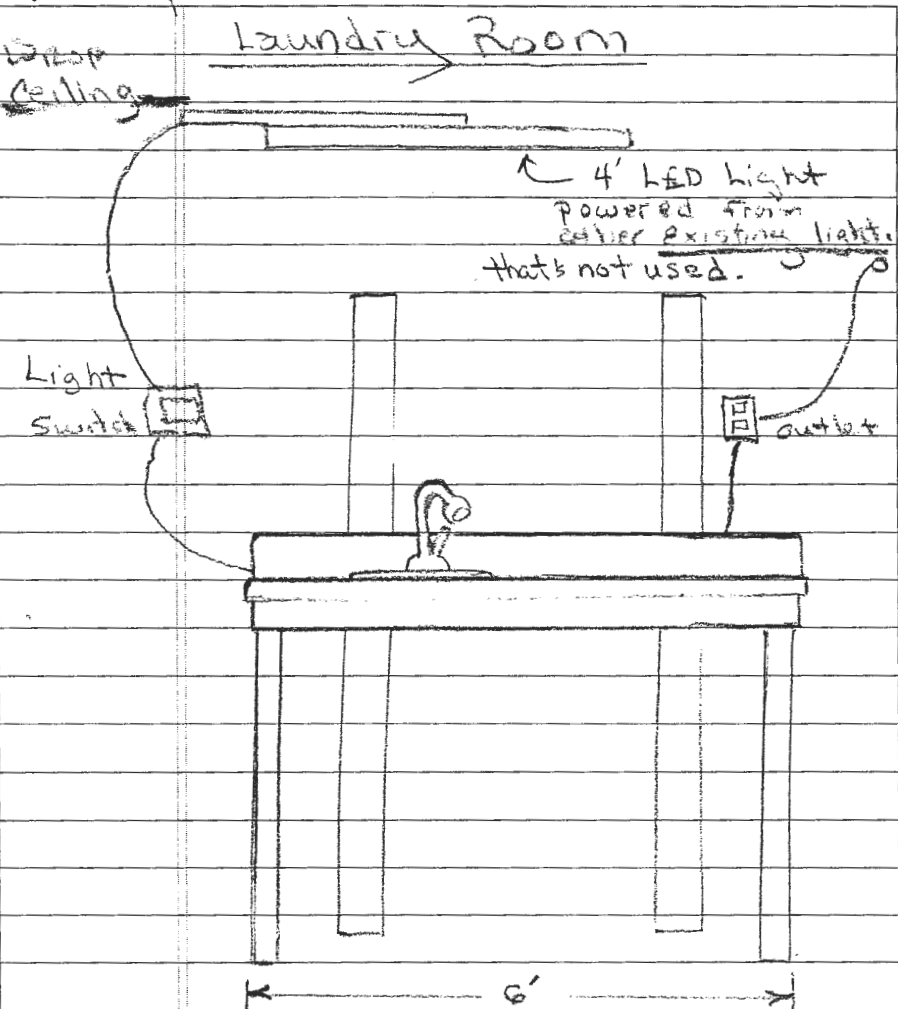

UTILITY SINK (Addition)

Youn Myles
3855 Route 27
Glenwood MD
21738

(Stainless Steel) clothes
 Utility Sink & Folding Table
 Sink
 Water lines from washing machine lines
 Sink drains into washing machine drains.

2x4 PT
Angle Supports
and
OVER HEAD
LED LIGHT

Set of
2x6 FT
Back boards
(Not shown)

Light
Switch

BACK BOARD
(Not shown)
outlet

Existing
Washing
Machine
&
Dryer
(stacked)

Youn Myles
3855 Route 94
Glenwood NJ
2438

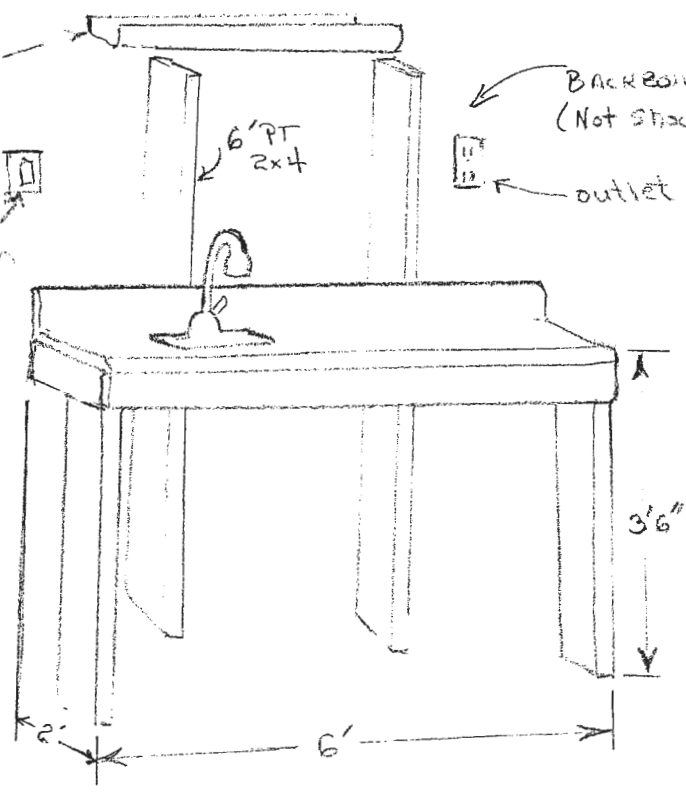

UTILITY SINK (Addition)