

729 Driver Rd
 Piney Run Overlook
 Lot 3

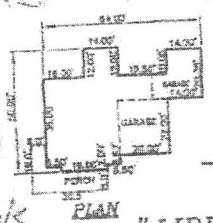

Approved Septic System Plan
 Howard County Health Department

Dana Bernard 7/17/20
 Signature Date

PLOT PLAN (SITE SPECIFIC)
 PINEY RUN OVERLOOK
 LOT 3

M. M. BOENDER & ASSOC., INC.
 ENGINEERS, PLANNERS, ARCHITECTS
 7950 B Grace Drive, Columbia, MD 21046
 (410) 992-0200 Fax (410) 997-0292 Fax

PL 200419-010\DWG\PL01.PLAN LOT 3

THIRD ELECTION DISTRICT HOWARD COUNTY, MARYLAND
 SCALE: 1"=60' DRAWN BY: MVM DATE: SEP 2019 PH:19-010

SHEET 1 OF 1

On-line

TRINITY INDUSTRIES, INC.

Underground Vesse

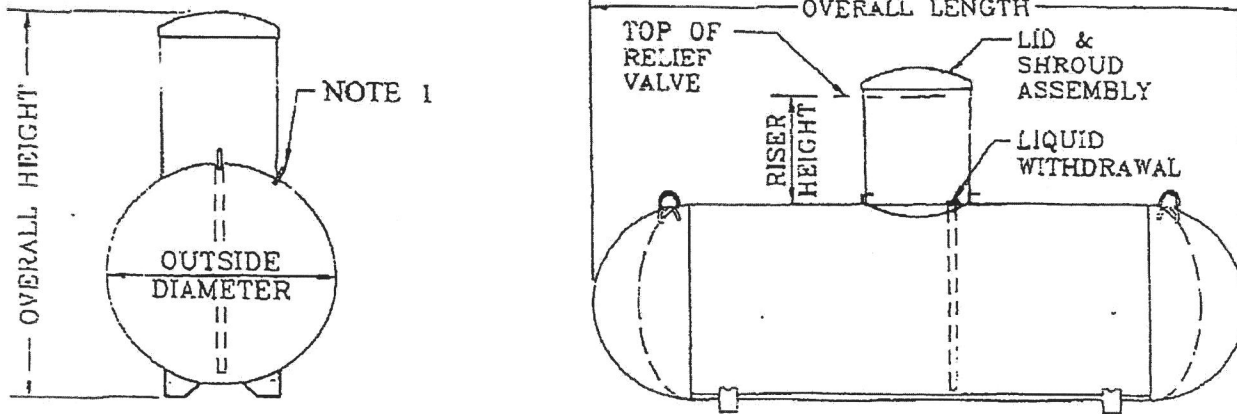

General Specifications

Conforms to the latest edition and addenda of the ASME, Section VIII, div.1 code for Pressure Vessels. Complies with NFPA 58 and is listed by Underwriters Laboratories, Inc.

Rated at 250 psig from -20°F. to 125°F. All tanks may be evacuated to a full (14.7 psi) vacuum.

Vessel Finish: Coated with epoxy red powder.

Applicable federal, state or local regulations may contain specific requirements for protective coatings and cathodic protection. The purchaser and installer are responsible for compliance with such federal, state or local regulations.

All vessel dimensions are approximate

WATER CAPACITY	OUTSIDE DIAMETER	HEAD TYPE	OVERALL LENGTH	OVERALL HEIGHT		WEIGHT	QUANTITY IN FULL LOAD
				14" Riser Height	28" Riser Height		
120 wg 454.2 L	24" 609.6 mm	Ellip	5' - 5 7/8" 1671.6 mm	3' - 9 7/8" 1165.2 mm	4' - 8 3/8" 1431.9 mm	252 lbs. 114.3 kg	63
250 wg 946.3 L	31.5" 800.1 mm	Hemi	7' - 2 1/2" 2197.1 mm	4' - 5 3/8" 1355.7 mm	5' - 3 3/8" 1609.7 mm	472 lbs. 214.1 kg	42
320 wg 1211.2 L	31.5" 800.1 mm	Hemi	8' - 11 3/4" 2736.9 mm	4' - 5 3/8" 1355.7 mm	5' - 3 3/8" 1609.7 mm	588 lbs. 266.7 kg	35
500 wg 1892.5 L	37.42" 950.5 mm	Hemi	9' - 10" 2997.2 mm	4' - 11 3/8" 1506.6 mm	5' - 9 7/8" 1773.2 mm	921 lbs. 417.8 kg	25
1000 wg 3785.0 L	40.96" 1040.4 mm	Hemi	15' - 10 7/8" 4846.6 mm	5' - 2 7/8" 1597.0 mm	6' - 1 3/8" 1863.7 mm	1731 lbs. 785.2 kg	15
2000 wg 3785.6 L	46.614" 1183.9 mm	Ellip	23' - 9 3/8" 7248.5 mm	5' - 8 13/16" 1747.8 mm	6' - 7 5/16" 2014.5 mm	3685 lbs. 1671.4 kg	8

Menu Refine Search GIS Help Data Filter: Filter TMP's My Filters

⏪ < 1 > ⏩

<input type="checkbox"/>	<u>Permit #</u>	<u>Status</u>	<u>Record Type Alias</u>	<u>Street #</u>	<u>Street Name</u>	<u>Type</u>	<u>Unit Type</u>	<u>Unit #</u>	<u>City</u>
<input type="checkbox"/>	B20002195	Review In Process	Residential Tank Permit	739	DRIVER	RD			MARRIC

⏪ < 1 > ⏩