

RECEIVED

JUL 13 2021

LICENSES & PERMITS
DIVISION

HEALTH
FROM: STEPHEN J. JOHNSON
8515 BLOUNTS LANE
FULTON, MO. 20759
301-366-4616. SJOHNSON8515@gmail.com

DATE: 7/12/21

Approved
RAC 9/13/2021

SUB: PLAN submission, addendum.

To whom it may concern,

Approximately, 10 days ago, a person from either inspection or enforcement called me regarding permit # B20002730, and the reconstruction of my front porch. I have included plans for my front porch and plans reflect the construction of a roof over my retaining wall project.

I did not secure a permit for the replacement of my front porch, and will fill out necessary forms if needed. If you can identify person who requested this information and

please ask him to contact me
@ 301-366-4666. Thank you in
advance for all your help.

Regards,
Stem

STEPHEN J. JOHNSON

8515 BLOUNTS LAWE

FULTON MD 20759 301-366-4616

SJohnson8515@gmail.com.

PLAN SUBMISSION / ADDENDUM.

- ① REPLACING FRONT PORCH.
- ② INSTALLING ROOF OVER RETAINING WALL
PERMIT # B20002730.

WILSON J. JOHNSON
 8515 BLOUNT'S LANE
 FULTON, MD. 20759
 301-366-4616

7/08/21

FRONT PORCH REPLACEMENT

(2)

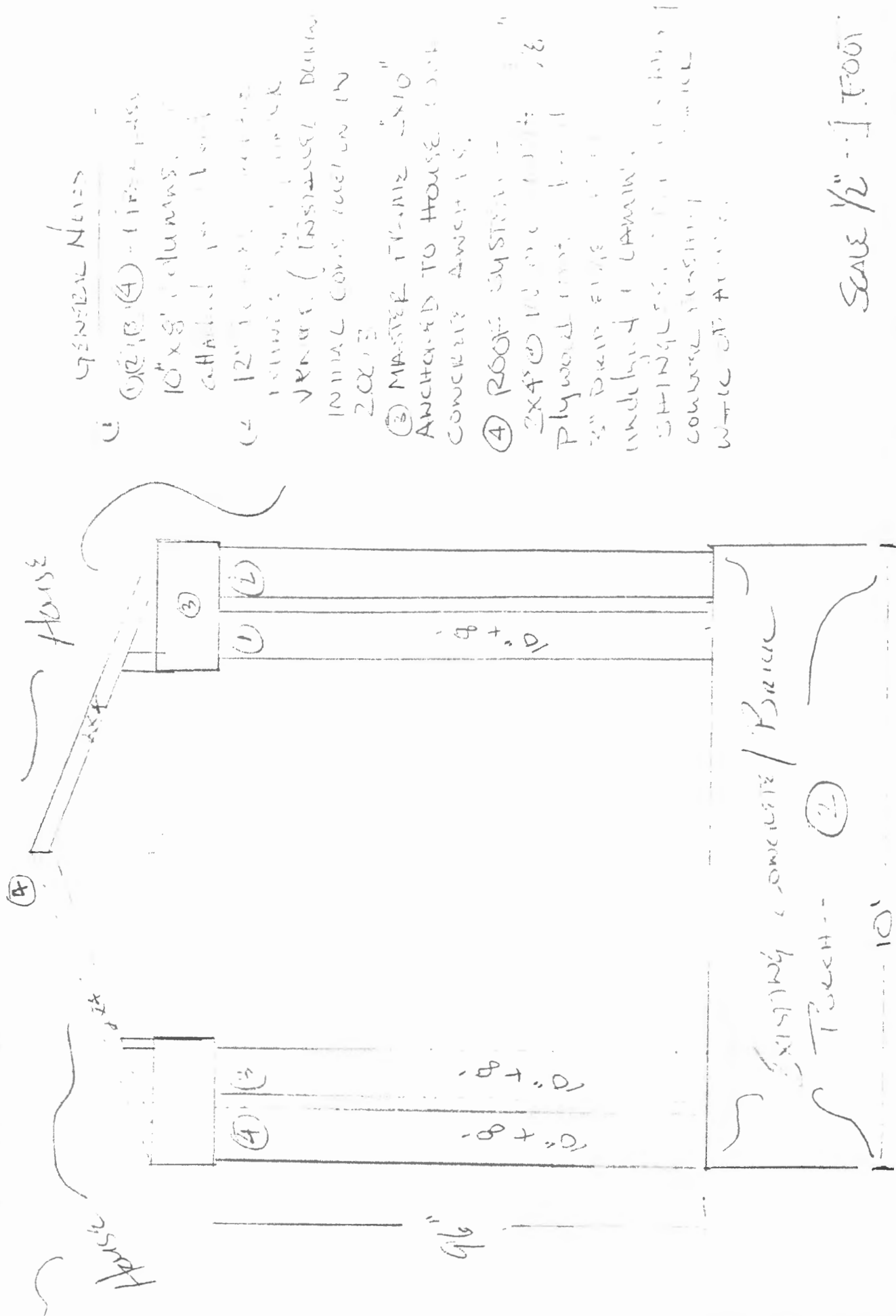

GENERAL NOTES

- (1) (2) (3) (4) - 10" x 8" columns attached to foundation beams (12" x 12" concrete beams) - INITIAL CONSTRUCTION IN 20013
- (3) MASTER TRIMIZ 2x10" ANCHORED TO HOUSE WITH CONCRETE ANCHORS
- (4) ROOF SYSTEM - 2x4" JOISTS @ 16" O.C. Plywood roof deck 3/4" BRICK EDGE FINISH UNDERLAY LAMIN. SHINGLES. 2x6" RAFTERS. CONCRETE FLOORING UNDER SIDE WALK OFF AREA.

SCALE 1/2" = 1' FOOT

STEPHEN J. JOHNSON
 8515 BLOUNTS LAWE
 FURCION MO 20759
 301-306-4616

07/08/21

(3)

FRONT PORCH REPLACEMENT

SIDE VIEW

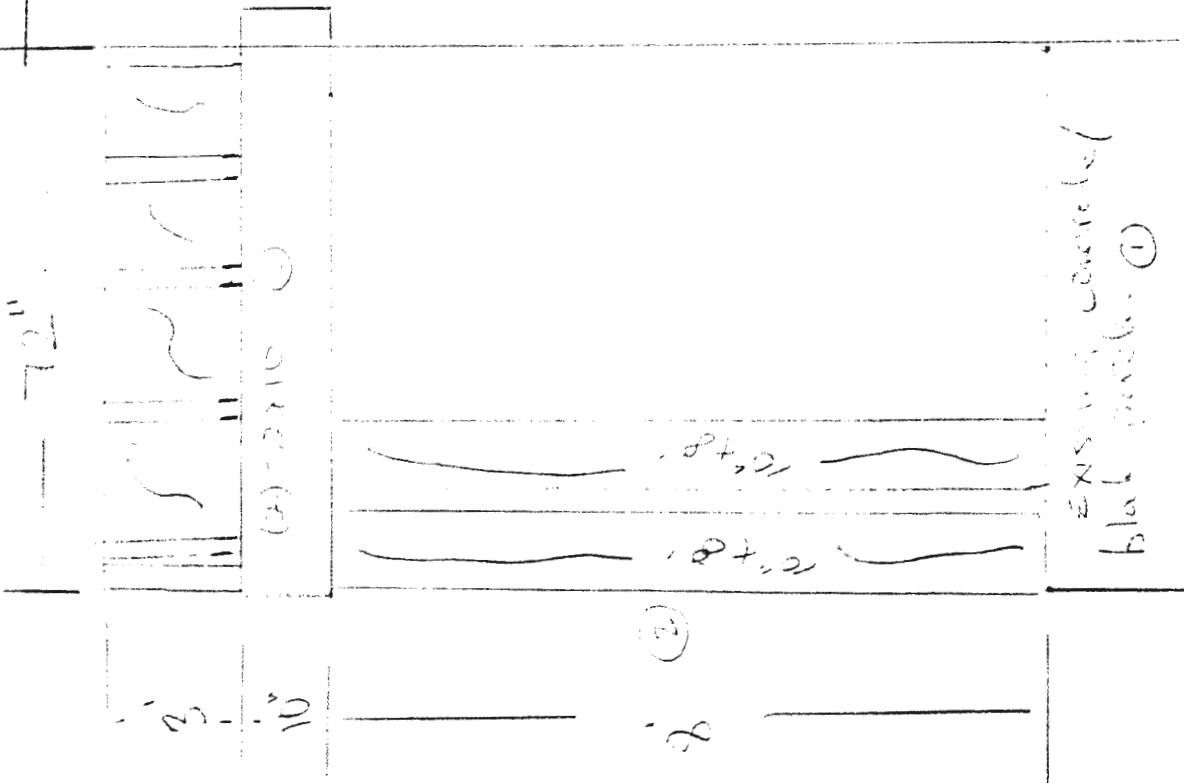

- General Note:
- ① EXISTING CONCRETE (FROM FOUNDATION)
 - ② 10" X 8" FINISH JOIST
 - ③ (2) - 2X10 MAIN MEMBERS
 - ④ 2X4 BRACKETS @ 16" O.C. w/ 5/8" BOLTS @ 16" O.C.

Scale 1/2" = 1 Foot

POLY-CLASSIC COLUMNS ALLOWABLE LOADS

Column Type and Nominal Size (in)	Maximum Length (ft-in)	Concentric Loadings		Eccentric Loadings	
		Allowable Load (lbs.)	Ultimate Failure (lbs.)	Maximum "e" (in)	Allowable Load (lbs.)
6 - Round	8-0	6000	28600	0-3/4	6000
8 - Round	10-0	10000	30310	1-5/8	6600
10 - Round	12-0	14000	35450	2-5/8	10720
12 - Round	16-0	18000	58750	3-3/8	13200
14 - Round	16-0	20000	61950	4	11520
16 - Round	20-0	20000	64300	4-1/4	13200
18 - Round	24-0	20000	62850	4-1/4	9040
20 - Round	20-0	20000	65150	4-1/4	18960
24 -Round	20-0	20000	62980	4-1/4	13200
8 - Round Non-Taper	10-0	10000	29150	2-1/8	8240
10 - Round Non-Taper	10-0	14000	38750	3	11520
12 - Round Non-taper	12-0	18000	61350	4-1/8	11520
14 - Round Non-Taper	14-0	20000	60200	5	18120
6x6 Square	10-0	6000	29370	1-1/4	6000
8x8 Square	10-0	10000	29380	2-1/4	10000
10x10 Square	10-0	12800	32260	3-1/4	12800
12x12 Square	16-0	18000	59900	4-1/4	17320

Notes:

1. Round columns include plain and fluted.
2. Maximum "e" (in) is eccentricity measured from the centerline of the top of the column. The eccentric load simulated a nominal 4-inch wide wood beam (3-½ inch actual width) bearing at the top end. The base end was installed against a flat steel surface to create concentric loading.

Eccentricity Chart

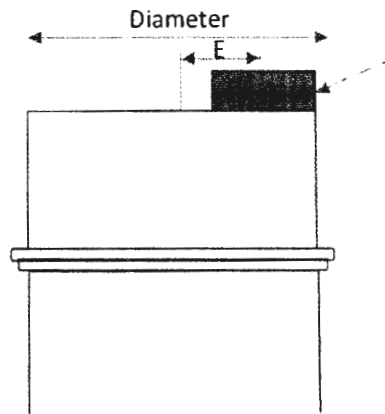

3-1/2" Steel Plate

Columns up to 14" tested with edge of 3-1/2" plate aligned with edge of column top

Columns over 14" tested with maximum eccentricity of 4.25"

Round Columns

Description	Diameter	(E) Eccentricity
6"	5	0.75
8"	6.75	1.625
10"	8.75	2.625
12"	10.25	3.375
14"	11.56	4.031
16"	13.13	4.250
18"	14.31	4.250
20"	16.31	4.250
24"	19.31	4.250

Round Non-Tapered Columns

Description	Diameter	(E) Eccentricity
8"	7.63	2.063
10"	9.69	3.094
12"	11.63	4.063
14"	13.50	5.000

Square Columns

Description	Diameter	(E) Eccentricity
6"	5.625	1.063
8"	7.625	2.063
10"	9.625	3.063
12"	11.75	4.125

DIEHLEN JOHNSON
8515 BLOENTS LANE
FURTON, MD 20759
301-366-4616
sjohnson8515@gmail.com

APPENDUM TO PERMIT
B20002730

(1)

FLOOR OVER RETAINING WALL

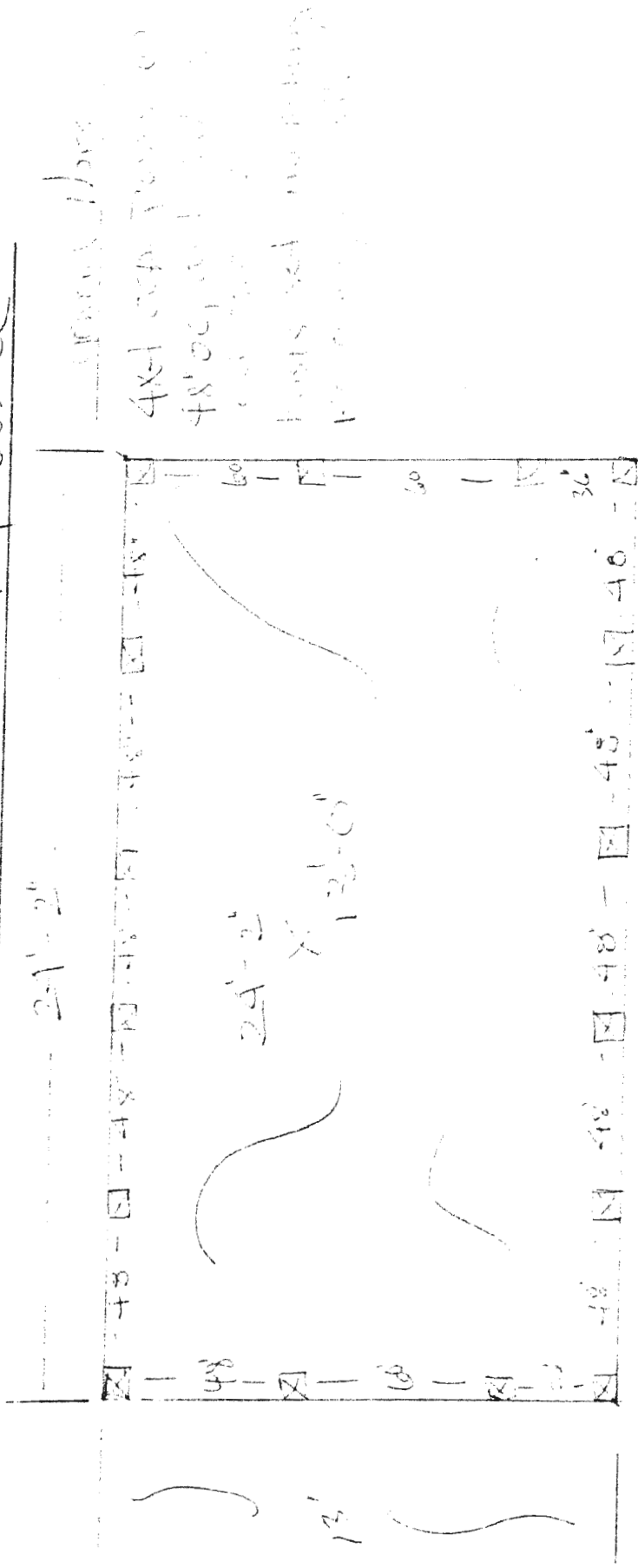

Scale 1/4" = 1 Foot

STEPHEN J. JOHNSON
 8515 BLOUNT'S LAKE
 FULTON, MO 20753
 301-366-4616 07/08/21

HDBEDUM TO PERMIT # B20002730

(2)

ROOF OVER RETAINING WALL

2x8 @ 16" o.c.

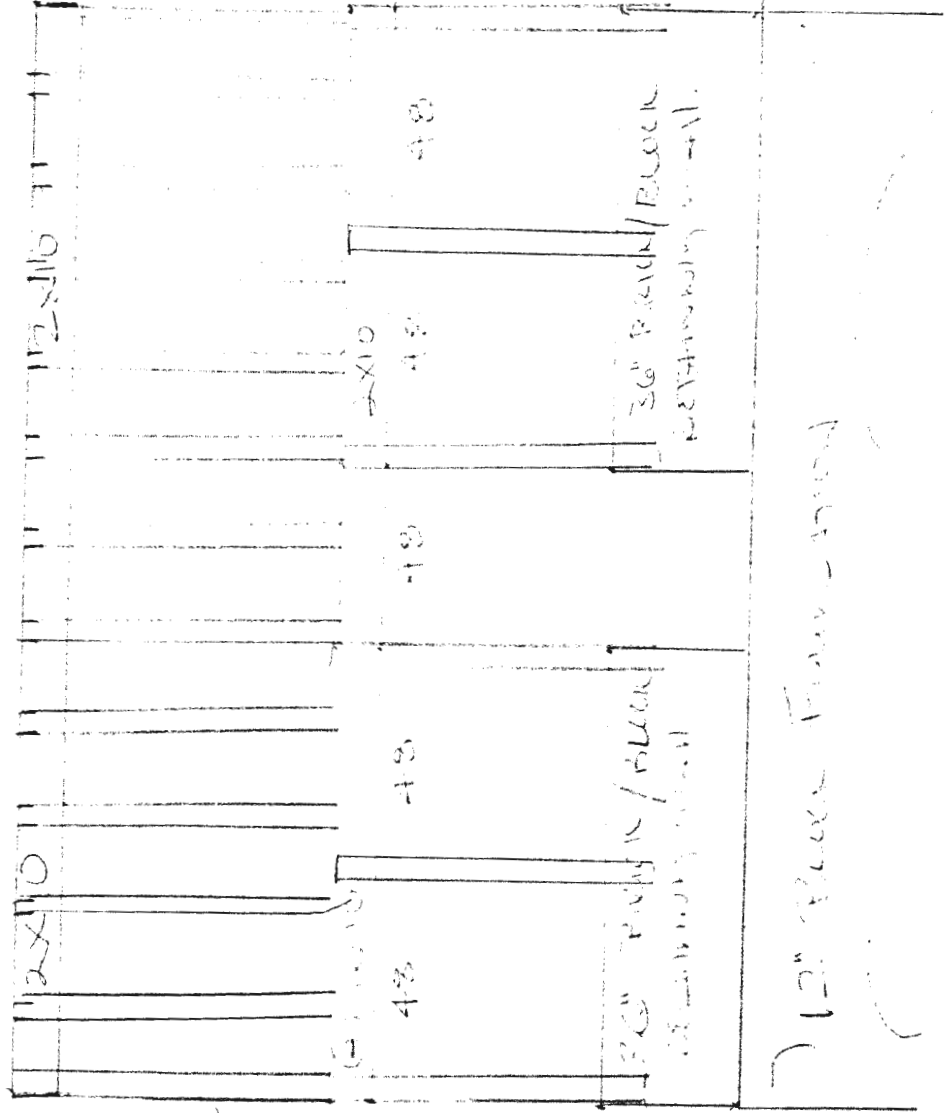

General Notes

- ① 4x4 o.c. spacing of columns, 54" o.c.
- ② 4- 2x8 HEAVY JOIST SYSTEM
- ③ 2x8 HEAVY JOIST @ 24" o.c.
- ④ 3x3 plywood over 3/8" metal deck
- ⑤ 3" deep, 1/2" thick perimeter joist
- ⑥ Laminated 1/2" thick glass sheathing
- ⑦ 2x6 collar ties 24" o.c. @ bottom 1/3 of rafter.

12" Block Retaining Wall