



APPLICATION

FOR PERCOLATION TESTING AND SITE EVALUATION

TEST DATE(S) _____ TEST TIME _____

AP 535241
DATE 06/08/2011

AGENCY REVIEW: _____

DO NOT WRITE ABOVE THIS LINE

I HEREBY APPLY FOR THE NECESSARY TESTING/EVALUATION PRIOR TO ISSUANCE OF SEWAGE DISPOSAL SYSTEM PERMIT(S) TO:

CHECK AS NEEDED:

- CONSTRUCT NEW SEPTIC SYSTEM(S)
- REPAIR/ADD TO AN EXISTING SEPTIC SYSTEM
- REPLACE AN EXISTING SEPTIC SYSTEM

CHECK AS NEEDED:

- NEW STRUCTURE(S)
- ADDITION TO AN EXISTING STRUCTURE
- REPLACE AN EXISTING STRUCTURE

CHECK ONE:

- CREATE NEW LOT(S)
- BUILD ON AN EXISTING LOT IN A SUBDIVISION
- BUILD ON AN EXISTING PARCEL OF RECORD

IS THE PROPERTY WITHIN 2500' OF ANY RESERVOIR?

- YES
- NO

THE TYPE OF STRUCTURE IS:

- RESIDENTIAL WITH 3 PROPOSED BEDROOMS IN THE COMPLETED STRUCTURE (NOTE **UNKNOWN** IF APPROPRIATE)
- COMMERCIAL (PROVIDE DETAIL OF NUMBERS AND TYPES OF EMPLOYEES/ CUSTOMERS ON ACCOMPANYING PLAN)
- INSTITUTIONAL/GOVERNMENT (PROVIDE DETAIL OF NUMBERS AND TYPES OF EMPLOYEES/USERS ON ACCOMPANYING PLAN)

PROPERTY OWNER(S) St. James Church / Robert Grim

DAYTIME PHONE 410-489-7455 CELL _____ FAX _____

MAILING ADDRESS 12450 Old Frederick Rd. Marriottsville MD
STREET CITY/TOWN STATE ZIP

APPLICANT Ronnie Heaps / J.M. Contracting LLC

DAYTIME PHONE 413-277-7526 CELL Same FAX 410 552-5815

MAILING ADDRESS 425 Obrecht Rd Sykesville MD 21784
STREET CITY/TOWN STATE ZIP

APPLICANT'S ROLE: DEVELOPER BUILDER BUYER RELATIVE/FRIEND REALTOR CONSULTANT

PROPERTY LOCATION
SUBDIVISION/PROPERTY NAME 12450 Old Frederick Rd LOT NO. _____

PROPERTY ADDRESS House Next to Church Marriottsville MD
STREET TOWN/POST OFFICE

TAX MAP PAGE(S) _____ GRID _____ PARCEL(S) _____ PROPOSED LOT SIZE _____

AS APPLICANT, I UNDERSTAND THE FOLLOWING: THE SYSTEM INSTALLED SUBSEQUENT TO THIS APPLICATION IS ACCEPTABLE ONLY UNTIL PUBLIC SEWERAGE IS AVAILABLE. THIS APPLICATION IS COMPLETE WHEN ALL APPLICABLE FEES AND A SUITABLE SITE PLAN HAVE BEEN RECEIVED. I ACCEPT THE RESPONSIBILITY FOR COMPLIANCE WITH ALL M.O.S.H.A. AND "MISS UTILITY" REQUIREMENTS. APPROVAL IS BASED UPON SATISFACTORY REVIEW OF A PERC CERTIFICATION PLAN.

TEST RESULTS WILL BE MAILED TO APPLICANT. [Signature]
SIGNATURE OF APPLICANT

HOWARD COUNTY HEALTH DEPARTMENT, BUREAU OF ENVIRONMENTAL HEALTH, WELL AND SEPTIC PROGRAM
7178 COLUMBIA GATEWAY DRIVE COLUMBIA, MARYLAND 21046 (410) 313-2640 FAX (410) 313-2648
TDD (410) 313-2323 TOLL FREE 1-877-4MD-DHMH

A/P _____

DATE	TEST #	DEPTH	START	BREAK 1" DROP	STOP 2" DROP	TIME OF 2ND INCH	P/F/H

REMARKS _____

SANITARIAN _____ BACKHOE _____ OTHERS _____

TEST HOLES USED IN SDA _____ AVG. PERC TIME _____ SQ. FT/BR _____

TRENCH WIDTH _____ INLET DEPTH _____ MAX. BOT DEPTH _____ EFFECTIVE S/W _____

Percolation Information- 12450 Frederick Road (Repair)

NOT TO SCALE

#1

2sbk, Dark Brown Grey SCL
-----0.8'

Red-Brown SCL
Much Mica
-----2'

Red-Brown-Yellow FSL
Much Mica
Small Schist @ 6'

↓

-----14'

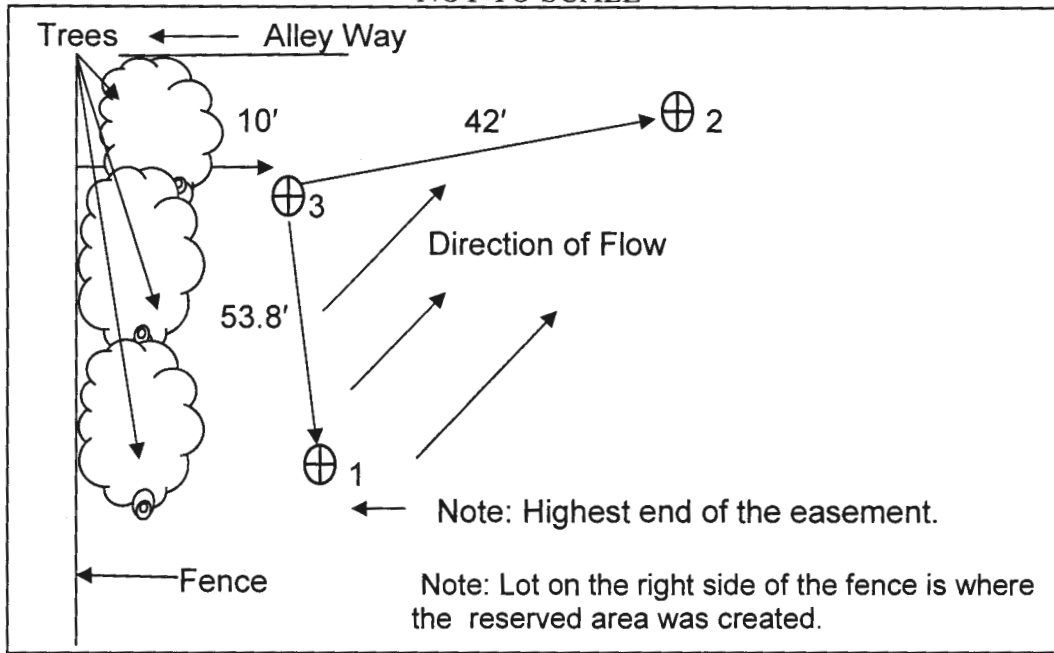

#4

#5

#2

2sbk, Dark Brown Grey SCL
-----0.8'

Red-Brown Weakly SCL
-----2'

Red-Brown Yellow FSL
Much Mica
10-20% Small Stones

↓

-----14'

Date	Test	Depth	Start	Break 1" Drop	Break 2" Drop	Time of 2 nd Inch	P/F/H
6-22-11	1	3 1/4'	10:17	10:20	10:22	2 min.	Pass
6-22-11	2	4/14	10:39	10:42	10:47	5 min.	Pass
6-22-11	3	4/14'	11:21	11:17	11:29	12 min.	Pass

#3

Remarks: Lot for easement is on the right side of the house.

#3

2sbk, Grey Brown SCL
-----0.8'

Red-Brown SCL
-----3'

Red-Brown Yellow FSL
Small Schist @ 3'
10-20% Small Stones
Much Mica

↓

-----14'

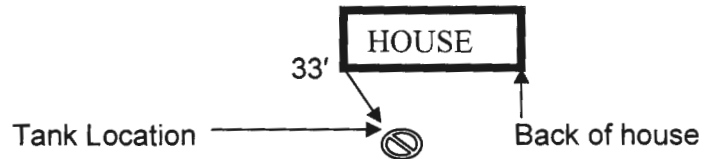

Two wells on property about 50' apart (sealed, tight, and above grade).
Well #1 tag # is HO-95-0041. Well #2 does not have a tag but is up to code.
Tank is steel and must be replaced with a 2000 gallon tank.

Sanitarian D.B. Backhoe: Ronnie Heaps _ Others: Homeowner_____

Test Holes Used in 3 Avg. Perc Time 6 min. SQ.FT/BR 150/4

Trench Width 3' Inlet Depth 3' Max Bot.Depth 5' Effective SW 2'

#3