

SITE INSPECTION SHEET

OWNER: \_\_\_\_\_ PHONE #: \_\_\_\_\_  
ADDRESS: 13183 Rt. 108 CONTRACTOR: \_\_\_\_\_  
SUBDIVISION: \_\_\_\_\_ LOT: \_\_\_\_\_ WELL TAG #: Hand dig  
PROPOSAL: Complaint COUNTY #: 13

LOCATION DIAGRAM

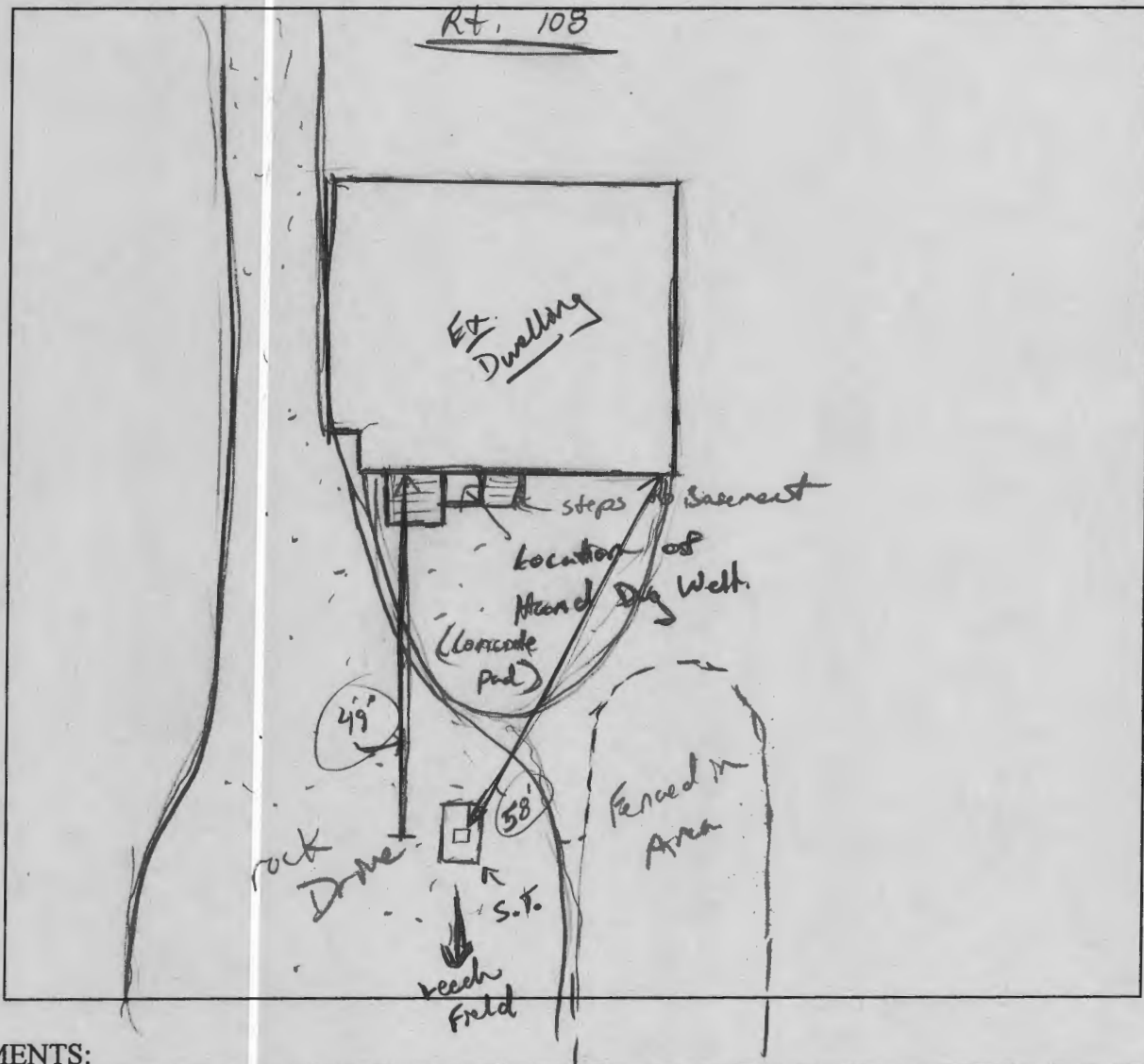

COMMENTS: \_\_\_\_\_

\_\_\_\_\_

\_\_\_\_\_

DATE: 8/26/08 INSPECTOR: (Signature)



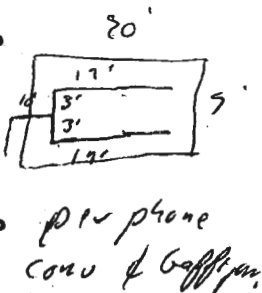
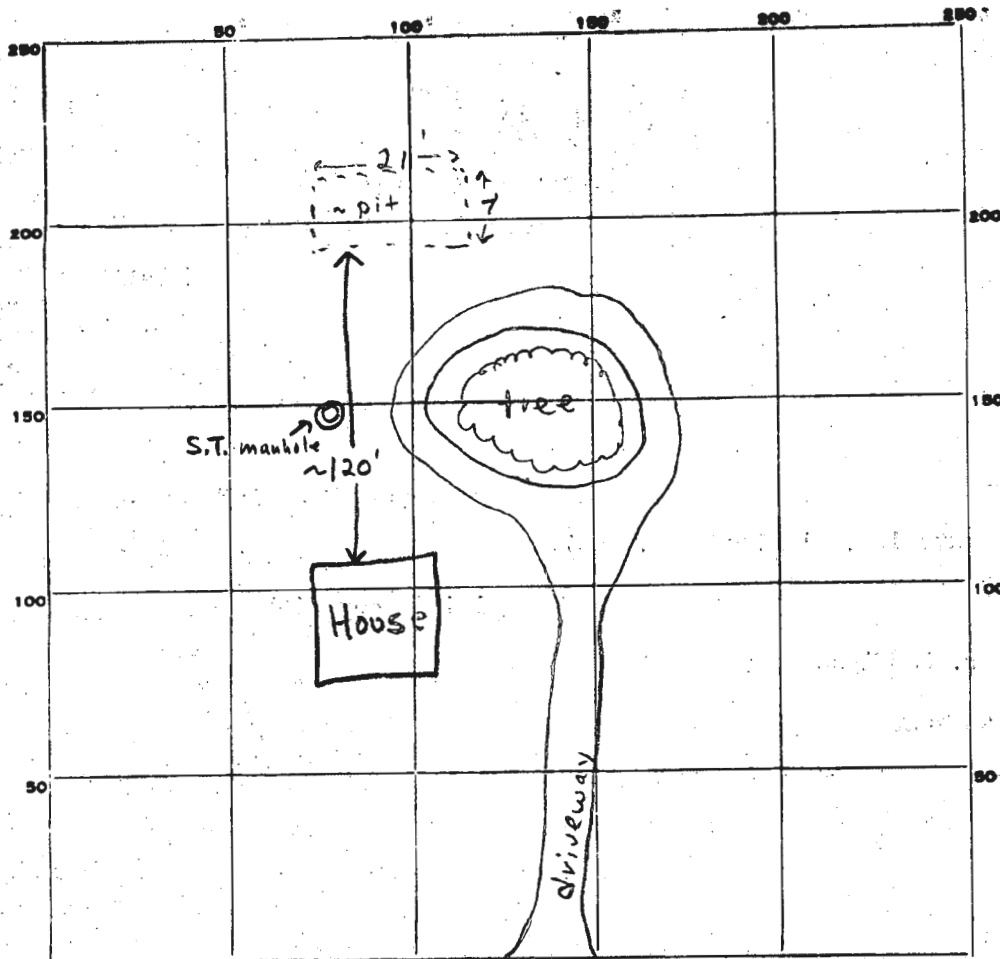

INDICATE NORTH. NAME ADJOINING ROADWAY AS BASE LINE.

Rte 108

PERMIT CARD signed ok & work complete

Gaffigan will send sketches etc.

SEPTIC TANK, LEVEL \_\_\_\_\_ CLEANOUTS \_\_\_\_\_

DISTRIBUTION BOX, LEVEL \_\_\_\_\_

TILE FIELD, DEPTH \_\_\_\_\_ FT. TRENCH WIDTH \_\_\_\_\_ FT.

GRAVEL DEPTH \_\_\_\_\_ IN. TOTAL LENGTH \_\_\_\_\_ FT.

NUMBER OF TRENCHES \_\_\_\_\_ TOTAL BOTTOM AREA \_\_\_\_\_

SEEPAGE PITS, INSIDE DIAMETER \_\_\_\_\_ FT. DEPTH BELOW INLET \_\_\_\_\_ FT.

ABSORBENT AREA \_\_\_\_\_ SQ. FT.

REMARKS ~2pm 9/2/78 Visited site, system has been covered over, spoke to Mr. & Mrs. Gaffigan who said that pit was 7'8" wide and ~21' long and 10ft. deep inlet 3-4' ± ~6' gravel under pipe G. Skinner I informed Ms Gaffigan 9/1/78 that work might begin in Aug 9/2/78 and continue. System repaired, but Not Inspector Reported design is within my specifications O.P.M.

DATE SYSTEM APPROVED DPOM - 9/6/78 INSPECTOR Paul J. Miller

9/2/78

Final OK  
DPOA 9/6/78

# PERMIT

P 28791  
A Repair

SEWAGE DISPOSAL SYSTEM

MARYLAND STATE DEPARTMENT OF HEALTH

HOWARD COUNTY

ELLICOTT CITY

DISTRICT 5th

INDEXED

DATE 9/1/78

Mr. Gaffigan IS PERMITTED TO INSTALL ALTER

ADDRESS 13183 Route 108, Highland, Md. 20777 PHONE 286-3882

SUBDIVISION ROAD 13183 Route 108 LOT

PROPERTY OWNER Mr. Gaffigan

ADDRESS same as above

SPECIFICATIONS

SEPTIC TANK CAPACITY \_\_\_\_\_ GALLONS  
DRAIN FIELD \_\_\_\_\_ DEPTH \_\_\_\_\_ FEET, BOTTOM AREA \_\_\_\_\_ SQ. FT.  
DEEP TRENCH \_\_\_\_\_ DEPTH \_\_\_\_\_ FEET, BOTTOM AREA \_\_\_\_\_ SQ. FT.  
SEEPAGE PITS \_\_\_\_\_ ABSORBENT SIDE-WALL AREA \_\_\_\_\_ SQ. FT.  
INLET PIPE \_\_\_\_\_ FT. BELOW ORIGINAL GRADE. MAXIMUM DEPTH \_\_\_\_\_ FT. BELOW ORIGINAL GRADE  
EFFECTIVE DEPTH AT \_\_\_\_\_ FT. BELOW ORIGINAL GRADE.  
LOCATE DISPOSAL AREA \_\_\_\_\_ FT. FROM \_\_\_\_\_ LOT LINE AND \_\_\_\_\_ FT. FROM \_\_\_\_\_ LOT LINE AS SEEN WHEN  
FACING LOT FROM

REPAIR - Call for an appointment when ground is opened up and Sanitarian will

recommend repair system. Pit 6'+wide, 20'+long, 6'+deep 4'+stone.  
Told Mrs Gaffigan to begin work in Am, keep working, inspector  
will stop by about noon. Keep notes on all work.

PLANS APPROVED BY Palmer F. Wine DATE 9/1/78

COVER NO WORK UNTIL INSPECTED AND APPROVED.

NEITHER THE HOWARD COUNTY COUNCIL NOR THE HEALTH DEPARTMENT IS RESPONSIBLE FOR THE SUCCESSFUL OPERATION OF ANY SYSTEM.

NOTE: IF TRENCH IS USED CALL FOR INSPECTION BEFORE PLACING GRAVEL IN TRENCH.

NOTE: NO DRY WELL SHALL EXCEED 15 FOOT IN DIAMETER.

NOTE: ALL PIPE FROM HOUSE TO DISPOSAL AREA MUST BE CAST IRON.

PERMIT VOID AFTER THREE YEARS.

NOTE: INSTALL STAND PIPE ON SEPTIC TANK AND DRY WELL. STAND PIPES MUST BE 6 INCHES IN DIAMETER. CAST IRON, CONCRETE OR TERRA  
COTTA ACCEPTED.

\*INSTALLER IS RESPONSIBLE FOR OBTAINING FINAL APPROVAL ON THIS PERMIT.

P28791



Account Identifier: District - 05 Account Number - 346525

**Owner Information**

Owner Name: FEDERLINE PETER F Use: RESIDENTIAL  
 Mailing Address: 13183 ROUTE 108 Principal Residence: YES  
 HIGHLAND MD 20777-9706 Deed Reference: 1) / 2344/ 542  
 2)

**Location & Structure Information**

Premises Address: 13183 CLARKSVILLE PIKE  
 HIGHLAND 20777  
 Legal Description: 2.04 A  
 13183 CLARKSVILLE PIKE  
 HIGHLAND

Map	Grid	Parcel	Sub District	Subdivision	Section	Block	Lot	Assessment Area	Plat No:
40	5	171						2	Plat Ref:

Special Tax Areas: Town Ad Valorem Tax Class  
 NO A/V, RURAL FIRE TAX

Enclosed Area	Property Land Area	County Use
1,451 SF	2.04 AC	

Stories	Basement	Type	Exterior
1 1/2	YES	STANDARD UNIT	FRAME

**Value Information**

	Base Value	Value Phase-in Assessments		
		As Of 01/01/2008	As Of 07/01/2008	As Of 07/01/2009
Land	280,400	335,400		
Improvements:	57,760	78,760		
<b>Total:</b>	<b>338,160</b>	<b>414,160</b>	<b>363,493</b>	<b>388,826</b>
Preferential Land:	0	0	0	0

**Transfer Information**

Seller: FENTRESS DONALD G AND WF Date: 06/18/1991 Price: \$128,000  
 Type: IMPROVED ARMS-LENGTH Deed1: / 2344/ 542 Deed2:  
 Seller: Date: Price:  
 Type: Deed1: Deed2:  
 Seller: Date: Price:  
 Type: Deed1: Deed2:

**Exemption Information**

Partial Exempt Assessments	Class	07/01/2008	07/01/2009
County	000	0	0
State	000	0	0
Municipal	000	0	0

Tax Exempt: NO  
 Exempt Class:

Special Tax Recapture:  
 \* NONE \*

-76°57'11"



39°11'11"



39°11'11"

Disclaimer: Howard County, Maryland assumes no responsibility for the accuracy of this report or the information contained herein or derived therefrom. The user assumes all risks and liabilities whatsoever resulting from or arising out of the use of this information. There are no oral agreements or warranties relating to the use of this report.

-76°57'11"



  
**Howard County**  
M A R Y L A N D

By:  
Office:  
Map Width: 455.00 ft.  
Print Date: 8/26/2008  
Scale: 1 in. = 50 ft.

-76°57'11"



39°11'11"



39°11'11"

-76°57'11"



Disclaimer: Howard County, Maryland assumes no responsibility for the accuracy of this report or the information contained herein or derived therefrom. The user assumes all risks and liabilities whatsoever resulting from or arising out of the use of this information. There are no oral agreements or warranties relating to the use of this report.

  
**Howard County**  
M A R Y L A N D

By:  
Office:  
Map Width: 455.00 ft.  
Print Date: 8/26/2008  
Scale: 1 in. = 50 ft.