



**Building Permit Application**  
 Howard County Maryland  
 Department of Inspections, Licenses and Permits  
 3430 Court House Drive  
 Permits: 410-313-2455  
 www.howardcountymd.gov

Date Received: 5/23/19

Permit No.: \_\_\_\_\_

Building Address: 915 SUNSET VALLEY DR  
 City: SYKESVILLE State: MD Zip Code: 21784  
 Suite/Apt. # \_\_\_\_\_ SDP/WP/BA #: \_\_\_\_\_  
 Census Tract: \_\_\_\_\_ Subdivision: \_\_\_\_\_  
 Section: \_\_\_\_\_ Area: \_\_\_\_\_ Lot: \_\_\_\_\_  
 Tax Map: \_\_\_\_\_ Parcel: \_\_\_\_\_ Grid: \_\_\_\_\_  
 Zoning: \_\_\_\_\_ Map Coordinates: \_\_\_\_\_ Lot Size: \_\_\_\_\_

Property Owner's Name: DANIEL + REBECCA ENNIS  
 Address: 915 SUNSET VALLEY DRIVE  
 City: SYKESVILLE State: MD Zip Code: 21784  
 Phone: 410-458-2936 Fax: \_\_\_\_\_  
 Email: ensix@verizon.net  
 Applicant's Name & Mailing Address, (If other than stated herein)  
 Applicant's Name: Bruce Becker  
 Address: 111 HANOVER PIKE  
 City: HAMPSTEAD State: MD Zip Code: 21074  
 Phone: \_\_\_\_\_ Fax: \_\_\_\_\_  
 Email: \_\_\_\_\_

Existing Use: KITCHEN  
 Proposed Use: DI - CALL AREA W  
 Estimated Construction Cost: \$ 7000 + 500.00  
 Description of Work: OPEN WALL INSTALL

Contractor Company: BROTHERS SERVICES  
 Contact Person: RYAN COLE R  
 Address: 111 HANOVER PIKE  
 City: HAMPSTEAD State: MD Zip Code: 21074  
 License No.: 27479  
 Phone: 443-507-1009 Fax: 443-507-1520  
 Email: rcole@brothersservices.com

3 LAM BEAMS - 1-60" - 2-12'10" - 3-13'3"

Occupant or Tenant: \_\_\_\_\_  
 Was tenant space previously occupied?  Yes  No  
 Contact Name: \_\_\_\_\_  
 Address: \_\_\_\_\_  
 City: \_\_\_\_\_ State: \_\_\_\_\_ Zip Code: \_\_\_\_\_  
 Phone: \_\_\_\_\_ Fax: \_\_\_\_\_  
 Email: \_\_\_\_\_

Engineer/Architect Company: \_\_\_\_\_  
 Responsible Design Prof.: \_\_\_\_\_  
 Address: \_\_\_\_\_  
 City: \_\_\_\_\_ State: \_\_\_\_\_ Zip Code: \_\_\_\_\_  
 Phone: \_\_\_\_\_ Fax: \_\_\_\_\_  
 Email: \_\_\_\_\_

Commercial Building Characteristics	Residential Building Characteristics	
Height:	<input checked="" type="checkbox"/> SF Dwelling <input type="checkbox"/> SF Townhouse	
No. of stories:	<u>Depth</u>	<u>Width</u>
Gross area, sq. ft./floor:	1 <sup>st</sup> floor:	
	2 <sup>nd</sup> floor:	
Area of construction (sq. ft.):	Basement:	
	<input type="checkbox"/> Finished Basement	
Use group:	<input type="checkbox"/> Unfinished Basement	
	<input type="checkbox"/> Craw Space	
	<input type="checkbox"/> Slab on Grade	
<u>Construction type:</u>	No. of Bedrooms:	
<input type="checkbox"/> Reinforced Concrete	<u>Multi-family Dwelling</u>	
<input type="checkbox"/> Structural Steel	No. of efficiency units:	
<input type="checkbox"/> Masonry	No. of 1 BR units:	
<input type="checkbox"/> Wood Frame	No. of 2 BR units:	
<input type="checkbox"/> State Certified Modular	No. of 3 BR units:	
	Other Structure:	
	Dimensions:	
<input checked="" type="checkbox"/> <u>Roadside Tree Project Permit</u>	Footings:	
<input type="checkbox"/> Yes <input type="checkbox"/> No	Roof:	
<u>Roadside Tree Project Permit #</u>	<input type="checkbox"/> State Certified Modular	
	<input type="checkbox"/> Manufactured Home	

Utilities	
<u>Water Supply</u>	
<input checked="" type="checkbox"/> Public	
<input checked="" type="checkbox"/> Private	
<u>Sewage Disposal</u>	
<input checked="" type="checkbox"/> Public	
<input checked="" type="checkbox"/> Private	
Electric: <input checked="" type="checkbox"/> Yes <input type="checkbox"/> No	
Gas: <input type="checkbox"/> Yes <input type="checkbox"/> No	
<u>Heating System</u>	
<input type="checkbox"/> Electric <input type="checkbox"/> Oil	
<input type="checkbox"/> Natural Gas <input type="checkbox"/> Propane Gas	
<input type="checkbox"/> Other:	
<u>Sprinkler System:</u>	
<input type="checkbox"/> Yes <input type="checkbox"/> No	
Grading Permit Number:	
Building Shell Permit Number:	

THE UNDERSIGNED HEREBY CERTIFIES AND AGREES AS FOLLOWS: (1) THAT HE/SHE IS AUTHORIZED TO MAKE THIS APPLICATION; (2) THAT THE INFORMATION IS CORRECT; (3) THAT HE/SHE WILL COMPLY WITH ALL REGULATIONS OF HOWARD COUNTY WHICH ARE APPLICABLE THERETO; (4) THAT HE/SHE WILL PERFORM NO WORK ON THE ABOVE REFERENCED PROPERTY NOT SPECIFICALLY DESCRIBED IN THIS APPLICATION; (5) THAT HE/SHE GRANTS COUNTY OFFICIALS THE RIGHT TO ENTER ONTO THIS PROPERTY FOR THE PURPOSE OF INSPECTING THE WORK PERMITTED AND POSTING NOTICES.

Bruce Becker  
 Applicant's Signature  
B & D DUCK & COMPANY, LLC  
 Email Address  
 \_\_\_\_\_  
 Title/Company

Bruce Becker  
 Print Name  
5/23/19  
 Date

Checks Payable to: DIRECTOR OF FINANCE OF HOWARD COUNTY

\*\*PLEASE WRITE NEATLY & LEGIBLY\*\*  
 -FOR OFFICE USE ONLY-

AGENCY	DATE	SIGNATURE OF APPROVAL
State Highways		
Building Officials		
PSZA (Zoning)		
PSZA (Engineering)		
Health	<u>5/23/2019</u>	<u>Bruce Becker</u>

DPZ SETBACK INFORMATION	
Front:	
Rear:	
Side:	
Side St.:	
All minimum setbacks met?	<input type="checkbox"/> Yes <input type="checkbox"/> No
Is Entrance Permit Required?	<input type="checkbox"/> Yes <input type="checkbox"/> No
Historic District?	<input type="checkbox"/> Yes <input type="checkbox"/> No
Lot Coverage for New Town Zone:	
SDP/Red-line approval date:	

Filing Fee	\$
Permit Fee	\$
Tech Fee	\$
Excise Tax	\$
PSFS	\$
Guaranty Fund	\$
Add'l per Fee	\$
Total Fees	\$
Sub- Total Paid	\$
Balance Due	\$
Check	#

Distribution of Copies: White: Building Officials Green: PSZA, Zoning Yellow: PSZA, Engineering Pink: Health Gold: SHH

Professional Certification: I hereby certify that these documents were prepared or approved by me, and that I am a duly licensed professional engineer under the laws of the State of Maryland

License No. 9862

Expiration Date 5/17/20

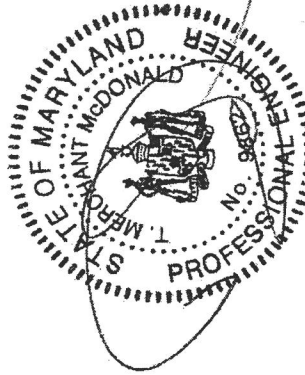

4-6-19

EXISTING BEAM SUPPORTS MUST BE EQUAL TO OR GREATER THAN SIZE NOTED,

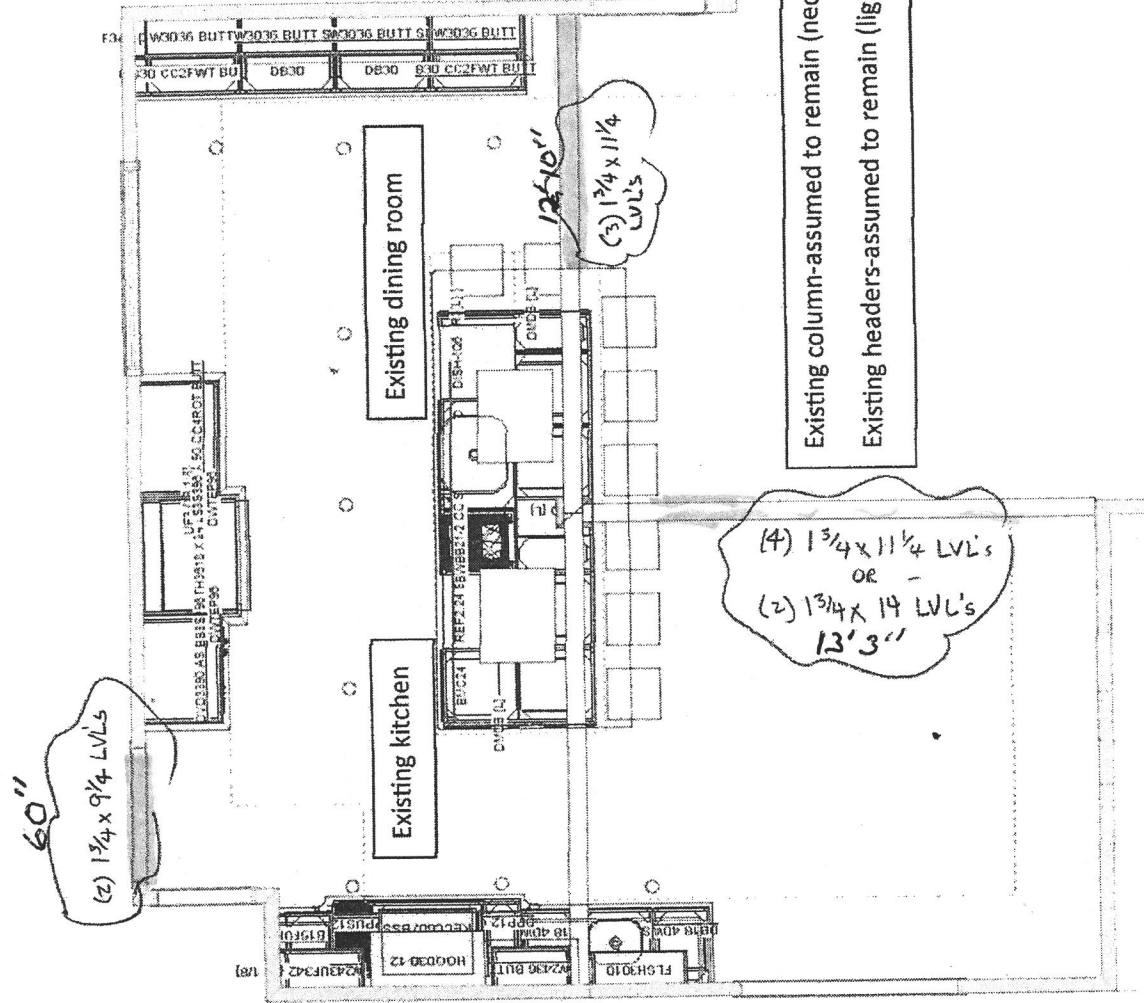

APPROVED  
WALK-THRU BUILDING PERMIT  
BP# \_\_\_\_\_ A# \_\_\_\_\_

APP. SAN Peter Freeman DATE: 5/23/2019  
DESC. OF WORK: open walk install  
3 Beams

BACK OF HOME